



- 外螺纹安装带扣环槽型悬臂销
- Cantilever Shafts - Standard, Retaining Ring Groove

型号实例	型式 Type+D-Y-F
例如	ZFXAA3-2-F3

Part Number	Type+D-Y-F
order	ZFXAA3-2-F3

型号实例	型式 Type+D-Y-F-N
例如	ZFXNAA3-2-F3-N6

Part Number	Type+D-Y-F-N
order	ZFXNAA3-2-F3-N6

- [!] 有些尺寸可能带中心孔
- [!] Some sizes may have a center hole.
- [!] 仅螺纹长度指定型可指定N。
- [!] N is available for Thread Length Configurable Type only.

螺纹长度固定型 / Thread Length Fixed

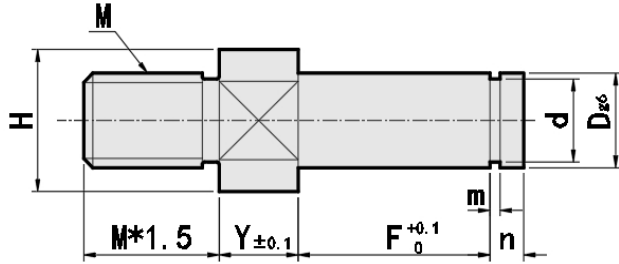

螺纹长度指定型 / Thread Length Configurable

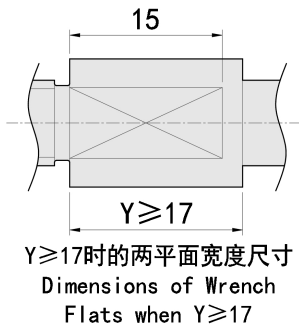
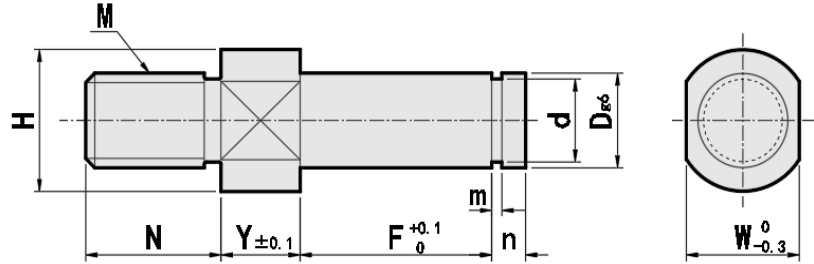

材质对照表 (Materials)				
型号Type		材质Material	硬度Hardness	表面处理Surface Treatment
螺纹长度固定型 Thread Length Fixed	螺纹长度指定型 Thread Length Configurable			
ZFXAA	ZFXNAA	S45C	/	发黑Clack Oxide
ZPFXAA	ZPFXNAA	S45C	/	镀镍Nickel Plating
ZSFXAA	ZSFXNAA	SUS304	/	/
ZHFXAA	/	SCM435	35~40HRC	发黑Clack Oxide

参数对照表 (Specifications)												
Type	型式Part Number					H	W	M (粗牙螺纹) (Coarse Thread)	d		m	n
	Dg6	指定单位1mm 1mm Increment			基准尺寸 Ref. Dim.				公差 Tolerance			
		Y	F	N								
ZFXAA ZPFXAA ZSFXAA ZHFXAA	3	-0.002 -0.008	2~30	3~50	3~6	7	5	M3	2	+0.06 0	0.5	2
	4	-0.004 -0.012	2~30	3~50	4~8	8	6	M4	3	+0.06 0	0.7	2
	5	-0.004 -0.012	2~30	3~50	5~10	9	7	M5	4	+0.075 0	0.7	2
	6	-0.004 -0.012	2~60	5~100	6~12	10	8	M6	5	+0.075 0	0.7	2
ZFXNAA ZPFXNAA ZSFXNAA	8	-0.005 -0.014	2~60	5~100	8~16	12	10	M8	7	+0.09 0	0.9	3
	10	-0.005 -0.014	2~60	5~100	10~20	15	13	M10	9.6	0 -0.09	1.15	3
	12	-0.006 -0.017	2~60	10~100	12~24	17	14	M12	11.5	0 -0.11	1.15	4
	15	-0.006 -0.017	2~60	10~100	12~24	20	17	M12	14.3	0 -0.11	1.15	4



- 台阶扣环型悬臂销
- Cantilever Shafts - Standard, Stepped, Retaining Ring

型号实例	型式 Type+D-Y-F
例如	ZFXBA3-7-F3

Part Number	Type+D-Y-F
order	ZFXBA3-7-F3

- [!] 有些尺寸可能带中心孔
- [!] Some sizes may have a center hole.
- [!] W < V时, 两平面宽度W将扩展到直径V的部位。
- [!] When W < V, wrench flats W reaches O.D.V.

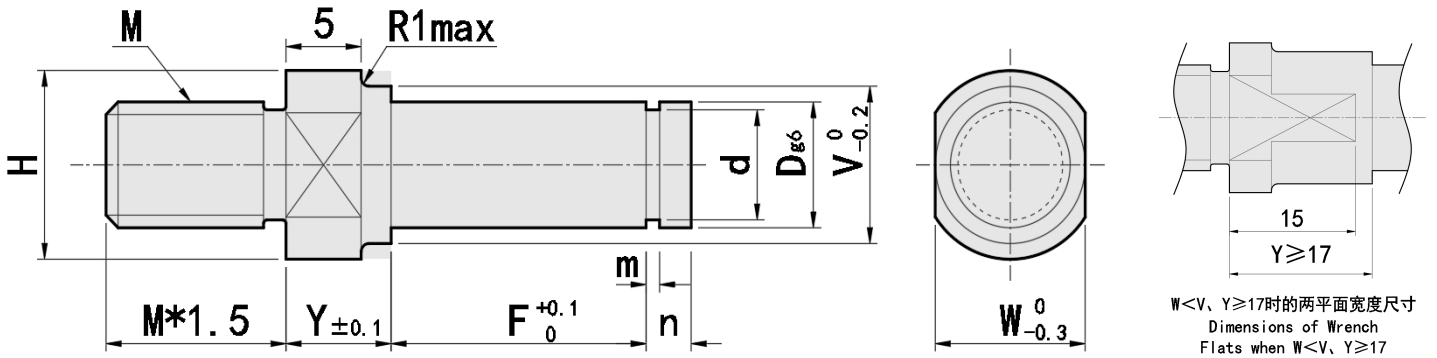

材质对照表 (Materials)			
型号 Type	材质 Material	硬度 Hardness	表面处理 Surface Treatment
ZFXBA	S45C	/	发黑Clack Oxide
ZPFXBA	S45C	/	镀镍Nickel Plating
ZSFXBA	SUS304	/	/
ZPHFXBA	SCM435	35~40HRC	发黑Clack Oxide

参数对照表(Specifications)												
Type	型式Part Number				V	H	W	M (粗牙螺纹) (Coarse Thread)	d		m	n
	Dg6		指定单位1mm 1mm Increment						基准尺寸 Ref. Dim.	公差 Tolerance		
	Y	F	Y	F								
ZFXBA ZPFXBA ZSFXBA ZPHFXBA	3	-0.002 -0.008	7~30	3~50	5	7	5	M3	2	+0.06 0	0.5	2
	4	-0.004 -0.012	7~30	3~50	6	8	6	M4	3	+0.06 0	0.7	2
	5	-0.004 -0.012	7~30	3~50	7	9	7	M5	4	+0.075 0	0.7	2
	6	-0.004 -0.012	7~60	5~100	8	10	8	M6	5	+0.075 0	0.7	2
	8	-0.005 -0.014	7~60	5~100	10	12	10	M8	7	+0.09 0	0.9	3
	10	-0.005 -0.014	7~60	5~100	13	15	13	M10	9.6	0 -0.09	1.15	3
	12	-0.006 -0.017	7~60	10~100	15	17	14	M12	11.5	0 -0.11	1.15	4
15	-0.006 -0.017	7~60	10~100	18	20	17	M12	14.3	0 -0.11	1.15	4	



- 六角型/标准扣环型悬臂销
- Cantilever Shafts - Standard, Hex Head, Retaining Ring Groove

型号实例	型式 Type+D-Y-F
例如	ZLXAA3-2-F3

Part Number	Type+D-Y-F
order	ZLXAA3-2-F3

型号实例	型式 Type+D-Y-F-N
例如	ZLXNAA3-2-F3-N6

Part Number	Type+D-Y-F-N
order	ZLXNAA3-2-F3-N6

- [!] 有些尺寸可能带中心孔
- [!] Some sizes may have a center hole.
- [!] 仅螺纹长度指定型可指定N。
- [!] N is available for Thread Length Configurable Type only.

螺纹长度固定型 / Thread Length Fixed

螺纹长度指定型 / Thread Length Configurable

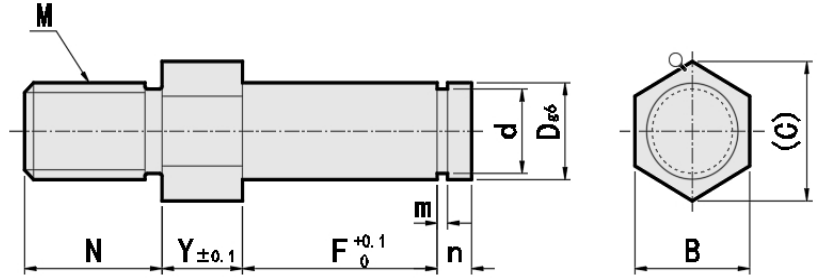
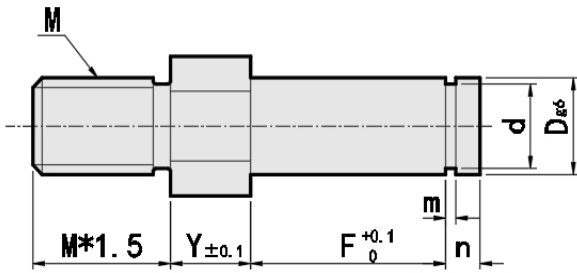

材质对照表 (Materials)				
型号Type		材质Material	硬度Hardness	表面处理Surface Treatment
螺纹长度固定型 Thread Length Fixed	螺纹长度指定型 Thread Length Configurable			
ZLXAA	ZLXNAA	S45C	/	发黑Black Oxide
ZPLXAA	ZPLXNAA	S45C	/	镀镍Nickel Plating
ZSLXAA	ZSLXNAA	SUS304	/	/

参数对照表 (Specifications)												
Type	型式Part Number		指定单位1mm 1mm Increment			B	(C)	M (粗牙螺纹) (Coarse Thread)	d		m	n
			Y	F	N				基准尺寸 Ref. Dim.	容差 Tolerance		
	Dg6											
ZLXAA ZPLXAA ZSLXAA	3	-0.002 -0.008	2~30	3~50	3~6	6	6.9	M3	2	+0.06 0	0.5	2
	4	-0.004 -0.012	2~30	3~50	4~8	6	6.9	M4	3	+0.06 0	0.7	2
	5	-0.004 -0.012	2~30	3~50	5~10	7	8.1	M5	4	+0.075 0	0.7	2
ZLXNAA ZPLXNAA ZSLXNAA	6	-0.004 -0.012	2~60	5~100	6~12	8	9.2	M6	5	+0.075 0	0.7	2
	8	-0.005 -0.014	2~60	5~100	8~16	10	11.5	M8	7	+0.09 0	0.9	3
	10	-0.005 -0.014	2~60	5~100	10~20	13	15.0	M10	9.6	0 -0.09	1.15	3



- 外螺纹安装、内螺纹安装标准型悬臂销
- Cantilever Shafts - Standard, Tapped End

型号实例	型式 Type+D-Y-F-MA
例如	ZFXAB6-2-F10-MA3

Part Number	Type+D-Y-F-MA
order	ZFXAB6-2-F10-MA3

型号实例	型式 Type+D-Y-F-N-MA
例如	ZFXAB6-2-F10-N6-MA3

Part Number	Type+D-Y-F-N-MA
order	ZFXAB6-2-F10-N6-MA3

[!] 有些尺寸可能带中心孔。

[!] 仅螺纹长度指定型可指定N。

[!] Some sizes may have a center hole.

[!] N is available for Thread Length Configurable Type only.

[!] MA及Y/F的尺寸请参阅表1后制定。

[!] Please refer to Table 1 to specify dimensions Y and F.

螺纹长度固定型 / Thread Length Fixed

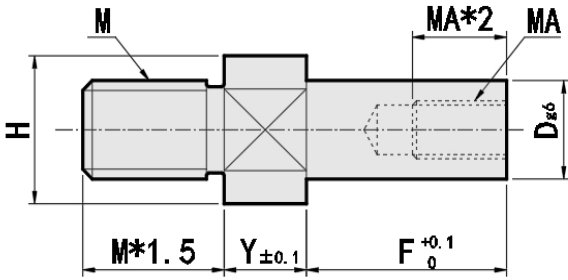

螺纹长度指定型 / Thread Length Configurable

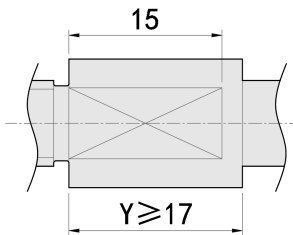
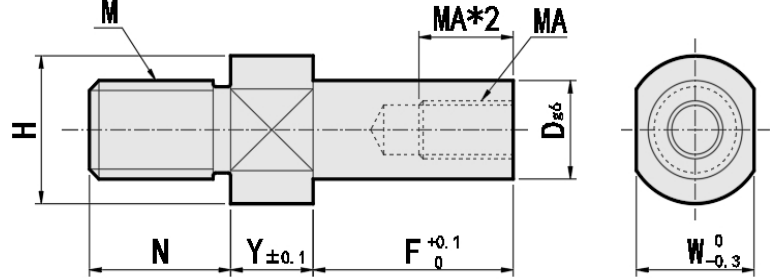

Y ≥ 17时的两平面宽度尺寸
Dimensions of Wrench Flats when Y ≥ 17

材质对照表 (Materials)				
型号Type		材质Material	硬度Hardness	表面处理Surface Treatment
螺纹长度固定型Thread Length Fixed	螺纹长度指定型Thread Length Configurable			
ZFXAB	ZFXNAB	S45C	/	发黑Black Oxide
ZPFXAB	ZPFXNAB	S45C	/	镀镍Nickel Plating
ZSFXAB	ZSFXNAB	SUS304	/	/
ZPHFXAB	/	SCM435	35~40HRC	镀镍Nickel Plating

参数对照表(Specifications)									
Type	型式Part Number								
	Dg6		指定单位1mm 1mm Increment			MA (粗牙螺纹) (Coarse)	H	W	M (粗牙螺纹) (Coarse Thread)
			Y	F	N				
ZFXAB ZPFXAB ZSFXAB ZPHFXAB	6	-0.004 -0.012	2~60	5~100	6~12	3	10	8	M6
	8	-0.005 -0.014	2~60	5~100	8~16	4	12	10	M8
	10	-0.005 -0.014	2~60	5~100	10~20	4 5 6	15	13	M10
ZFXNAB ZPFXNAB ZSFXNAB	12	-0.006 -0.017	2~60	10~100	12~24	5 6 8	17	14	M12
	15	-0.006 -0.017	2~60	10~100	12~24	6 8 10	20	17	M12

表1/Table 1	
MA	Y+F
M3	Y+F ≥ 11.5
M4	Y+F ≥ 14.0
M5	Y+F ≥ 16.2
M6	Y+F ≥ 18.5
M8	Y+F ≥ 23.5
M10	Y+F ≥ 28.5



- 外螺纹安装、内螺纹台阶型悬臂销
- Cantilever Shafts - Standard, Stepped, Tapped End

型号实例	型式 Type+D-Y-F-MA
例如	ZFXBB6-7-F5-MA3

Part Number	Type+D-Y-F-MA
order	ZFXBB6-7-F5-MA3

- [!] 有些尺寸可能带中心孔。
- [!] Some sizes may have a center hole.
- [!] $W < V$ 时，两平面宽度W将扩展到直径V的部位
- [!] When $W < V$, wrench flats W reaches O.D.V.

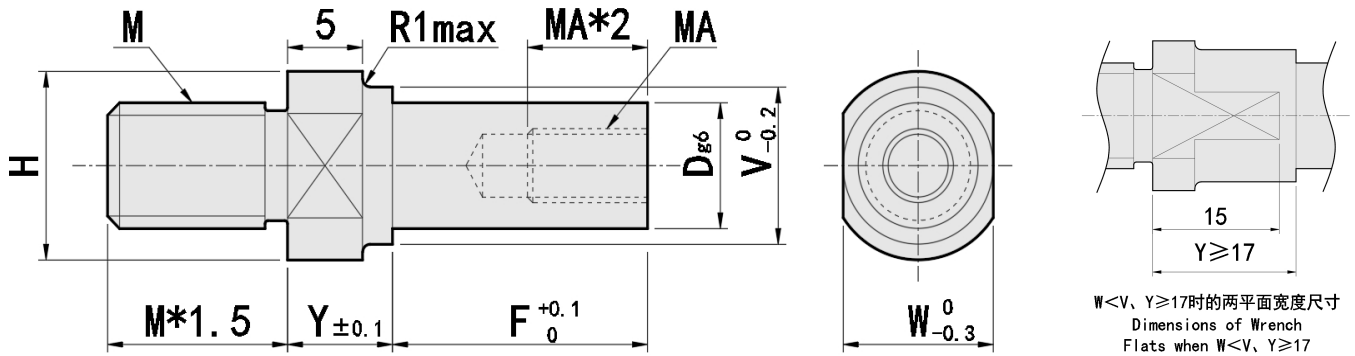

材质对照表 (Materials)		
型号 Type	材质 Material	表面处理 Surface Treatment
ZFXBB	S45C	发黑Clack Oxide
ZPFXBB	S45C	镀镍Nickel Plating
ZSFXBB	SUS304	/

参数对照表(Specifications)									
型式Part Number									
Type	Dg6		指定单位1mm 1mm Increment		MA (粗牙螺纹) (Coarse)	V	H	W	M (粗牙螺纹) (Coarse Thread)
			Y	F					
ZFXBB ZPFXBB ZSFXBB	6	-0.004 -0.012	7~60	5~75	3	8	10	8	M6
	8	-0.005 -0.014	7~60	5~75	4	10	12	10	M8
	10	-0.005 -0.014	7~60	5~75	4 5 6	13	15	13	M10
	12	-0.006 -0.017	7~60	10~75	5 6 8	15	17	14	M12
	15	-0.006 -0.017	7~60	10~75	6 8 10	18	20	17	M12

表1/Table 1	
MA	Y+F
M3	Y+F≥11.5
M4	Y+F≥14.0
M5	Y+F≥16.2
M6	Y+F≥18.5
M8	Y+F≥23.5
M10	Y+F≥28.5



- 外螺纹安装、内螺纹六角型悬臂销
- Cantilever Shafts - Standard, Hex Head, Tapped End

型号实例	型式 Type+D-Y-F-MA
例如	ZLXAB6-7-F10-MA3

Part Number	Type+D-Y-F-MA
order	ZLXAB6-7-F10-MA3

型号实例	型式 Type+D-Y-F-N-MA
例如	ZLXNAB6-2-F10-N6-MA3

Part Number	Type+D-Y-F-N-MA
order	ZLXNAB6-2-F10-N6-MA3

- [!] MA及Y/F的尺寸请参阅表1后指定。
- [!] Please refer to Table 1 to specify dimensions Y and F.
- [!] 有些尺寸可能带中心孔。
- [!] Some sizes may have a center hole.

螺纹长度固定型 / Thread Length Fixed

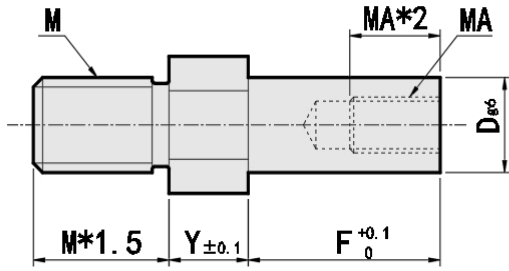

螺纹长度指定型 / Thread Length Configurable

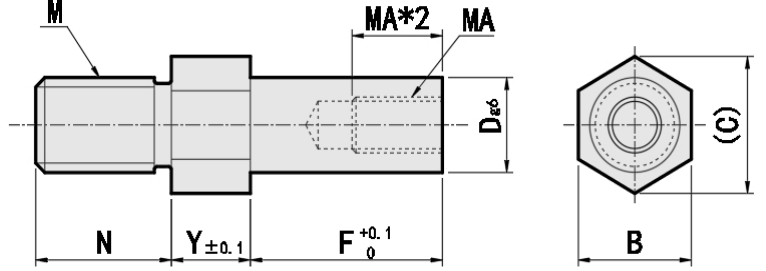

材质对照表 (Materials)			
型号Type		材质Material	表面处理Surface Treatment
螺纹长度固定型 Thread Length Fixed	螺纹长度指定型 Thread Length Configurable		
ZLXAB	ZLXNAB	S45C	发黑Clack Oxide
ZPLXAB	ZPLXNAB	S45C	镀镍Nickel Plating
ZSLXAB	ZSLXNAB	SUS304	/

参数对照表(Specifications)									
型式Part Number									
Type	Dg6		指定单位1mm 1mm Increment			MA (粗牙螺纹) (Coarse)	B	(C)	M (粗牙螺纹) (Coarse Thread)
			Y	F	N				
ZLXAB ZPLXAB ZSLXAB	6	-0.004 -0.012	2~60	5~100	6~12	3	8	9.2	M6
	8	-0.005 -0.014	2~60	5~100	8~16	4	10	11.5	M8
	10	-0.005 -0.014	2~60	5~100	10~20	4 5 6	13	15	M10
ZLXNAB ZPLXNAB ZSLXNAB	12	-0.006 -0.017	2~60	10~100	12~24	5 6 8	14	16.2	M12
	15	-0.006 -0.017	2~60	10~100	12~24	6 8 10	17	19.6	M12

表1	
MA	Y+F
M3	Y+F≥11.5
M4	Y+F≥14.0
M5	Y+F≥16.2
M6	Y+F≥18.5
M8	Y+F≥23.5
M10	Y+F≥28.5



■外螺纹安装、外螺纹标准型悬臂销

■ Cantilever Shafts - Standard, Threaded End

型号实例	型式 Type+D-Y-F-MA
例如	ZFXAC6-7-F10-MA4

Part Number	Type+D-Y-F-MA
order	ZFXAC6-7-F10-MA4

型号实例	型式 Type+D-Y-F-N-MA
例如	ZFXNAC6-2-F7-N6-MA4

Part Number	Type+D-Y-F-N-MA
order	ZFXNAC6-2-F7-N6-MA4

[!]有些尺寸可能带中心孔。

[!]Some sizes may have a center hole.

[!]仅螺纹长度指定型可指定N。

[!]N is available for Thread Length Configurable Type only.

螺纹长度固定型 / Thread Length Fixed

螺纹长度指定型 / Thread Length Configurable

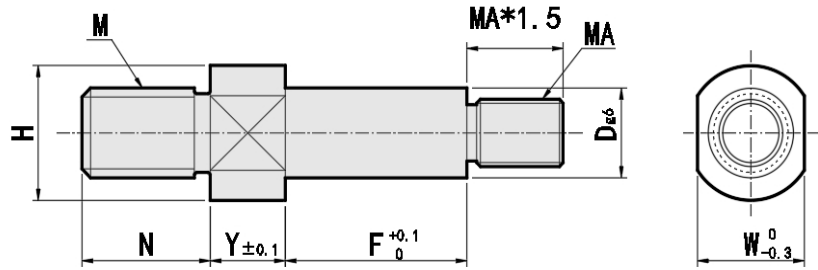
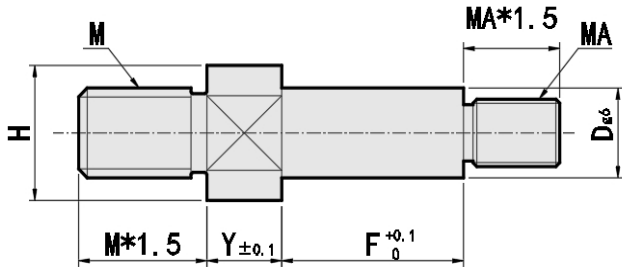

D=MA时 / When D=MA

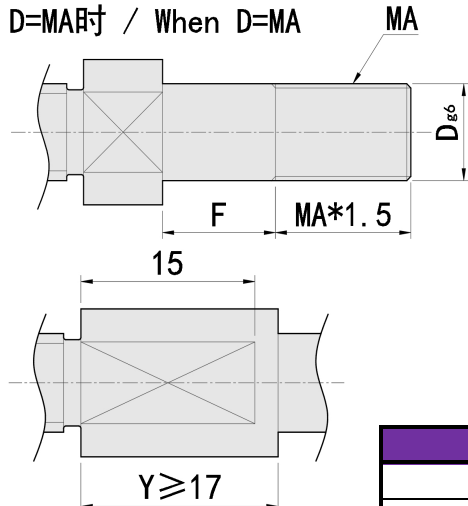

Y ≥ 17时的两平面宽度尺寸
Dimensions of Wrench Flats when Y ≥ 17

材质对照表 (Materials)				
型号Type		材质 Material	硬度 Hardness	表面处理 Surface Treatment
螺纹长度固定型 Thread Length Fixed	螺纹长度指定型 Thread Length Configurable			
ZFXAC	ZFXNAC	S45C	/	发黑Black Oxide
ZPFXAC	ZPFXNAC	S45C	/	镀镍Nickel Plating
ZSFXAC	ZSFXNAC	SUS304	/	/
ZPHFXAC	/	SCM435	35~40HRC	镀镍Nickel Plating

参数对照表(Specifications)									
Type	型式Part Number					MA (粗牙螺纹) (Coarse Thread)	H	W	M (粗牙螺纹) (Coarse Thread)
	Dg6	指定单位1mm 1mm Increment							
		Y	F	N					
ZFXAC ZPFXAC ZSFXAC ZPHFXAC	3	-0.002 -0.008	2~30	3~50	3~6	3	7	5	M3
	4	-0.004 -0.012	2~30	3~50	4~8	3 4	8	6	M4
	5	-0.004 -0.012	2~30	3~50	5~10	3 4 5	9	7	M5
ZFXNAC ZPFXNAC ZSFXNAC	6	-0.004 -0.012	2~60	5~100	6~12	4 5 6	10	8	M6
	8	-0.005 -0.014	2~60	5~100	8~16	5 6 8	12	10	M8
	10	-0.005 -0.014	2~60	5~100	10~20	6 8 10	15	13	M10
	12	-0.006 -0.017	2~60	10~100	12~24	6 8 10 12	17	14	M12
	15	-0.006 -0.017	2~60	10~100	12~24	6 8 10 12	20	17	M12



- 外螺纹安装、外螺纹台阶型悬臂销
- Cantilever Shafts - Standard, Stepped, Threaded End

型号实例	型式 Type+D-Y-F-MA
例如	ZFXBC3-7-F5-MA3

Part Number	Type+D-Y-F-MA
order	ZFXBC3-7-F5-MA3

- [!] 有些尺寸可能带中心孔。
- [!] Some sizes may have a center hole.
- [!] W < V时，两平面宽度W将扩展到直径V的部位
- [!] When W < V, wrench flats W reaches O.D.V.
- [!] Y+F ≤ 100

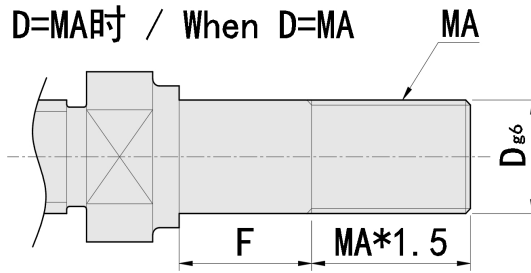
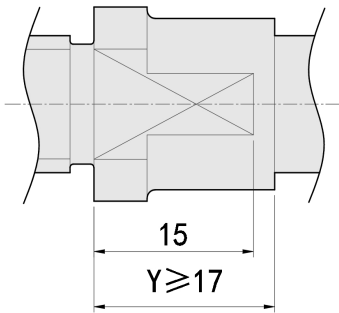
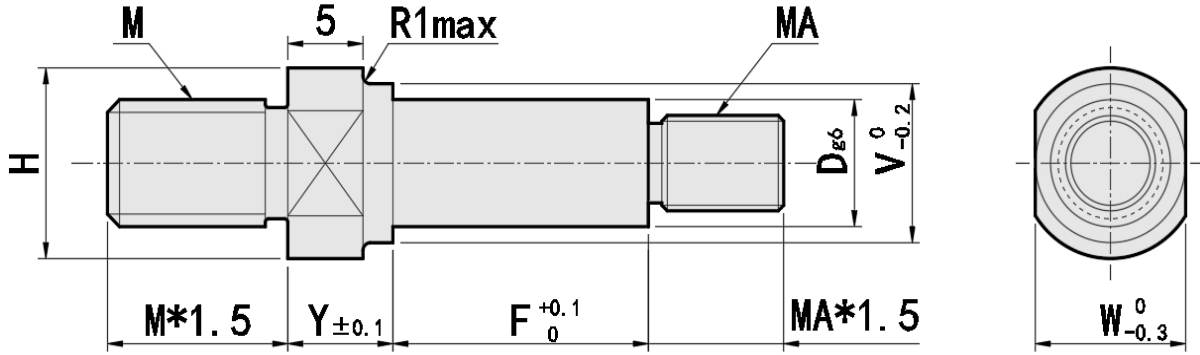

材质对照表 (Materials)		
型号 Type	材质 Material	表面处理 Surface Treatment
ZFXBC	S45C	发黑Black Oxide
ZPFXBC	S45C	镀镍Nickel Plating
ZSFXBC	SUS304	/

W < V、Y ≥ 17时的两平面宽度尺寸
Dimensions of Wrench Flats when W < V、Y ≥ 17

参数对照表 (Specifications)									
Type	Dg6		指定单位1mm 1mm Increment		MA (粗牙螺纹) (Coarse Thread)	V	H	W	M (粗牙螺纹) (Coarse Thread)
			Y	F					
	3	-0.002 -0.008	7~30	3~50	3				
ZFXBC ZPFXBC ZSFXBC	4	-0.004 -0.012	7~30	3~50	3 4	6	8	6	M4
	5	-0.004 -0.012	7~30	3~50	3 4 5	7	9	7	M5
	6	-0.004 -0.012	7~60	5~100	4 5 6	8	10	8	M6
	8	-0.005 -0.014	7~60	5~100	5 6 8	10	12	10	M8
	10	-0.005 -0.014	7~60	5~100	6 8 10	13	15	13	M10
	12	-0.006 -0.017	7~60	10~100	6 8 10 12	15	17	14	M12
	15	-0.006 -0.017	7~60	10~100	8 10 12	18	20	17	M12



- 悬臂销外螺纹安装.带扣环沟槽固定型
- Cantilever Shafts - Standard, Hex Head, Threaded End

型号实例	型式 Type+D-Y-F-MA
例如	ZLXAC6-7-F10-MA4

Part Number	Type+D-Y-F-MA
order	ZLXAC6-7-F10-MA4

型号实例	型式 Type+D-Y-F-N-MA
例如	ZLXNAC6-2-F10-N6-MA4

Part Number	Type+D-Y-F-N-MA
order	ZLXNAC6-2-F10-N6-MA4

- [!] 有些尺寸可能带中心孔。
- [!] Some sizes may have a center hole.
- [!] 仅螺纹长度指定型可指定N。
- [!] N is available for Thread Length Configurable Type only.

螺纹长度固定型 / Thread Length Fixed

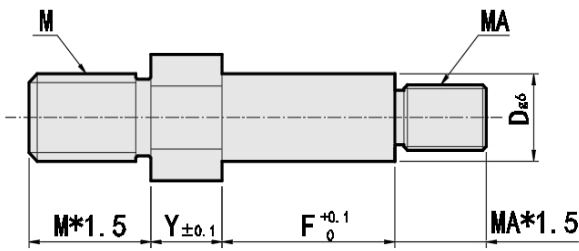

螺纹长度指定型 / Thread Length Configurable

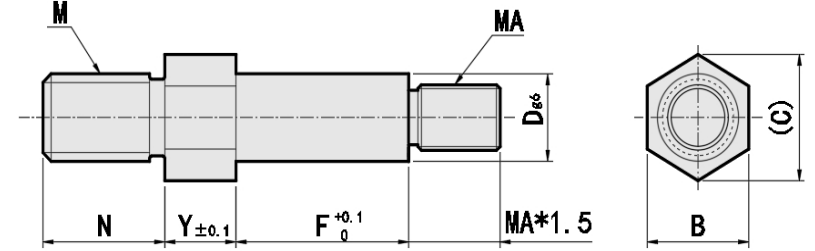

D=MA时 / When D=MA

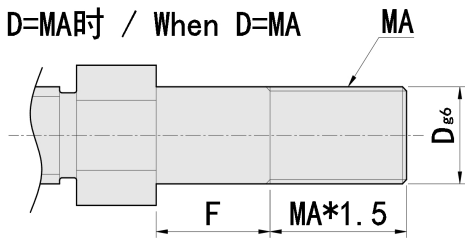

材质对照表 (Materials)				
型号Type		材质Material	硬度Hardness	表面处理Surface Treatment
螺纹长度固定型 Thread Length Fixed	螺纹长度指定型 Thread Length Configurable			
ZLXAC	ZLXNAC	S45C	/	发黑Black Oxide
ZPLXAC	ZPLXNAC	S45C	/	镀镍Nickel Plating
ZSLXAC	ZSLXNAC	SUS304	/	/

参数对照表(Specifications)									
Type	型式Part Number								
	Dg6	指定单位1mm 1mm Increment			MA (粗牙螺纹) (Coarse Thread)	B	(C)	M (粗牙螺纹) (Coarse Thread)	
		Y	F	N					
ZLXAC ZPLXAC ZSLXAC	3	-0.002 -0.008	2~30	3~50	3~6	3	6	6.9	M3
	4	-0.004 -0.012	2~30	3~50	4~8	3 4	6	6.9	M4
	5	-0.004 -0.012	2~30	3~50	5~10	3 4 5	7	8.1	M5
ZLXNAC ZPLXNAC ZSLXNAC	6	-0.004 -0.012	2~60	5~75	6~12	4 5 6	8	9.2	M6
	8	-0.005 -0.014	2~60	5~75	8~16	5 6 8	10	11.5	M8
	10	-0.005 -0.014	2~60	5~75	10~20	6 8 10	13	15	M10
	12	-0.006 -0.017	2~60	10~75	12~24	6 8 10 12	14	16.2	M12
	15	-0.006 -0.017	2~60	10~75	12~24	8 10 12	14	16.2	M12



- 嵌入外螺纹安装、带扣环槽标准型悬臂销
- Cantilever Shafts - Pilot, Retaining Ring Groove

型号实例	型式 Type+D-Y-F-G
例如	ZFXCA6-7-F10-G5

型号实例	型式 Type+D-Y-F-G-N
例如	ZFXNCA6-7-F10-G5-N6

Part Number	Type+D-Y-F-G
order	ZFXCA6-7-F10-G5

Part Number	Type+D-Y-F-G-N
order	ZFXNCA6-7-F10-G5-N6

- [!] 有些尺寸可能带中心孔
- [!] Some sizes may have a center hole.
- [!] 仅螺纹长度指定型可指定N。
- [!] N is available for Thread Length Configurable Type only.

螺纹长度固定型 / Thread Length Fixed

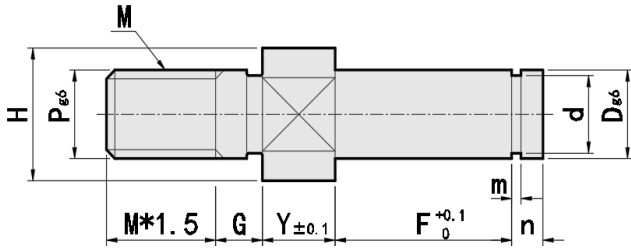

螺纹长度指定型 / Thread Length Configurable

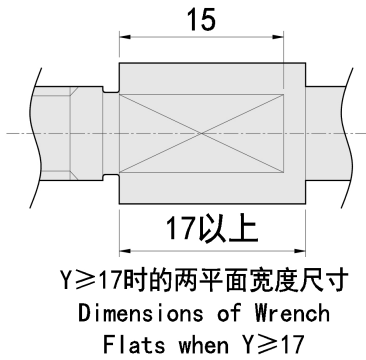
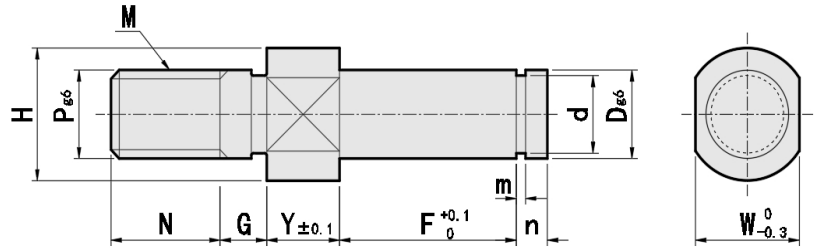

材质对照表 (Materials)				
型号Type		材质 Material	硬度 Hardness	表面处理 Surface Treatment
螺纹长度固定型 Thread Length Fixed	螺纹长度指定型 Thread Length Configurable			
ZFXCA	ZFXNCA	S45C	/	发黑Clack Oxide
ZPFXCA	ZPFXNCA	S45C	/	镀镍Nickel Plating
ZSFXCA	ZSFXNCA	SUS304	/	/
ZHFXCA	/	SCM435	35~40HRC	发黑Clack Oxide

参数对照表(Specifications)															
Type	型式Part Number						Pg6	M (粗牙螺纹) (Coarse Thread)	H	W	d		m	n	
	Dg6	指定单位1mm 1mm Increment				基准尺寸 Ref. Dim.					公差 Tolerance				
		Y	F	G	N										
ZFXCA ZPFXCA ZSFXCA ZHFXCA	3	-0.002 -0.008	2~30	3~50	3~8	3~6	3	-0.002 -0.008	M3	7	5	2	+0.06 0	0.5	2
	4	-0.004 -0.012	2~30	3~50	3~8	4~8	4	-0.004 -0.012	M4	8	6	3	+0.06 0	0.7	2
	5	-0.004 -0.012	2~30	3~50	3~8	5~10	5	-0.004 -0.012	M5	9	7	4	+0.075 0	0.7	2
	6	-0.004 -0.012	2~60	5~100	5~10	6~12	6	-0.004 -0.012	M6	10	8	5	+0.075 0	0.7	2
ZFXNCA ZPFXNCA ZSFXNCA	8	-0.005 -0.014	2~60	5~100	5~10	8~16	8	-0.005 -0.014	M8	12	10	7	+0.09 0	0.9	3
	10	-0.005 -0.014	2~60	5~100	5~10	10~20	10	-0.005 -0.014	M10	15	13	9.6	0 -0.09	1.15	3
	12	-0.006 -0.017	2~60	10~100	5~15	12~24	12	-0.006 -0.017	M12	17	14	11.5	0 -0.11	1.15	4
	15	-0.006 -0.017	2~60	10~100	5~15	12~24	12	-0.006 -0.017	M12	20	17	14.3	0 -0.11	1.15	4



- 嵌入外螺纹安装、带扣环槽台阶型悬臂销
- Cantilever Shafts - Pilot, Stepped, Retaining Ring Groove

型号实例	型式 Type+D-Y-F-G
例如	ZFXDA6-7-F10-G5

Part Number	Type+D-Y-F-G
order	ZFXDA6-7-F10-G5

- [!] 有些尺寸可能带中心孔
- [!] Some sizes may have a center hole.
- [!] W < V时，两平面宽度W将扩展到直径V的部位。
- [!] When W < V, wrench flats W reaches O.D.V.

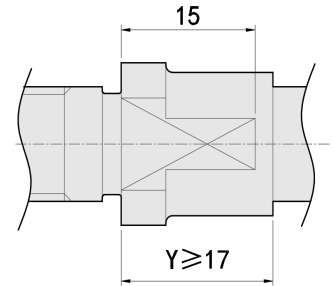
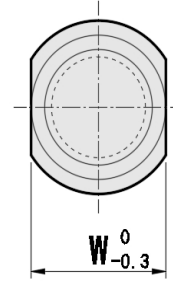
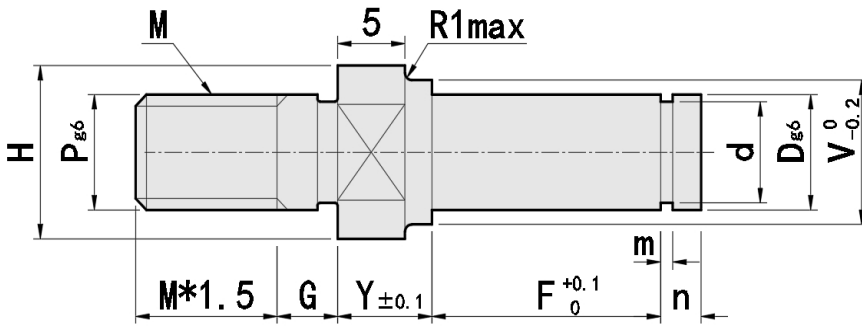

W < V, Y ≥ 17时的两平面宽度尺寸
Dimensions of Wrench Flats when W < V, Y ≥ 17

材质对照表 (Materials)		
型号 Type	材质 Material	表面处理 Surface Treatment
ZFXDA	S45C	发黑Black Oxide
ZPFXDA	S45C	镀镍Nickel Plating
ZSFXDA	SUS304	/

参数对照表(Specifications)															
型式Part Number						Pg6		M (粗牙螺纹) (Coarse Thread)	V	H	W	d		m	n
Type	Dg6		指定单位1mm 1mm Increment									基准尺寸 Ref. Dim.	容差 Tolerance		
			Y	F	G										
ZFXDA ZPFXDA ZSFXDA	3	-0.002 -0.008	7~30	3~50	3~8	3	-0.002 -0.008	M3	5	7	5	2	+0.06 0	0.5	2
	4	-0.004 -0.012	7~30	3~50	3~8	4	-0.004 -0.012	M4	6	8	6	3	+0.06 0	0.7	2
	5	-0.004 -0.012	7~30	3~50	3~8	5	-0.004 -0.012	M5	7	9	7	4	+0.075 0	0.7	2
	6	-0.004 -0.012	7~60	5~100	5~10	6	-0.004 -0.012	M6	8	10	8	5	+0.075 0	0.7	2
	8	-0.005 -0.014	7~60	5~100	5~10	8	-0.005 -0.014	M8	10	12	10	7	+0.09 0	0.9	3
	10	-0.005 -0.014	7~60	5~100	5~10	10	-0.005 -0.014	M10	13	15	13	9.6	0 -0.09	1.15	3
	12	-0.006 -0.017	7~60	10~100	5~15	12	-0.006 -0.017	M12	15	17	14	11.5	0 -0.11	1.15	4
	15	-0.006 -0.017	7~60	10~100	5~15	12	-0.006 -0.017	M12	18	20	17	14.3	0 -0.11	1.15	4

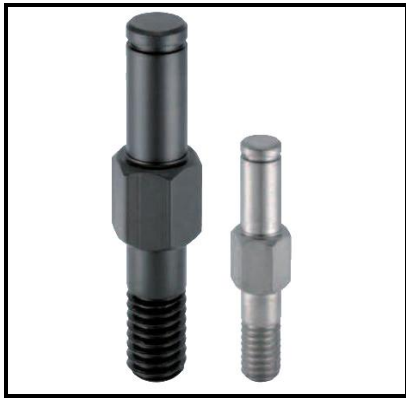

- 嵌入外螺纹安装、带扣环槽六角型悬臂销
- Cantilever Shafts - Pilot, Hex Head, Retaining Ring Groove

型号实例	型式 Type+D-Y-F-G
例如	ZLXCA6-7-F10-G5

Part Number	Type+D-Y-F-G
order	ZLXCA6-7-F10-G5

型号实例	型式 Type+D-Y-F-G-N
例如	ZLXNCA6-7-F10-G5-N6

Part Number	Type+D-Y-F-G-N
order	ZLXNCA6-7-F10-G5-N6

- [!] 有些尺寸可能带中心孔
- [!] Some sizes may have a center hole.
- [!] 仅螺纹长度指定型可指定N。
- [!] N is available for Thread Length Configurable Type only.

螺纹长度固定型 / Thread Length Fixed

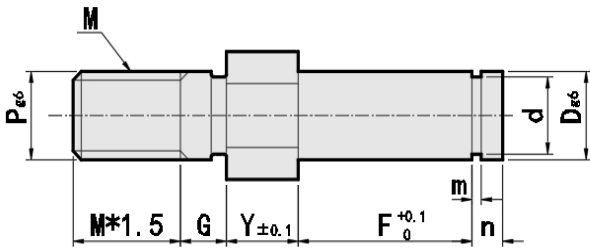

螺纹长度指定型 / Thread Length Configurable

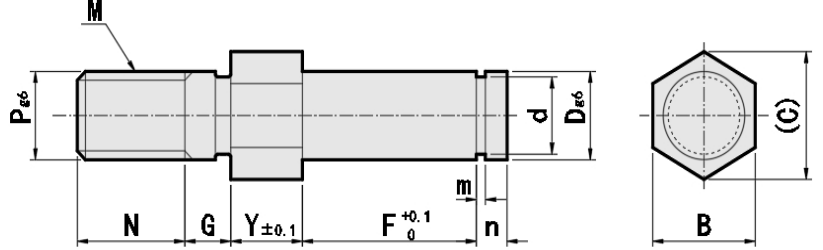

材质对照表 (Materials)			
型号Type		材质Material	表面处理Surface Treatment
螺纹长度固定型Thread Length Fixed	螺纹长度指定型Thread Length Configurable		
ZLXCA	ZLXNCA	S45C	发黑Black Oxide
ZPLXCA	ZPLXNCA	S45C	镀镍Nickel Plating
ZSLXCA	ZSLXNCA	SUS304	/

参数对照表(Specifications)															
型式Part Number															
Type	Dg6		指定单位1mm 1mm Increment				Pg6	M (粗牙螺纹) (Coarse Thread)	B	(C)	d		m	n	
			Y	F	G	N					基准尺寸 Ref. Dim.	容差 Tolerance			
ZLXCA ZPLXCA ZSLXCA	3	-0.002 -0.008	2~30	3~50	3~8	3~6	3	-0.002 -0.008	M3	6	6.9	2	+0.06 0	0.5	2
	4	-0.004 -0.012	2~30	3~50	3~8	4~8	4	-0.004 -0.012	M4	6	6.9	3	+0.06 0	0.7	2
	5	-0.004 -0.012	2~30	3~50	3~8	5~10	5	-0.004 -0.012	M5	7	8.1	4	+0.075 0	0.7	2
ZLXNCA ZPLXNCA ZSLXNCA	6	-0.004 -0.012	2~60	5~100	5~10	6~12	6	-0.004 -0.012	M6	8	9.2	5	+0.075 0	0.7	2
	8	-0.005 -0.014	2~60	5~100	5~10	8~16	8	-0.005 -0.014	M8	10	11.5	7	+0.09 0	0.9	3
	10	-0.005 -0.014	2~60	5~100	5~10	10~20	10	-0.005 -0.014	M10	13	15	9.6	0 -0.09	1.15	3
	12	-0.006 -0.017	2~60	10~100	5~15	12~24	12	-0.006 -0.017	M12	14	16.2	11.5	0 -0.11	1.15	4
	15	-0.006 -0.017	2~60	10~100	5~15	12~24	12	-0.006 -0.017	M12	17	19.6	14.3	0 -0.11	1.15	4



- 嵌入外螺纹安装、内螺纹标准型悬臂销
- Cantilever Shafts - Pilot, Tapped End

型号实例	型式 Type+D-Y-F-G-MA
例如	ZFXCB6-7-F10-G5-MA3

Part Number	Type+D-Y-F-G-MA
order	ZFXCB6-7-F10-G5-MA3

型号实例	型式 Type+D-Y-F-G-N-MA
例如	ZFXNCB6-7-F10-G5-N6-MA3

Part Number	Type+D-Y-F-G-N-MA
order	ZFXNCB6-7-F10-G5-N6-MA3

- [!] 有些尺寸可能带中心孔
- [!] Some sizes may have a center hole.
- [!] 仅螺纹长度指定型可指定N。
- [!] N is available for Thread Length Configurable Type only.

螺纹长度固定型 / Thread Length Fixed

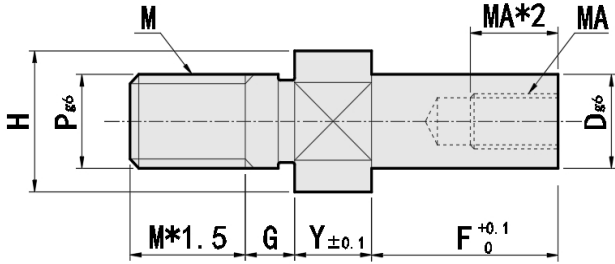

螺纹长度指定型 / Thread Length Configurable

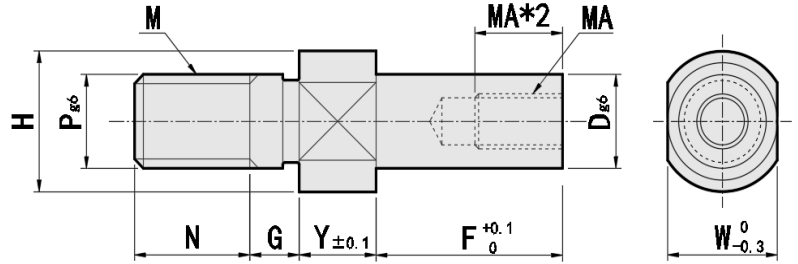

材质对照表 (Materials)			
型号Type		材质Material	表面处理Surface Treatment
螺纹长度固定型 Thread Length Fixed	螺纹长度指定型 Thread Length Configurable		
ZFXCB	ZFXNCB	S45C	发黑Black Oxide
ZPFXCB	ZPFXNCB	S45C	镀镍Nickel Plating
ZSFXCB	ZSFXNCB	SUS304	/

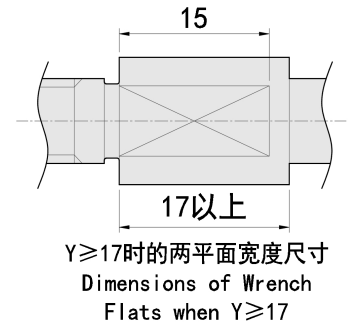

参数对照表(Specifications)												
Type	型式Part Number		指定单位1mm 1mm Increment				MA (粗牙螺纹) (Coarse Thread)	Pg6		M (粗牙螺纹) (Coarse Thread)	H	W
			Y	F	G	N						
	ZFXCB ZPFXCB ZSFXCB	6	-0.004 -0.012	2~60	5~100	5~10	6~12	3	6	-0.004 -0.012	M6	10
ZFXNCB ZPFXNCB ZSFXNCB	8	-0.005 -0.014	2~60	5~100	5~10	8~16	4	8	-0.005 -0.014	M8	12	10
ZFXNCB ZPFXNCB ZSFXNCB	10	-0.005 -0.014	2~60	5~100	5~10	10~20	4 5 6	10	-0.005 -0.014	M10	15	13
ZFXNCB ZPFXNCB ZSFXNCB	12	-0.006 -0.017	2~60	10~120	5~15	12~24	5 6 8	12	-0.006 -0.017	M12	17	14
ZFXNCB ZPFXNCB ZSFXNCB	15	-0.006 -0.017	2~60	10~120	5~15	12~24	6 8 10	12	-0.006 -0.017	M12	20	17

表1/Table 1	
MA	Y+F
M3	Y+F ≥ 11.5
M4	Y+F ≥ 14.0
M5	Y+F ≥ 16.2
M6	Y+F ≥ 18.5
M8	Y+F ≥ 23.5
M10	Y+F ≥ 28.5



- 嵌入外螺纹安装、内螺纹台阶型悬臂销
- Cantilever Shafts - Pilot, Stepped, Tapped End

型号实例	型式 Type+D-Y-F-G-MA
例如	ZFXDB6-7-F10-G5-MA3

Part Number	Type+D-Y-F-G-MA
order	ZFXDB6-7-F10-G5-MA3

- [!] MA及Y/F的尺寸请参阅表1后制定。
- [!] Please refer to Table 1 to specify dimensions Y and F.
- [!] 有些尺寸可能带中心孔
- [!] Some sizes may have a center hole.
- [!] W < V时，两平面宽度W将扩展到直径V的部位。
- [!] When W < V, wrench flats W reaches O.D.V.

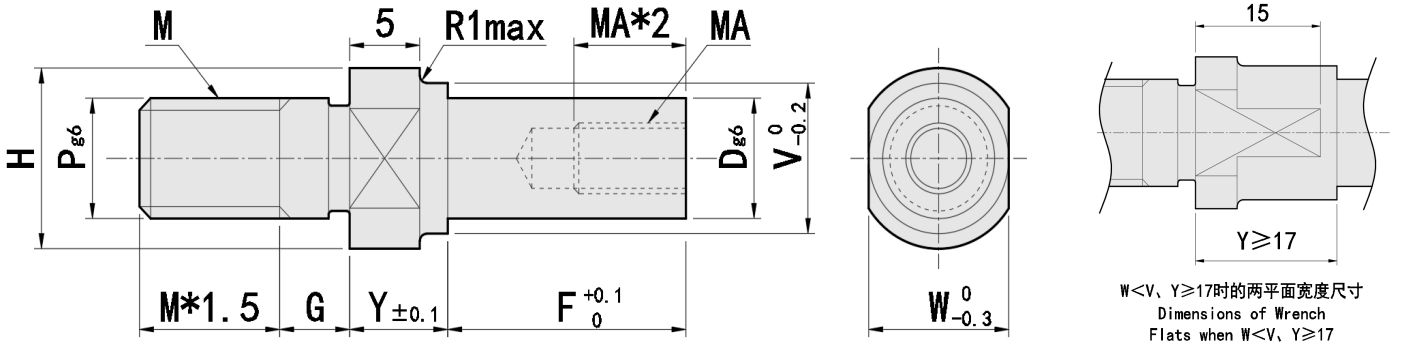

材质对照表 (Materials)		
型号 Type	材质 Material	表面处理 Surface Treatment
ZFXDB	S45C	发黑Black Oxide
ZPFXDB	S45C	镀镍Nickel Plating
ZSFXDB	SUS304	/

参数对照表(Specifications)												
Type	型式Part Number		指定单位1mm 1mm Increment			MA (粗牙螺纹) (Coarse Thread)	Pg6		M (粗牙螺纹) (Coarse Thread)	V	H	W
			Y	F	G							
	ZFXDB ZPFXDB ZSFXDB	6	-0.004 -0.012	7~60	5~100	5~10	3	6	-0.004 -0.012	M6	8	10
8		-0.005 -0.014	7~60	5~100	5~10	4	8	-0.005 -0.014	M8	10	12	10
10		-0.005 -0.014	7~60	5~100	5~10	4 5 6	10	-0.005 -0.014	M10	13	15	13
12		-0.006 -0.017	7~60	10~100	5~15	5 6 8	12	-0.006 -0.017	M12	15	17	14
15		-0.006 -0.017	7~60	10~100	5~15	6 8 10	12	-0.006 -0.017	M12	18	20	17

表1/Table 1	
MA	Y+F
M3	Y+F ≥ 11.5
M4	Y+F ≥ 14.0
M5	Y+F ≥ 16.2
M6	Y+F ≥ 18.5
M8	Y+F ≥ 23.5
M10	Y+F ≥ 28.5



- 嵌入外螺纹安装、内螺纹六角型悬臂销
- Cantilever Shafts - Pilot, Hex Head, Tapped End

型号实例	型式 Type+D-Y-F-G-MA
例如	ZLXCB6-7-F10-G5-MA3

Part Number	Type+D-Y-F-G-MA
order	ZLXCB6-7-F10-G5-MA3

[!] MA及Y/F的尺寸请参阅表1后制定。
 [!] Please refer to Table 1 to specify dimensions Y and F.

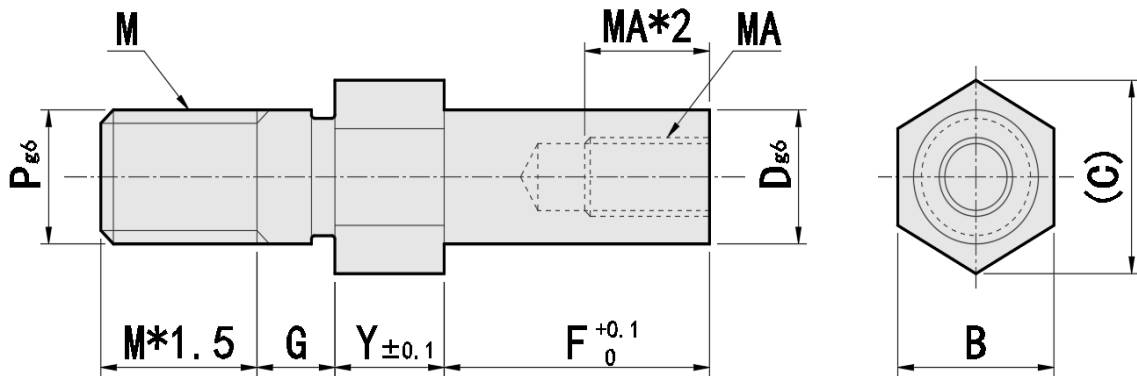

材质对照表 (Materials)		
型号 Type	材质 Material	表面处理 Surface Treatment
ZLXCB	S45C	发黑Clack Oxide
ZPLXCB	S45C	镀镍Nickel Plating
ZSLXCB	SUS304	/

参数对照表(Specifications)													
Type	Dg6		指定单位1mm 1mm Increment			MA (粗牙螺纹) (Coarse Thread)			Pg6		M (粗牙螺纹) (Coarse Thread)	B	(C)
			Y	F	G								
	ZLXCB ZPLXCB ZSLXCB	6	-0.004 -0.012	2~60	5~100	5~10	3			6	-0.004 -0.012	M6	8
8		-0.005 -0.014	2~60	5~100	5~10	4			8	-0.005 -0.014	M8	10	11.5
10		-0.005 -0.014	2~60	5~100	5~10	4	5	6	10	-0.005 -0.014	M10	13	15
12		-0.006 -0.017	2~60	10~100	5~15	5	6	8	12	-0.006 -0.017	M12	14	16.2
15		-0.006 -0.017	2~60	10~100	5~15	6	8	10	12	-0.006 -0.017	M12	17	19.6

表1/Table 1	
MA	Y+F
M3	Y+F≥11.5
M4	Y+F≥14.0
M5	Y+F≥16.2
M6	Y+F≥18.5
M8	Y+F≥23.5
M10	Y+F≥28.5



- 嵌入外螺纹安装、外螺纹标准型悬臂销
- Cantilever Shafts - Pilot, Threaded End

型号实例	型式 Type+D-Y-F-G-MA
例如	ZFXCC6-7-F10-G5-MA4

Part Number	Type+D-Y-F-G-MA
order	ZFXCC6-7-F10-G5-MA4

型号实例	型式 Type+D-Y-F-G-N-MA
例如	ZFXNCC6-7-F10-G5-N6-MA4

Part Number	Type+D-Y-F-G-N-MA
order	ZFXNCC6-7-F10-G5-N6-MA4

- [!] 有些尺寸可能带中心孔
- [!] Some sizes may have a center hole.
- [!] 仅螺纹长度指定型可指定N。
- [!] N is available for Thread Length Configurable Type only.

螺纹长度固定型 / Thread Length Fixed

螺纹长度指定型 / Thread Length Configurable

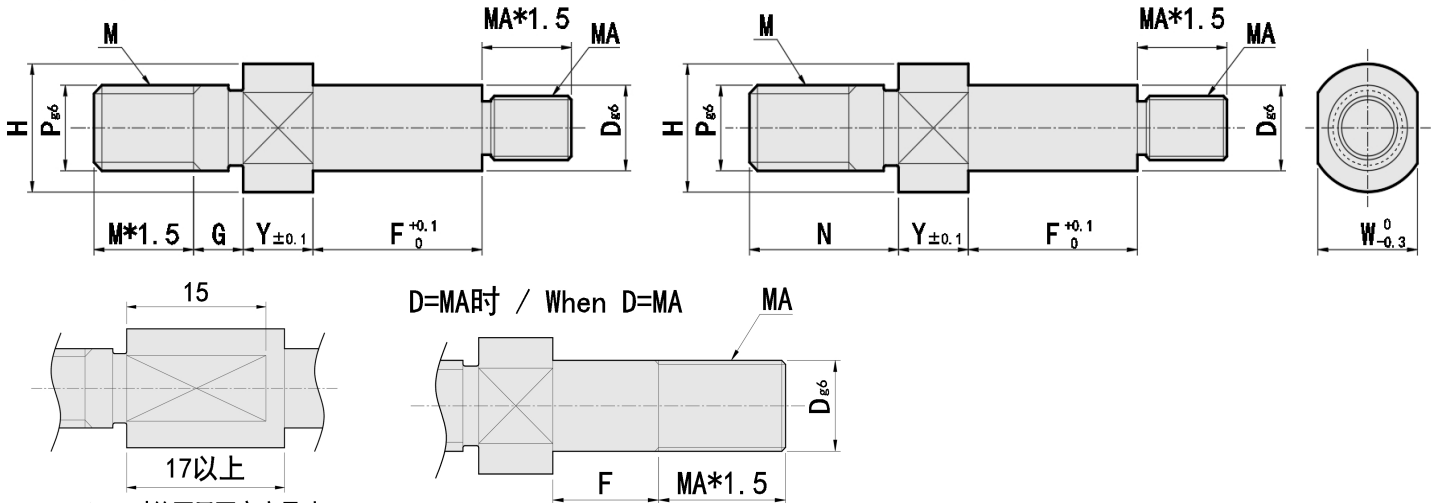

Y≥17时的两平面宽度尺寸
Dimensions of Wrench
Flats when Y≥17

材质对照表 (Materials)			
型号Type		材质 Material	表面处理 Surface Treatment
螺纹长度固定型 Thread Length Fixed	螺纹长度指定型 Thread Length Configurable		
ZFXCC	ZFXNCC	S45C	发黑Black Oxide
ZPFXCC	ZPFXNCC	S45C	镀镍Nickel Plating
ZSFXCC	ZSFXNCC	SUS304	/

参数对照表(Specifications)												
Type	型式Part Number											
	Dg6		指定单位1mm 1mm Increment				MA (粗牙螺纹) (Coarse Thread)	Dg6		M (粗牙螺纹) (Coarse Thread)	H	W
			Y	F	G	N						
ZFXCC ZPFXCC ZSFXCC	3	-0.002 -0.008	2~30	3~50	3~8	3~6	3	3	-0.002 -0.008	M3	7	5
	4	-0.004 -0.012	2~30	3~50	3~8	4~8	3 4	4	-0.004 -0.012	M4	8	6
	5	-0.004 -0.012	2~30	3~50	3~8	5~10	3 4 5	5	-0.004 -0.012	M5	9	7
ZFXNCC ZPFXNCC ZSFXNCC	6	-0.004 -0.012	2~60	5~100	5~10	6~12	4 5 6	6	-0.004 -0.012	M6	10	8
	8	-0.005 -0.014	2~60	5~100	5~10	8~16	5 6 8	8	-0.005 -0.014	M8	12	10
	10	-0.005 -0.014	2~60	5~100	5~10	10~20	6 8 10	10	-0.005 -0.014	M10	15	13
	12	-0.006 -0.017	2~60	10~100	5~15	12~24	6 8 10 12	12	-0.006 -0.017	M12	17	14
	15	-0.006 -0.017	2~60	10~100	5~15	12~24	8 10 12	12	-0.006 -0.017	M12	20	17



- 嵌入外螺纹安装、外螺纹台阶型悬臂销
- Cantilever Shafts - Pilot, Stepped, Threaded End

型号实例	型式 Type+D-Y-F-G-MA
例如	ZFXDC6-7-F10-G5-MA4

Part Number	Type+D-Y-F-G-MA
order	ZFXDC6-7-F10-G5-MA4

- [!] 有些尺寸可能带中心孔
- [!] Some sizes may have a center hole.
- [!] W < V时, 两平面宽度W将扩展到直径V的部位。
- [!] When W < V, wrench flats W reaches O.D.V.
- [!] Y+F ≤ 100

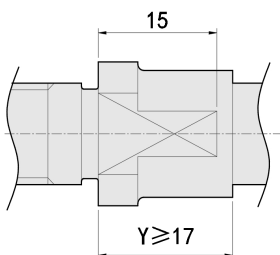
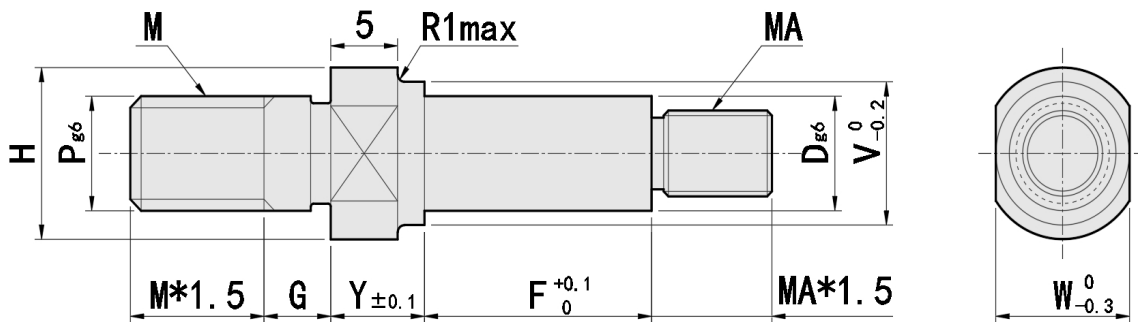

W < V, Y ≥ 17时的两平面宽度尺寸
Dimensions of Wrench Flats when W < V, Y ≥ 17

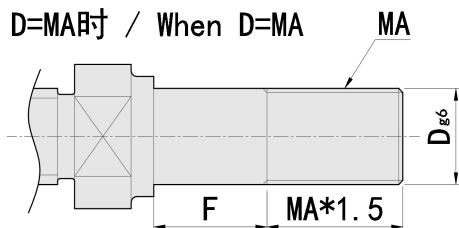

材质对照表 (Materials)		
型号 Type	材质 Material	表面处理 Surface Treatment
ZFXDC	S45C	发黑Black Oxide
ZPFXDC	S45C	镀镍Nickel Plating
ZSFXDC	SUS304	/

参数对照表 (Specifications)												
Type	型式 Part Number						Dg6	M (粗牙螺纹) (Coarse Thread)	V	H	W	
	指定单位1mm 1mm Increment			MA (粗牙螺纹) (Coarse Thread)								
	Y	F	G	Y	F	G						
ZFXDC ZPFXDC ZSFXDC	3	-0.002 -0.008	7~30	3~50	3~8	3	3	-0.002 -0.008	M3	5	7	5
	4	-0.004 -0.012	7~30	3~50	3~8	3 4	4	-0.004 -0.012	M4	6	8	6
	5	-0.004 -0.012	7~30	3~50	3~8	3 4 5	5	-0.004 -0.012	M5	7	9	7
	6	-0.004 -0.012	7~60	5~75	5~10	4 5 6	6	-0.004 -0.012	M6	8	10	8
	8	-0.005 -0.014	7~60	5~75	5~10	5 6 8	8	-0.005 -0.014	M8	10	12	10
	10	-0.005 -0.014	7~60	5~75	5~10	6 8 10	10	-0.005 -0.014	M10	13	15	13
	12	-0.006 -0.017	7~60	10~75	5~15	6 8 10 12	12	-0.006 -0.017	M12	15	17	14
15	-0.006 -0.017	7~60	10~75	5~15	8 10 12	12	-0.006 -0.017	M12	18	20	17	



- 嵌入外螺纹安装、外螺纹六角型悬臂销
- Cantilever Shafts - Pilot, Hex Head, Threaded End

型号实例	型式 Type+D-Y-F-G-MA
例如	ZLXCC6-7-F10-G5-MA4

Part Number	Type+D-Y-F-G-MA
order	ZLXCC6-7-F10-G5-MA4

[!] 有些尺寸可能带中心孔
 [!] Some sizes may have a center hole.

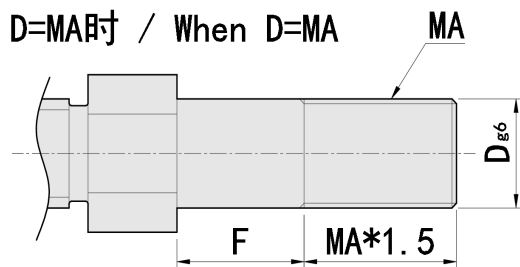
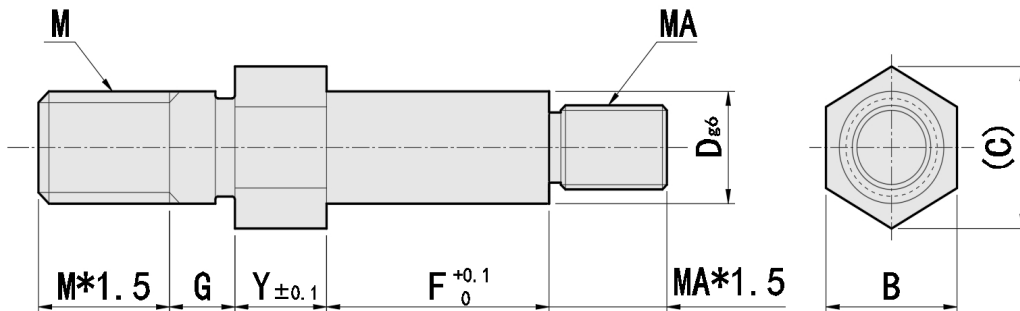

材质对照表 (Materials)		
型号 Type	材质 Material	表面处理 Surface Treatment
ZLXCC	S45C	发黑Black Oxide
ZPLXCC	S45C	镀镍Nickel Plating
ZSLXCC	SUS304	/

参数对照表 (Specifications)																
Type	型式 Part Number									Dg6	M (粗牙螺纹) (Coarse Thread)	B	(C)			
	指定单位1mm 1mm Increment			MA (粗牙螺纹) (Coarse Thread)												
	Y	F	G													
ZLXCC ZPLXCC ZSLXCC	3	-0.002 -0.008	2~30	3~50	3~8	3				3	-0.002 -0.008	M3	6	6.9		
	4	-0.004 -0.012	2~30	3~50	3~8	3	4			4	-0.004 -0.012	M4	6	6.9		
	5	-0.004 -0.012	2~30	3~50	3~8	3	4	5			5	-0.004 -0.012	M5	7	8.1	
	6	-0.004 -0.012	2~60	5~75	5~10	4	5	6			6	-0.004 -0.012	M6	8	9.2	
	8	-0.005 -0.014	2~60	5~75	5~10	5	6	8			8	-0.005 -0.014	M8	10	11.5	
	10	-0.005 -0.014	2~60	5~75	5~10	6	8	10			10	-0.005 -0.014	M10	13	15	
	12	-0.006 -0.017	2~60	10~75	5~15	6	8	10	12			12	-0.006 -0.017	M12	14	16.2
	15	-0.006 -0.017	2~60	10~75	5~15	8	10	12			12	-0.006 -0.017	M12	17	19.6	



- 螺栓座扣环标准型悬臂销
- Cantilever Shafts - Bolt Mounted, Retaining Ring Groove

型号实例	型式 Type+D-Y-F
例如	ZFXHA6-7-F10

Part Number	Type+D-Y-F
order	ZFXHA6-7-F10

[!] 有些尺寸可能带中心孔
 [!] Some sizes may have a center hole.

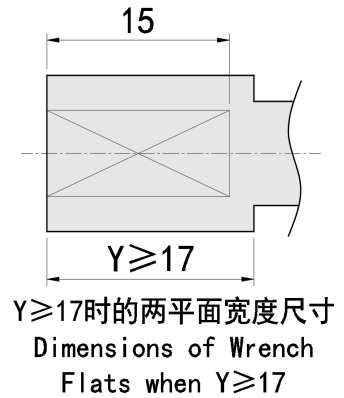
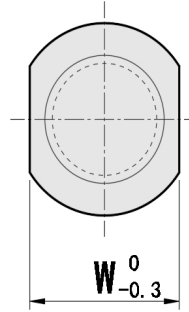
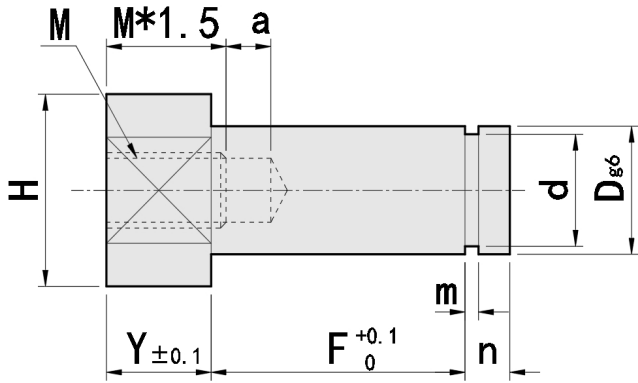

材质对照表 (Materials)		
型号 Type	材质 Material	表面处理 Surface Treatment
ZFXHA	S45C	发黑Black Oxide
ZPFXHA	S45C	镀镍Nickel Plating
ZSFXHA	SUS304	/

参数对照表(Specifications)													
Type	型式Part Number				M (粗牙螺纹) (Coarse Thread)	H	W	d		m	n	M	a
	Dg6		指定单位1mm 1mm Increment					基准尺寸 Ref. Dim.	容差 Tolerance				
	Y	F	Y	F									
ZFXHA ZPFXHA ZSFXHA	6	-0.004 -0.012	2~60	5~100	M3	10	8	5	+0.075 0	0.7	2	(Mx1.5)+a≥Y+F时,M的底孔为通孔。 When (Mx1.5)+a≥Y+F, the pilot hole for M goes through. 另外,Mx1.5≥Y+F时,M变为通孔。 When Mx1.5≥Y+F, M also goes through.	
	8	-0.005 -0.014	2~60	5~100	M4	12	10	7	+0.09 0	0.9	3		
	10	-0.005 -0.014	2~60	5~100	M6	15	13	9.6	0 -0.09	1.15	3		
	12	-0.006 -0.017	2~60	10~100	M8	17	14	11.5	0 -0.11	1.15	4		
	15	-0.006 -0.017	2~60	10~100	M10	20	17	14.3	0 -0.11	1.15	4		
	20	-0.007 -0.020	4~60	10~100	M12	26	24	19	0 -0.21	1.35	4		



■ 螺栓座扣环台阶型悬臂销

■ Cantilever Shafts - Bolt Mounted, Stepped, Retaining Ring Groove

型号实例	型式 Type+D-Y-F
例如	ZFXJA6-7-F10

Part Number	Type+D-Y-F
order	ZFXJA6-7-F10

[!] 有些尺寸可能带中心孔

[!] Some sizes may have a center hole.

[!] W < V时, 两平面宽度W将扩展到直径V的部位。

[!] When W < V, wrench flats W reaches O.D.V.

[!] Y + F ≤ 100

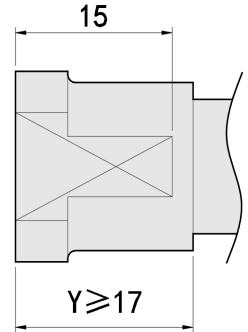
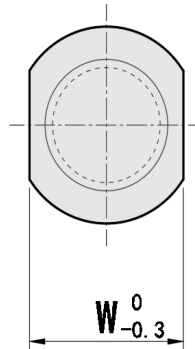
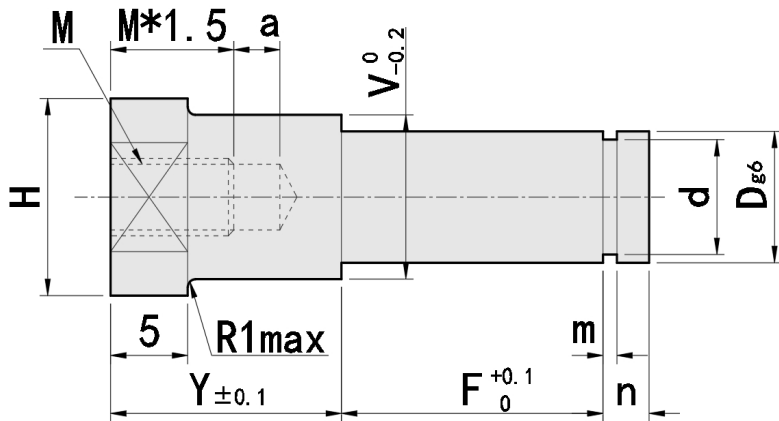

W < V, Y ≥ 17时的两平面宽度尺寸
Dimensions of Wrench Flats when W < V, Y ≥ 17

材质对照表 (Materials)		
型号 Type	材质 Material	表面处理 Surface Treatment
ZFXJA	S45C	发黑Black Oxide
ZPFXJA	S45C	镀镍Nickel Plating
ZSFXJA	SUS304	/

参数对照表 (Specifications)													
Type	型式 Part Number				M (粗牙螺纹) (Coarse Thread)	a	V	H	W	d		m	n
	Dg6		指定单位1mm 1mm Increment							基准尺寸 Ref. Dim.	容差 Tolerance		
	Y	F	Y	F									
ZFXJA ZPFXJA ZSFXJA	6	-0.004 -0.012	7~60	5~100	M3	5	8	10	8	5	+0.075 0	0.7	2
	8	-0.005 -0.014	7~60	5~100	M4	5	10	12	10	7	+0.09 0	0.9	3
	10	-0.005 -0.014	7~60	5~100	M6	5	13	15	13	9.6	0 -0.09	1.15	3
	12	-0.006 -0.017	7~60	10~100	M8	5	15	17	14	11.5	0 -0.11	1.15	4
	15	-0.006 -0.017	7~60	10~100	M10	5	18	20	17	14.3	0 -0.11	1.15	4
	20	-0.007 -0.020	7~60	10~100	M12	7	24	26	24	19	0 -0.21	1.35	4



■ 螺栓座扣环六角型悬臂销

■ Cantilever Shafts - Bolt Mounted, Hex Head, Retaining Ring Groove

型号实例	型式 Type+D-Y-F
例如	ZLXHA6-7-F10

Part Number	Type+D-Y-F
order	ZLXHA6-7-F10

[!] 有些尺寸可能带中心孔

[!] Some sizes may have a center hole.

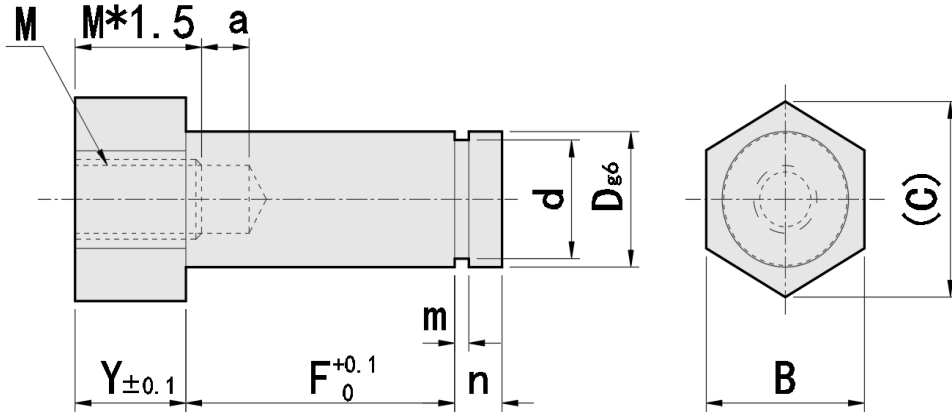

材质对照表 (Materials)		
型号 Type	材质 Material	表面处理 Surface Treatment
ZLXHA	S45C	发黑Black Oxide
ZPLXHA	S45C	镀镍Nickel Plating
ZSLXHA	SUS304	/

参数对照表(Specifications)												
Type	型式Part Number				M (粗牙螺纹) (Coarse Thread)	a	B	(C)	d		m	n
	Dg6		指定单位1mm 1mm Increment						基准尺寸 Ref. Dim.	容差 Tolerance		
	Y	F										
ZLXHA ZPLXHA ZSLXHA	6	-0.004 -0.012	2~60	5~100	M3	10	8	9.2	5	+0.075 0	0.7	2
	8	-0.005 -0.014	2~60	5~100	M4	12	10	11.5	7	+0.09 0	0.9	3
	10	-0.005 -0.014	2~60	5~100	M6	15	13	15.0	9.6	0 -0.09	1.15	3
	12	-0.006 -0.017	2~60	10~100	M8	17	14	16.2	11.5	0 -0.11	1.15	4
	15	-0.006 -0.017	2~60	10~100	M10	20	17	19.6	14.3	0 -0.11	1.15	4
	20	-0.007 -0.020	4~60	10~100	M12	26	24	27.7	19	0 -0.21	1.35	4



- 螺栓安装内螺纹标准型悬臂销
- Cantilever Shafts - Bolt Mounted, Tapped End

型号实例	型式 Type+D-Y-F-MA
例如	ZFXHB6-7-F10-MA3

Part Number	Type+D-Y-F-MA
order	ZFXHB6-7-F10-MA3

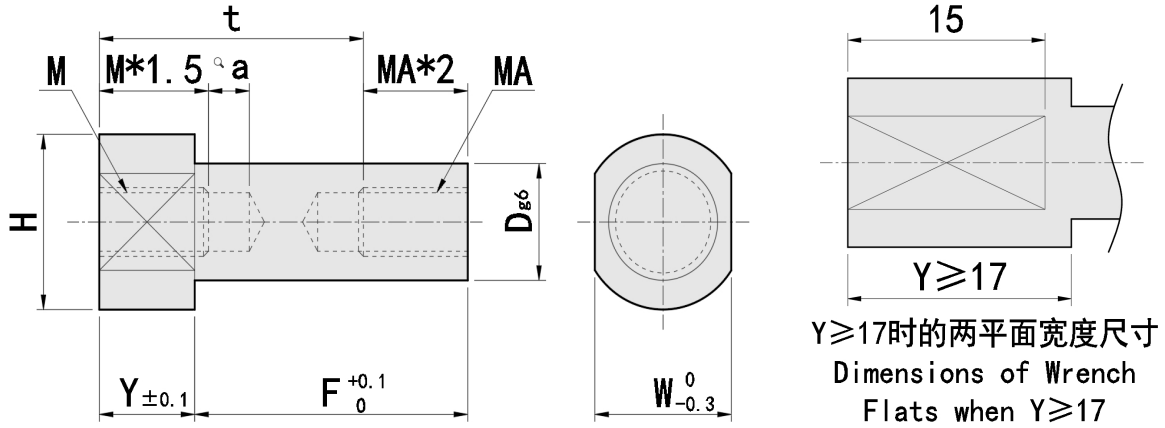

材质对照表 (Materials)			
型号 Type	材质 Material	硬度 Hardness	表面处理 Surface Treatment
ZFXHB	S45C	/	发黑Black Oxide
ZPFXHB	S45C	/	镀镍Nickel Plating
ZSDXHB	SUS304	/	/
ZPHFXHB	SCM435	35~40HRC	镀镍Nickel Plating

参数对照表(Specifications)											
Type	型式Part Number			M (粗牙螺纹) (Coarse Thread)	H	W	D	M	t		
	Dg6	指定单位1mm 1mm Increment									MA (粗牙螺纹) (Coarse Thread)
		Y	F								
ZFXHB ZPFXHB ZSFXHB ZPHFXHB	6	-0.004 -0.012	2~60	5~100	3	M3	10	8			
	8	-0.005 -0.014	2~60	5~100	4	M4	12	10			
	10	-0.005 -0.014	2~60	5~100	4 5 6	M6	15	13			
	12	-0.006 -0.017	2~60	10~100	5 6 8	M8	17	14			
	15	-0.006 -0.017	2~60	10~100	6 8 10	M10	20	17			
	20	-0.007 -0.020	4~60	10~100	6 8 10 12	M12	26	24			

选择Y、F时，应确保图中的t尺寸不小于上表所示的值。另外，底孔互相干涉时，则为通孔。
Specify dimensions Y and F not to make the dimension "t" less than the values in the table above.
When the pilot hole interferes, it goes through.



- 悬臂销螺栓安装.内纹螺台型
- Low Head Shoulder Bolts - SelectaCle Step Length

型号实例	型式 Type+D-Y-F-MA
例如	ZFXJB6-7-F10-MA3

Part Number	Type+D-Y-F-MA
order	ZFXJB6-7-F10-MA3

[!] W < V时, 两平面宽度W将扩展到直径V的部位。
 [!] When W < V, wrench flats W reaches O.D.V.

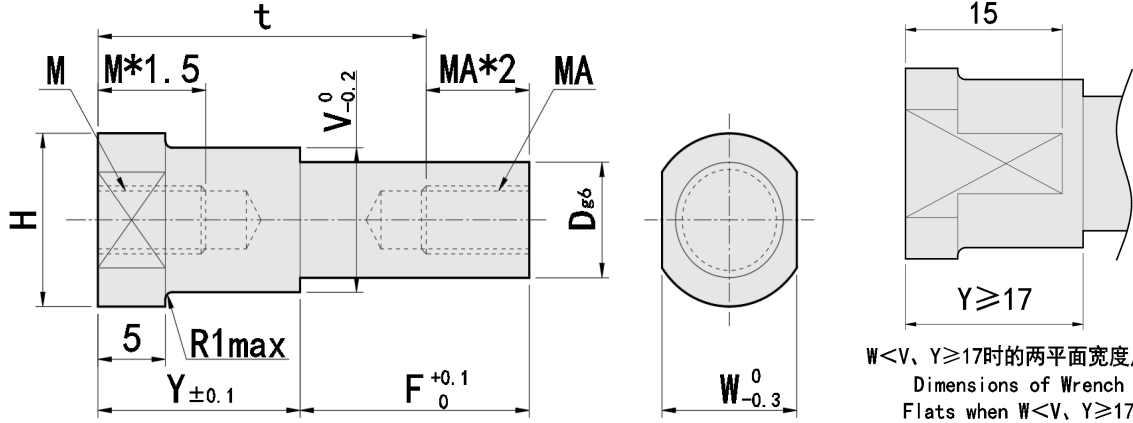

W < V、Y ≥ 17时的两平面宽度尺寸
 Dimensions of Wrench Flats when W < V、Y ≥ 17

材质对照表 (Materials)		
型号 Type	材质 Material	表面处理 Surface Treatment
ZFXJB	S45C	发黑Black Oxide
ZPFXJB	S45C	镀镍Nickel Plating
ZSFXJB	SUS304	/

参数对照表(Specifications)													
Type	型式Part Number		指定单位1mm 1mm Increment		MA (粗牙螺纹) (Coarse Thread)	M (粗牙螺纹) (Coarse Thread)	V	H	W	D	M	t	
	Dg6			Y									F
ZFXJB ZPFXJB ZSFXJB	6	-0.004 -0.012	7~60	5~100	3	M3	8	10	8	6	M3	11	
	8	-0.005 -0.014	7~60	5~100	4	M4	10	12	10	8	M4	12.5	
	10	-0.005 -0.014	7~60	5~100	4 5 6	M6	13	15	13	10	M6	14	
	12	-0.006 -0.017	7~60	10~100	5 6 8	M8	15	17	14	12	M8	17	
	15	-0.006 -0.017	7~60	10~100	6 8 10	M10	18	20	17	15	M10	20	
	20	-0.007 -0.020	7~60	10~100	6 8 10 12	M12	24	26	24	20	M12	25	

选择Y、F时, 应确保图中的t尺寸不小于上表所示的值。另外, 底孔互相干涉时, 则为通孔。
 Specify dimensions Y and F not to make the dimension "t" less than the values in the table above.
 When the pilot hole interferes, it goes through.



- 螺栓安装内螺纹六角型悬臂销
- Cantilever Shafts - Bolt Mounted, Hex Head, Tapped End

型号实例	型式 Type+D-Y-F-MA
例如	ZLXHB6-7-F10-MA3

Part Number	Type+D-Y-F-MA
order	ZLXHB6-7-F10-MA3

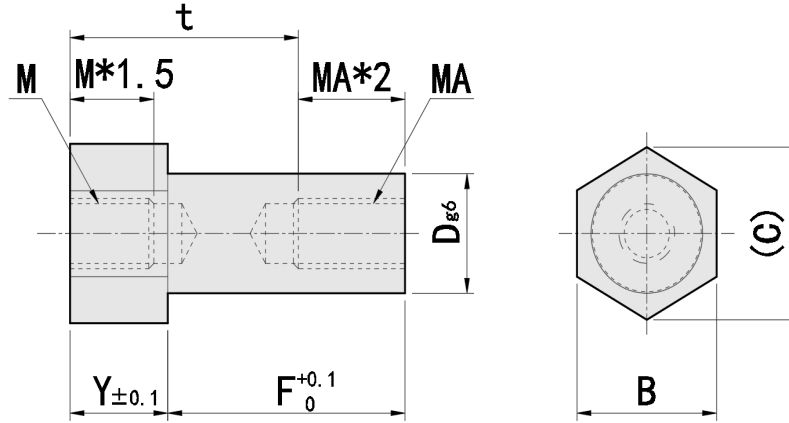

材质对照表 (Materials)		
型号 Type	材质 Material	表面处理 Surface Treatment
ZLXHB	S45C	发黑Clack Oxide
ZPLXHB	S45C	镀镍Nickel Plating
ZSLXHB	SUS304	/

参数对照表(Specifications)														
Type		Dg6		指定单位1mm 1mm Increment		MA (粗牙螺纹) (Coarse Thread)			M (粗牙螺纹) (Coarse Thread)	B	(C)	D	M	t
				Y	F									
ZLXHB ZPLXHB ZSLXHB	6	-0.004 -0.012	2~60	5~100	3				M3	8	9.2	6	M3	11
	8	-0.005 -0.014	2~60	5~100	4				M4	10	11.5	8	M4	12.5
	10	-0.005 -0.014	2~60	5~100	4	5	6	M6	13	15	10	M6	14	
	12	-0.006 -0.017	2~60	10~100	5	6	8	M8	14	16.2	12	M8	17	
	15	-0.006 -0.017	2~60	10~100	6	8	10	M10	17	19.6	15	M10	20	
	20	-0.007 -0.020	4~60	10~100	6	8	10	12	M12	24	27.7	20	M12	25

选择Y、F时，应确保图中的t尺寸不小于上表所示的值。另外，底孔互相干涉时，则为通孔。
Specify dimensions Y and F not to make the dimension "t" less than the values in the table above.
When the pilot hole interferes, it goes through.



■螺栓安装外螺纹准型悬臂销

■Cantilever Shafts - Bolt Mounted, Threaded End

型号实例	型式 Type+D-Y-F-MA
例如	ZFXHC6-7-F10-MA4

Part Number	Type+D-Y-F-MA
order	ZFXHC6-7-F10-MA4

[!] 有些尺寸可能带中心孔

[!] Some sizes may have a center hole.

[!] Y/F的尺寸请参阅表1后指定。

[!] Please refer to Table 1 to specify dimensions Y and F.

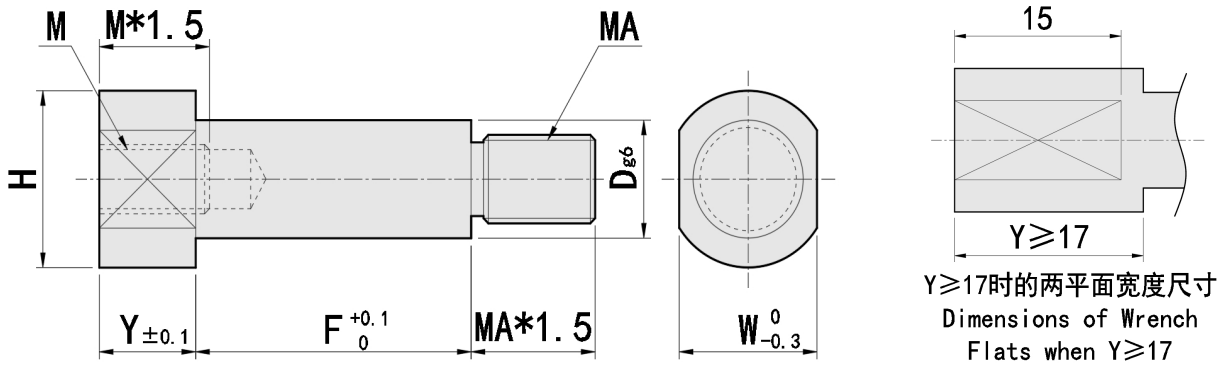

D=MA时 / When D=MA MA

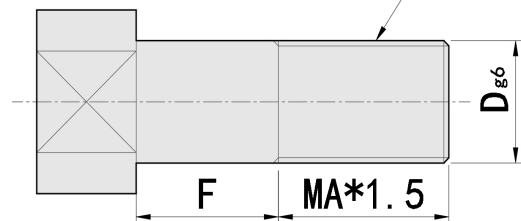

材质对照表 (Materials)		
型号 Type	材质 Material	表面处理 Surface Treatment
ZFXHC	S45C	发黑Clack Oxide
ZPFXHC	S45C	镀镍Nickel Plating
ZSFXHC	SUS304	/

参数对照表(Specifications)										
Type	Dg6		指定单位1mm 1mm Increment		MA (粗牙螺纹) (Coarse Thread)			M (粗牙螺纹) (Coarse Thread)	H	W
			Y	F						
	ZFXHC ZPFXHC ZSFXHC	6	-0.004 -0.012	2~60	5~100	4	5			
	8	-0.005 -0.014	2~60	5~100	5	6	8	M4	12	10
	10	-0.005 -0.014	2~60	5~100	6	8	10	M6	15	13
	12	-0.006 -0.017	2~60	10~100	6	8	10 12	M8	17	14
	15	-0.006 -0.017	2~60	10~100	8	10	12	M10	20	17

表1	
M	Y+F
M3	Y+F≥10
M4	Y+F≥12
M6	Y+F≥15.5
M8	Y+F≥19.5
M10	Y+F≥23.5



■螺栓安装外螺纹台阶型悬臂销

■ Cantilever Shafts - Bolt Mounted, Stepped, Threaded End

型号实例	型式 Type+D-Y-F-MA
例如	ZFXJC6-7-F10-MA4

Part Number	Type+D-Y-F-MA
order	ZFXJC6-7-F10-MA4

[!] 有些尺寸可能带中心孔

[!] Some sizes may have a center hole.

[!] Y/F的尺寸请参阅表1后指定。

[!] Please refer to Table 1 to specify dimensions Y and F.

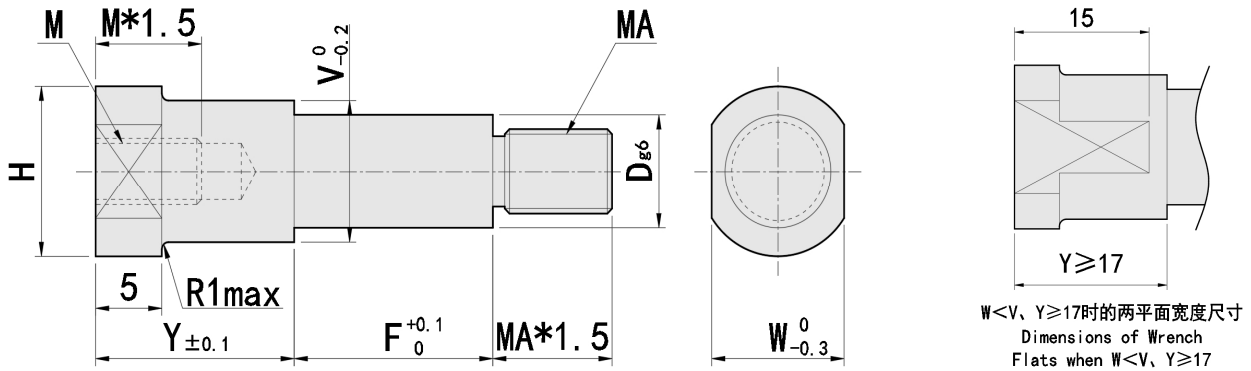

D=MA时 / When D=MA MA

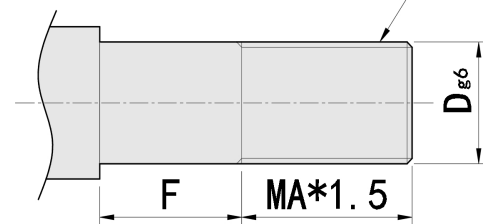

材质对照表 (Materials)		
型号 Type	材质 Material	表面处理 Surface Treatment
ZFXJC	S45C	发黑Black Oxide
ZPFXJC	S45C	镀镍Nickel Plating
ZSFXJC	SUS304	/

参数对照表(Specifications)											
Type	D _{g6}		指定单位1mm 1mm Increment		MA (粗牙螺纹) (Coarse Thread)			M (粗牙螺纹) (Coarse Thread)	V	H	W
			Y	F							
	6	-0.004 -0.012	7~60	5~75	4	5	6				
ZFXJC ZPFXJC ZSFXJC	8	-0.005 -0.014	7~60	5~75	5	6	8	M3	8	10	8
	10	-0.005 -0.014	7~60	5~75	6	8	10	M4	10	12	10
	12	-0.006 -0.017	7~60	10~75	6	8	10 12	M6	13	15	13
	15	-0.006 -0.017	7~60	10~75	6	8	10 12	M8	15	17	14
					8	10	12	M10	18	20	17

表1	
M	Y+F
M3	Y+F≥10
M4	Y+F≥12
M6	Y+F≥15.5
M8	Y+F≥19.5
M10	Y+F≥23.5



■螺栓安装外螺纹六角型悬臂销

■Cantilever Shafts - Bolt Mounted, Hex Head, Threaded End

型号实例	型式 Type+D-Y-F-MA
例如	ZLXHC6-7-F10-MA4

Part Number	Type+D-Y-F-MA
order	ZLXHC6-7-F10-MA4

[!]有些尺寸可能带中心孔

[!]Some sizes may have a center hole.

[!]Y/F的尺寸请参阅表1后指定。

[!]Please refer to Table 1 to specify dimensions Y and F.

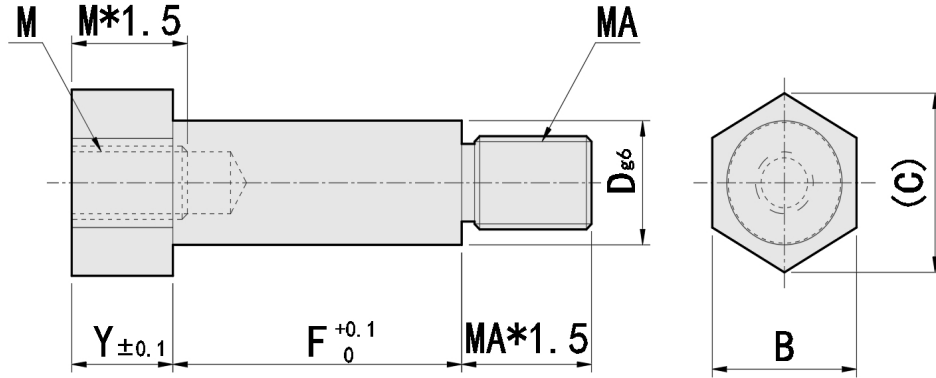

型号 Type	材质 Material	表面处理 Surface Treatment
ZLXHC	S45C	发黑Black Oxide
ZPLXHC	S45C	镀镍Nickel Plating
ZSLXHC	SUS304	/

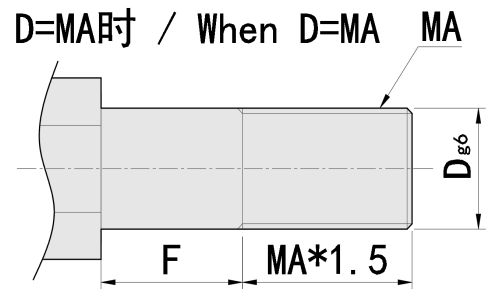

Type	型式Part Number		指定单位1mm 1mm Increment		MA (粗牙螺纹) (Coarse Thread)			M (粗牙螺纹) (Coarse Thread)	B	(C)
	Dg6		Y	F	4	5	6			
ZLXHC ZPLXHC ZSLXHC	6	-0.004 -0.012	2~60	5~100	4	5	6	M3	8	9.2
	8	-0.005 -0.014	2~60	5~100	5	6	8	M4	10	11.5
	10	-0.005 -0.014	2~60	5~100	6	8	10	M6	13	15.0
	12	-0.006 -0.017	2~60	10~100	6	8	10 12	M8	14	16.2
	15	-0.006 -0.017	2~60	10~100	8	10	12	M10	17	19.6

M	Y+F
M3	Y+F≥10
M4	Y+F≥12
M6	Y+F≥15.5
M8	Y+F≥19.5
M10	Y+F≥23.5



■重载扣环型悬臂销

■Cantilever Shafts - Heavy Load, Retaining Ring Groove

型号实例	型式 Type+D-Y-F-T
例如	ZFXMA6-7-F10-T3

Part Number	Type+D-Y-F-T
order	ZFXMA6-7-F10-T3

[!]有些尺寸可能带中心孔

[!]Some sizes may have a center hole.

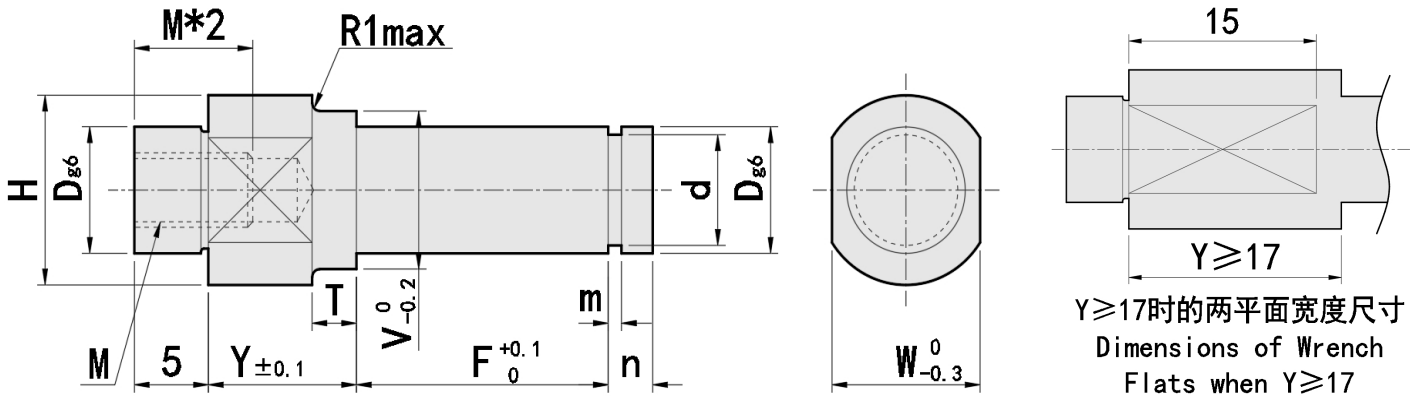

材质对照表 (Materials)		
型号 Type	材质 Material	表面处理 Surface Treatment
ZFXMA	S45C	发黑Black Oxide
ZPFXMA	S45C	镀镍Nickel Plating
ZSFXMA	SUS304	/

螺纹规格 Tap Size	有效长度 Effective Length	底孔深度 Pilot Hole Depth
M3	6	11
M4	8	14
M5	10	17

螺纹规格 Tap Size	有效长度 Effective Length	底孔深度 Pilot Hole Depth
M6	12	20
M8	12	25

参数对照表 (Specifications)													
Type	型式 Part Number				M (粗牙螺纹) (Coarse Thread)	V	H	W	d		m	n	
	Dg6		指定单位1mm 1mm Increment						选择 Selection	基准尺寸 Ref. Dim.			公差 Tolerance
	Y	F	T										
ZFXMA ZPFXMA ZSFXMA	6	-0.004 -0.012	4~60	5~75	1 3 5	M3	8	10	8	5	+0.075 0	0.7	2
	8	-0.005 -0.014	4~60	5~75	1 3 5	M4	10	12	10	7	+0.09 0	0.9	3
	10	-0.005 -0.014	4~60	5~75	2 5 8	M6	13	15	13	9.6	0 -0.09	1.15	3
	12	-0.006 -0.017	4~60	10~100	2 5 8	M8	15	17	14	11.5	0 -0.11	1.15	4
	15	-0.006 -0.017	4~60	10~100	2 5 8	M8	18	20	17	14.3	0 -0.11	1.15	4
	20	-0.007 -0.020	4~60	10~100	2 5 8	M8	24	26	24	19	0 -0.12	1.35	5
	25	-0.007 -0.020	4~75	10~100	2 5 8	M8	29	43	38	23.9	0 -0.12	1.35	5
	30	-0.007 -0.020	4~75	10~100	2 5 8	M8	34	50	44	28.6	0 -0.12	1.65	5



■重载内螺纹型悬臂销

■Cantilever Shafts - Heavy Load, Tapped End

型号实例	型式 Type+D-Y-F-T-MA
例如	ZFXMB6-7-F10-T3-MA3

Part Number	Type+D-Y-F-T-MA
order	ZFXMB6-7-F10-T3-MA3

[!]选择Y/F/T时，请注意避免M、MA互相干涉。

[!]Please select Y, F and T so that M and MA don't interfere with each other.

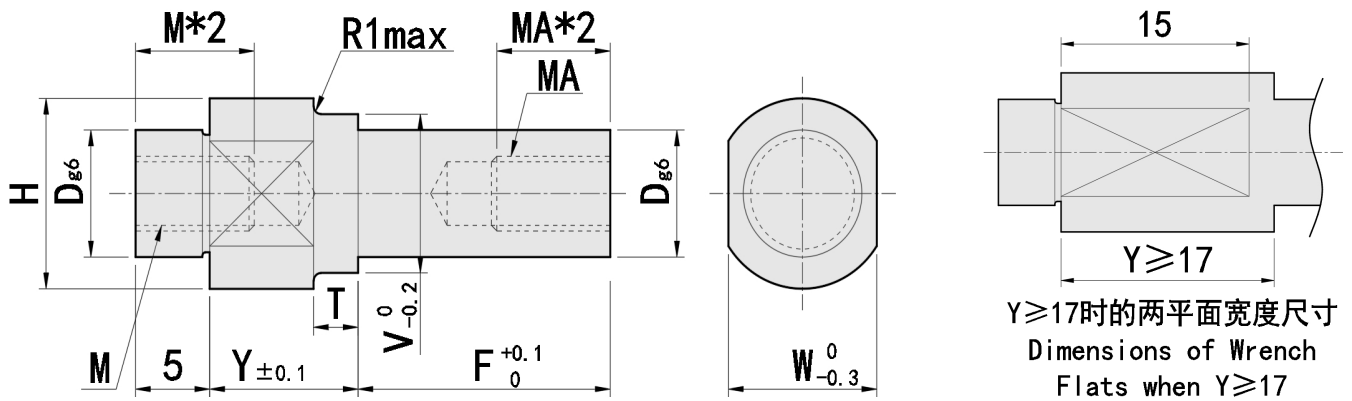

Y ≥ 17时的两平面宽度尺寸
Dimensions of Wrench Flats when Y ≥ 17

材质对照表 (Materials)		
型号 Type	材质 Material	表面处理 Surface Treatment
ZFXMB	S45C	发黑Black Oxide
ZPFXMB	S45C	镀镍Nickel Plating
ZSFXMB	SUS304	/

螺纹规格 Tap Size	有效长度 Effective Length	底孔深度 Pilot Hole Depth
M3	6	11
M4	8	14
M5	10	17
M6	12	20

螺纹规格 Tap Size	有效长度 Effective Length	底孔深度 Pilot Hole Depth
M8	12	25
M10	20	29
M12	24	34
M16	32	44

参数对照表 (Specifications)													
Type	Dg6		型式 Part Number							M (粗牙螺纹) (Coarse Thread)	V	H	W
			指定单位1mm 1mm Increment		选择 Selection			MA (粗牙螺纹) (Coarse Thread)					
	Y	F	T	MA		MA							
ZFXMB ZPFXMB ZSFXMB	6	-0.004 -0.012	4~60	5~75	1	3	5	3	M3	8	14	12	
	8	-0.005 -0.014	4~60	5~75	1	3	5	4	M4	10	17	14	
	10	-0.005 -0.014	4~60	5~75	1	3	5	4 5 6	M6	13	21	18	
	12	-0.006 -0.017	4~60	10~100	2	5	8	5 6 8	M8	15	24	21	
	15	-0.006 -0.017	4~60	10~100	2	5	8	6 8 10	M8	18	28	25	
	20	-0.007 -0.020	4~60	10~100	2	5	8	6 8 10	M8	24	36	32	
	25	-0.007 -0.020	4~60	10~100	2	5	8	8 10 12	M8	29	43	38	
	30	-0.007 -0.020	4~60	10~100	2	5	8	8 10 12 16	M8	34	50	44	



■六角型/张紧用扣环型悬臂销

■Cantilever Shafts - For Tension, Retaining Ring Groove

型号实例	型式 Type+D-Y-F-G
例如	ZFXKA6-5-F5-G5

Part Number	Type+D-Y-F-G
order	ZFXKA6-5-F5-G5

型号实例	型式 Type+D-Y-F-G-N
例如	ZFXNKA6-5-F5-G5-N6

Part Number	Type+D-Y-F-G-N
order	ZFXNKA6-5-F5-G5-N6

[!]有些尺寸可能带中心孔

[!]Some sizes may have a center hole.

标准型 / Standard

台阶型 / Stepped

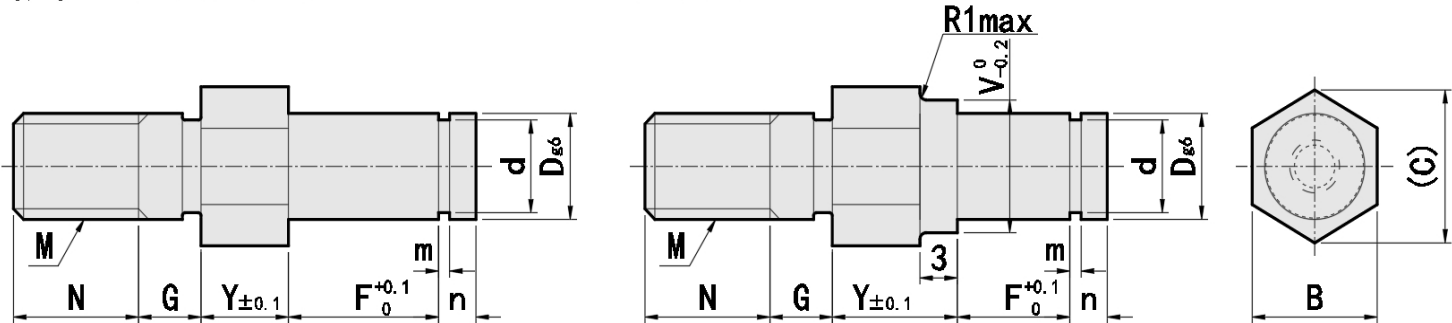

材质对照表 (Materials)					
型号Type				材质Material	表面处理Surface Treatment
标准型Standard		台阶型Stepped			
螺纹长度固定型 Thread Length Fixed	螺纹长度指定型 Thread Length Fixed	螺纹长度固定型 Thread Length Fixed	螺纹长度指定型 Thread Length Fixed		
ZFXKA	ZFXNKA	ZFXLA	ZFXNLA	S45C	发黑Clack Oxide
ZPFXKA	ZPFXNKA	ZPFXLA	ZSPFXNLA	S45C	镀镍Nickel Plating
ZSFXKA	ZSFXNKA	ZSFXLA	ZSFXNLA	SUS304	/

D公差/D Tolerance(g6)	
6	-0.004 -0.012
8~10	-0.005 -0.014
12~18	-0.006 -0.017
20~30	-0.007 -0.020

参数对照表(Specifications)															
Type	D	型式Part Number				P	M (粗牙螺纹) (Coarse Thread)	V (仅台阶型) (Stepped only)	B	(C)	d		m	n	
		指定单位1mm 1mm Increment			N						基准尺寸 Ref. Dim.	容差 Tolerance			
		Y	F	G											
ZFXKA ZPFXKA ZSFXKA	6	5~60	5~100	5~10	9	6	M6	8	10	11.5	5	+0.075 0	0.7	2	
	8	5~60	5~100	5~10	12	8	M8	10	12	13.9	7	+0.09 0	0.9	3	
	10	5~60	5~100	5~10	15	10	M10	13	14	16.2	9.6	0 -0.09	1.15	3	
ZFXNKA ZPFXNKA ZSFXNKA	12	5~60	10~100	5~15	18	12	M12	15	17	19.6	11.5	0 -0.11	1.15	3	
	15	5~60	10~100	5~15	18	12	M12	18	19	21.9	14.3	0 -0.11	1.15	4	
	20	5~60	10~100	5~20	30	20	M20	24	27	31.2	19	0 -0.21	1.35	4	
ZFXNLA ZSPFXNLA ZSFXNLA	25	5~60	10~100	5~20	30	20	M20	29	30	34.6	23.9	0 -0.21	1.35	5	
	30	5~60	10~100	5~20	30	20	M20	34	36	41.6	28.6	0 -0.21	1.65	5	



■张紧用/六角型/螺栓固定型悬臂销

■Cantilever Shafts - For Tension, Tapped End

型号实例	型式 Type+D-Y-F-G-MA
例如	ZFXKB6-5-F7-G5-MA3

Part Number	Type+D-Y-F-G-MA
order	ZFXKB6-5-F7-G5-MA3

型号实例	型式 Type+D-Y-F-G-N-MA
例如	ZFXNKB6-5-F7-G5-N6-MA3

Part Number	Type+D-Y-F-G-N-MA
order	ZFXNKB6-5-F7-G5-N6-MA3

[!]Y/F的尺寸请参阅表1后指定。

[!]Please refer to Table 1 to specify dimensions Y and F.

标准型 / Standard

台阶型 / Stepped

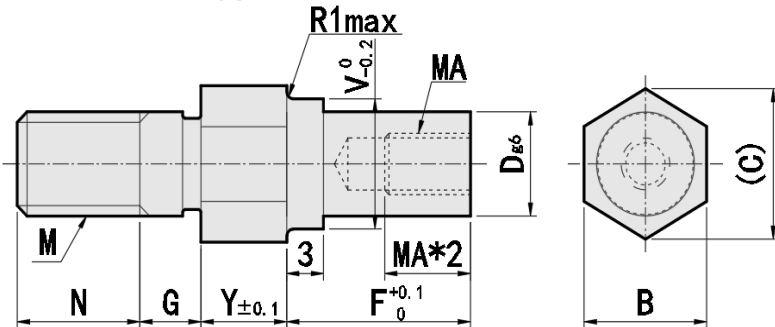
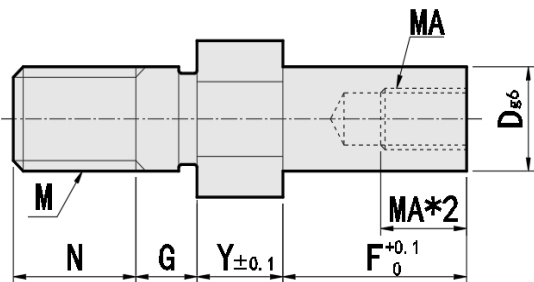

材质对照表 (Materials)					
型号Type				材质Material	表面处理Surface Treatment
标准型Standard		台阶型Stepped			
螺纹长度固定型 Thread Length Fixed	螺纹长度指定型 Thread Length Fixed	螺纹长度固定型 Thread Length Fixed	螺纹长度指定型 Thread Length Fixed		
ZFXKB	ZFXNKB	ZFXLB	ZFXNLB	S45C	发黑Black Oxide
ZPFXKB	ZPFXNKB	ZPFXLB	ZSPFXNLB	S45C	镀镍Nickel Plating
ZSFXKB	ZSFXNKB	ZSFXLB	ZSFXNLB	SUS304	/

D公差/D Tolerance(g6)	
6	-0.004 -0.012
8~10	-0.005 -0.014
12~18	-0.006 -0.017
20~30	-0.007 -0.020

表1/Table 1	
MA	Y+F
M3	Y+F≥11.5
M4	Y+F≥14.0
M5	Y+F≥16.2
M6	Y+F≥18.5
M8	Y+F≥23.5
M10	Y+F≥28.5
M12	Y+F≥35.5
M16	Y+F≥45.0
M20	Y+F≥55.0

参数对照表(Specifications)												
型式Part Number												
Type	D	指定单位1mm 1mm Increment			N		MA (粗牙螺纹) (Coarse Thread)	P	M (粗牙螺纹) (Coarse Thread)	V (仅台阶型) (Stepped only)	B	(C)
		Y	F	G	螺纹长度固定型 Thread Length Fixed	螺纹长度指定型 Thread Length Configurable						
ZFXKB ZPFXKB ZSFXKB	6	5~60	5~100	5~10	9	6~12	3	6	M6	8	10	11.5
	8	5~60	5~100	5~10	12	8~16	4	8	M8	10	12	13.9
	10	5~60	5~100	5~10	15	10~20	4 5 6	10	M10	13	14	16.2
ZFXNKB ZPFXNKB ZSFXNKB	12	5~60	10~100	5~15	18	12~24	5 6 8	12	M12	15	17	19.6
	15	5~60	10~100	5~15	18	12~24	6 8 10	12	M12	18	19	21.9
ZFXNLB ZSPFXNLB ZSFXNLB	20*	5~60	10~100	5~20	30	20~40	6 8 10 12	20	M20	24	27	31.2
	25*	5~60	10~100	5~20	30	20~40	8 10 12 16	20	M20	29	30	34.6
	30*	5~60	10~100	5~20	30	20~40	8 10 12 16 20	20	M20	34	36	41.6