

Outdoor Waterproof Smart Lock Manual

Please read the instruction carefully before use and keep it properly

Directory

Notice.....	02
Instructions for using heat shrink tubing.....	02
Multi language settings.....	02
Installation diagram.....	03
Square steel and tail ruler length processing.....	04
One.Basic function description.....	05
1.Low voltage warning.....	05
2.External power supply.....	05
3.Doorbell or mute function.....	05
4.Human body detection.....	05
5.Demo model.....	05
6.Anti-pry alarm.....	05
Two.Setting Operation.....	06
1.Main menu.....	06
2.Add admin.....	06
3.Add user.....	07
4.Delete user.....	08
5.Remote manage.....	08
6.System setting.....	09
7.System query.....	11
Three.Remote unlock setting.....	12

Notice

To ensure that you are using this product properly, please read this manual carefully before using it for the first time.

Instructions for using heat shrink tubing

To provide better waterproof performance, we offer black heat shrink tubing (included in the accessory package or already placed on the wire). The following is the instructions for use.

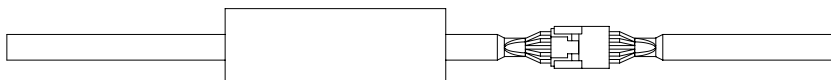

If the heat shrink tubing is not installed, first insert the heat shrink tubing onto one side of the wire, and then connect the plug.

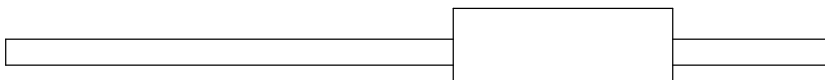

Move the heat shrink tubing to the fully covered plug position, use a lighter or heat gun to heat the tubing and fully tighten the wrapped joint and the wires at both ends of the joint.

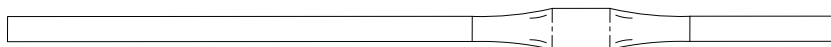

Multi language settings : Wake up the screen, enter "1200#" to set,enter the corresponding code, and press the # key to confirm.

1201 Chinese; 1202 English; 1203 Turkish; 1204 Russian; 1205 Portuguese;
1206 Vietnamese; 1207 Spanish;1208 Indonesian; 1209 French;
1210 Mongolian (display in English); 1211 Arabic(display in English);
1212 Persian (display in English);

Installation diagram

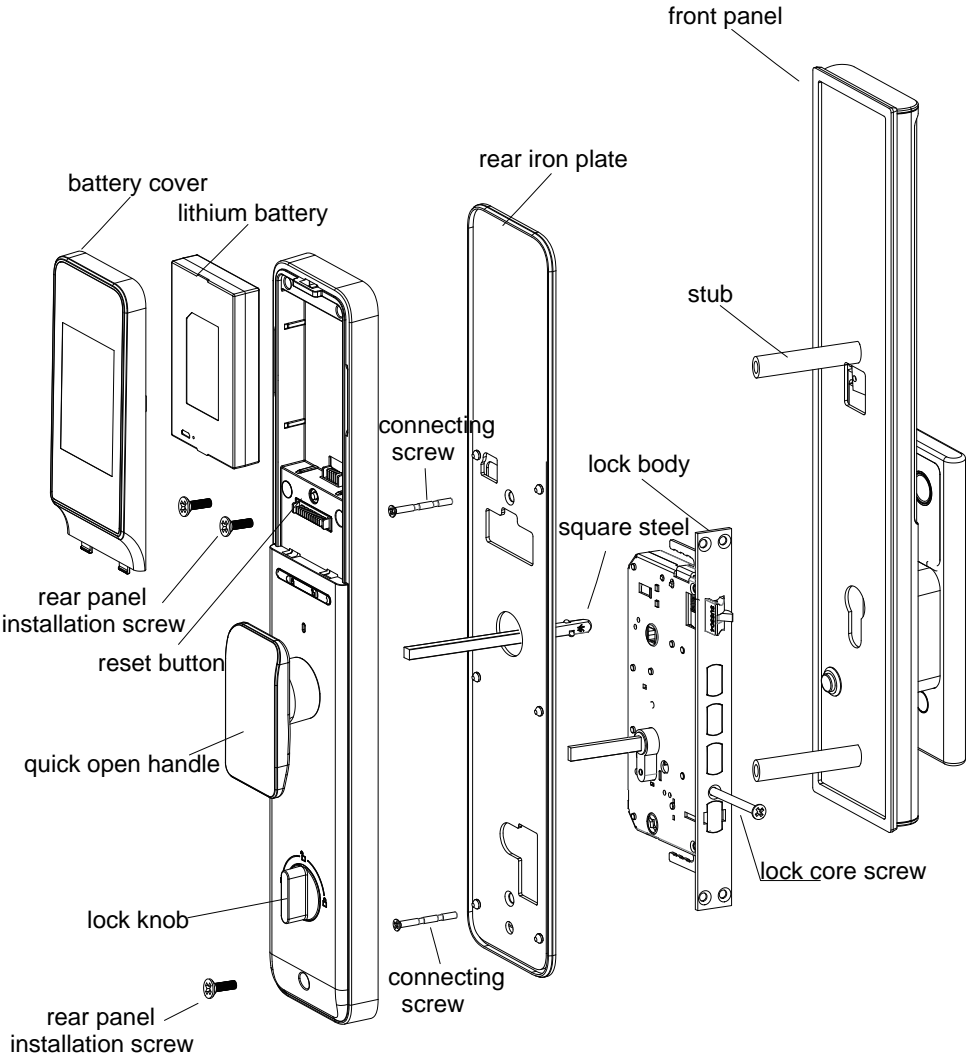

Square steel and tail ruler length processing

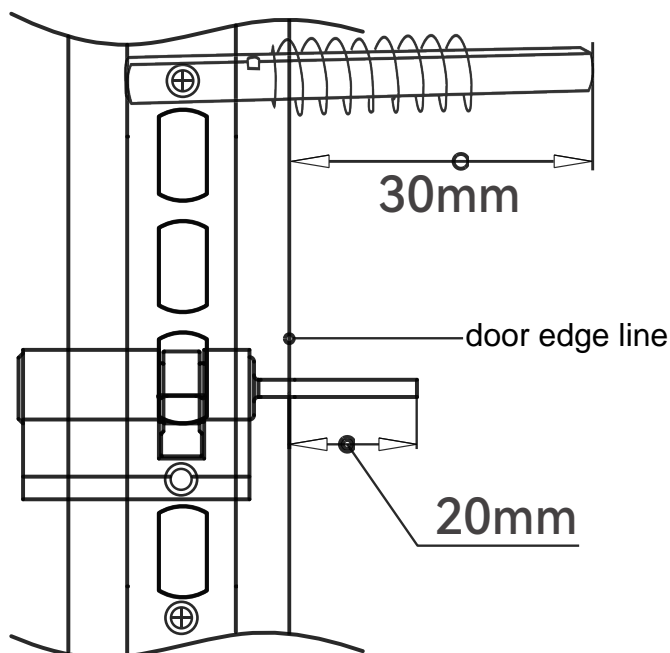

! Attention

Insert the square steel into the lock body from indoors. The limit point should be tightly attached to the lock body, the square steel protrudes 30mm from the door and truncate it.

The tail ruler of the lock cylinder protrudes about 20mm from the door. Mark the appropriate size by trial installation, take out the lock cylinder and cut it short.

One.Basic function description

1.Low voltage warning

When the system detects that the battery voltage is lower than or equal to 7.0V, it will prompt "Low battery" every time the door is opened.Note: After the low voltage alarm, the door lock can still be opened about 100 times (depending on the total battery capacity). Please recharge or replace the battery as soon as possible.

2.External power supply

When the internal battery runs out and the door cannot be opened, use a 5V USB power supply to charge with the emergency charging port.Note: The emergency charging port only provides emergency charging function outside the door, please do not charge for a long time. The battery can be removed and charged with a 5V charger separately.

3.Doorbell or mute function

Press the doorbell button on the touchpad, and the rear panel will sound a doorbell to alert that someone is outside the door.After enabling mute function, the voice will no longer prompt for the lock operation, making it suitable for night operation to avoid affecting family rest.

4.Human body detection

The effective recognition distance for human detection is 0.6-1.0 meters. When someone approaches the effective recognition distance, the door lock will activate and emit a "beep beep" sound, indicating that the machine has detected a human body. The user needs to face the door lock to perform facial recognition. The detection distance may vary depending on height, clothing, or lighting conditions.

5.Demo model

The lock is in demonstration mode when no administrator added.
In demonstration mode, any face in the effective recognition area can unlock it.
In demonstration mode, after the door lock is opened, there is no need to wait for 15 seconds, and the unlocking can be repeatedly verified.

6.Anti-pry alarm

When the anti pry function is on and the anti pry switch is triggered, the voice broadcasts " system locked", the red light flashes, and the alarm continues for about 8 seconds. After 180 seconds, the alarm will be off.

If the lock is in standby mode and the button light goes out, and the alarm time has not expired yet, when the lock is awakened, the alarm will continue.

After verifying the correct user information, the lock can be unlocked normally and the alarm can be cleared. Any other way can not clear the alarm.

Note: In the initialization state of the lock, the anti pry function is off.

Two.Setting Operation

1.Main menu

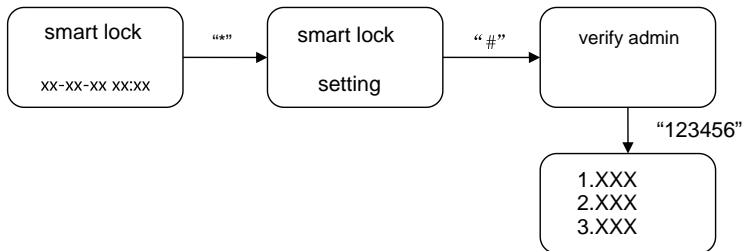

There are two ways to enter the main menu by lighting up the screen and pressing the "*" followed by the "#" key, or by pressing the SET button on the rear panel. To enter the main menu, administrator information verification is required. Users can select the operation by pressing the corresponding number keys according to the menu number.

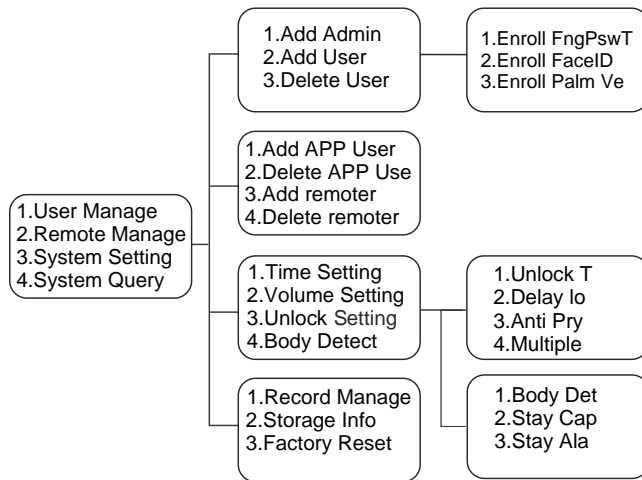

2.Add admin

1. Press 1 after entering user manage menu, select admin information type and input information.
2. Inputting finished after it broadcasts "successful".
3. It has 9 administrator accounts from 001 to 009 with one type of face ID, fingerprint, IC card, password. normal user is from 010 to 200.

3.Add User

Press "*" + "#" to enter verify admin ;

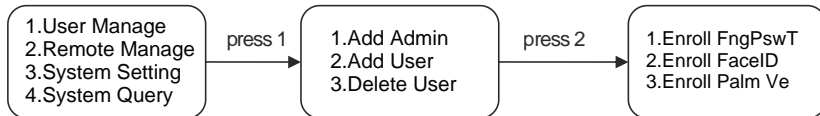

(1)Add Fingerprint/Password/IC card

Place finger on the fingerprint sensor and press again when hearing "beep beep" sound. After four times, inputting will complete when the lock broadcast "successful".

Input 6-8 digitals password, press # to confirm, input the same password again when hearing "beep beep" sound, inputting will complete when the lock broadcast "successful".

Place IC card on the card sensor, inputting will complete when the lock broadcast "successful".

(2)Add Face ID

Press "2" to input face ID, the red light will flash slowly;Face the facial recognition module, rotate head according to the lock prompts, the lock will prompt "successful" after completing;

Note: The distance from the lock is about 0.7-1 meters. Operation will be failed if it is too close or too far; Do not rotate the head too much either;There should be no bystanders when inputting, do not cover your face.

(3)Add Handprint

Press "3" to input handprint, the red light will flash slowly; Put your hand in front of the facial recognition module for about 5 seconds. The lock will prompt "successful" after completing;

Note: The distance from the lock is about 0.15-0.2 meters. Operation will be failed if it is too close or too far.

Note:

- Because of the different system versions, you may need to press # key to confirm user number after selecting the type of adding operation.

4.Delete user

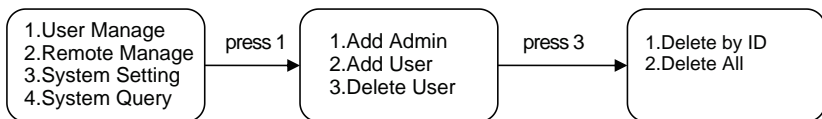

Delete by ID

- ◆ Press 1 and the lock broadcasts "please enter user ID"
- ◆ Enter the user ID need to be deleted, and press # to confirm operation.

Note: he current login administrator can not be deleted.

Delete All

- ◆ Press 3 and # to delete all user information.

Note: The current login administrator will not be deleted.

5.Remote manage

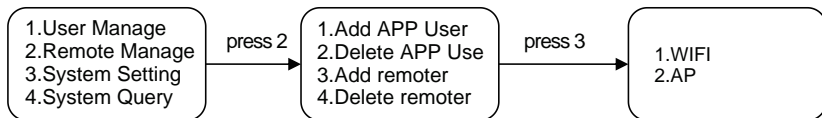

- ◆ Press "2" to enter remote manage menu.

1Add app user 2Delete app user 3add remote 4Delete remote

- ◆ Press "1" to add app user

1 WIFI 2 AP

Press "1" or "2", operate as prompts to add app user.

- ◆ Press "2" to delete all app users
- ◆ Press "3" to add remote control user, press any key on remote control to finish operation.
- ◆ Press "4" to delete all remote control users

Note: Remote controller is optional

6.System setting

6.1 Time setting

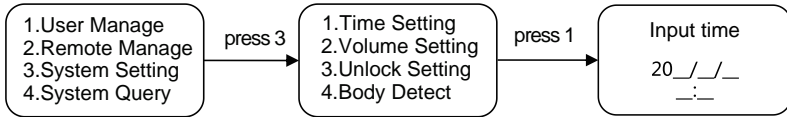

Press 1 to set the time

Input the time with pressing # to confirm

Note: to keep the time format, you need to fill the blank with "0", for example:
8:01 May 1st 2022 input as 2022 05 01 08: 01

6.2 Language & Volume

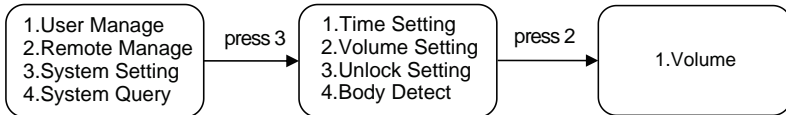

◆ Press 1 to switch Chinese and English

◆ Press 2 to change volume setting to High/Mid/Low/Mute

6.3 Unlock Setting

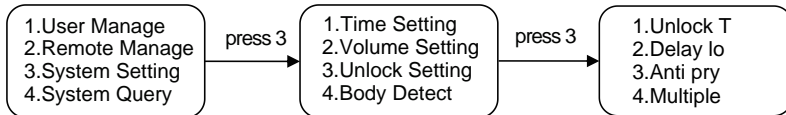

Unlock time:

Press 1 to set lock back time, an effective lock back time is from 2 to 9 seconds.

Delay unlock:

Press 2 to set delay unlock, it can be set to off/5s/10s/15s/20s/25s/30s.

Anti pry:

Press 3 to enable or disable anti pry function.

Multiple verify:

Press 4 to enable or disable multiple verify function.

Note: When multiple verify function enabled, except the administrator accounts, it will need two normal users information to unlock.

6.4 Body detect

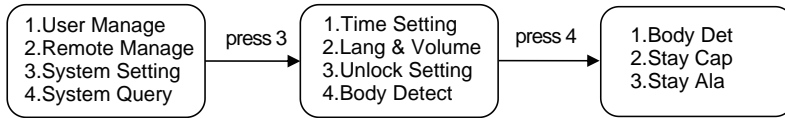

Body Detect

Press '1' to set body detect option, it can be set to off/near/far.

Stay capture

Press '2' to enable or disable stay snap function;

When stay capture function is enabled, after human body is detected, the lock will be awakened, if 3D facial module can not recognize a face, it will wake up the camera and take a snap. This function is disabled by default, because it consumes much power, it will not capture photos when this function is disabled.

Stay alarm

Press '3' to enable or disable stay alarm function;

When stay alarm function is enabled, if the lock verifying failing time accumulates to 3 times, the system will give an alarm prompt. If it accumulates to 5 times, the system will be locked for 90 seconds, and no user can unlock it within 90 seconds. After turning off the stay alarm function, the lock will not alarm.

Note: The human body sensing uses the principle of infrared reflection. Please avoid obstacles to prevent detection errors. If the human body is within the sensing range for a long time, the lock will activate the power-saving mode and turn off the infrared detection function. When a person moves outside the sensing range (0.6-1 meters), the infrared detection function will restart.

7.System query

7.1 Record manage

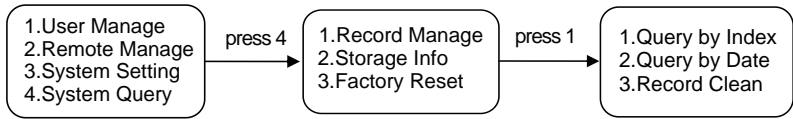

Query by Index:

Press 1 to read unlock records, press 2 to page up, press 8 to page down.

Query by Date:

Press 2 to search unlock records by date, it display like:

Input date

20__-__-__

Record Clean

Press 3 and # to confirm to delete all unlock records

7.2 Storage Info



Admin Info

Display: Fng:000 Face:000 Tag:000 Psw: 000 PAL:000 Total:000 Remain:010

User Info

Display: Fng:000 Face:000 Tag:000 Psw: 000 PAL:000 Total:000 Remain:200

7.3 Factory Reset

Press 3 and # to confirm to recover the lock to factory initial status.

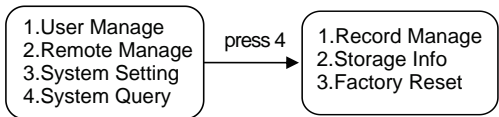

Three.Remote unlock setting

1.Network connection



Scan this qr-code to download the app

You can also search for "TUYA" in the app store to download and install it. during use, the app will request permissions for push messages, Bluetooth, location tracking, etc. Please click agree.

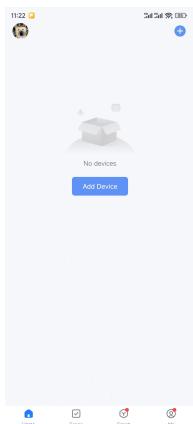

1.After successfully logging in, tap "Add Device" or "+" button in the upper right corner



Reset the device



Power on the device and confirm that the smart door lock works normally.

Confirm the indicator is blinking rapidly.

Reset Device Step by Step

4.After entering this interface, operate on the smart lock by verifying the administrator, selecting "Remote Manage", "Add Phone User", and choosing "1. WIFI"

After confirming that the light below the smart lock keyboard is flashing, click "Confirm the indicator is blinking rapidly" on your phone.

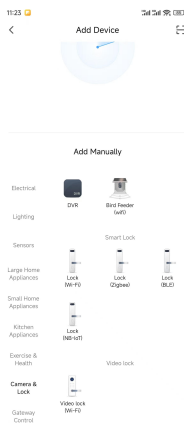

2. Scroll down to find "Camera&Lock" and select "Lock (Wi-Fi)"



Select the status of the indicator light or hear the beep.

AP Mode

EZ Mode

5. Select "EZ Mode"

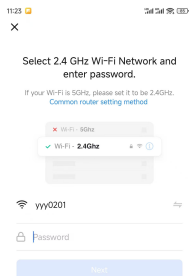

3. Select WiFi and enter the password, click next



Connecting Device
Keep the network stable.



01:57



6. Wait for connection

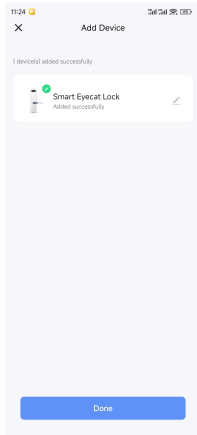

7. Connection completed, click "Done"

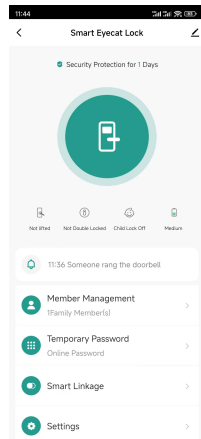

8. Remote management page

2. Temporary Password

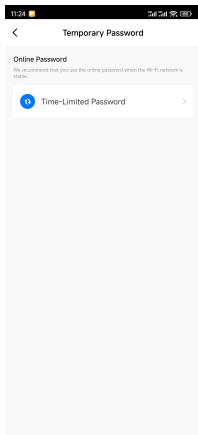

1. Tap "Temporary Password" and "Time-Limited Password" on the remote management interface

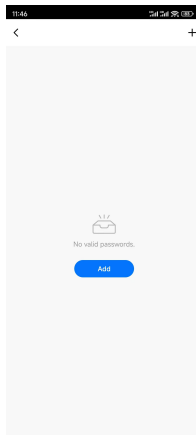

2. Tap the "Add" or "+" button in the upper right corner

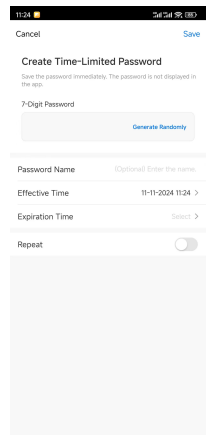

3. Enter or generate a temporary password, select the expiration time, click "Save" (turn on the "Repeat" switch, you can set the temporary password to take effect for a specified period of time on certain days of the week). After setting, you can enter the password on the smart lock to unlock.

3.Remote intercom

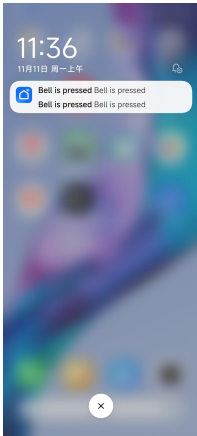

1.After pressing the doorbell button on the smart lock, the phone will receive app push notifications

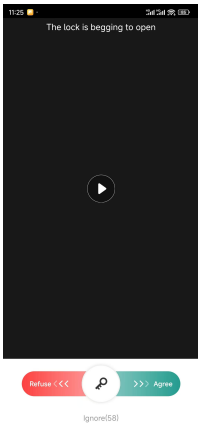

2.Click the play button in the center of the screen to start video intercom, and use the slider at the bottom of the screen to unlock or refuse to unlock.



3.After the video intercom is connected, you can click on the microphone icon in the middle below to start the phone intercom, and click again to stop the phone intercom.