

# Automatic Side-Hung Door Instruction Manual

---

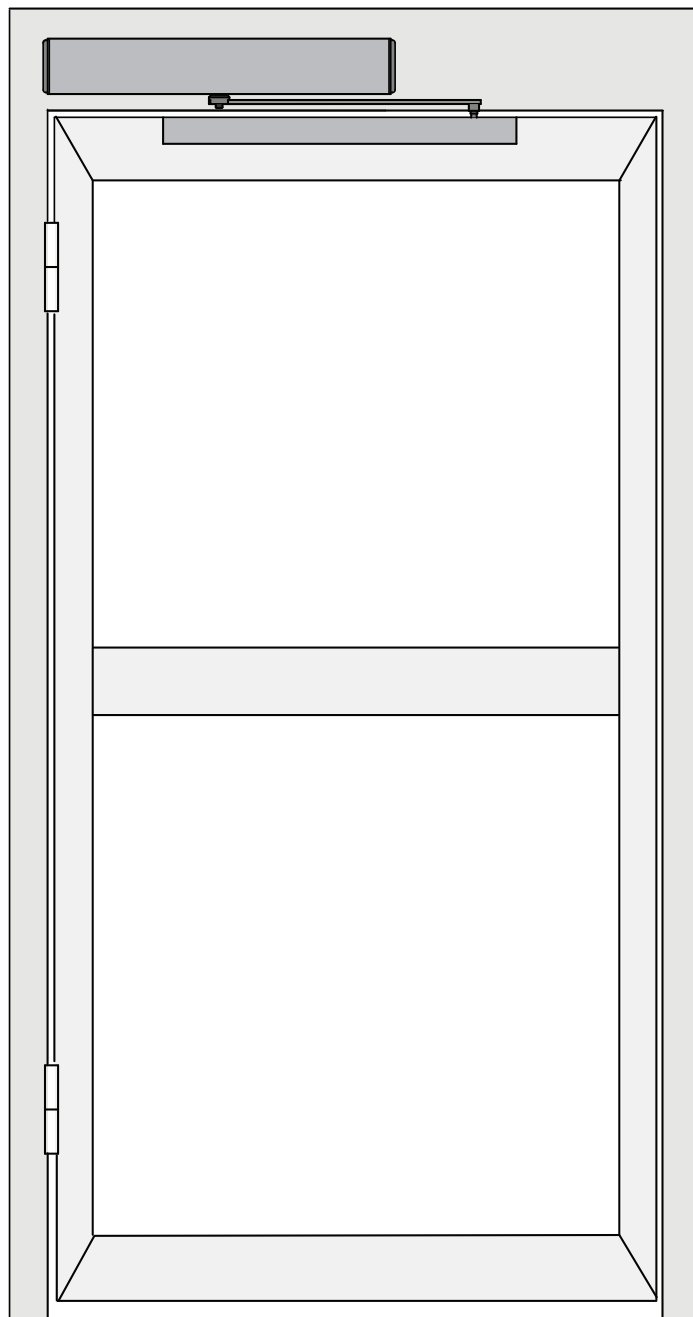

---

**AUTOMATIC ENTRANCE SPECIALISTS**

# Table of contents

1	Technical parameters .....	1
2	Accessories description .....	2
3	Mechanical installation .....	3-9
3.1	Installation example .....	3
3.2	Base plate installation .....	4-5
3.3	Draw arm installation .....	6
3.4	Pushing arm installation .....	7
3.5	Drive system installation .....	8
3.6	Hood installation .....	8
3.7	Connection of drive system and draw arm .....	9
3.8	Connection of drive system and pushing arm .....	9
4	Electrical connection .....	11
5	Parameter adjustment .....	12

# 1 Technical parameters

---

Power supply: 200V~240V

Opening time: 3~7s/90°

Opening time: 1~30s

Temperature: -20°C~+55°C

Protection level: IP12D

Product weight: 6.5 Kg

Product volume: 515×95×90mm

mm= Door width

kg= Door weight



Most suitable range



Limit range

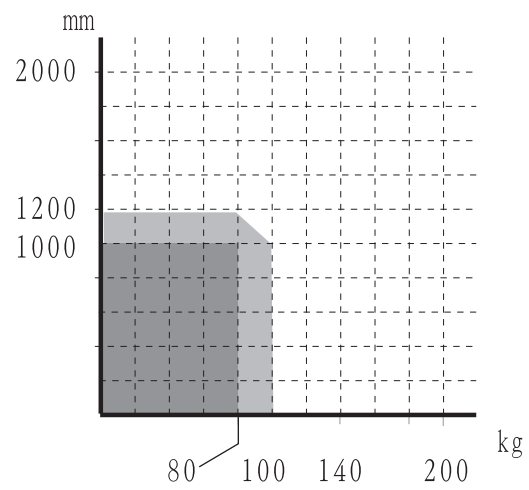

## 2 Accessories description

---

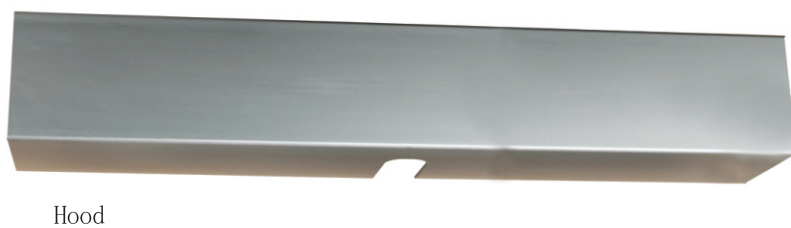
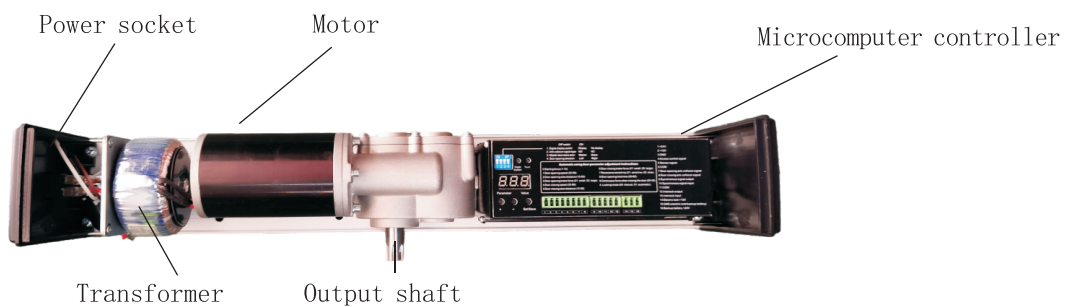



## 3 Mechanical installation

---

### 3.1 Installation example

Draw arm installation: suitable for door wings opening inward (the drive system is inside)

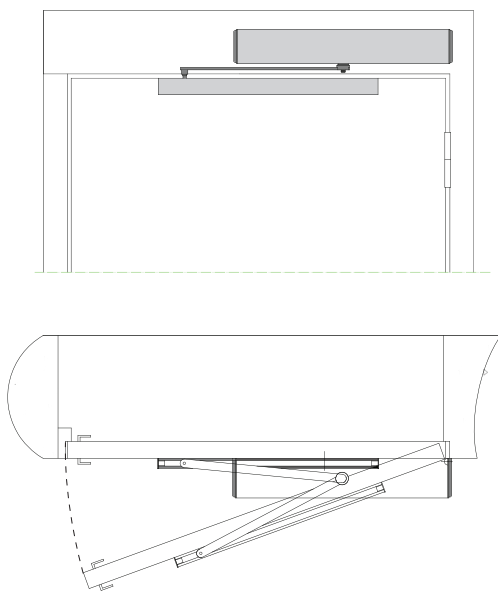

Pushing arm installation: suitable for door wings opening outwards (the drive system is inside)

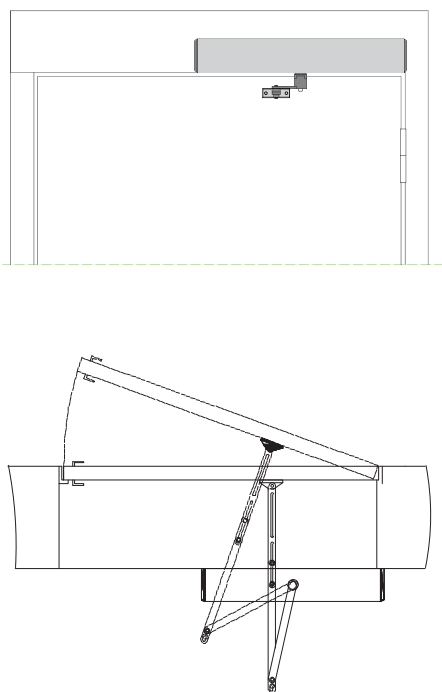

### 3 Mechanical installation

---

#### 3.2 Base plate installation

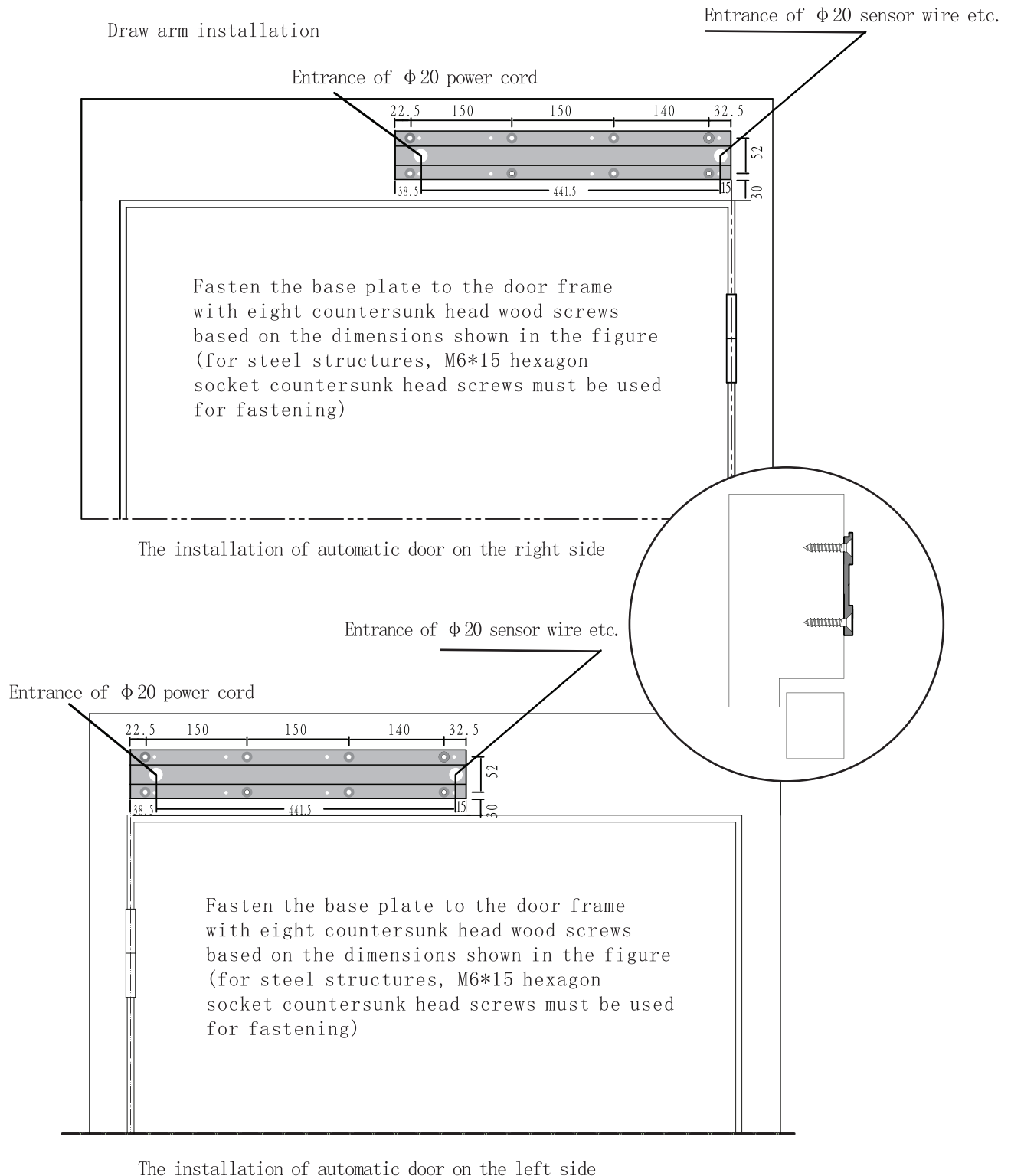

### 3 Mechanical installation

#### 3.2 Pushing arm installation

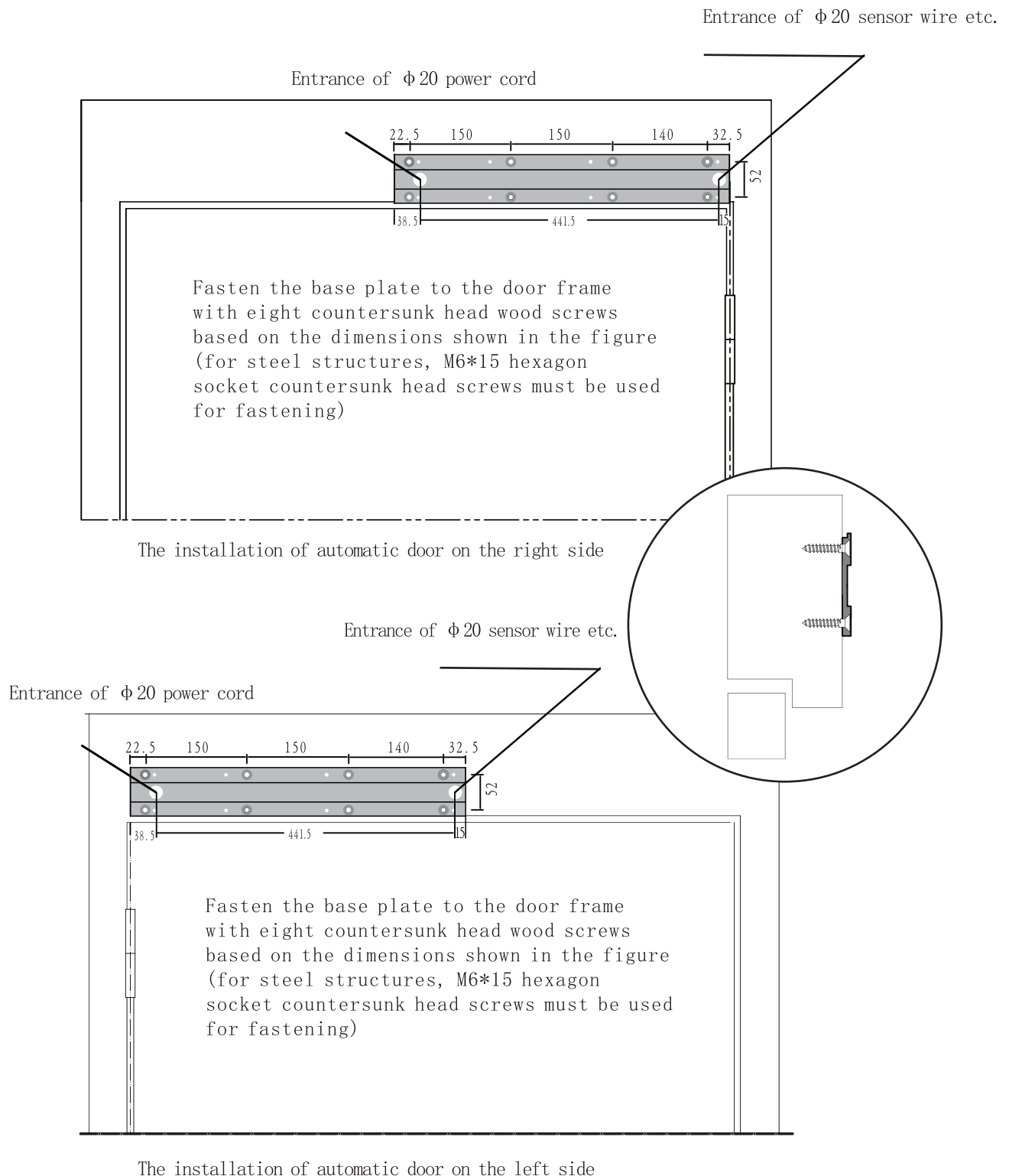

### 3 Mechanical installation

---

#### 3.3 Draw arm installation

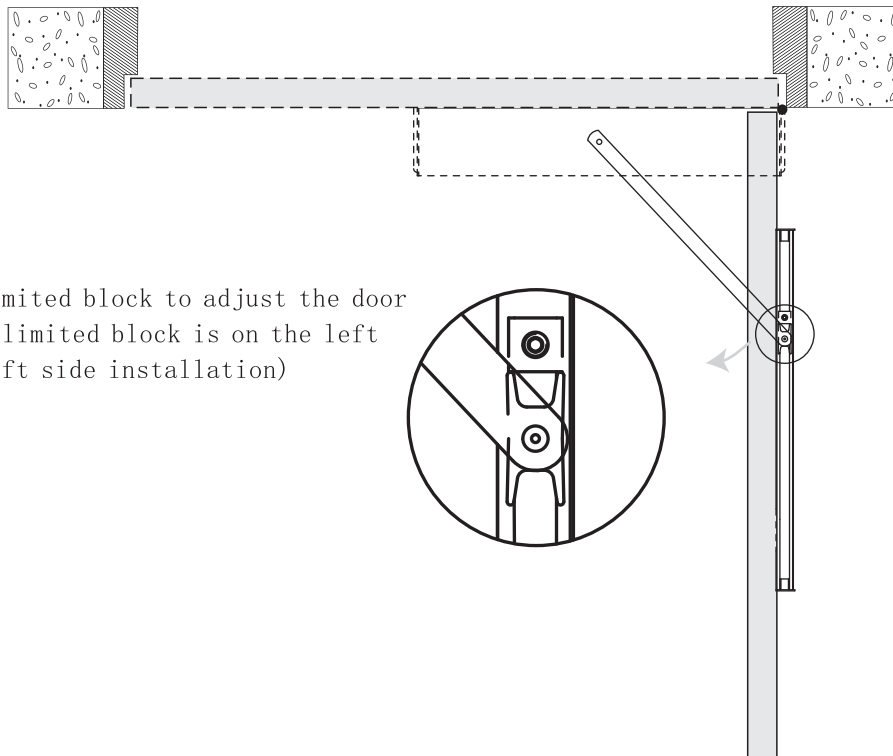
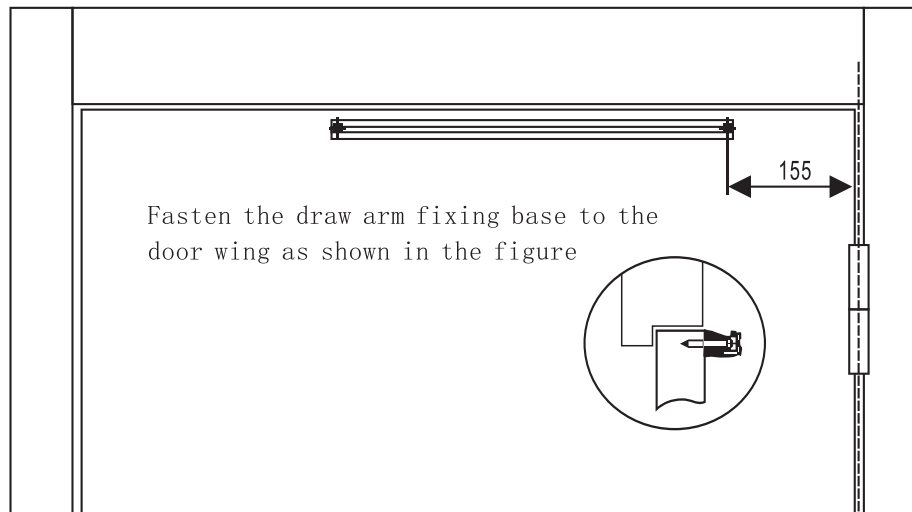

The installation of automatic door on the right side

### 3 Mechanical installation

---

#### 3.4 Pushing arm installation

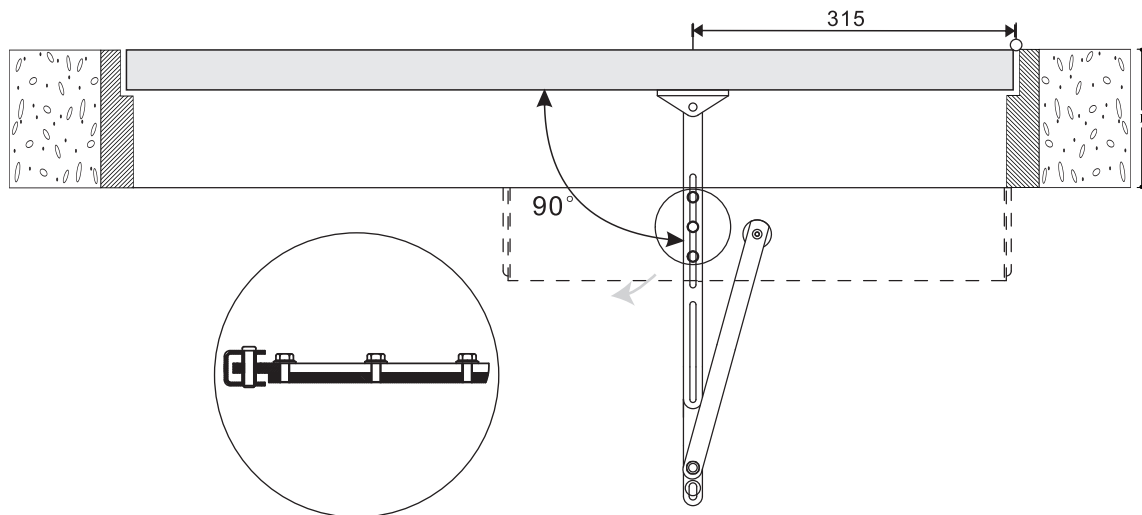
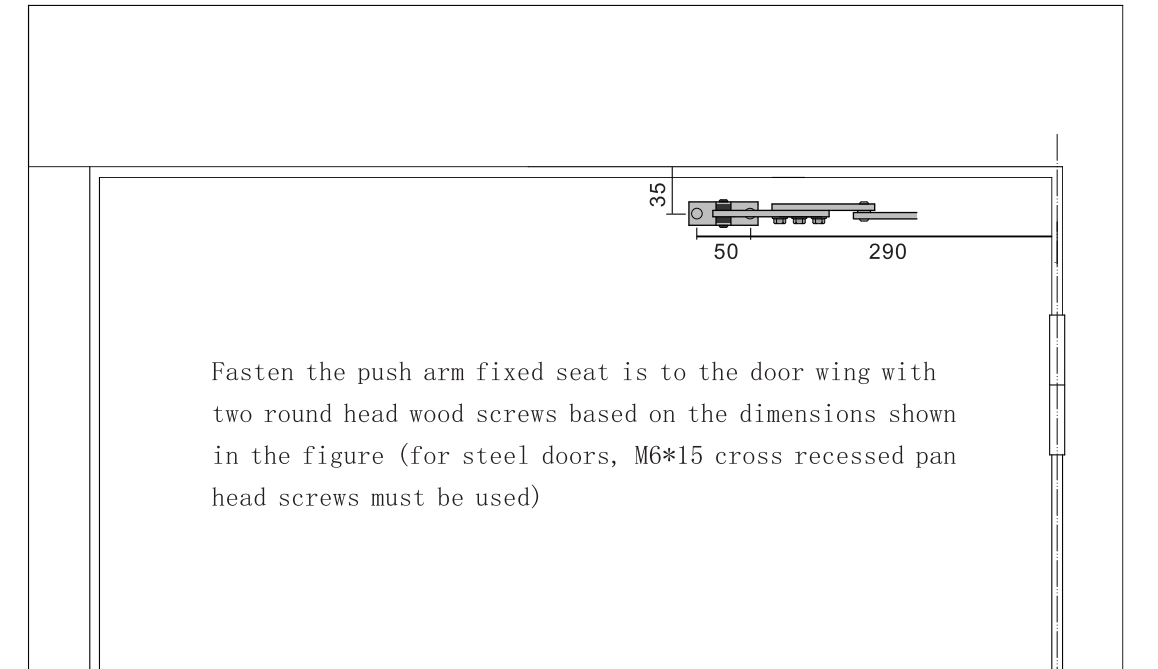

Based on the depth of the door frame L, loosen the three clamping bolts to adjust the length of the push arm, enabling the angle between the pushing arm and the door body is 90° as shown in the figure.

The installation of automatic door on the right side

### 3 Mechanical installation

---

#### 3.4 Pushing arm installation

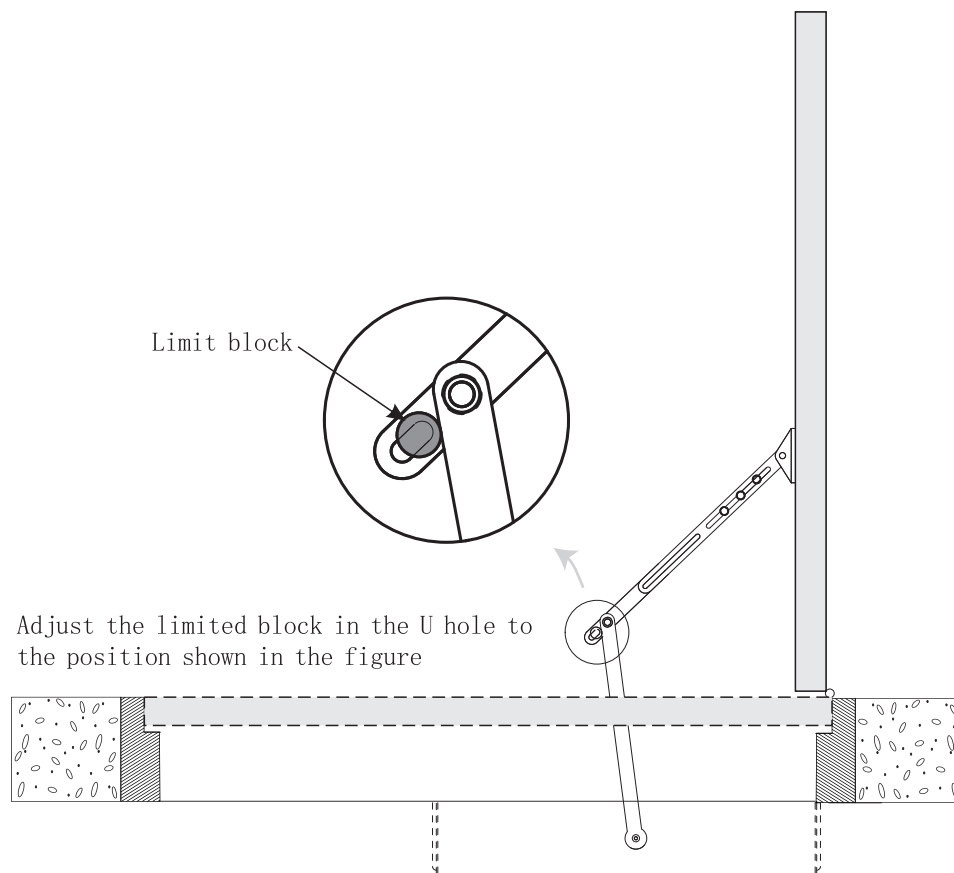

## 3 Mechanical installation

---

### 3.5 Drive system installation

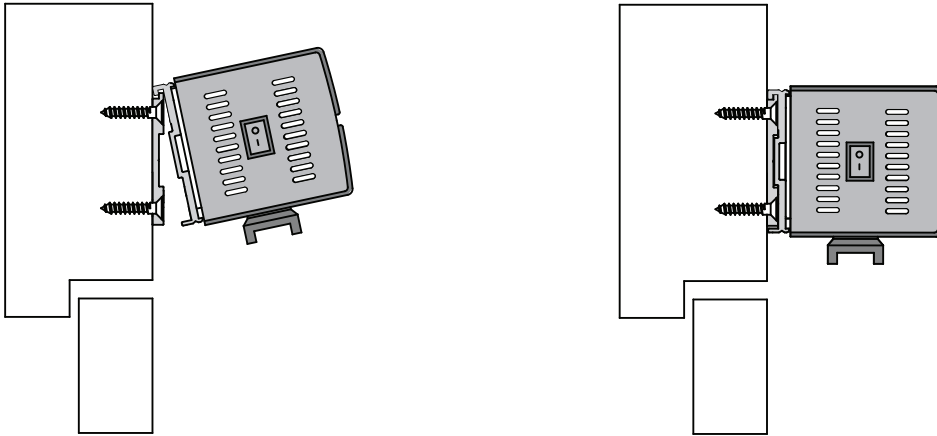

Hook the drive system to the installed base plate as shown in the figure and tighten it with eight hexagon socket head cap screws.

### 3.6 Hood installation

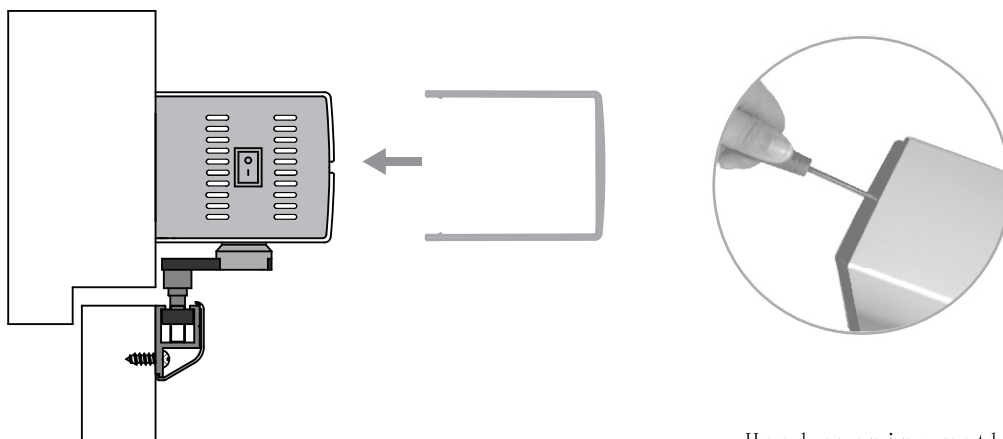

Hood opening method

### 3 Mechanical installation

---

#### 3.7 Connection of drive system and draw arm

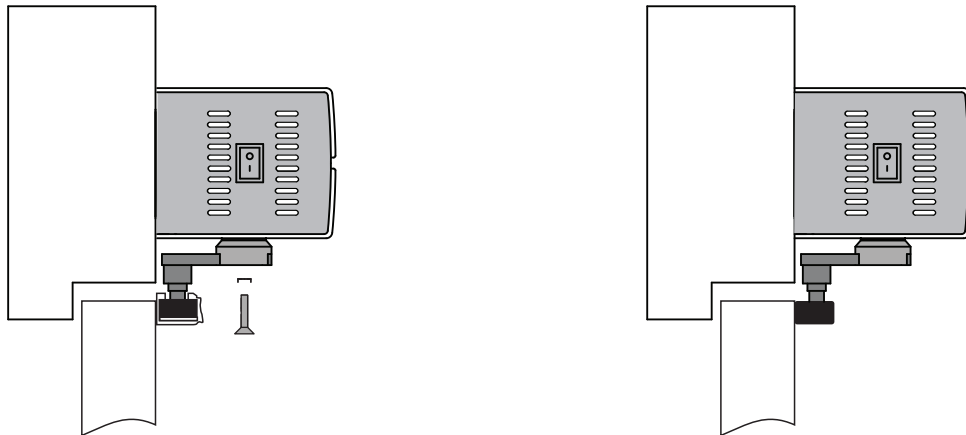

#### 3.8 Connection of drive system and pushing arm

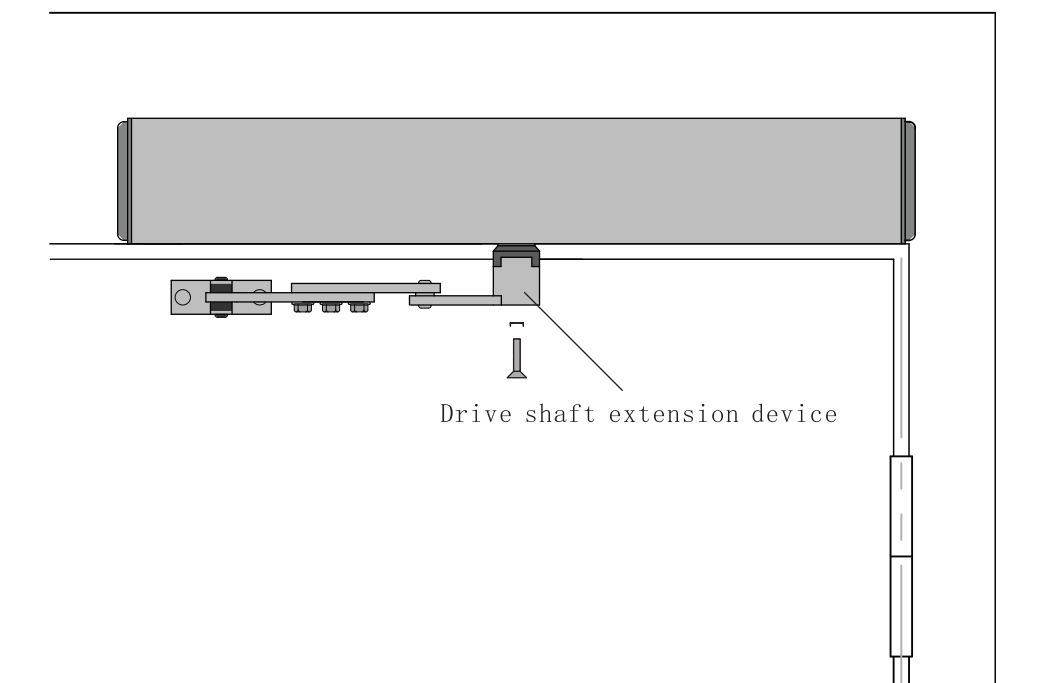



## 4 Electrical connection

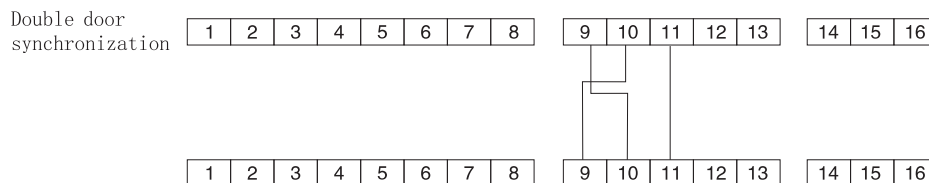
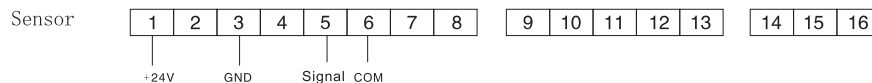
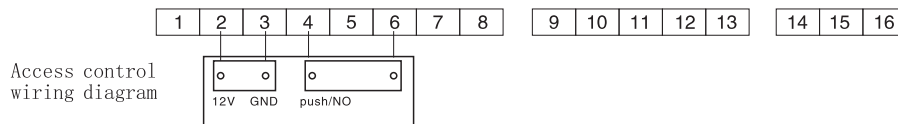
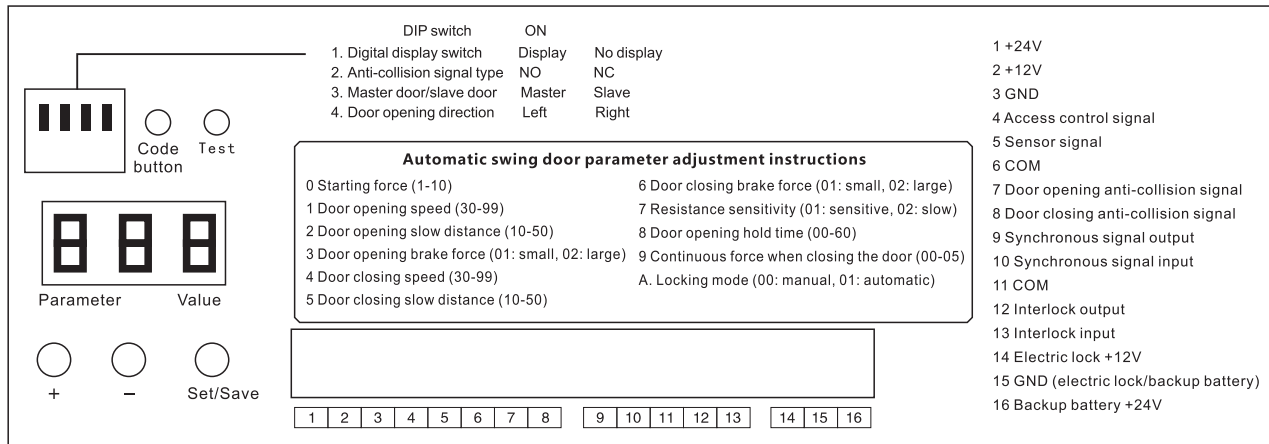

### Double door synchronization

- \* In the double door, the door of first open and then close is set as the active door, and the door of later open and first close is set as the driven door; the active door K3 is set low, and the driven door K3 is set above.
- \* The sensor and access control connect with the active door controller.

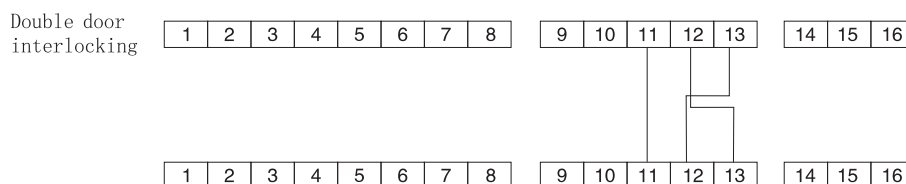

Note: When the two doors share a sensor or the same signal source, they may be normally open. At this time, exchange the two signal lines of the sensor on one of the controllers to return to normal.

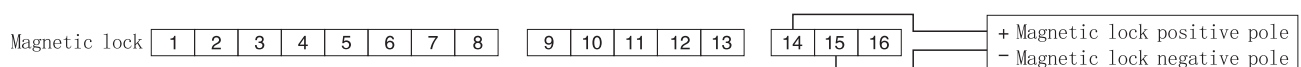

## 5 Parameter adjustment

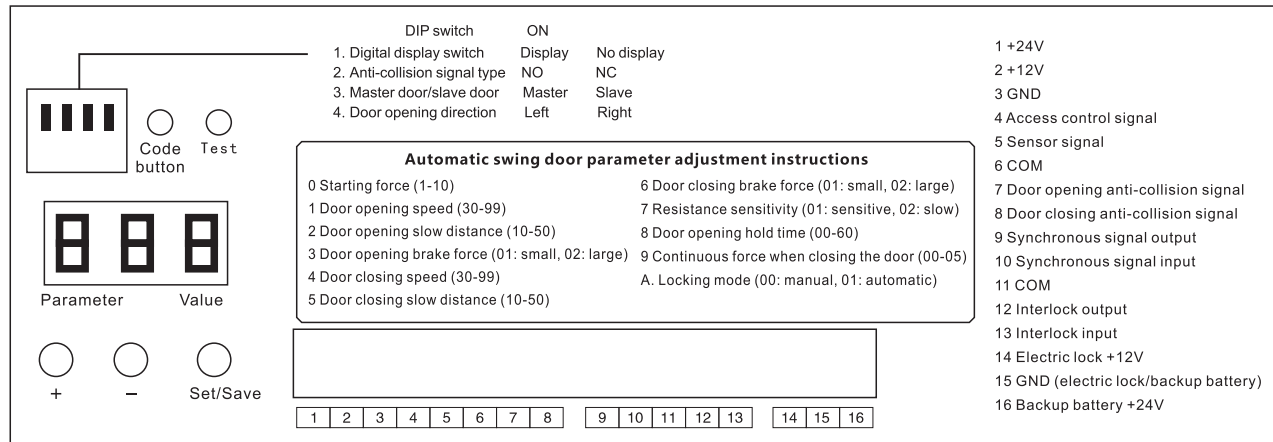

### Automatic swing door parameter adjustment instructions

0 Starting force (1-10)

1 Door opening speed (30-99)

2 Door opening slow distance (10-50)

3 Door opening brake force (01: small, 02: large)

4 Door closing speed (30-99)

5 Door closing slow distance (10-50)

6 Door closing brake force (01: small, 02: large)

7 Resistance sensitivity (01: sensitive, 02: slow)

8 Door opening hold time (00-60)

9 Continuous force when closing the door (00-05)

A. Locking mode (00: manual, 01: automatic)

## 5 Parameter adjustment

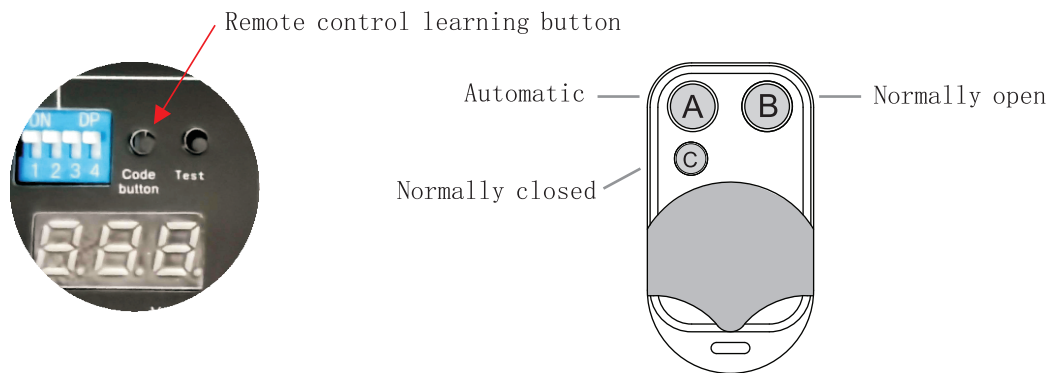
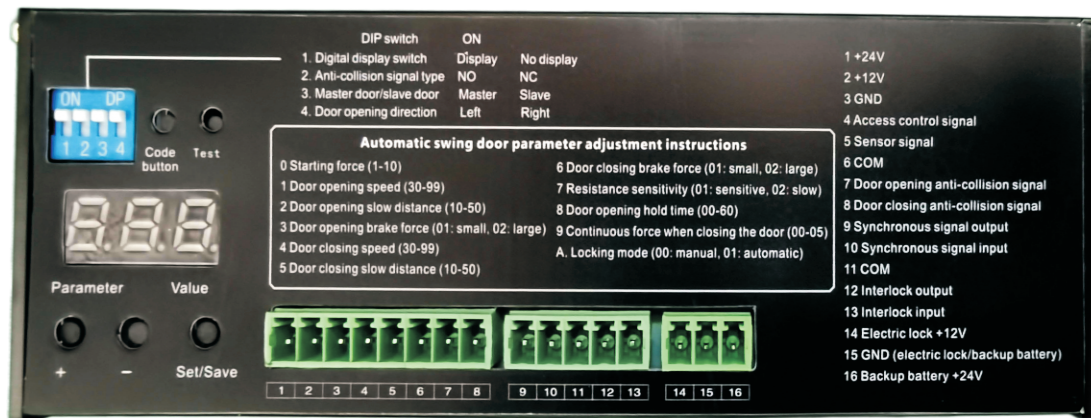

### Remote control and controller coding instructions

1. Clear: Press and hold the "Coding" button until there is no buzzer sound, then release the button.
2. Code matching: Press the "Coding" button and the buzzer will sound. At this time, press any button on the remote control and the buzzer will stop beeping, which means that the code matching is successful. When the remote control is used, the buzzer will sound for 2 seconds.
3. Note: When using the remote control, if the buzzer beeps twice, it means that the remote control and controller code matching failed. Please repeat Step 2.
4. Door opening: Press the "Door Opening" button to open and close the door once.



---

The Product Has Passed ISO 9001:2015 Quality Management System Certification.