

PLT-UV222 Excimer Lamp Series

 $\lambda = 222\text{nm}$ 

● Key Features

- *Efficient Sterilization*
- *Rapid Activation*
- *Human-Safe*
- *Long Lifespan*
- *Over 100 studies and peer-reviewed papers demonstrate efficacy in viral reduction*
- *Eco-Friendly*

● Product Characteristics

- *Non-penetrating to skin and cornea, ensuring user safety.*
- *Achieves full power within 1 second for instant disinfection.*
- *Eliminates up to 99.9% of surface bacteria and pathogens.*

● Product Advantages

- *High Environmental Adaptability: Performs reliably across diverse conditions.*
- *Low Harmonic Content: Minimizes electrical interference and enhances system stability.*
- *Eco-Friendly: Zero pollution or toxic chemical residues.*
- *Cost-Efficient: Reduces expenses on purchasing and disposing corrosive cleaning agents.*
- *Safe Operation: Generates no harmful substances during use, ensuring user and environmental safety.*

● Applications

- *Air sterilization & disinfection*
- *Jewelry inspection*
- *Plant growth acceleration*
- *Optical monitoring & analysis*

● Operational Requirements:

- *Lamp Orientation: Any direction*
- *Ambient Temperature: -25°C to 55°C*
- *Installation requirements: The lamp tube must be kept clean and properly maintained*
- *Power Supply: Matched high-voltage driver*

● Service Life Specifications

- *Rated Service Life:* 4000 hours
- *UV intensity decay @222nm under rated service life:* ≤30%

Lamp Parameters

Model	Power	Voltage	Tube Material	Terminal Material	UV Irradiance
PLT-UV222-3W-D16Z65	3W	2000V	Quartz Glass	Silicone	> 1000µw/cm²@222nm (h=5cm)
PLT-UV222-5W-D16Z115	5W	2000V	Quartz Glass	Silicone	> 1000µw/cm²@222nm (h=5cm)
PLT-UV222-10W-D16Z115	10W	2500V	Quartz Glass	Silicone	> 1000µw/cm²@222nm (h=5cm)
PLT-UV222-20W-D33Z120	20W	3000V	Quartz Glass	Ceramic	> 35µw/cm2@222nm (h=100cm)
PLT-UV222-60W-D16Z589	60W	2500V	Quartz Glass	Ceramic	> 70µw/cm2@222nm (h=100cm)
PLT-UV222-150W-D41Z525	150W	3500V	Quartz Glass	Ceramic	> 380µw/cm2@222nm (h=100cm)

Ballast Parameters

Model	Input Voltage	Max Current	Load Power	Output Voltage	Efficiency (η)	Dimensions
ES-3.7V-3W	DC 3.7V	0.8 A@3.7V	3W	2.0KV MAX	>80%	52*27*23mm
ES-24V-5W	DC 24V	0.38 A@24V	5-10W	2.0KV MAX	>85%	52*27*23mm
ES-23.5-10W-S	DC 24V	0.38 A@24V	5-10W	2.5KV MAX	>85%	84*46*28mm
ES-24V-20W	DC 24V	1.25 A@24V	15-30W	2.5KV MAX	>82%	122*53*32mm
ES-24V-60W	DC 24V	2.7 A@24V	40-60W	3KV MAX	>85%	122*53*32mm
ES-U-150W	110-240v 50-60Hz	0.72A@230V	80-150W	3.5KV MAX	>90%	152*95*56.5mm

Ballast Standards

- Operating Temperature: -15°C to 40°C
- Humidity: 5%–85% RH

Ballast Standards

- IP Rating: IP20/IP40
- Compliance Certifications: [Specify applicable certifications, e.g., CE, UL, RoHS]



Safety Notes

- Disconnect power before installation or replacement.
- Use 0.5–1.0mm² wires with 8–10mm stripped ends.
- Max cable length between ballast and lamp: 5m.
- Maximum enclosure temperature: 70°C.

Mechanical Dimensions

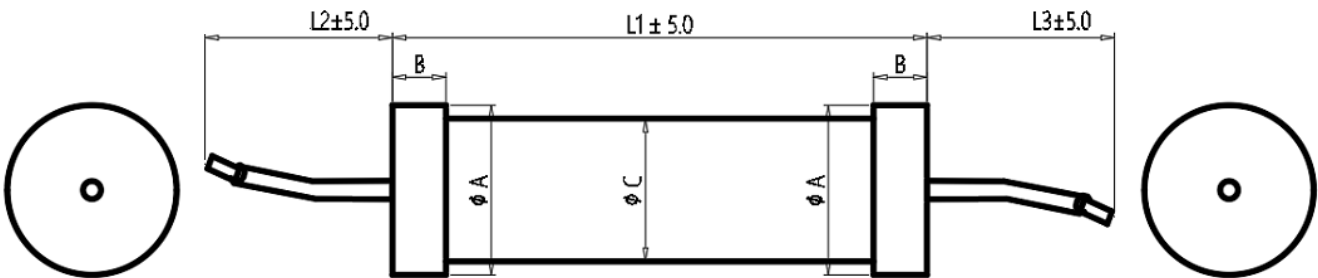

Model	Tube Length (L1)	Lead Length (L2)	Diameter (C)	Terminal Size(A)
PLT-UV222-3W-D16Z65	65mm ± 5.0	200mm ± 5.0	16mm ± 2.0	19mm ± 0.5
PLT-UV222-5W-D16Z115	115mm ± 5.0	200mm ± 5.0	16mm ± 2.0	19mm ± 0.5
PLT-UV222-10W-D16Z115	115mm ± 5.0	200mm ± 5.0	16mm ± 2.0	19mm ± 0.5
PLT-UV222-20W-D33Z120	120mm ± 5.0	200mm ± 5.0	16mm ± 2.0	38.5mm ± 0.5
PLT-UV222-60W-D16Z589	589mm ± 5.0	200mm ± 5.0	16mm ± 2.0	38.5mm ± 0.5
PLT-UV222-150W-D41Z525	525mm ± 5.0	200mm ± 5.0	16mm ± 2.0	42.5mm ± 0.5

