

Series 8 Controller and I/O Specification



**S803-150-530**

**Release 530**

**May 2024, Version 1.0**

**Revision History**

Revision	Date	Description
1.0	May 2024	Release version for Experion R530

**Table of Contents**

**1. Introduction ..... 5**

    1.1. Overview ..... 5

    1.2. Scope ..... 5

    1.3. Definitions ..... 5

**2. Platform Environmental Specifications ..... 6**

    2.1. General Environmental Characteristics ..... 6

    2.2. Approval Bodies ..... 7

    2.3. Detailed Specification- Approvals ..... 7

**3. C300 Controller ..... 10**

    3.1. Overview ..... 10

    3.2. Model Numbers ..... 11

    3.3. C300 Controller Specifications ..... 11

        3.3.1. C300 Control Execution Environment (CEE) ..... 11

        3.3.2. C300 Hardware Specifications ..... 11

        3.3.3. C300 Supported Function Blocks ..... 13

**4. Series 8 I/O Hardware ..... 15**

    4.1. Overview and Features ..... 15

    4.2. I/O Module Functions ..... 16

    4.3. Series 8 I/O Sizing ..... 16

        4.3.1. Series 8 Field connections ..... 16

        4.3.2. I/O Module Sizes ..... 17

    4.4. Specifications for Series 8 I/O ..... 18

        4.4.1. Analog Input with HART - Differential ..... 18

        4.4.2. Analog Input with HART – Single Ended ..... 20

        4.4.3. Analog Input – Single Ended ..... 22

        4.4.4. Low Level Analog (Temperature) Input LLAI ..... 24

        4.4.5. Analog Output with HART ..... 27

        4.4.6. Analog Output ..... 29

        4.4.7. Digital Input 24VDC ..... 31

        4.4.8. Digital Input Sequence of Events ..... 32

        4.4.9. Digital Input Pulse Accumulation ..... 33

        4.4.10. Digital Output 24VDC ..... 34

        4.4.11. DO Relay Extension Board ..... 36

    4.5. Series 8 IO Function Matrix ..... 38

**5. Series-8 Power Systems and Accessories ..... 39**

    5.1. COTS Series-8 Power System ..... 39

        5.1.1. Notable Features ..... 39

        5.1.2. Model Numbers ..... 39

        5.1.3. Detailed Specifications- Power System ..... 40

    5.2. Header Board ..... 42

        5.2.1. Notable Features ..... 42

        5.2.2. Model Number ..... 42

        5.2.3. Detailed Specifications- Header Board ..... 42

- 5.3. Circuit Breaker Box Assembly..... 43
  - 5.3.1. Notable Features .....43
  - 5.3.2. Model Number .....43
  - 5.3.3. Detailed Specification - Circuit Breaker Box Assembly.....43
- 5.4. C300 Controller memory backup ..... 44
  - 5.4.1. Notable Features .....44
  - 5.4.2. Model Number .....44
  - 5.4.3. Detailed Specification – RAM Charger Assembly.....44
- 5.5. S8 IO Extension Solutions ..... 45
  - 5.5.1. Model Number.....45
- 6. Glossary ..... 46**

## 1. Introduction

### 1.1. Overview

This document provides technical information to configure the Experion® Series 8 I/O and the C300 Controller.

### 1.2. Scope

The following Series 8 hardware items are included in this document.

- Series 8 C300 Controller
- Analog Input with HART – Differential
- Analog Input with HART – Single Ended
- Analog Input – Single Ended
- Low Level Analog (Temperature) Input LLAI
- Analog Output with HART
- Analog Output
- Digital Input, 24 VDC
- Digital Input Sequence of Events (SOE)
- Digital Input Pulse Accumulation
- Digital Output, 24 VDC
- DO Relay Extension Board

### 1.3. Definitions

- **Input Output Termination Assembly (IOTA):** An assembly that holds the IOM and the connections for field wiring,
- **Input Output Module (IOM):** A device that contains most of the electronics required to perform a specific I/O function. The IOM plugs onto the IOTA.

## 2. Platform Environmental Specifications

### 2.1. General Environmental Characteristics

This section relates to the physical characteristics applicable to Series 8 C300 controller and all Series 8 I/O components. Where applicable, specifications state limits within an approved cabinet and to the cabinet skin.

Consideration	Operating Limit <sup>1</sup>	Transportation and Storage Limits <sup>1a</sup>
Ambient Temp Range	External: 0 to 50°C <sup>2</sup> Internal : 0 to 60°C <sup>3</sup>	-40 to 85°C
Temp. Rate of Change	<= 1°C/min	<=5°C/min
Relative Humidity <sup>3</sup>	5 to 95% (non-condensing) <sup>4</sup>	5 to 95% (non-condensing) <sup>4</sup>
Barometric Pressure Altitude	-300 to +3000 m	Any
Corrosives	G3 Standard (ISA S71.04) - Denoted by "8C-" model number in this doc	G3 Standard (ISA S71.04) - Denoted by "8C-" model number in this doc
Vibration (3 axes)	Sinusoidal (5 to 10 Hz) 2.54mm/0.100in Max (10 to 150 Hz) 0.5 g max. (0-Pk)	Random Vertical Shipping Axis 5 to 300 Hz 1.07 g (rms) Longitudinal and Transverse 10 to 500 Hz, 0.74 g (rms) 60 Minutes each axis
Mechanical Shock (3 Axes)	Site Induced: Terminal Peak Sawtooth waveform 4g max. @25ms	N/A
<p>Note 1 – Operating Limits define the range of operating conditions within which the system is designed to operate. Performance characteristics are defined when operating in this state. Please see ANSA/ISA D 51.1 Process Instrumentation Terminology for more information.</p> <p>Note 1a – Transportation and Storage Limits define the range of conditions to which the system may be subjected without permanent damage to the equipment. Performance is not guaranteed in this state. Please see ANSA/ISA D 51.1 Process Instrumentation Terminology for more information.</p> <p>Note 2 – This rating applies to the external ambient temperature of the Standard 2000mm enclosure with doors closed.</p> <p>Note 3 – This rating applies to the internal ambient temperature of the Standard 2000mm enclosure with the doors closed. New version of the C300 controller(8C-PCNT05) and Memory Backup Assembly module (50182539-001) support an extended temperature range from 0°C to 70°C.</p> <p>Note 4 – The maximum relative humidity spec applies up to 40°C. Above 40°C the RH spec is de-rated to 55% to maintain constant moisture content.</p>		





#### A note on the transportation of Batteries:

Some Government agencies have regulations that may prohibit air transport of Lithium Batteries.

## 2.2. Approval Bodies

Approval Body	Certification Category	Description
Canadian Standards Association (CSA)	Division 2 Certifications	All models are certified as suitable for use in Class I, Division 2, Group A, B, C, D hazardous locations.
	Zone 2 Certifications	All models are certified as normally non-sparking apparatus, Class I, Zone 2, AEx/Ex ec IIC T4 Gc (except 8C-SDOX01), Class I, Zone 2, AEx/Ex ec nC IIC T4 Gc (for 8C-SDOX01 only), for use in Zone 2 hazardous locations. Temperature rating of all individual models as well as cabinet configurations is not to exceed T4.
ATEX IECEX UKCA	Zone 2 Certifications	All models are certified as normally non-sparking apparatus, II 3G, Ex ec IIC T4 Gc (except 8C-SDOX01), Ex ec nC IIC T4 Gc (for 8C-SDOX01 only), for use in Zone 2 hazardous locations. Temperature rating of all individual models as well as cabinet configurations are rated T4.
European Compliance (CE)	EMC, LVD	<ul style="list-style-type: none"> <li>European EMC Directive 2014/30/EU EN 61326-1 2013 Electrical equipment for measurement, control and laboratory use - EMC requirements.</li> <li>European LVD Directive 2014/35/EU IEC/EN 61010-1:2010 Safety Requirements for Electrical Equipment for Measurement, Control and Laboratory Use -. Part 1: General Requirements</li> </ul>
Others		RCM, EAC

## 2.3. Detailed Specification- Approvals

Consideration	Approval
Agency Approvals	     NA: Class I, Division 2, Grp. ABCD, T4; Class I, Zone 2, AEx/Ex ec IIC T4 Gc Class I, Zone 2, AEx/Ex ec nC IIC T4 Gc ATEX: II 3G Ex ec IIC T4 Gc II 3G Ex ec nC IIC T4 Gc IECEX: Ex ec IIC T4 Gc Ex ec nC IIC T4 Gc  Ex ec IIC T4 Gc (except 8C-SDOX01); Ex ec nC IIC T4 Gc (for 8C-SDOX01 only)

Item	Specification		
CE Conformity	This product is in conformity with the protection requirements of the following European Council Directives: 2014/35/EU, the Low Voltage Directive, and 2014/30/EU, the EMC Directive. Conformity of this product with any other "CE Mark" Directive(s) shall not be assumed.		
	<b>LVD Directive:</b>		
	Title	Number	Issue date
	Safety requirements for electrical equipment for measurement, control, and laboratory use - Part 1: General requirements	EN 61010-1	2010
	<b>EMC directive:</b>		
	Title	Number	Issue date
	Electrical equipment for measurement, control and laboratory use - EMC requirements - Part 1: General requirements	EN 61326-1	2021
	Industrial, scientific and medical equipment - Radio-frequency disturbance characteristics - Limits and methods of measurement	CISPR 11	2015
	Electromagnetic compatibility (EMC) - Part 3-2: Limits –Limits for harmonic current emissions (equipment input current ≤ 16A per phase)	IEC 61000-3-2	2018
	Electromagnetic compatibility (EMC) - Part 3-3: Limits –Limitation of voltage changes, voltage fluctuations and flicker in public low-voltage supply systems, for equipment with rated current ≤ 16 A per phase and not subject to conditional connection	IEC 61000-3-3	2013
	Electromagnetic compatibility (EMC) - Part 4-2: Testing and measurement techniques – Electrostatic discharge immunity test	IEC 61000-4-2	2008
	Electromagnetic compatibility (EMC) - Part 4-3: Testing and measurement techniques – Radiated, radio-frequency, electromagnetic field immunity test	IEC 61000-4-3	2020
	Electromagnetic compatibility (EMC) - Part 4-4: Testing and measurement techniques – Electrical fast transient/burst immunity test	IEC 61000-4-4	2012
	Electromagnetic compatibility (EMC) - Part 4-5: Testing and measurement techniques – Surge immunity test	IEC 61000-4-5	2014
	Electromagnetic compatibility (EMC) - Part 4-6: Testing and measurement techniques – Immunity to conducted disturbances, induced by radio-frequency fields	IEC 61000-4-6	2023
	Electromagnetic compatibility (EMC) - Part 4-8: Testing and measurement techniques – Power frequency magnetic field immunity test	IEC 61000-4-8	2009
	Electromagnetic compatibility (EMC) - Part 4-11: Testing and measurement techniques – Voltage dips, short interruptions and voltage variations immunity tests	IEC 61000-4-11	2020
CSA (US) <sup>1,2</sup>	Nonincendive Electrical Equipment for Use in Class I and II, Division 2 and Class III, Divisions 1 and 2 Hazardous (Classified) Locations	ANSI/UL 121201	2017 Ninth Edition
	Explosive atmospheres - Part 0: Equipment - General Requirements	ANSI/UL 60079-0	2013(R2017) Sixth Edition
	Explosive atmospheres - Part 7: Equipment protection by increased safety "e"	ANSI/UL 60079-7	2017 Fifth Edition

Item	Specification		
	Explosive atmospheres - Part 15: Equipment protection by type of protection "n"	ANSI/UL 60079-15	2013(R2017) Fourth Edition
	Safety Requirements for Electrical Equipment for Measurement, Control, and Laboratory Use - Part 1: General Requirements	UL 61010-1	3rd edition (2012), AMD1: 2018
CSA (Canada) <sup>1,2</sup>	Nonincendive electrical equipment for use in Class I and II, Division 2 and Class III, Division 1 and 2 hazardous (classified) locations	CAN/CSA C22.2 No. 213-17	2017
	Explosive atmospheres - Part 0: Equipment - General requirements	CAN/CSA-C22.2 No. 60079-0	2015
	Explosive atmospheres - Part 7: Equipment protection by increased safety "e"	CAN/CSA-C22.2 No. 60079-7	2016
	Explosive atmospheres - Part 15: Equipment protection by type of protection "n"	CAN/CSA-C22.2 No. 60079-15	2018
	Safety Requirements for Electrical Equipment for Measurement, Control, and Laboratory Use - Part 1: General Requirements	CAN/CSA C22.2 No. 61010-1-12	UPD1: 2015, UPD2: 2016, AMD1: 2018
ATEX/UKCA <sup>1</sup>	Explosive atmospheres - Part 0: Equipment - General requirements	EN IEC 60079-0	2018
	Explosive atmospheres - Part 7: Equipment protection by increased safety "e".	EN IEC 60079-7	2015+A1:2018
	Explosive atmospheres - Part 15: Equipment protection by type of protection "n"	EN 60079-15	2010
IECEX <sup>1</sup>	Explosive atmospheres - Part 0: Equipment - General requirements	IEC 60079-0	2017 Edition 7.0
	Explosive atmospheres - Part 7: Equipment protection by increased safety "e"	IEC 60079-7	2017 Edition 5.1
	Explosive atmospheres - Part 15: Equipment protection by type of protection "n"	IEC 60079-15	2010 Edition 4
<p><b>Note1:</b></p> <ul style="list-style-type: none"> <li>i. The installation shall provide a controlled environment that limits the pollution degree to the pollution degree 2 or better, as defined in IEC/EN 60664-1.</li> <li>ii. The equipment shall be mounted within a tool-secured enclosure which meets the requirements of IEC/EN/CSA/UL 60079-0, IEC/EN/CSA/UL 60079-7 and is capable of accepting the applicable wiring methods specified in IEC/EN 60079-14, CEC Part I and NFPA 70.</li> <li>iii. The enclosure for the equipment shall provide a degree of protection not less than IP54 in accordance with the test of enclosure section of IEC/EN/CSA/UL 60079-0 and IEC/EN/CSA/UL 60079-7 unless the equipment is afforded an equivalent degree of protection by location.</li> <li>iv. The installer shall provide transient over-voltage protection external to the equipment such that the voltage at the supply terminal of the equipment does not exceed 140% of the voltage rating of the equipment.</li> </ul> <p><b>Note2:</b></p> <ul style="list-style-type: none"> <li>v. Equipment is only to be installed by trained personal in accordance with the installation, set-up, operation and maintenance of comparable devices.</li> <li>vi. Equipment has only been tested for electrical safety. No evaluation of functional safety and performance characteristics has been conducted.</li> </ul>			

## 3. C300 Controller

### 3.1. Overview

The Experion Series 8 C300 controller forms the heart of the Experion control system and deterministically executes control strategies, batch operations, interfaces to local and remote I/O and directly hosts custom programmable applications. The compact controller design does not require any additional Interface / communication modules and all control execution and communications are contained in the controller module.

The C300 controller runs the field proven, deterministic Control Execution Environment (CEE) which is the core C300 software that provides powerful and robust control for the distributed control system (DCS). The control strategies are configured and loaded to the C300 controller through the Control Builder, an easy and intuitive engineering tool.

The C300 Controller is constructed using the Series 8 form factor that employs an Input Output Termination Assembly (IOTA) and an electronics module which mounts and connects to the IOTA. One C300 Controller module and its IOTA contains all of the control and communication functionalities. The C300 IOTA contains only passive devices such as FTE address switches, FTE cable connectors and I/O Link cable connectors. Figure 1 below depicts the IOTA components.

The C300 Controller may operate in both non-redundant and redundant configurations. Redundant operation requires a second identical controller with its own IOTA and connecting redundancy cable. The C300 Controller supports Series 8 I/O modules. Two IO Link interfaces, which are redundant, provide connection between the C300 controller and associated I/O modules. The IO Link interface connectors are on the C300 IOTA.

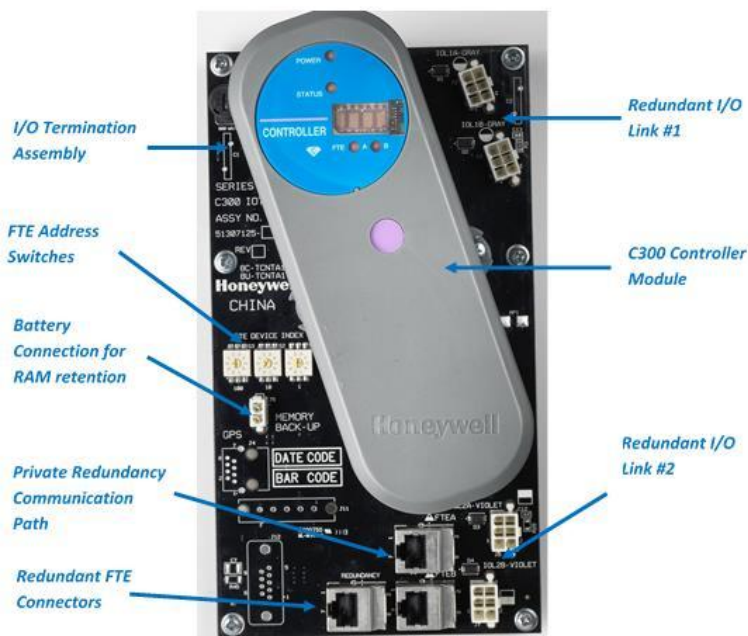

Figure 1 - C300 Controller

## 3.2. Model Numbers

The Model Numbers of C300 controller are shown as below:

Model Number	Description
8C-PCNT03	Series 8 C300 Controller, Coated <sup>1,3,4</sup>
8C-PCNT05	Series 8 C300 Controller, V5, Coated <sup>5,6</sup>
8C-TCNTA1	Series 8 C300 Controller I/O Termination Assembly(IOTA), Coated <sup>1</sup>
51305980-836	Cable, Redundant C300 Controller <sup>2</sup>
<p>Note 1 – Conformal coating applied on the module and the IOTA</p> <p>Note 2 – Redundancy is implemented with two modules/IOTAs and a redundancy cable (51305980-836)</p> <p>Note 3 – Optional rechargeable battery pack for C300 Memory Backup is available, details are provided in section <a href="#">5.4</a></p> <p>Note 4 – 8C-PCNT02 part number is replaced by 8C-PCNT03. The new controller (8C-PCNT03) is compatible with all current and previous PC/LX releases.</p> <p>Note 5 – 8C-PCNT05 is the new S8 C300 controller, and only supports Experion R520 and later releases. Both 8C-PCNT03 and 8C-PCNT05 supports Experion R520 releases. While 8C-PCNT03 also supports all previous Experion releases. 8C-PCNT05 is not interoperable with 8C-PCNT03 controller.</p> <p>Note 5 – 8C-PCNT05 uses the same S8 C300 IOTA, i.e. 8C-TCNTA1 and controller redundancy cable.</p>	

## 3.3. C300 Controller Specifications

### 3.3.1. C300 Control Execution Environment (CEE)

The C300 CEE provides an execution and scheduling environment in which Control Modules (CMs) and Sequential Control Modules (SCMs) execute user-configured control strategies. The CEE also support peer to peer communications with other C300 controllers and communication modules like Foundation Fieldbus and Profibus. The C300 CEE is configured using the Control Builder Engineering environment. The Control builder provides a graphical engineering environment where engineers can configure the Experion system and create control strategies by using the various function blocks available in the Library. The C300 CEE based control strategies can be configured with minimum execution rates of 50 msec.

### 3.3.2. C300 Hardware Specifications

Specifications	8C-PCNT03	8C-PCNT05
Power requirement	24 V (provided through cables by the Series 8 power system)	
IOTA Dimension	220 mm (9 ") height, 120 mm (4,75 ") width	
Program Memory	16MB	32MB
Processor core	Single	Dual
Supported Releases	Experion R110, 120, R500, R51x and R520	Experion R520 and onwards

Specifications	8C-PCNT03	8C-PCNT05
<b>Features</b>		
Module Removal and Insertion Under Power	Supported	
Conformal Coated	Yes, G3 level of Harsh Environment (ANSI/ISAS71.04-1985 corrosion standard)	
Redundancy	IOTA based design, no single point of failure for IOM, Termination, and Communication links (Downlink and Uplink)	
RAM Retention	50 hour through rechargeable battery backup pack (Optional)	
Switchover	Bump less, Internal parameters, variables and outputs are maintained during transition	
Programing Language	Function Block Design (FBD) via Experion Control Builder	
<b>Supported I/Os and Uplink Communication</b>		
Supported I/O type	Series 8	
Supported I/O Links	2 I/O Links, each I/O Link configurable for Series 8 I/Os	
Supported I/O Link Speed	750 kbps	
Supported number of I/O Modules per Controller	80 I/O Units (Redundant or Non-Redundant IOMs)	
Supported number of I/O Modules per I/O Link	40 I/O Units (Redundant or Non-Redundant IOMs)	
Maximum number of I/Os per Controller	2560 <sup>1</sup>	
Number of Uplink (FTE) Connection	Dual uplink FTE ports, 100Mbps speed	
<b>Control Capacity</b>		
Execution Units	5500 Execution Units (single or redundant)	9000 Execution Units (single or redundant)
Tagged Objects	4095 objects	
Memory Units	16384 Memory Units	32768 Memory Units
Execution Period	50 msec – 60000 msec (adjustable per control strategy, configurable)	
Minimum Reserved CPU to be maintained During Runtime	20% for each CPU	
<b>Controller Communication</b>		
CEE-based Platforms	Native peer to peer with other Series 8 C300s, C200 and ControlEdge UOC controllers <sup>2</sup>	
Supervisory Control Network	Fault Tolerant Ethernet (FTE)	

Specifications	8C-PCNT03	8C-PCNT05
Third party devices	Modbus Master	
Modbus TCP devices	PCDI function block	
Modbus RTU or ASCII	Via Modbus TCP/IP conversion gateway	
Ethernet/IP	Native peer to peer	
Foundation Fieldbus	Via Fieldbus Interface Module (FIM) gateway	
Profibus DP	Via Profibus Gateway Module (PGM)	
Max number of PGM connections per C300	4	8
<b>Optional C300 Memory Backup</b>		
RAM Charger Module <sup>3</sup>	51454475-100	50182539-001
Cable, Battery RAM charger	30 inches, 51202330-300 84 inches, 51202330-200	
Note 1 – When using full capacity with 32 channel digital IO module		
Note 2 – C200 and ControlEdge UOC support available from Experion LX/PlantCruise R510 and onwards.		
Note 3 – The RAM charger (Battery backup module) is different for 8C-PCNT03 and 8C-PCNT05 controllers.		

### 3.3.3. C300 Supported Function Blocks

Function Block	Function Block	Function Block	Function Block
<b>General Purpose (Utility)</b>	Timer	Lead / Lag	Override Selector (4 inputs)
Alarm Window	Type Convert	Rate of Change	PID (Proportional, Integral, Derivative)
Annpanel	<b>PV Algorithms (Auxiliary)</b>	Signal Selector	PID with External Reset
Dig Acq	PV Calculator	Totalizer	PID with Feed Forward
EXECTIMER	Summer	<b>PV Handling</b>	Profit Loop
First Out	Counter	Data Acquisition	Positional Proportional
Flag	Dead Time	<b>Regulatory Control</b>	Pulse Count
Flag Array	Enhanced PV Calculator	Auto Manual	Pulse Length
Operator Message	Enhanced General Linearization	Regulatory Calculator	Ramp / Soak
Numeric	Flow Compensation	Enhanced Regulatory Calculator	Ratio Bias
Numeric Array	General Linearization	Fan Out (1 input / up to 8 outputs)	
Push			
Text Array			

Function Block	Function Block	Function Block	Function Block
Ratio Control	Subtract	MVOTE	LEVELCOMP
Remote Cascade Support	Truncate	NAND	LTMOTOR
Switch (8 input single pole)	<b>Discrete Logic</b>	NE	MAINIBV
<b>Device Control</b>	2oo3 (2 out of 3 voting)	nOON	SOLENOID
Device Control (multi input, multi output, multi state)	AND	NOR	VALVEDAMPER
<b>Custom Block Types</b>	CHECKBAD	NOT	<b>Sequential Control Functions</b>
Custom Data Block	CHECKBOOL	OFFDELAY	Step
Custom Algorithm Block	CHGEXEC	ONDELAY	Transition
<b>Math</b>	CONTACTMON	OR	Synchronize
Absolute Value	DELAY	PULSE	Handler
Addition	EQ (Compare Equal)	QOR	Phase
Divide	FTRIG (Falling Edge Trigger)	ROL	<b>Container Block Types</b>
Exponent	GE (Compare Greater than or Equal)	ROR	Control Module
LN	GT (Compare Greater Than)	RS	Sequential Control Module
LOG	LE (Compare Less than or Equal)	RTRIG	Recipe Control Module
Modulo	LIMIT	SEL	Unit Control Module
Multiply	LT	SELREAL	<b>IO Related</b>
Negate	MAX	SHL	Series 8 I/O
Power	MAXPULSE	SHR	PCDI
Rolling Average	MIN	SR	Profibus Interface
Round	MINPULSE	STARTSIGNAL	VCONE
Square Root	MUX	TRIG	
	MUXREAL	WATCHDOG	
		XOR	
		<b>Power Related</b>	
		GRPCAPRBK	
		HTMOTOR	

## 4. Series 8 I/O Hardware

### 4.1. Overview and Features

Series 8 features an innovative design that supports enhanced heat management. This unique look provides a significant reduction in overall size for the equivalent function.

Both Series 8 IOM and IOTA are available with Conformal Coated feature. The term 'Coated' stands for hardware with conformal coating material applied to electronic circuitry for protection against moisture, dust, chemicals, and temperature extremes. Coated IOM and IOTA are recommended when electronics must withstand harsh environments and need to have added protection.

The unique features of the Series 8 I/O include:

- I/O Module and field terminations are combined in the same area. The I/O Module is plugged into the IOTA to eliminate the need for a separate chassis to hold the electronics assemblies
- Two level "detachable" terminals for landing the field wiring in the enclosure, providing easier plant installation and maintenance
- Field power can be supplied through the IOTA, with no need for extra power supplies and the associated craft wired marshalling
- Redundancy is available directly on the IOTA without any external cabling or redundancy control devices, by simply adding a second IOM to an IOTA
- The innovative styling is one of its unique features. This styling includes features to facilitate the effective use of control hardware in a systems environment. These features include:
  - Vertical mounting for more effective wiring since most field wiring applications require entry from the top or bottom of the systems cabinet
  - An "information circle" for a quick visual cue to draw the Maintenance Technician's eye to important status information
  - "Tilted" design for effective heat management within the cabinet enclosure. Since Series C allows for a significant increase in cabinet density, an effective heat management system is critical for high systems availability
  - Input and output circuits are protected from shorts to alleviate the need for in-line fusing, reducing installation and maintenance costs

Series 8 IOTAs combine multiple functions into a single piece of equipment:

- Single and redundant configurations
- On-board termination of process signals
- On-board signal conditioning
- On-board connection to appropriate networks (FTE, I/O LINK)
- Field power distribution without external marshalling
- IOM plugs into the IOTA and receives power from the IOTA
- The IOTA receives its power through cables from header board



## 4.2. I/O Module Functions

- **High Level Analog Input /HART Input Module (16pt)** – The High Level Analog Input Module supports both high level analog and HART inputs. Analog inputs are typically 4-20mA DC for both traditional and HART devices. HART data can be used for status and configuration. HART data, such as the secondary and tertiary variables, can also be used as process control variables. Two versions Single ended and Differential type are available.
- **High Level Analog Input w/o HART (16pt)** – The High Level Analog Input Module supports high level analog inputs Analog inputs are typically 4-20mA DC for traditional devices.
- **Analog Output/HART Output Module (16pt)** – The Analog Output Module supports both standard 4-20mA DC outputs and HART transmitter outputs.
- **Analog Output w/o HART (16pt)** – The Analog Output Module supports standard 4-20mA DC outputs.
- **Digital Input 24 VDC (32pt)** – Digital input sensing for 24V signals
- **Digital Input Sequence of Events (32pt)** – Accepts 24VDC discrete signals as discrete inputs. The inputs can be time tagged to support 1ms resolution Sequence of Events.
- **Digital Input Pulse Accumulation (32pt)** – Accepts 24VDC discrete signals as discrete inputs. The first 16 channels can be configured as Pulse accumulation to support Pulse Accumulation and frequency measurement on per channel basis. Channels 17 – 32 can be configured as DI.
- **Digital Output 24 VDC (32pt)** – Current sinking digital outputs. Outputs are electronically short-circuit protected.
- **DO Relay Extension Board (32pt)** – Digital output with NO or NC dry contacts. It can be used for low power or high power applications.
- **Low Level Analog Input – RTD & TC (16pt)** – Provides thermocouple (TC) and resistance temperature device (RTD) inputs.

## 4.3. Series 8 I/O Sizing

In virtually all configurations, the C300 controller and Series 8 I/O provides useful, maintainable process equipment connections in a smaller footprint than existing competitors and Honeywell equivalent products. Installing Series 8 I/O modules contributes to overall total installed cost savings.

IOTA sizes vary based on the application. In general, an analog module has 16 points and resides on a 6 inch (152mm) IOTA for non-redundant applications and a 12 inch (304mm) IOTA for redundant applications. A discrete module has 32 points and resides on a 9-inch (228mm) IOTA for non-redundant applications and a 12 inch (304mm) IOTA for redundant applications. Specific information on the size of a particular module is described in the Model Number Table.

### 4.3.1. Series 8 Field connections

Series 8 Field connections use a standard modular connector. The connector modularity allows for removal and insertion of the field wiring. This significantly reduces installation and maintenance procedures and can assist in field check out. Series 8 field connectors accept up to 12 AWG / 2.5 mm<sup>2</sup> stranded wire.

### 4.3.2. I/O Module Sizes

IOTA Sizing is nominal (6in = 152mm, 9in = 228mm, 12in = 304mm). I/O modules are associated with their respective IOTAs in the table below. The I/O Module is supported by one or more IOTAs. Below section also provides an overview of various available IO modules, IOTA, IOTA size and redundancy features.

I/O Module (Coated)	IOTA (Coated)	Description	Circuits	Size (in “)	Red.
8C-PAIH54		High-level AI HART, Differential	16		✓
	8C-TAIDA1	AI IOTA		9	
	8C-TAIDB1	AI IOTA Redundant		12	✓
8C-PAIHA1		High-level AI HART, Single-ended	16		✓
8C-PAINA1		High-level AI w/o HART, Single-ended	16		✓
	8C-TAIXA1	AI IOTA		6	
	8C-TAIXB1	AI IOTA Redundant		12	✓
8C-PAIMA1		Low-level AI – RTD & TC	16		
	8C-TAIMA1	Low-level AI IOTA		9	
8C-PAOHA1		Analog Output HART	16		✓
8C-PAONA1		Analog Output w/o HART	16		✓
	8C-TAOXA1	AO IOTA		6	
	8C-TAOXB1	AO IOTA Redundant		12	✓
8C-PDILA1		Digital Input 24V	32		✓
8C-PDISA1		Digital Input Sequence of Events	32		✓
8C-PDIPA1		Digital Input 24V Pulse Accumulation	32		✓
	8C-TDILA1	DI 24V IOTA		9	
	8C-TDILB1	DI 24V IOTA Redundant		12	✓
8C-PDODA1		DO 24V Bussed Out	32		✓
	8C-TDODA1	DO 24V Bussed IOTA		9	
	8C-TDODB1	DO 24V Bussed IOTA Redundant		12	✓
	8C-SDOX01	DO Relay Extension <sup>1</sup>		15	✓

Note 1- DO Relay Extension board is used along with DO IO module with IOTA (Redundant or non-redundant). Refer Section [4.4.11](#) for more details.

## 4.4. Specifications for Series 8 I/O

Specifications for Series 8 I/O modules are shown below.

### 4.4.1. Analog Input with HART - Differential

#### Function

Analog Input Module accepts high level current or voltage inputs from transmitters and sensing devices.

#### Notable Features

- Extensive self-diagnostics
- Optional redundancy
- Supports either Single Ended / Differential Inputs
- HART-capable, multivariable instruments and multiple modems for fast collection of control variables
- Fast loop scan

#### Detailed Specification- Analog Input with HART - (8C-PAIH54)

Parameter	Specification		
Input / Output Module	8C-PAIH54 - Analog Input with HART (16), Coated		
IOTA Modules	8C-TAIDA1	Non Redundant, Coated	9"
	8C-TAIDB1	Redundant, Coated	12"
Input Type	Voltage, Current (2-wire or self-powered transmitters), Single ended or Differential inputs		
Input Channels <sup>1</sup>	16 Channels (All 16 Single Ended or Differential type)		
A/D Converter Resolution	16 bits		
Input Range <sup>1</sup>	0 to 5 V, 1 to 5 V, 0.4 to 2 V, 4-20 mA (through 250 $\Omega$ )		
Voltage Rating	24 VDC		
Module Current Rating	310 mA		
Common Mode Rejection Ratio, dc to 60 Hz (500 $\Omega$ source imbalance)	70 dB		
Common Mode Voltage, dc to 60 Hz	-6 to +5 V peak		
Normal Mode Rejection Ratio, at 60 Hz	19 dB		
Normal Mode Filter Response	Single-pole RC, -3 dB @ 6.5 Hz		
Crosstalk, dc to 60 Hz (channel-to-channel)	-60 dB		
Input Impedance (voltage inputs)	> 10 M $\Omega$ powered		
Maximum Normal Mode Input (any input referenced to common, no damage)	$\pm$ 30 Volts		

Parameter	Specification
Input Scan Rate	50 ms
Hardware Accuracy (@ CMV = 0 V)	$\pm 0.075\%$ of full-scale ( $23.5 \pm 2^\circ\text{C}$ ) $\pm 0.15\%$ of full-scale (0 to $60^\circ\text{C}$ )
Module Removal and Insertion Under Power	Supported
Transmitter Field Power Conditioning	Individually Protected Current Limiting Circuits, No fuse required
Note 1 – 8C-PAIH54 supports voltage inputs for channels 1-16 when used with 8C-TAIDx1 IOTA. Each channel's 250-Ohm load resistor is connected to the input terminal through a wire jumper on the IOTA. This jumper should be cut by the user on channels to be used with voltage transmitters.	