



CIRCULAR CHARCOAL GRILL

BEFORE USING

- Be sure to use an open, uncluttered place away from combustible elements for your barbecue.
- Before using for the first time, it is recommended to leave the fire burning for about 30 minutes.

PRECAUTIONS

- It is recommended not to move the grill with the fire on.
- Keep children out of the reach of the drum or hot areas.
- When lighting the charcoal, do not use flammable liquids.
- Do not use in closed spaces.

Item	Quantity	Description
1	1	Left windbreaker
2	1	Right windbreaker
3	1	Grill
4	1	Drum for fire
5	1	Handle for the drum
6	4	Feet stops
7	2	Short legs
8	2	Long legs
9	1	Tray
10	1	Axle for wheels
11	2	Wheels
12	2	Handle
13	1	Warming Grid
A	4 sets	M5x10 Screw, Nut and Screw Set for Windbreaker
B	8 sets	Set Screw M5x30, Nut and Screw for Handle and tray
C	4 sets	Set Screw M6x30 and Gasket for legs
D	2 sets	Set of Nuts and Gasket M8

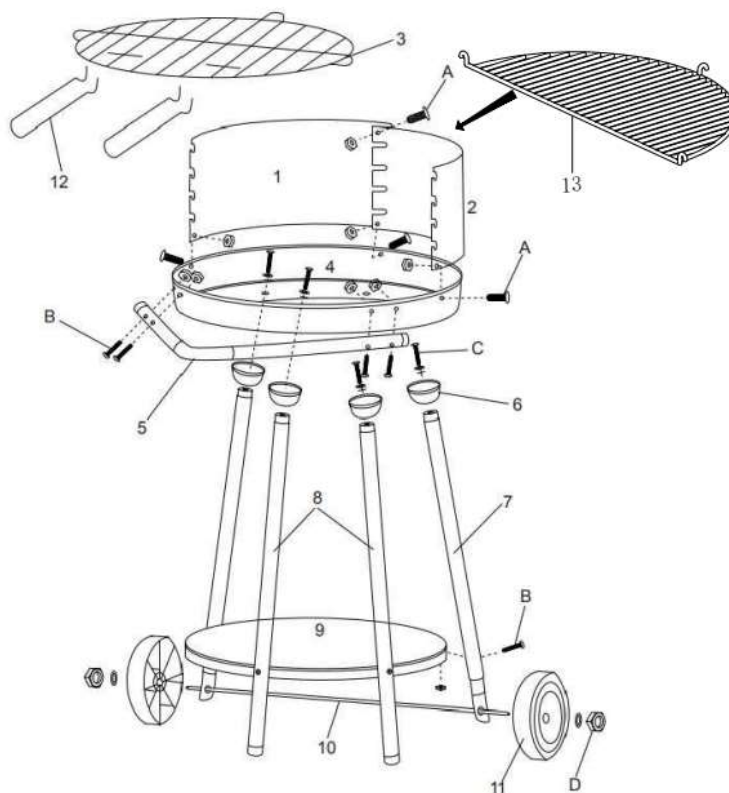

Step 1

- Assemble Legs (7 and 8) on their stops and later on the drum (4) using screws and gaskets (C)
- Insert the Axle (10) through the two short legs (7), then install the wheels (11) and fix with nuts and gaskets (D)
- Install the Tray (9) and fix with screws, nuts and gaskets (B)

Step 2

- Install the handle (5) on the drum (4) using Screws, Nuts and gaskets (B)
- Install the Right (2) and left (1) windbreaker, fixing it to the drum using Screws, nuts and gaskets (A)

Step 3

- Position the Grill (3) according to the height required to use

Step 4

- Put The Warming Grid(13) on the top of windbreaker