



唐山市宝鼎建材有限公司

Tangshan Baoding Building Materials Co., Ltd.

🌐 <https://www.tsbaoding.com>

☎ +86-315-5691888 ✉ sales@tsbaoding.com

📍 中国·河北省唐山市高新区宝鼎建材产业园
Baoding Building Materials Industrial Park, Tangshan, China



Expandable Container House **BROCHURE**

Easy to assemble



PHOTOVOLTAIC OFF-GRID POWER GENERATION SYSTEM

5000W off grid solar system (case one)

Item	Model	Description	Quantity
1	Solar Panel	Mono 320W	6 pieces
2	Battery	12V 150Ah	4 pieces
3	Controller	48V5000W Inverter (Built-in MPPT 48V60A controller)	1 piece
4	Inverter		
5	PV Cable	The standard 4mm ²	100 meters
6	MC4 connector	1000VDC	8 pieces
7	Mounting Brackets	Roof/Ground	1 piece

Consult a sales consultant for more details

Dally power generation/storage		Support loads		
Power generation	9.6 degrees	Appliance	Air condition 1500w	Washing 1000w
		Using time	6 hours	5 hours
Battery storage capacity	7.2 degrees	Appliance	elec-cooker 2000w	water pump 800w
		Using time	10 hours	12 hours

5000W off grid solar system (case two)

Item	Model	Description	Quantity
1	Solar Panel	Mono 320W	10 pieces
2	Battery	12V 200Ah	4 pieces
3	Controller	48V5000W Inverter (Built-in MPPT 48V60A controller)	1 piece
4	Inverter		
5	PV Cable	The standard 4mm ²	100 meters
6	MC4 connector	1000VDC	8 pieces
7	Mounting Brackets	Roof/Ground	1 piece

Consult a sales consultant for more details

Dally power generation/storage		Support loads		
Power generation	16 degrees	Appliance	Air condition 1500w	Washing 1000w
		Using time	10 hours	16 hours
Battery storage capacity	9.6 degrees	Appliance	elec-cooker 2000w	water pump 800w
		Using time	8 hours	20 hours

5000W off grid solar system (case three)

Item	Model	Description	Quantity
1	Solar Panel	Mono 320W	16 pieces
2	Battery	12V 150Ah	8 pieces
3	Controller	48V100A	1 piece
4	Inverter	5000W	1 piece
5	PV Cable	The standard 4mm ²	100 meters
6	MC4 connector	1000VDC	8 pieces
7	Mounting Brackets	Roof/Ground	1 piece

Consult a sales consultant for more details

Dally power generation/storage		Support loads		
Power generation	25.6 degrees	Appliance	Air condition 2000w	Washing 1300w
		Using time	17 hours	20 hours
Battery storage capacity	14.4 degrees	Appliance	elec-cooker 2000w	water pump 800w
		Using time	12 hours	32 hours



EXPANDABLE CONTAINER HOUSE

With shower and toilet, dry and wet separation wooden floor with damp proof, more comfortable



Big space



Easy installation

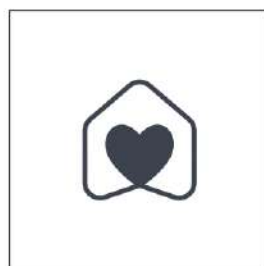

High comfort



Come with accessories

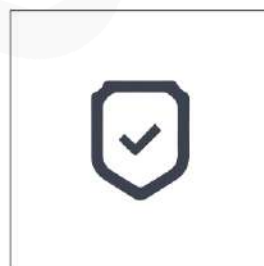

Durable

INSTALLATION



5 STEPS = 10 MINUTES = 1 HOUSE



FAST ASSEMBLING

averagely **5 workers** can achieve 1 container opened within **10mins**. The container also can be assembled in factory and then transferred to the site.

SAFE AND DURABLE

over **15-20 years** life span, seismic resistance to 8 degree, wind resistance to 11 degree.

• We will first finished prefabricated in the factory, folded up the overall transport, save space after shipping to the destination can be used 5 people can finish operation.

• Save shipping cost-folded up the overall transport, save space.

20FT

BASIC CHARACTERISTICS

External Dimensions(mm):

L5900*W6300*H2480mm

Internal Dimensionss(mm):

L5460*W6140*H2240mm

Folded Dimensions(mm):

L5900*W2200*H2480mm

Total weight (kg):

Approximately 3120

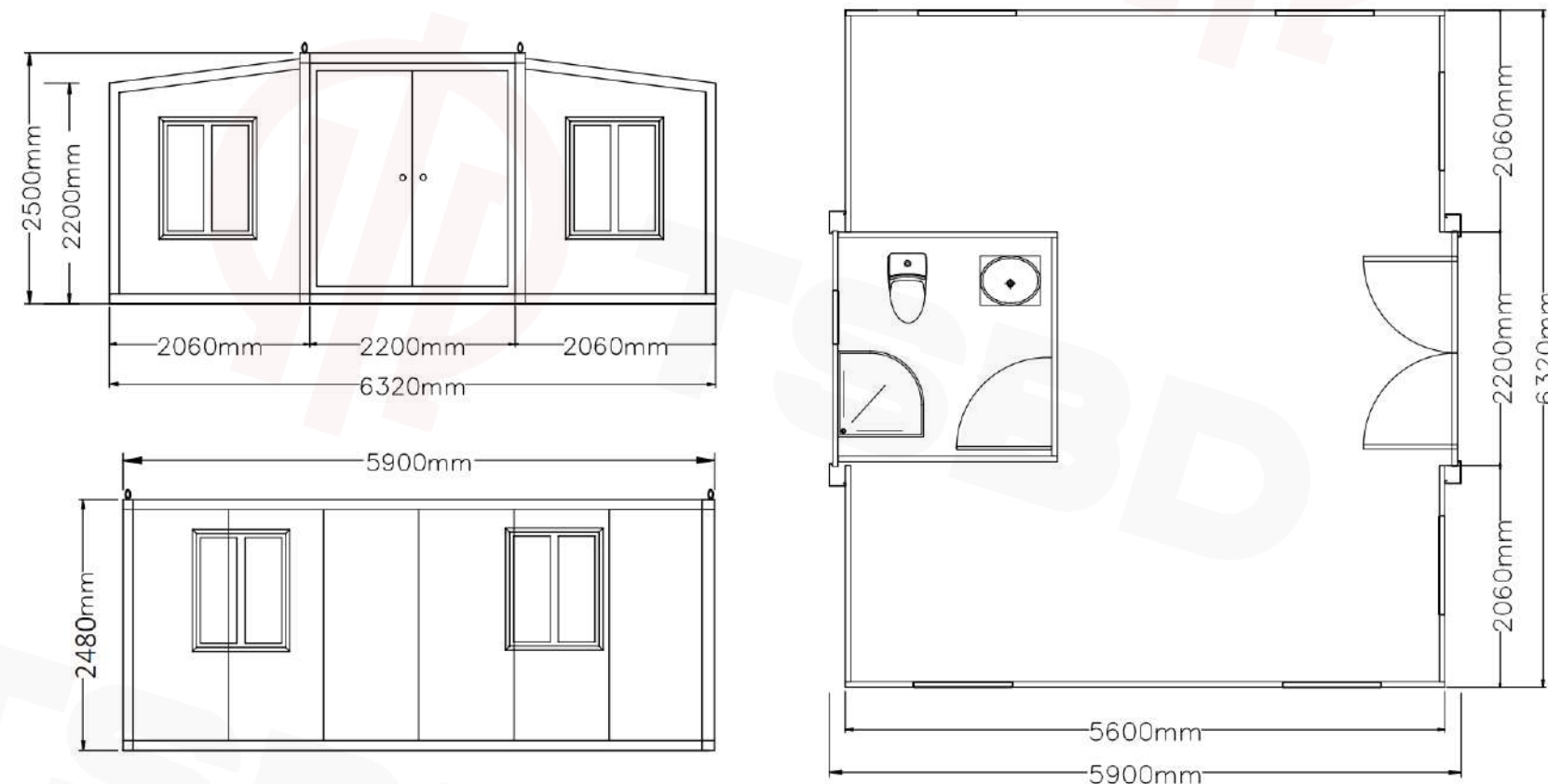

20FT LAYOUT

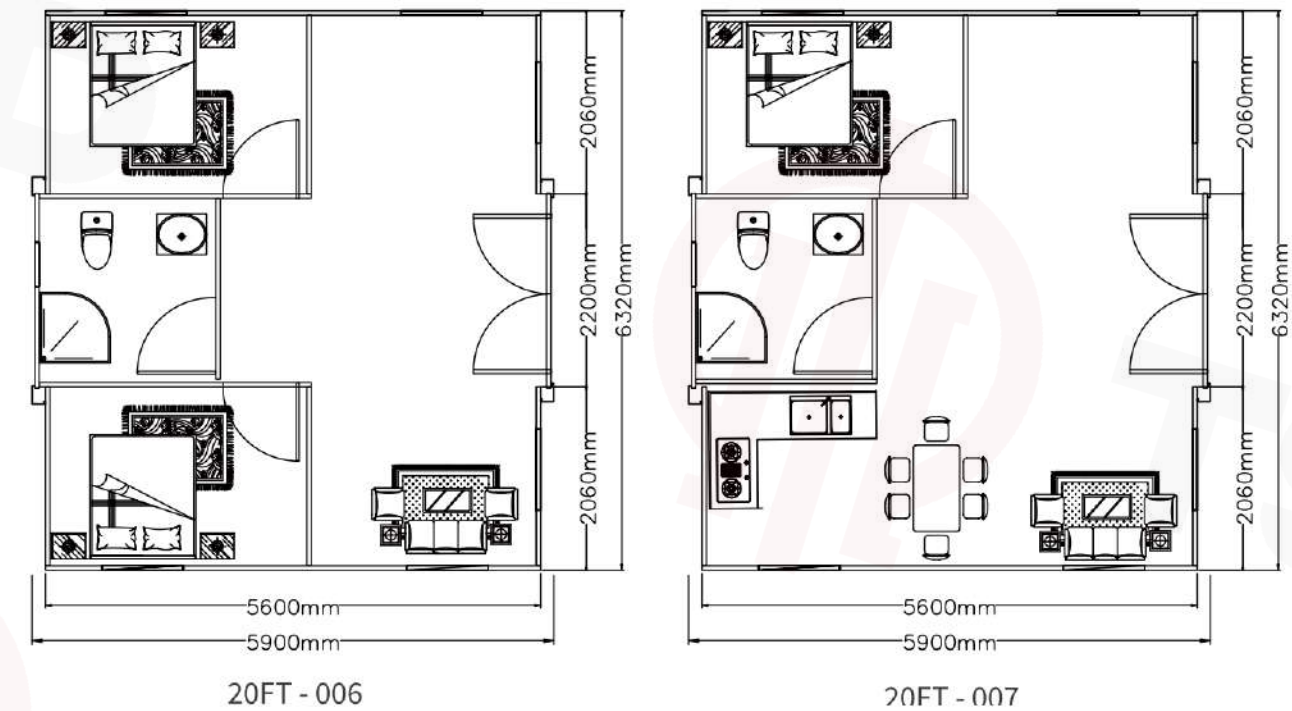
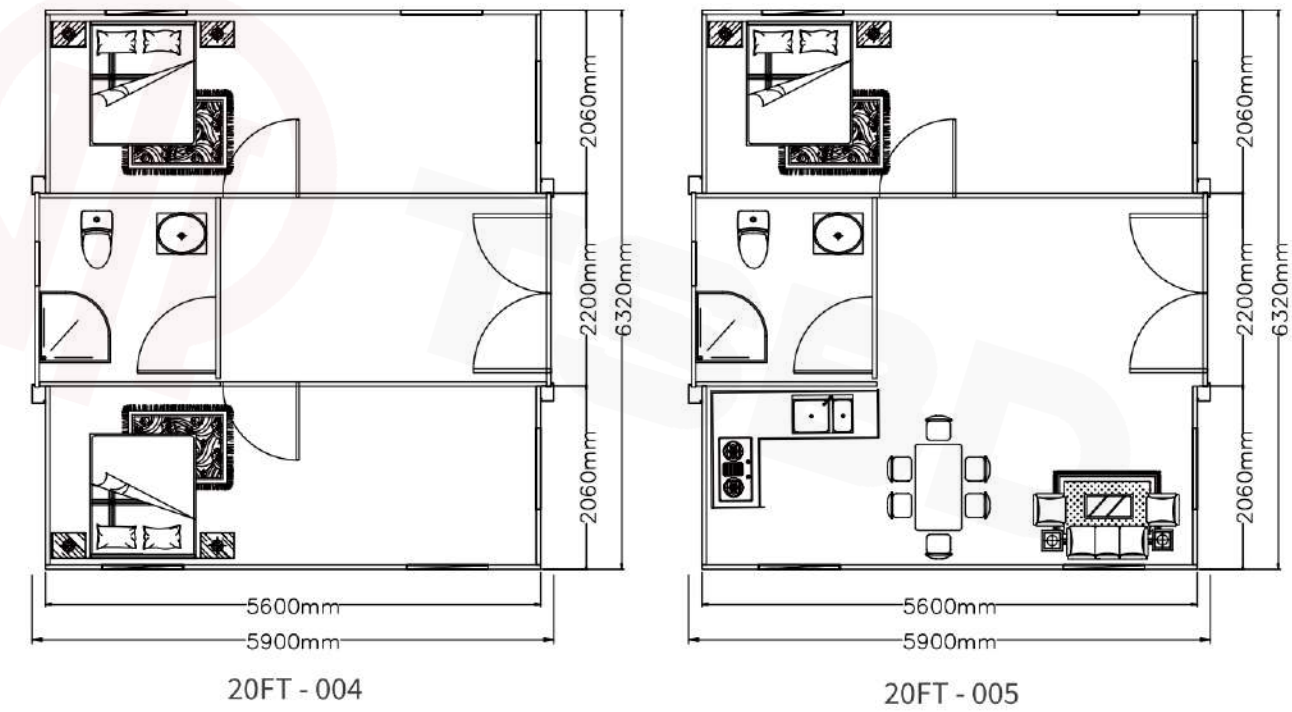
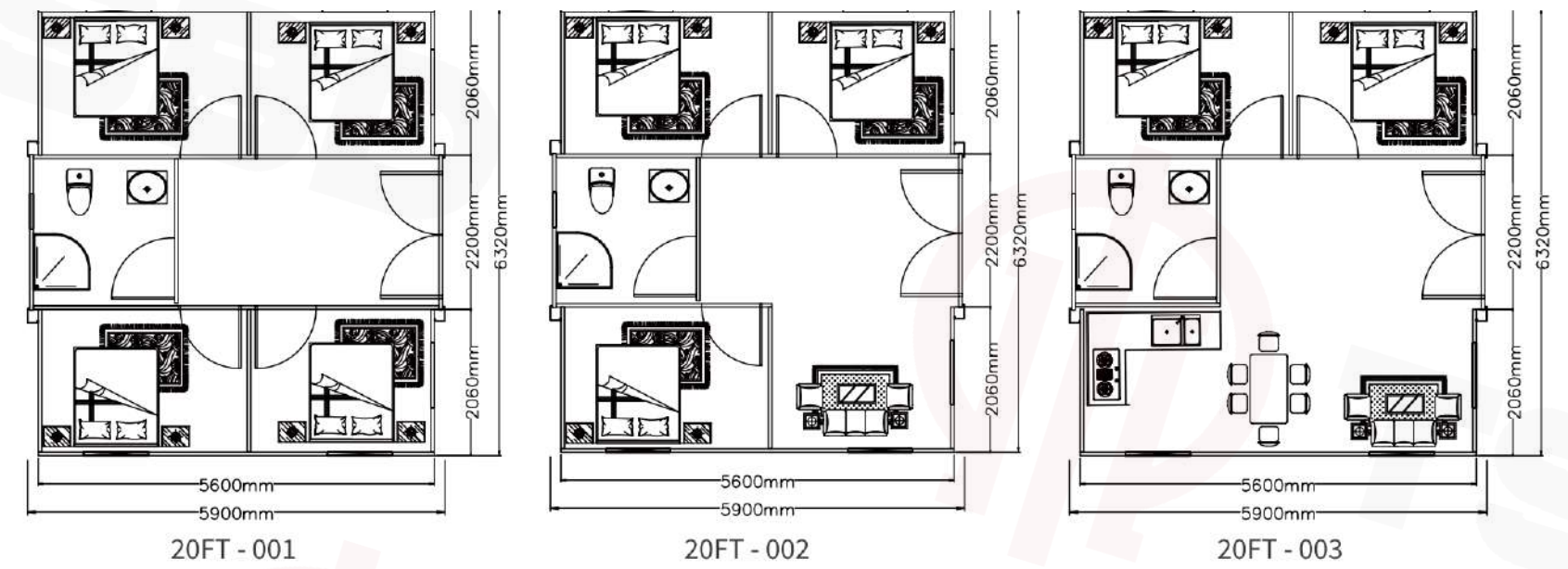

30FT

BASIC CHARACTERISTICS

External Dimensions(mm):

L9000*W6220*H2480mm

Internal Dimensions(mm):

L8540*W6060*H2240mm

Folded Dimensions(mm):

L9000*W2200*H2480mm

Total weight (kg):

Approximately 4250

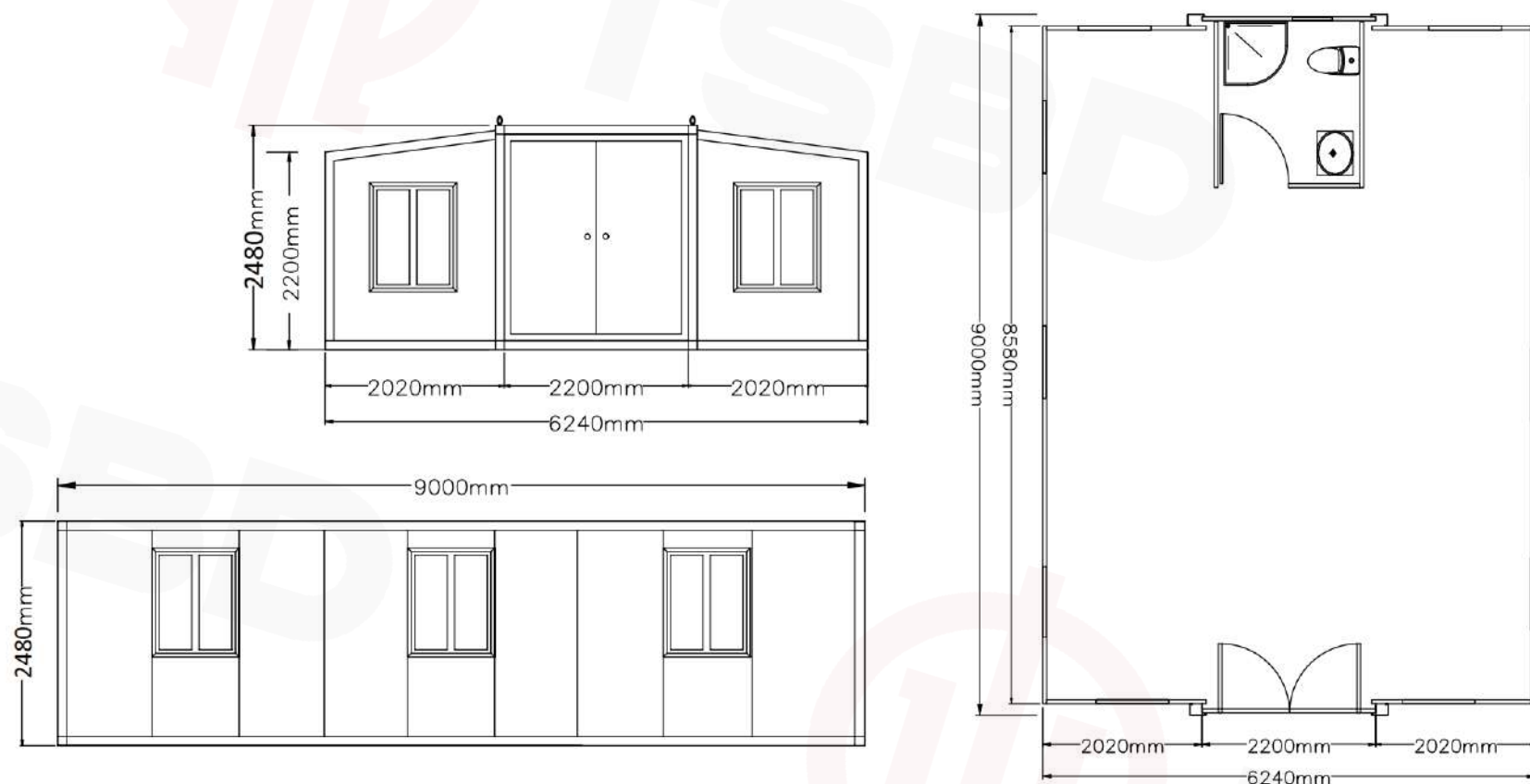

30FT LAYOUT

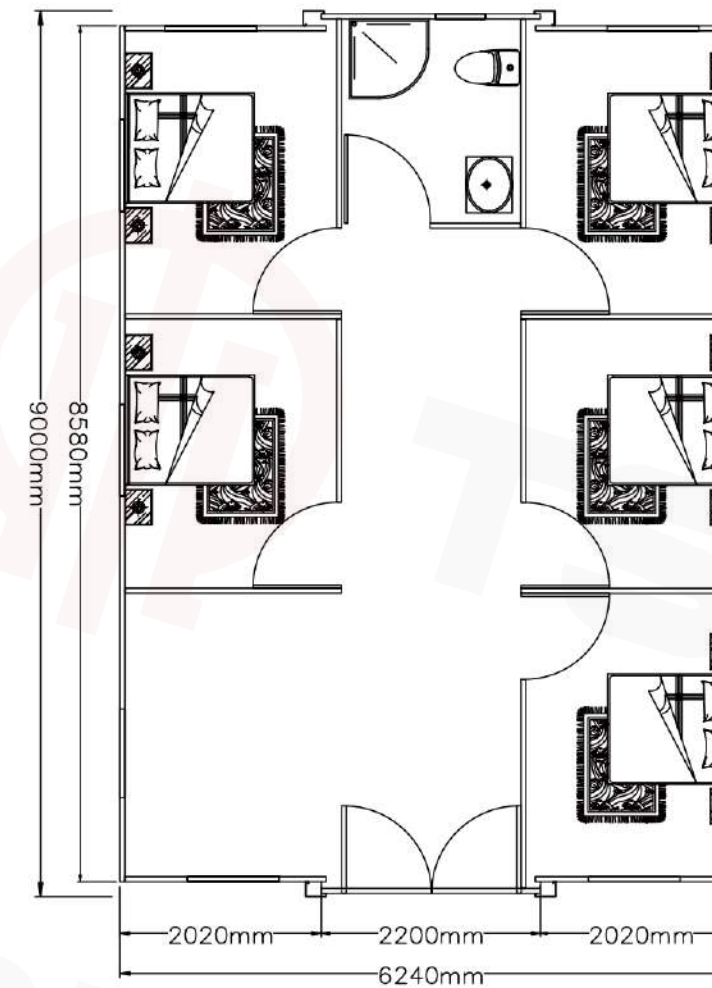

30FT - 001

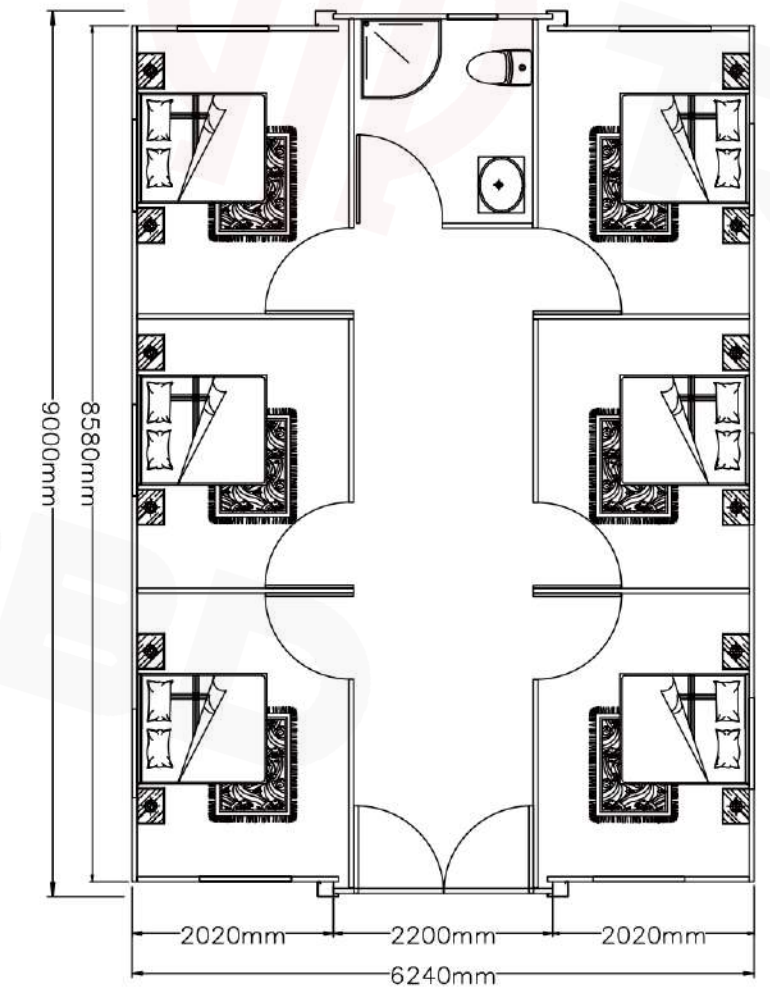

30FT - 002

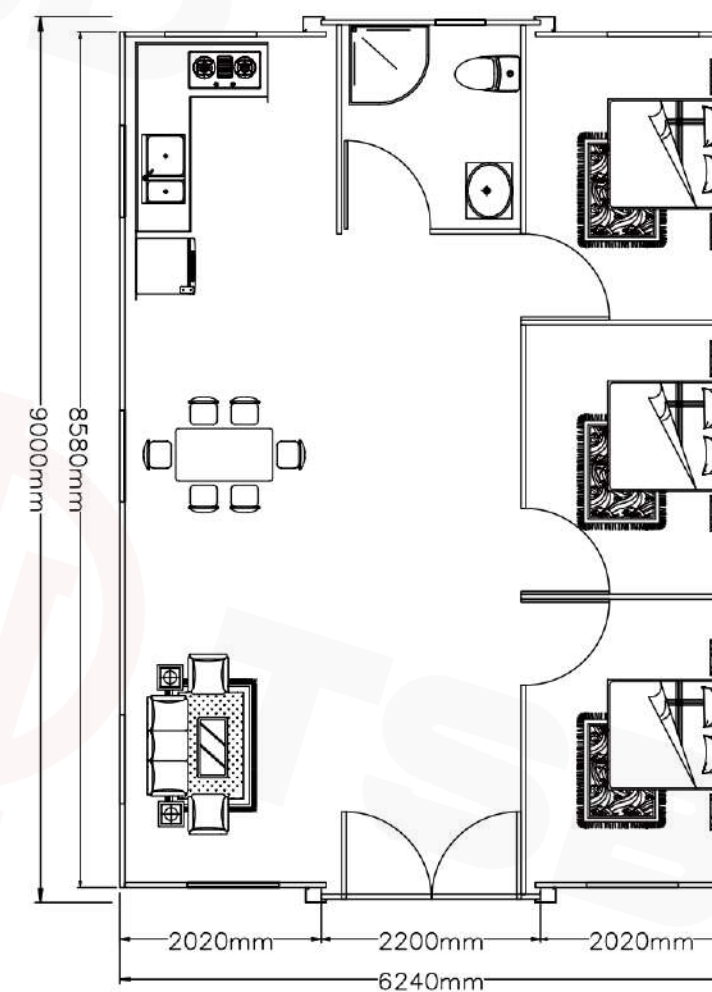

30FT - 003

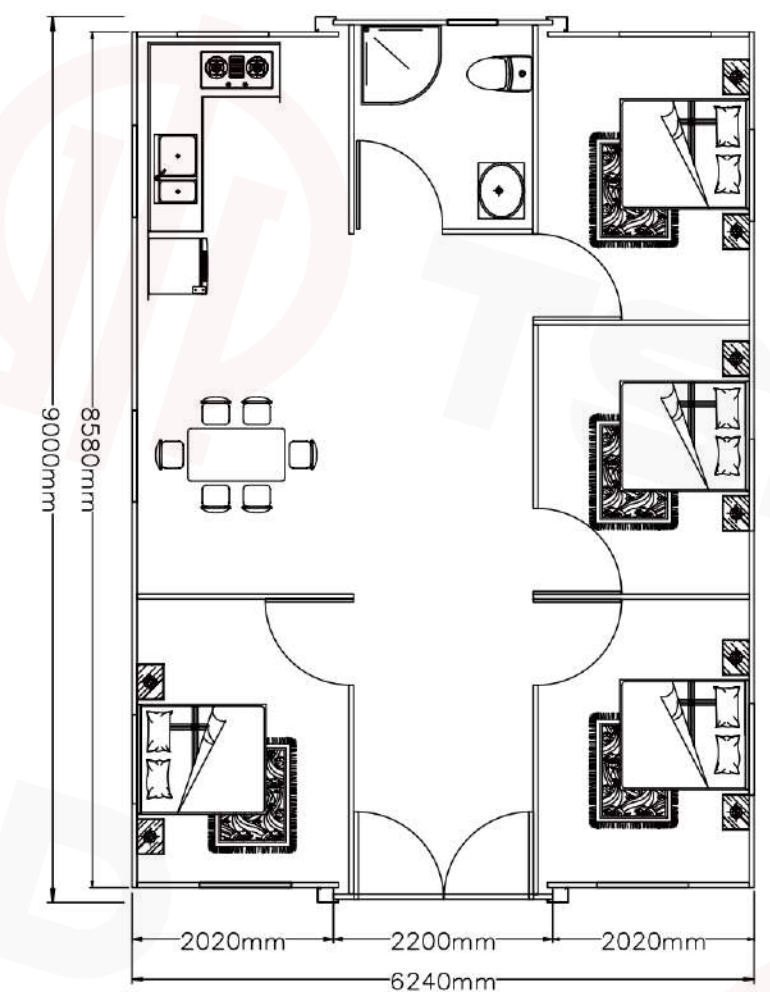

30FT - 004

40FT

BASIC CHARACTERISTICS



External Dimensions(mm):

L11800*W6220*H2480mm

Internal Dimensionss(mm):

L11540*W6060*H2240mm

Folded Dimensions(mm):

L11800*W2200*H2480mm

Total weight (kg):

Approximately 5300

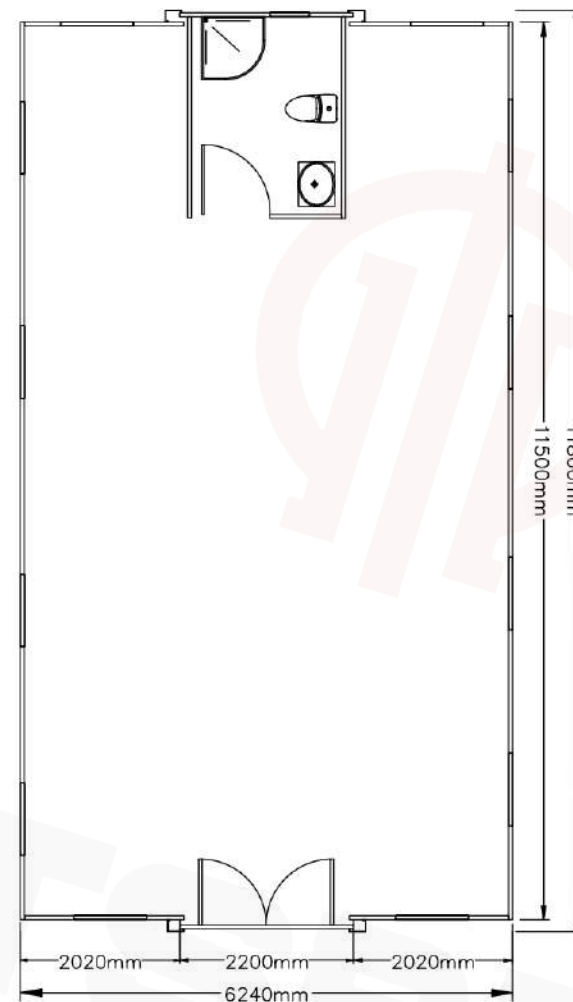
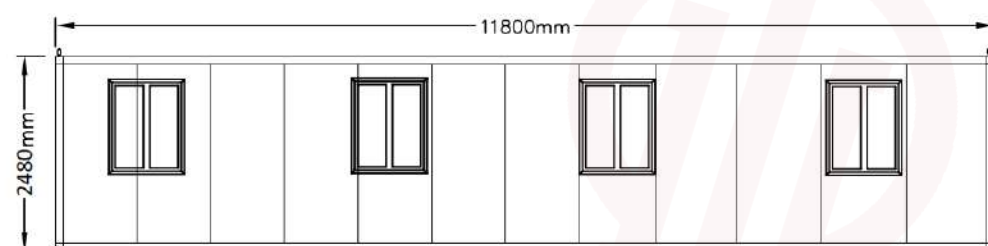
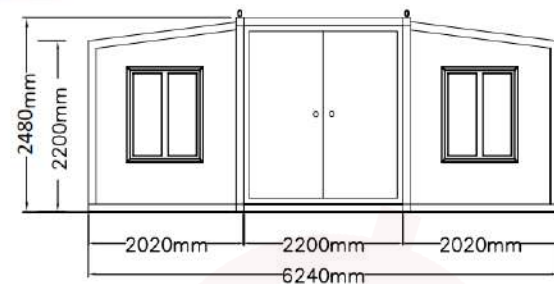

40FT LAYOUT

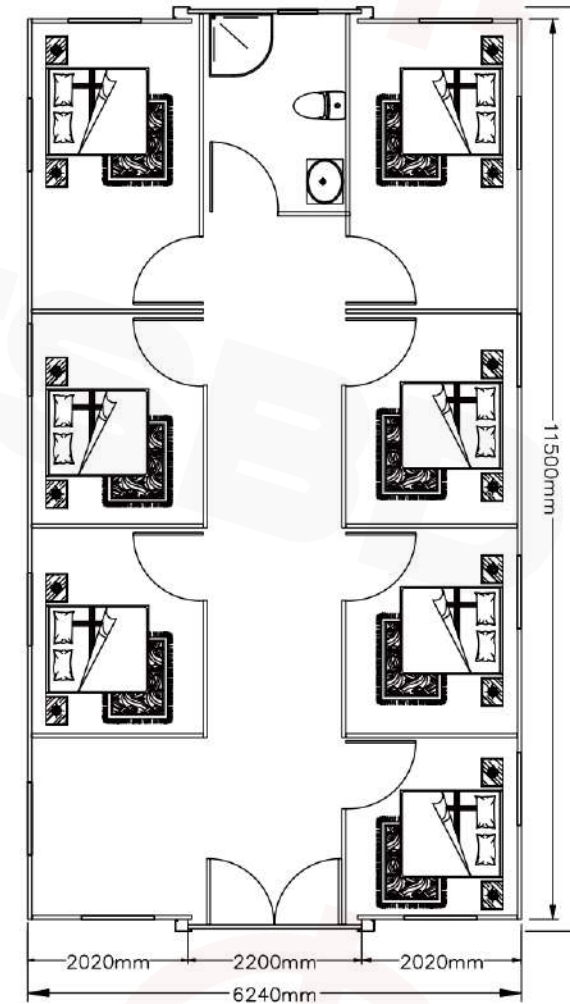

40FT - 001

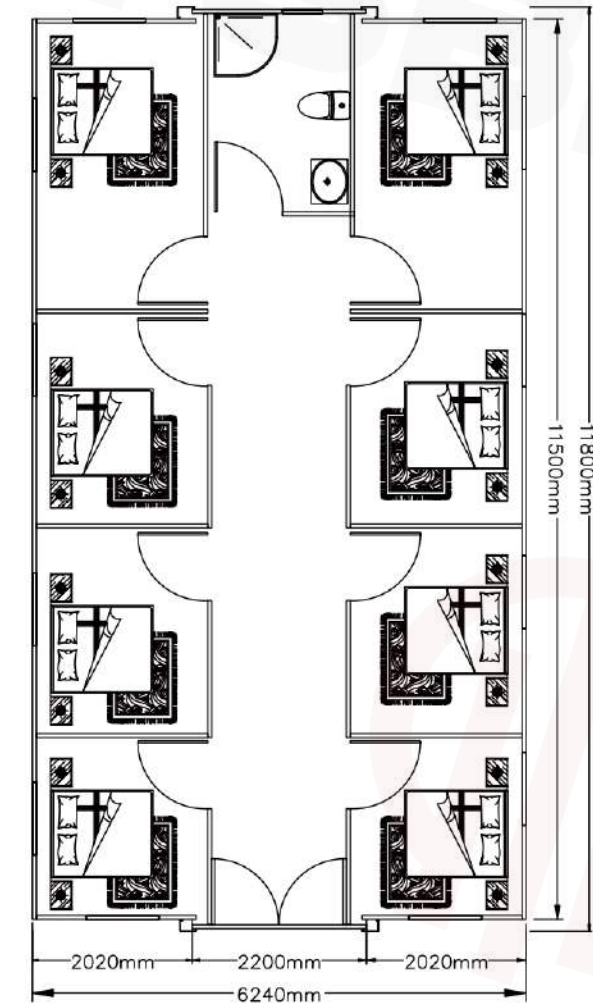

40FT - 002

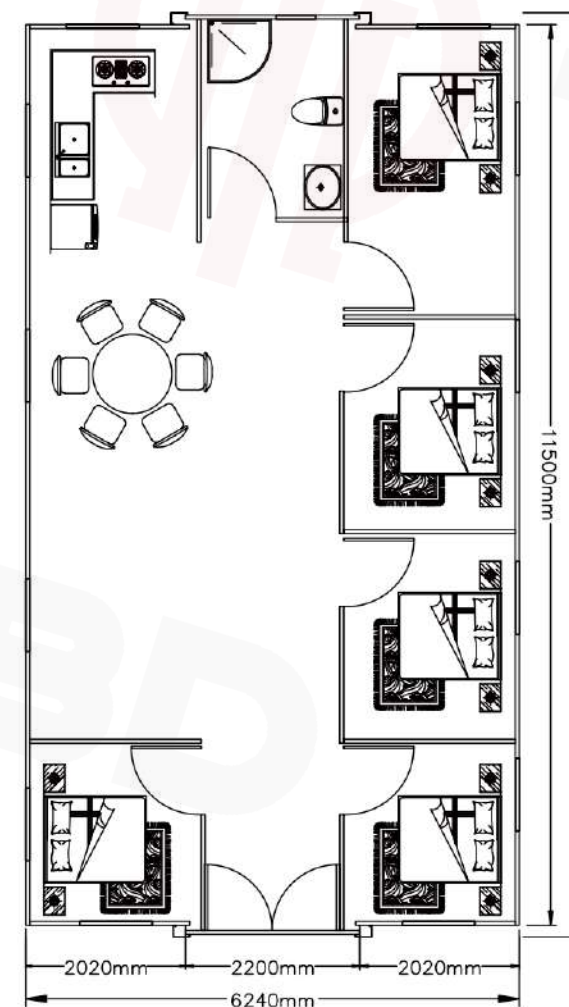

40FT - 003

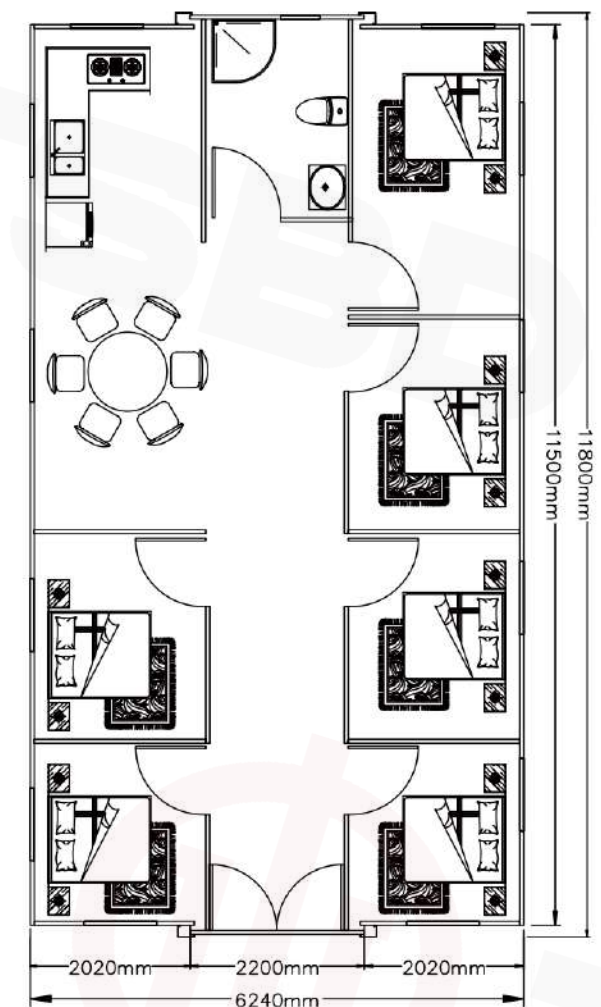

40FT - 004

40FT LAYOUT

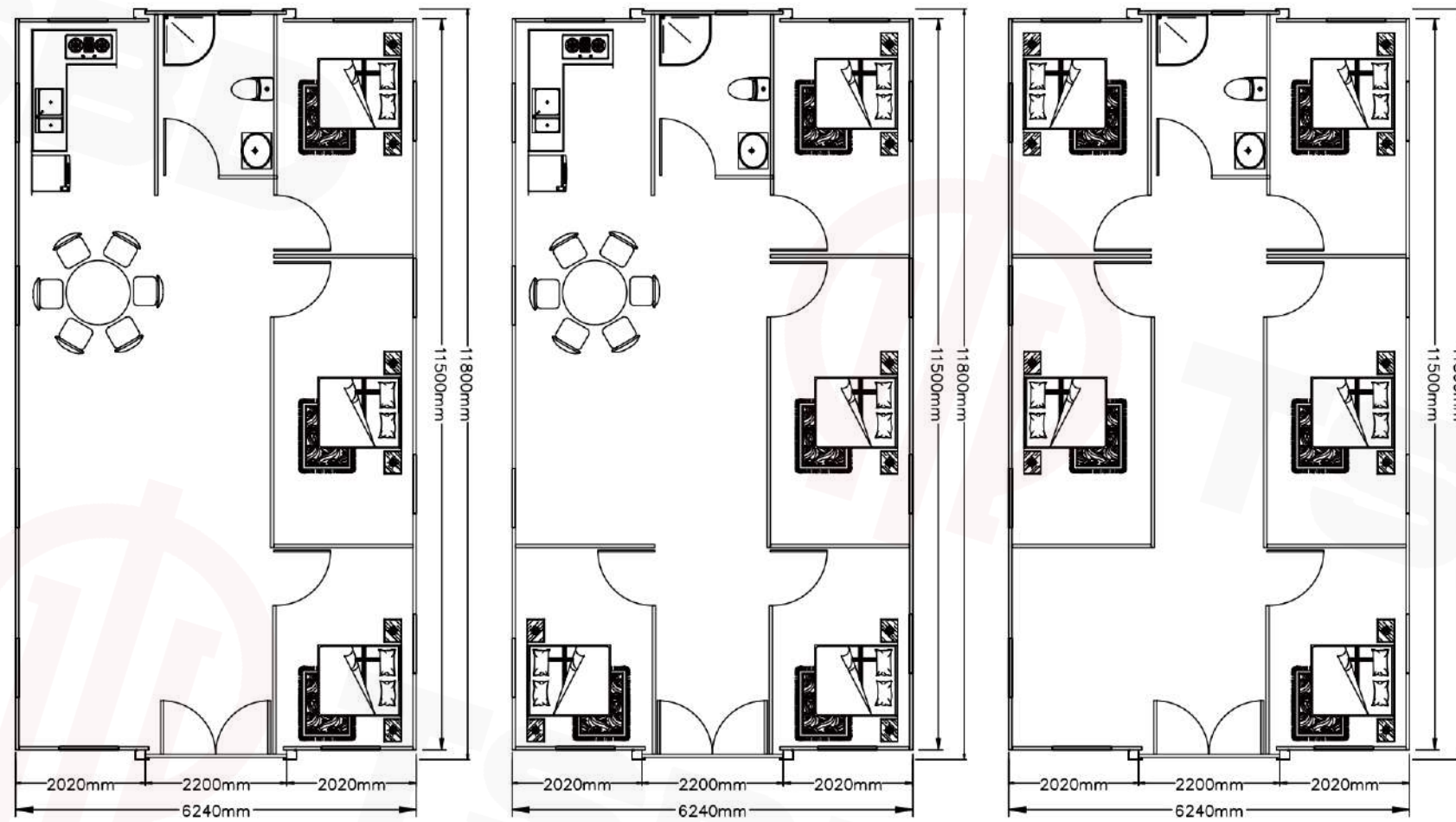

40FT - 005

40FT - 006

40FT - 007

40FT LAYOUT

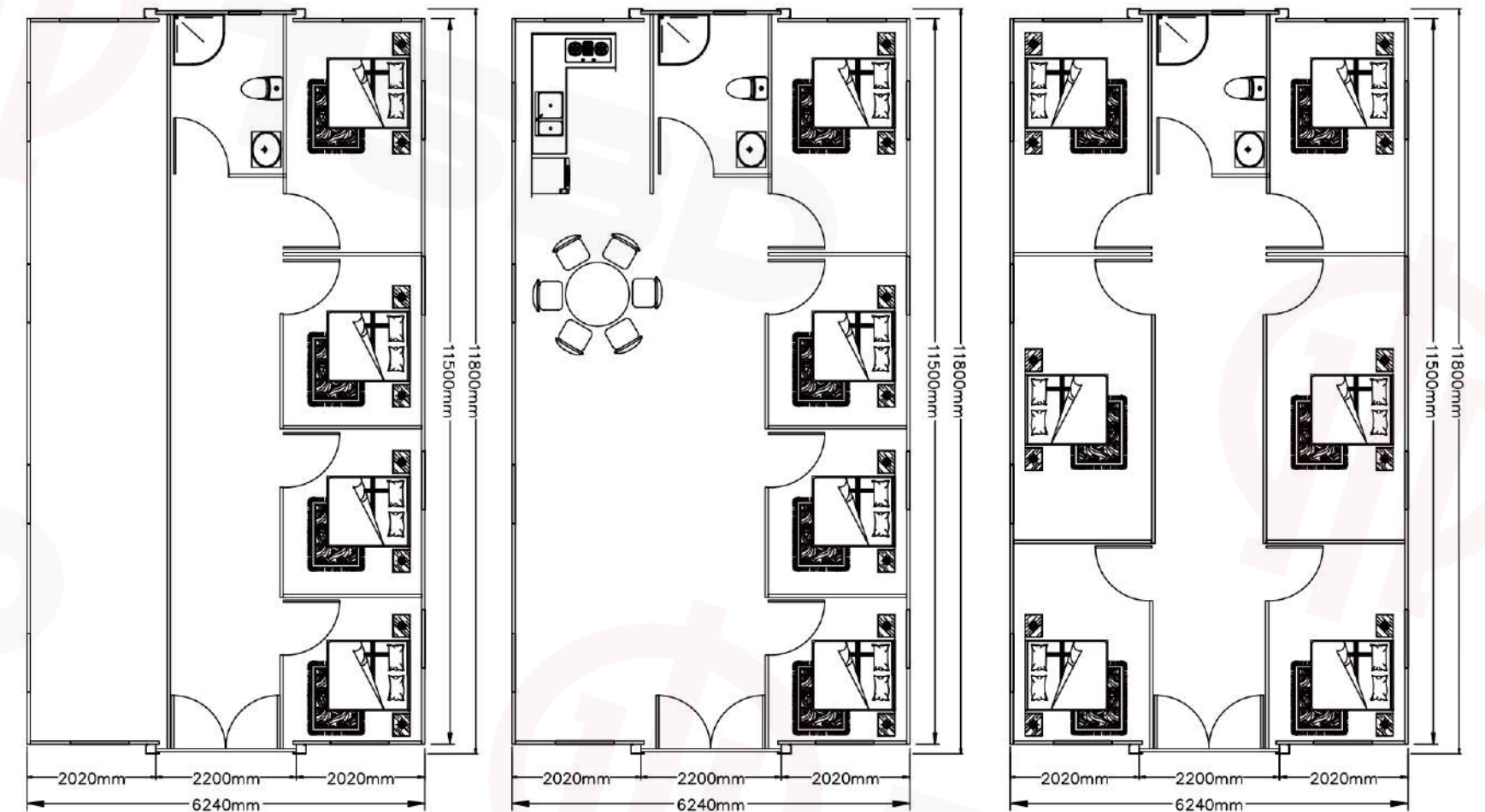

40FT - 010

40FT - 011

40FT - 012

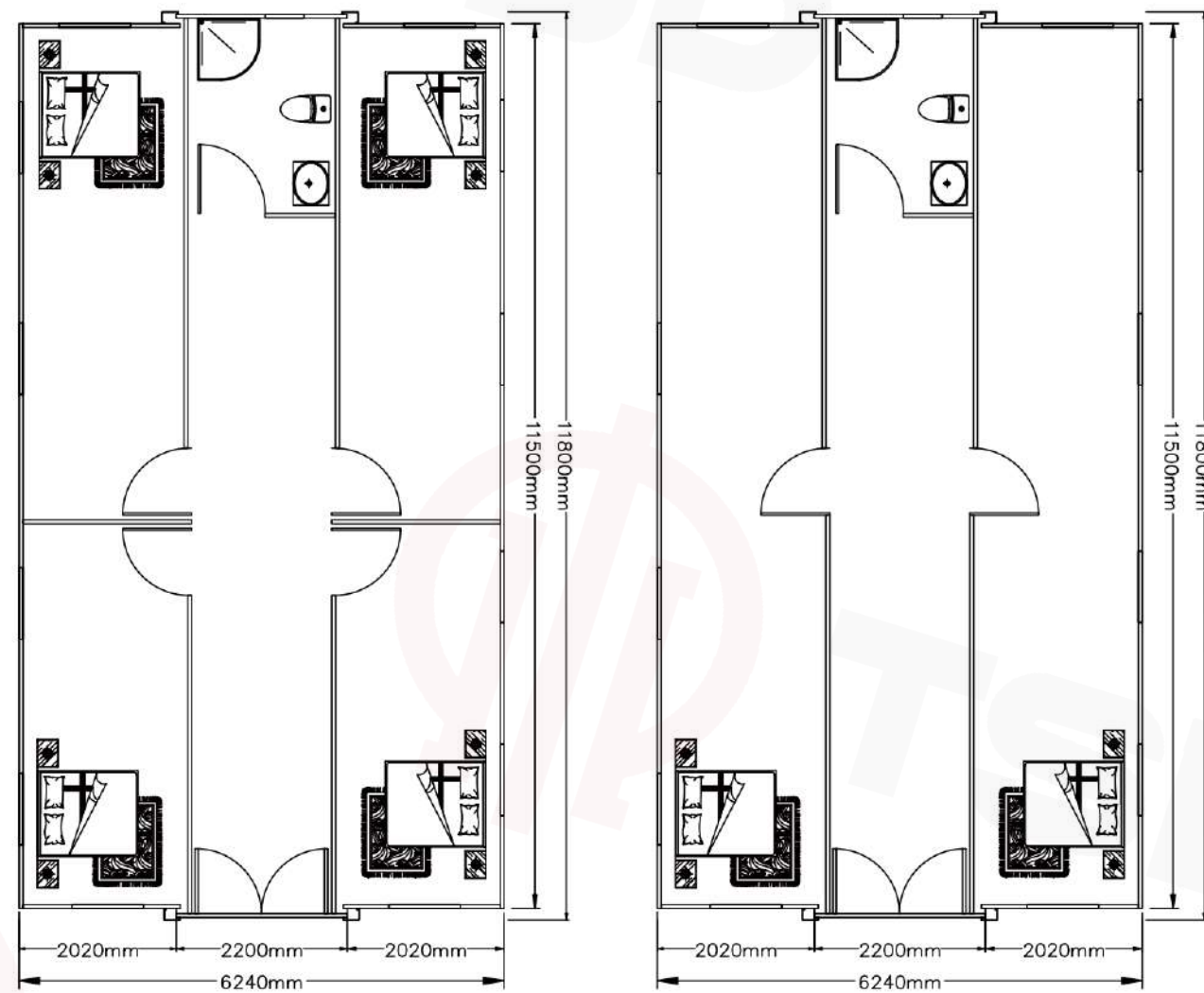

40FT - 008

40FT - 009

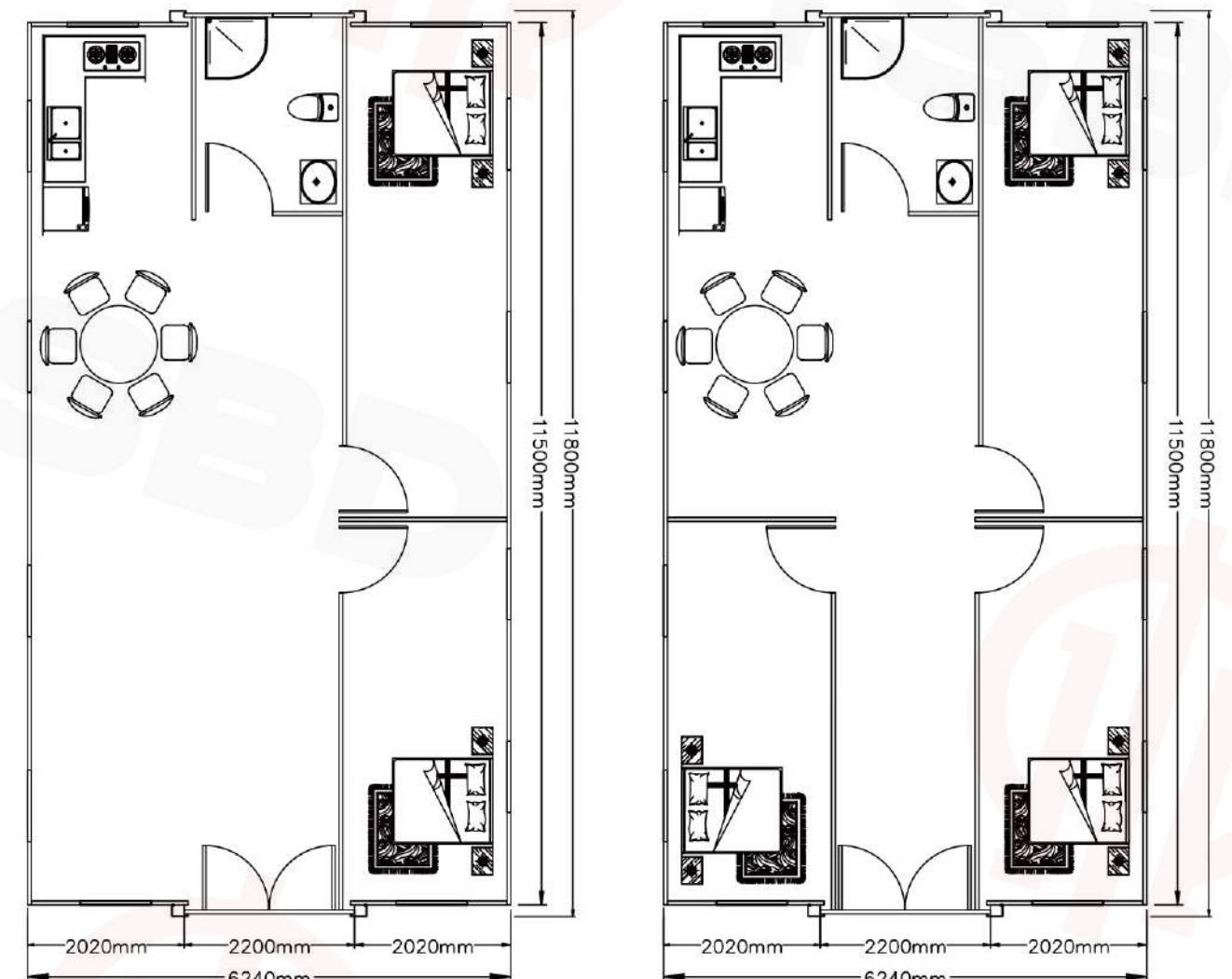

40FT - 013

40FT - 014

20FT MINI

BASIC CHARACTERISTICS

External Dimensions(mm):

L5900*W4800*H2480mm

Internal Dimensions(mm):

L5460*W4640*H2240mm

Folded Dimensions(mm):

L5900*W700*H2480mm

Total weight (kg):

Approximately 2100

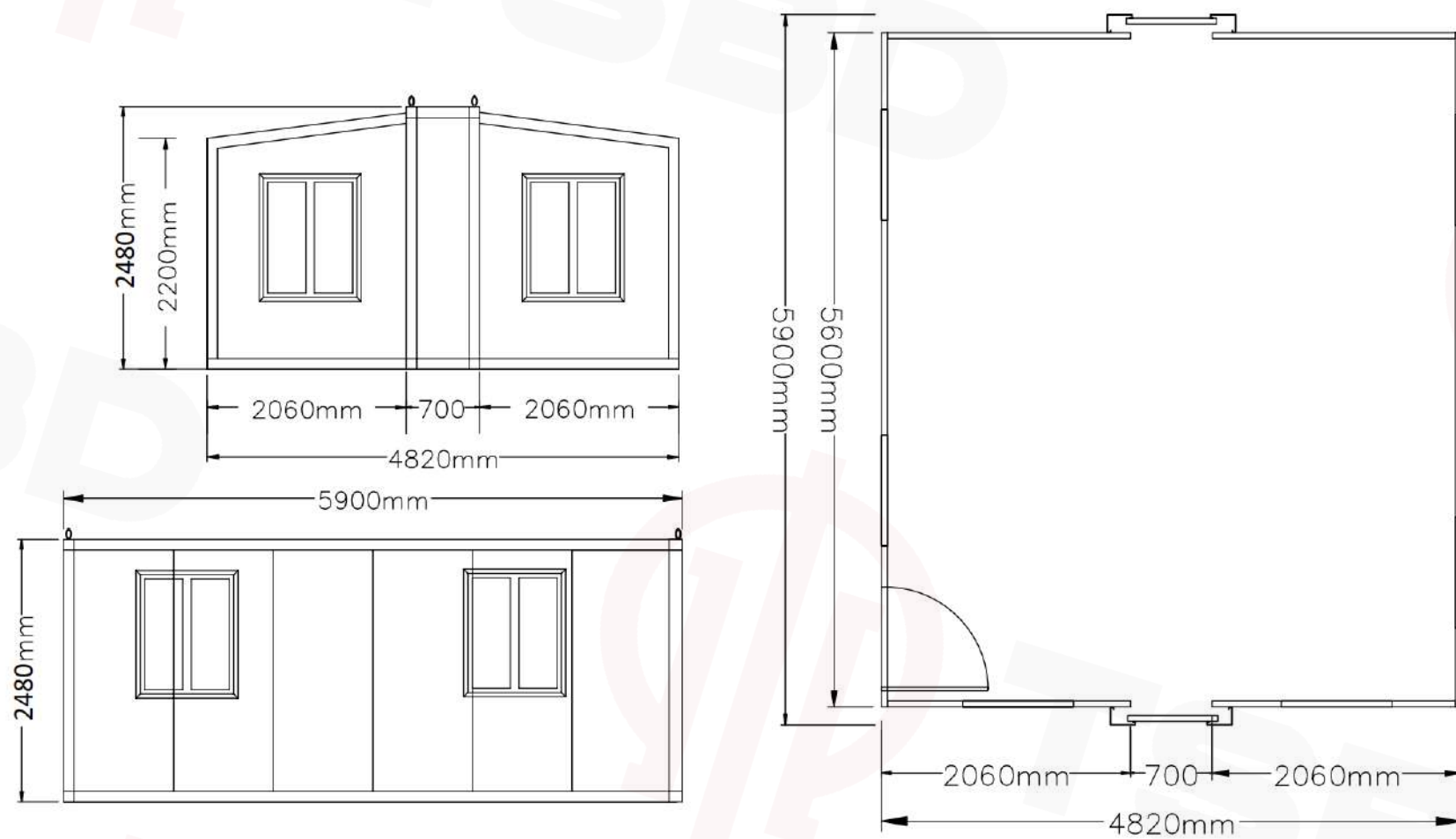

20FT MINI LAYOUT

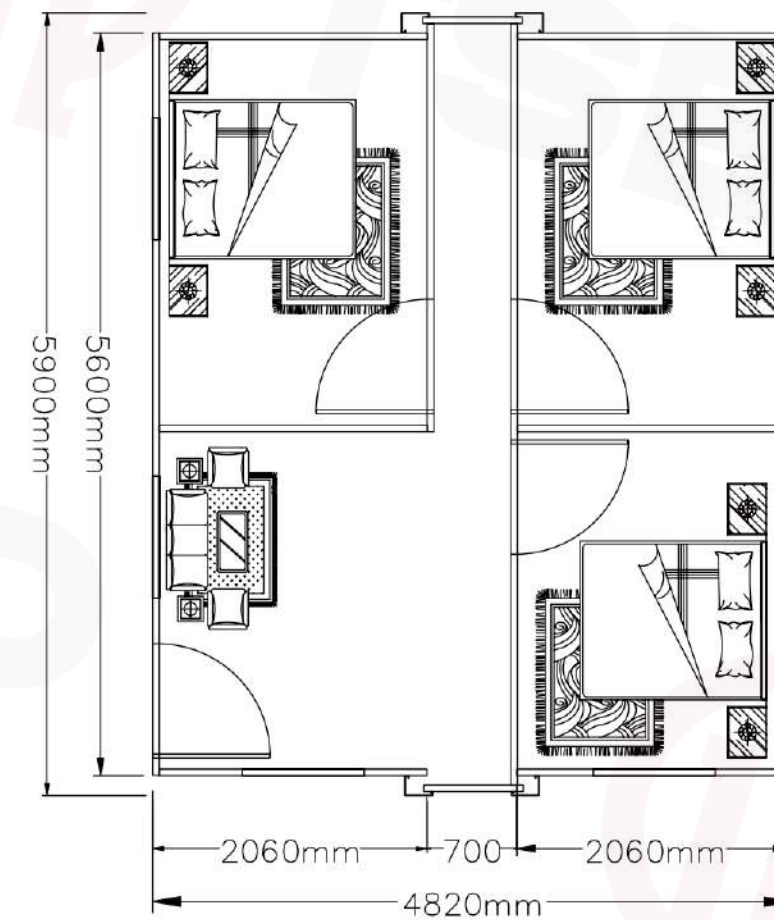

20FT MINI - 001

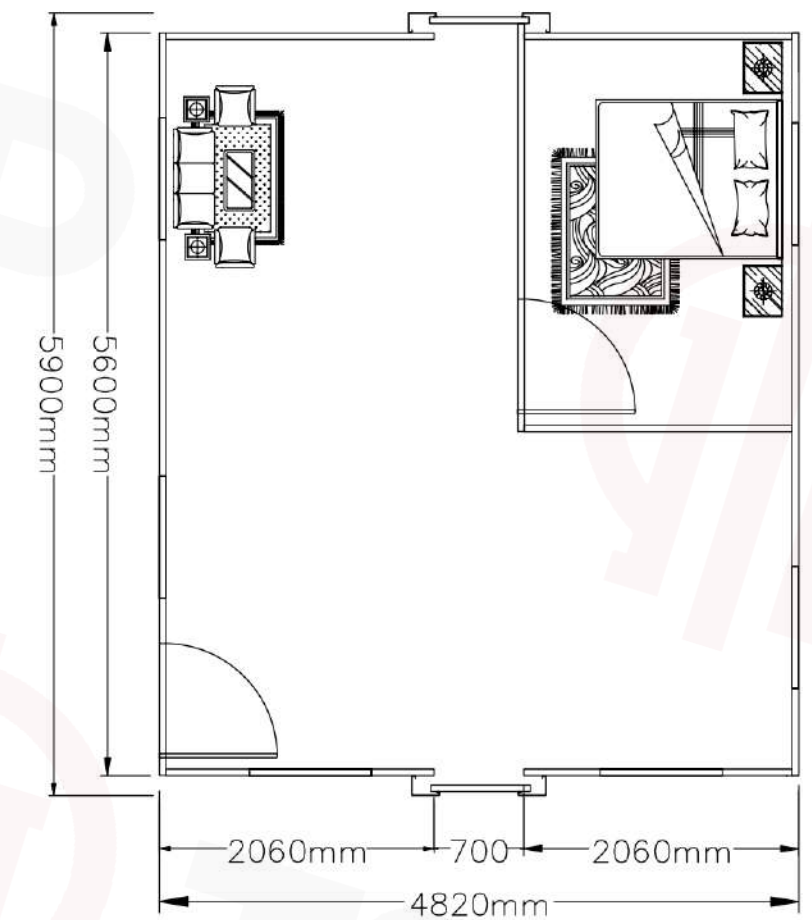

20FT MINI - 002

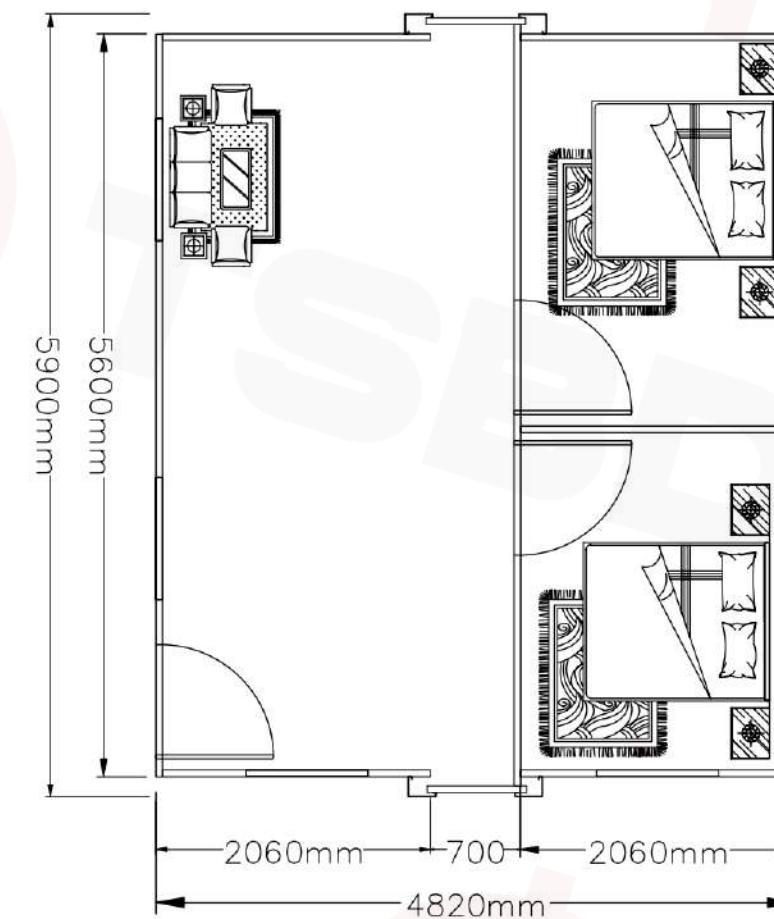

20FT MINI - 003

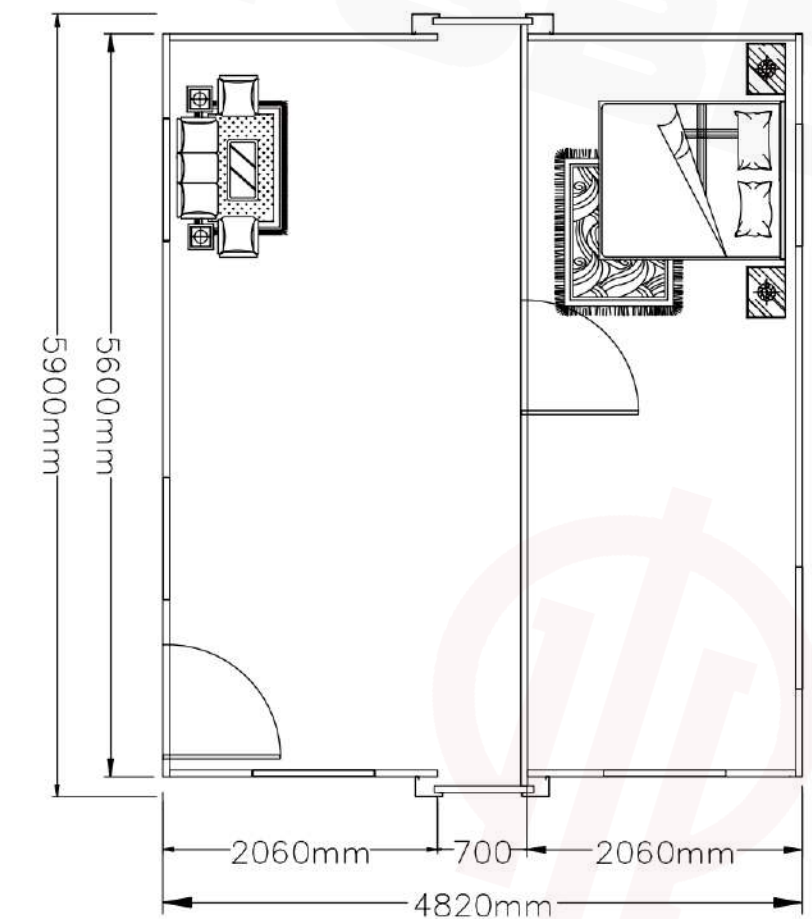

20FT MINI - 004

OPTIONAL ACCESSORY

EXTERIOR WALL PANEL COLOR

The number of other colors can be customized



Chicken-wing-wood wall panel



Brown wood grain wall panel



White wall panel



Black gray wall panel



White oak wall panel



STEEL FRAME COLOR



S1



白
White

S2



户外白高光
White Gloss

S3

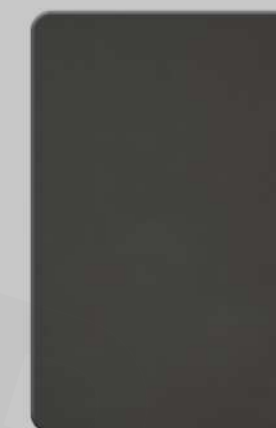

灰
Gray

S4



灰高光
Gray Gloss

S5

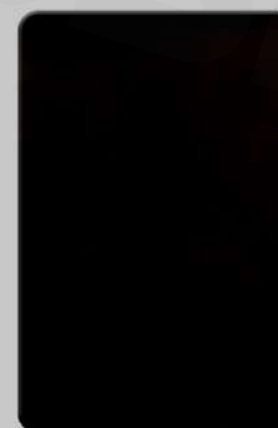

黑高光
Black Gloss

EXTERIOR WALLS

Decorable metal carved panels

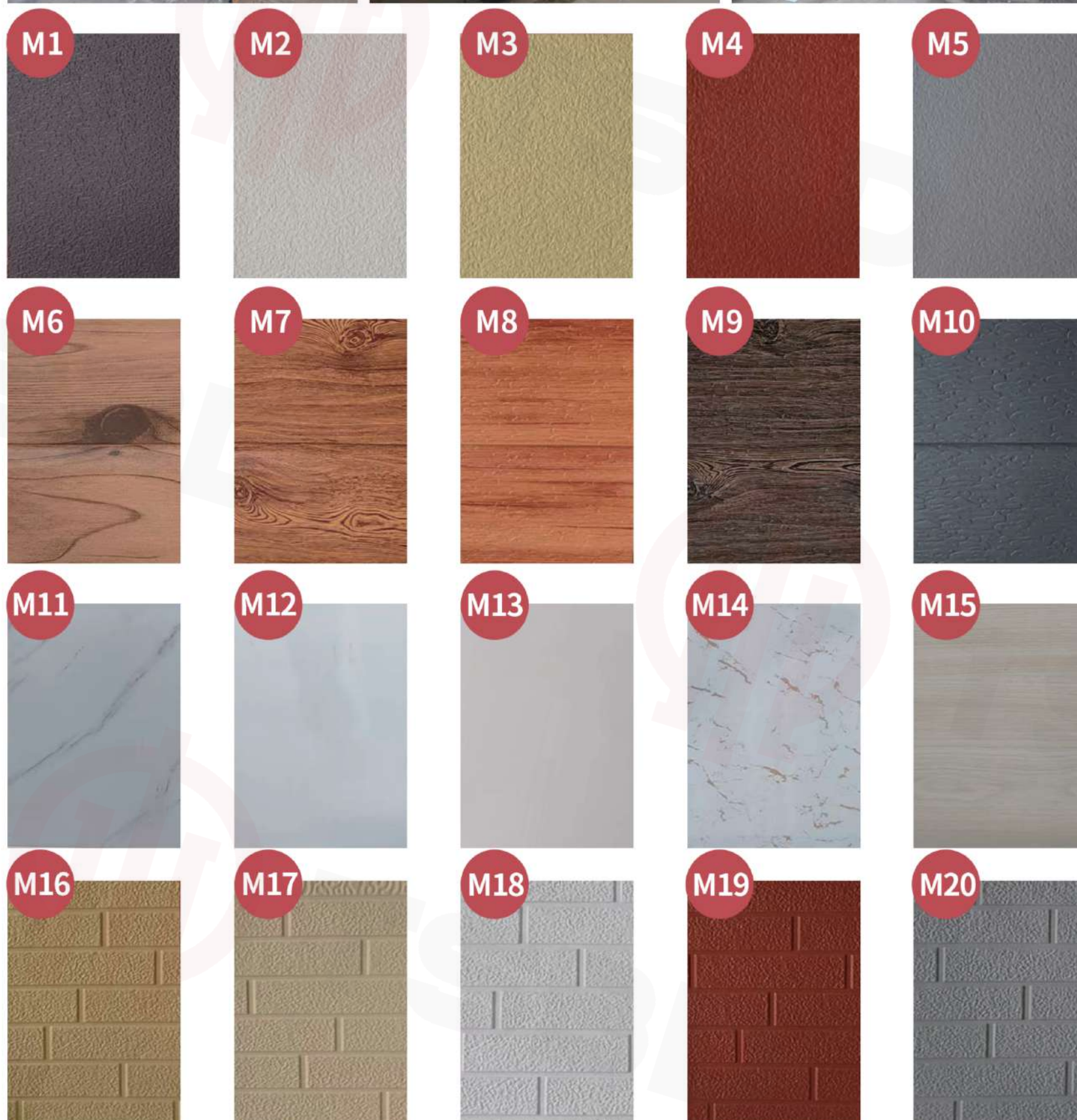

INTERIOR WALL BOARD

bamboo and wood fiberboard



Advantages of bamboo wood fiber board

- 1. Easy to clean:** the treated appearance is easy to clean and sanitary, can be directly wiped with water, no blistering and deformation.
- 2. Fashionable and elegant:** rich and diverse types, many colors, can be designed and matched according to personal preferences, elegant and exquisite.
- 3. Time saving:** using ordinary buckle board device, it can be directly folded, spliced and overlapped, easy to install and reduce decoration time.
- 4. Super sound insulation:** the sound insulation effect reaches twenty-nine decibels, which is similar to the real wall, making the room quiet and comfortable.
- 5. Super hardness:** made by using original ecological bamboo wood fiber to improve hardness, anti-collision, anti-friction and not easy to scratch.

PLASTIC FLOORING



SPC FLOORING



SKIRTING BOARD

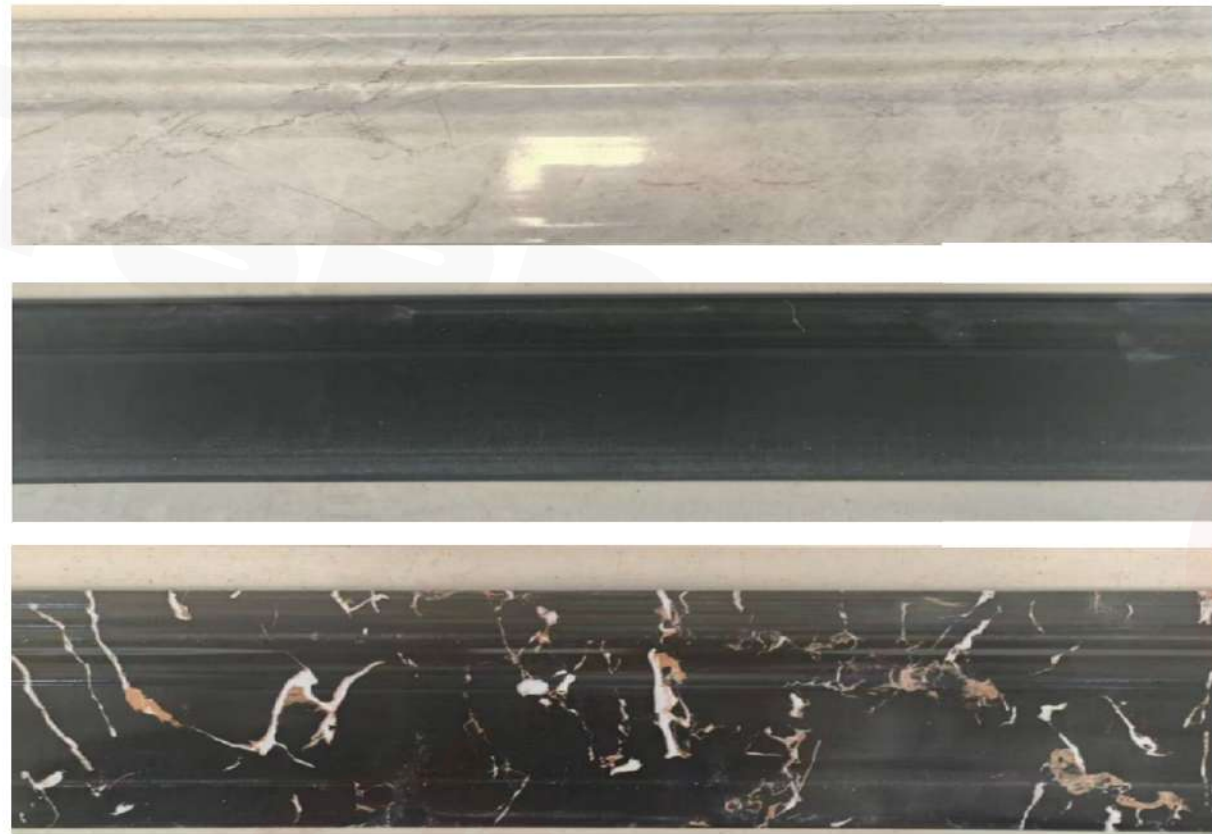

UV BOARD

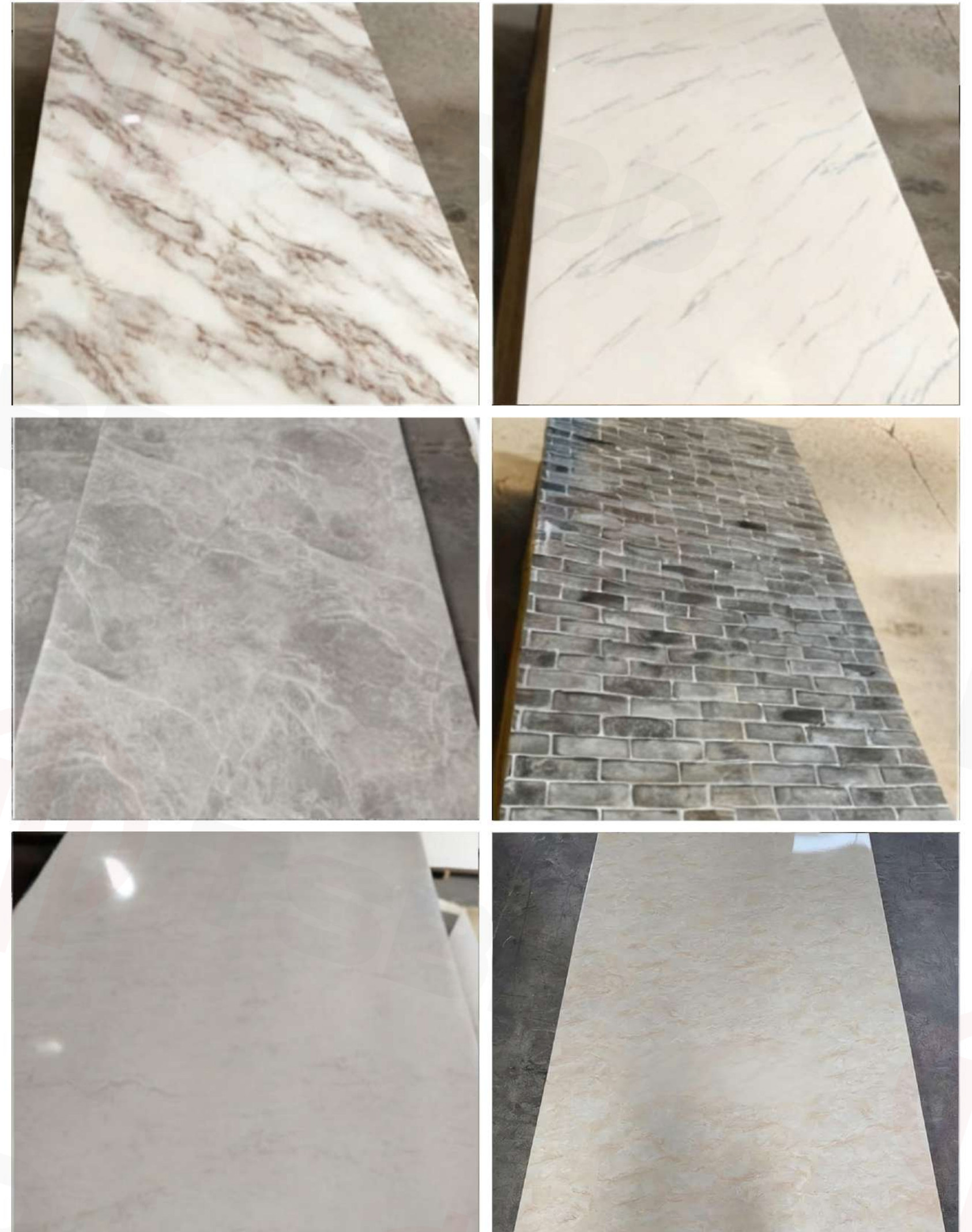

DOOR



BALCONY



WOOD PLASTIC COMPOSITES

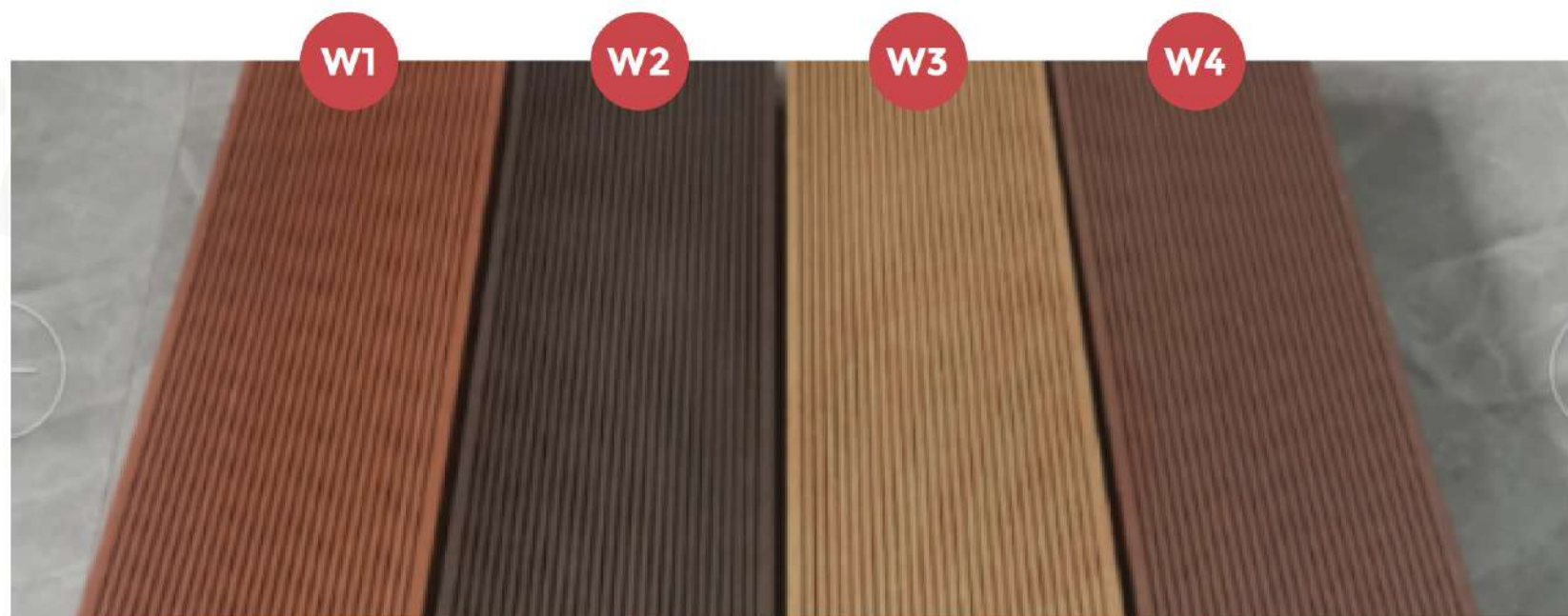

INTERIOR FINISH

L-SHAPED CABINET

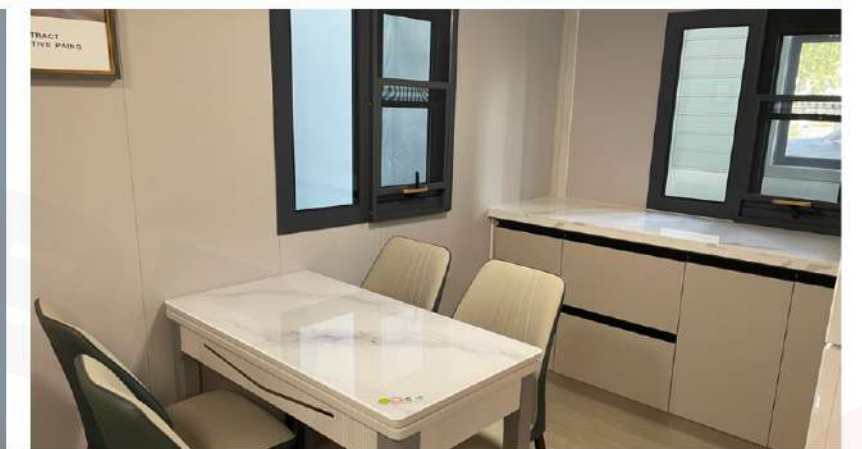
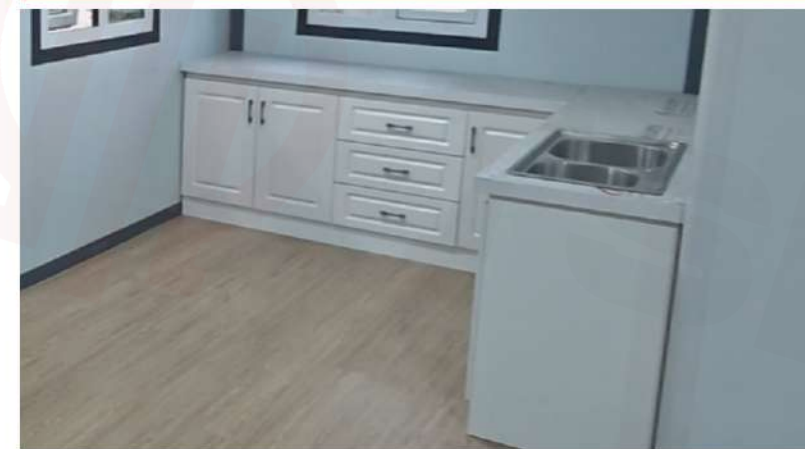

TOILET



Acrylic Bathroom

Acrylic Bathroom



Marble Bathroom

20FT mini dedicated integrated bathroom

DOOR



Aluminum Alloy



KFC door



Brige-Cut Aluminum (black)



Steel door(white)

WINDOW



UPVC



Brige-Cut Aluminum (black)



Brige-Cut Aluminum (white)

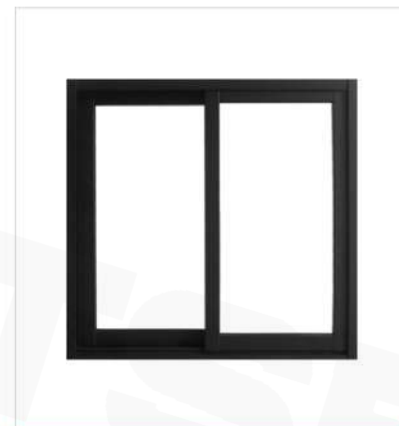

Aluminum Alloy

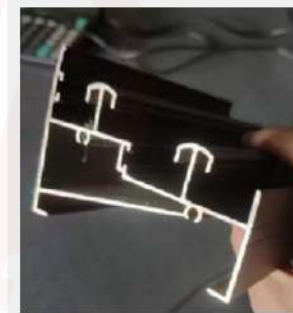

Non-broken bridge structure
 1. Poor sound insulation
 2. Poor heat insulation



broken bridge structure
 1. Excellent sound insulation
 2. Excellent heat insulation effect

POWER CONFIGURATION



AU STANDARD



US STANDARD



EUR STANDARD



UK STANDARD

OPTIONAL



Refrigerator



Water heater



Brige-Cut Aluminum (black)



Closet

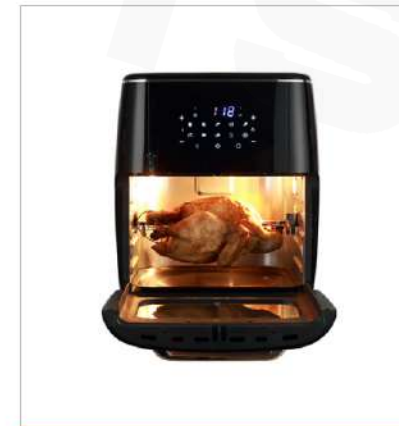

Oven



Air fryer

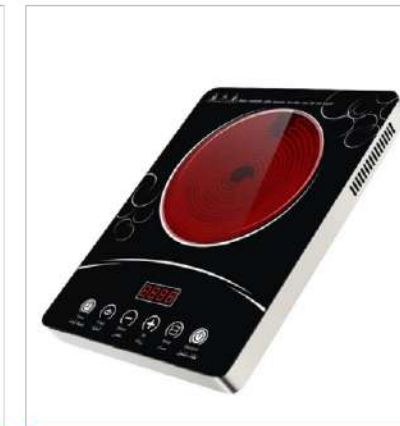

Electric Stove



Louver curtain



Toilet



Bathroom sink



Bathroom sink



Bathroom sink



Cabinet



Cabinet



Cabinet



Cabinet

EXPANDABLE CONTAINER HOUSE

THE SPECIFICATIONS OF THE 20FT EXPANDABLE CONTAINER HOUSE

Name	Specification	Size
Basic Features	External dimensions(mm)	W6300*L5900*H2480
	Internal dimensions(mm)	W6140*L5640*H2260
	Folding state(mm)	W2200*L5900*H2480
	Total weight (kg)	2500
Frame Structure	Roof beam	T2.5mmQ235B
	Insole beam	T2.5mmQ235B
	End side beam	T2.5mmQ235B
	Center column	T2.5mmQ235B
	Side wall frame	T2.0mmQ235B
	Secondary frame	T2.0mmQ235B
	Hanging head	T4mmQ235B
	Folding hinge	13mm galvanized hinge
	Overall frame protective coating	Electrostatic spray/straight white plastic powder
	Top and bottom of middle cabinet	80*100*2.5mm square tube
Side cabinet top and bottom	40*60*2.0 mm square tube	
Top of Box	External top plate	T0.5mm galvanized sheet
	Internal ceiling	T0.35mm 831 type internal ceiling
Wallboard	Middle roof insulation	T65mm high strength EPS, steel plate or T65mm glass wool
	Side wall, front and rear wall panels	T65mm high strength EPS, steel plate or T65mm glass wool
	Internal partition	T65mm high strength EPS, steel plate or T65mm glass wool
	Internal toilet	1700*1500(can adjusted size)

EXPANDABLE CONTAINER HOUSE

Name	Specification	Size
Floor	Central part	Fireproof glass magnesium floor (15mm)
Electrical System	Electrical wiring, installation in strict accordance with moisture-proof specifications, all electrical products must meet CE certification. Connection circuit according to circuit engineering specifications, indoor: 2 LED lights, 2 ceiling lights, 5 single socket 3, single socket 1, 10 socket 3, air conditioning socket 1, 20A leakage protector Voltage: 220V,50HZ. can do American standard, European standard, Italian standard, Australian standard and other national standard sockets and voltages.	
Security Doors	1SET (can adjustable door size and quantity and position)	
Windows	8pieces (920*920mm)	
Service Life	1 years	
Fire rating	Rate A	
Seismic grade	Grade 8	
Wind resistance level	Level 10	

EXPANDABLE CONTAINER HOUSE

THE SPECIFICATIONS OF THE 40FT EXPANDABLE CONTAINER HOUSE

Name	Specification	Size
<i>Basic Features</i>	External dimensions(mm)	W6300*L11800*H2480
	Internal dimensions(mm)	W6140*L11460*H2260
	Folding state(mm)	W2200*L11800*H2480
	Total weight (kg)	5000
<i>Frame Structure</i>	Roof beam	T2.5mmQ235B
	Insole beam	T2.5mmQ235B
	End side beam	T2.5mmQ235B
	Center column	T2.5mmQ235B
	Side wall frame	T2.0mmQ235B
	Secondary frame	T2.0mmQ235B
	Hanging head	T4mmQ235B
	Folding hinge	13mm galvanized hinge
	Overall frame protective coating	Electrostatic spray/straight white plastic powder
	Top and bottom of middle cabinet	80*100*2.5mm square tube
	Side cabinet top and bottom	40*60*2.0 mm square tube
<i>Top of Box</i>	External top plate	T0.5mm galvanized sheet
	Internal ceiling	T0.35mm 831 type internal ceiling
<i>Wallboard</i>	Middle roof insulation	T65mm high strength EPS, steel plate or T65mm glass wool
	Side wall, front and rear wall panels	T65mm high strength EPS, steel plate or T65mm glass wool
	Internal partition	T65mm high strength EPS, steel plate or T65mm glass wool
	Internal toilet	1700*1500(can adjusted size)

EXPANDABLE CONTAINER HOUSE

Name	Specification	Size
<i>Floor</i>	Central part	Fireproof glass magnesium floor (15mm)
<i>Electrical System</i>	Electrical wiring, installation in strict accordance with moisture-proof specifications, all electrical products must meet CE certification. Connection circuit according to circuit engineering specifications, indoor: 2 LED lights, 2 ceiling lights, 5 single socket 3, single socket 1, 10 socket 3, air conditioning socket 1, 20A leakage protector Voltage: 220V,50HZ. can do American standard, European standard, Italian standard, Australian standard and other national standard sockets and voltages.	
<i>Security Doors</i>	1SET (can adjustable door size and quantity and position)	
<i>Windows</i>	10pieces (920*920mm)	
<i>Service Life</i>	1 years	
<i>Fire rating</i>	Rate A	
<i>Seismic grade</i>	Grade 8	
<i>Wind resistance level</i>	Level 10	