



守正创新 智启未来

HAO QUAN
PUMPS
皓泉泵业

温州皓泉泵业有限公司
Wenzhou Haoquan Pump Co., Ltd.



Wenzhou Haoquan Pump Industry Co., Ltd. is a pump - series manufacturing firm integrating R&D, production and sales. Located in Dongcheng Industrial Park, Longgang, Wenzhou, it has a prime location and convenient transport.

The company combines advanced tech with years of experience, following the spirit of "pioneering and perfecting". It builds a high - quality workforce, makes top - notch products, and offers them sincerely to customers.

Quality is seen as the core of the enterprise. There's an advanced quality inspection system and comprehensive pre - and after - sales service. Products are used widely in chemical, medical, construction and other fields, winning great favor from users.

"Quality, brand, reputation" are our constant pursuits, with customer satisfaction as our aim. We'll always focus on customers, meet market changes, cooperate sincerely with friends, and seek win - win results.

As the times progress, "Haoquan" is soaring. We welcome your visit! Friends from all sectors are welcome to visit, guide and negotiate business.

MP Series 2-7

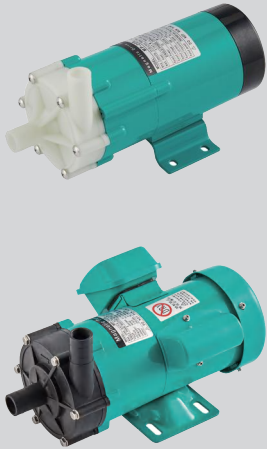

Magnetic Drive Circulating Pump

MPH Series 8-11



Corrosion Resistant Magnetic Pump

MP Series 12-13



Stainless Steel Magnetic Pump

WS Series 14-15



Brushless Magnetic Pump

DP Series 16-17



High Pressure Diaphragm Pump

DS Series 18-19



Bellows Metering Pump

HQP Series 20



Urea Diaphragm Pump

JV Series 21



Diaphragm Metering Pump

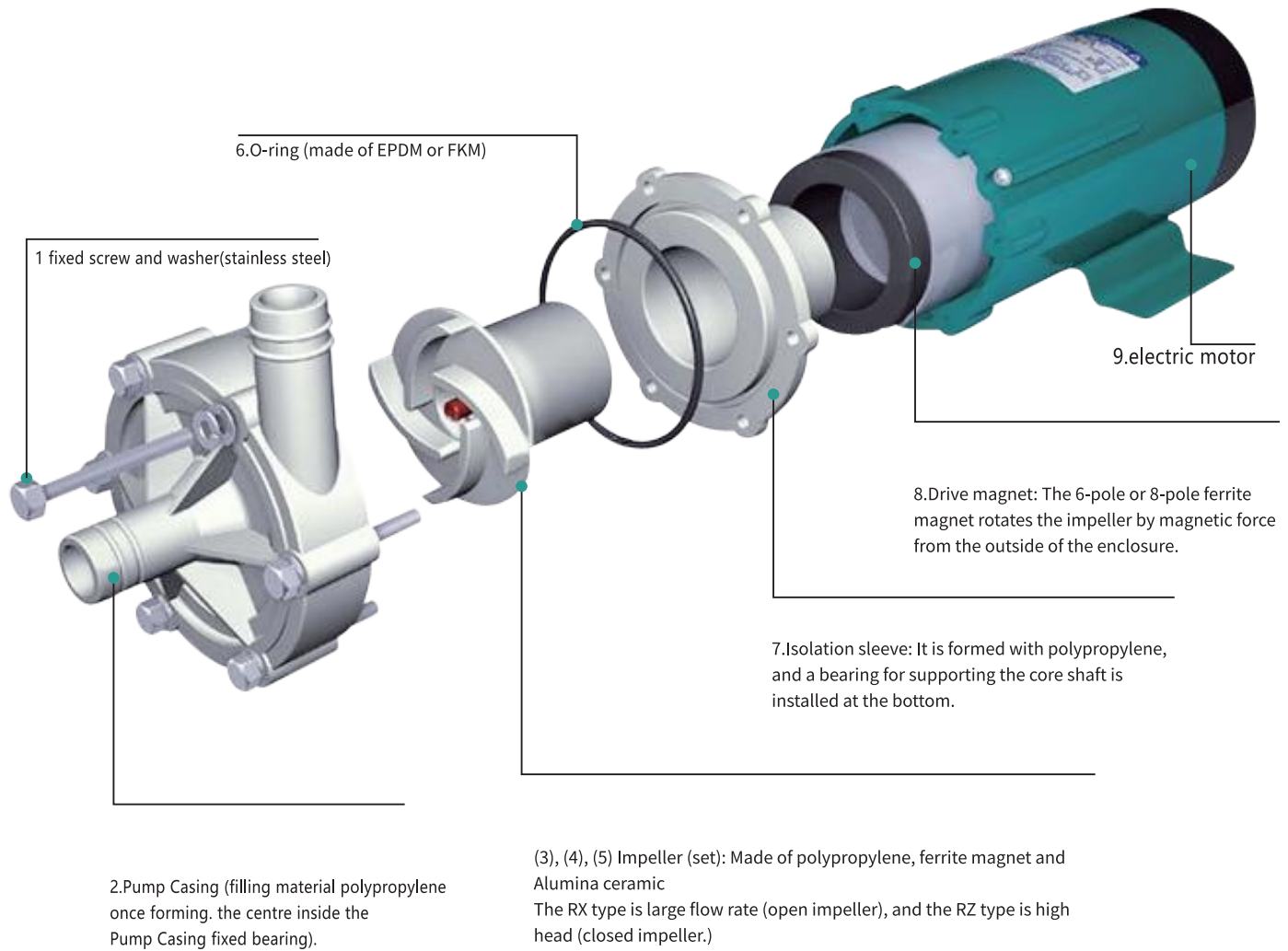

Name

- (1) Screws
- (2) Pump casing
- (3,4,5) Impeller (set)
- (6) Sealing ring
- (7) Isolation sleeve
- (8) Drive magnet
- (9) Motor

Material

- 304 Stainless steel
- Glass fiber reinforced polypropylene FRPP/PVDF/ Stainless Steel
- Glass fiber Reinforced polypropylene FRPP/PVDF/PPS(Alumina Ceramics)
- Fluorine rubber (FKM) or ethylene propylene diene (EPDM)
- Glass fiber reinforced polypropylene FRPP/PVDF/PPS
- Strontium ferrite
- Pure copper wire

MAGNTIC DRIVE CIRCULATING PUMP

The magnetic drive circulation pump has magnetic materials on the coupling shaft and impeller. It runs via their mutual attraction, needing no traditional mechanical shaft seals and featuring a fully sealed structure. This design eliminates the corrosion and pollution from liquid leakage in traditional pumps. The ceramic bearings, made with special designs and processes, are highly abrasion and corrosion resistant. Thanks to its high efficiency and quality, it's an ideal pump for industrial liquid transportation.

MODEL NOTE

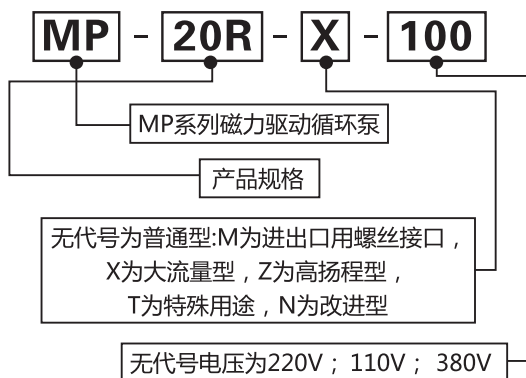

MP Series Products



MP-6R



MP-10RM



MP-10RN

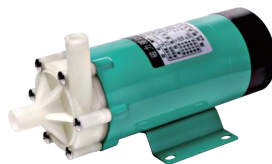

MP-15R



MP-15RM



MP-15RN



MP-20R



MP-20RM



MP-20RX



MP-20RZ



MP-20RZM



MP-30R



MP-30RM



MP-30RX



MP-30RXM



MP-30RZ



MP-30RZM



MP-40R



MP-40RM



MP-40RX



MP-40RXM



MP-55R



MP-55RM



MP-70R



MP-70RM



MP-100R



MP-100RM



MP-100RX



MP-120R

| Model | Tube interface | | Thread interface | | Max. Capacity (L/min) | Max. Head (m) | Standard capacity | | Specific gravit | Motor | |
|----------|----------------|----------------|------------------|------------------|--------------------------|------------------|----------------------------------|----------------------|--------------------|-------------------------|-------|
| | Inlet (mm) | Outlet (mm) | Inlet (inch) | Outlet (inch) | 50Hz/60Hz | 50Hz/60Hz | Capacity (L/min) 50Hz/60Hz | Head(m) 50Hz/60Hz | | Output (w) 50Hz/60Hz | Phase |
| MP-6R | 14 | 14 | - | - | 8/9 | 1/1.4 | 2.8/5 | 0.8 | <1.2 | 6 | 1 |
| MP-6RZ | 14 | 14 | - | - | 5.5/6 | 2.1/2.7 | 3.2/4.5 | 0.8 | <1.1 | 6 | 1 |
| MP-10RN | 14 | 14 | - | - | 11/12 | 1.5/2.1 | 5/8 | 1 | <1.1 | 6 | 1 |
| MP-10RM | - | - | 1/2 | 1/2 | 11/12 | 1.5/2.1 | 5/8 | 1 | <1.1 | 6 | 1 |
| MP-15R | 16 | 16 | - | - | 16/19 | 2.7/3.4 | 8/12 | 1.5 | <1.3 | 10 | 1 |
| MP-15RN | 16 | 16 | - | - | 16/19 | 2.7/3.4 | 8/12 | 1.5 | <1.3 | 10 | 1 |
| MP-15RM | - | - | 1/2 | 1/2 | 16/19 | 2.7/3.4 | 8/12 | 1.5 | <1.3 | 10 | 1 |
| MP-20R | 18 | 18 | - | - | 27/32 | 3.1/4.3 | 17/22 | 2 | <1.2 | 15 | 1 |
| MP-20RM | - | - | 1/2 | 1/2 | 27/32 | 3.1/4.3 | 17/22 | 2 | <1.2 | 15 | 1 |
| MP-20RX | 26 | 26 | - | - | 46/52 | 1.8/2.5 | 30/40 | 1 | <1.3 | 15 | 1 |
| MP-20RZ | 18 | 18 | - | - | 10/11 | 4.6/6.9 | 7/10 | 4 | <1.1 | 15 | 1 |
| MP-20RZM | - | - | 3/4 | 3/4 | 10/11 | 4.6/6.9 | 7/10 | 4 | <1.1 | 15 | 1 |
| MP-30R | 20 | 20 | - | - | 33/38 | 3.8/5.4 | 16/25 | 2.5 | <1.3 | 25 | 1 |
| MP-30RM | - | - | 3/4 | 3/4 | 33/38 | 3.8/5.4 | 16/25 | 2.5 | <1.3 | 25 | 1 |
| MP-30RX | 26 | 26 | - | - | 62/72 | 2.9/4.1 | 32/46 | 2 | <1.1 | 25 | 1 |
| MP-30RXM | - | - | 1 | 1 | 62/72 | 2.9/4.1 | 32/46 | 2 | <1.1 | 25 | 1 |
| MP-30RZ | 18 | 18 | - | - | 15/17 | 8/11 | 10/14 | 6 | <1.1 | 25 | 1 |
| MP-30RZM | - | - | 3/4 | 3/4 | 15/17 | 8/11 | 10/14 | 6 | <1.1 | 25 | 1 |
| MP-40R | 20 | 20 | - | - | 45/52 | 4.6/6.5 | 22/34 | 4 | <1.1 | 65 | 1or3 |
| MP-40RM | - | - | 3/4 | 3/4 | 45/52 | 4.6/6.5 | 22/34 | 4 | <1.1 | 65 | 1or3 |
| MP-40RX | 26 | 26 | - | - | 75/85 | 3.3/4.7 | 47/65 | 2 | <1.1 | 65 | 1or3 |
| MP-40RXM | - | - | 1 | 1 | 75/85 | 3.3/4.7 | 47/65 | 2 | <1.1 | 65 | 1or3 |
| MP-40RZ | 18 | 18 | - | - | 22/28 | 10/13.5 | 10 | 8 | <1.1 | 65 | 1or3 |
| MP-40RZM | - | - | 3/4 | 3/4 | 22/28 | 10/13.5 | 10 | 8 | <1.1 | 65 | 1or3 |
| MP-55R | 26 | 26 | - | - | 60/70 | 5.6/8.2 | 30/45 | 4 | <1.2 | 90 | 1or3 |
| MP-55RM | - | - | 1 | 1 | 60/70 | 5.6/8.2 | 30/45 | 4 | <1.2 | 90 | 1or3 |
| MP-55RZ | 26 | 26 | - | - | 25/28 | 10/14 | 15/22 | 8 | <1.1 | 90 | 1or3 |
| MP-55RZM | - | - | 3/4 | 3/4 | 25/28 | 10/14 | 15/22 | 8 | <1.1 | 90 | 1or3 |
| MP-70R | 26 | 26 | - | - | 86/97 | 6.7/9.7 | 50/72 | 4 | <1.1 | 150/180 | 1or3 |
| MP-70RM | - | - | 1 | 1 | 86/97 | 6.7/9.7 | 50/72 | 4 | <1.1 | 150/180 | 1or3 |
| MP-70RZ | 20 | 20 | - | - | 40/43 | 14.3/20.3 | 20/24 | 12 | <1.1 | 150/180 | 1or3 |
| MP-70RZM | - | - | 3/4 | 3/4 | 40/43 | 14.3/20.3 | 20/24 | 12 | <1.1 | 150/180 | 1or3 |
| MP-100R | 26 | 26 | - | - | 120/130 | 8.6/11.6 | 60/70 | 7/9 | <1.3 | 250/265 | 1or3 |
| MP-100RM | - | - | 1 | 1 | 120/130 | 8.6/11.6 | 60/70 | 7/9 | <1.3 | 250/265 | 1or3 |
| MP-100RX | - | - | 1 1/4 | 1 1/4 | 170 | 9.0 | 100 | 5.0 | <1.3 | 250 | 1or3 |
| MP-120R | - | - | 1 1/2 | 1 1/2 | 220 | 10.5 | 140 | 6.0 | <1.3 | 370 | 1or3 |

PERFORMANCE CURVES

The below data are for reference only.

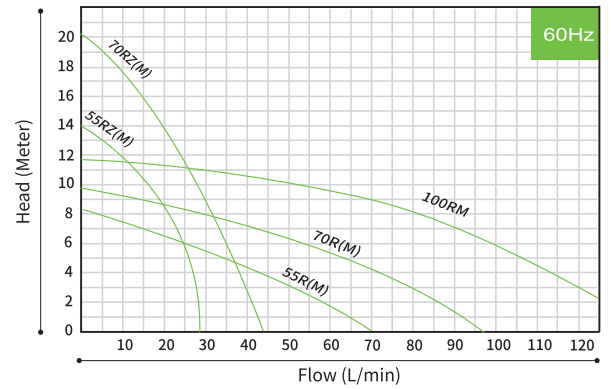
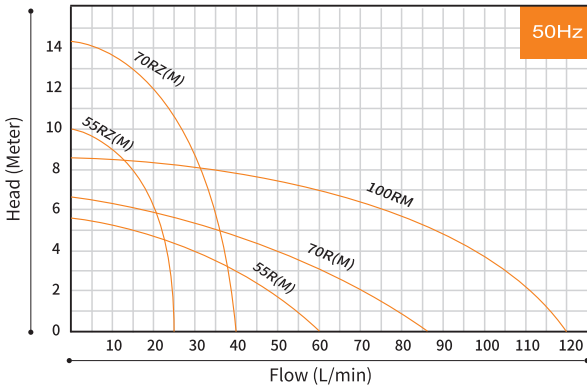
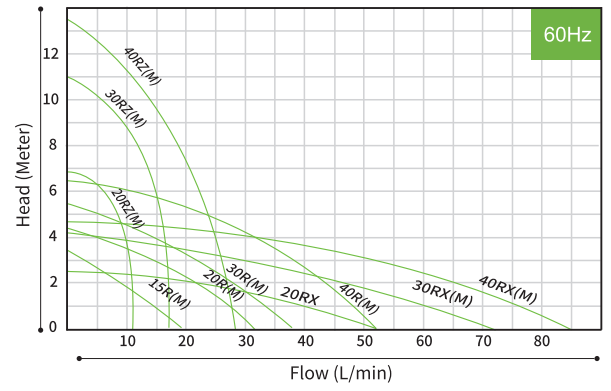
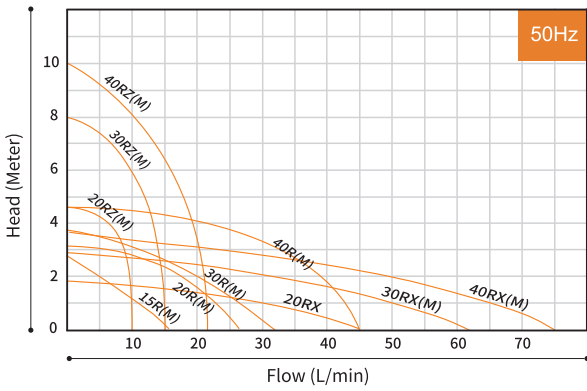
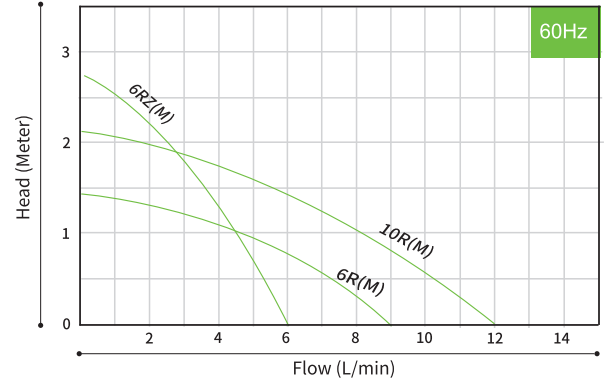
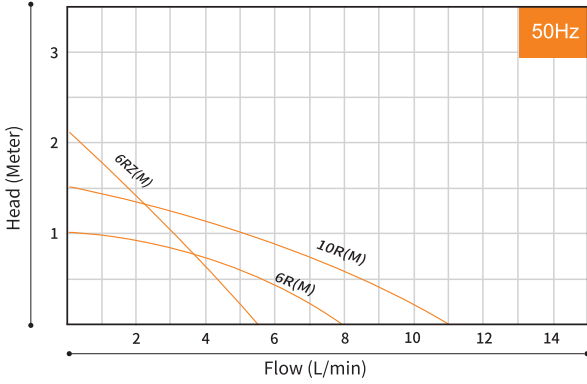

The below data are for reference only.

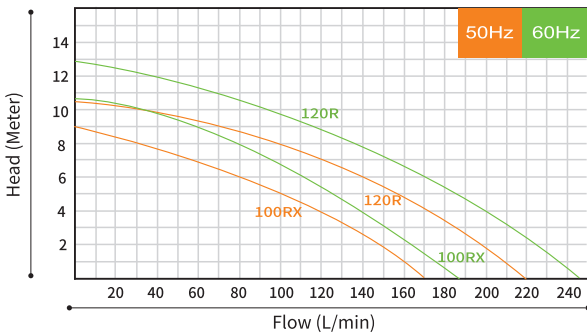

Note :

- The flow curves are based on pumping clear water.
When head is 0, it's max flow, When flow is 0, It's max head.
- Single - phase motors are 100V, 110V, 220V or 240V; three phase motors are 380V.
- Normal working temperature is 0 - 80°C.
If you need a higher temperature, please contact our sales staff
- (M) means: Threaded connection.

DIMENSIONS

MP-6R-10R-15R-20R-30R-40R

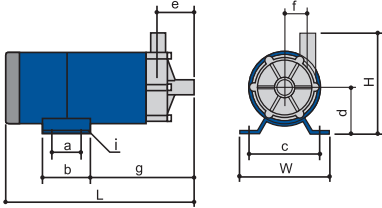

| Model No. | W | H | L | a | b | c | d | e | f | g | i |
|-----------|-----|-----|-------|----|----|-----|----|----|----|-----|---------|
| MP-6R | 74 | 85 | 129.5 | - | 30 | 59 | 37 | 32 | 17 | 62 | 2-Ø5.6 |
| MP-10R | 74 | 85 | 129.5 | - | 30 | 59 | 37 | 32 | 17 | 62 | 2-Ø5.6 |
| MP-15R | 84 | 101 | 195 | 44 | 70 | 67 | 45 | 36 | 23 | 88 | 4-Ø6*9 |
| MP-20R | 86 | 115 | 214 | 30 | 50 | 71 | 54 | 43 | 28 | 112 | 4-Ø5*8 |
| MP-30R | 121 | 132 | 250 | 40 | 64 | 101 | 57 | 47 | 32 | 135 | 4-Ø9*15 |
| MP-40R | 121 | 132 | 240 | 34 | 64 | 99 | 57 | 46 | 32 | 132 | 4-Ø9*15 |

MP-55R

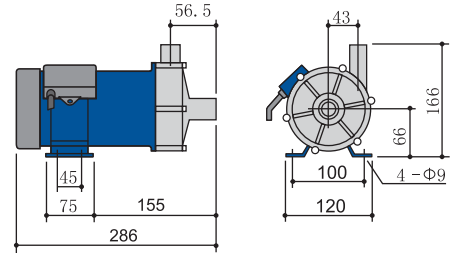

MP-70R

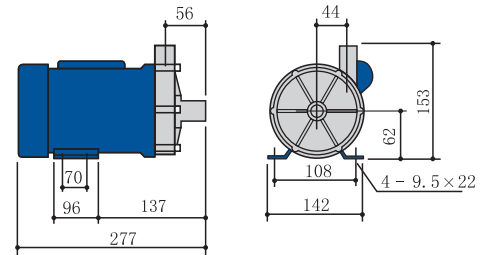

MP-70RZ

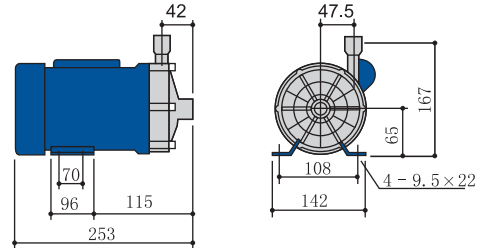

MP-100R

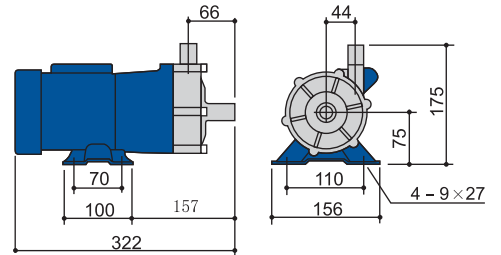

MP-120R

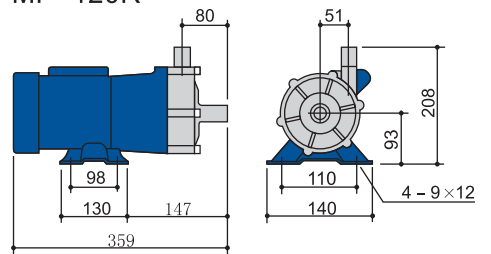

MP-20RZ-30RZ-40RZ

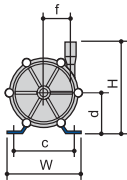
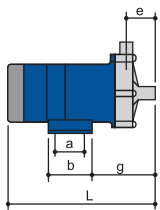

MP-20RX-30RX-40RX-100RX

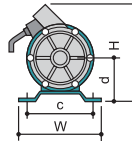
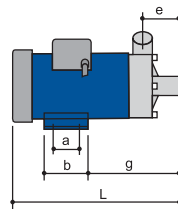

| Model No. | W | H | L | a | b | c | d | e | f | g | i |
|-----------|-----|-----|-----|----|-----|-----|----|----|----|-------|--------|
| MP-20RZ | 86 | 125 | 211 | 30 | 59 | 69 | 55 | 40 | 39 | 108 | 4-5×8 |
| MP-30RZ | 120 | 130 | 234 | 40 | 64 | 100 | 60 | | | 120 | 45 |
| MP-40RZ | | 133 | 226 | | | | | 39 | | | |
| MP-20RX | 86 | 130 | 220 | 30 | 59 | 69 | 56 | 47 | - | 117 | 4-5×8 |
| MP-30RX | 120 | 138 | 253 | 40 | 64 | 100 | 60 | 48 | - | 138 | 4-φ9 |
| MP-40RX | | 137 | 276 | | | | | | | | |
| MP-100RX | 156 | 174 | 323 | 70 | 100 | 110 | 74 | 63 | - | 196.5 | 4-9×27 |

NOTE

- The performance and installation dimensions of the threaded interface pump are the same as those of the hose interface pump;
- G=British straight pipe thread specification;
- Specifications and dimensions are subject to change without prior notice.

MPH CORROSION RESISTANT MAGNETIC PUMP

MPH-40-0-F-C-C-V-5-V38

① ② ③ ④ ⑤ ⑥ ⑦ ⑧ ⑨

- 1、 Model number:MPH
- 2、 Inlet&outlet Size (DN): 40x40, 50x40, 65x50
- 3、 Horsepower: 1/2HP, 1HP, 2HP, 3HP, 5HP
- 4、 Pump body material:F-CFRPP, P-PVDF
- 5、 Axis:C-CERAMIC S-SIC
- 6、 Bearing:C -CARBON P-PTFE S-SIC
- 7、 Rubber material:V-VITON, E-EPDM
- 8、 Frequency: 50HZ, 60HZ
- 9、 Voltage: 220V 380V



MPH-401



MPH-400



MPH-422/423



MPH-422/423 PVDF



MPH-425/455

CHARACTERISTICS

- The product is injection - molded with high - grade plastics and magnetic driven, featuring a shaft - seal - free design
- that eliminates leakage hazards.
- suitable for transporting and circulating acid - base liquids.
- Different materials can be selected for various chemical solutions.
- Temperature limits: PP up to 80°C; PVDF up to 120°C.

APPLICATION FIELDS

Electroplating, water treatment, acidity, chemical solution, purification smoke and cleaning solution

SPECIFICATIC

| Model | (DN) Caliber | | Max. Capacity (L/min) | | Max. Head (m) | | Rated Head Flow (Meter-L/min) | | Specific gravit | Horespower (KW) Output power | Weight (kg) |
|---------|--------------|--------|-----------------------|------|---------------|------|-------------------------------|---------|-----------------|------------------------------|-------------|
| | Inlet | Outlet | 50Hz | 60Hz | 50Hz | 60Hz | 50Hz | 60Hz | | | |
| | | | | | | | | | | | |
| MPH-400 | 40 | 40 | 260 | 260 | 12.5 | 12.5 | 8.0-150 | 8.0-150 | 1.05 | 0.37 | 13 |
| MPH-440 | 40 | 40 | 280 | 280 | 12.5 | 12.5 | 8.5-150 | 8.5-150 | 1.05 | 0.55 | 13 |
| MPH-401 | 40 | 40 | 330 | 330 | 18 | 18 | 12-200 | 12-200 | 1.05 | 0.75 | 19 |
| MPH-422 | 50 | 40 | 400 | 400 | 23 | 23 | 18-200 | 18-200 | 1.2 | 1.5 | 23 |
| MPH-423 | 50 | 40 | 500 | 500 | 24 | 24 | 20-300 | 20-300 | 1.2 | 2.2 | 26 |
| MPH-425 | 50 | 40 | 600 | 600 | 29 | 29 | 25-400 | 25-400 | 1.0 | 4.0 | 45 |
| MPH-455 | 65 | 50 | 750 | 850 | 29.5 | 29.5 | 20-630 | 20-630 | 1.0 | 4.0 | 55 |

STRUCTURAL DIAGRAM

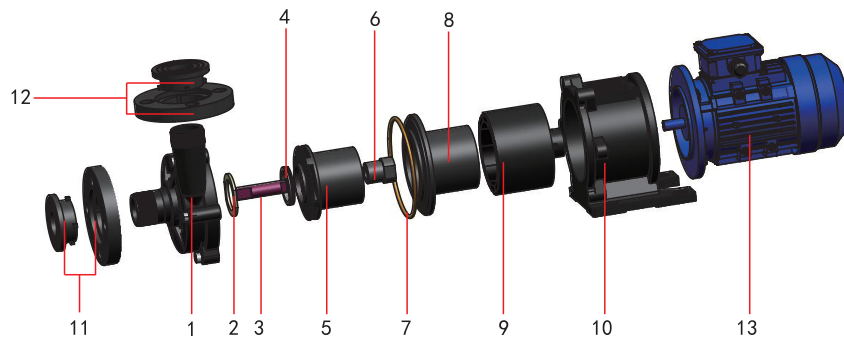

| | | | | | | | | | | | | |
|---------|-------------|-------|-------------------|----------|---------|--------|------------------|--------------|-------|--------------|---------------|-------|
| 1 | 2 | 3 | 4 | 5 | 6 | 7 | 8 | 9 | 10 | 11 | 12 | 13 |
| 泵外壳 | 止推环 | 轴 | 耐磨环 | 叶轮 | 轴承 | O型圈 | 隔离套 | 外磁钢 | 框架 | 入口法兰 | 出口法兰 | 电机 |
| Housing | Thrust ring | Shaft | Anti-wearing ring | Impeller | Bearing | O-ring | Isolation Sleeve | Drive Magnet | Frame | Inlet Flange | Outlet Flange | Motor |

PERFORMANCE CURVES

The below data are for reference only.

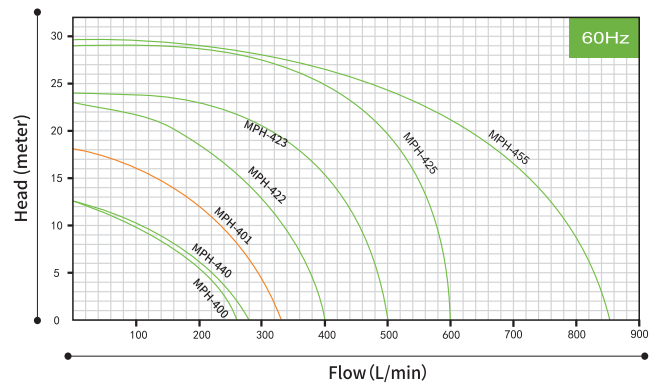
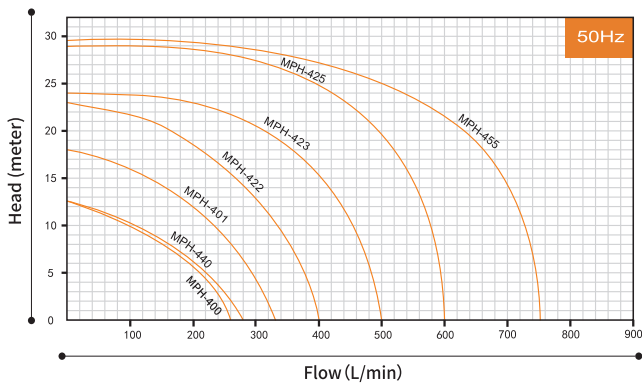

DIMENSIONS

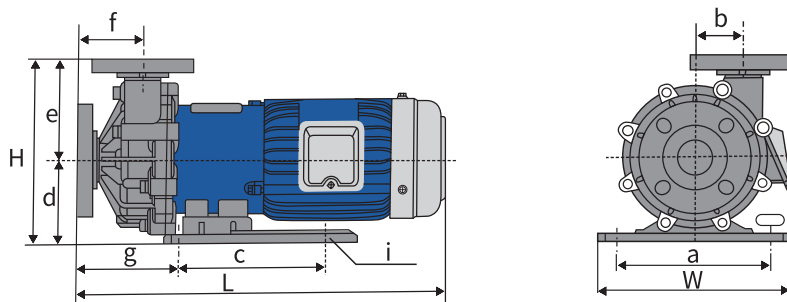

| ITEM | W | H | L | a | b | c | d | e | f | g | i |
|---------|-----|-----|-----|-----|----|-----|-----|-----|-----|-----|----------|
| MPH-440 | 140 | 218 | 441 | 110 | 63 | 100 | 98 | 120 | 80 | 107 | 4-Ø12*20 |
| MPH-400 | 140 | 218 | 441 | 110 | 63 | 100 | 98 | 120 | 80 | 136 | 4-Ø12*20 |
| MPH-401 | 162 | 255 | 457 | 130 | 65 | 130 | 115 | 130 | 90 | 225 | 4-Ø12 |
| MPH-422 | 250 | 267 | 520 | 208 | 75 | 200 | 123 | 146 | 92 | 156 | 4-Ø12 |
| MPH-423 | 260 | 285 | 555 | 208 | 75 | 200 | 123 | 162 | 105 | 156 | 4-Ø12 |
| MPH-425 | 260 | 300 | 638 | 230 | 65 | 261 | 135 | 163 | 91 | 156 | 4-Ø14*36 |
| MPH-455 | 260 | 295 | 650 | 230 | 70 | 261 | 135 | 161 | 110 | 178 | 4-Ø14*36 |

CHEMICAL RESISTANCE GUIDE

Chemical resistance ratings:

- A — Excellent
- B — Good
- C — Fair
- X — Not Recommended
- — Data Not Available

Maximum operating temperature:

- 1 — 20°C (68F)
- 2 — 40°C (104F)
- 3 — 60°C (140F)
- 4 — 80°C (176F)
- 5 — 100°C (212F)
- 6 — 120°C (248F)

| CHEMICAL | 材料 MATERIAL | | | | | | | |
|-------------------------------|-------------|------|-----|----------|------|-----------|---------------------|----|
| | PP | PVDF | FKM | Chemigum | EPDM | 95Ceramic | High density carbon | |
| 硫酸 Sulfuric Acid | 0~10% | A4 | A6 | A6 | B2 | A4 | A5 | A6 |
| | 10~75% | A3 | A6 | A4 | X | A3 | A5 | A6 |
| | 75~100% | B2 | A4 | A4 | - | B2 | A5 | A4 |
| 硝酸 Nitric Acid | 10% | A3 | A5 | A5 | X | A2 | A5 | A6 |
| | 30% | A2 | A6 | A6 | X | A2 | A5 | A6 |
| | 50% | B2 | A3 | A1 | X | X | A5 | A5 |
| 盐酸 Hydrochloric Acid | 0~25% | A4 | A6 | A3 | B1 | A3 | A5 | A6 |
| | 25~40% | A4 | A6 | B2 | X | C2 | A5 | A6 |
| 氢氟酸 Hydrofluoric Acid | 10% | B2 | A6 | A3 | X | A3 | - | A3 |
| | 30% | C2 | A6 | A4 | - | B3 | - | A3 |
| | 60% | X | A6 | A4 | - | C2 | - | A2 |
| 醋酸 Acetic Acid | 20% | A2 | A6 | B1 | B2 | A2 | A5 | A4 |
| | 80% | B1 | A6 | X | - | - | A5 | A4 |
| 氢氧化钠 Sodium Hydroxide | 20% | A3 | A6 | B1 | B2 | A4 | - | A3 |
| | 50% | A3 | A6 | X | B1 | A3 | - | A3 |
| 溴水 Bromine Water | | C1 | A3 | A2 | - | X | A1 | A2 |
| 乙醇 Ethyl Alcohol | | A2 | A3 | A3 | X | B3 | A3 | A5 |
| 丙酮 Acetone | | A2 | A6 | X | - | B2 | A3 | A5 |
| 氟里昂12 Freon 12 | | X | A6 | A1 | X | B1 | A4 | A4 |
| 氯化铝 Aluminum Chloride | | A4 | A6 | A5 | B4 | A4 | A4 | A5 |
| 氨水 Ammonia Liquid | | A1 | A6 | C1 | B4 | B3 | A3 | A5 |
| 王水 Aqua Regia | | C2 | A5 | B2 | - | C2 | A4 | - |
| 甲醛 Formaldehyde | | A4 | A6 | A4 | x | A4 | A4 | A5 |
| 汽油 Gasolines | | X | A6 | B3 | B3 | X | A4 | A6 |
| 煤油 Kerosene | | A1 | A6 | A1 | B1 | X | A4 | A6 |
| 甲醇 Methyl Alcohol | | A3 | A6 | B2 | B4 | A3 | A5 | A6 |
| 甲苯 Toluene | | C1 | A4 | B1 | - | X | A5 | A4 |
| 三氯乙烯 Trichloroethylene | | C1 | A6 | A1 | - | X | A4 | A6 |
| 二甲苯 Xylene | | X | A6 | B1 | - | X | A5 | A5 |
| 无水硝酸 Nitric Acid Anhydrous | | C1 | A3 | A1 | - | X | A5 | A2 |
| 发烟硫酸 Oleum | | X | A6 | A4 | - | X | A5 | A2 |
| 氢氧化钾 Potassium Hydroxide | | A4 | A6 | B1 | C2 | A5 | - | A6 |

Note: 95ceramic means containing 95 percent of alumina

APPLICATIONS

The “HAOQUAN” Brand magnetic-driven cycle pump, made by polypropylene, excellent performance to endure the corrosion from chemical Liquid, extensive applications.

| | |
|----------------------------------|--|
| Chemical industry: | Sodium carbonate industry(production of hydrochloric acid, hypochlorous acids secondary chemical product);production of fluoride,chemical fertilizer;cycle of reactive liquid of gas absorb tower, abstract grease(sulfuric acid);recycle &reactivation system of waste acid substance;transport of strong acid between chemical factory and transport vehicle |
| Pharmaceuticals industry: | Production of luminophor (EL)for semiconductor,pesticides,medicine ,water treatment agent |
| Electric plate: | Cycle filter kinds of electroplating liquid. |
| Photograph processing: | At-once photograph system;Xfilm,wash-out of back andwhite ,colour and solidphotograph |
| Electric appliance : | Production of chemical capacitor(erosion by alum inurn film) ,Transport electrolyte for manufacture of dry battery and accumulator ;Etching circuit board;Transfer high purity of chemical liquid during the manufacture of semiconductor. |
| Metal industry : | Treatment device for aluminum oxide film;Wire stretching;Oil elimination and cleaning and acid cleaning for steel rolling ; Oil elimination and acid cleaning before painting of vehicle;production of oxidized titanium and rare-earth element. |
| Mineral industry : | Fusion metallurgy(Transport and recycle electrolyte);handling waste liquid. |
| Food industry : | Production of gluconic acid(hydrochloric acid);abstracting cooking oil(sulfuric acid);potted fruit industry(hydrochloric acid). |
| Medicine remedy: | Man-made kidney and heart,ultrasonic washing machine and various of medical equipment. |
| Water treatment: | Cleaning ion exchange resin;pure water production equipment ;sea-water desalting equipment. |
| Pollution controll : | Add waste water treatment agent to medical liquid tank;collect and transport waste liquid;waste gas absorb equipment (deodorization equipment,desulfurisation before waste gas discharge). |
| Other application: | Applied in silver recycle,wafer manufacture, laboratory-ice making machine,drinking machine,living boiler,heating exchange machine,solar energy system,dyeing,laser system,water spouting pool,rearing pond fish jar etc. |



MPS STAINLESS STEEL MAGNETIC PUMP



1. Model number:MP
2. Product specifications
3. "No Code" represents tube connection
M: represents Thread connection
4. Pump body material:SS-304 stainless steel、 316 stainless steel
5. Voltage: 110V /220V /380V

CHARACTERISTICS

- The pump head is made of stainless steel material, driven by magnetic force, and designed without shaft seal.
- The impeller and isolation sleeve are made of food grade high-temperature resistant plastic, with a temperature of up to 140 degrees.
- Passed CE and food grade certification.
- Can customize plugs from different countries EU/US/AU/UK.

APPLICATION FIELDS

Beer brewing, water treatment, pharmaceutical industry, food and beverage industry.

SPECIFICATIC

| Model | Tube interface | | Thread interface | | Max. Capacity (L/min) 50Hz/60Hz | Max. Head (m) 50Hz/60Hz | Standard capacity | | Specific gravit | Motor | |
|----------|----------------|-------------|------------------|---------------|------------------------------------|----------------------------|-------------------------------|-----------------------|-----------------|------------|-------------|
| | Inlet (mm) | Outlet (mm) | Inlet (inch) | Outlet (inch) | | | Capacity (L/min) 50Hz/60Hz | Head (m) 50Hz/60Hz | | Output (w) | Voltage (V) |
| MP-10RN | 14 | 14 | - | - | 11/12 | 1.5/2.1 | 5/8 | 1 | <1.1 | 6 | 110/220 |
| MP-10RM | - | - | 1/2 | 1/2 | 11/12 | 1.5/2.1 | 5/8 | 1 | <1.1 | 6 | 110/220 |
| MP-15R | 16 | 16 | - | - | 16/19 | 2.7/3.4 | 8/12 | 1.5 | <1.3 | 10 | 110/220 |
| MP-15RM | - | - | 1/2 | 1/2 | 16/19 | 2.7/3.4 | 8/12 | 1.5 | <1.3 | 10 | 110/220 |
| MP-20R | 18 | 18 | - | - | 27/32 | 3.1/4.3 | 17/22 | 2 | <1.2 | 15 | 110/220 |
| MP-20RM | - | - | 1/2 | 1/2 | 27/32 | 3.1/4.3 | 17/22 | 2 | <1.2 | 15 | 110/220 |
| MP-30R | 20 | 20 | - | - | 33/38 | 3.8/5.4 | 16/25 | 2.5 | <1.3 | 25 | 110/220 |
| MP-30RM | - | - | 3/4 | 3/4 | 33/38 | 3.8/5.4 | 16/25 | 2.5 | <1.3 | 25 | 110/220 |
| MP-40R | 20 | 20 | - | - | 45/52 | 4.6/6.5 | 23/34 | 4 | <1.1 | 65 | 110/220/380 |
| MP-40RM | - | - | 3/4 | 3/4 | 45/52 | 4.6/6.5 | 23/34 | 4 | <1.1 | 65 | 110/220/380 |
| MP-55R | 26 | 26 | - | - | 60/70 | 5.6/8.2 | 30/45 | 4 | <1.2 | 90 | 110/220/380 |
| MP-55RM | - | - | 1 | 1 | 60/70 | 5.6/8.2 | 30/45 | 4 | <1.2 | 90 | 110/220/380 |
| MP-70R | 26 | 26 | - | - | 86/97 | 6.7/9.7 | 50/72 | 4 | <1.1 | 150/180 | 110/220/380 |
| MP-70RM | - | - | 1 | 1 | 86/97 | 6.7/9.7 | 50/72 | 4 | <1.1 | 150/180 | 110/220/380 |
| MP-100R | 26 | 26 | - | - | 120/130 | 8.6/11.6 | 60/70 | 7/9 | <1.3 | 250/265 | 110/220/380 |
| MP-100RM | - | - | 1 | 1 | 120/130 | 8.6/11.6 | 60/70 | 7/9 | <1.3 | 250/265 | 110/220/380 |

PERFORMANCE CURVES

The below data are for reference only.

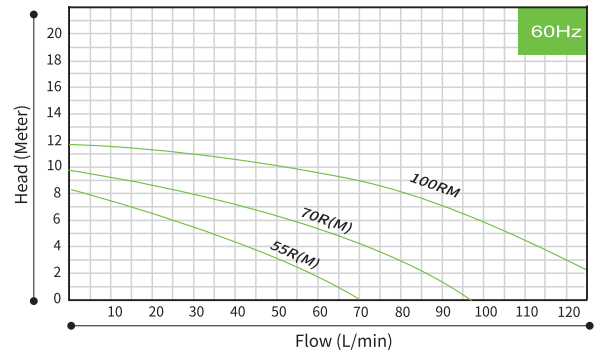
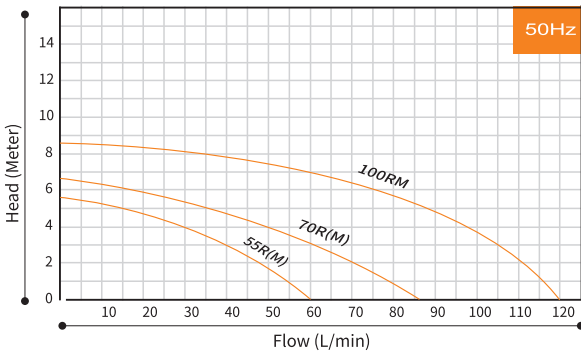
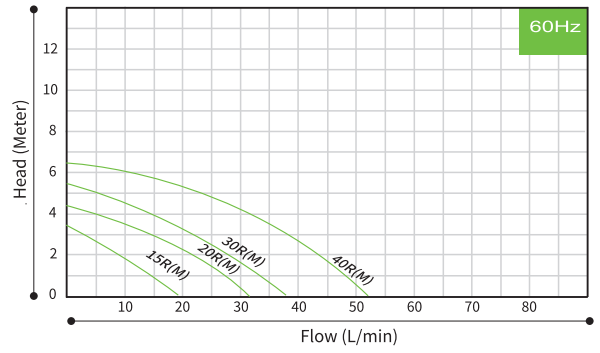
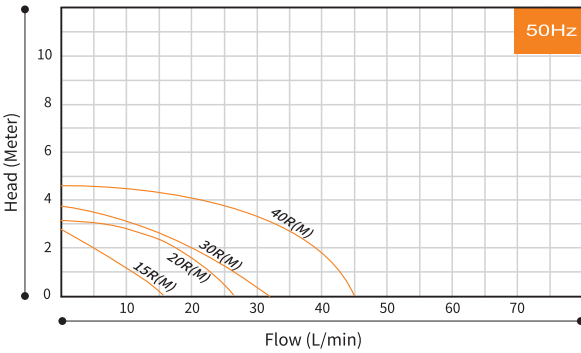
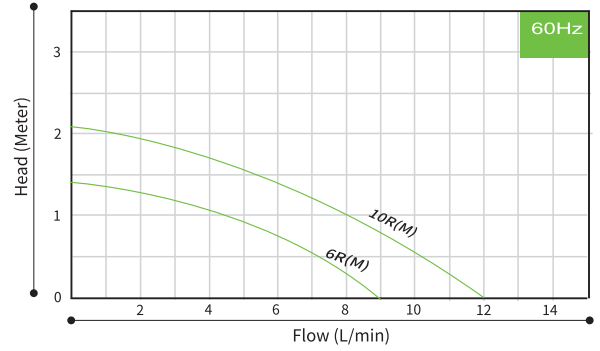
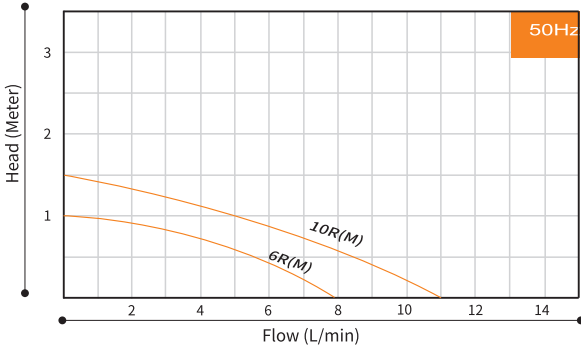

DIMENSIONS

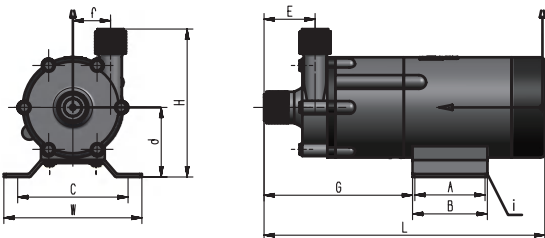

| Item NO. | W | H | L | A | B | C | d | E | f | G | i |
|----------|-------|-------|-------|------|------|-------|------|------|------|-------|-------------|
| MP-10RM | 73.5 | 88.5 | 131.5 | — | 30.5 | 59.6 | 38 | 32 | 16 | 63 | 2-Ø9.8*5.8 |
| MP-15RM | 83.5 | 97 | 195 | 41.9 | 65.3 | 67.3 | 43 | 34 | 24 | 87.5 | 4-Ø10.5*5.6 |
| MP-20RM | 87 | 116 | 233 | 30.3 | 50.5 | 67 | 56.8 | 38.5 | 28 | 107 | 4-Ø7.5*5.2 |
| MP-30RM | 119 | 127.5 | 242 | 34.5 | 64.5 | 99 | 60 | 44 | 32.5 | 128 | 4-Ø14.5*9 |
| MP-40RM | 119.1 | 124.5 | 234 | 35.1 | 64.5 | 98.1 | 58.5 | 42.5 | 33.8 | 127 | 4-Ø14.7*10 |
| MP-55RM | 123.5 | 162 | 278 | 39.5 | 76.1 | 101.7 | 69 | 52.5 | 43.5 | 146.9 | 4-Ø8.8*13.8 |
| MP-70RM | 142.5 | 155.5 | 267.5 | 70.5 | 96 | 69.7 | 62 | 51 | 42.8 | 126.9 | 4-Ø9.5*15.6 |
| MP-100RM | 156 | 175 | 322 | 70 | 100 | 110 | 75 | 66 | 44 | 157 | 4-Ø9*27 |



WS BRUSHLESS MAGNETIC PUMP



WS - 15R - M - PP - 24V

① ② ③ ④ ⑤

1. Model number:WS
2. Product specifications
3. "No Code" represents tube connection
M: represents Thread connection
X: represents High flow type
Z: represents High Head type
4. Pump body material: 304stainless steel
5. Voltage:12VDC 24VDC

CHARACTERISTICS

- Adopting brushless motor, small size, low noise, and long service life.
- The flow rate can be controlled through speed regulation to meet the needs of different scenarios.
- Magnetic drive, high power, stable performance.
- Cooperate with different fields, choose different materials to transport liquid, and circulate operation.

SPECIFICATIC

| Model | Tube interface | | Thread interface | | Max. Capacity (L/min) | Max. Head (m) | Standard capacity | | Specific gravit | Motor | |
|----------|----------------|-------------|------------------|---------------|-----------------------|---------------|-------------------|----------|-----------------|------------|-------------|
| | Inlet (mm) | Outlet (mm) | Inlet (inch) | Outlet (inch) | | | Capacity (L/min) | Head (m) | | Output (w) | Voltage (V) |
| WS-6R | 14 | 14 | - | - | 9 | 1.4 | 5 | 0.8 | <1.2 | 6 | 12/24 |
| WS-6RZ | 14 | 14 | - | - | 6 | 2.7 | 4.5 | 0.8 | <1.1 | 6 | 12/24 |
| WS-10RN | 14 | 14 | - | - | 12 | 2.1 | 8 | 1 | <1.1 | 6 | 12/24 |
| WS-10RM | - | - | 1/2 | 1/2 | 12 | 2.1 | 8 | 1 | <1.1 | 6 | 12/24 |
| WS-15R | 16 | 16 | - | - | 19 | 3.4 | 12 | 1.5 | <1.3 | 10 | 12/24 |
| WS-15RM | - | - | 1/2 | 1/2 | 19 | 3.4 | 12 | 1.5 | <1.3 | 10 | 12/24 |
| WS-20R | 18 | 18 | - | - | 32 | 4.3 | 22 | 2 | <1.2 | 15 | 12/24 |
| WS-20RM | - | - | 1/2 | 1/2 | 32 | 4.3 | 22 | 2 | <1.2 | 15 | 12/24 |
| WS-20RX | 26 | 26 | - | - | 52 | 2.5 | 40 | 1 | <1.3 | 15 | 12/24 |
| WS-30R | 20 | 20 | - | - | 38 | 5.4 | 25 | 2.5 | <1.3 | 25 | 12/24 |
| WS-30RM | - | - | 3/4 | 3/4 | 38 | 5.4 | 25 | 2.5 | <1.3 | 25 | 12/24 |
| WS-30RX | 26 | 26 | - | - | 72 | 4.1 | 46 | 2 | <1.1 | 25 | 12/24 |
| WS-30RXM | - | - | 1 | 1 | 72 | 4.1 | 46 | 2 | <1.1 | 25 | 12/24 |
| WS-40R | 20 | 20 | - | - | 52 | 6.5 | 46 | 4 | <1.1 | 65 | 12/24 |
| WS-40RM | - | - | 3/4 | 3/4 | 52 | 6.5 | 46 | 4 | <1.1 | 65 | 12/24 |
| WS-40RX | 26 | 26 | - | - | 85 | 4.7 | 65 | 2 | <1.1 | 65 | 12/24 |
| WS-40RXM | - | - | 1 | 1 | 85 | 4.7 | 65 | 2 | <1.1 | 65 | 12/24 |

PERFORMANCE CURVES

The below data are for reference only.

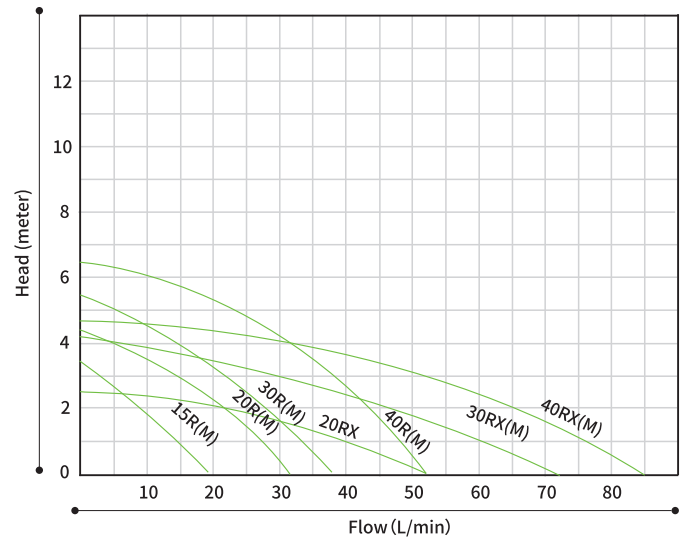
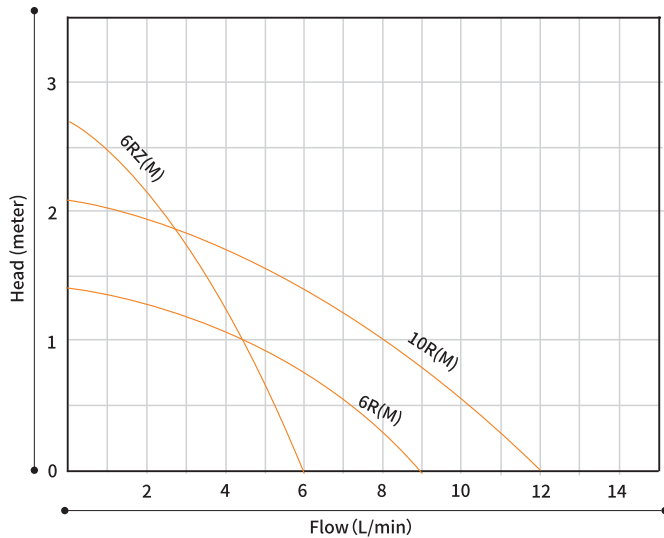

DIMENSIONS

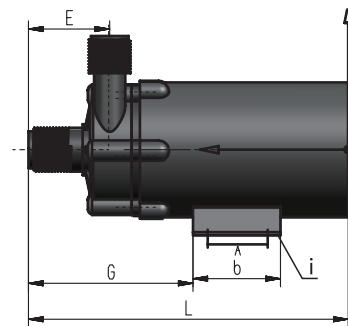
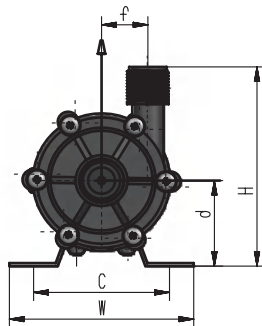

| Item No. | W | H | L | A | b | C | d | E | f | G | i |
|----------|------|-----|-------|----|------|------|------|------|------|-------|------------|
| WS-10RM | 75 | 93 | 120 | — | 30.2 | 42 | 42.8 | 32.5 | 16.1 | 63 | 2-11.5*5.9 |
| WS-15RM | 88.5 | 96 | 148.5 | 21 | 42 | 73.5 | 42 | 34 | 24 | 74 | 4-10*5 |
| WS-20RM | 84 | 114 | 174 | 30 | 50 | 67.7 | 56 | 39 | 27.5 | 85 | 4-7.7*5.2 |
| WS-20RX | 84 | 124 | 183.5 | 30 | 50 | 45.5 | 56 | 46.5 | — | 94.5 | 4-5.4*5.2 |
| WS-30RM | 124 | 131 | 229 | 37 | 64.5 | 102 | 57.5 | 46.5 | 32.5 | 100 | 4-11.4*8.5 |
| WS-30RXM | 124 | 125 | 238.5 | 37 | 64.5 | 102 | 57.5 | 54.5 | — | 109.5 | 4-11.4*8.5 |
| WS-40RM | 124 | 131 | 229 | 37 | 64.5 | 102 | 57.5 | 46.5 | 32.5 | 100 | 4-11.4*8.5 |
| WS-40RXM | 124 | 125 | 238.5 | 37 | 64.5 | 102 | 57.5 | 54.5 | — | 109.5 | 4-11.4*8.5 |

APPLICATION FIELDS

Scientific research experiments, medical devices, online collection, disinfection systems, laser fields, refrigeration systems

CHARACTERISTICS

- Easy Installation
- Excellent self suction capability
- Pump controlled automatically by built-in pressure switch
- Permissible liquid temperature up to 60°C
- Low Noise, Excellent Corrosion Resistance, High Pressure



DP-35



DP-60A



DP-70



DP-60/130(BLDC)



DP-35/50(BLDC)



DP-60/100/125

SPECIFICATIC

| Model | Voltage (V) | Max.current (A) | Max.Flow Gallon(L)/min | Speed (r/min) | Pressurre(max) Psi(Mpa) | Suction (m) | Pressure switch psi(Mpa) | Power (w) |
|-------------|-------------|-----------------|------------------------|---------------|-------------------------|-------------|--------------------------|-----------|
| DP-35 | 24 | 4.8 | 3.2(12) | 1300 | 35 (0.24) | 5 | 35 (0.24) | 40 |
| | 12 | 7 | 2.5(9.5) | 1200 | 35 (0.24) | 5 | 35 (0.24) | 40 |
| DP-60A | 24 | 3 | 1.3(5.0) | 1200 | 60 (0.42) | 5 | / | 40 |
| | 12 | 6 | 1.3(5.0) | 1200 | 60 (0.42) | 5 | / | 40 |
| | 220 | 0.42 | 1.3(5.0) | 1200 | 60 (0.42) | 5 | / | 40 |
| BLDC DP-60A | 12 | 5 | 1.3(5.0) | 1200 | 60 (0.42) | 5 | / | 20 |
| DP-60 | 24 | 3 | 1.3(5.0) | 1200 | 60 (0.42) | 5 | 60(0.42) | 40 |
| | 12 | 6 | 1.3(5.0) | 1200 | 60 (0.42) | 5 | 60(0.42) | 40 |
| | 220 | 0.42 | 1.3(5.0) | 1200 | 60 (0.42) | 5 | 60(0.42) | 40 |
| BLDC DP-60 | 24 | 2.8 | 1.3(5.0) | 1200 | 60 (0.42) | 5 | 60(0.42) | 28 |
| | 12 | 5 | 1.3(5.0) | 1200 | 60 (0.42) | 5 | 60(0.42) | 20 |
| DP-100A | 24 | 1.1 | 0.32(1.2) | 375 | 100 (0.68) | 5 | / | 10 |
| DP-100 | 24 | 1.1 | 0.32(1.2) | 375 | 100 (0.68) | 5 | 100(0.68) | 10 |
| DP-125 | 24 | 1 | 0.26(1.0) | 375 | 125 (0.86) | 5 | 125(0.86) | 10 |
| DP-130B | 24 | 1.2 | 0.45(1.7) | 470 | 130 (0.90) | 5 | 125(0.86) | 15 |
| | 12 | 2.2 | 0.45(1.7) | 470 | 130 (0.90) | 5 | 125(0.86) | 15 |
| DP-130 | 24 | 1.2 | 0.45(1.7) | 470 | 130 (0.90) | 5 | / | 15 |
| | 12 | 2.2 | 0.45(1.7) | 470 | 130 (0.90) | 5 | / | 15 |
| DP-150 | 12 | 10 | 1.4(5.3) | 720 | 150 (1.00) | 5 | 150 (1.00) | 40 |
| | 24 | 5 | 1.4(5.3) | 720 | 150 (1.00) | 5 | 150 (1.00) | 40 |
| | 220 | 0.7 | 1.4(5.3) | 720 | 150 (1.00) | 5 | / | 40 |
| DP-50 | 24 | 6 | 4.2(16) | 1800 | 50(0.35) | 5 | 50(0.35) | 65 |
| | 12 | 12 | 4.2(16) | 1500 | 50(0.35) | 5 | 50(0.35) | 65 |
| DP-70 | 12 | 17 | 5.02(19) | 1200 | 70(0.48) | 5 | 70(0.48) | 70 |
| | 24 | 9 | 5.02(19) | 1200 | 70(0.48) | 5 | 70(0.48) | 70 |
| | 220 | 1.3 | 5.02(19) | 1200 | 70(0.48) | 5 | 70(0.48) | 70 |

Specification can be customized

PERFORMANCE CURVES

The below data are for reference only.

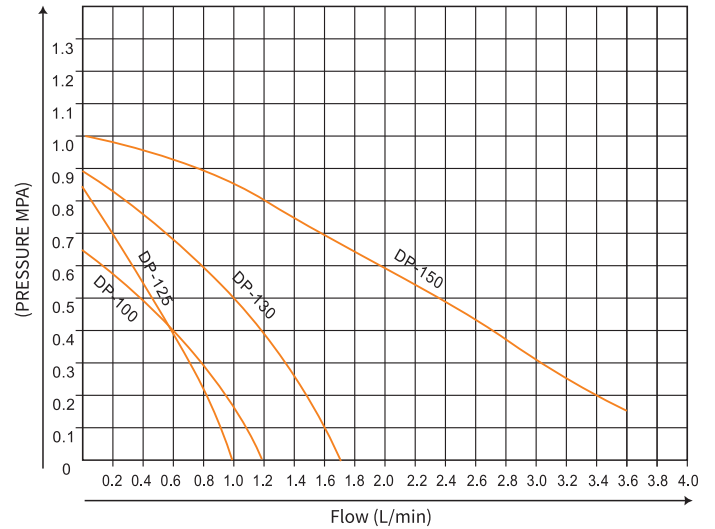
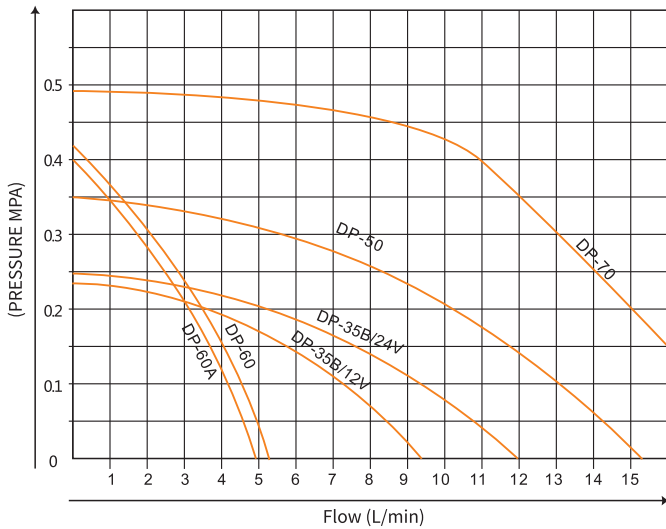

DIMENSIONS

DP-35 · 50

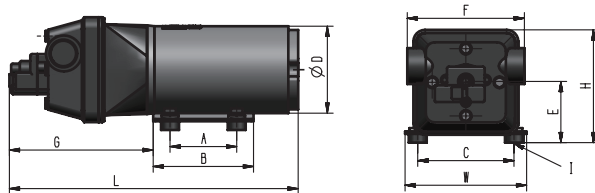

| Item NO. | A | B | C | D | H | L | W |
|-----------------|------|------|------|-------|-----|-------|-----|
| DP-35 | 57.5 | 86.5 | 83 | Φ75 | 97 | 249 | 105 |
| DP-50 | | | | | | 196 | |
| DP-35/50 (BLDC) | 57 | 86 | 83 | Φ71.5 | 86 | 196 | 105 |
| DP-60(BLDC) | 57 | 77 | 84 | Φ71.5 | 83 | 146 | 105 |
| DP-70 | 57 | 86 | 83.5 | Φ76 | 126 | 229.5 | 105 |

DP-60A · 100 · 125 · 130 · 150 No Pressure Switch

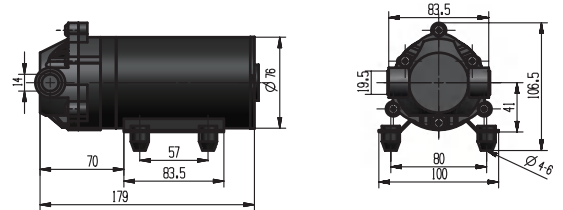

DP-60 · 100 · 125 · 130 · 150 With Pressure Switch

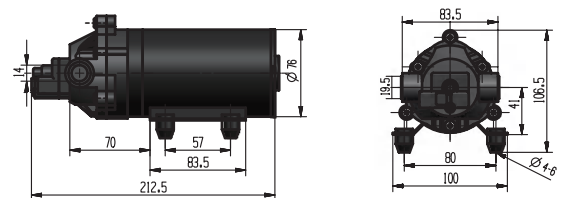

PRODUCT PURPOSE

Car flushing
Reverse Osmosis Water Purification System
Filter
Spray Equipment
General industrial equipment
Chemical Metering
Hygienic, Pollution control
Printing

MODEL NOTE

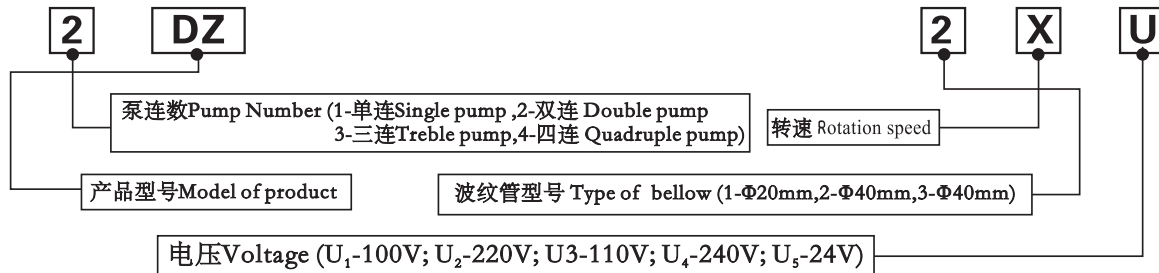

FEATURES:

- ▲ Completely leak-free... Without a mechanical shaft seal part, there is no leakage.
- ▲ High precision of output... In the case of clear water, a high precision of $\pm 1.5\%$ can be achieved.
- ▲ Self-priming ability... Under the condition of clear water at room temperature, the suction lift is 1 meter.
- ▲ Allows dry running... The working chamber is a bellows, so it can run dry.
- ▲ Long service life... The chamber is made of polypropylene with a special formula material resistant to bending, which can withstand millions of reciprocating motions.
- ▲ Good corrosion resistance... The pump body is made of polypropylene, and the valves are made of FPM and EPDM with a special formula, which can resist various corrosive liquids such as acids and alkalis.
- ▲ Liquid temperature... The maximum temperature of the chemical liquid is 60°C . When the temperature exceeds 50°C , the maximum pressure is half of that at 20°C . When the temperature exceeds 40°C , the corrosiveness of the liquid will increase, and attention should be paid.

DIMENSION OF STRUCTURE DRAWING

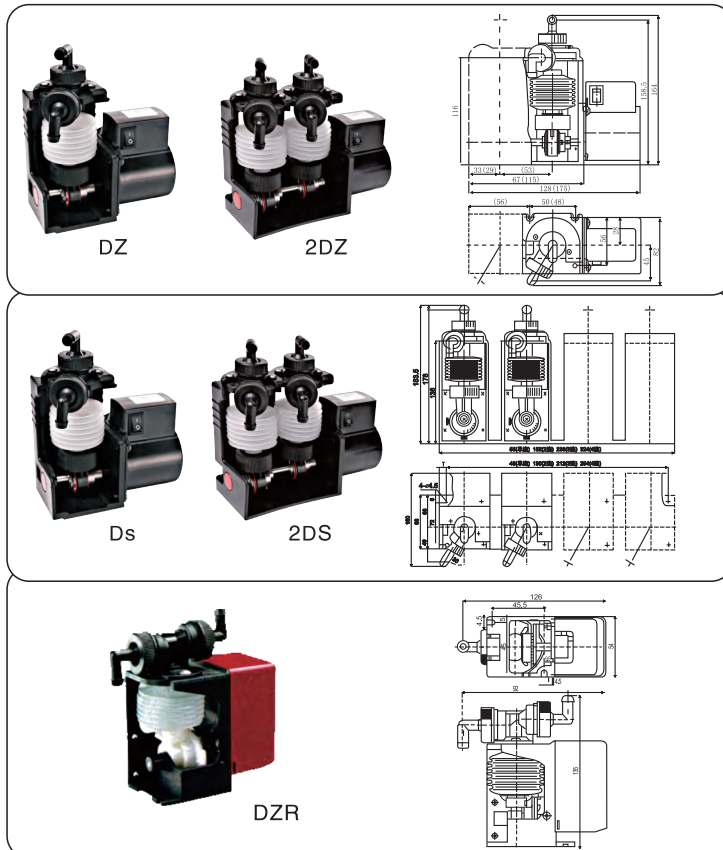

STRUCTURAL DIAGRAM

| No. | Name | Material | Quantity |
|-----|----------------|----------------|----------|
| 1 | Body | PP | 2 |
| 2 | Poppet valve | EPDM.CSM.FPM | 2 |
| 3 | Bellows | PP | 1 |
| 4 | Connecting Bod | PP/POM | 1 |
| 5 | Spindle | 1Cr18Ni9Ti | 1 |
| 6 | Crank (B) | 1Cr18Ni9Ti/POM | 1 |
| 7 | Crank (A) | 1Cr18Ni9Ti/POM | 1 |
| 8 | Nut | PP | 2 |
| 9 | End Hoouse. | ABS | 1 |
| 10 | Trestle | PP/PA66 | 1 |
| 11 | Motor | / | 1 |

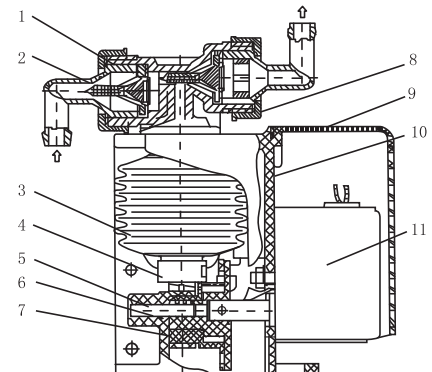

TECHHNNICAL PARAMETER

| Model | Pump Number | Type of bellow pump | Max capacity(ml/min) | | Rotate speed(RPM) | | Max pressure (Mpa) | Size (mm) | Moter(W) | Height of self-suction (cm) |
|--------|----------------------------|---------------------|----------------------|----------|-------------------|------|--------------------|-----------------|----------|-----------------------------|
| | | | 50HZ | 60HZ | 50HZ | 60HZ | | Outlet & outlet | | |
| DZ-1X | Single pump | 1 | 29 | 35 | 10 | 12 | 9 | 5 | 50 | |
| DZ-2X | | 2 | 119 | 141 | 10 | 12 | | | | |
| DZ-2Y | | | 175 | 210 | 15 | 18 | | | | |
| DZ-2Z | | | 232 | 278 | 20 | 24 | | | | |
| 2DZ-1X | Double pump | 1 | 29 × 2 | 35 × 2 | 10 | 12 | 9 | 5 | 50 | |
| 2DZ-2X | | 2 | 119 × 2 | 141 × 2 | 10 | 12 | | | | |
| 2DZ-2Y | | | 175 × 2 | 210 × 2 | 15 | 18 | | | | |
| 2DZ-2Z | | | 232 × 2 | 278 × 2 | 20 | 24 | | | | |
| DZN-1X | Single pump quadruple pump | 1 | 29 | 35 | 10 | 12 | 9 | 5 | 50 | |
| DZN-2X | | 2 | 119 | 141 | 10 | 12 | | | | |
| DZN-2Y | | | 175 | 210 | 15 | 18 | | | | |
| DZN-2Z | | | 232 | 278 | 20 | 24 | | | | |
| DS-1F | Single pump | 1 | 115 | 139 | 40 | 48 | 9 | 8 | 100 | |
| DS-1P | | | 200 | 243 | 70 | 84 | | | | |
| DS-1Q | | | 260 | 310 | 90 | 108 | | | | |
| 2DS-1F | Double pump | 1 | 115 × 2 | 139 × 2 | 40 | 48 | 9 | 8 | 100 | |
| 2DS-1P | | | 200 × 2 | 243 × 2 | 70 | 84 | | | | |
| 2DS-1Q | | | 260 × 2 | 310 × 2 | 90 | 108 | | | | |
| DS-2E | Single pump | 2 | 357 | 428 | 30 | 36 | 9 | 8 | 100 | |
| DS-2F | | | 460 | 552 | 40 | 48 | | | | |
| DS-2G | | | 570 | 685 | 50 | 60 | | | | |
| DS-2P | | | 798 | 955 | 70 | 84 | | | | |
| DS-2Q | | | 990 | 1180 | 90 | 108 | | | | |
| 2DS-2E | Double pump | 2 | 357 × 2 | 428 × 2 | 30 | 36 | 9 | 8 | 100 | |
| 2DS-2F | | | 460 × 2 | 552 × 2 | 40 | 48 | | | | |
| 2DS-2G | | | 570 × 2 | 685 × 2 | 50 | 60 | | | | |
| 2DS-2P | | | 798 × 2 | 955 × 2 | 70 | 84 | | | | |
| 2DS-2Q | | | 990 × 2 | 1180 × 2 | 90 | 108 | | | | |
| DZR-3X | Single pump | 3 | 100 | 120 | 10 | 12 | 9 | 6 | | |
| DZR-3Y | | 3 | 150 | 180 | 15 | 18 | | | | |
| DZR-3Z | | 3 | 200 | 240 | 20 | 24 | | | | |

APPLICATIONS:

- ▲ Automatic development of color films, photo enlargement, X-ray films, microfilms, motion picture films, etc.
- ▲ Used in beverage vending machines.
- ▲ Blending of mucilage and quantitative addition of food additives.
- ▲ Etching, cleaning, and printing plate making of printed circuits on electronic substrates.
- ▲ Acid-base neutralization in water treatment and addition of coagulants.
- ▲ Quantitative replenishment of electroplating solutions.
- ▲ Widely applied to the quantitative injection of various chemicals such as additives and bleaching solutions.

ALP Urea Diaphragm Pump



CHARACTERISTICS

- Acid and alkali resistant, corrosion-resistant, selected from different materials, capable of extracting different liquids at temperatures below 70 degrees Celsius.
- No need for watering, vacuum self priming, suction range up to 5 meters, with built-in reflux device.
- The newly upgraded pure copper motor continuously works to improve its service life

DIMENSIONS



SPECIFICATIC

| Model | Voltage (V) | Max.current (A) | Max.Flow L/min | Head (M) | Pressurre(max) Psi (bar) | Suction (m) | Pressure switch psi(Mpa) | Power (w) |
|---------|-------------|-----------------|----------------|----------|--------------------------|-------------|--------------------------|-----------|
| HQP-310 | 12 | 8.0 | 10 | 30 | 55(3.8) | 5 | | 150 |
| | 24 | 4.0 | 10 | 30 | 55(3.8) | 5 | | 150 |
| HQP-415 | 220 | 1.1 | 15 | 30 | 55(3.8) | 5 | / | 240 |
| HQP-420 | 12 | 13.0 | 20 | 30 | 70(4.82) | 5 | | 120 |
| | 24 | 9.0 | 20 | 30 | 70(4.82) | 5 | | 120 |
| | 220 | 1.3 | 20 | 30 | 70(4.82) | 5 | / | 290 |
| HQP-550 | 12 | 12.0 | 30 | 10 | 25(1.7) | 5 | | 180 |
| | 24 | 6.0 | 38 | 10 | 25(1.7) | 5 | / | 180 |
| | 220 | 2.0 | 40 | 10 | 25(1.7) | 5 | / | 370 |
| | | 2.0 | 50 | 10 | 25(1.7) | 5 | / | 400 |
| | | 2.0 | 40 | 10 | 25(1.7) | 5 | / | 370 |

application

- Urea model: non-acidic and non-alkaline liquids such as vehicle urea, clean water, seawater, engine oil, diesel oil, etc. up to 60°C.
- Acid and alkali model: weak acidic and weak alkaline liquids such as laundry detergent, sodium hydroxide, oxalic acid, citric acid, etc. up to 60°C.
- Acrylic model: medium acidic and alkaline liquids such as acrylic acid, glacial acetic acid, acetic acid, and formic acid. up to 60°C.
- Nitric acid model: strong acidic and alkaline liquids such as nitric acid, phosphites, sulfates, and phosphates. up to 70°C.
- Hydrochloric acid model.: high - strength acidic and alkaline liquids such as hydrochloric acid, sulfuric acid, phosphoric acid, hydrochloric acid and caustic soda. up to 70°C.
- Solvent model: organic solvents such as methanol, ethanol, corrosion inhibitor, benzene, etc. up to 60°C.
- Wine model: food-grade liquids such as edible alcohol, Chinese liquor, wine, soy sauce, beverages, etc. high temperatures up to 60°C.

PERFORMANCE CURVES

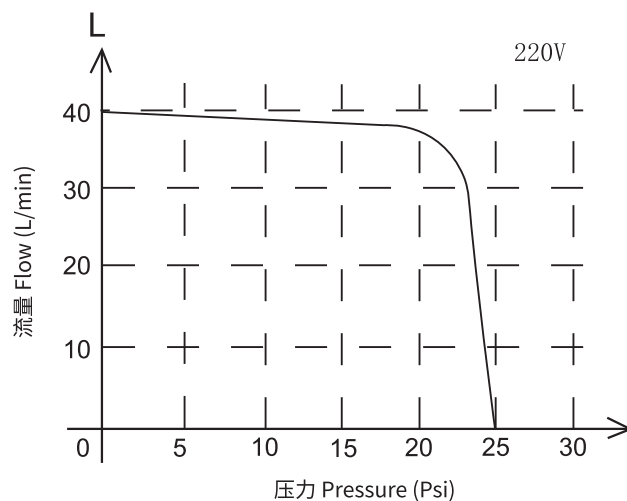

DIAPHRGM METERING PUMP

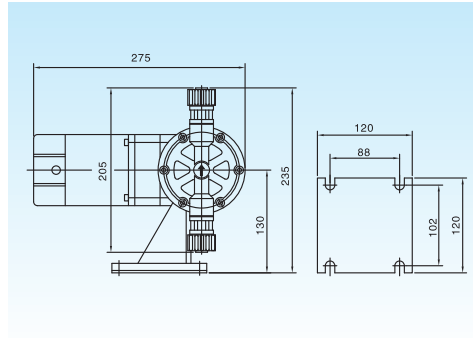

Product Features

Structurally, it's completely leak-free.

Optional configurations (Pump Head):
PVC, PTFE, 304 L, 316 L;

Suitable for various acid and alkali resistant liquid medications.;

Can be mounted on chemical barrels.

Easy to install, maintain and service.

High operational safety.

Flow rate adjustable during operation.

SPECIFICATIC

| MODEL | Max Flow rate (L/H) | Max Pressure (Mpa) | Stroke (mm) | Stroke speed (SPM) | Diaphragm diameter | Connections (mm) | Weight (KG) | Motor powers (W) |
|------------|---------------------|--------------------|-------------|--------------------|--------------------|---|-------------|----------------------|
| JVL6.5/1 | 6.5 | 1.0 | 3.0 | 56 | 65 | PVC: 9*13软管 DN15胶粘 不锈钢: DN15焊接 PTFE: DN15内螺纹 | 7 | 380V,60W 220V,60W |
| JVL12/1 | 12 | 1.0 | 4.0 | 56 | | | | |
| JVL24/1 | 24 | 1.0 | 4.0 | 93 | | | | |
| JVL32/1 | 32 | 1.0 | 4.0 | 108 | | | | |
| JVL40/1 | 40 | 1.0 | 4.0 | 135 | 84 | PVC: DN15胶粘 不锈钢: DN15焊接 PTFE: DN15内螺纹 | 8 | 380V,90W 220V,90W |
| JVL60/1 | 60 | 1.0 | 4.0 | 108 | | | | |
| JVL80/0.5 | 80 | 0.5 | 4.0 | 135 | | | | |
| JVL100/0.5 | 100 | 0.5 | 5.0 | 135 | | | | |
| JVL120/0.5 | 120 | 0.5 | 4.0 | 180 | | | | |
| JVL150/0.3 | 150 | 0.3 | 5.0 | 180 | | | | |
| JVL180/0.3 | 180 | 0.3 | 5.0 | 180 | 94 | | | |

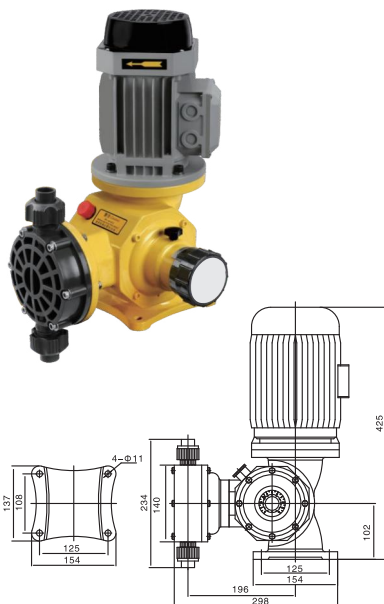

SPECIFICATIC

| MODEL | Max Flow rate (L/H) | Max Pressure (Mpa) | Stroke speed (SPM) | Motor powers (W) | Connections (mm) | Weight (KG) |
|--------------|---------------------|--------------------|--------------------|------------------|---|-------------|
| JVR- 25/1.0 | 25 | 1.2 | 48 | 0.37 | PVC: 9*13软管 DN15胶粘 不锈钢: DN15焊接 PTFE: DN15内螺纹 | 22 |
| JVR- 50/1.0 | 50 | 1.2 | 48 | | | |
| JVR- 80/0.7 | 80 | 0.7 | 96 | | | |
| JVR- 120/0.7 | 120 | 0.7 | 96 | | | |
| JVR- 170/0.7 | 170 | 0.7 | 96 | | | |
| JVR- 240/0.7 | 240 | 0.7 | 96 | 0.55 | PVC: DN15胶粘 不锈钢: DN15焊接 PTFE: DN15内螺纹 | 28 |
| JVR- 320/0.5 | 320 | 0.5 | 144 | | | |
| JVR- 420/0.5 | 420 | 0.5 | 144 | | | |
| JVR- 500/0.5 | 500 | 0.5 | 144 | | PVC: DN25胶粘 不锈钢: DN25焊接 PTFE: DN25内螺纹 | |