

# Installation Manual

Compatible Model	CAudi CA7L
Year	2022



## 1. Points to note

- For safety and to ensure the proper use of product, please ask a professional technician to install. Do not disassemble and install it privately in case of damaging product and installation accidents.
- Please arrange each wiring harness according to the wiring method in this manual, be sure to tie each wiring harness to the vehicle's original wiring harness with cable ties. Make sure the wiring harnesses are not located at the fasteners or screw holes to avoid the wiring harnesses crushed by the vehicle interior trim panel buckles and screws during the installation process.
- Because some of the wiring harness terminals (as shown in the red ellipses below) are not inserted into the wiring harness connectors during manufacture, please insert terminals into the wiring harness connector first to avoid short circuit between terminals after the wiring harnesses have been arranged, then connect other plugs of the wiring harnesses (as shown in the blue ellipses below) with the original plugs.



- Check the function display of instrument panel before installation, whether the button of the vehicle is working properly, whether the doors and windows work properly while opening and closing, whether there are scratches on the internal and external surfaces of the vehicle; and report to the customers in a timely manner if there are any problems.
- During the process of disassembly and assembly, do not carry metal ornaments and other hard objects with you to prevent damage to the paintwork, seats and interior. Be sure to place the removed trim components properly to avoid scratching them.
- All the pictures in this manual are for reference only, vehicle models with different configurations may have different pictures, but the installation methods are the same.

## 2. Installation tools



## 3. Product list

No.	Name	QTY	Picture
①	Strut	2	
②	ECU	1 set	
③	Wiring harness	1 set	
④	Latch	1	
⑤	Actuator	1	
⑥	Added tailgate switch		
⑦	Other parts (screws, brackets, etc.)	1 set	Omitted

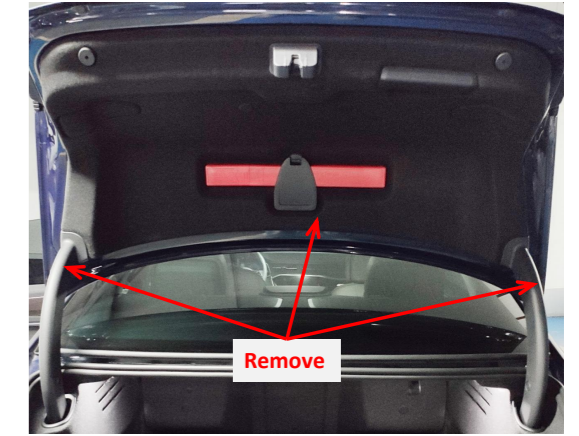

1. Remove the tailgate trim panels.

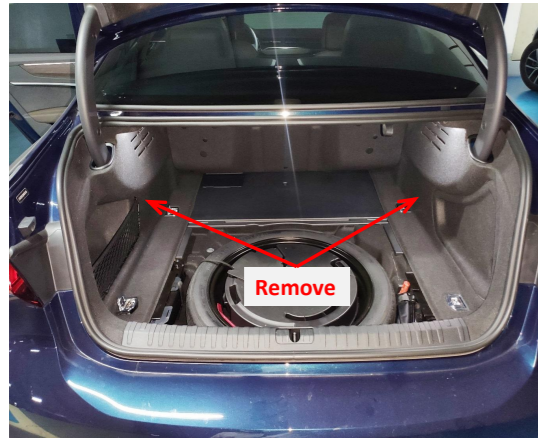

2. Remove the trunk trim panels.

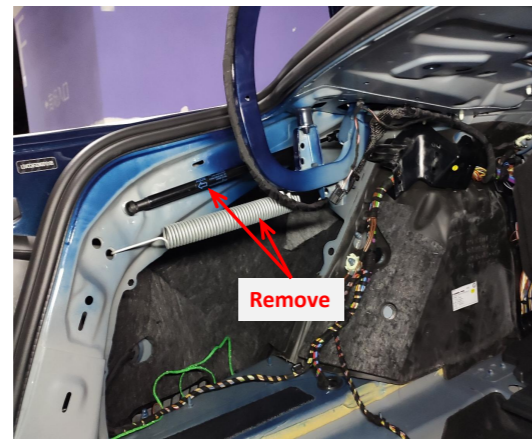

3. Remove the gas strut and the spring from the left side of the trunk.

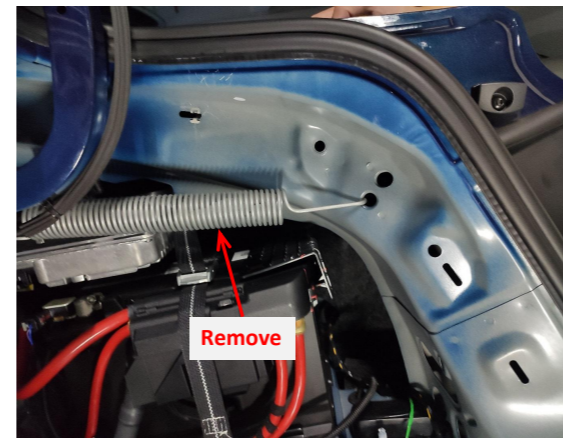

4. Remove the spring from the right side of the trunk.

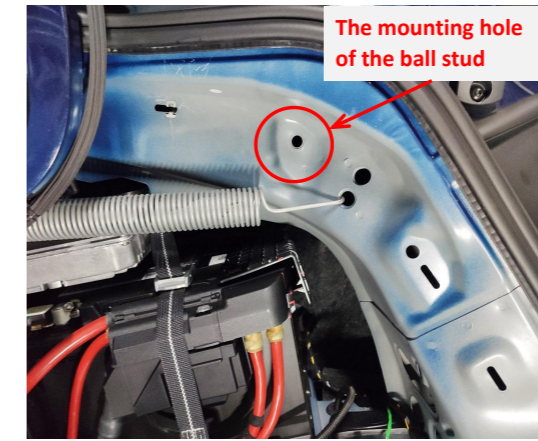

5. Locate the mounting hole of the ball stud.

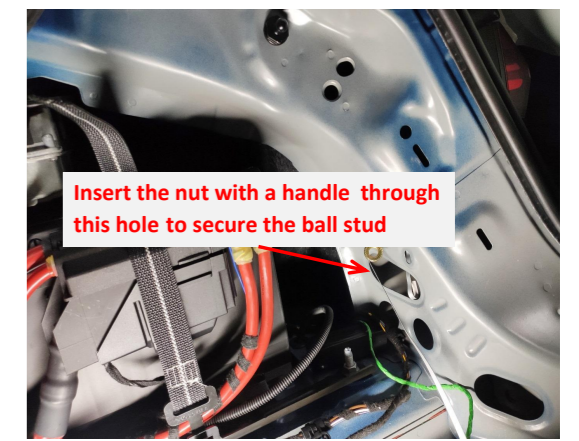

6. Insert the nut with a handle through this hole to secure the ball stud.

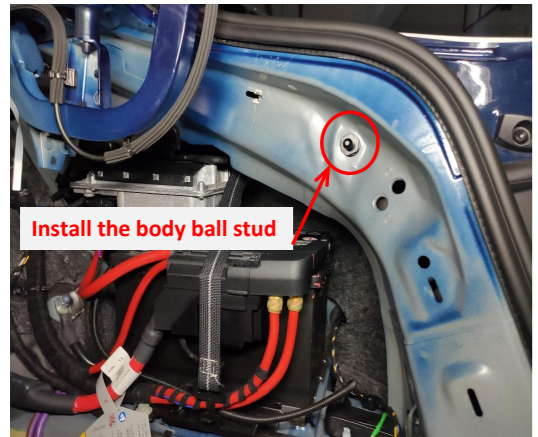

7. Install the ball stud on the right side of the trunk.

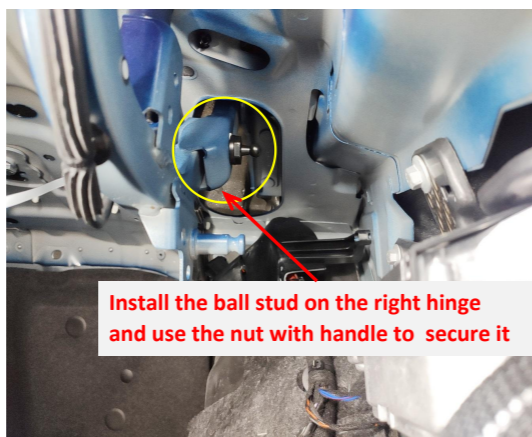

8. Install the ball stud on the right hinge.

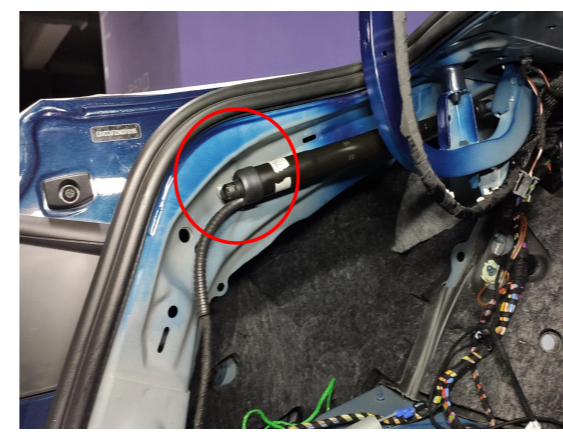

9. Install the left electric strut at the position of the original gas strut, and pay attention to the direction.



10. Install the right electric strut at the position of the original gas strut, and pay attention to the direction.



11. Hang the left and right springs back.

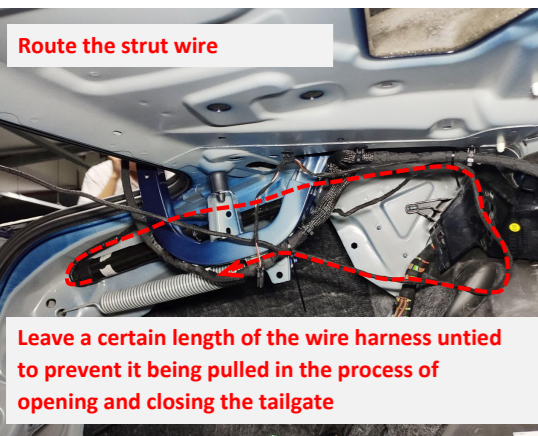

12. Route the left and right strut wiring harnesses through the hinges to the tailgate.

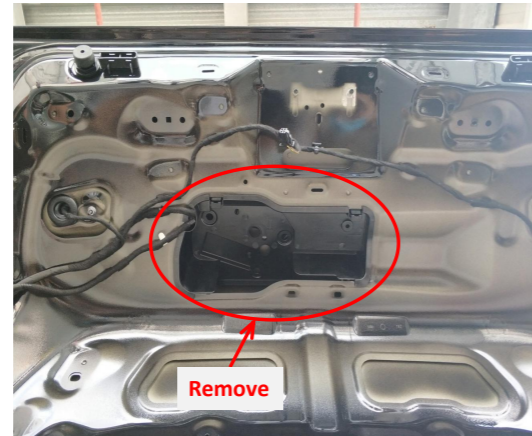

13. Remove the plastic housing from the tailgate.

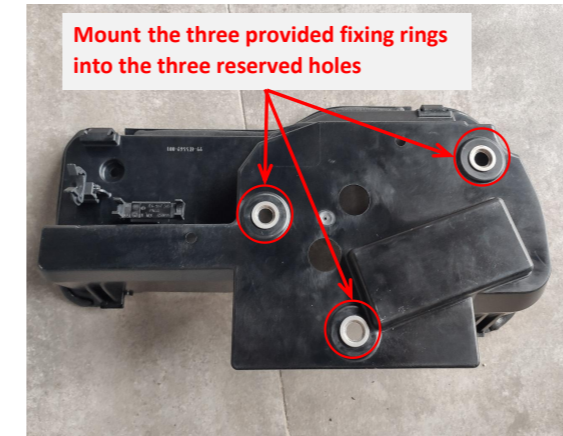

14. Mount the three provided fixing rings onto the housing (if it is difficult, use a knife to scrape the holes).

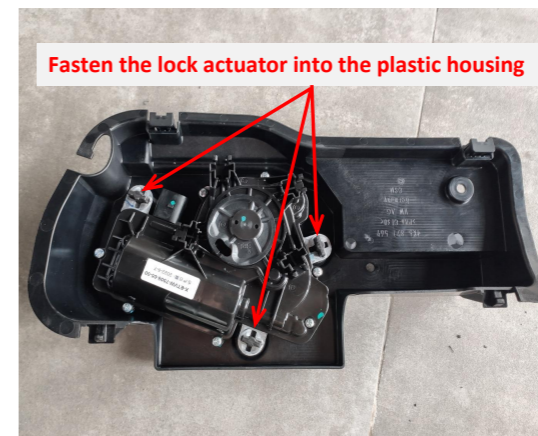

15. Install the lock actuator.



16. Connect the plugs of the lock signal harness to the original tailgate switch.



Put the plastic case with the lock actuator back

17. Put the plastic housing and the lock actuator back.



Assemble the lock latch and the lock cable together

18. Assemble the lock latch and the cable together.

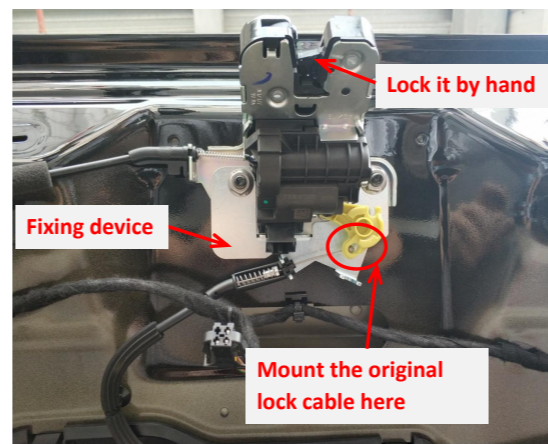

Lock it by hand  
Fixing device  
Mount the original lock cable here

19. Install the lock latch together with the fixing device and mount the original lock cable onto it.

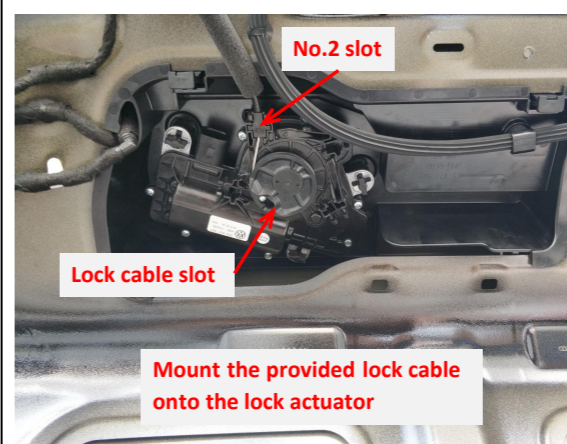

No.2 slot  
Lock cable slot  
Mount the provided lock cable onto the lock actuator

20. Mount our lock cable onto the power latch.

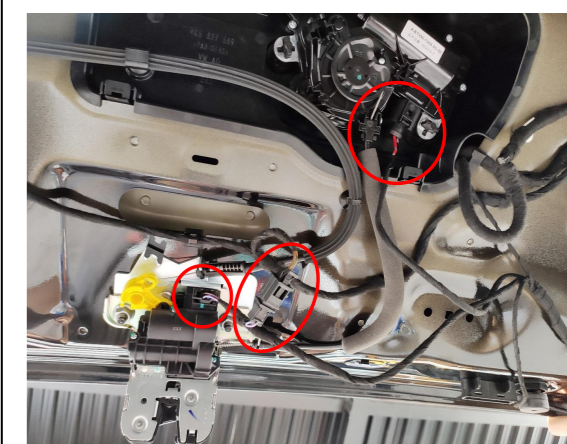

21. Connect the plugs lock signal harness to the plugs of the latch and the actuator.

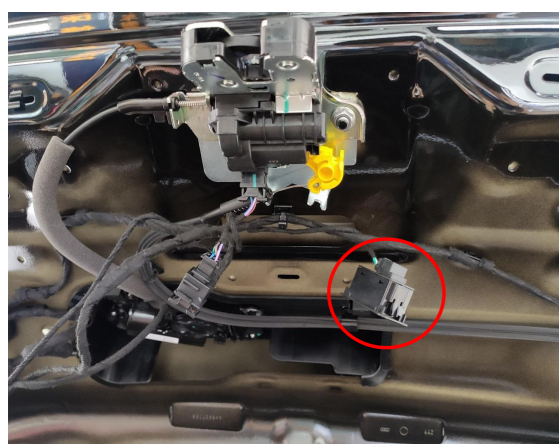

22. Connect the plug of lock signal harness to the added tailgate switch.

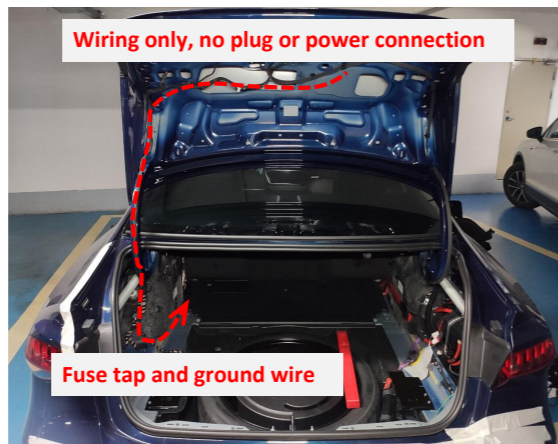

Wiring only, no plug or power connection  
Fuse tap and ground wire

23. Route the power harness.



Grounding

24. Ground at the left side of the trunk.

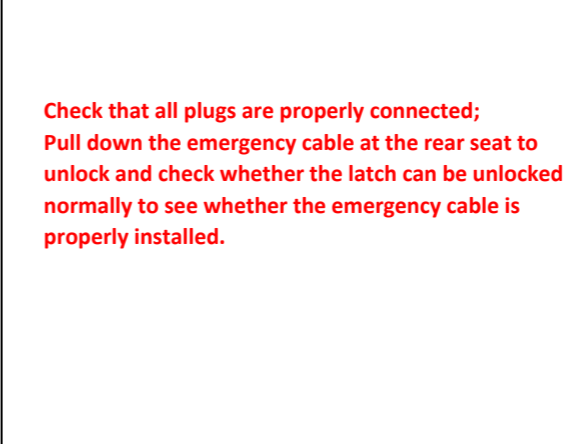

Check that all plugs are properly connected; Pull down the emergency cable at the rear seat to unlock and check whether the latch can be unlocked normally to see whether the emergency cable is properly installed.

25. Check all the plugs and the emergency cable.



26. Connect to the fuse box for power supply (all the vacant slots are constant power).

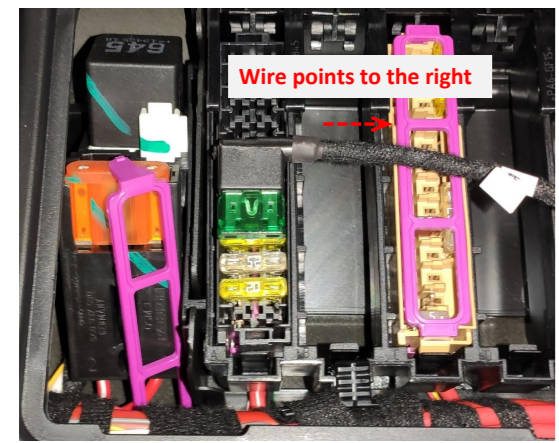

Wire points to the right

27. Plug the fuse tap into the fuse box with wire pointing to the right.



Use a  $\phi 6\text{mm}$  drill bit to drill a hole here for the installation of the ECU

28. Use a  $\phi 6\text{mm}$  drill bit to drill a hole at the indicated position for the the installation of the ECU.



29. Insert the strut wiring harnesses ①②, lock signal harness ③, and power harness ④ into the ECU in sequence and mount the ECU onto its bracket.

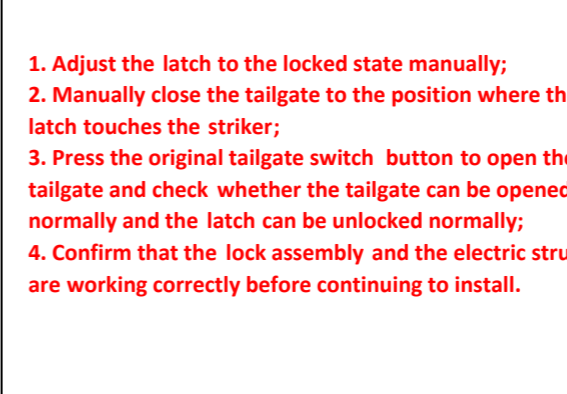

1. Adjust the latch to the locked state manually;  
2. Manually close the tailgate to the position where the latch touches the striker;  
3. Press the original tailgate switch button to open the tailgate and check whether the tailgate can be opened normally and the latch can be unlocked normally;  
4. Confirm that the lock assembly and the electric struts are working correctly before continuing to install.

30. Check whether the lock assembly and the electric struts function well.



31. Test each function of the electric tailgate.



32. Stick the hole template to the indicated position of the tailgate.



33. Reinstall all the trim panels and fit the added switch in.

### 5. System initialization method

1. Press the added tailgate switch button to make the tailgate close automatically;
2. Press the switch button outside the tailgate to open the tailgate and it will make a long sound of "beep".
3. The system initialization is complete.

### 6. Instructions for the electric tailgate

1. Methods to open and close the tailgate:
  - Press the tailgate button on the remote key 2 times;
  - Press the tailgate button in the driver's area;
  - Press the original tailgate switch button;
  - Press the added tailgate switch button.

### 2. Method to pause the tailgate:

During the operation of the tailgate, press the button with any of the above methods, and the tailgate will be paused. Press again, and the tailgate will move in reverse.

### 3. Method to memorize the height:

Open the tailgate to the height you want to set, long press the added tailgate switch, and release the switch after hearing a long "beep ----". The height memory is complete.  
Tip: During the operation of the tailgate, pause the tailgate, and then push the tailgate to the ideal height with your hand.

### 4. Meanings of the buzzer sound:

"Beep" once: Receiving an open/close or pause signal, the tailgate will immediately open/close or pause;  
"Beep" twice: The tailgate has been fully opened or closed;  
"Beep" three times: The resistance during opening or closing the tailgate is too large, and the intelligent anti-pinch has been turned on;  
Long sound of "beep": The height memory is complete.