

Installation Manual

Compatible Model	CSkoda CKaroq
Year	2018-2022



1. Points to note

- For safety and to ensure the proper use of product, please ask a professional technician to install. Do not disassemble and install it privately in case of damaging product and installation accidents.
- Please arrange each wiring harness according to the wiring method in this manual, be sure to tie each wiring harness to the vehicle's original wiring harness with cable ties. Make sure the wiring harnesses are not located at the fasteners or screw holes to avoid the wiring harnesses crushed by the vehicle interior trim panel buckles and screws during the installation process.
- Because some of the wiring harness terminals (as shown in the red ellipses below) are not inserted into the wiring harness connectors during manufacture, please insert terminals into the wiring harness connector first to avoid short circuit between terminals after the wiring harnesses have been arranged, then connect other plugs of the wiring harnesses (as shown in the blue ellipses below) with the original plugs.



- Check the function display of instrument panel before installation, whether the button of the vehicle is working properly, whether the doors and windows work properly while opening and closing, whether there are scratches on the internal and external surfaces of the vehicle; and report to the customers in a timely manner if there are any problems.
- During the process of disassembly and assembly, do not carry metal ornaments and other hard objects with you to prevent damage to the paintwork, seats and interior. Be sure to place the removed trim components properly to avoid scratching them.
- All the pictures in this manual are for reference only, vehicle models with different configurations may have different pictures, but the installation methods are the same.

2. Installation tools

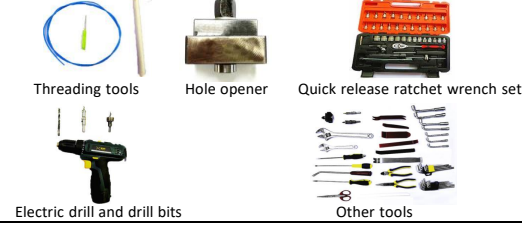

3. Product list

No.	Name	QTY	Picture
①	Strut	2	
②	ECU	1 set	
③	Wiring harness	1 set	
④	Lock latch	1	
⑤	Lock actuator	1	
⑥	Added tailgate switch	1	
⑦	Other accessories (screws, brackets, etc.)	1 set	Omitted



1. Remove the front left side trim panel, door sill panel and the storage box.



2. Remove the rear left side door sill panel and B-pillar trim panel.



3. Remove the tailgate trim panels.



4. Remove the original gas struts.



5. Install the electric struts, L on the left and R on the right (the first letter of the strut code), making sure the ends with wiring harnesses are on the tailgate.



6. Mark the positions to be drilled with tape and pay attention to avoid the taillights.



7. The final effect is as shown above.



8. Thread the left and right strut wiring harnesses into the tailgate through the drilled holes.



9. Plug the holes on both sides with the rubber plugs.



10. Remove the original latch.

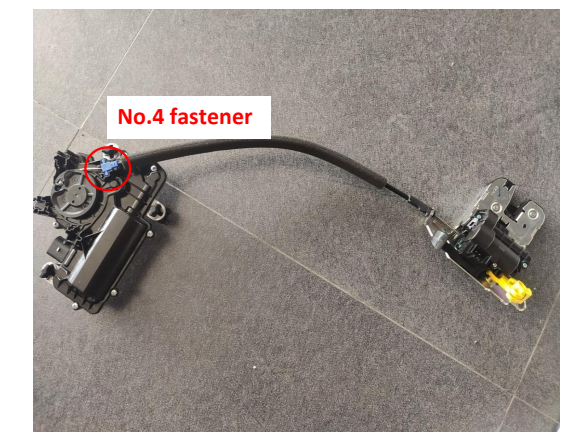

11. Assemble the lock latch and actuator.

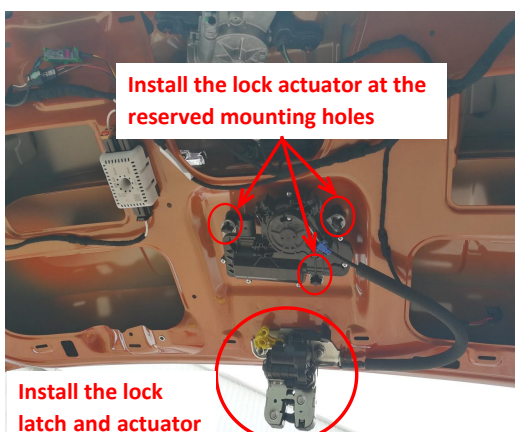

12. Install the lock latch and actuator.



13. Connect the lock signal harness to the plugs of the lock latch and the actuator.

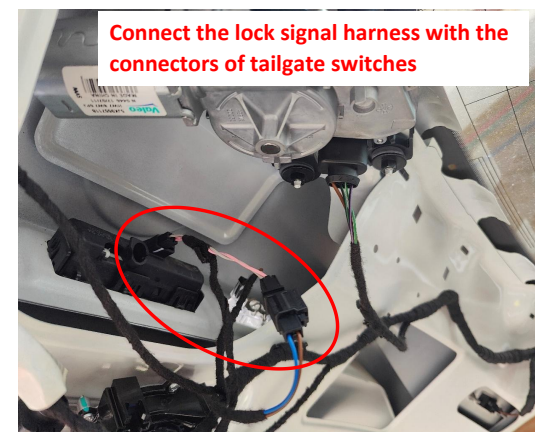

14. Connect the lock signal harness to the plugs of the original tailgate switch and the added switch.

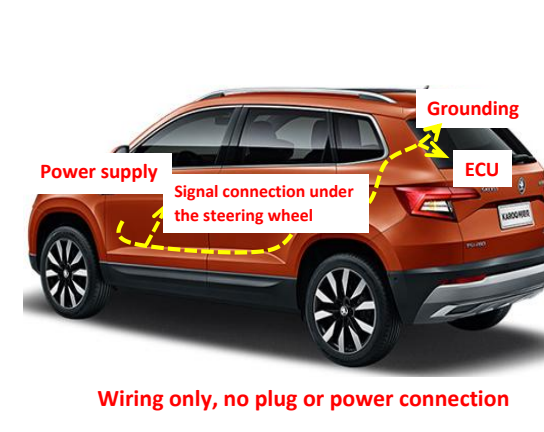

15. Route the power harness (wiring only, no plug or power connection).



16. Route power harness to tailgate.

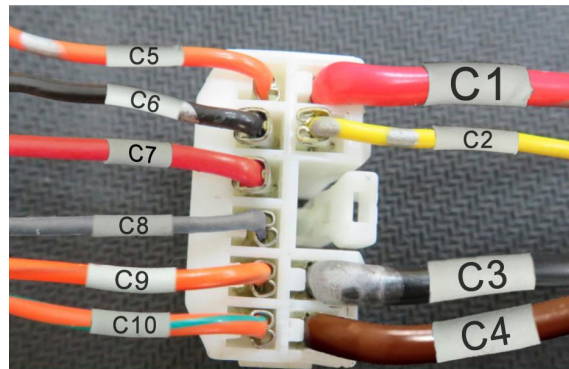

Note: For models with fewer than 10 wires, just insert them according to the corresponding label or color.

17. Insert the power harness terminals into the wiring harness connector.



18. Ground at the indicated position on the tailgate.

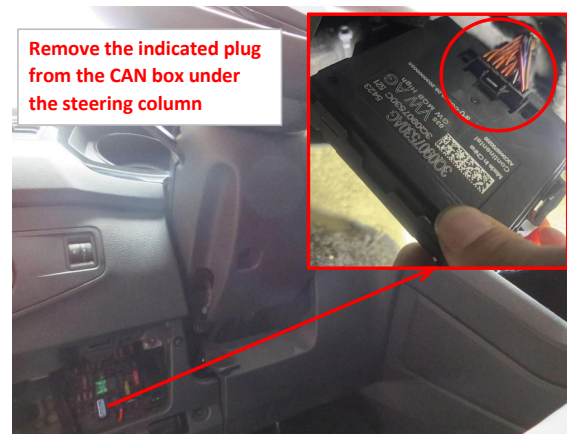

19. Find out the indicated CAN box and connect the power harness with the CAN box and the signal plug.

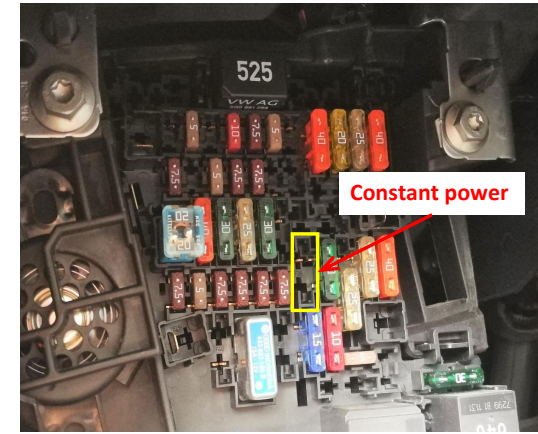

20. The fuse slot for power supply is indicated above.

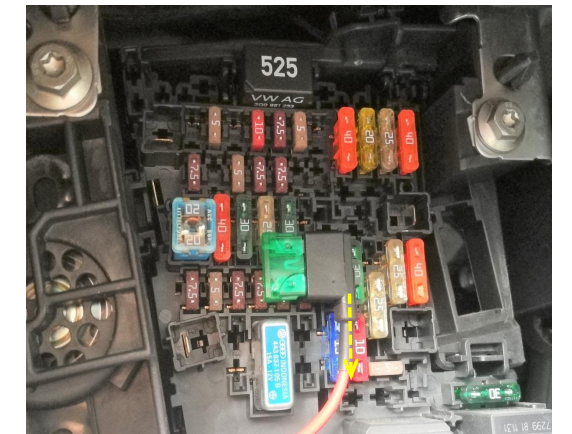

21. Plug the fuse tap into the fuse box.

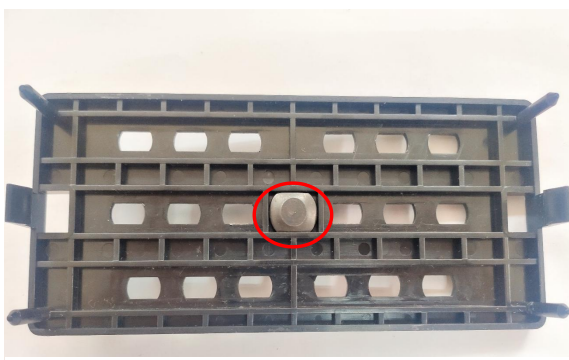

The position of the bolt on the bracket can be freely adjusted. Find a suitable position for installation.

22. Put a bolt on the ECU bracket.



23. Place the ECU at the indicated position and secure it with a nut.



24. Insert the strut wiring harnesses ①②, lock signal harness ③, and power harness ④ into the ECU in sequence.



25. Press the added tailgate switch to open and close the tailgate once for initializing the system, and then test the functions of the electric tailgate.

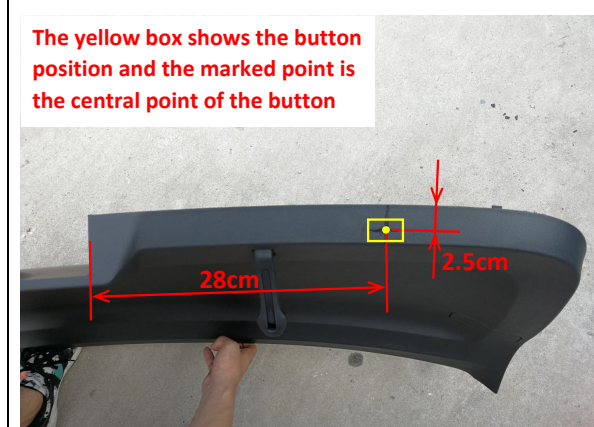

26. Drill a hole at the indicated position of the tailgate trim panel with a $\phi 14$ mm drill bit.



27. Reinstall all trim panels and install the added tailgate switch.

5. System initialization method

1. Press the added tailgate switch button to make the tailgate close automatically;
2. Press the switch button outside the tailgate to open the tailgate and it will make a long sound of "beep".
3. The system initialization is complete.

6. Instructions for the electric tailgate

1. Methods to open and close the tailgate:
 - Long press the tailgate button on the remote key;
 - Press the unlock button on the remote key 3 times;
 - Press the unlock button at the driver's area: press 3 times to close and 6 times to open;
 - Press the original tailgate switch button;
 - Press the added tailgate switch button.

2. Method to pause the tailgate:

During the operation of the tailgate, press the button with any of the above methods, and the tailgate will be paused. Press again, and the tailgate will move in reverse.

3. Method to memorize the height:

Open the tailgate to the height you want to set, long press the added tailgate switch, and release the switch after hearing a long "beep ----". The height memory is complete.
Tip: During the operation of the tailgate, pause the tailgate, and then push the tailgate to the ideal height with your hand.

4. Meanings of the buzzer sound:

"Beep" once: Receiving an open/close or pause signal, the tailgate will immediately open/close or pause;
"Beep" twice: The tailgate has been fully opened or closed;
"Beep" three times: The resistance during opening or closing the tailgate is too large, and the intelligent anti-pinch has been turned on;
Long sound of "beep": The height memory is complete.