

Installation Manual

Compatible Model	CAudi CA6L
Year	2019-2023



8-ETVW-5100-00-00

1. Points to note

- For safety and to ensure the proper use of product, please ask a professional technician to install. Do not disassemble and install it privately in case of damaging product and installation accidents.
- Please arrange each wiring harness according to the wiring method in this manual, be sure to tie each wiring harness to the vehicle's original wiring harness with cable ties. Make sure the wiring harnesses are not located at the fasteners or screw holes to avoid the wiring harnesses crushed by the vehicle interior trim panel buckles and screws during the installation process.
- Because some of the wiring harness terminals (as indicated by the red ellipses below) are not plugged into the wiring harness connectors during manufacture, please insert terminals into the wiring harness connector first to avoid short circuit between terminals after the wiring harnesses have been arranged, then connect other plugs of the wiring harnesses (as indicated by the blue ellipses below) with the original plugs.



- Check the function display of instrument panel before installation, whether the button of the vehicle is working properly, whether the doors and windows work properly while opening and closing, whether there are scratches on the vehicle internal and exterior surfaces; and report to the customers in a timely manner if there are any problems.
- During the process of disassembly and assembly, do not carry metal ornaments and other hard objects with you to prevent damage to the paintwork, seats and interior. Be sure to place the removed trim components properly to avoid scratching them.
- All the pictures in this manual are for reference only, vehicle models with different configurations may have different pictures, but the installation methods are the same.

2. Installation tools

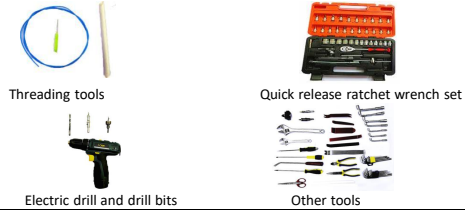

3. Product list

No.	Name	QTY	Picture
①	Strut	2	
②	ECU	1 set	
③	Wiring harness	1 set	
④	Power latch	1	
⑤	Added tailgate switch	1	
⑥	Other parts (screws, brackets, etc.)	1 set	Omitted

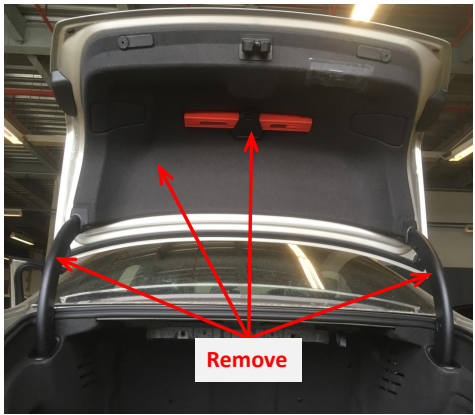

1. Remove the tailgate trim panels.



2. Remove the trunk trim panels.

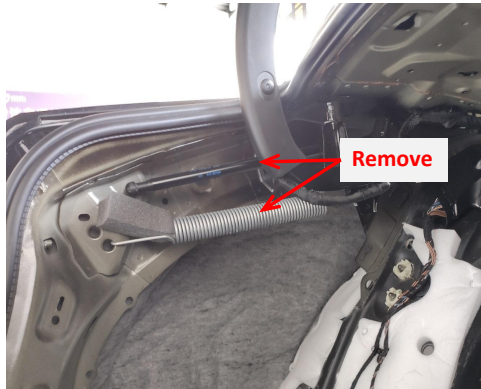

3. Remove the gas strut and the spring from the left side of the trunk.



4. Remove the gas strut and the spring from the right side of the trunk.



5. Install the right body bracket. Insert the bolts with handle from the indicated position into the car body.

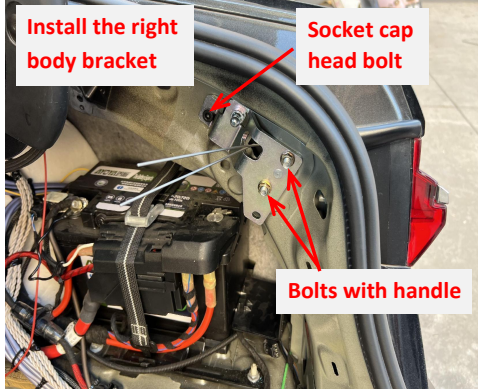

6. Install the right body bracket with the locating pin in the middle hole and tighten the three nuts.

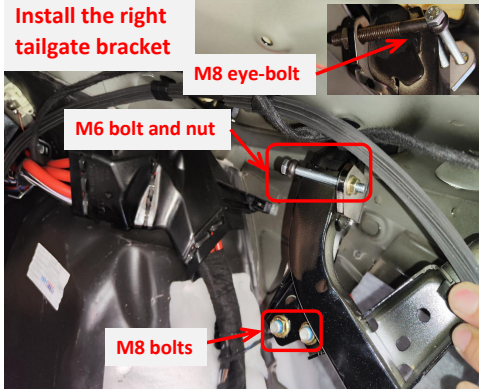

7. Install the right tailgate bracket. Tighten all the nuts according to the diagram.

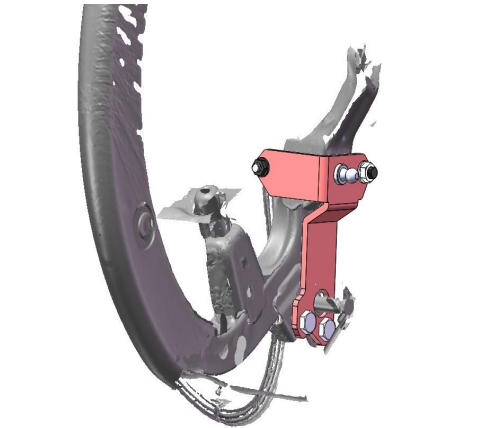

7-1. Model of the tailgate bracket.

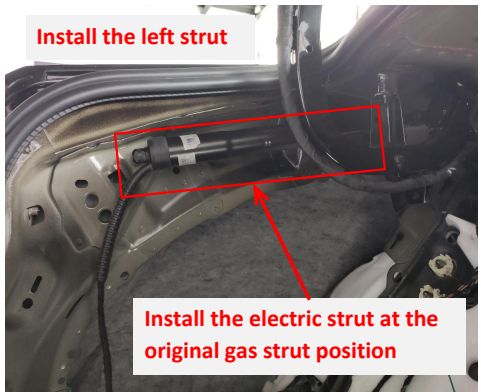

8. Install the left electric strut, L on the left and R on the right (the first letter of the strut code).

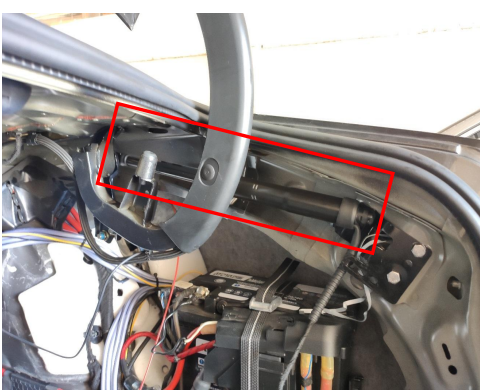

9. Install the right electric strut, L on the left and R on the right (the first letter of the strut code).



10. Hang the left spring back.

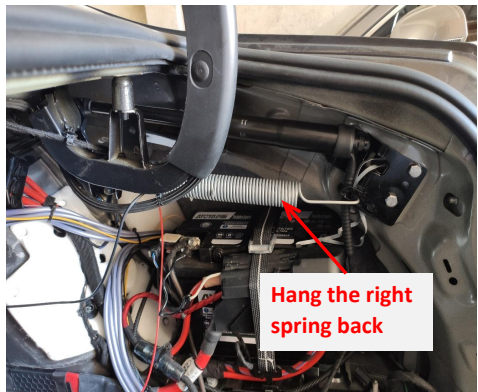

11. Hang the right spring back.

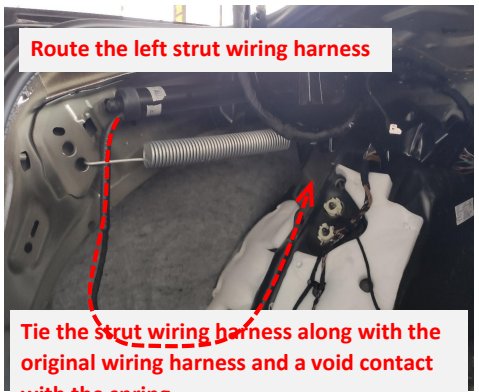

12. Route the left strut wiring harness.

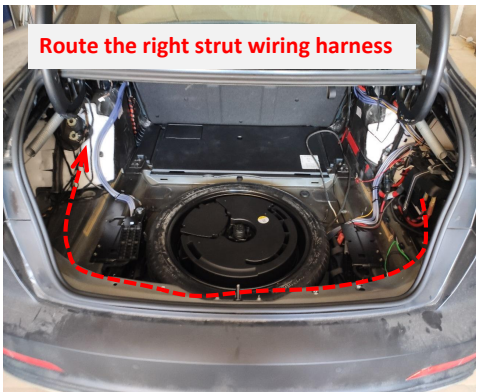

13. Route the right strut wiring harness to the left side.



14. Remove the plastic housing from the tailgate.



15. Connect the plugs of the lock signal harness to the original tailgate switch.

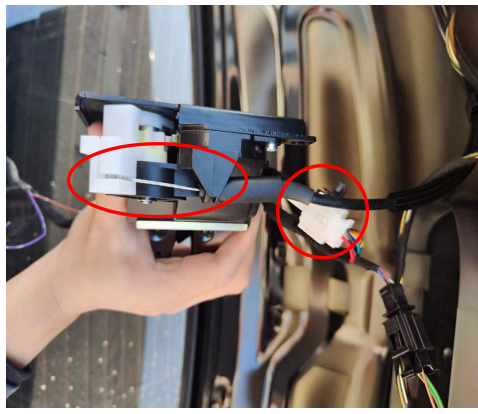

16. Remove the original latch and mount the emergency cable of the original latch onto our power latch.

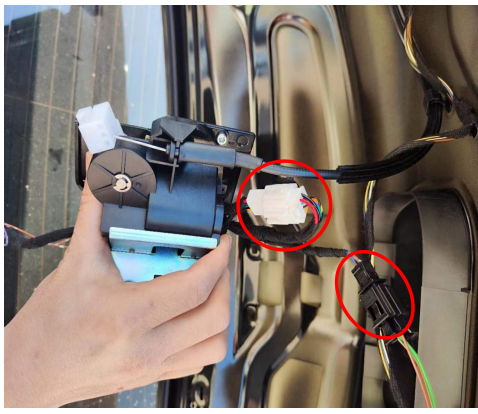





17. Connect the plugs of the lock signal harness to the plugs of the power latch.

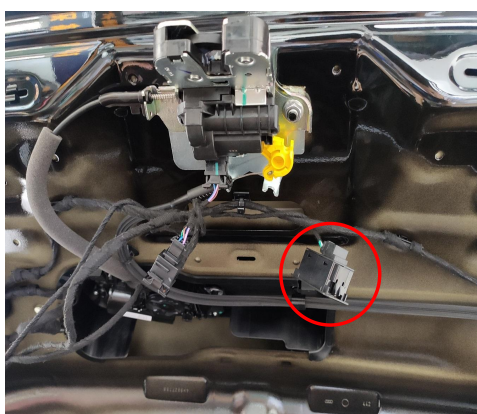

18. Install the power latch. (Manually adjust the latch to the locked state to prevent accidental closing during installation)

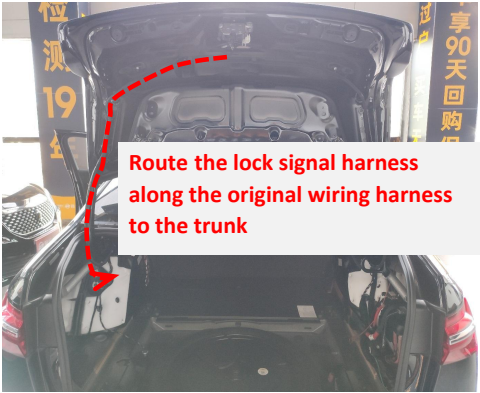

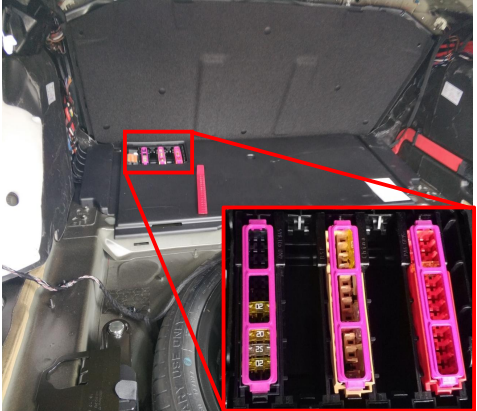
19. Connect the plug of the lock signal harness to the added tailgate switch.

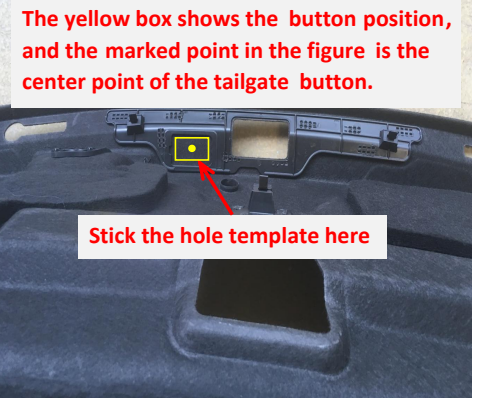
 <p>Route the lock signal harness along the original wiring harness to the trunk</p>	 <p>Hide the emergency wires</p>	 <p>Grounding</p>	<p>Check that all plugs are properly connected; Pull down the emergency cable at the rear seat to unlock and check whether the latch can be unlocked normally to see whether the emergency cable is properly installed.</p>	 <p>Wire points to the right</p>	
20. Route the lock signal harness to the trunk.	21. Hide the two emergency wires of the power latch under the rear left door sill panel.	22. Ground at the left side of the trunk.	23. Check all the plugs and the emergency cable.	24. Connect to the fuse box in the trunk for power supply (all the slots are constant power).	25. Plug the fuse tap into the fuse box and pay attention to the direction.
 <p>Place the ECU at the indicated holes on the left side of trunk and secure it with</p>		<p>1. Adjust the latch to the locked state manually; 2. Manually close the tailgate to the position where the latch touches the striker; 3. Press the original tailgate switch button to open the tailgate and check whether the tailgate can be opened normally and the latch can be unlocked normally; 4. Confirm that the latch, actuator and the electric struts are working correctly before continuing to install.</p>		 <p>The yellow box shows the button position, and the marked point in the figure is the center point of the tailgate button.</p> <p>Stick the hole template here</p>	
26. Install the ECU bracket at the left side of the trunk.	27. Insert the left and right strut wiring harnesses①②, lock signal harness③, and power harness④ into the ECU in sequence.	28. Check if the power latch and the struts function well.	29. Test each function of the electric tailgate.	30. Stick the hole template to the indicated position and open a hold for the installation of the added switch.	31. Reinstall all trim panels and install the added tailgate switch.
<p>5. System initialization method</p> <p>1. Press the added tailgate switch button, and the tailgate will close automatically;</p> <p>2. Press the tailgate switch button outside the tailgate to open the tailgate and it will make a long sound of "beep".</p> <p>3. The system initialization is complete.</p> <p>6. Instructions for the electric tailgate</p> <p>1. Methods to open and close the tailgate:</p> <ul style="list-style-type: none">●Press the tailgate button on the remote key 2 times;●Press the tailgate button at the driver's area;●Press the original tailgate switch button;●Press the added tailgate switch button.	<p>3. Instructions for the added tailgate switch</p> <p>①Closing speed acceleration (5 Settings)</p> <p>1.Press and hold the switch button until hearing the first short beep sound</p> <p>2.After releasing the button, you will hear a short beep, indicating that the closing speed acceleration has taken effect.</p> <p>3.Repeat this step once to increase by one setting.</p> <p>②Opening speed acceleration (5 Settings)</p> <p>1.Press and hold the switch button until hearing the second short beep sound</p> <p>2. After releasing the button, you will hear two short beeps, indicating that the opening speed acceleration has taken effect.</p> <p>3. Repeat this step once to increase by one setting.</p> <p>③Settings of the voice module</p> <p>1.Press and hold the switch button until hearing the third short beep sound.</p> <p>2.After releasing the button, you will hear three short beeps, indicating that the voice module has entered configuration mode. (For details, see the voice module operation manual)</p> <p>④Block the voice module</p> <p>1.Press and hold the switch button until hearing the fourth beep sound.</p>	<p>2.After releasing the button, you will hear four short beeps indicating that the voice module has been blocked.</p> <p>⑤Height setting</p> <p>1.Press and hold the switch button until hearing the fifth short beep sound.</p> <p>2.After releasing the button, you will hear a long beep sound indicating that the height setting has taken effect.</p> <p>⑥Switch between quick/slow press of the unlock button on remote key</p> <p>1.Press and hold the added tailgate switch button until hearing the sixth short beep sound.</p> <p>2.After releasing the button, you will hear a long beep sound and a short beep sound indicating that the switch between quick press and slow press of the unlock button has taken effect.</p> <p>⑦Switch between pressing the unlock button twice/three times</p> <p>1.Press and hold the switch button until hearing the seventh short beep sound.</p> <p>2.After releasing the button, you will hear a long beep sound and two short beeps indicating that the switch between pressing the unlock button twice/three times has taken effect.</p>	<p>⑧Braking force increase (5 Settings)</p> <p>1.Press and hold the switch button until hearing the eighth short beep sound.</p> <p>2.After releasing the button, you will hear a long beep sound and three short beeps indicating that the switch between pressing the unlock button twice/three times has taken effect.</p> <p>⑨Restore to factory settings</p> <p>1.Press and hold the switch button until hearing the ninth short beep sound.</p> <p>2.After releasing the button, you will hear a long beep sound and four short beeps indicating that the restoration to the factory setting has taken effect.</p> <p>4. Meanings of the buzzer sound:</p> <p>"Beep" once: Receiving an open/close or pause signal, the tailgate will immediately open/close or pause;</p> <p>"Beep" twice: The tailgate has been fully opened or closed;</p> <p>"Beep" three times: The resistance during opening or closing the tailgate is too large, and the intelligent anti-pinch has been turned on.</p>		