

Installation Manual

Compatible Model	CBenz E-CClass
Year	2016-2023



8-ETBZ-5010-00-00

1. Points to note

- For safety and to ensure the proper use of product, please ask a professional technician to install. Do not disassemble and install it privately in case of damaging product and installation accidents.
- Please arrange each wiring harness according to the wiring method in this manual, be sure to tie each wiring harness to the vehicle's original wiring harness with cable ties. Make sure the wiring harnesses are not located at the fasteners or screw holes to avoid the wiring harnesses crushed by the vehicle interior trim panel buckles and screws during the installation process.
- Because some of the wiring harness terminals (as indicated by the red ellipses below) are not plugged into the wiring harness connectors during manufacture, please insert terminals into the wiring harness connector first to avoid short circuit between terminals after the wiring harnesses have been arranged, then connect other plugs of the wiring harnesses (as indicated by the blue ellipses below) with the original plugs.



- Check the function display of instrument panel before installation, whether the button of the vehicle is working properly, whether the doors and windows work properly while opening and closing, whether there are scratches on the vehicle internal and exterior surfaces; and report to the customers in a timely manner if there are any problems.
- During the process of disassembly and assembly, do not carry metal ornaments and other hard objects with you to prevent damage to the paintwork, seats and interior. Be sure to place the removed trim components properly to avoid scratching them.
- All the pictures in this manual are for reference only, vehicle models with different configurations may have different pictures, but the installation methods are the same.

2. Installation tools

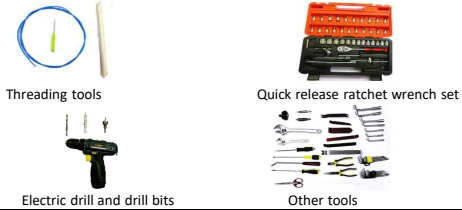

3. Product list

No.	Name	QTY	Picture
①	Strut	2	
②	ECU	1 set	
③	Wiring harness	1 set	
④	Power latch	1	
⑤	Added tailgate switch	1	
⑥	Other parts (screws, brackets, etc.)	1 set	Omitted



1. Remove the trim panels from the tailgate and trunk.

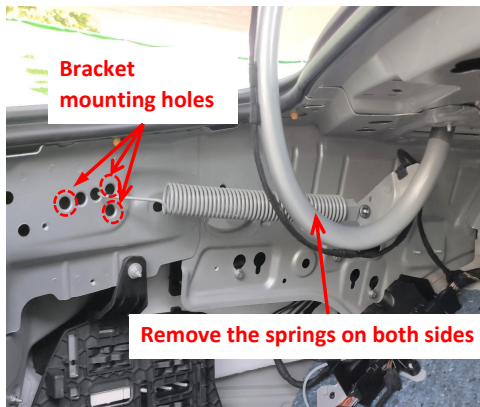

2. Remove the springs on both sides.



3. Remove the spring hanging ring from the left hinge.

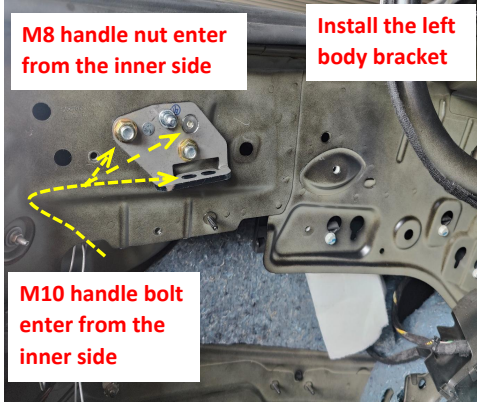

4. Install the left body bracket: thread the M8 handle nut to secure the bracket first and then thread the M10 handle bolt.

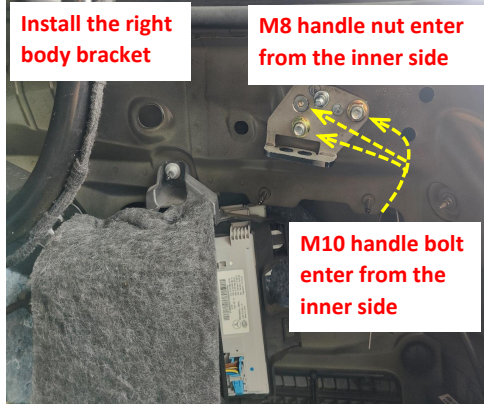

5. Install the right body bracket: thread the M8 handle nut to secure the bracket first and then thread the M10 handle bolt.

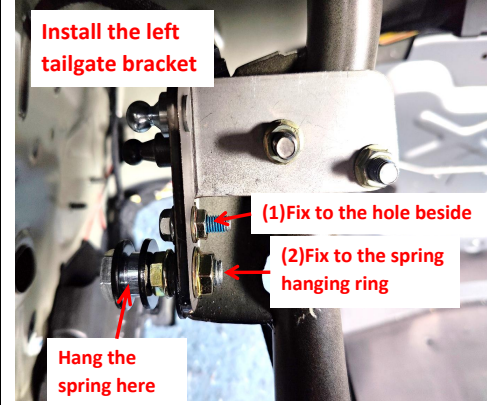

6. Install the left tailgate bracket: remove the M10 nut, thread the M10 bolt through the spring hanging ring and then screw the nut and fasten the M6 bolt.

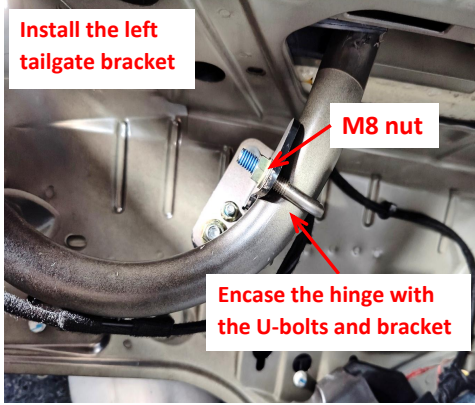

7. Encase the hinge with the U-bolt and bracket and tighten the bolt with the M8 nut.



8. On the right hinge, keep the spring hanging ring and only use the hole beside for securing the bracket.

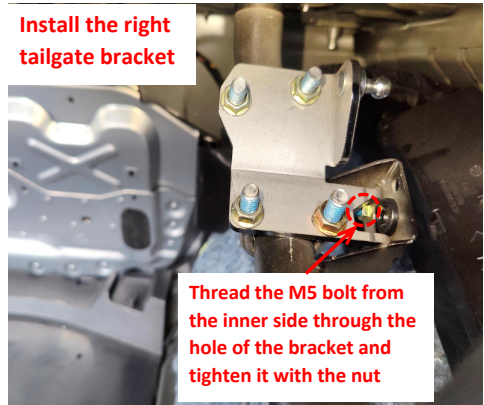

9. Install the right tailgate bracket: thread the M5 bolt through the bracket hole from the inner side and tighten it with the nut.



10. Encase the hinge with the U-bolt and bracket and tighten the bolt with the M8 nut.

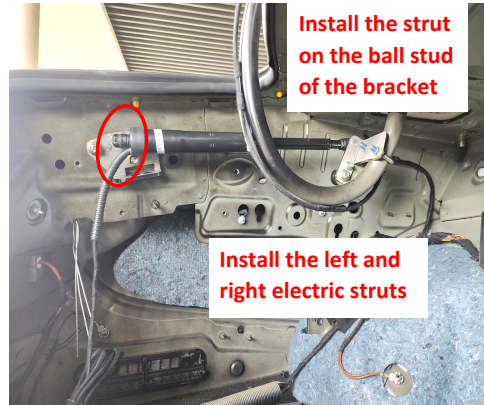

11. Install the left and right electric struts on the ball stud of the bracket (not the original car ball stud).



12. Hang the left springs back. Hang the long end at the body bracket and hang the short end between the two washers.

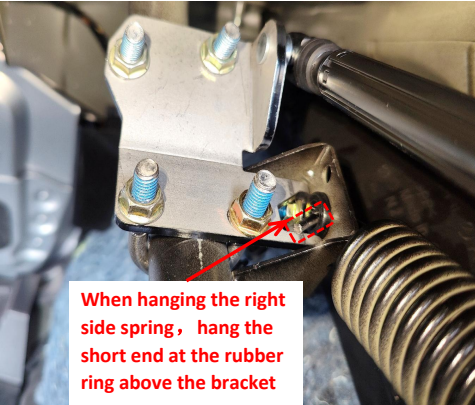

13. Hang the right springs back. Hang the long end of the spring at the body bracket and hang the short at the original spring hanging ring.

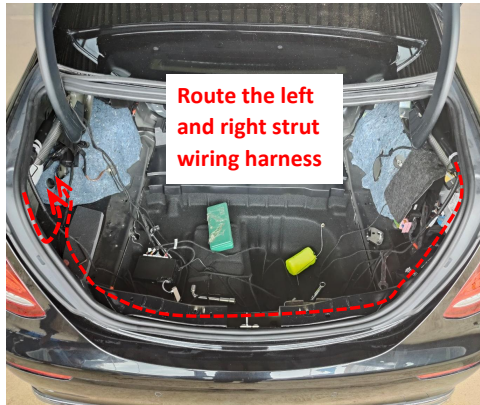

14. Route the left and right strut wiring harnesses to the left side of the trunk.

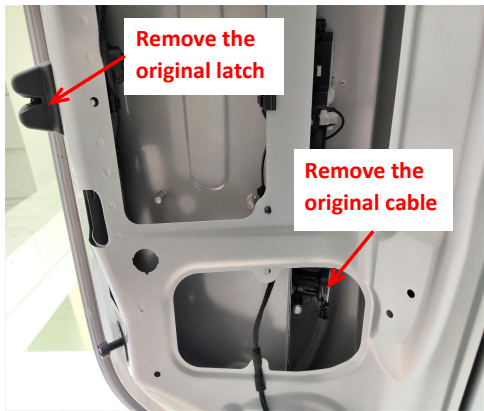

15. Remove the original latch and cable.

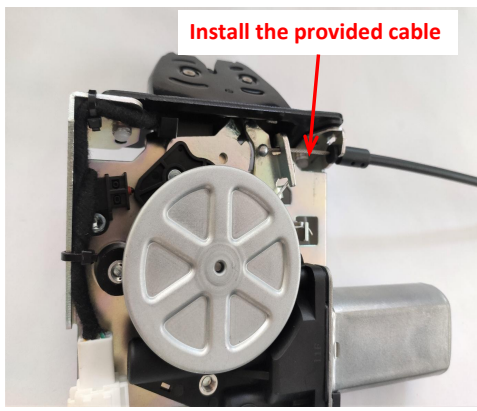

16. Install the provided cable on the power latch.



17. Install the power latch with original screws. Manually adjust the latch to the locked state to prevent accidental closing.



18. Install the emergency cable. (use the mechanical key to ensure the latch can be unlocked)



19. Connect the plugs of the lock signal harness to the plugs of the power latch.

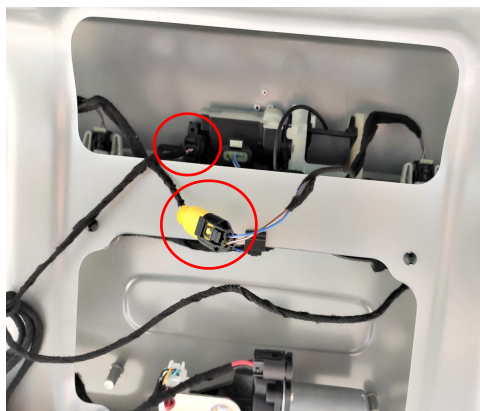

20. Connect the plugs of the lock signal harness to the plugs of original tailgate switch and the added tailgate switch.



 <p>Route the lock signal harness and the emergency wire</p>	 <p>Hide the emergency wire of the lock signal harness under the rear left door sill panel</p>	 <p>Route the power harness Grounding CAN signal</p>		 <p>Connect to the signal plug and its socket</p>	 <p>Fuse slots for power supply</p>
21. Route the lock signal harness and the emergency wire to the trunk along with the left hinge.	22. Thread the emergency wires of the lock signal harness to the rear left door and hide them under the trim panel.	23. Route the power harness (no power connection for now).	24. Ground at the indicated position on the left side of the trunk.	25. Connect to the signal plug behind the fuse box on the right side of the trunk.	26. The fuse slots for power supply is as indicated.
 <p>Plug the fuse tap into the second slot with wire pointing downward</p>					
27. Plug the fuse tap into the second slot and pay attention to the direction.	28. Remove the ECU, place a bolt on the bracket and mount the ECU onto its bracket.	29. Secure the ECU at the indicated position with a nut.	30. Insert the left and right strut wiring harnesses ①②, lock signal harness ③, and power harness ④ into the ECU in sequence.	31. Press the added tailgate switch to close the tailgate once, the system completes initialization, and then test each function of the electric tailgate.	32. Open a hole at the indicated position for installing the added switch.
 <p>Mark the hole position for installing the added switch</p>	 <p>Here is the mark for the hole to be opened</p>	 <p>Stick the hole template to the marked position</p>	 <p>Open the hole</p>	 <p>Fit the added switch in</p>	 <p>Install the added tailgate switch</p>
33. Fasten the trim panel to be pierced, align it with the hole of the sheet metal, and mark the hole position with a pen.	34. Mark it.	35. Stick the hole template to the marked position.	36. Open the hole.	37. Fit the added switch in and check whether it can bounce back normally.	38. Reinstall all trim panels and install the added tailgate switch.
<p><b>5. System initialization method</b></p> <p>1. Press the added tailgate switch button, and the tailgate will close automatically;</p> <p>2. Press the tailgate switch button outside the tailgate to open the tailgate and it will make a long sound of "beep".</p> <p>3. The system initialization is complete.</p> <p><b>6. Instructions for the electric tailgate</b></p> <p>1. Methods to open and close the tailgate:</p> <ul style="list-style-type: none"><li>●Press the tailgate button at the driver's position;</li><li>●Press and hold the tailgate button the remote key;</li><li>●Press the original tailgate switch button;</li><li>●Press the added tailgate switch button.</li></ul>	<p>3. Instructions for the added tailgate switch</p> <p>①Closing speed acceleration (5 Settings)</p> <p>1.Press and hold the switch button until hearing the first short beep sound</p> <p>2.After releasing the button, you will hear a short beep, indicating that the closing speed acceleration has taken effect.</p> <p>3.Repeat this step once to increase by one setting.</p> <p>②Opening speed acceleration (5 Settings)</p> <p>1.Press and hold the switch button until hearing the second short beep sound</p> <p>2. After releasing the button, you will hear two short beeps, indicating that the opening speed acceleration has taken effect.</p> <p>3. Repeat this step once to increase by one setting.</p> <p>③Settings of the voice module</p> <p>1.Press and hold the switch button until hearing the third short beep sound.</p> <p>2.After releasing the button, you will hear three short beeps, indicating that the voice module has entered configuration mode. (For details, see the voice module operation manual)</p> <p>④Block the voice module</p> <p>1.Press and hold the added switch button until hearing the fourth beep sound.</p>	<p>2.After releasing the button, you will hear three four beeps indicating that the voice module has been blocked.</p> <p>⑤Height setting</p> <p>1.Press and hold the switch button until hearing the fifth short beep sound.</p> <p>2.After releasing the button, you will hear a long beep sound indicating that the height setting has taken effect.</p> <p>⑥Switch between quick/slow press of the unlock button on remote key</p> <p>1.Press and hold the added tailgate switch button until hearing the sixth short beep sound.</p> <p>2.After releasing the button, you will hear a long beep sound and a short beep sound indicating that the switch between quick press and slow press of the unlock button has taken effect.</p> <p>⑦Switch between pressing the unlock button twice/three times</p> <p>1.Press and hold the switch button until hearing the seventh short beep sound.</p> <p>2.After releasing the button, you will hear a long beep sound and two short beeps indicating that the switch between pressing the unlock button twice/three times has taken effect.</p>	<p>⑧Braking force increase (5 Settings)</p> <p>1.Press and hold the unlock button until hearing the eighth short beep sound.</p> <p>2.After releasing the button, you will hear a long beep sound and three short beeps indicating that the switch between pressing the unlock button twice/three times has taken effect.</p> <p>⑨Restore to factory settings</p> <p>1.Press and hold the unlock button until hearing the ninth short beep sound.</p> <p>2.After releasing the button, you will hear a long beep sound and four short beeps indicating that the restoration to the factory setting has taken effect.</p> <p>4. Meanings of the buzzer sound:</p> <p>"Beep" once: Receiving an open/close or pause signal, the tailgate will immediately open/close or pause;</p> <p>"Beep" twice: The tailgate has been fully opened or closed;</p> <p>"Beep" three times: The resistance during opening or closing the tailgate is too large, and the intelligent anti-pinch has been turned on.</p>		