

Installation Manual

Compatible Model	CAudi CQ2L
Year	2018-2021



8-ETVW-5119-00-00

1. Points to note

- For safety and to ensure the proper use of product, please ask a professional technician to install. Do not disassemble and install it privately in case of damaging product and installation accidents.
- Please arrange each wiring harness according to the wiring method in this manual, be sure to tie each wiring harness to the vehicle's original wiring harness with cable ties. Make sure the wiring harnesses are not located at the fasteners or screw holes to avoid the wiring harnesses crushed by the vehicle interior trim panel buckles and screws during the installation process.
- Because some of the wiring harness terminals (as shown in the red ellipses below) are not inserted into the wiring harness connectors during manufacture, please insert terminals into the wiring harness connector first to avoid short circuit between terminals after the wiring harnesses have been arranged, then connect other plugs of the wiring harnesses (as shown in the blue ellipses below) with the original plugs.



- Check the function display of instrument panel before installation, whether the button of the vehicle is working properly, whether the doors and windows work properly while opening and closing, whether there are scratches on the internal and external surfaces of the vehicle; and report to the customers in a timely manner if there are any problems.
- During the process of disassembly and assembly, do not carry metal ornaments and other hard objects with you to prevent damage to the paintwork, seats and interior. Be sure to place the removed trim components properly to avoid scratching them.
- All the pictures in this manual are for reference only, vehicle models with different configurations may have different pictures, but the installation methods are the same.

2. Installation tools

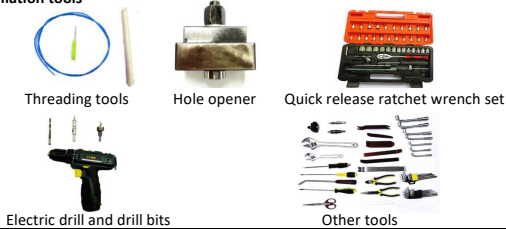

3. Product list

No.	Name	QTY	Picture
①	Strut	2	
②	ECU	1 set	
③	Wiring harness	1 set	
④	Power latch	1	
⑤	Added tailgate switch	1	
⑥	Other accessories (screws, brackets, etc.)	1 set	Omitted



1. Remove the front left side trim panel, door sill panel and storage box.



2. Remove the rear left door sill panel and B-pillar trim panel.



3. Remove the screws on the tailgate trim panel.

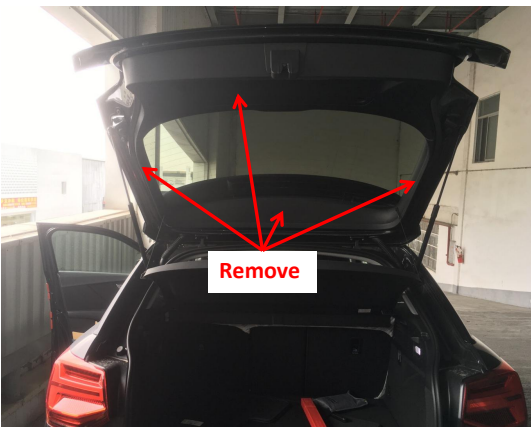

4. Remove the tailgate trim panels.



5. Remove the trunk floor mat.

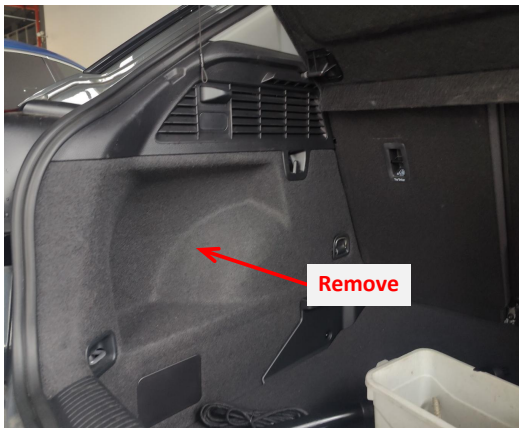

6. Remove the indicated trim panel from the trunk.



7. Thread the lock signal harness to the left side of the trunk through the original rubber tube.(no plug connection for now)

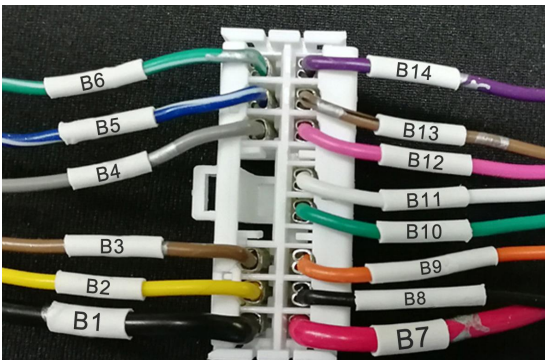

Note: For models with fewer than 14 wires, just insert them according to the corresponding label or color.

8. Insert the lock signal terminals into the wiring harness connector and fasten it inward.



9. Remove the original latch and install our power latch.

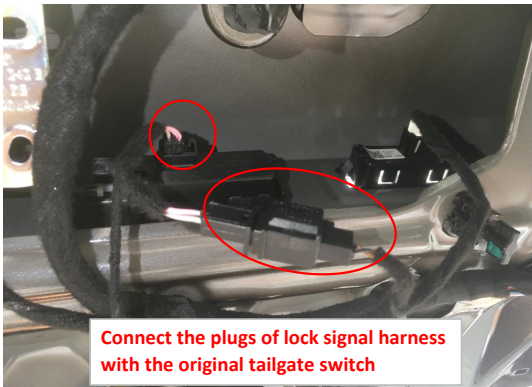

10. Two plugs(A&B) are reserved. Choose one plug to connect to the original tailgate switch. After finishing the tailgate installation, test if it works. If not, choose the other plug.



11. Connect the plugs of the lock signal harness to the power latch.



12. Connect the plug of lock signal harness to the added tailgate switch.



13. Remove the gas struts.

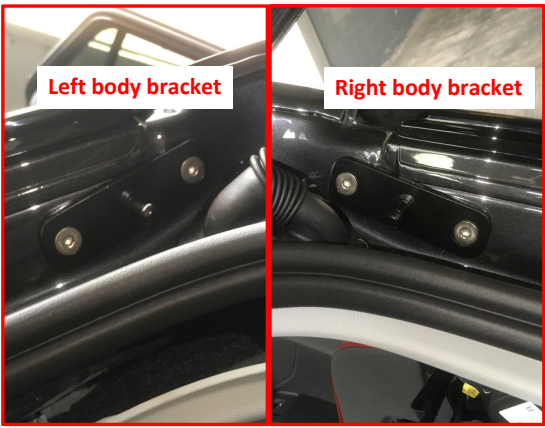

14. Replace the body brackets on both sides of the trunk.



15. Install the electric struts, L on the left R on the right (the first letter of the strut code).



16. Drill a hole at the indicated position on both sides of the tailgate with a φ21mm drill bit.

				
17. Thread the strut wiring harnesses to the trunk as indicated; both sides are the same.	18.Thread the strut wiring harnesses through the rubber tubes on both sides to the trunk and route them to the left side.	19. Route the power harness.	20. Ground at the indicated position on the left side of the trunk.	21. Find out the CAN box behind the fuse box at the driver's position and connect to the indicated plug and its socket.
				
22. Plug the fuse tap into the indicated slot.	23. Secure the ECU at the indicated position.	24.Insert the strut wire harnesses ①②, lock signal harness ③, and power harness④ into the ECU in sequence.	25. Initialize the system and test each function of the electric tailgate.	26. Drill a hole at the indicated position on the right side of the tailgate trim panel with a φ14mm drill bit.
		<p>5. System initialization method</p> <p>1. Press the added tailgate switch button to make the tailgate close automatically;</p> <p>2. Press the switch button outside the tailgate to open the tailgate and it will make a long sound of "beep".</p> <p>3. The system initialization is complete.</p> <p>6. Instructions for the electric tailgate</p> <p>1. Methods to open and close the tailgate:</p> <ul style="list-style-type: none">●Press and hold the tailgate button on the remote key;●Press the unlock button at the driver's area 3 times;●Press the original tailgate switch button;●Press the added tailgate switch button. <p>2. Method to pause the tailgate:</p> <p>During the operation of the tailgate, press the button with any of the above methods, and the tailgate will be paused. Press again, and the tailgate will move in reverse.</p>	<p>3. Instructions for the added tailgate switch</p> <p>①Closing speed acceleration</p> <p>Press and hold the added switch button on tailgate until hearing a beep sound. When the tailgate makes a short beep sound again, the close speed acceleration is complete. (There are five speed settings. Repeat this step once to increase by one setting.)</p> <p>②Opening speed acceleration</p> <p>Press and hold the added switch button on tailgate until hearing two beep sounds. When the tailgate makes two short beep sounds again, the open speed acceleration is complete. (There are five speed settings. Repeat this step once to increase by one setting.)</p> <p>③Height setting</p> <p>Press and hold the added switch button on tailgate until hearing three beep sounds. When the tailgate makes three short beep sounds again, the height setting is complete. Tip: During the operation of the tailgate, pause the tailgate, and then push the tailgate to the ideal height.</p> <p>④Switch between quick/slow press of the unlock button on remote key</p> <p>Press and hold the added switch button on tailgate until hearing four beep sounds. When the tailgate makes four short beep sounds again, the switch of pressing way is complete.</p>	<p>⑤Switch between pressing the unlock button twice/three times</p> <p>Press and hold the added switch button on tailgate until hearing five beep sounds. When the tailgate makes a long beep sound, the switch of pressing times is complete.</p> <p>⑥Braking force increase (Retention force for open)</p> <p>Press and hold the added switch button on tailgate until hearing six beep sounds. When the tailgate makes two long beep sounds, the braking force increase is complete. (There are five speed settings. Repeat this step once to increase by one setting.)</p> <p>⑦Restore to factory settings</p> <p>Press and hold the added switch button on tailgate until hearing seven beep sounds. When the tailgate makes three long beep sounds, the reset is complete.</p> <p>4. Meanings of the buzzer sound:</p> <p>"Beep" once: Receiving an open/close or pause signal, the tailgate will immediately open/close or pause;</p> <p>"Beep" twice: The tailgate has been fully opened or closed;</p> <p>"Beep" three times: The resistance during opening or closing the tailgate is too large, and the intelligent anti-pinch has been turned on;</p> <p>Long sound of "beep": The height memory is complete.</p>
27. Reinstall the tailgate trim panel. Note: Slight trimming is required for any interfering parts	28. Reinstall all trim panels and install the added tailgate switch.			