

# Installation Manual

Compatible Model	CRange Rover CSport
Year	2014-2017



8-ETLR-5102-00-00

### 1. Points to note

- For safety and to ensure the proper use of product, please ask a professional technician to install. Do not disassemble and install it privately in case of damaging product and installation accidents.
- Please arrange each wiring harness according to the wiring method in this manual, be sure to tie each wiring harness to the vehicle's original wiring harness with cable ties. Make sure the wiring harnesses are not located at the fasteners or screw holes to avoid the wiring harnesses crushed by the vehicle interior trim panel buckles and screws during the installation process.
- Because some of the wiring harness terminals (as shown in the red ellipses below) are not inserted into the wiring harness connectors during manufacture, please insert terminals into the wiring harness connector first to avoid short circuit between terminals after the wiring harnesses have been arranged, then connect other plugs of the wiring harnesses (as shown in the blue ellipses below) with the original plugs.



- Check the function display of instrument panel before installation, whether the button of the vehicle is working properly, whether the doors and windows work properly while opening and closing, whether there are scratches on the internal and external surfaces of the vehicle; and report to the customers in a timely manner if there are any problems.
- During the process of disassembly and assembly, do not carry metal ornaments and other hard objects with you to prevent damage to the paintwork, seats and interior. Be sure to place the removed trim components properly to avoid scratching them.
- All the pictures in this manual are for reference only, vehicle models with different configurations may have different pictures, but the installation methods are the same.

### 2. Installation tools

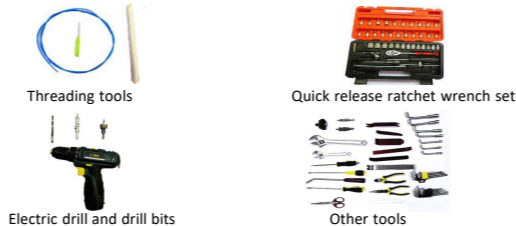

### 3. Product list

No.	Name	QTY	Picture
①	Strut	2	
②	ECU	1 set	
③	Wiring harness	1 set	
④	Added tailgate switch	1	
⑤	Other parts (screws, brackets, etc.)	1 set	Omitted



1. Remove the tailgate trim panels.

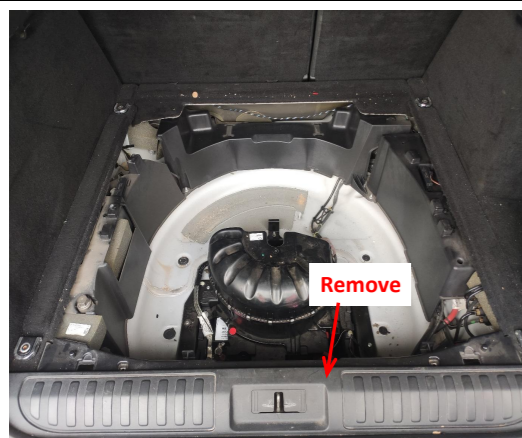

2. Take out the trunk liner, spare tire, and remove the door sill trim panel from the trunk.



3. Remove the trim panel from the right side of the trunk to allow the power harness to pass through.



4. Remove the original gas struts.



5. Install the electric struts, L on the left and R on the right (the first letter of the strut code), making sure the ends with wiring harnesses are on the tailgate.



6. Remove the indicated rubber plug to allow the strut wiring harness to pass through and then plug hole tightly. Both sides follow the same method.



7. Route the strut wiring harnesses to the tailgate.



8. Unplug the indicated plug from the original power latch.



9. Remove the original power latch(for easy connection of the plugs), connect the plugs of the lock signal harness to the power latch and then put the power latch back.



10. Plug the previous plug back in.

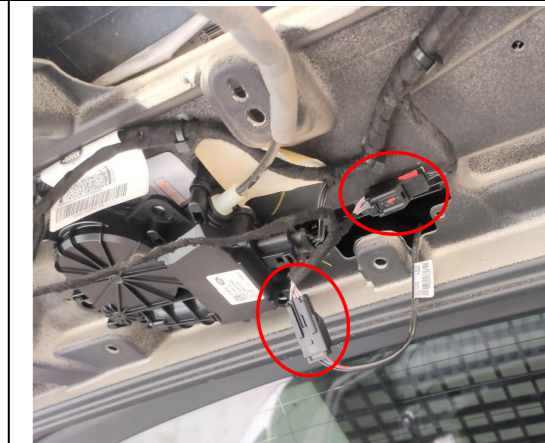

11. Connect the plugs of the lock signal harness to the plugs of the tailgate switch.



12. Install the added tailgate switch (remove the original cover panel here).



13. Disassemble the spoiler to allow the power harness to pass through.



14. Route the power harness to the tailgate (wiring only, no power or plug connection).

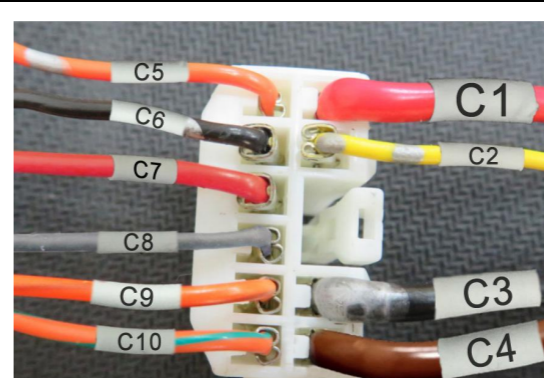

Note: For models with fewer than 10 wires, just insert them according to the corresponding label or color.

15. Insert the power harness terminals into the wiring harness connector according to the diagram.

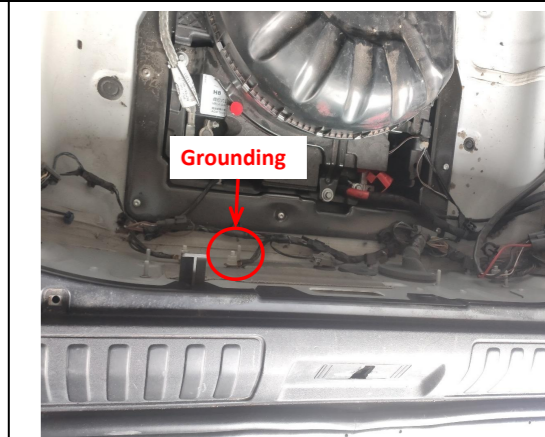

16. Ground at the indicated position on the tailgate.



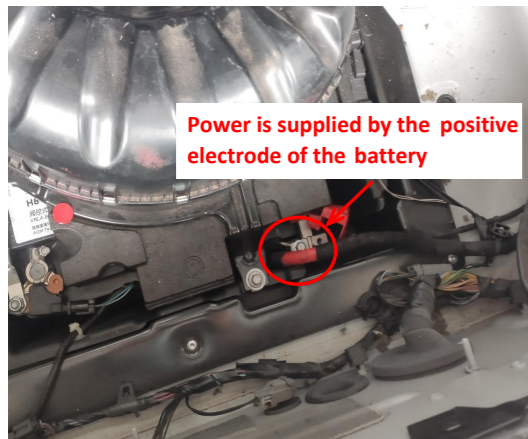

Power is supplied by the positive electrode of the battery

17. Connect to the positive electrode of the battery under the spare tire of the trunk for power supply.



18. Insert the strut wiring harnesses ① ②, lock signal harness ③, and power harness ④ into the ECU in sequence.

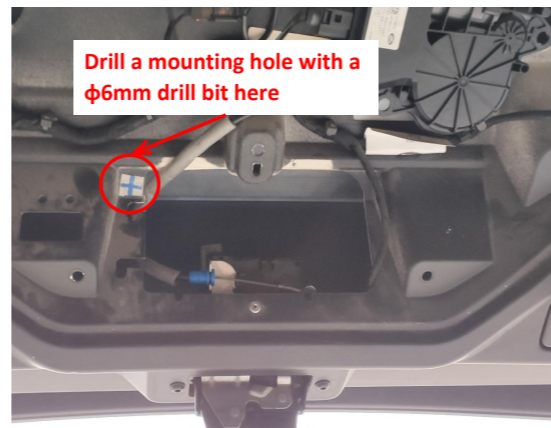

Drill a mounting hole with a  $\phi 6\text{mm}$  drill bit here

19. Drill a mounting hole at the indicated position with a  $\phi 6\text{mm}$  drill bit for the ECU bracket.



20. Press the added tailgate switch to open and close the tailgate once, the system completes initialization, and then test each function of the electric tailgate.



21. Reinstall all the trim panels and fit the added tailgate switch button in.

**5. System initialization method**  
 1. Press the added tailgate switch button to make the tailgate close automatically;  
 2. Press the switch button outside the tailgate to open the tailgate and it will make a long sound of "beep".  
 3. The system initialization is complete.

**6. Instructions for the electric tailgate**  
 1. Methods to open and close the tailgate:  
 ● Press and hold the tailgate button on the remote key;  
 ● Press and hold the tailgate button at the driver's area;  
 ● Press the original tailgate switch button;  
 ● Press the added tailgate switch button.

2. Method to pause the tailgate:  
 During the operation of the tailgate, press the button with any of the above methods, and the tailgate will be paused. Press again, and the tailgate will move in reverse.

3. Method to memorize the height:  
 Open the tailgate to the height you want to set, long press the added tailgate switch, and release the switch after hearing a long "beep ----". The height memory is complete.  
 Tip: During the operation of the tailgate, pause the tailgate, and then push the tailgate to the ideal height with your hand.

4. Meanings of the buzzer sound:  
 "Beep" once: Receiving an open/close or pause signal, the tailgate will immediately open/close or pause;  
 "Beep" twice: The tailgate has been fully opened or closed;  
 "Beep" three times: The resistance during opening or closing the tailgate is too large, and the intelligent anti-pinch has been turned on;  
 Long sound of "beep": The height memory is complete.