

Installation Manual

Compatible Model	CROX 01
Year	2024



8-ETJS-5001-00-00

1. Points to note

- For safety and to ensure the proper use of product, please ask a professional technician to install. Do not disassemble and install it privately in case of damaging product and installation accidents.
- Please arrange each wiring harness according to the wiring method in this manual, be sure to tie each wiring harness to the vehicle's original wiring harness with cable ties. Make sure the wiring harnesses are not located at the fasteners or screw holes to avoid the wiring harnesses crushed by the vehicle interior trim panel buckles and screws during the installation process.
- Because some of the wiring harness terminals (as shown in the red ellipses below) are not inserted into the wiring harness connectors during manufacture, please insert terminals into the wiring harness connector first to avoid short circuit between terminals after the wiring harnesses have been arranged, then connect other plugs of the wiring harnesses (as shown in the blue ellipses below) with the original plugs.



- Check the function display of instrument panel before installation, whether the button of the vehicle is working properly, whether the doors and windows work properly while opening and closing, whether there are scratches on the internal and external surfaces of the vehicle; and report to the customers in a timely manner if there are any problems.
- During the process of disassembly and assembly, do not carry metal ornaments and other hard objects with you to prevent damage to the paintwork, seats and interior. Be sure to place the removed trim components properly to avoid scratching them.
- All the pictures in this manual are for reference only, vehicle models with different configurations may have different pictures, but the installation methods are the same.

2. Installation tools

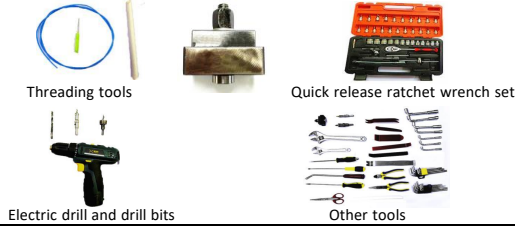

3. Product list

No.	Name	QTY	Picture
①	Strut	1	
②	ECU	1 set	
③	Wire harness	1 set	
④	Added tailgate switch	1	
⑤	Other parts (screws, brackets, etc.)	1 set	Omitted

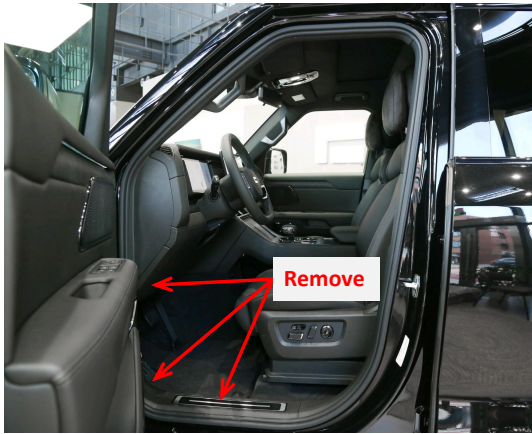

1. Remove the indicated driver side trim panels.



2. Remove the rear left door sill panel.

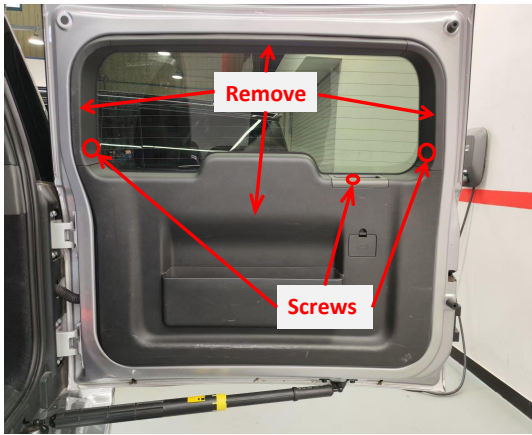

3. Remove the tailgate trim panels and pay attention to the screws.

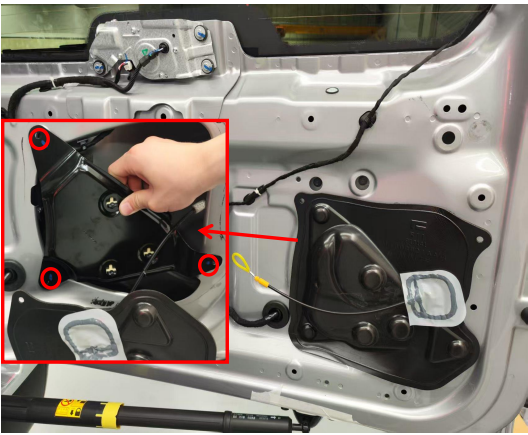

4. Remove the triangular cover and the indicated three screws.

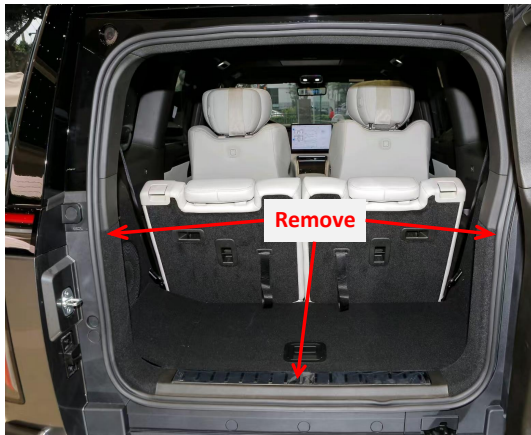

5. Take out the trunk floor mat and remove the indicated trim panels on both sides and the bottom.

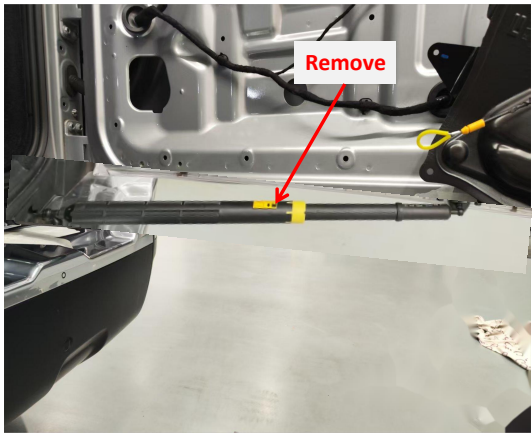

6. Remove the original gas strut.



7. Replace the tailgate bracket and use the provided screws.

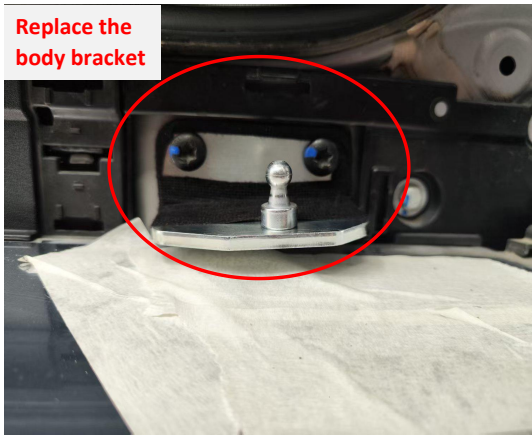

8. Replace the body bracket and use the original screws.

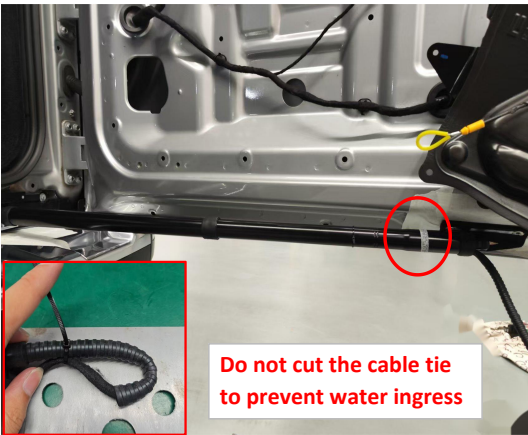

9. Install the electric strut and the end with wiring harness should be on the tailgate.



10. Drill a  $\phi 21\text{mm}$  hole at the indicated position to allow the strut wire harness to pass through and plug the hole.



11. Remove the original latch and connect the T-harness of the lock signal harness to corresponding connectors of the latch.

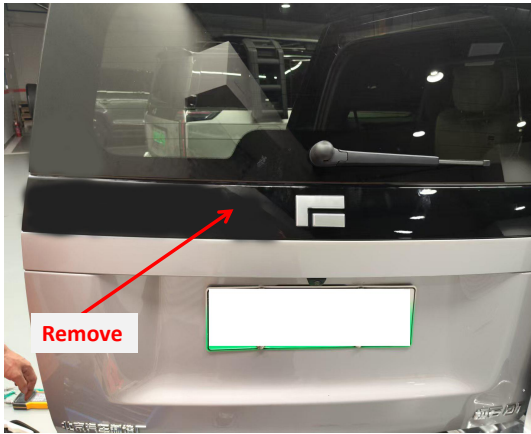

12. Remove the indicated trim panel below the wiper.

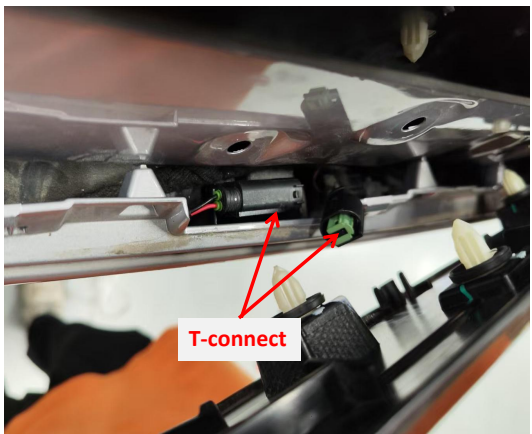

13. Connect the T-harness of the lock signal harness to the corresponding connectors of the tailgate handle switch.

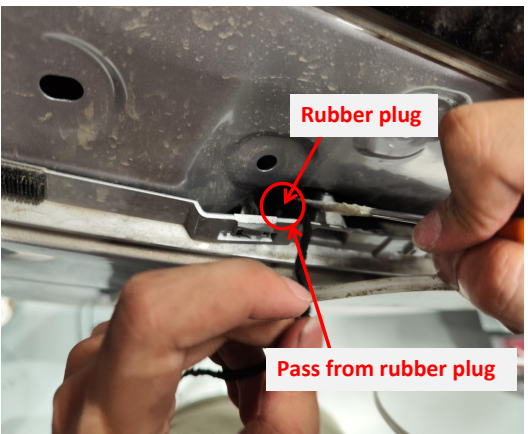

14. Pass the pink signal wire(B12) through the inner hole plug to the other side of the tailgate.





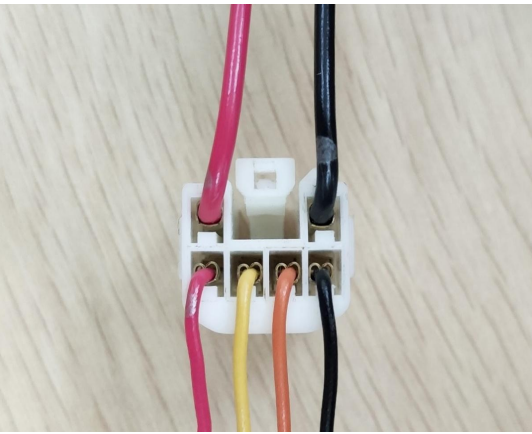



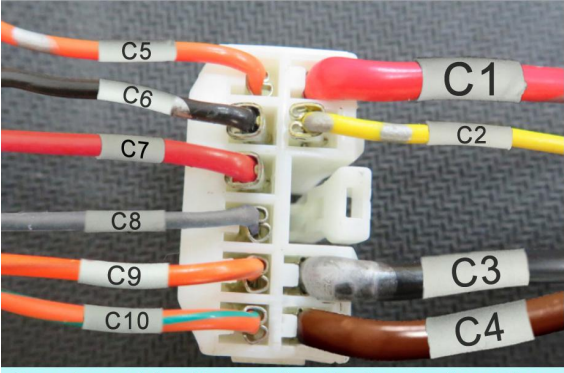

15. Route the power harness to the tailgate as indicated.(no plug connection for now)

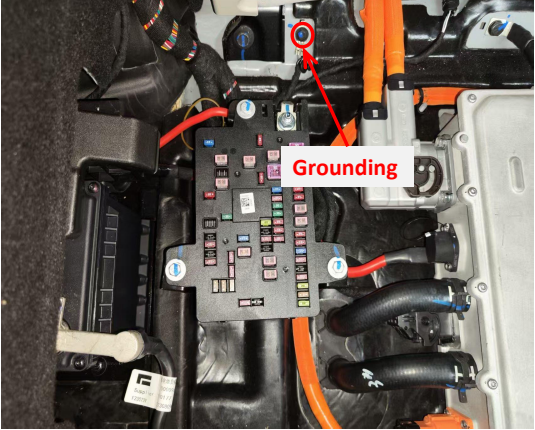
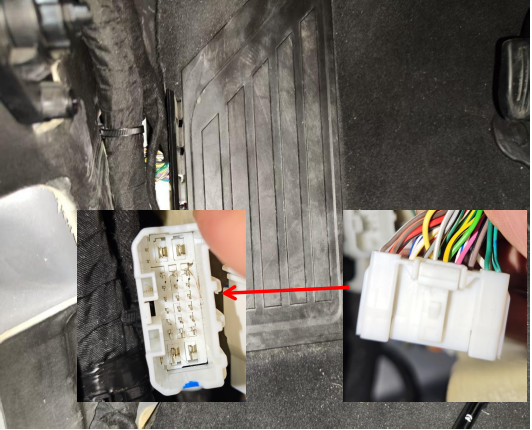
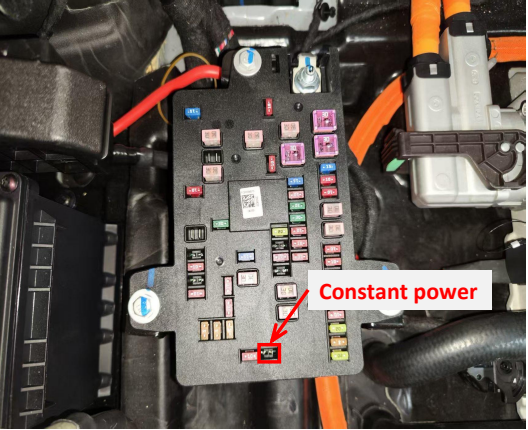
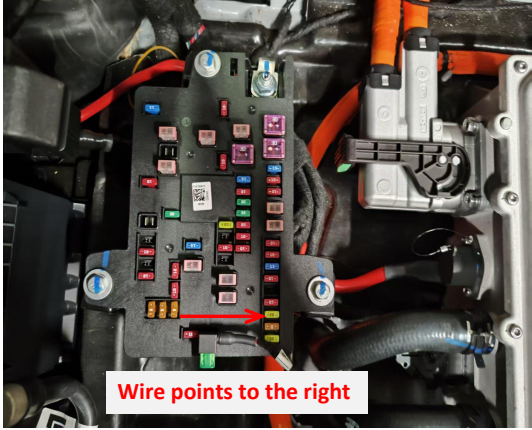

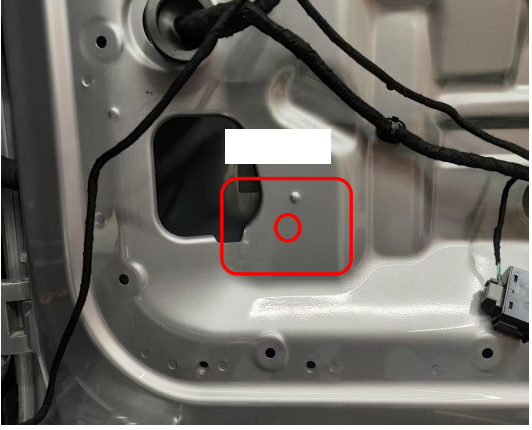
16. Insert the strut wire harness terminals into the connector according to the diagram.

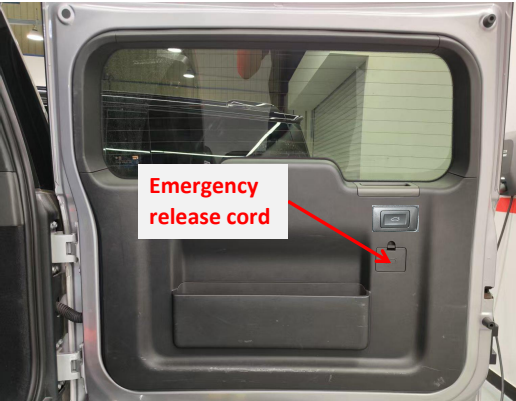

<div><p>Note: For models with fewer than 14 wires, just insert them according to the corresponding label or color.</p></div> <div>17. Insert the signal terminal(B12) of the tailgate handle switch into the connector according to the diagram.</div>	<div><p>Note: For models with fewer than 10 wires, just insert them according to the corresponding label or color.</p></div> <div>18. Insert the power harness terminals into the connector according to the diagram.</div>	<div><p>Unlock signal</p><p>Grounding</p><p>Power supply</p></div> <div>19. Route the unlock signal harness of the power harness to the left side of the driver's area.</div>	<div><p>Grounding</p></div> <div>20. Ground at the left side of the trunk.</div>	<div></div> <div>21. Connect the T-harness of the unlock signal harness to the indicated signal connectors beside the pedals.</div>
<div><p>Constant power</p></div> <div>22. The fuse box is located at the left side of the trunk and the fuse slot for power supply is as indicated.</div>	<div><p>Wire points to the right</p></div> <div>23. Plug the fuse tap into the fuse box and pay attention to the direction of wire.</div>	<div></div> <div>24. Drill a hole at the indicated position with a φ6mm drill bit.</div>	<div></div> <div>25. Secure the ECU at the hole with a nut.</div>	<div><p>Do not plug the strut wire harness into this socket</p></div> <div>26. Insert the left and right strut wire harnesses①, lock signal harness②, and power harness③ into the ECU in sequence.</div>
<div></div> <div>27. Manually close the tailgate, and press the button on the tailgate handle to complete the system initialization, and then test each function of the electric tailgate.</div>	<div></div> <div>28. Open a hole at the indicated position with the hole opener for installing the added tailgate switch.</div>	<div><p>Emergency release cord</p></div> <div>29. Install the added tailgate switch and reinstall all trim panels (the emergency release cord should be pulled out of the cover).</div>	<p>Due to the side-opening door design of this vehicle and the significant blind spots it creates, it is not recommended to install a control switch in the driver's area.</p>	
<div>3. Instructions for the added tailgate switch</div> <div>①Closing speed acceleration (5 Settings)</div> <div>1.Press and hold the switch button until hearing the first short beep sound.</div> <div>2.After releasing the button, you will hear a short beep, indicating that the closing speed acceleration has taken effect.</div> <div>3.Repeat this step once to increase by one setting.</div> <div>②Opening speed acceleration (5 Settings)</div> <div>1.Press and hold the switch button until hearing the second short beep sound</div> <div>2. After releasing the button, you will hear two short beeps, indicating that the opening speed acceleration has taken effect.</div> <div>3. Repeat this step once to increase by one setting.</div> <div>③Settings of the voice module</div> <div>1.Press and hold the switch button until hearing the third short beep sound.</div> <div>2.After releasing the button, you will hear three short beeps, indicating that the voice module has entered configuration mode. (For details, see the voice module operation manual)</div> <div>④Block the voice module</div> <div>1.Press and hold the added switch button until hearing the fourth beep sound.</div> <div>2.After releasing the button, you will hear four short beeps indicating that the voice module has been blocked.</div>	<div>⑤Height setting</div> <div>1.Press and hold the switch button until hearing the fifth short beep sound.</div> <div>2.After releasing the button, you will hear a long beep sound indicating that the height setting has taken effect.</div> <div>⑥Switch between quick/slow press of the unlock button on remote key</div> <div>1.Press and hold the switch button until hearing the sixth short beep sound.</div> <div>2.After releasing the button, you will hear a long beep sound and a short beep sound indicating that the switch between quick and slow press of the unlock button has taken effect.</div> <div>⑦Switch between pressing the unlock button twice/three times</div> <div>1.Press and hold the switch button until hearing the seventh short beep sound.</div> <div>2.After releasing the button, you will hear a long beep sound and two short beeps indicating that the switch between pressing the unlock button twice/three times has taken effect.</div> <div>⑧Braking force increase (five settings)</div> <div>1.Press and hold the unlock button until hearing the eighth short beep sound.</div> <div>2.After releasing the button, you will hear a long beep sound and three short beeps indicating that the switch between pressing the unlock button twice/three times has taken effect.</div> <div>3.Repeat this step to increase by one setting.</div>	<div>⑨Restore to factory settings</div> <div>1.Press and hold the unlock button until hearing the ninth short beep sound.</div> <div>2.After releasing the button, you will hear a long beep sound and four short beeps indicating that the restoration to the factory setting has taken effect.</div> <div>4. Meanings of the buzzer sound:</div> <div>"Beep" once: Receiving an open/close or pause signal, the tailgate will immediately open/close or pause;</div> <div>"Beep" twice: The tailgate has been fully opened or closed;</div> <div>"Beep" three times: The resistance during opening or closing the tailgate is too large, and the intelligent anti-pinch has been turned on.</div>	<div>5. System initialization method</div> <div>1. Press the added tailgate switch button to make the tailgate close automatically;</div> <div>2. Press the switch button outside the tailgate to open the tailgate and it will make a long sound of "beep".</div> <div>3. The system initialization is complete.</div> <div>6. Instructions for the electric tailgate</div> <div>1. Methods to open and close the tailgate:</div> <div>●Press the unlock button on the remote key 3 times;</div> <div>●Press the button on the tailgate handle (open only);</div> <div>●Press the added tailgate switch button.</div> <div>2. Method to pause the tailgate:</div> <div>During the operation of the tailgate, press the button with any of the above methods, and the tailgate will be paused. Press again, and the tailgate will move in reverse.</div>	