

Installation Manual

Compatible Model	CBenz CCLA
Year	2015-2020



1. Points to note

- For safety and to ensure the proper use of product, please ask a professional technician to install. Do not disassemble and install it privately in case of damaging product and installation accidents.
- Please arrange each wiring harness according to the wiring method in this manual, be sure to tie each wiring harness to the vehicle's original wiring harness with cable ties. Make sure the wiring harnesses are not located at the fasteners or screw holes to avoid the wiring harnesses crushed by the vehicle interior trim panel buckles and screws during the installation process.
- Because some of the wiring harness terminals (as shown in the red ellipses below) are not inserted into the wiring harness connectors during manufacture, please insert terminals into the wiring harness connector first to avoid short circuit between terminals after the wiring harnesses have been arranged, then connect other plugs of the wiring harnesses (as shown in the blue ellipses below) with the original plugs.



- Check the function display of instrument panel before installation, whether the button of the vehicle is working properly, whether the doors and windows work properly while opening and closing, whether there are scratches on the internal and external surfaces of the vehicle; and report to the customers in a timely manner if there are any problems.
- During the process of disassembly and assembly, do not carry metal ornaments and other hard objects with you to prevent damage to the paintwork, seats and interior. Be sure to place the removed trim components properly to avoid scratching them.
- All the pictures in this manual are for reference only, vehicle models with different configurations may have different pictures, but the installation methods are the same.

2. Installation tools

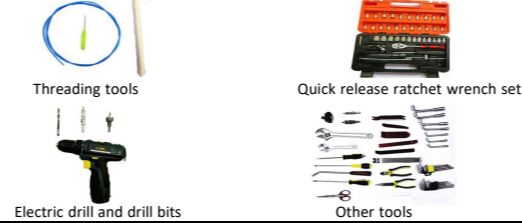

3. Product list

No.	Name	QTY	Picture
①	Strut	2	
②	ECU	1 set	
③	Wiring harness	1 set	
④	Power latch	1	
⑤	Added tailgate switch	1	
⑥	Other parts (screws, brackets, etc.)	1 set	Omitted



1. Remove the tailgate trim panels.



2. Remove the trunk trim panels



3. Remove the front right side door sill panel, lift up the floor mat and find out the fuse box.



4. Remove the rear right side door sill panels.



5. Remove the original springs from the both sides of the trunk.



6. Remove the spring hangers.

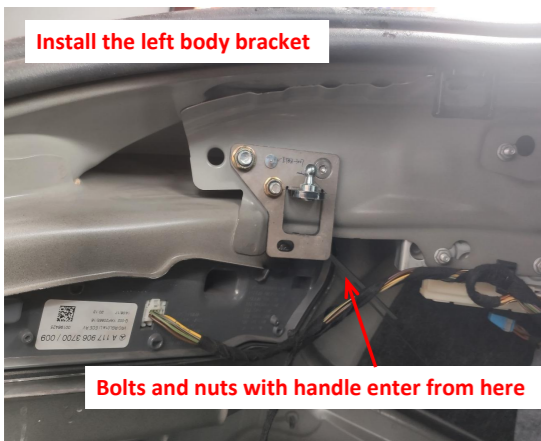

7. Install the left body bracket.

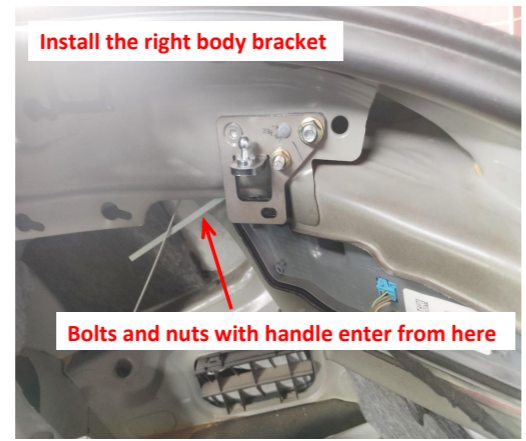

8. Install the right body bracket.



9. Install the left tailgate bracket on the left hinge.



10. Install the right tailgate bracket on the right hinge.

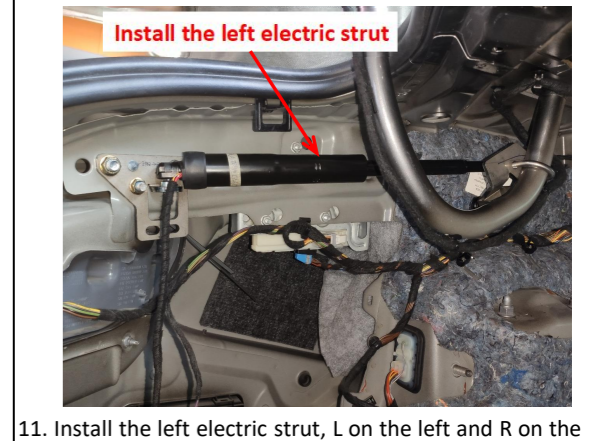

11. Install the left electric strut, L on the left and R on the right (the first letter of the strut code), making sure the end with wiring harness points outward.



12. Install the right electric strut, L on the left and R on the right (the first letter of the strut code), making sure the end with wiring harness points outward.

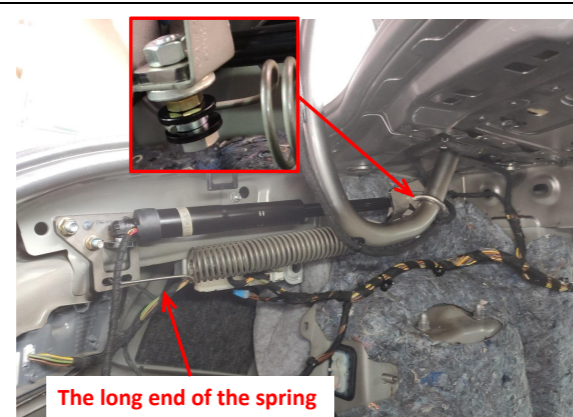

13. Hang the left spring back.

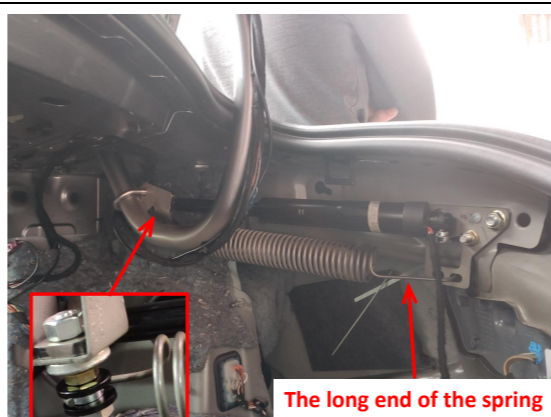

14. Hang the right spring back.

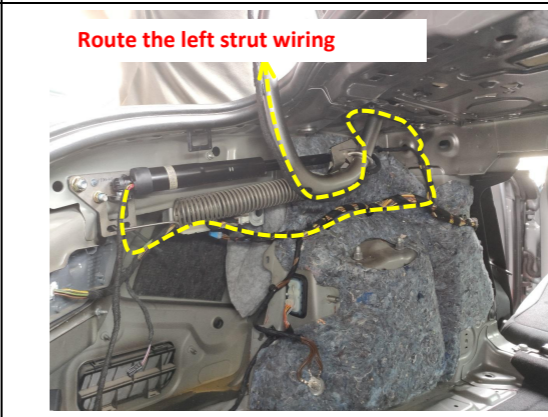

15. Route the left strut wiring harness to the tailgate and tie it along with original wiring harness. Pay attention to avoid the spring when routing.

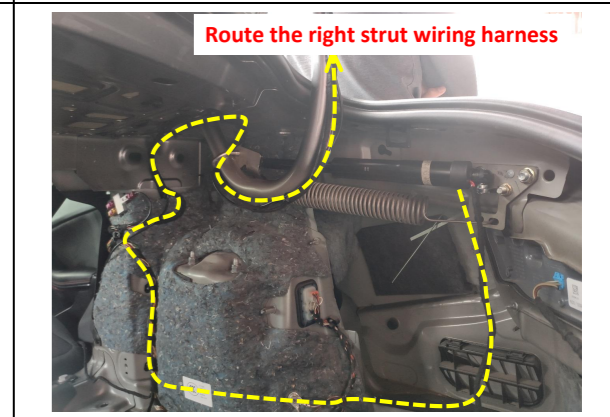

16. Route the right strut wiring harness to the tailgate and tie it along with original wiring harness. Pay attention to avoid the spring when routing.



17. Remove the original latch.

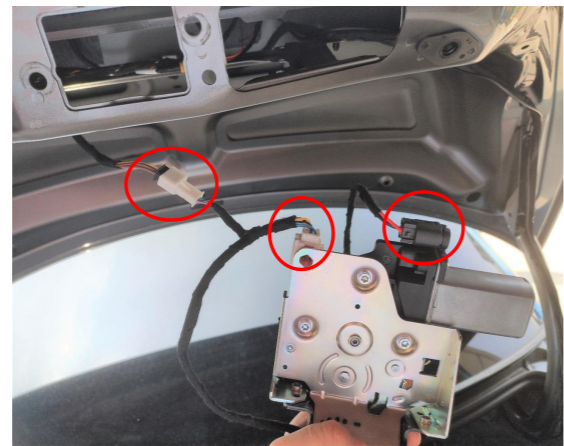

18. Connect the plugs of lock signal harness to the plugs of the power latch.



19. Install the power latch and manually adjust the latch to the locked state to prevent accidental closing during installation process.



20. Connect the plugs of the lock signal harness to the plugs of the original tailgate switch and the added tailgate switch.



21. Route the emergency wires of the lock signal harness along the right hinge to the right side of rear seat (the emergency wires should be in place for emergency use).

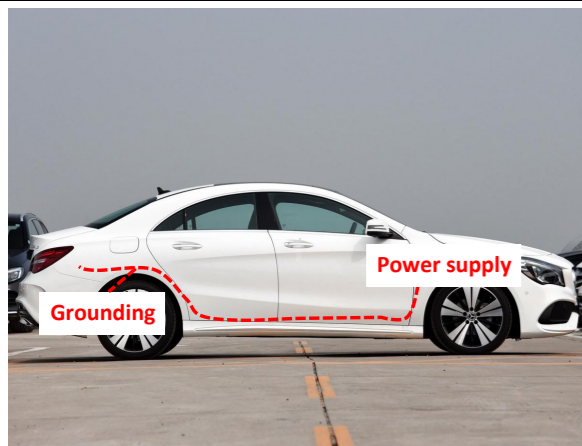

22. Route the power harness.



23. Ground at the right side of the trunk.

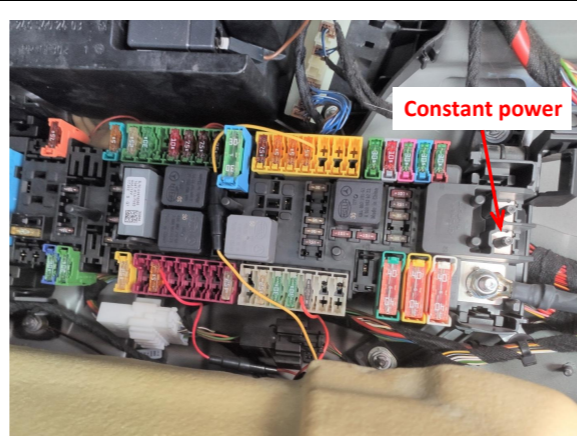

24. The location for power supply is indicated above.

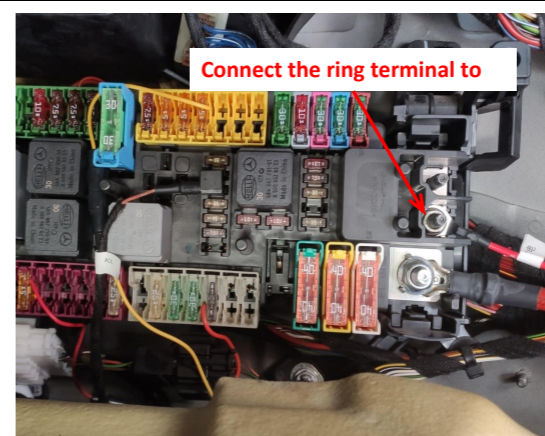

25. Connect the ring terminal and a nut to the indicated location on the fuse box for power supply.



26. Route the power harness to the tailgate.



The screw can be freely adjusted on the bracket. Find an appropriate location for easy installation.

27. Put a screw on the ECU bracket and then mount the ECU on it.

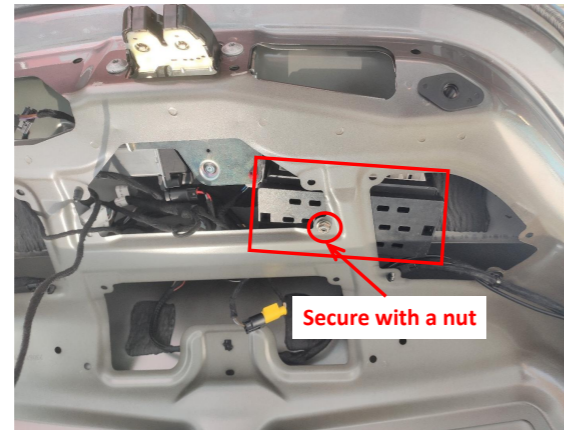

28. Place the ECU at the indicated hole and secure it with a nut.



29. Insert the strut wiring harnesses ①②, lock signal harness ③, and power harness ④ into the ECU in sequence.



30. Manually close the tailgate until it touches the striker, then press the original tailgate switch button to open the tailgate. The system will complete initialization, and then test each function of the electric tailgate.



31. Drill a hole at the indicated position with a φ20mm drill bit for the installation of the added switch.



32. Reinstall all the trim panels and install the added tailgate switch.

5. System initialization method

1. Press the added tailgate switch button to make the tailgate close automatically;
2. Press the switch button outside the tailgate to open the tailgate and it will make a long sound of "beep".
3. The system initialization is complete.

6. Instructions for the electric tailgate

1. Methods to open and close the tailgate:
 - Press and hold the tailgate button on the remote key;
 - Press the tailgate button at the driver's area;
 - Press the original tailgate switch button;
 - Press the added tailgate switch button.

2. Method to pause the tailgate:

During the operation of the tailgate, press the button with any of the above methods, and the tailgate will be paused. Press again, and the tailgate will move in reverse.

3. Method to memorize the height:

Open the tailgate to the height you want to set, long press the added tailgate switch, and release the switch after hearing a long "beep ----". The height memory is complete.
Tip: During the operation of the tailgate, pause the tailgate, and then push the tailgate to the ideal height with your hand.

4. Meanings of the buzzer sound:

"Beep" once: Receiving an open/close or pause signal, the tailgate will immediately open/close or pause;
"Beep" twice: The tailgate has been fully opened or closed;
"Beep" three times: The resistance during opening or closing the tailgate is too large, and the intelligent anti-pinch has been turned on;
Long sound of "beep": The height memory is complete.