

Installation Manual

Compatible Model	CCitroen CC5 X
Year	2021-2024



1. Points to note

- For safety and to ensure the proper use of product, please ask a professional technician to install. Do not disassemble and install it privately in case of damaging product and installation accidents.
- Please arrange each wiring harness according to the wiring method in this manual, be sure to tie each wiring harness to the vehicle's original wiring harness with cable ties. Make sure the wiring harnesses are not located at the fasteners or screw holes to avoid the wiring harnesses crushed by the vehicle interior trim panel buckles and screws during the installation process.
- Because some of the wiring harness terminals (as shown in the red ellipses below) are not inserted into the wiring harness connectors during manufacture, please insert terminals into the wiring harness connector first to avoid short circuit between terminals after the wiring harnesses have been arranged, then connect other plugs of the wiring harnesses (as shown in the blue ellipses below) with the original plugs.



- Check the function display of instrument panel before installation, whether the button of the vehicle is working properly, whether the doors and windows work properly while opening and closing, whether there are scratches on the internal and external surfaces of the vehicle; and report to the customers in a timely manner if there are any problems.
- During the process of disassembly and assembly, do not carry metal ornaments and other hard objects with you to prevent damage to the paintwork, seats and interior. Be sure to place the removed trim components properly to avoid scratching them.
- All the pictures in this manual are for reference only, vehicle models with different configurations may have different pictures, but the installation methods are the same.

2. Installation tools

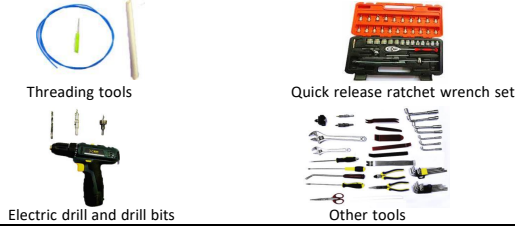

3. Product list

No.	Name	QTY	Picture
①	Strut	2	
②	ECU	1 set	
③	Wiring harness	1 set	
④	Power latch	1	
⑤	Added tailgate switch	1	
⑥	Other parts (screws, brackets, etc.)	1 set	Omitted



1. Remove the indicated driver's side trim panels.



2. Remove the rear left door sill panel and B-pillar trim panel.

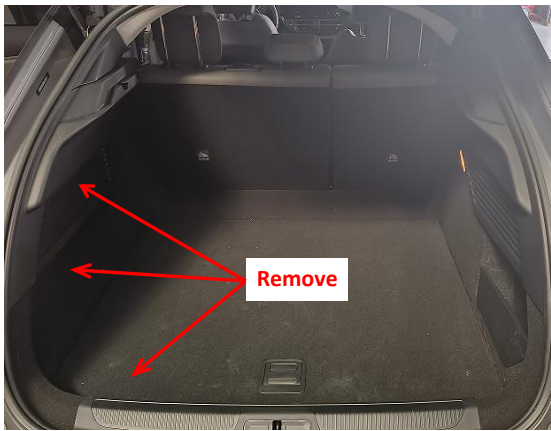

3. Remove the trim panel on the left side of the trunk, the trunk floor mat and the foam storage box.



4. Remove the tailgate trim panels.



5. Pay attention to the screws in the indicated areas.



6. Remove the original gas struts.



7. Replace the left body bracket



8. Replace the right body bracket.



9. Replace the ball studs on both sides of the tailgate (pay attention to put a shim under the ball stud).

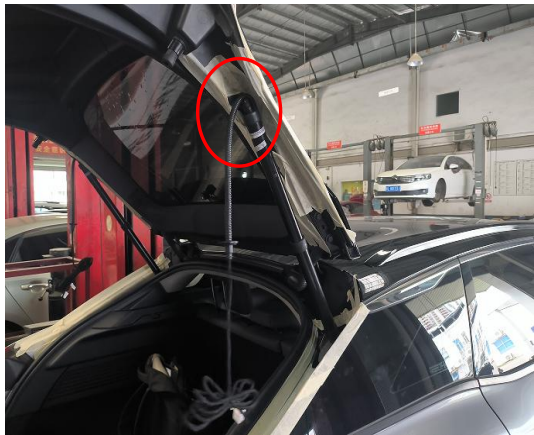

10. Install the electric struts, L on the left and R on the right (the first letter of the strut code).



11. Drill a hole at the indicated position with a Ø21 drill bit to allow strut wiring harness to pass through.

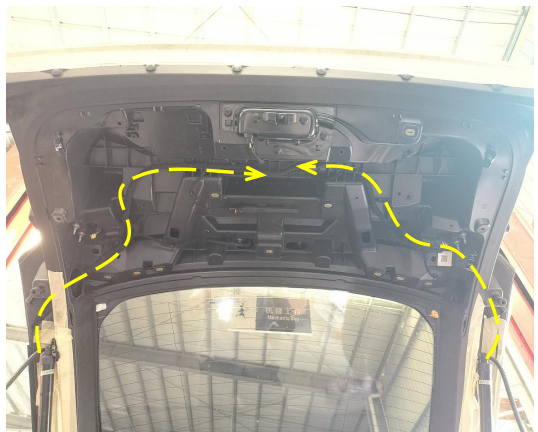

12. Thread the strut wiring harness into the tailgate, route them as indicated and plug the holes with hole plugs.



13. Remove the original latch.



14. Fit the power latch into the metal casing of the original latch.



15. Install the power latch.



16. Connect the plugs of the lock signal harness to the plugs of the power latch.



17. Connect the plugs of the lock signal harness to the plugs of original tailgate switch.

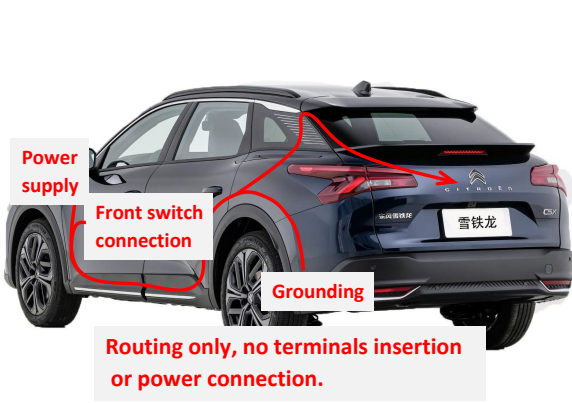

18. Route the power harness to the tailgate as indicated.



19. Ground at the left side of the trunk.

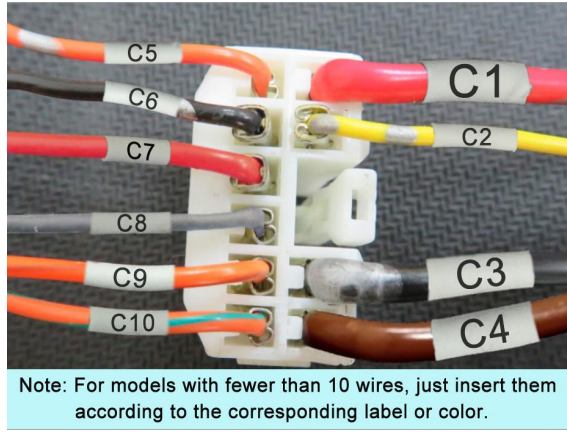

Note: For models with fewer than 10 wires, just insert them according to the corresponding label or color.

20. Insert the power harness terminals into the connector according to the diagram. (the connector is inserted on the ECU)



21. Remove the blank button from the switch panel for installing the front switch.



22. Connect the plugs of front switch to the first button.



23. Install the front switch.

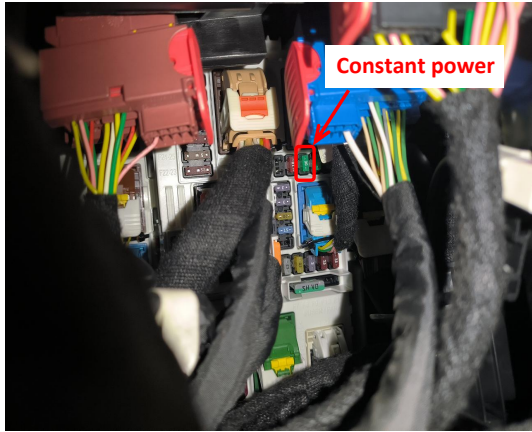

24. The fuse slot for power supply is indicated.

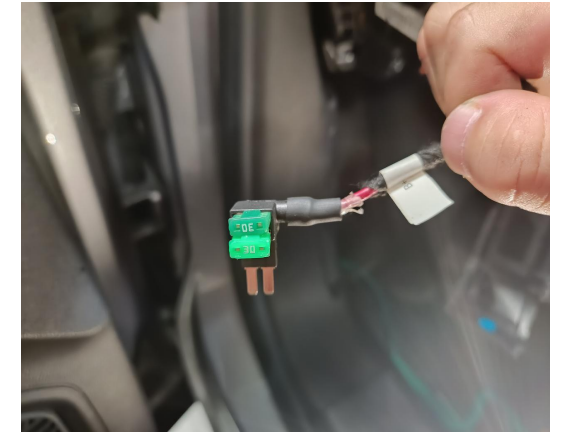

25. Move the fuse from the fuse box to the fuse tap.

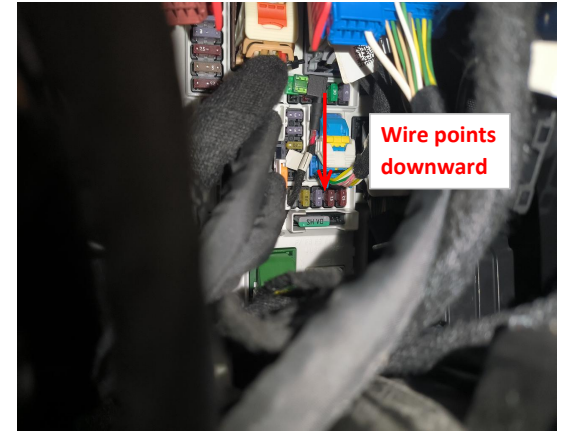

26. Plug the fuse tap into the fuse box and pay attention to the direction of wire.



27. Drill a hole at the indicated position with a $\phi 6$ mm drill bit.

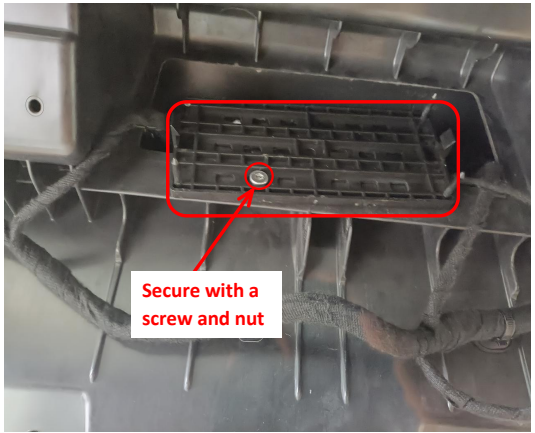

28. Install the ECU bracket.



29. Insert the left and right strut wiring harnesses ① ②, lock signal harness ③, and power harness ④ into the ECU in sequence.



30. Fit the ECU into the bracket and tie the wiring harnesses to the original wiring harness.



31. Press the added tailgate switch to close the tailgate once, the system completes initialization, and then test each function of the electric tailgate.



32. Stick the hole template to the indicated position and open a hole for the added tailgate switch.



33. Install the added tailgate switch and reinstall all the trim panels.

5. System initialization method

1. Press the added tailgate switch button to make the tailgate close automatically;
2. Press the switch button outside the tailgate to open the tailgate and it will make a long sound of "beep".
3. The system initialization is complete.

6. Instructions for the electric tailgate

1. Methods to open and close the tailgate:
 - Press and hold the tailgate button on the remote key;
 - Press the tailgate button at the driver's area: press and hold to open short press to close;
 - Press the original tailgate switch button;
 - Press the added tailgate switch button to close.

2. Method to pause the tailgate:

During the operation of the tailgate, press the button with any of the above methods, and the tailgate will be paused. Press again, and the tailgate will move in reverse.

1. Press and hold the switch button until hearing the first short beep sound.
2. After releasing the button, you will hear a short beep, indicating that the closing speed acceleration has taken effect.
3. Repeat this step once to increase by one setting.

② Opening speed acceleration (5 Settings)

1. Press and hold the switch button until hearing the second short beep sound
2. After releasing the button, you will hear two short beeps, indicating that the opening speed acceleration has taken effect.
3. Repeat this step once to increase by one setting.

- ③ Settings of the voice module (see the voice module operation manual)
- ④ Block the voice module (see the voice module operation manual)
- ⑤ Height setting

1. Press and hold the switch button until hearing the fifth short beep sound.
2. After releasing the button, you will hear a long beep sound indicating that the height setting has taken effect.

⑥ Switch between quick/slow press of the unlock button on remote key

1. Press and hold the switch button until hearing the sixth short beep sound.
2. After releasing the button, you will hear a long beep and a short beep indicating that the switch between quick and slow press of the unlock button has taken effect.

⑦ Switch between pressing the unlock button twice/three times

1. Press and hold the switch button until hearing the seventh short beep sound.
2. After releasing the button, you will hear a long beep sound and two short beeps indicating that the switch between pressing the unlock button twice/three times has taken effect.

⑧ Braking force increase (five settings)

1. Press and hold the switch button until hearing the eighth short beep sound.
2. After releasing the button, you will hear a long beep sound and three short beeps indicating that the switch between pressing the unlock button twice/three times has taken effect.

⑨ Restore to factory settings

1. Press and hold the switch button until hearing the ninth short beep sound.
2. After releasing the button, you will hear a long beep sound and four short beeps indicating that the restoration to the factory setting has taken effect.

4. Meanings of the buzzer sound:

- "Beep" once: Receiving an open/close or pause signal, the tailgate will immediately open/close or pause;
- "Beep" twice: The tailgate has been fully opened or closed;
- "Beep" three times: The resistance during opening or closing the tailgate is too large, and the intelligent anti-pinch has been turned on.