

Installation Manual

Compatible Model	CToyota CLand Cruiser (RHD)
Year	2022



8-ETTY-5092-00-00

1. Points to note

- For safety and to ensure the proper use of product, please ask a professional technician to install. Do not disassemble and install it privately in case of damaging product and installation accidents.
- Please arrange each wiring harness according to the wiring method in this manual, be sure to tie each wiring harness to the vehicle's original wiring harness with cable ties. Make sure the wiring harnesses are not located at the buckles or screw holes to avoid the wiring harnesses crushed by the vehicle interior trim panel buckles and screws during the installation process.
- Because some of the wiring harness terminals (as indicated by the small ovals below) are not plugged into the wiring harness connectors during manufacture, please insert terminals into the wiring harness connector first to avoid short circuit between terminals after the wiring harnesses have been arranged, then connect other plugs of the wiring harnesses (as indicated by the big ovals below) with the original plugs.



- Check the function display of instrument panel before installation, whether the button of the vehicle is working properly, whether the doors and windows work properly while opening and closing, whether there are scratches on the internal and external surfaces of the vehicle; and report to the customers in a timely manner if there are any problems.
- During the process of disassembly and assembly, do not carry metal ornaments and other hard objects with you to prevent damage to the paintwork, seats and interior. Be sure to place the removed trim components properly to avoid scratching them.
- All the pictures in this manual are for reference only, vehicle models with different configurations may have different pictures, but the installation methods are the same.

2. Installation tools

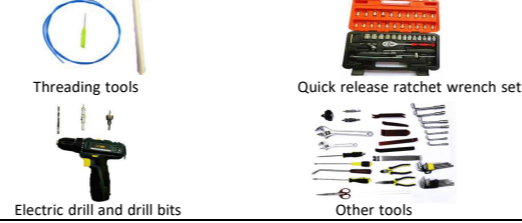

3. Product list

No.	Name	QTY	Picture
①	Strut	2	
②	ECU	1 set	
③	Wiring harness	1 set	
④	Power latch	1	
⑤	Added tailgate switch	1	
⑥	Other parts (screws, brackets, etc.)	1 set	Omitted



1. Remove the front right side trim panel, door sill panel and switch panel.



2. Remove the rear right B-pillar trim panel and door sill panel.



3. Remove the tailgate trim panels.



4. Separate the trim panel from the right side of the trunk.



5. Remove the indicated rubber pad to allow the strut wiring harness to pass through. Both sides are the same.



6. Add a washer to the hinges on both sides of the tailgate and secure them with provided screws.



7. Plug the holes on both sides with the provided hole plugs.

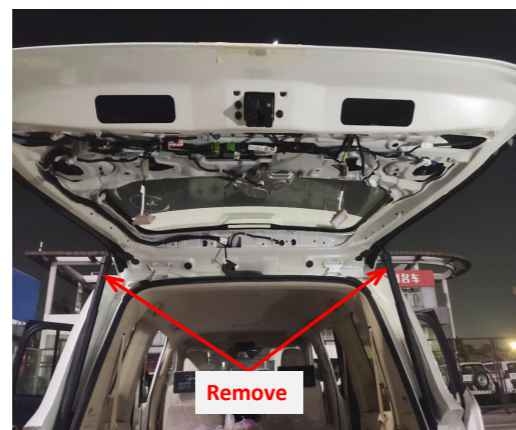

8. Remove the original gas struts.

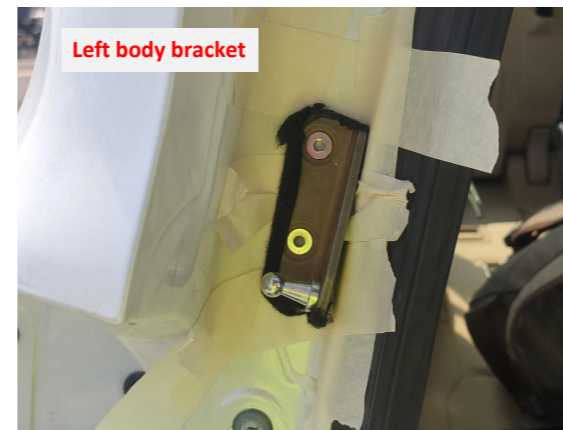

9. Install the bracket on the left side of the vehicle body.



10. Install the bracket on the right side of the vehicle body.



11. Install the bracket on the left side of the tailgate.



12. Install the bracket on the right side of the tailgate.

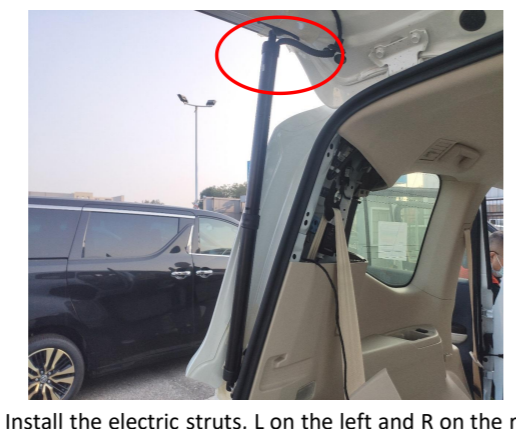

13. Install the electric struts, L on the left and R on the right (the first letter of the strut code), making sure the ends with wiring harnesses are on the tailgate.

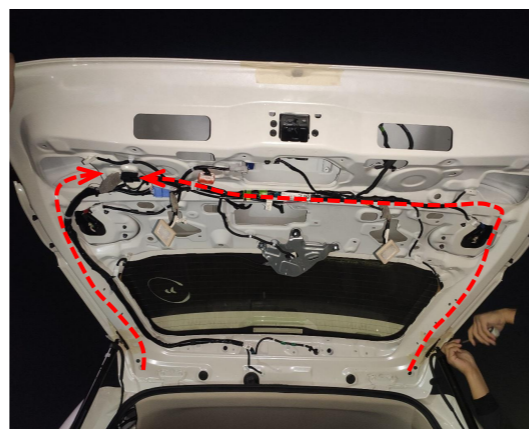

14. Pass the strut wiring harnesses through the original car holes and route them to the tailgate.

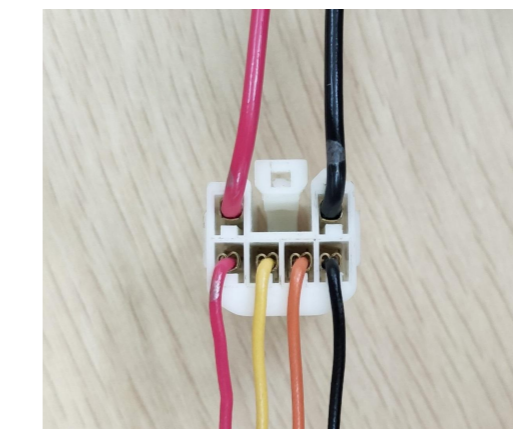

15. Insert the strut wiring harness terminals into the wiring harness connector as shown above.



16. Remove the original latch and install the power latch.



17. Connect the plugs of lock signal harness to the power latch.



18. Connect the tailgate switch signal: connect the plugs of the lock signal harness to the original tailgate switch.

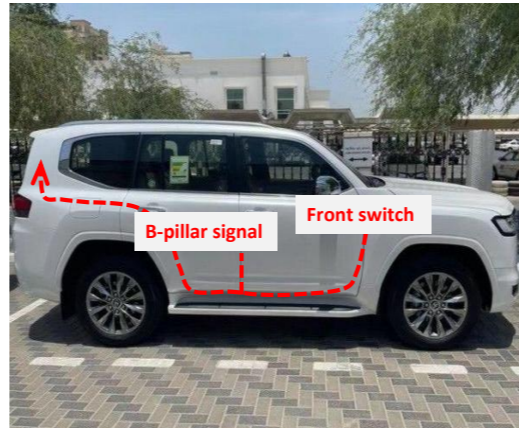

19. Route the power harness along the right side of the vehicle.

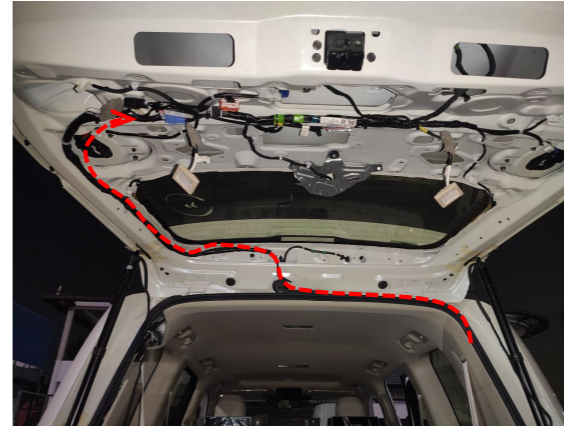

20. Thread the power harness to the tailgate (do not connect plugs before inserting terminals into wiring harness connector).

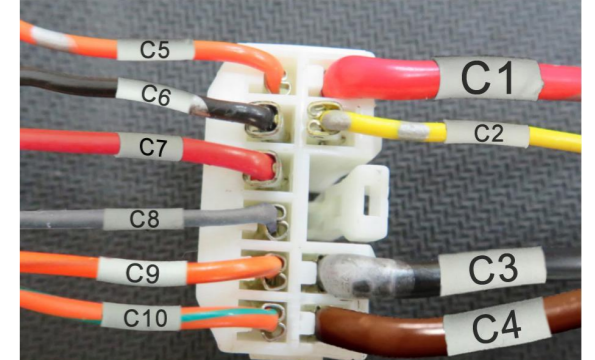

Note: For models with fewer than 10 wires, just insert them according to the corresponding label or color.

21. Insert the power harness terminals into the wiring harness connector as shown above.



22. Ground at the right side of trunk.



23. Connect the B-pillar signal at the rear right side B-pillar.



24. Remove the blank button from the switch panel, install the front switch and connect the plugs with the switch beside it to make the button light up.

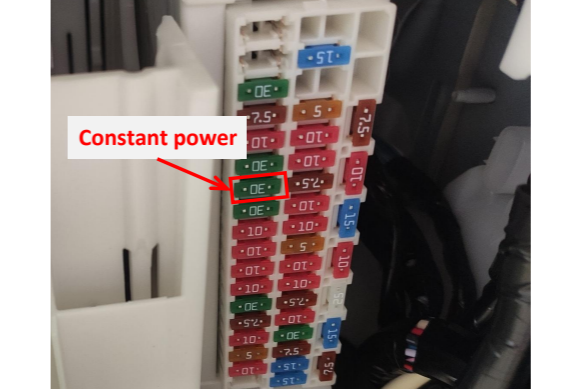

25. The fuse box is on the right side of the front passenger's seat and the fuse slot for power supply is indicated above.

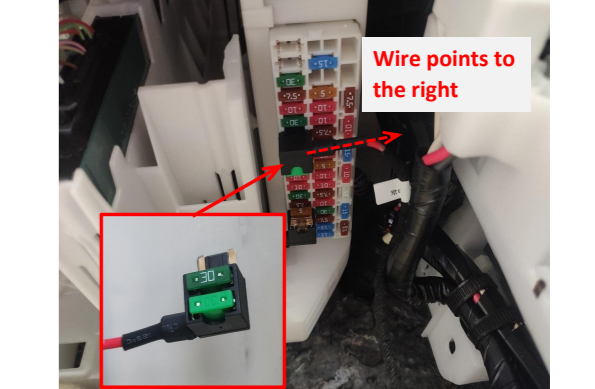

26. Move the original fuse from the fuse box to the fuse tap and plug the fuse tap into the fuse box. Pay attention to the direction.

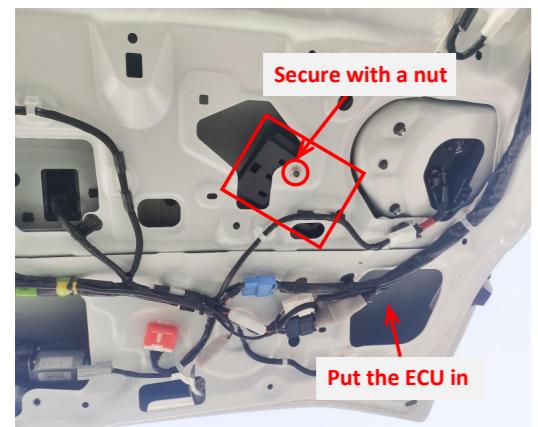

27. Place the ECU at the indicated position and secure it with a nut.



28. Insert the left and right strut wiring harnesses ①②, lock signal harness ③, and power harness ④ into the ECU in sequence.



29. Press the tailgate switch buttons to open and close the tailgate once, the system completes initialization, then test each function of the electric tailgate.



30. Reinstall all the trim panels and install the added tailgate switch.

5. System initialization method
 1. Press the added tailgate switch button to make the tailgate close automatically;
 2. Press the switch button outside the tailgate to open the tailgate and it will make a long sound of "beep".
 3. The system initialization is complete.

6. Instructions for the electric tailgate
 1. Methods to open and close the tailgate:
 • Press the unlock button on the remote key 3 times;
 • Press the unlock button at the driver's area 3 times;
 • Press the original tailgate switch button;
 • Press the added tailgate switch button to close;
 • Press the added front switch button: press and hold for 4s to open and press once to close.

2. Method to pause the tailgate:
 During the operation of the tailgate, press the button with any of the above methods, and the tailgate will be paused. Press again, and the tailgate will move in reverse.

3. Instructions for the added tailgate switch
 ① Closing speed acceleration
 Press and hold the added switch button on tailgate until hearing a beep sound. When the tailgate makes a short beep sound again, the close speed acceleration is complete. (There are five speed settings. Repeat this step once to increase by one setting.)
 ② Opening speed acceleration
 Press and hold the added switch button on tailgate until hearing two beep sounds. When the tailgate makes two short beep sounds again, the open speed acceleration is complete. (There are five speed settings. Repeat this step once to increase by one setting.)
 ③ Height setting
 Press and hold the added switch button on tailgate until hearing three beep sounds. When the tailgate makes three short beep sounds again, the height setting is complete. Tip: During the operation of the tailgate, pause the tailgate, and then push the tailgate to the ideal height.
 ④ Switch between quick/slow press of the unlock button on remote key
 Press and hold the added switch button on tailgate until hearing four beep sounds. When the tailgate makes four short beep sounds again, the switch of pressing way is complete.

⑤ Switch between pressing the unlock button twice/three times
 Press and hold the added switch button on tailgate until hearing five beep sounds. When the tailgate makes a long beep sound, the switch of pressing times is complete.
 ⑥ Braking force increase (Retention force for open)
 Press and hold the added switch button on tailgate until hearing six beep sounds. When the tailgate makes two long beep sounds, the braking force increase is complete. (There are five speed settings. Repeat this step once to increase by one setting.)
 ⑦ Restore to factory settings
 Press and hold the added switch button on tailgate until hearing seven beep sounds. When the tailgate makes three long beep sounds, the reset is complete.
4. Meanings of the buzzer sound:
 "Beep" once: Receiving an open/close or pause signal, the tailgate will immediately open/close or pause;
 "Beep" twice: The tailgate has been fully opened or closed;
 "Beep" three times: The resistance during opening or closing the tailgate is too large, and the intelligent anti-pinch has been turned on;
 Long sound of "beep": The height memory is complete.