



京澎机械设备(上海)有限公司

Jingpeng Machinery & Equipment (Shanghai) Co.,Ltd



CROSS ROLLER GUIDE

About Us

Jingpeng Machinery Equipment (Shanghai) Co., Ltd. was established in 2015. Our main products are ball screws, linear guides, cross guides, precision ball screws/splines, single shaft actuators, medium and large bearings, rack, couplings, support units, servo motors and drives, etc. We cooperate with the German YOSO company. With independent import and export management rights, Jingpeng has completed trademark registration and continues to promote and use it. Today, YOSO is one of the world's well-known brands. The company's products sell well all over the world, and are exported to the United States, Spain, Turkey, Italy, Austria, Brazil and other countries. Jingpeng Machinery has learned German production technology, combined with European and Japanese design concepts, specially established an independent research and development center, and introduced advanced manufacturing equipment and high-precision testing equipment at home and abroad to complete an annual output value of 1.5 million sets of screw guides. The application areas of the products are as follows: - Automation industry - Robot industry - Semiconductor industry - Industrial machinery - Medical equipment - Green energy industry - Machine tools - Automatic storage and retrieval system products, excellent in all industrial fields. Jingpeng Machinery integrates global resources, continues to innovate, and makes unremitting efforts for better human well-being and a better working environment. In the field of transmission components, Jingpeng Machinery has become the best partner with high-quality professional manufacturing and solutions. We also provide technical support and industry analysis to meet customer needs. At the same time, we have a solid business team to ensure the stability of the foreign trade sales system and strong market development capabilities, so that our products can be exported to all parts of the world at the fastest speed. Jingpeng Machinery is a professional manufacturer of transmission control products and system technology products all over the world.

Contents

◆ VR1/VR2	1
◆ VR3/VR4	2
◆ VR6/VR9	3
◆ CRWG2	4
◆ CRWG4	6
◆ CRWG6	7
◆ CRWG9	8
◆ CRW1/CRW2	9
◆ CRW3/CRW4	10
◆ CRW6/CRW9	11
◆ SVW1/SVW2	12
◆ SVW3/SVW4	13
◆ NV2/NV3	14
◆ NV4/NV6	15
◆ RNG2/RNG3	16
◆ RNG4/RNG6	17
◆ RGN9	18
◆ LWRE3 ACS	19
◆ LWRE4 ACS	20
◆ AC4/AC6	21
◆ AC9	22
◆ N/O 62015 Cross Needle Guide	23



- ◆ N/O 92025 Cross Needle Guide 24
- ◆ N/O 2025 Cross Needle Guide 25
- ◆ N/O 2035 Cross Needle Guide 26
- ◆ N/O 3405 Cross Needle Guide 27
- ◆ N/O 3555 Cross Needle Guide 28
- ◆ M/V 3015 Cross Needle Guide 29
- ◆ M/V 4020 Cross Needle Guide 30
- ◆ M/V 5025 Cross Needle Guide 31
- ◆ M/V 6035 Cross Needle Guide 32
- ◆ M/V 7040 Cross Needle Guide 33
- ◆ M/V 8050 Cross Needle Guide 34
- ◆ LWR6 35
- ◆ LWREM3/LWREM4 36
- ◆ RN2/RN3 37
- ◆ RN4/RN6 38
- ◆ RN9 39
- ◆ RNW2/RNW3 40
- ◆ RNW4 41
- ◆ RNWG2/RNWG3 42
- ◆ RNWG4 43
- ◆ NVW2/NVW3 44
- ◆ NVW4 45
- ◆ SV1/SV2 46



◆ SV3/SV4	47
◆ SV6/SV9	48
◆ CRWM1/CRWM2	49
◆ CRWM3/CRWM4	50
◆ CRWVG2/CRWVG3	51
◆ CRWVG4	52
◆ VRG2/VRG3	53
◆ VRG4	54
◆ VRM1/VRM2	55
◆ VRM3/VRM4	56
◆ VRVG2/VRVG3	57
◆ VRVG4	58
◆ VB2/VB3	59
◆ VB4/VB6	60
◆ VB9	61

Advantages of cross roller guide/ball guide

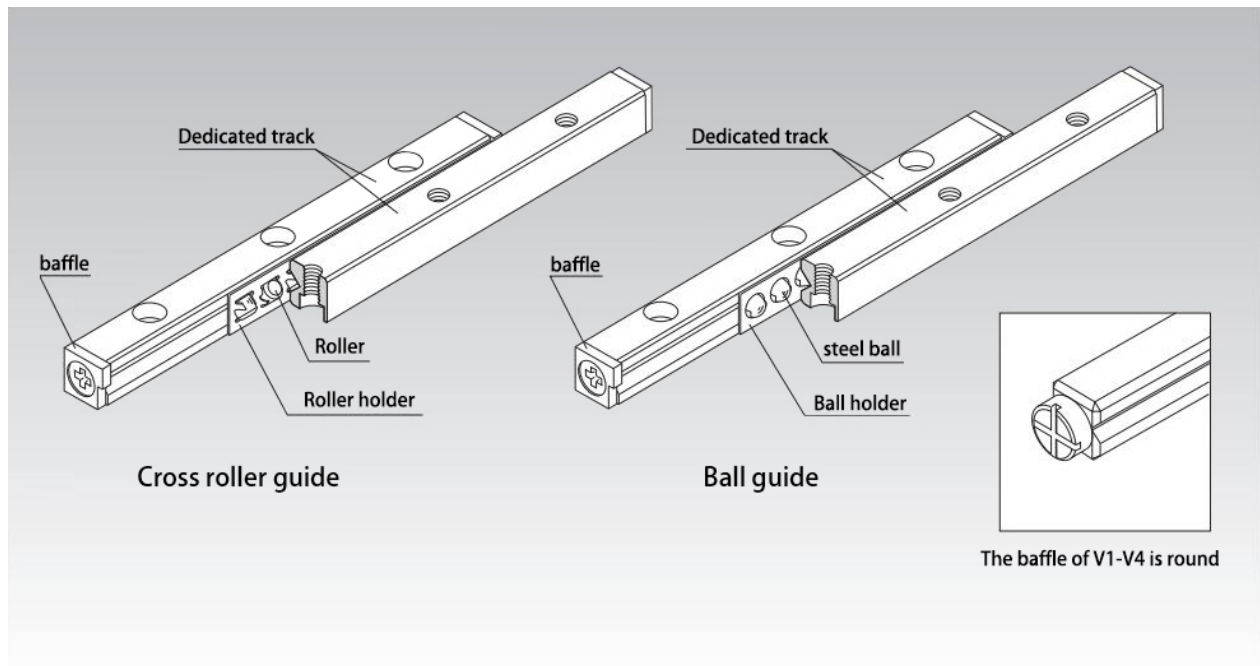

In the cross roller guide rail, the roller retainer, which is composed of precision rollers that are orthogonal to each other, is used together with the 90 ° V-groove rolling surface set on the special track. By assembling two rows of roller guides in parallel, the guide rail system can bear the load in four directions. Moreover, because it can apply preload to the cross roller guide rail, a sliding mechanism with no clearance, high rigidity and light movement can be obtained.

The ball guide uses short pitch interval to combine the ball holder B from the precision steel ball holder with the special track V, which is a limited linear motion system with low friction and high precision.

Cross-roller guide rail and ball guide rail are widely used in the slide part of office equipment and its external equipment, various measuring instruments, printing substrate drilling machines and other precision machines, live optical

measuring equipment, optical working platform, operating mechanism, X-ray devices, etc.

【Long service life, high rigidity】

The effective contact length of the roller is 1.7 times longer than that of the traditional products by using the unique roller retention method, and because the pitch interval of the roller is shorter and the number of rollers is more, the rigidity is increased by 2 times and the service life can be obtained by 6 times. Therefore, for the vibration and impact problems that are not easily caused by linear motion, the safety design can be fully considered.

【Smooth motion】

In the VR model, the rollers are kept separately by the cage, and because the roller bag in the cage is in contact with the rollers, it has good lubricating oil retention, so the wear is small and smooth rolling movement can be obtained.

【High corrosion resistance】

VR and VB series also provide stainless steel with excellent wear and corrosion resistance.

VR1/VR2

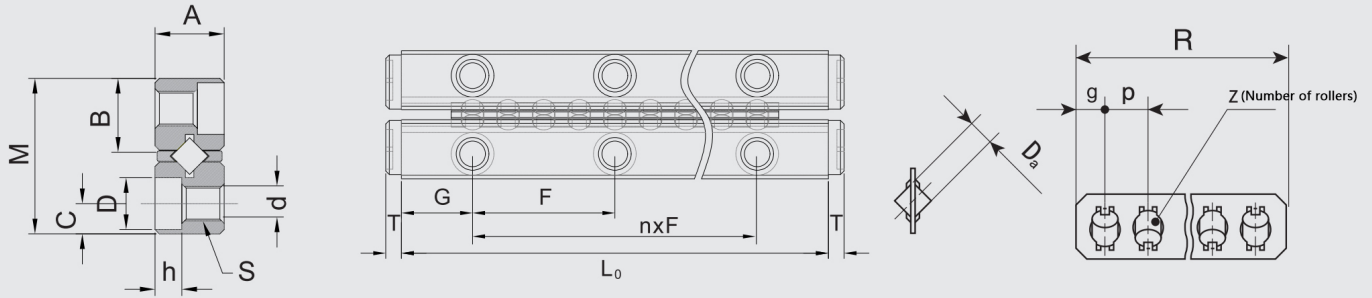

Model	Maximum stroke mm	Main dimensions																Number of rollers Z									
		Combined size				Assembly dimensions									Cylindrical roller with retainer												
		M	A	L0	nxF	G	B	C	S	d	D	h	T	Da	R	g	P										
VR1-20x5Z	15	8.5	4	20	1×10	5	3.9	1.8	M2	1.65	3	1.4	1	1.5	12.5	2	2.5	5									
VR1-30x7Z	25			30	2×10										17.5				7								
VR1-40x10Z	30			40	3×10										25					10							
VR1-50x13Z	35			50	4×10										32.5						13						
VR1-60x16Z	40			60	5×10										40							16					
VR1-70x19Z	45			70	6×10										47.5								19				
VR1-80x21Z	55			80	7×10										52.5									21			
VR2-30x5Z	20	12	6	30	1×15	7.5	5.5	2.5	M3	2.55	4.5	2.2	1.4	2	20	2.5	4	5									
VR2-45x8Z	26			45	2×15										32				8								
VR2-60x11Z	32			60	3×15										44					11							
VR2-75x13Z	46			75	4×15										52						13						
VR2-90x16Z	52			90	5×15										64							16					
VR2-105x18Z	66			105	6×15										72								18				
VR2-120x21Z	72			120	7×15										84									21			
VR2-135x23Z	86			135	8×15										92										23		
VR2-150x26Z	92			150	9×15										104											26	
VR2-165x29Z	98			165	10×15										116												29
VR2-180x32Z	104			180	11×15										128												

VR3/VR4

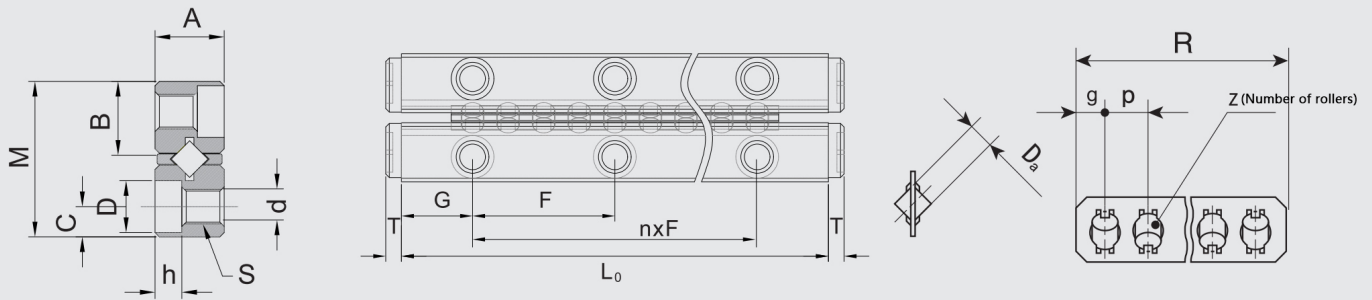

Model	Maximum stroke mm	Main dimensions															Number of rollers Z		
		Combined size				Assembly dimensions								Cylindrical roller with retainer					
		M	A	L0	nxF	G	B	C	S	d	D	h	T	Da	R	g		P	
VR3-50x7Z	30	18	8	50	1×25	12.5	8.3	3.5	M4	3.3	6	3.1	1.5	3	35	3	5	7	
VR3-75x10Z	50			75	2×25													10	50
VR3-100x14Z	60			100	3×25													14	70
VR3-125x17Z	80			125	4×25													17	85
VR3-150x21Z	90			150	5×25													21	105
VR3-175x24Z	110			175	6×25													24	120
VR3-200x28Z	120			200	7×25													28	140
VR3-225x31Z	140			225	8×25													31	155
VR3-250x35Z	150			250	9×25													35	175
VR3-275x38Z	170			275	10×25													38	190
VR3-300x42Z	180			300	11×25													42	210
VR4-80x7Z	62	22	11	80	1×40	20	10	4.5	M5	4.3	8	4.2	2	4	49	4.5	27	7	
VR4-120x11Z	86			120	2×40													11	77
VR4-160x15Z	110			160	3×40													15	105
VR4-200x19Z	134			200	4×40													19	133
VR4-240x23Z	158			240	5×40													23	161
VR4-280x27Z	182			280	6×40													27	189
VR4-320x31Z	206			320	7×40													31	217
VR4-360x35Z	230			360	8×40													35	245
VR4-400x39Z	254			400	9×40													39	273
VR4-440x43Z	278			440	10×40													43	301
VR4-480x47Z	302			480	11×40													47	329

VR6/VR9

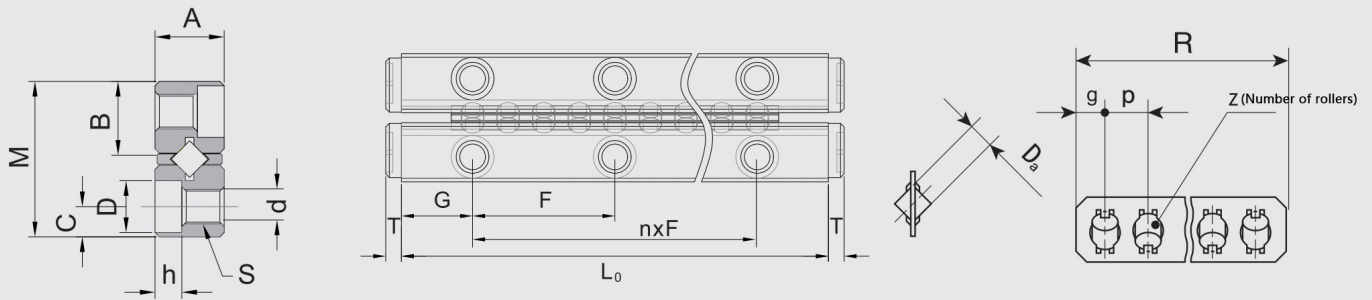

Model	Maximum stroke mm	Main dimensions															Number of rollers Z	
		Combined size				Assembly dimensions								Cylindrical roller with retainer				
		M	A	L0	nxF	G	B	C	S	d	D	h	T	Da	R	g		P
VR6-100x7Z	60	30 (31)	15	100	1×50	25	13.6 (14.1)	6	M6	5.2	9.5	5.2	2.9	6	70	6	10	7
VR6-150x10Z	100			150	2×50										100			10
VR6-200x13Z	140			200	3×50										130			13
VR6-250x17Z	160			250	4×50										170			17
VR6-300x20Z	200			300	5×50										200			20
VR6-350x24Z	220			350	6×50										240			24
VR6-400x27Z	260			400	7×50										270			27
VR6-450x31Z	280			450	8×50										310			31
VR6-500x34Z	320			500	9×50										340			34
VR6-550x38Z	340			550	10×50										380			38
VR6-600x41Z	380			600	11×50										410			41
VR9-200x10Z	120	40 (44)	20 (22)	200	1×100	50	18.1 (20.2)	8	M8	6.8	10.5	6.2	4	9	140	7.5	14	10
VR9-300x15Z	180			300	2×100										210			15
VR9-400x20Z	240			400	3×100										280			20
VR9-500x25Z	300			500	4×100										350			25
VR9-600x30Z	360			600	5×100										420			30
VR9-700x35Z	420			700	6×100										490			35
VR9-800x40Z	480			800	7×100										560			40

CRWG2

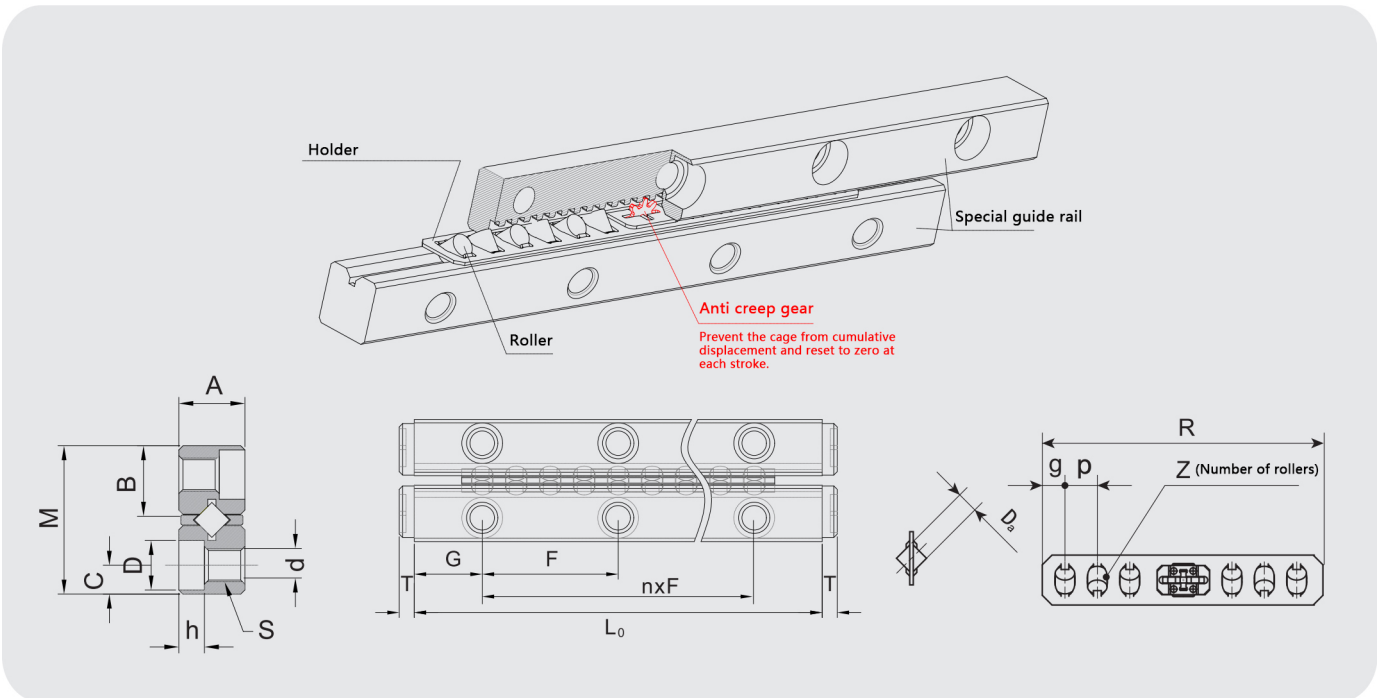

Model	Maximum stroke mm	Main dimensions															Number of rollers Z	
		Combined size				Assembly dimensions								Cylindrical roller with retainer				
		M	A	L0	nxF	G	B	C	S	d	D	h	T	Da	R	g		P
CRWG2-30x4Z	12	12	6	30	1x15	7.5	5.5	2.5	M3	2.55	4.4	2	1.5	2	24	2.5	4	4
CRWG2-45x8Z	10			45	2x15										40			8
CRWG2-60x10Z	24			60	3x15										40			10
CRWG2-75x14Z	22			75	4x15										56			14
CRWG2-90x16Z	36			90	5x15										64			16
CRWG2-105x20Z	34			105	6x15										80			20
CRWG2-120x22Z	48			120	7x15										88			22
CRWG2-135x26Z	46			135	8x15										104			26
CRWG2-150x28Z	60			150	9x15										112			28
CRWG2-165x30Z	74			165	10x15										120			30
CRWG2-180x32Z	88			180	11x15										128			32

CRWG2

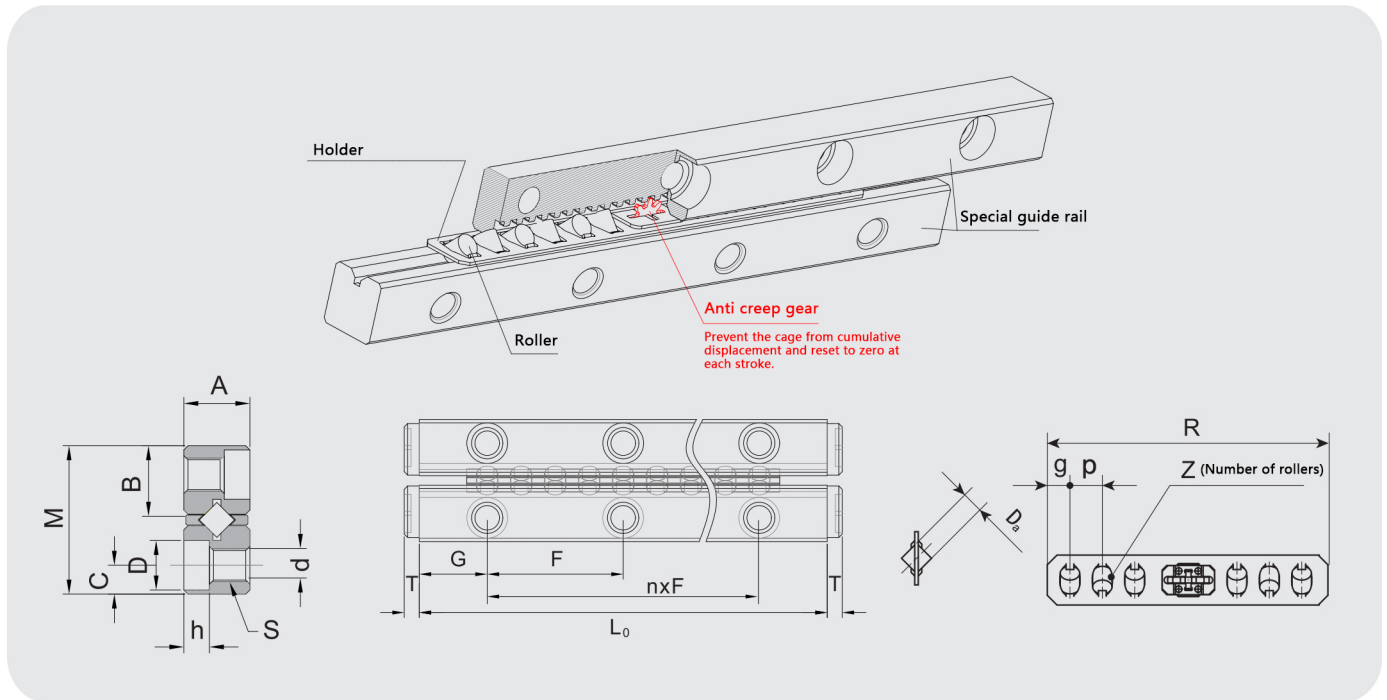

Model	Maximum stroke mm	Main dimensions														Number of rollers Z	
		Combined size				Assembly dimensions								Cylindrical roller with retainer			
		M	A	L0	nxF	G	B	C	S	d	D	h	T	Da	R		g
CRWG3-50x6Z	20	18	8	50	1x25	12.5	8.3	3.5	M4	3.3	6	3.1	2	40	3	5	6
CRWG3-75x10Z	30			75	2x25									60			10
CRWG3-100x14Z	40			100	3x25									80			14
CRWG3-125x18Z	50			125	4x25									100			18
CRWG3-150x22Z	60			150	5x25									120			22
CRWG3-175x26Z	70			175	6x25									140			26
CRWG3-200x30Z	80			200	7x25									160			30
CRWG3-225x34Z	90			225	8x25									180			34
CRWG3-250x38Z	100			250	9x25									200			38
CRWG3-275x42Z	110			225	10x25									220			42
CRWG3-300x46Z	120			250	11x25									240			46

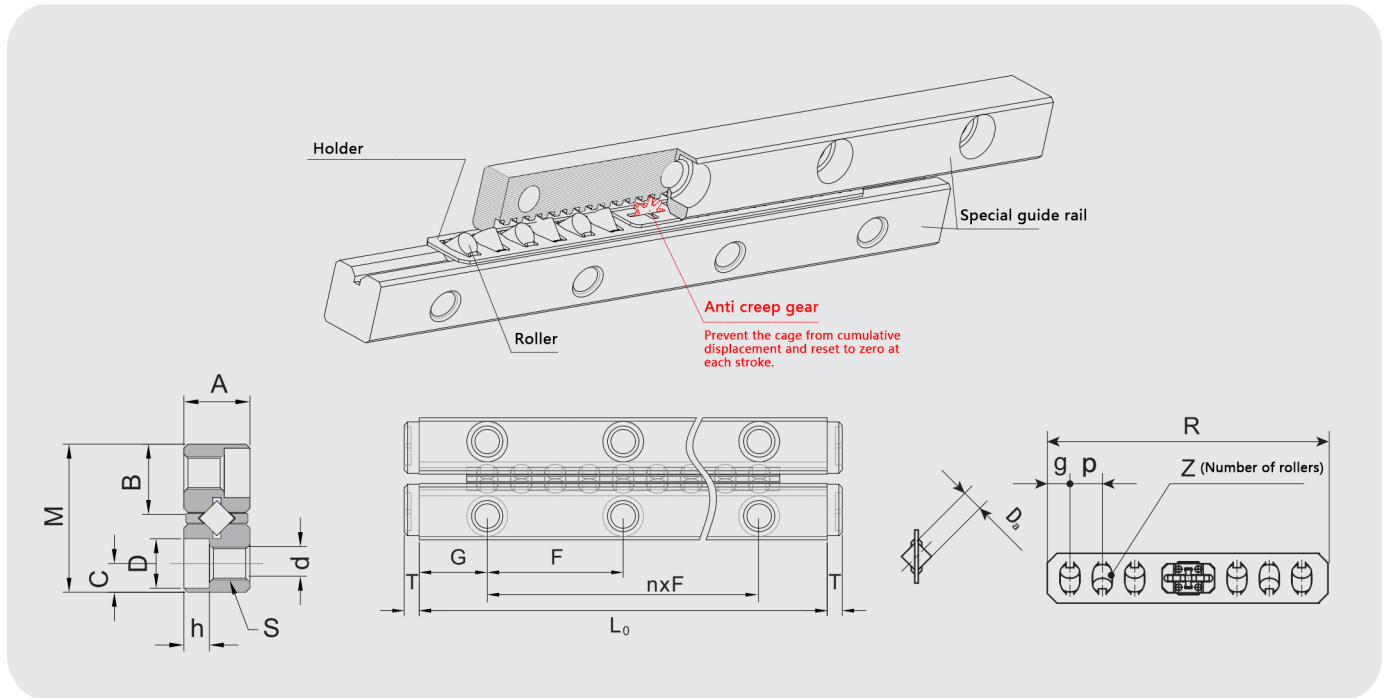
CRWG4

Model	Maximum stroke mm	Main dimensions														Number of rollers Z		
		Combined size				Assembly dimensions								Cylindrical roller with retainer				
		M	A	L0	nxF	G	B	C	S	d	D	h	T	Da	R		g	P
CRWG4-80x8Z	20	22	11	80	1x40	20	10	4.5	M5	4.3	7.5	4.1	2	4	70	4.5	7	8
CRWG4-120x12Z	44			120	2x40										98			12
CRWG4-160x16Z	68			160	3x40										126			16
CRWG4-200x20Z	92			200	4x40										154			20
CRWG4-240x26Z	88			240	5x40										196			26
CRWG4-280x30Z	112			280	6x40										224			30
CRWG4-320x34Z	136			320	7x40										252			34
CRWG4-360x38Z	160			360	8x40										280			38
CRWG4-400x42Z	184			400	9x40										308			42
CRWG4-440x46Z	208			440	10x40										336			46
CRWG4-480x50Z	232			480	11x40										364			50

CRWG6

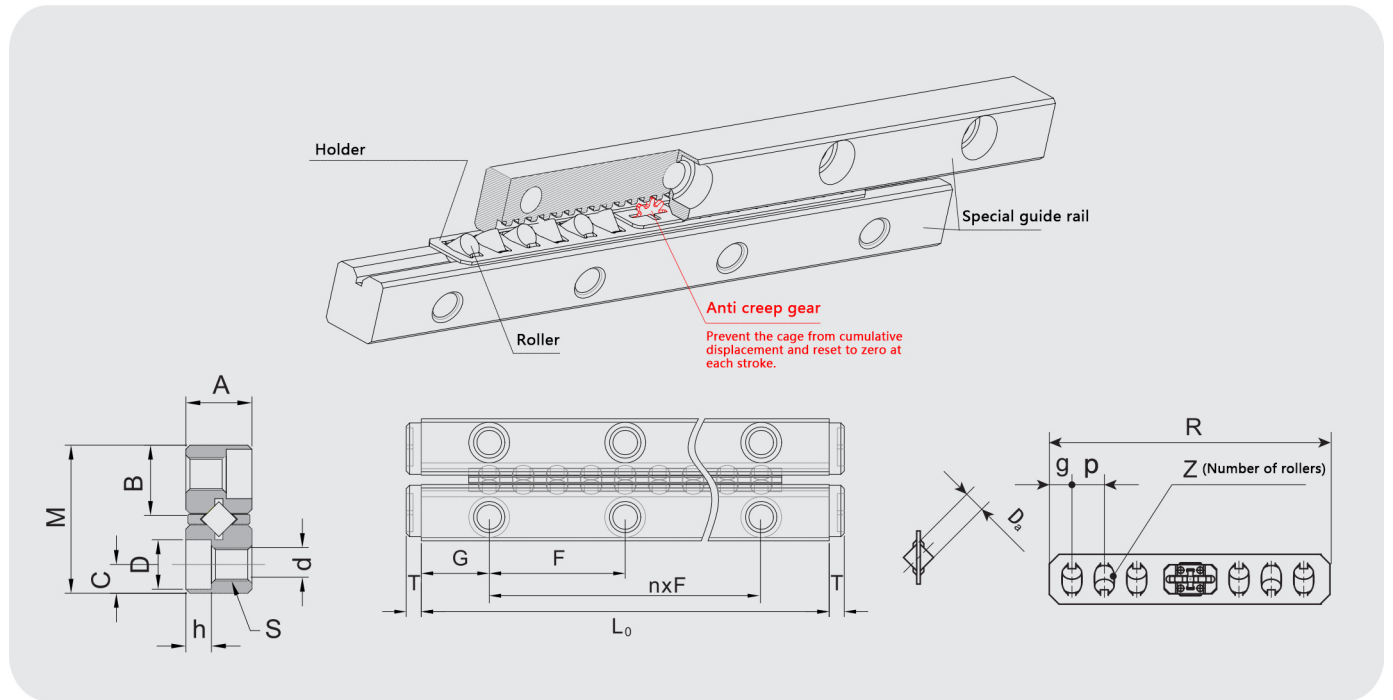

Model	Maximum stroke mm	Main dimensions															Number of rollers Z	
		Combined size				Assembly dimensions									Cylindrical roller with retainer			
		M	A	L0	nxF	G	B	C	S	d	D	h	T	Da	R	g		P
CRWG6-100x6Z	56	30 (31)	15	100	1x50	25	13.6 (14)	6	M6	5.3	9.5	5.2	2.9	6	72	5	9	6
CRWG6-150x12Z	48			150	2x50										126			12
CRWG6-200x16Z	76			200	3x50										162			16
CRWG6-250x20Z	104			250	4x50										198			20
CRWG6-300x24Z	132			300	5x50										234			24
CRWG6-350x28Z	160			350	6x50										270			28
CRWG6-400x32Z	188			400	7x50										306			32
CRWG6-450x36Z	216			450	8x50										342			36
CRWG6-500x40Z	244			500	9x50										378			40
CRWG6-550x44Z	272			550	10x50										414			44
CRWG6-600x48Z	300			600	11x50										450			48

CRWG9

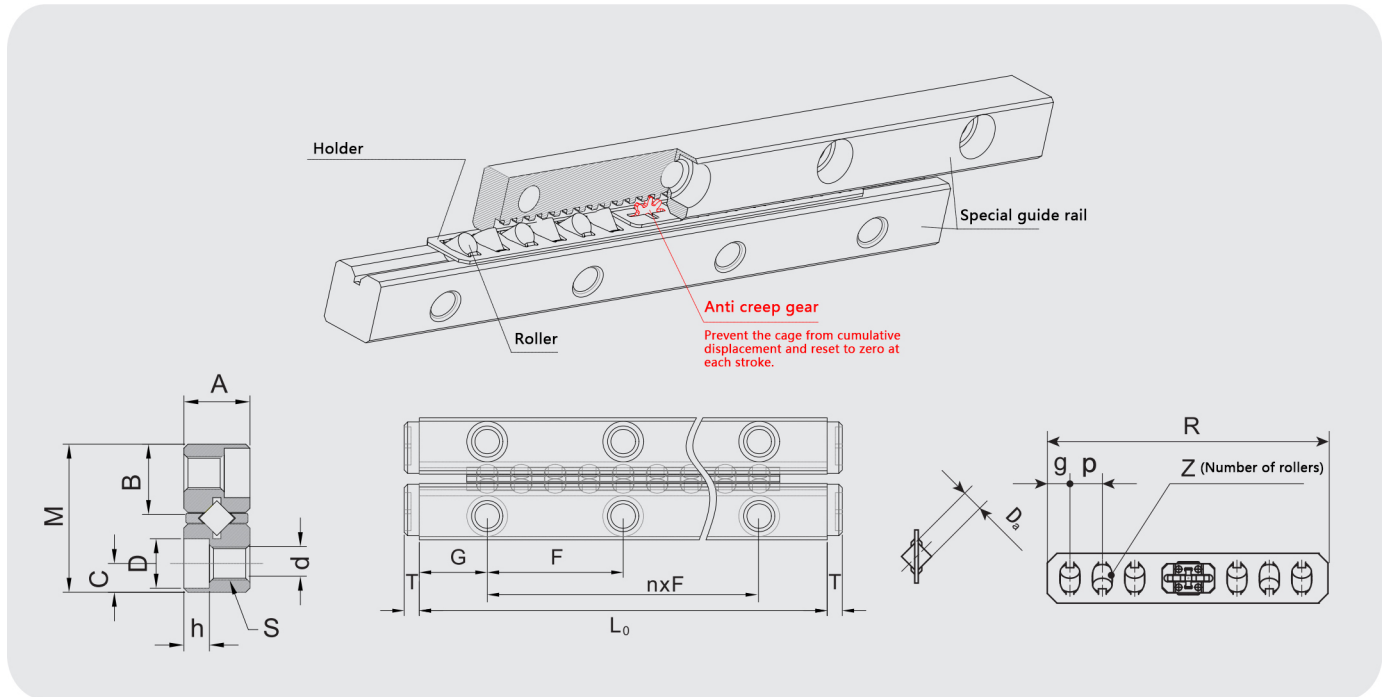

Model	Maximum stroke mm	Main dimensions														Number of rollers Z		
		Combined size				Assembly dimensions								Cylindrical roller with retainer				
		M	A	L0	nxF	G	B	C	S	d	D	h	T	Da	R		g	P
CRWG9-200x10Z	64	40 (44)	20	200	1x100	50	19.2 (20.2)	8	M8	6.8	9.5	10.5	4	9	168	7	14	10
CRWG9-300x16Z	96			300	2x100										252			16
CRWG9-400x20Z	184			400	3x100										308			20
CRWG9-500x26Z	216			500	4x100										392			26
CRWG9-600x30Z	304			600	5x100										448			30
CRWG9-700x36Z	336			700	6x100										532			36
CRWG9-800x40Z	424			800	7x100										588			40

CRW1/CRW2

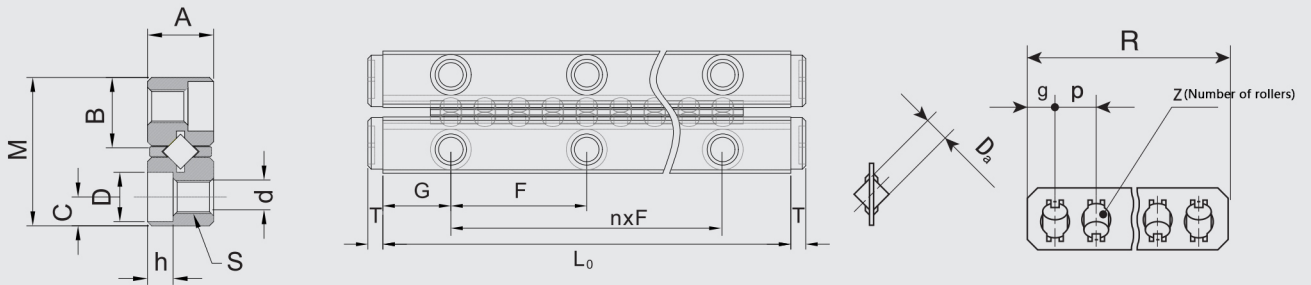

Model	Maximum stroke mm	Main dimensions																Number of rollers Z	
		Combined size				Assembly dimensions								Cylindrical roller with retainer					
		M	A	L0	nxF	G	B	C	S	d	D	h	T	Da	R	g	P		
CRW1-20x5Z	15	8.5	4	20	1×10	5	3.9	1.8	M2	1.65	3	1.4	1.5	12.5	2	2.5	5		
CRW1-30x7Z	25			30	2×10									17.5				7	
CRW1-40x10Z	30			40	3×10									25				10	
CRW1-50x13Z	35			50	4×10									32.5				13	
CRW1-60x16Z	40			60	5×10									40				16	
CRW1-70x19Z	45			70	6×10									47.5				19	
CRW1-80x21Z	55			80	7×10									52.5				21	
CRW2-30x5Z	20	12	6	30	1×15	7.5	5.5	2.5	M3	2.55	4.5	2.2	1.4	2	20	2.5	4	5	
CRW2-45x8Z	26			45	2×15										32				8
CRW2-60x11Z	32			60	3×15										44				11
CRW2-75x13Z	46			75	4×15										52				13
CRW2-90x16Z	52			90	5×15										64				16
CRW2-105x18Z	66			105	6×15										72				18
CRW2-120x21Z	72			120	7×15										84				21
CRW2-135x23Z	86			135	8×15										92				23
CRW2-150x26Z	92			150	9×15										104				26
CRW2-165x29Z	98			165	10×15										116				29
CRW2-180x32Z	104			180	11×15										128				32

CRW3/CRW4

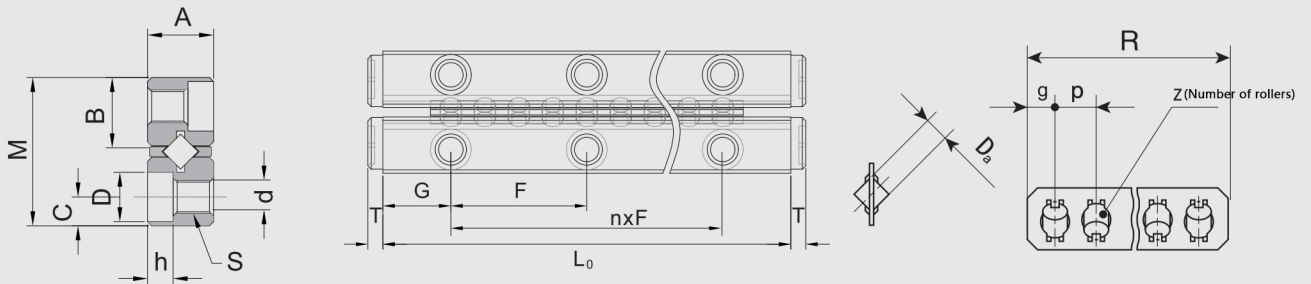

Model	Maximum stroke mm	Main dimensions														Number of rollers Z		
		Combined size				Assembly dimensions								Cylindrical roller with retainer				
		M	A	L0	nxF	G	B	C	S	d	D	h	T	Da	R		g	P
CRW3-50x7Z	30	18	8	50	1×25	12.5	8.3	3.5	M4	3.3	6	3.1	2	3	36	5	7	
CRW3-75x10Z	50			75	2×25										51			10
CRW3-100×14Z	60			100	3×25										71			14
CRW3-125x17Z	80			125	4×25										86			17
CRW3-150x21Z	90			150	5×25										106			21
CRW3-175x24Z	110			175	6×25										121			24
CRW3-200×28Z	120			200	7×25										141			28
CRW3-225x31Z	140			225	8×25										156			31
CRW3-250x35Z	150			250	9×25										176			35
CRW3-275x38Z	170			275	10×25										191			38
CRW3-300x42Z	180			300	11×25										211			42
CRW4-80x7Z	62	22	11	80	1×40	20	10	4.7	M5	4.3	8	4.2	2	4	51	4.5	7	
CRW4-120x11Z	86			120	2×40										79			11
CRW4-160x15Z	110			160	3×40										107			15
CRW4-200x19Z	134			200	4×40										135			19
CRW4-240×23Z	158			240	5×40										163			23
CRW4-280×27Z	182			280	6×40										191			27
CRW4-320x31Z	206			320	7×40										219			31
CRW4-360x35Z	230			360	8×40										247			35
CRW4-400x39Z	254			400	9×40										275			39
CRW4-440x43Z	278			440	10×40										303			43
CRW4-480x47Z	302			480	11×40										331			47

CRW6/CRW9

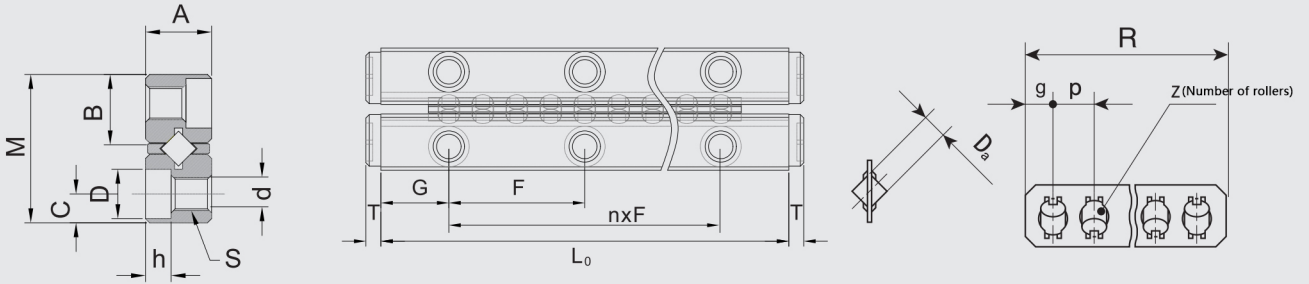

Model	Maximum stroke mm	Main dimensions																Number of rollers Z
		Combined size				Assembly dimensions								Cylindrical roller with retainer				
		M	A	L0	nxF	G	B	C	S	d	D	h	T	Da	R	g	P	
CRW6-100x7Z	60	30 (31)	15	100	1×50	25	13.6 (14.1)	6	M6	5.2	9.5	5.2	2.9	6	70	6	10	7
CRW6-150x10Z	100			150	2×50										100			10
CRW6-200x13Z	140			200	3×50										130			13
CRW6-250x17Z	160			250	4×50										170			17
CRW6-300x20Z	200			300	5×50										200			20
CRW6-350x24Z	220			350	6×50										240			24
CRW6-400x27Z	260			400	7×50										270			27
CRW6-450x31Z	280			450	8×50										310			31
CRW6-500x34Z	320			500	9×50										340			34
CRW6-550x38Z	340			550	10×50										380			38
CRW6-600x41Z	380			600	11×50										410			41
CRW9-200x10Z	120	40 (44)	20 (22)	200	1×100	50	18.1 (20.2)	8	M8	6.8	10.5	6.2	4	9	140	7.5	14	10
CRW9-300x15Z	180			300	2×100										210			15
CRW9-400x20Z	240			400	3×100										280			20
CRW9-500x25Z	300			500	4×100										350			25
CRW9-600x30Z	360			600	5×100										420			30
CRW9-700x35Z	420			700	6×100										490			35
CRW9-800x40Z	480			800	7×100										560			40

SVW1/SVW2

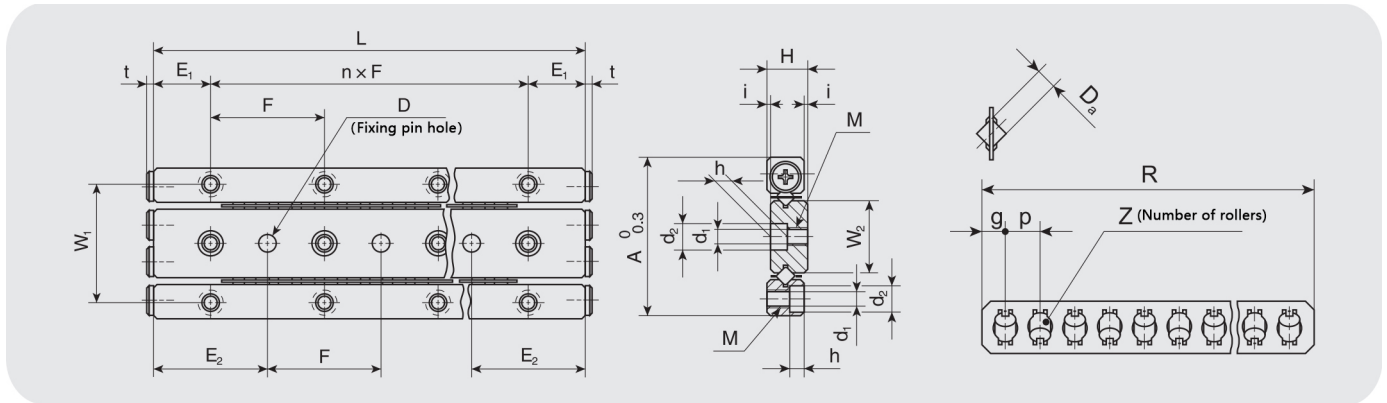

Model	Maximum stroke mm	Appearance			Cylindrical roller with retainer				Main dimensions and allowable tolerances												
		A	H	L(nxF)	P	g	R	Z	Da	W	W ₂	E ₁	E ₂	M	d ₁	d ₂	h	D	Dimensional tolerance	t	
SVW3-50x8Z	20	36	8.5	50(1x25)	0.5	5	3.5	40	8	3	29	16.6	12.5	25	M4	3.3	6	3.1	4	0.012	1.5
SVW3-75x12Z	30			75(2x25)				60	12												
SVW3-100x16Z	40			100(3x25)				80	16												
SVW3-125x20Z	50			125(4x25)				100	20												
SVW3-150x24Z	60			150(5x25)				120	24												
SVW3-175x28Z	70			175(6x25)				140	28												
SVW3-200x32Z	80			200(7x25)				160	32												
SVW3-225x36Z	90			225(8x25)				180	36												
SVW3-250x40Z	100			250(9x25)				200	40												
SVW3-275x44Z	110			275(10x25)				220	44												
SVW3-300x48Z	120			300(11x25)				240	48												
SVW4-80x10Z	20			44				11.5	80(1x40)												
SVW4-120x14Z	44	120(2x40)	98		14																
SVW4-160x19Z	54	160(3x40)	133		19																
SVW4-200x23Z	78	200(4x40)	161		23																
SVW4-240x28Z	88	240(5x40)	196		28																
SVW4-280x32Z	112	280(6x40)	224		32																
SVW4-320x37Z	122	320(7x40)	259		37																
SVW4-360x42Z	132	360(8x40)	294		42																
SVW4-400x46Z	156	400(9x40)	322		46																
SVW4-440x51Z	166	440(10x40)	357		51																
SVW4-480x55Z	190	480(11x40)	385		55																

SVW3/SVW4

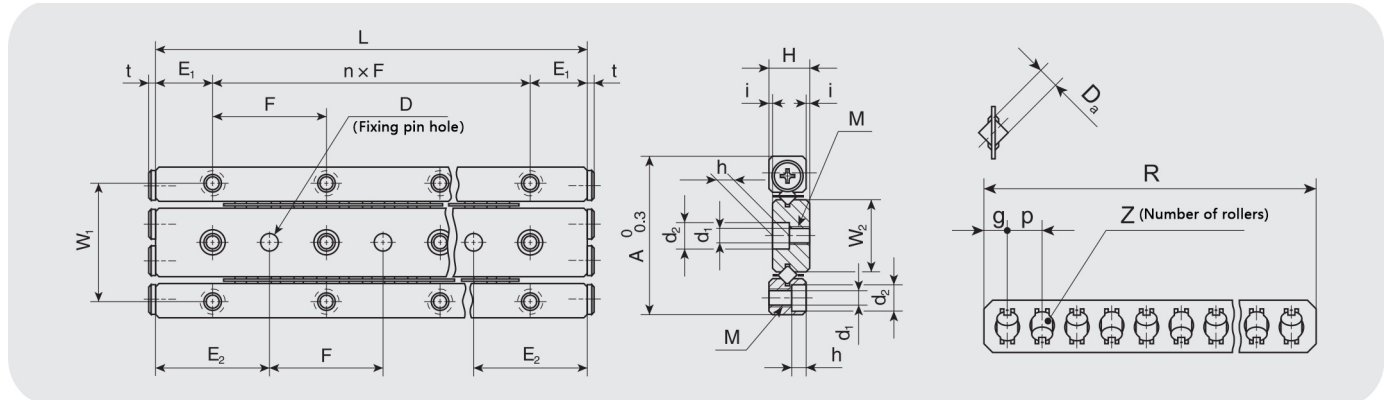

Model	Maximum stroke mm	Appearance			Cylindrical roller with retainer				Main dimensions and allowable tolerances												
		A	H	L(nxF)	P	g	R	Z	Da	W	W2	E1	E2	M	d1	d2	h	D	Dimensional tolerance	t	
SVW3-50x8Z	20	36	8.5	50(1x25)	0.5	5	3.5	40	8	3	29	16.6	12.5	25	M4	3.3	6	3.1	4	0.012	1.5
SVW3-75x12Z	30			75(2x25)				60	12												
SVW3-100x16Z	40			100(3x25)				80	16												
SVW3-125x20Z	50			125(4x25)				100	20												
SVW3-150x24Z	60			150(5x25)				120	24												
SVW3-175x28Z	70			175(6x25)				140	28												
SVW3-200x32Z	80			200(7x25)				160	32												
SVW3-225x36Z	90			225(8x25)				180	36												
SVW3-250x40Z	100			250(9x25)				200	40												
SVW3-275x44Z	110			275(10x25)				220	44												
SVW3-300x48Z	120			300(11x25)				240	48												
SVW4-80x10Z	20	44	11.5	80(1x40)	0.5	7	5	70	10	4	35	20	20	40	M5	4.3	7.5	4.1	5	0.012	2
SVW4-120x14Z	44			120(2x40)				98	14												
SVW4-160x19Z	54			160(3x40)				133	19												
SVW4-200x23Z	78			200(4x40)				161	23												
SVW4-240x28Z	88			240(5x40)				196	28												
SVW4-280x32Z	112			280(6x40)				224	32												
SVW4-320x37Z	122			320(7x40)				259	37												
SVW4-360x42Z	132			360(8x40)				294	42												
SVW4-400x46Z	156			400(9x40)				322	46												
SVW4-440x51Z	166			440(10x40)				357	51												
SVW4-480x55Z	190			480(11x40)				385	55												

NV2/NV3

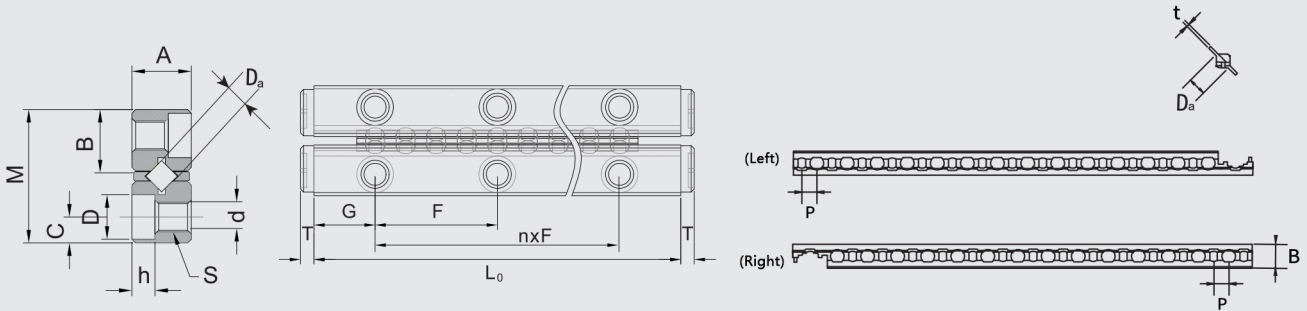

Model	Maximum stroke mm	Main dimensions															Number of rollers Z	
		Combined size				Assembly dimensions								Cylindrical roller with retainer				
		M	A	LO	nxF	G	B	C	S	d	D	h	T	Da	R	g		P
NV2-30x5Z	18	12	6	30	1x15	7.5	5.7	2.5	M3	2.55	4.4	2	1.4	2	22	2.5	2.35	5
NV2-45x9Z	25			45	2x15										30			9
NV2-60x15Z	30			60	3x15										42			15
NV2-75x19Z	40			75	4x15										50			19
NV2-90x23Z	50			90	5x15										58			23
NV2-105x27Z	65			105	6x15										66			27
NV2-120x33Z	70			120	7x15										78			33
NV2-135x37Z	80			135	8x15										86			37
NV2-150x41Z	90			150	9x15										94			41
NV2-165x47Z	95			165	10x15										106			47
NV2-180x51Z	100			180	11x15										114			51
NV3-50x9Z	25	18	8	50	1x25	12.5	8.6	3.5	M4	3.3	6	3.1	1.5	3	41.5	1.75	3.5	9
NV3-75x13Z	48			75	2x25										55.5			13
NV3-100x19Z	60			100	3x25										76.5			19
NV3-125x23Z	83			125	4x25										90.5			23
NV3-150x29Z	90			150	5x25										111.5			29
NV3-175x35Z	103			175	6x25										132.5			35
NV3-200x41Z	113			200	7x25										153.5			41
NV3-225x43Z	150			225	8x25										160.5			43

NV4/NV6

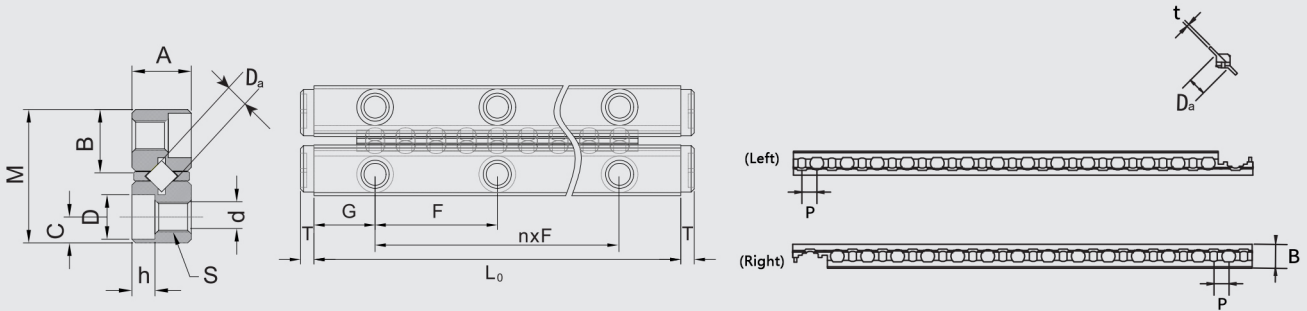

Model	Maximum stroke mm	Main dimensions																Number of rollers Z
		Combined size				Assembly dimensions								Cylindrical roller with retainer				
		M	A	LO	nxP	G	B	C	S	d	D	h	T	Da	R	g	P	
NV4-80x9Z	60	22	11	80	1x40	20	10.65	4.5	M5	4.3	8	4.2	2	4	48.7	2.1	4.3	9
NV4-120x17Z	75			120	2x40										83			17
NV4-160x23Z	105			160	3x40										109			23
NV4-200x29Z	130			200	4x40										134.7			29
NV4-240x37Z	143			240	5x40										169			37
NV4-280x43Z	170			280	6x40										195			43
NV6-100x9Z	63	31	15	100	1x50	25	15.15	6	M6	5.2	9.5	5.2	2.9	6	68.5	3.4	6.5	9
NV6-150x15Z	85			150	2x50										107.5			15
NV6-200x19Z	135			200	3x50										133.5			19
NV6-250x25Z	158			250	4x50										172.5			25
NV6-300x31Z	180			300	5x50										211.5			31
NV6-350x35Z	230			350	6x50										237.5			35
NV6-400x39Z	275			400	7x50										263.5			39

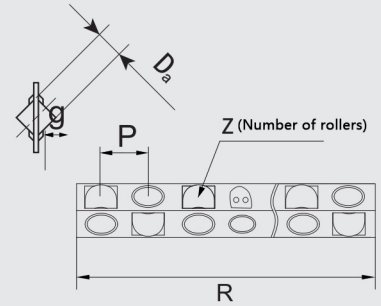
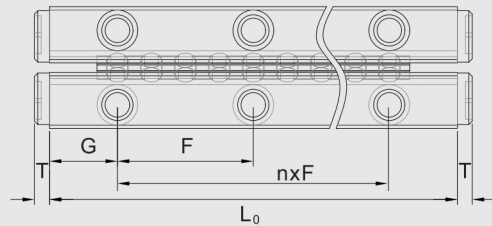
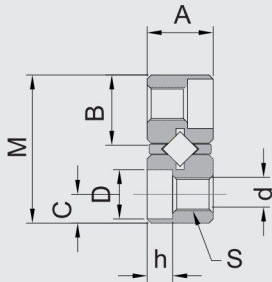
RNG2/RNG3

Model	Maximum stroke mm	Main dimensions																Number of rollers Z
		Combined size				Assembly dimensions									Cylindrical roller with retainer			
		M	A	L0	NxF	G	B	C	S	d	D	h	T	Da	R	g	P	
RNG2-30x4Z	20	12	6	30	1×15	7.5	5.5	2.5	M3	2.6	4.5	2.2	1.4	2	20	2.5	4	4
RNG2-45x8Z	18			45	2×15										36			8
RNG2-60x10Z	32			60	3×15										44			10
RNG2-75x12Z	46			75	4×15										52			12
RNG2-90x16Z	44			90	5×15										68			16
RNG2-105x18Z	58			105	6×15										76			18
RNG2-120×20Z	72			120	7×15										84			20
RNG2-135x22Z	86			135	8×15										92			22
RNG2-150×26Z	84			150	9×15										108			26
RNG2-165×28Z	98			165	10×15										116			28
RNG2-180x30Z	112			180	11×15										124			30
RNG3-50x6Z	30	18	8	50	1×25	12.5	8.3	3.5	M4	3.3	6	3.1	1.5	3	35	3.5	5	6
RNG3-75x10Z	40			75	2×25										55			10
RNG3-100x14Z	50			100	3×25										75			14
RNG3-125x16Z	80			125	4×25										85			16
RNG3-150×20Z	90			150	5×25										105			20
RNG3-175x24Z	100			175	6×25										125			24
RNG3-200x28Z	110			200	7×25										145			28
RNG3-225x30Z	140			225	8×25										155			30
RNG3-250x34Z	150			250	9×25										175			34
RNG3-275x38Z	160			275	10×25										195			38
RNG3-300x42Z	170			300	11×25										215			42

RNG4/RNG6

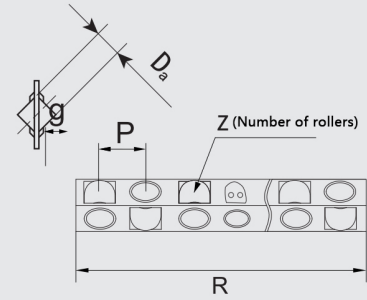
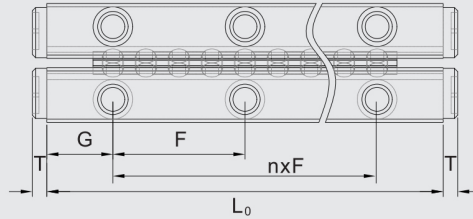
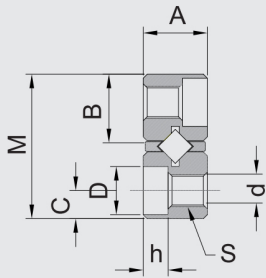

Model	Maximum stroke mm	Main dimensions																Number of rollers Z
		Combined size				Assembly dimensions								Cylindrical roller with retainer				
		M	A	L0	nxF	G	B	C	S	d	D	h	T	Da	R	g	P	
RNG4-80x6Z	70	22	11	80	1×40	20	10	4.5	M5	4.3	8	4.2	2	4.5	45	4	6.5	6
RNG4-120x10Z	98			120	2×40										71			10
RNG4-160x14Z	126			160	3×40										97			14
RNG4-200x18Z	154			200	4×40										123			18
RNG4-240x22Z	182			240	5×40										149			22
RNG4-280x26Z	210			280	6×40										175			26
RNG4-320x30Z	238			320	7×40										201			30
RNG4-360x34Z	266			360	8×40										227			34
RNG4-400x38Z	294			400	9×40										253			38
RNG4-440x42Z	322			440	10×40										279			42
RNG4-480x46Z	350			480	11×40										305			46
RNG6-100x6Z	81	30 (31)	15	100	1×50	25	13.6 (14.1)	6	M6	5.2	9.5	5.2	2.9	6.5	59.5	5	8.5	6
RNG6-150x10Z	113			150	2×50										93.5			10
RNG6-200x12Z	179			200	3×50										110.5			12
RNG6-250x16Z	211			250	4×50										144.5			16
RNG6-300x20Z	243			300	5×50										178.5			20
RNG6-350x24Z	275			350	6×50										212.5			24
RNG6-400x26Z	341			400	7×50										229.5			26
RNG6-450x30Z	373			450	8×50										263.5			30
RNG6-500x34Z	405			500	9×50										297.5			34
RNG6-550x38Z	437			550	10×50										331.5			38
RNG6-600x40Z	503			600	11×50										348.5			40

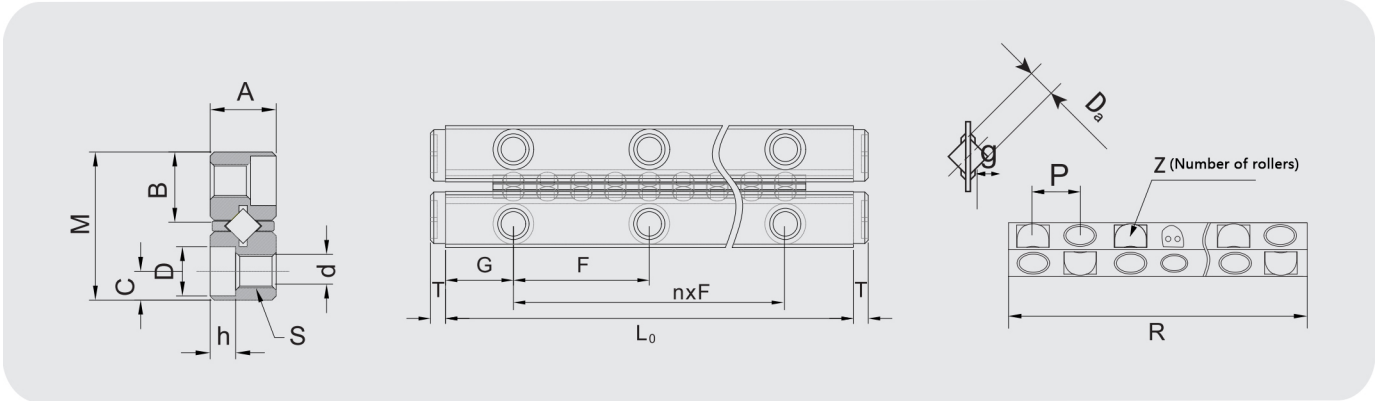
RGN9

Model	Maximum stroke mm	Main dimensions																Number of rollers Z
		Combined size				Assembly dimensions								Cylindrical roller with retainer				
		M	A	L0	nxP	G	B	C	S	d	D	h	T	Da	R	g	P	
RNG9-200x10Z	136	40 (44)	20 (22)	200	1×100	50	18.1 (20.2)	8	M8	6.8	10.5	6.2	4	9	132	7.5	12	10
RNG9-300x14Z	240			300	2×100										180			14
RNG9-400×20Z	296			400	3×100										252			20
RNG9-500×24Z	400			500	4×100										300			24
RNG9-600x30Z	456			600	5×100										372			30
RNG9-700x34Z	560			700	6×100										420			34
RNG9-800×40Z	616			800	7×100										492			40

LWRE3 ACS

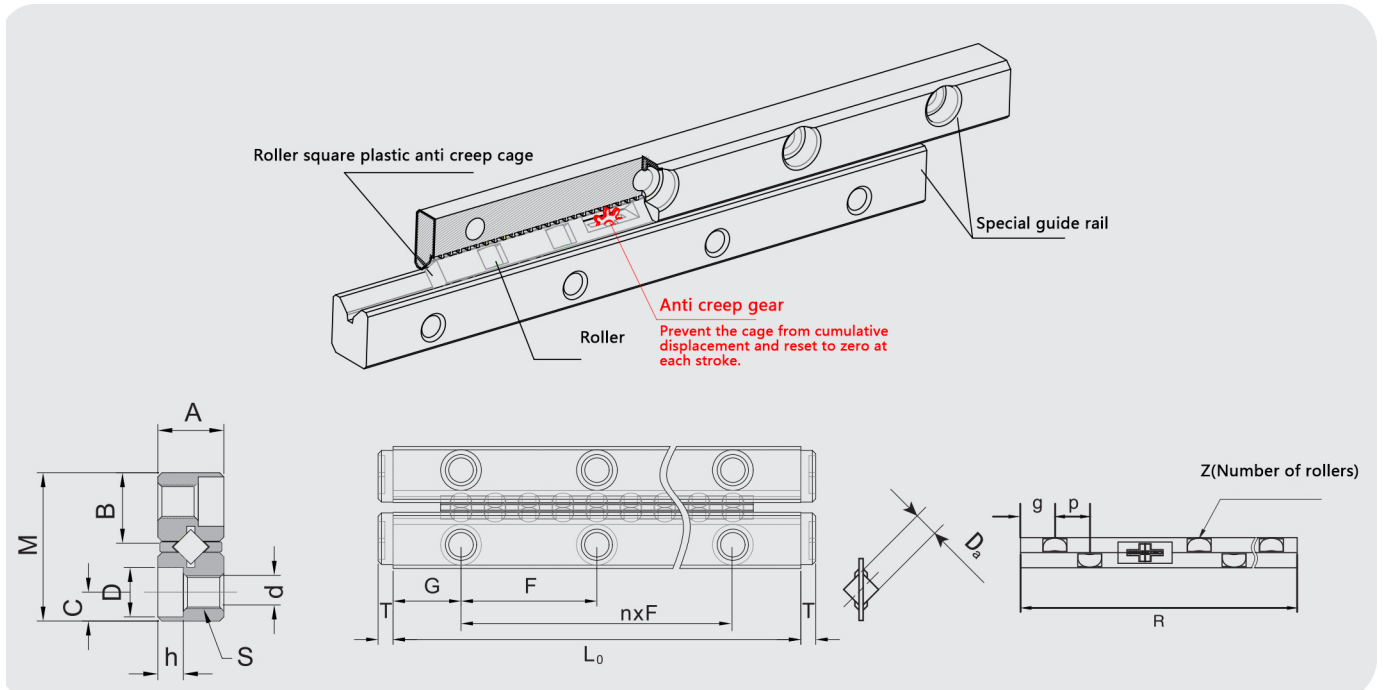

Model	Maximum stroke mm	Main dimensions														Number of rollers Z	
		Combined size		Assembly dimensions										Cylindrical roller with retainer			
		M	A	L0	nxF	G	B	C	S	d	D	h	T	R	Da		P
LWRE3-50x4Z ACS	19	18	8	30	1x25	12.5	8.69	3.5	M4	3.3	6	3.2	2.5	40.4	3	P	4
LWRE3-75x6Z ACS	45			45	2x25									52.4			6
LWRE3-100x8ZACS	71			60	3x25									64.4			8
LWRE3-125x12Z ACS	73			75	4x25									88.4			12
LWRE3-150x14Z ACS	99			90	5x25									100.4			14
LWRE3-175x18ZACS	101			105	6x25									114.4			18
LWRE3-200x20Z ACS	127			120	7x25									136.4			20
LWRE3-225x24Z ACS	129			135	8x25									160.4			24
LWRE3-250x26Z ACS	155			150	9x25									172.4			26
LWRE3-275x28ZACS	181			165	10x25									184.4			28
LWRE3-300x30ZACS	207	300	11x25	196.4	30												

LWRE4 ACS

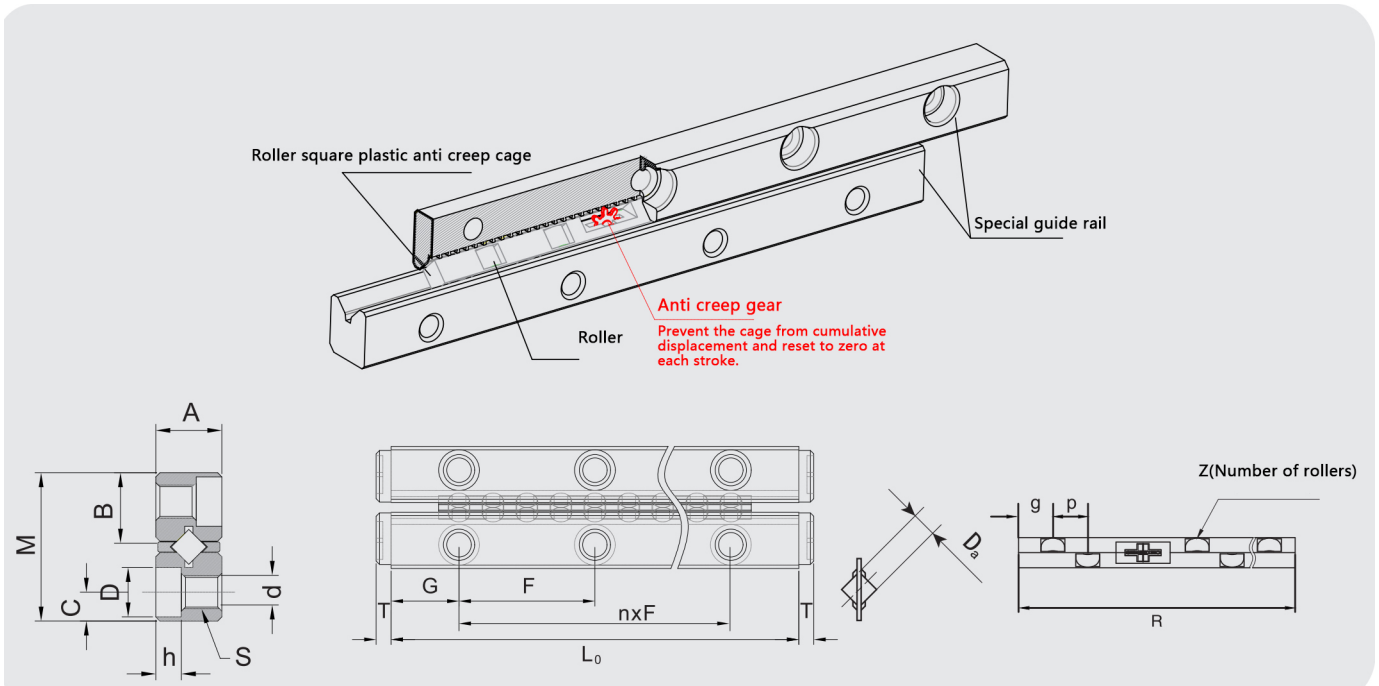

Model	Maximum stroke mm	Main dimensions														Number of rollers Z	
		Combined size			Assembly dimensions									Cylindrical roller with retainer			
		M	A	L0	nxF	G	B	C	S	d	D	h	T	R	Da		P
LWRE4-80x6ZACS	64	22	11	40	1x40	19.2	10.89	4.5	M5	4.3	7.9	4.2	2	48	4	6	6
LWRE4-120x10ZACS	96			120	2x40									72			10
LWRE4-160x14ZACS	128			160	3x40									96			14
LWRE4-200x20ZACS	136			200	4x40									132			20
LWRE4-240x24Z ACS	168			240	5x40									156			24
LWRE4-280x28ZACS	200			280	6x40									180			28
LWRE4-320x34Z ACS	208			320	7x40									216			34
LWRE4-360x38ZACS	240			360	8x40									240			38
LWRE4-400x40ZACS	296			400	9x40									252			40
LWRE4-440x46ZACS	304			440	10x40									288			46
LWRE4-480x50ZACS	336			480	11x40									312			50

AC4/AC6

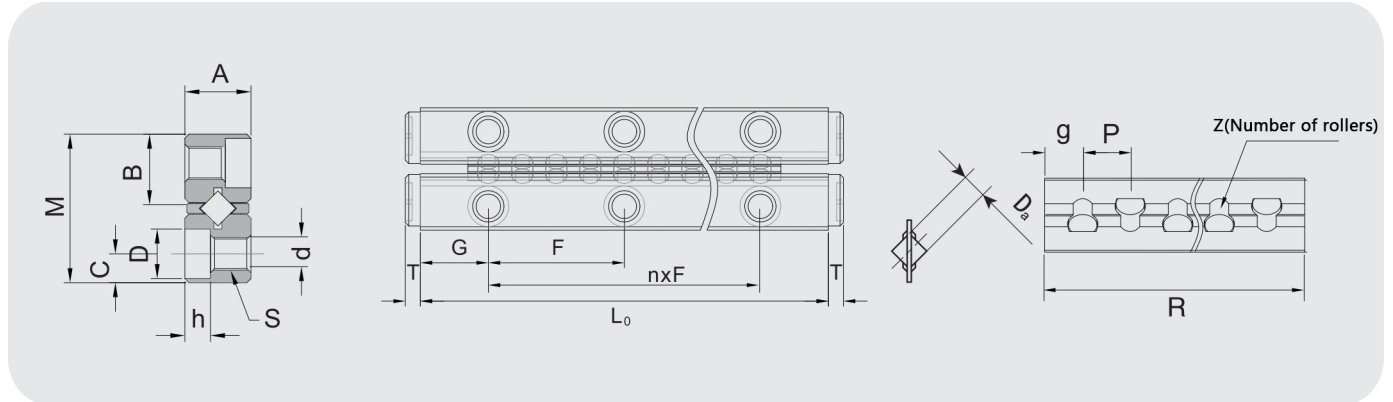
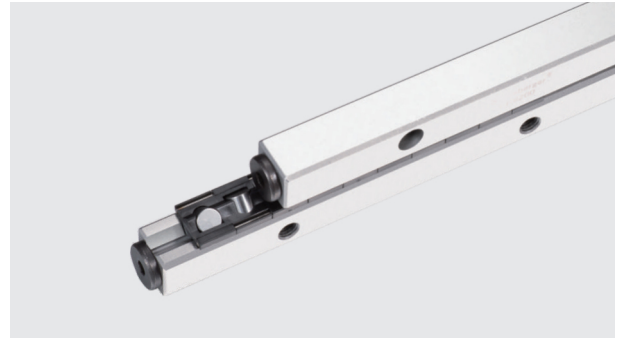

Model	Maximum stroke mm	Main dimensions															
		Combined size				Assembly dimensions											
		M	A	L0	nxF	G	B	C	S	d	D	h	T	Da	R	g	P
AC4-80x7Z	62	22	11	80	1x40	20	10.2	4.5	M5	4.3	8	4.2	2.5	4	49	3.5	7
AC4-120x11Z	86			120	2x40										77		
AC4-160x15Z	110			160	3x40										105		
AC4-200x19Z	134			200	4x40										133		
AC4-240x23Z	158			240	5x40										161		
AC4-280x27Z	182			280	6x40										189		
AC4-320x31Z	206			320	7x40										217		
AC4-360x35Z	230			360	8x40										245		
AC4-400x39Z	254			400	9x40										273		
AC4-440x43Z	278			440	10x40										301		
AC4-480x47Z	302			480	11x40										329		
AC6-100x7Z	74			31	15										100		
AC6-150x10Z	120	150	2x50			90											
AC6-200x13Z	166	200	3x50			117											
AC6-250x17Z	194	250	4x50			153											
AC6-300x20Z	240	300	5x50			180											
AC6-350x24Z	268	350	6x50			216											
AC6-400x27Z	314	400	7x50			243											
AC6-450x31Z	342	450	8x50			279											
AC6-500x34Z	388	500	9x50			306											
AC6-550x38Z	416	550	10x50			342											
AC6-600x41Z	462	600	11x50			369											

AC9

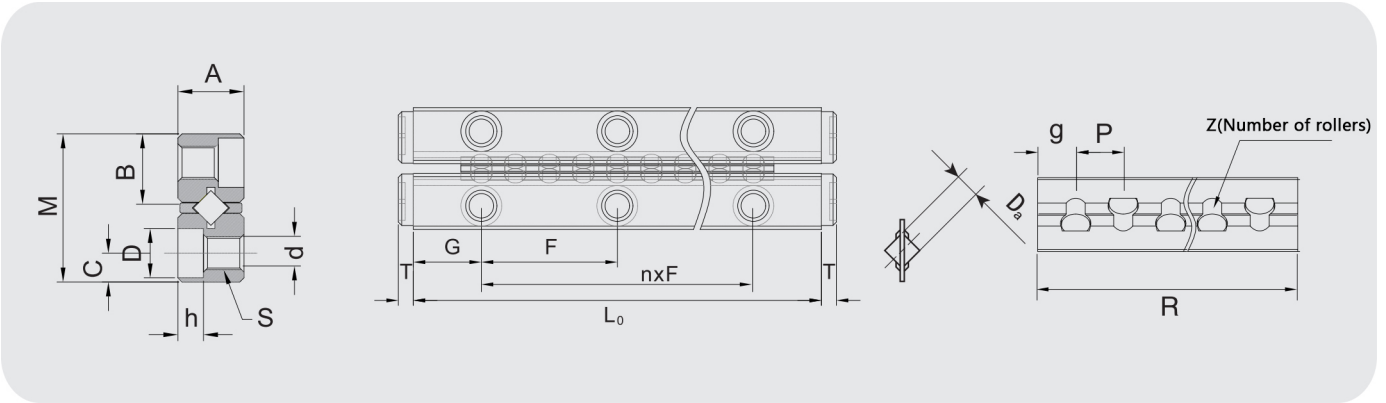

Model	Maximum stroke mm	Main dimensions															
		Combined size				Assembly dimensions									Cylindrical roller with retainer		
		M	A	L0	nxF	G	B	C	S	d	D	h	T	Da	R	g	P
AC9-200x10Z	120	44	22	200	1x100	50	19.7	9	M8	10.5	6.8	6.2	4	9	140	7	14
AC9-300x15Z	180			300	2x100										210		
AC9-400x20Z	240			400	3x100										280		
AC9-500x25Z	300			500	4x100										350		
AC9-600x30Z	360			600	5x100										420		
AC9-700x35Z	420			700	6x100										490		
AC9-800x40Z	480			800	7x100										560		

N/O 62015 Cross Needle Guide

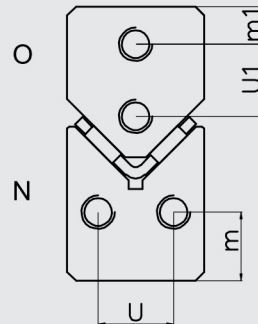
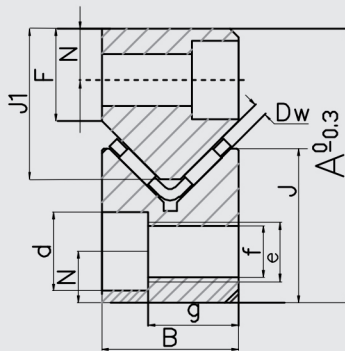
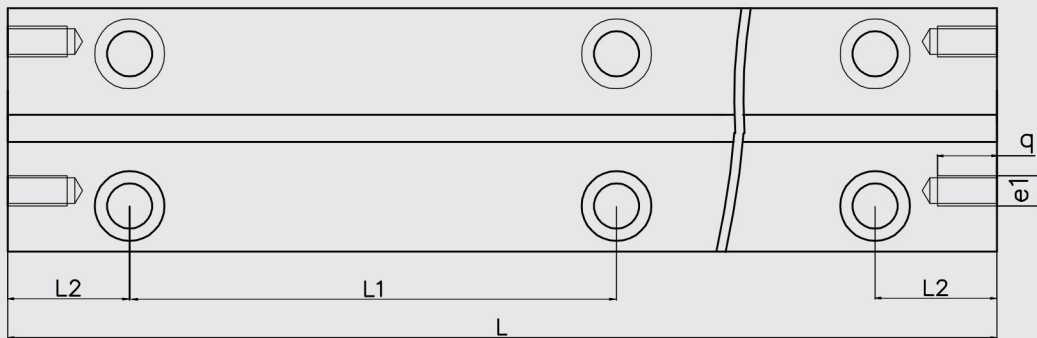

Model	Specifications	Size	A	B	Dw	F	J	J1	L1	L2	N	d	e	e1	f	9	m	m1	q	u	u1
N/O	62015	100	31	15	2	11	16	18	50	25	6	9.5	M6	M3	5.2	9.8	7.5	4.5	7	7	7
		150																			
		200																			
		250																			
		300																			
		350																			
		400																			
		450																			
		500																			

1)For length 100:L1=35(2X) 2)For length 100:L1=50(3)min.154)min.20

N/O 92025 Cross Needle Guide

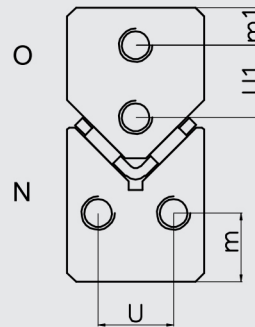
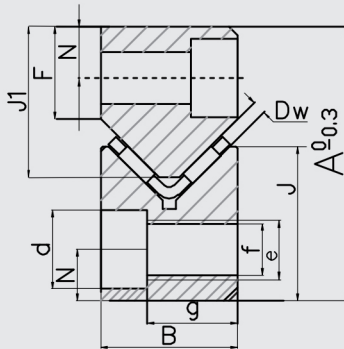
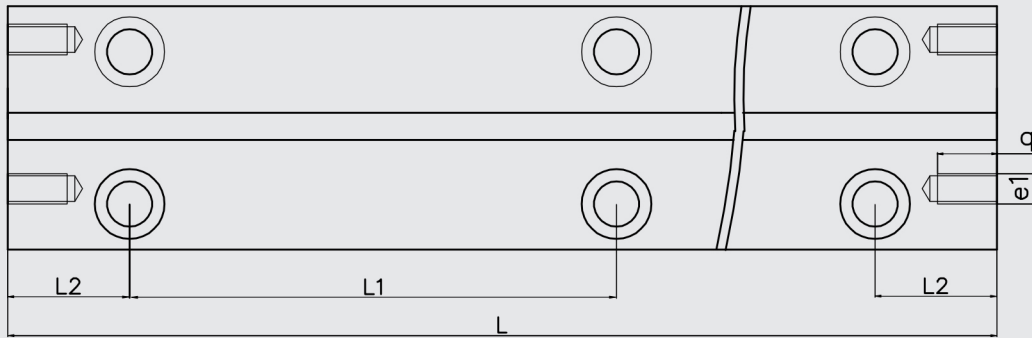

Model	Specifications	Size	A	B	Dw	F	J	J1	L1	L2	N	d	e	e1	f	g	m	m1	q	u	u1
N/O	92025	100	44	22	2	15	24	24.5	100	50	9	10.5	M8	M4	6.8	15.8	11	6	11	10	10
		150																			
		200																			
		250																			
		300																			
		350																			
		400																			
		450																			
500																					

1)For length 100:L1=35(2X) 2)For length 100:L1=50 3)min.154)min.20

N/O 2025 Cross Needle Guide

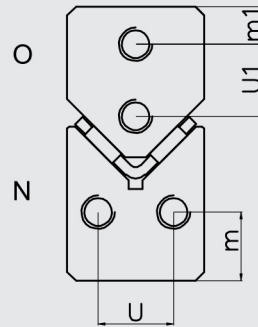
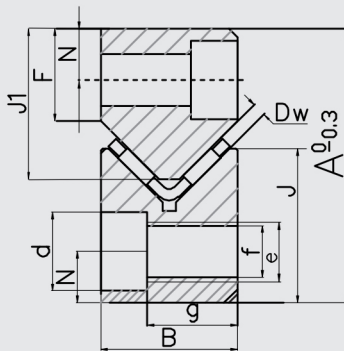
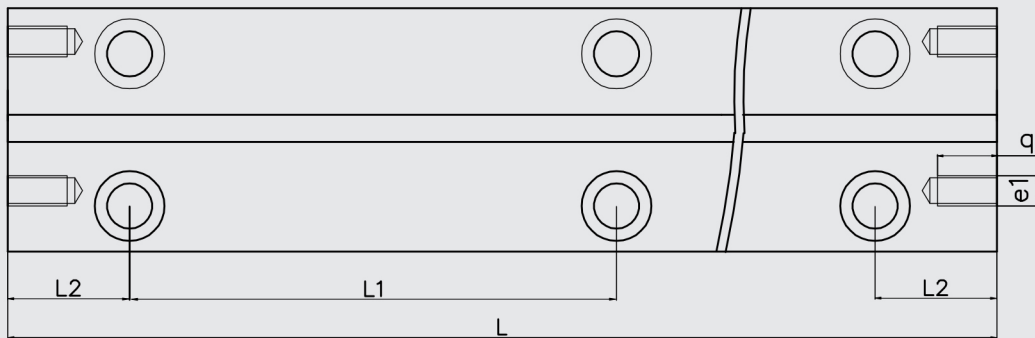

Model	Specifications	Size	A	B	Dw	F	J	J1	L1	L2	N	d	e	e1	f	g	m	m1	q	u	u1	
N/O	2025	200																				
		300																				
		400																				
		500																				
		600	52	25	2	18	28	29	100	50	10	13.5	M10	M6	8.5	16.8	12	7	11	14	11	
		700																				
		800																				
		900																				
1000																						

1)For length 100:L1=35(2X) 2)For length 100:L1=50 3)min.154)min.20

N/O 2535 Cross Needle Guide

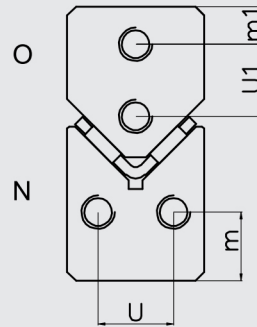
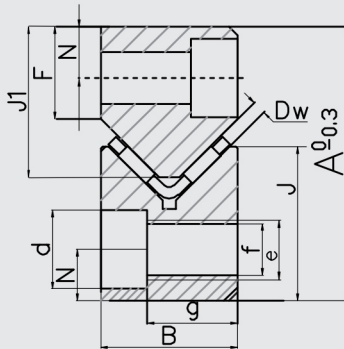
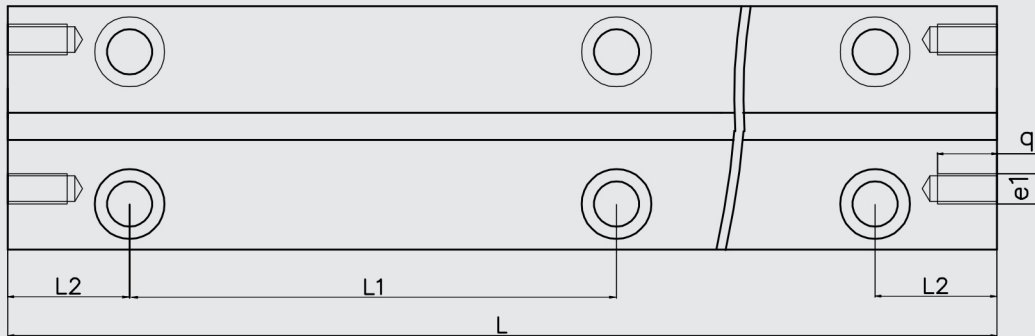

Model	Specifications	Size	A	B	Dw	F	J	J1	L1	L2	N	d	e	e1	f	g	m	m1	q	u	U1
N/O	2535	300	62	30	2.5	22	34	35	100	50	12	16.5	M12	M6	10.5	19.8	15	8	11	18	12
		400																			
		500																			
		600																			
		700																			
		800																			
		900																			
		1000																			

1)For length 100:L1=35(2X) 2)For length 100:L1=50 3)min.15 4)min.20

N/O 3405 Cross Needle Guide

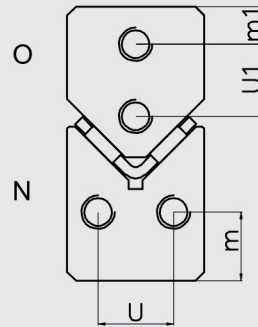
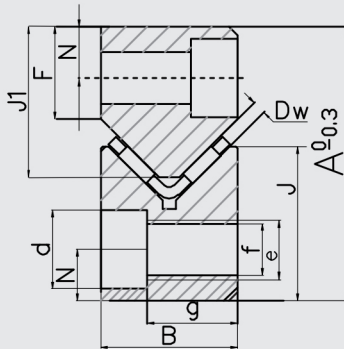
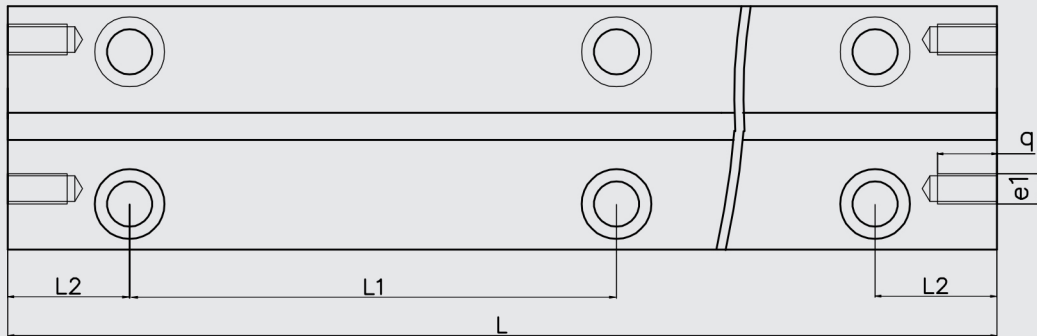

Model	Specifications	Size	A	B	Dw	F	J	J1	L1	L2	N	d	e	e1	f	g	m	m1	q	u	u1
N/O	3045	500	74	35	3	25	42.5	40	100	50	14	18.5	M14	M6	12.5	22.8	18	10	11	19	16
		600																			
		700																			
		800																			
		900																			
		1000																			
		1100																			
1200																					

1)For length 100:L1=35(2X) 2)For length 100:L1=503)min.154)min.20

N/O 3555 Cross Needle Guide

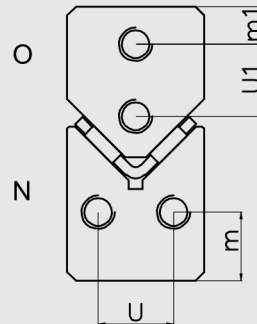
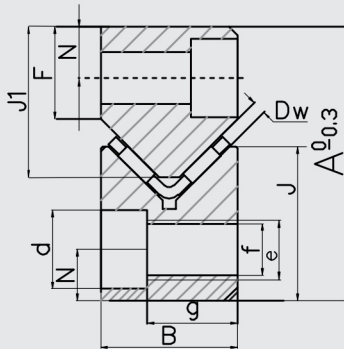
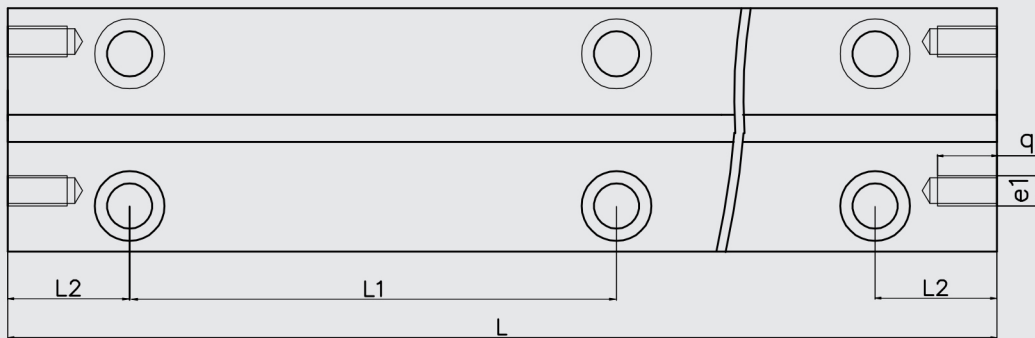

Model	Specifications	Size	A	B	Dw	F	J	J1	L1	L2	N	d	e	e1	f	g	m	m1	q	u	u1
N/O	3555	500	78	45	3.5	25	45	45	100	50	14	18.5	M14	M6	12.5	32.8	18	12	11	29	20
		600																			
		700																			
		800																			
		900																			
		1000																			
		1100																			
1200																					

1)For length 100:L1=35(2X) 2)For length 100:L1=503)min.154)min.20

M/V 3015 Cross Needle Guide

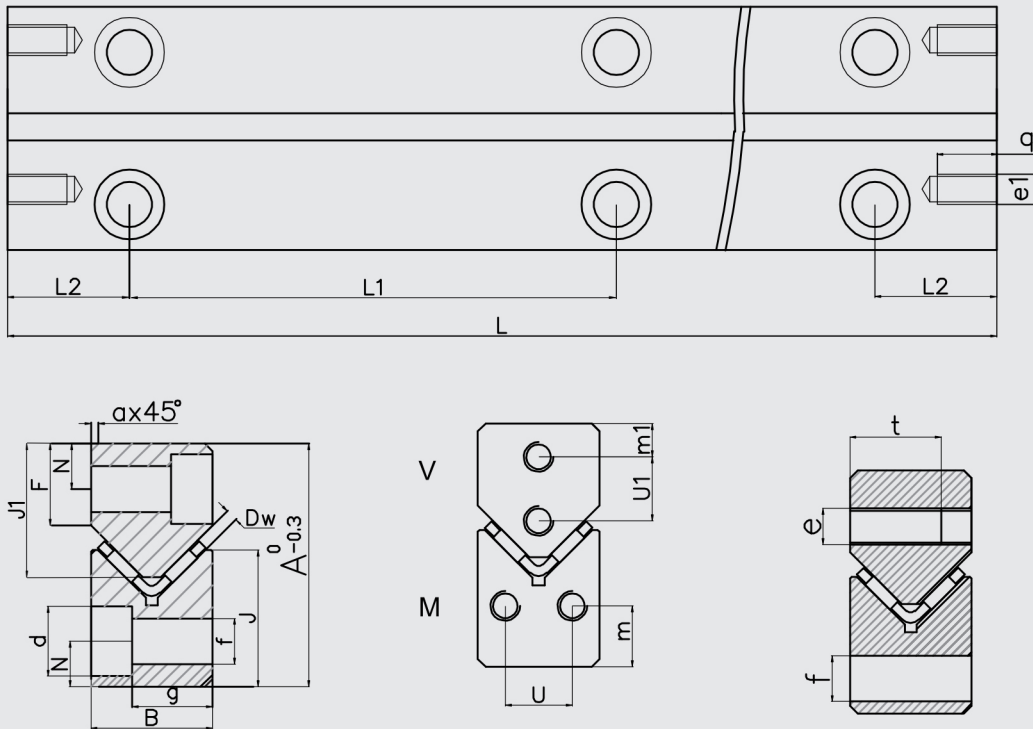

Model	Specifications	Size	A	B	Dw	F	J	J1	L1	L2	N	a	d	e	e1	f	g	m	m1	q	t	u	u1
M/V	3015	100	30	15	2	10.5	15.5	17.4	40	3	5.5	0.7	8.5	M4	M3	5.3	10.5	8	5.5	7	15	7	7
		150																					
		200																					
		300																					
		400																					
		500																					
600																							

1)For length 100:L1=35(2X) 2)For length 100:L1=50 3)min.15 4)min.20

M/V 4020 Cross Needle Guide

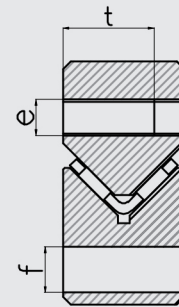
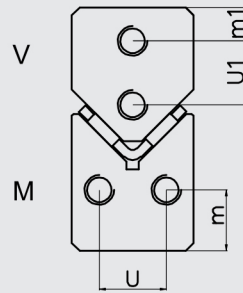
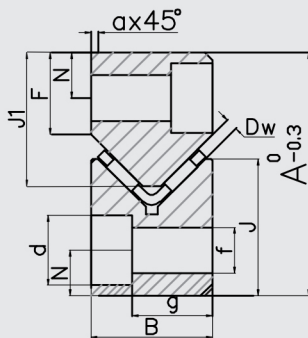
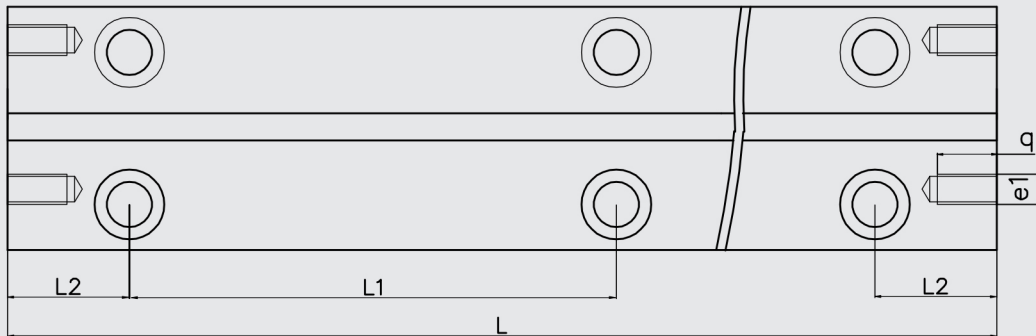

Model	Specifications	Size	A	B	Dw	F	J	J1	L1	L2	N	a	d	e	e1	f	9	m	m1	q	t	u	u1
M/V	4020	100	40	20	2	13.5	22.5	22	2'80	4	7.5	1.3	11.5	M6	M5	7.5	13.2	10	5.5	8	20	11	10.5
		150																					
		200																					
		300																					
		400																					
		500																					
600																							

1)For length 100:L1=35(2X) 2)For length 100:L1=503)min.154)min.20

M/V 5025 Cross Needle Guide

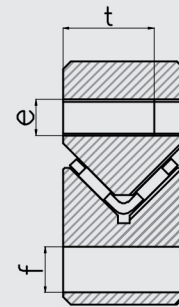
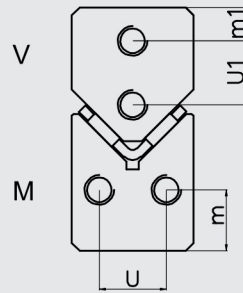
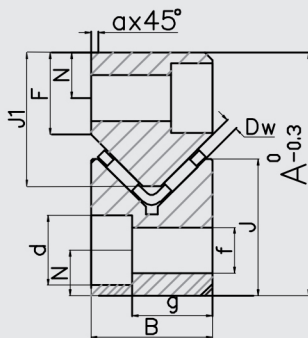
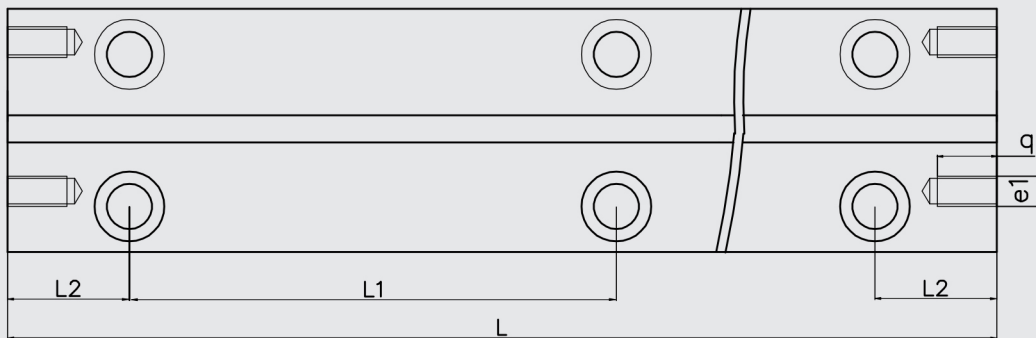

Model	Specifications	Size	A	B	Dw	F	J	J1	L1	L2	N	a	d	e	e1	f	g	m	m1	q	u	u1	
M/V	5025	100	50	25	2	17	28	28	280	4	10	1.3	11.5	M6	M6	7.5	18.2	12	7	9	15	13	13
		200																					
		300																					
		400																					
		500																					
		600																					
		700																					
		800																					
		900																					
		1000																					

1)For length 100:L1=35(2X) 2)For length 100:L1=50 3)min.154)min.20

M/V 6035 Cross Needle Guide

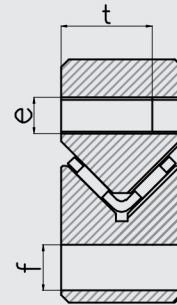
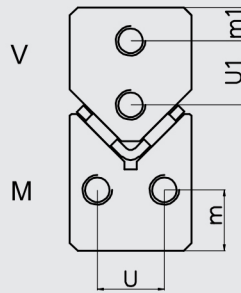
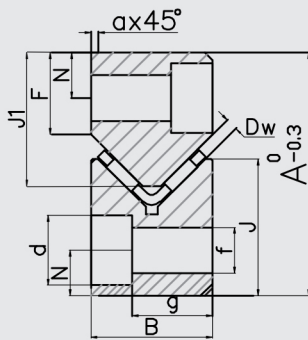
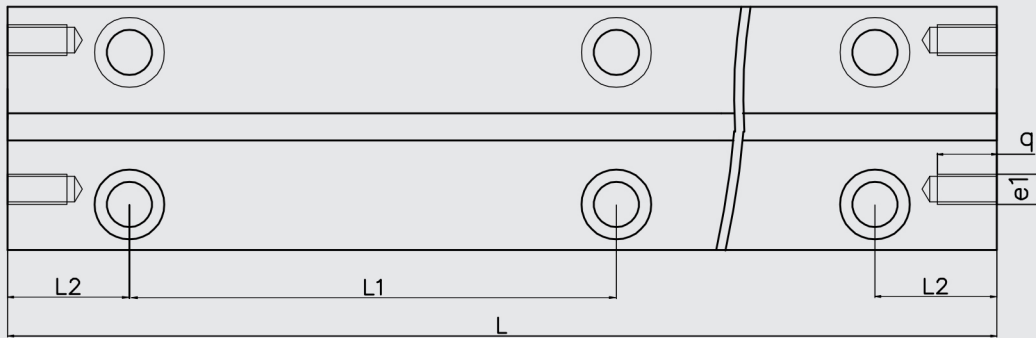

Model	Specifications	Size	A	B	Dw	F	J	J1	L1	L2	N	a	d	e	e1	f	g	m	m1	q	t	u	u1
M/V	6035	200	60	35	2.5	20	35	35.5	100	50	11	1.3	15	M8	M6	10	26	14	8	9	20	20	18
		300																					
		400																					
		500																					
		600																					
		700																					
		800																					
		900																					
1000																							

1)For length 100:L1=35(2X) 2)For length 100:L1=503)min.154)min.20

M/V 7040 Cross Needle Guide

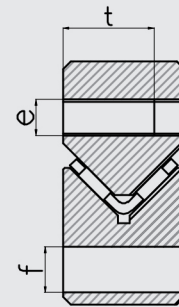
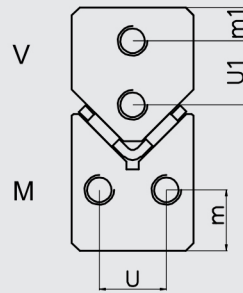
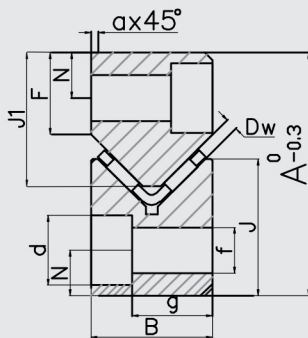
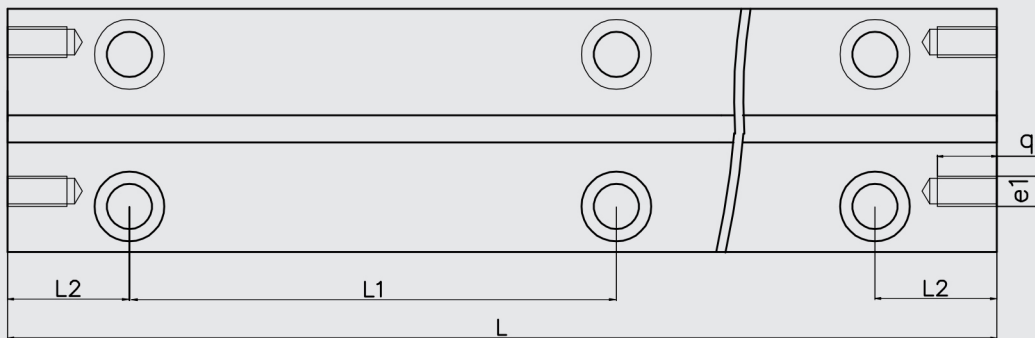

Model	Specifications	Size	A	B	Dw	F	J	J1	L1	L2	N	a	d	e	e1	f	g	m	m1	q	t	u	u1
M/V	7040	200	70	40	3	24	40	41.5	100	50	13	1.3	18.5	M10	M6	12.5	29	16	10	9	25	20	20
		300																					
		400																					
		500																					
		600																					
		700																					
		800																					
		900																					
1000																							

1)For length 100:L1=35(2X) 2)For length 100:L1=50 3)min.15 4)min.20

M/V 8050 Cross Needle Guide

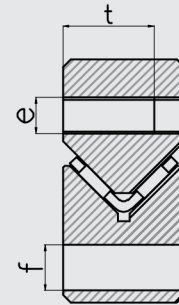
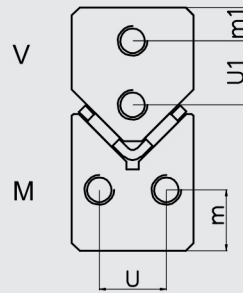
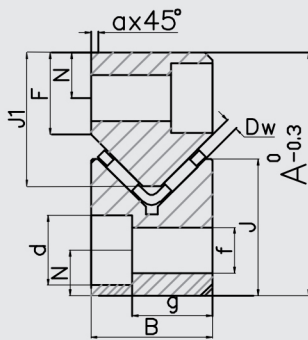
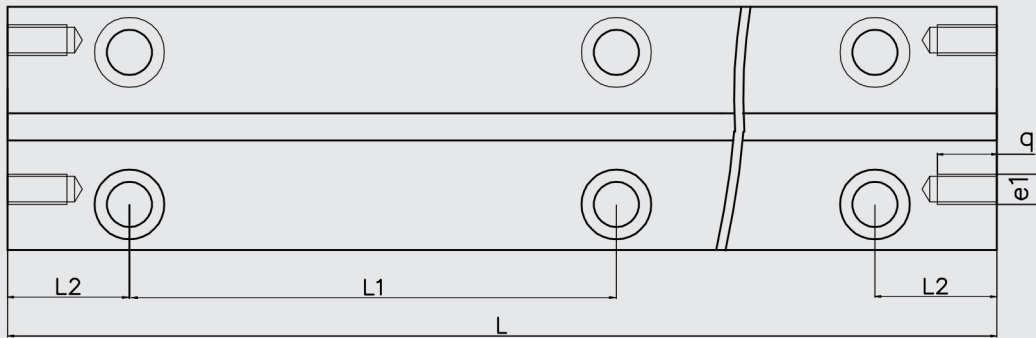

Model	Specifications	Size	A	B	Dw	F	J	J1	L1	L2	N	a	d	e	e1	f	g	m	m1	q	t	u	u1
M/V	8050	300	80	50	3.5	26	45	48	100	50	14	1.3	20	M12	M6	14	37	20	10	9	30	30	25
		400																					
		500																					
		600																					
		700																					
		800																					
		900																					
1000																							

1)For length 100:L1=35(2X) 2)For length 100:L1=50 3)min.154)min.20

LWR6

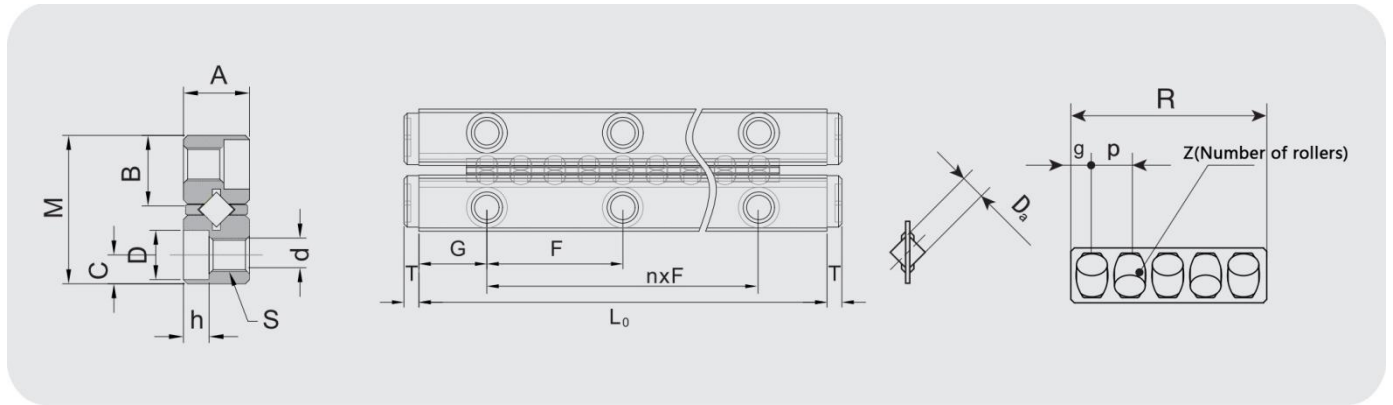
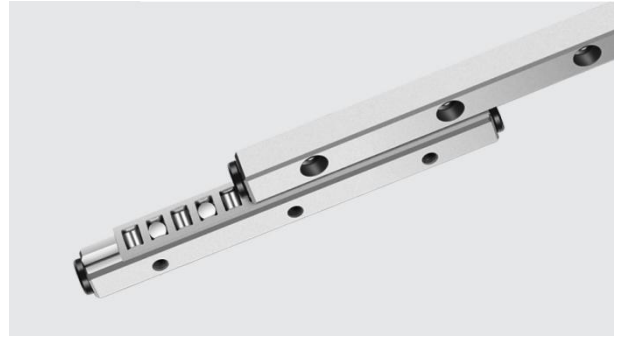

Model	Maximum stroke mm	Main dimensions														Number of rollers Z		
		Combined size				Assembly dimensions												
		M	A	L0	nxF	G	B	C	S	d	D	h	T	Da	R		g	P
LWR6-100x7Z	74	31	15	100	1x50	25	14.2	6	M6	5.2	9.5	5.2	3.2	6	63	6	9	7
LWR6-150x10Z	120			150	2x50										90			10
LWR6-200x13Z	166			200	3x50										117			13
LWR6-250x17Z	194			250	4x50										153			17
LWR6-300x20Z	240			300	5x50										180			20
LWR6-350x24Z	268			320	6x50										216			24
LWR6-400x27Z	314			400	7x50										243			27
LWR6-450x31Z	342			450	8x50										279			31
LWR6-500x34Z	388			500	9x50										306			34
LWR-6550x38Z	416			550	10x50										342			38
LWR-6600x41Z	462			600	11x50										369			41

LWREM3/LWREM4

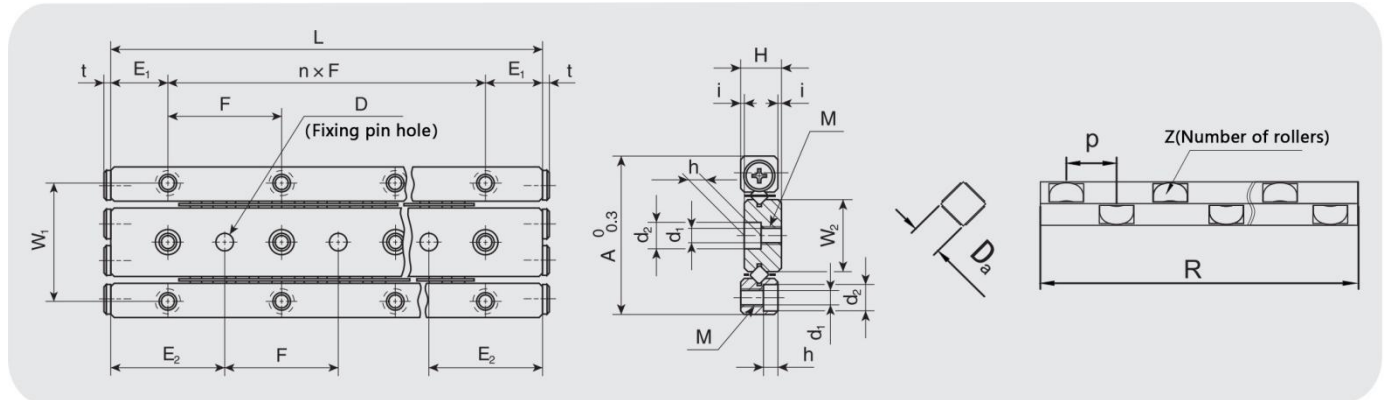

Model	Maximum stroke mm	appearance			Cylindrical roller with retainer			Main dimensions and allowable tolerances												
		A	H	L(nxF)	P	R	Z	Da	W1	W2	E1	E2	M	d1	d2	h	D	Dimensional tolerance	t	
LWREM3-50x6Z	28	36	8.5	50(1x25)	0.5	6	36	6	4	29	16.6	12.5	25	M4	3.3	6	3.1	4	0.012	1.5
LWREM3-75x8Z	54			75(2x25)			48	8												
LWREM3-100x11Z	68			100(3x25)			66	11												
LWREM3-125x14Z	82			125(4x25)			84	14												
LWREM3-150x17Z	96			150(5x25)			102	17												
LWREM3-175x20Z	110			175(6x25)			120	20												
LWREM3-200x23Z	124			200(7x25)			138	23												
LWREM3-225x26Z	138			225(8x25)			156	26												
LWREM3-250x29Z	152			250(9x25)			174	29												
LWREM3-275x31Z	178			275(10x25)			186	31												
LWREM3-300x35Z	180			300(11x25)			210	35												
LWREM4-80x8Z	64	44	11.5	80(1x40)	0.5	6	48	8	4	35	20	20	40	M5	4.3	7.5	4.1	5	0.012	2
LWREM4-120x12Z	96			120(2x40)			72	12												
LWREM4-160x17Z	116			160(3x40)			102	17												
LWREM4-200x22Z	136			200(4x40)			132	22												
LWREM4-240x27Z	156			240(5x40)			162	27												
LWREM4-280x31Z	188			280(6x40)			186	31												
LWREM4-320x36Z	208			320(7x40)			216	36												
LWREM4-360x41Z	228			360(8x40)			246	41												
LWREM4-400x45Z	260			400(9x40)			270	45												
LWREM4-440x50Z	280			440(10x40)			300	50												
LWREM4-480x54Z	312			480(11x40)			324	54												

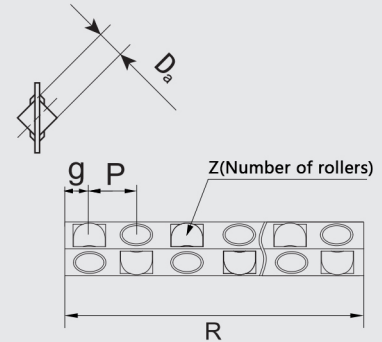
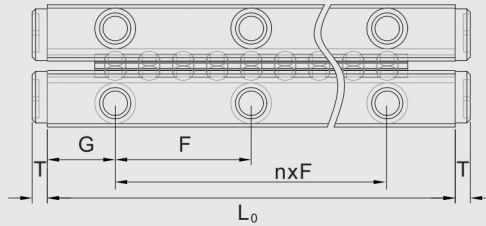
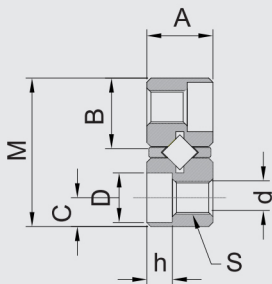
RN2/RN3

Model	Maximum stroke mm	Main dimensions																Number of rollers Z
		Combined size				Assembly dimensions									Cylindrical roller with retainer			
		M	A	L0	nxF	G	B	C	S	d	D	h	T	Da	R	g	P	
RN2-30x5Z	20	12	6	30	1×15	7.5	5.5	2.5	M3	2.6	4.5	2.2	1.4	2	20	2.5	4	5
RN2-45x8Z	26			45	2×15										32			8
RN2-60x11Z	32			60	3×15										44			11
RN2-75x13Z	46			75	4×15										52			13
RN2-90x16Z	52			90	5×15										64			16
RN2-105x18Z	66			105	6×15										72			18
RN2-120x21Z	72			120	7×15										84			21
RN2-135x23Z	86			135	8×15										92			23
RN2-150x26Z	92			150	9×15										104			26
RN2-165x29Z	98			165	10×15										116			29
RN2-180x32Z	104			180	11×15										128			32
RN3-50x7Z	30	18	8	50	1×25	12.5	8.3	3.5	M4	3.3	6	3.1	1.5	3	35	3.5	5	7
RN3-75x10Z	50			75	2×25										50			10
RN3-100x14Z	60			100	3×25										70			14
RN3-125x17Z	80			125	4×25										85			17
RN3-150x21Z	90			150	5×25										105			21
RN3-175x24Z	110			175	6×25										120			24
RN3-200x28Z	120			200	7×25										140			28
RN3-225x31Z	140			225	8×25										155			31
RN3-250x35Z	150			250	9×25										175			35
RN3-275x38Z	170			275	10×25										190			38
RN3-300x42Z	180			300	11×25										210			42

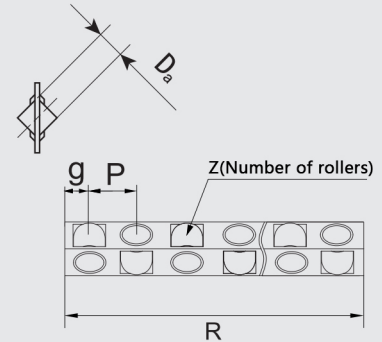
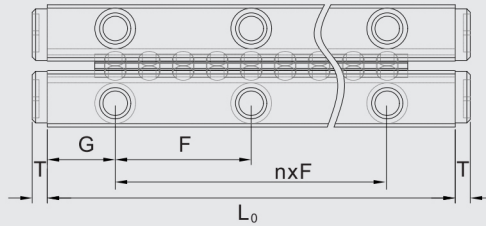
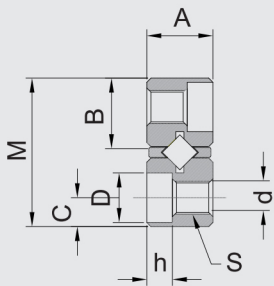
RN4/RN6

model	Maximum stroke mm	Main dimensions															Number of rollers Z	
		Combined size				Assembly dimensions								Cylindrical roller with retainer				
		M	A	L0	nxF	G	B	C	S	d	D	h	T	Da	R	g		P
RN4-80x7Z	62	22	11	80	1×40	20	10	4.5	M5	4.3	8	4.2	2	4.5	49	4	6.5	7
RN4-120x11Z	86			120	2×40										77			11
RN4-160x15Z	110			160	3×40										105			15
RN4-200x19Z	134			200	4×40										133			19
RN4-240x23Z	158			240	5×40										161			23
RN4-280×27Z	182			280	6×40										189			27
RN4-320x31Z	206			320	7×40										217			31
RN4-360x35Z	230			360	8×40										245			35
RN4-400x39Z	254			400	9×40										273			39
RN4-440x43Z	278			440	10×40										301			43
RN4-480x47Z	302			480	11×40										329			47
RN6-100×7Z	81	30 (31)	15	100	1×50	25	13.6 (14.1)	6	M6	5.2	9.5	5.2	2.9	6.5	59.5	5	8.5	7
RN6-150x10Z	130			150	2×50										85			10
RN6-200×13Z	179			200	3×50										110.5			13
RN6-250x17Z	211			250	4×50										144.5			17
RN6-300x20Z	260			300	5×50										170			20
RN6-350x24Z	292			350	6×50										204			24
RN6-400x27Z	341			400	7×50										229.5			27
RN6-450x31Z	373			450	8×50										263.5			31
RN6-500x34Z	422			500	9×50										289			34
RN6-550x38Z	454			550	10×50										323			38
RN6-600x41Z	503			600	11×50										348.5			41

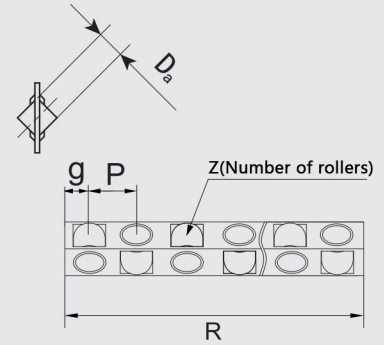
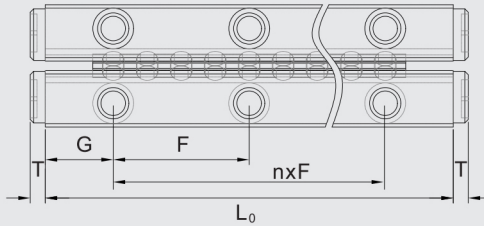
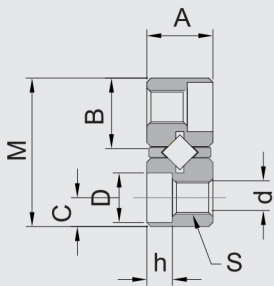
RN9

Model	Maximum stroke mm	Main dimensions															Number of rollers Z	
		Combined size				Assembly dimensions									Cylindrical roller with retainer			
		M	A	L0	nxF	G	B	C	S	d	D	h	T	Da	R	g		P
RN9-200x10Z	160	40 (44)	20 (22)	200	1×100	50	18.1 20.2	8	M8	6.8	10.5	6.2	4	9	120	7.5	12	10
RN9-300x15Z	240			300	2×100										180			15
RN9-400x20Z	320			400	3×100										240			20
RN9-500x25Z	400			500	4×100										300			25
RN9-600x30Z	480			600	5×100										360			30
RN9-700x35Z	560			700	6×100										420			35
RN9-800x40Z	640			800	7×100										480			40

RNW2/RNW3

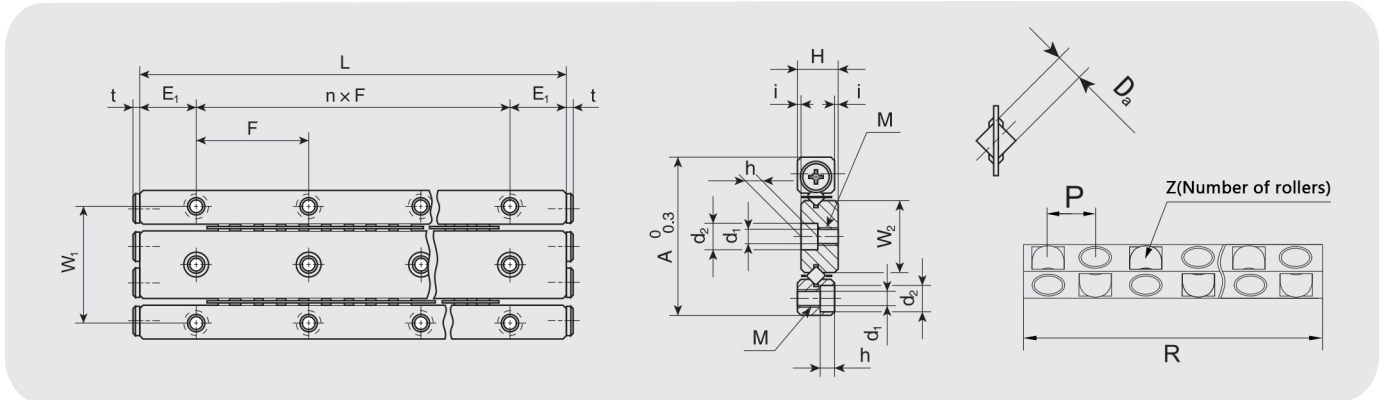

Model	Maximum stroke mm	appearance			Cylindrical roller with retainer	Main dimensions and allowable tolerances													
		A	H	L(nxF)		P	R	Z	Da	W1	W2	E1	E2	M	d1	d2	h	D	Dimensional tolerance
RNW2-30x4Z	12	24	6.5	30(1x15)	0.5	4	24	4	2	19	11	7.5	M3	2.55	4.4	2		0.01	1.4
RNW2-45x6Z	26			45(2x15)			32	6											
RNW2-60x8Z	40			60(3x15)			40	8											
RNW2-75x12Z	38			75(4x15)			56	12											
RNW2-90x14Z	52			90(5x15)			64	14											
RNW2-105x16Z	66			105(6x15)			72	16											
RNW2-120x20Z	64			120(7x15)			88	20											
RNW2-135x22Z	78			135(8x15)			96	22											
RNW2-150x24Z	92			150(9x15)			104	24											
RNW2-165x28Z	90			65(10x15)			120	28											
RNW2-180x30Z	104	80(11x15)	128	30															
RNW3-50x6Z	20	36	8.5	50(1x25)	0.5	5	40	6	3	29	16.6	12.5	M4	3.3	6	3.1		0.012	1.5
RNW3-75x8Z	50			75(2x25)			50	8											
RNW3-100x12Z	60			100(3x25)			70	12											
RNW3-125x16Z	70			125(4x25)			90	16											
RNW3-150x20Z	80			150(5x25)			110	20											
RNW3-175x22Z	110			175(6x25)			120	22											
RNW3-200x26Z	120			200(7x25)			140	26											
RNW3-225x30Z	130			225(8x25)			160	30											
RNW3-250x34Z	140			250(9x25)			180	34											
RNW3-275x36Z	170			275(10x25)			190	36											
RNW3-300x40Z	180	300(11x25)	210	40															

RNW4

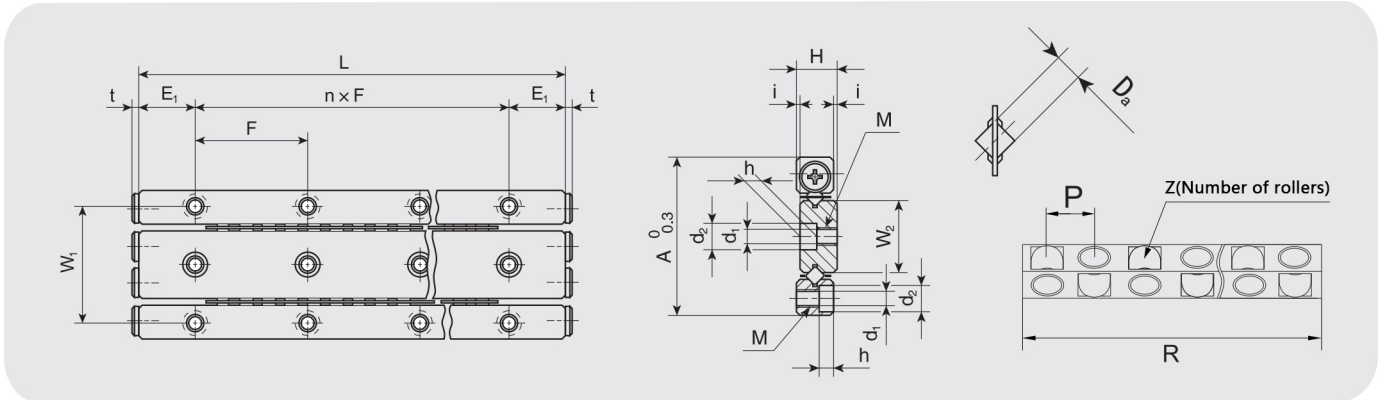

Model	Maximum stroke mm	appearance			Cylindrical roller with retainer	Main dimensions and allowable tolerances												
		A	H	L(nxF)		P	R	Z	Da	W	W2	E1	E2	M	d1	d2	h	D
RNW4-80x6Z	48	44	11.5	80(1x40)	0.5	6.5	56	6	4	35	20	20	M5	4.3	7.5	4.1	0.012	2
RNW4-120x10Z	72			120(2x40)			84	10										
RNW4-160x14Z	96			160(3x40)			112	14										
RNW4-200x18Z	120			200(4x40)			140	18										
RNW4-240x24Z	116			240(5x40)			182	24										
RNW4-280x28Z	140			280(6x40)			210	28										
RNW4-320x32Z	164			320(7x40)			238	32										
RNW4-360x34Z	216			360(8x40)			252	34										
RNW4-400x38Z	240			400(9x40)			280	38										
RNW4-440x42Z	264			440(10x40)			308	42										
RNW4-480x46Z	288			480(11x40)			336	46										

RNWG2/RNWG3

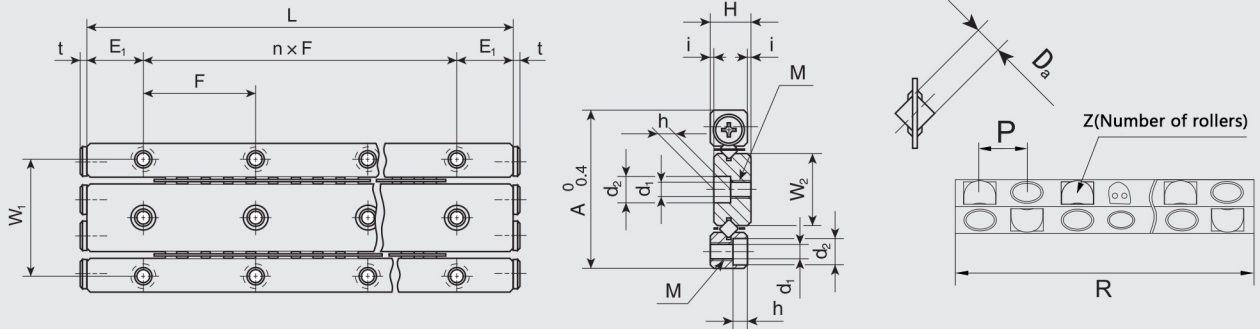

Model	Maximum stroke mm	appearance			Cylindrical roller with retainer			Main dimensions and allowable tolerances													
		A	H	L(nxF)	P	R	Z	Da	W1	W2	E1	E2	M	d1	d2	h	D	Dimensional tolerance	t		
RNWG2-30x4Z	12	24	6.5	30(1x15)	0.5	4	24	4	2	19	11	7.5	M3	2.55	4.4	2		0.01	1.4		
RNWG2-45x6Z	26			45(2x15)			32	6													
RNWG2-60x8Z	40			60(3x15)			40	8													
RNWG2-75x12Z	38			75(4x15)			56	12													
RNWG2-90x14Z	52			90(5x15)			64	14													
PNWG2-105x16Z	66			105(6x15)			72	16													
RNWG2-120x20Z	64			120(7x15)			88	20													
RNWG2-135x22Z	78			135(8x15)			96	22													
RNWG2-150x24Z	92			150(9x15)			104	24													
RNWG2-165x28Z	90			165(10x15)			120	28													
RNWG2-180x30Z	104	80(11x15)	128	30																	
RNWG3-50x6Z	20	36	8.5	50(1x25)	0.5	5	40	6	3	29	16.6	12.5	M4	3.3	6	3.1		0.012	1.5		
RNWG3-75x8Z	50			75(2x25)			50	8													
RNWG3-100x12Z	60			100(3x25)			70	12													
RNWG3-125x16Z	70			125(4x25)			90	16													
RNWG3-150x20Z	80			150(5x25)			110	20													
RNWG3-175x22Z	110			175(6x25)			120	22													
RNWG3-200x26Z	120			200(7x25)			140	26													
RNWG3-225x30Z	130			225(8x25)			160	30													
RNWG3-250x34Z	140			250(9x25)			180	34													
RNWG3-275x36Z	170			275(10x25)			190	36													
RNWG3-300x40Z	180	300(11x25)	210	40																	

RNWG4

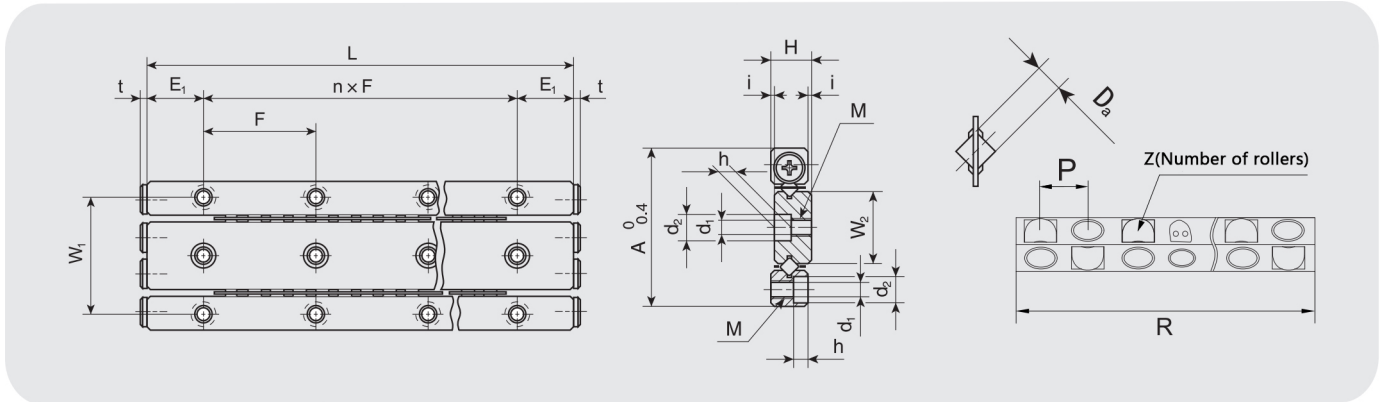

Model	Maximum stroke mm	appearance			Cylindrical roller with retainer			Main dimensions and allowable tolerances												
		A	H	L(nx F)	P	R	Z	Da	W1	W2	E1	E2	M	d1	d2	h	D	Dimensional tolerance	t	
RNWG4-80x6Z	48	44	11.5	80(1x40)	0.5	6.5	56	6	4	35	20	20	M5	4.3	7.5	4.1	0.012	2		
RNWG4-120x10Z	72			120(2x40)			84	10												
RNWG4-160x14Z	96			160(3x40)			112	14												
RNWG4-200x18Z	120			200(4x40)			140	18												
RNWG4-240x24Z	116			240(5x40)			182	24												
RNWG4-280x28Z	140			280(6x40)			210	28												
RNWG4-320x32Z	164			320(7x40)			238	32												
RNWG4-360x34Z	216			360(8x40)			252	34												
RNWG4-400x38Z	240			400(9x40)			280	38												
RNWG4-440x42Z	264			440(10x40)			308	42												
RNWG4-480x46Z	288			480(11x40)			336	46												

NVW2/NVW3

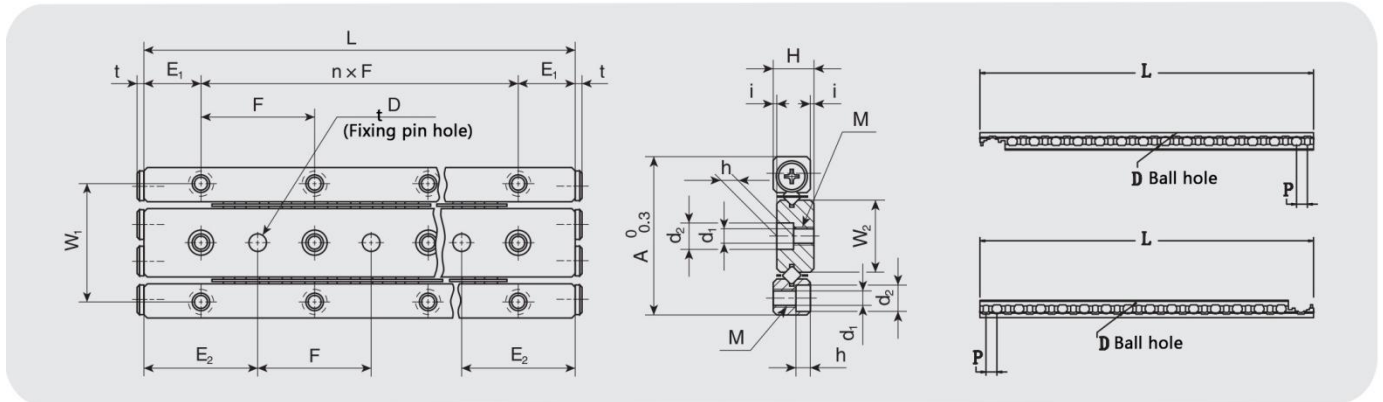

Model	Maximum stroke mm	appearance			Cylindrical roller with retainer			Main dimensions and allowable tolerances													
		A	H	L(nxF)	P	R	Z	Da	W	W2	E1	E2	M	d1	d2	h	D	Dimensional tolerance	t		
NVW2-30x4Z	12	24	6.5	30(1x15)	0.5	2.5		2	19	11	7.5	15	M3	2.55	4.4	2	3	0.01	1.4		
NVW2-45x6Z	26			45(2x15)																24	4
NVW2-60x8Z	40			60(3x15)																32	6
NVW2-75x12Z	38			75(4x15)																40	8
NVW2-90x14Z	52			90(5x15)																56	12
NVW2-105x16Z	66			105(6x15)																64	14
NVW2-120x20Z	64			120(7x15)																72	16
NVW2-135x22Z	78			135(8x15)																88	20
NVW2-150x24Z	92			150(9x15)																96	22
NVW2-165x28Z	90			65(10x15)																104	24
NVW2-180x30Z	104			80(11x15)																120	28
NVW3-50x6Z	20	36	8.5	50(1x25)	0.5	3.5		3	29	16.6	12.5	25	M4	3.3	6	3.1	4	0.012	1.5		
NVW3-75x8Z	50			75(2x25)																40	6
NVW3-100x12Z	60			100(3x25)																50	8
NVW3-125x16Z	70			125(4x25)																70	12
NVW3-150x20Z	80			150(5x25)																90	16
NVW3-175x22Z	110			175(6x25)																110	20
NVW3-200x26Z	120			200(7x25)																120	22
NVW3-225x30Z	130			225(8x25)																140	26
NVW3-250x34Z	140			250(9x25)																160	30
NVW3-275x36Z	170			275(10x25)																180	34
NVW3-300x40Z	180			300(11x25)																190	36
																				210	40

NVW4

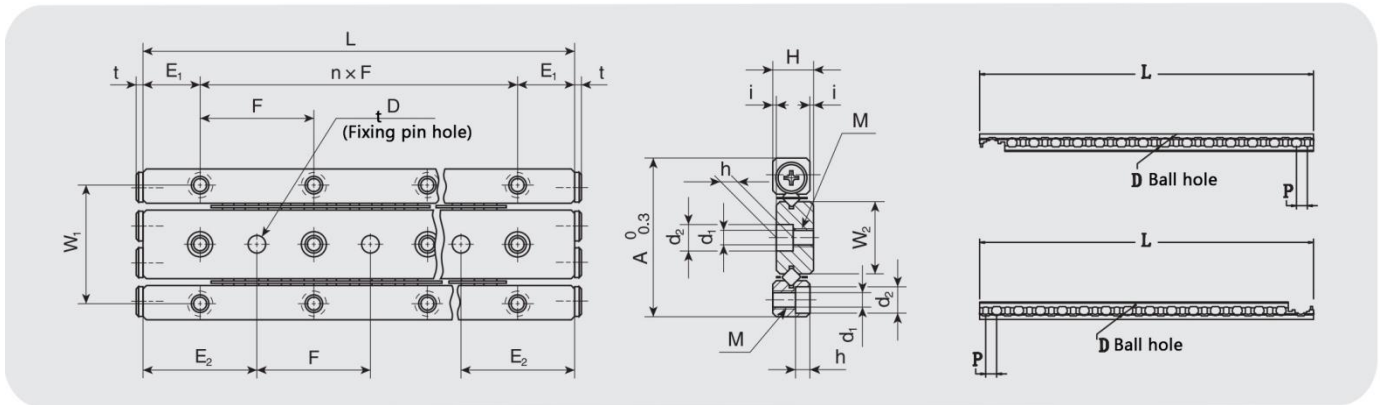

Model	Maximum stroke mm	appearance			Cylindrical roller with retainer			Main dimensions and allowable tolerances												
		A	H	L(nxF)	P	R	Z	Da	W1	W2	E1	E2	M	d1	d2	h	D	Dimensional tolerance	t	
NVW4-80x6Z	48	44	11.5	80(1x40)	0.5	4.5	56	6	4	35	20	20	40	M5	4.3	7.5	4.1	5	0.012	2
NVW4-120x10Z	72			120(2x40)			84	10												
NVW4-160x14Z	96			160(3x40)			112	14												
NVW4-200x18Z	120			200(4x40)			140	18												
NVW4-240x24Z	116			240(5x40)			182	24												
NVW4-280x28Z	140			280(6x40)			210	28												
NVW4-320x32Z	164			320(7x40)			238	32												
NVW4-360x34Z	216			360(8x40)			252	34												
NVW4-400x38Z	240			400(9x40)			280	38												
NVW4-440x42Z	264			440(10x40)			308	42												
NVW4-480x46Z	288	480(11x40)	336	46																

SV1/SV2

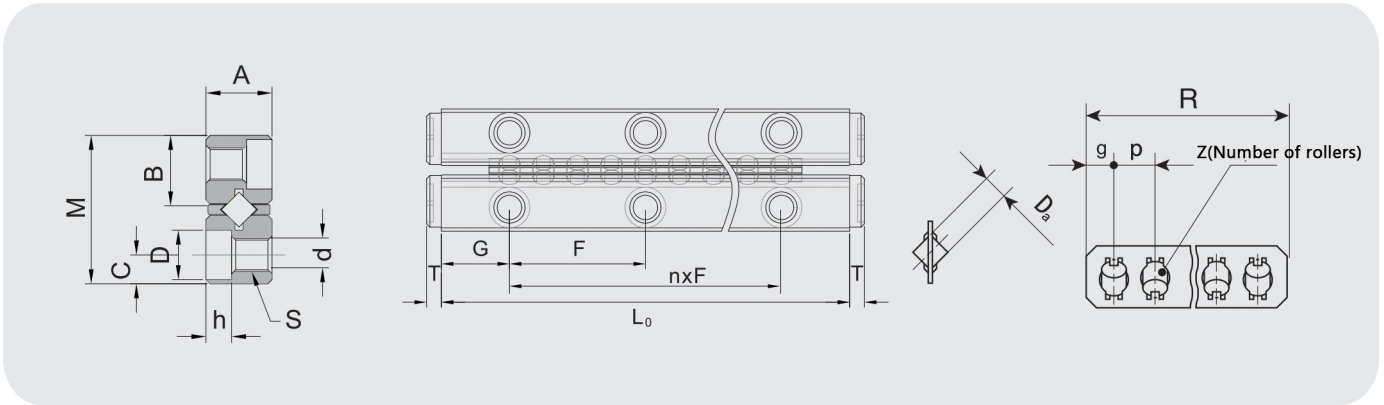

model	Maximum stroke mm	Main dimensions															Number of rollers Z	
		Combined size				Assembly dimensions								Cylindrical roller with retainer				
		M	A	L0	nxF	G	B	C	S	d	D	h	T	Da	R	g		P
SV1-20x5Z	15	8.5	4	20	1×10	5	3.9	1.8	M2	1.65	3	1.4	1.5	12.5	2	2.5	5	
SV1-30x7Z	25			30	2×10									17.5			7	
SV1-40x10Z	30			40	3×10									25			10	
SV1-50x13Z	35			50	4×10									32.5			13	
SV1-60x16Z	40			60	5×10									40			16	
SV1-70x19Z	45			70	6×10									47.5			19	
SV1-80x21Z	55			80	7×10									52.5			21	
SV2-30x5Z	20	12	6	30	1×15	7.5	5.5	2.5	M3	2.55	4.5	2.2	1.4	2	20	2.5	4	5
SV2-45x8Z	26			45	2×15										32			8
SV2-60x11Z	32			60	3×15										44			11
SV2-75x13Z	46			75	4×15										52			13
SV2-90x16Z	52			90	5×15										64			16
SV2-105x18Z	66			105	6×15										72			18
SV2-120x21Z	72			120	7×15										84			21
SV2-135x23Z	86			135	8×15										92			23
SV2-150x26Z	92			150	9×15										104			26
SV2-165x29Z	98			165	10×15										116			29
SV2-180x32Z	104			180	11×15										128			32

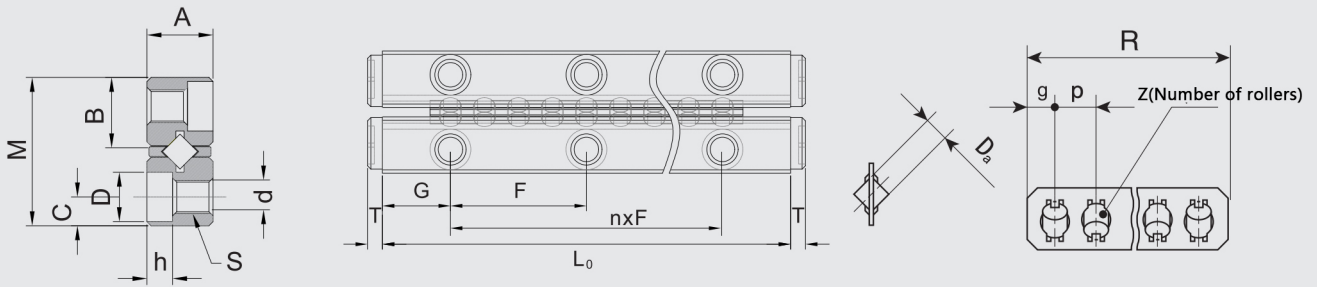
SV3/SV4

Model	Maximum stroke mm	Main dimensions																Number of rollers Z
		Maximum stroke				Cylindrical roller with retainer								Cylindrical roller with retainer				
		M	A	L0	nxF	G	B	C	S	d	D	h	T	Da	R	g	P	
SV3-50x7Z	30	18	8	50	1×25	12.5	8.3	3.5	M4	3.3	6	3.1	1.5	3	35	3	5	7
SV3-75x10Z	50			75	2×25										50			10
SV3-100x14Z	60			100	3×25										70			14
SV3-125x17Z	80			125	4×25										85			17
SV3-150x21Z	90			150	5×25										105			21
SV3-175x24Z	110			175	6×25										120			24
SV3-200x28Z	120			200	7×25										140			28
SV3-225x31Z	140			225	8×25										155			31
SV3-250x35Z	150			250	9×25										175			35
SV3-275x38Z	170			275	10×25										190			38
SV3-300x42Z	180			300	11×25										210			42
SV4-80x7Z	62	22	11	80	1×40	20	10	4.5	M5	4.3	8	4.2	2	4	49	4.5		7
SV4-120x11Z	86			120	2×40										77			11
SV4-160x15Z	110			160	3×40										105			15
SV4-200x19Z	134			200	4×40										133			19
SV4-240x23Z	158			240	5×40										161			23
SV4-280x27Z	182			280	6×40										189			27
SV4-320x31Z	206			320	7×40										217			31
SV4-360x35Z	230			360	8×40										245			35
SV4-400x39Z	254			400	9×40										273			39
SV4-440x43Z	278			440	10×40										301			43
SV4-480x47Z	302			480	11×40										329			47

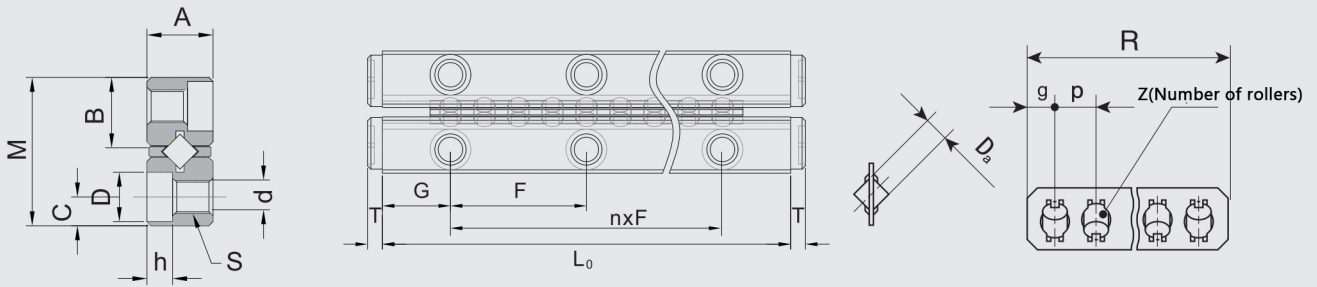
SV6/SV9

Model	Maximum stroke mm	Main dimensions															Number of rollers Z	
		Combined size				Assembly dimensions								Cylindrical roller with retainer				
		M	A	L0	nxF	G	B	C	S	d	D	h	T	Da	R	g		P
SV6-100×7Z	60	30 (31)	15	100	1×50	25	13.6 (14.1)	6	M6	5.2	9.5	5.2	2.9	6	70	6	10	7
SV6-150×10Z	100			150	2×50										100			10
SV6-200×13Z	140			200	3×50										130			13
SV6-250×17Z	160			250	4×50										170			17
SV6-300×20Z	200			300	5×50										200			20
SV6-350×24Z	220			350	6×50										240			24
SV6-400×27Z	260			400	7×50										270			27
SV6-450×31Z	280			450	8×50										310			31
SV6-500×34Z	320			500	9×50										340			34
SV6-550×38Z	340			550	10×50										380			38
SV6-600×41Z	380			600	11×50										410			41
SV9-200×10Z	120	40 (44)	20 (22)	200	1×100	50	18.1 (20.2)	8	M8	6.8	10.5	6.2	4	9	140	7.5	14	10
SV9-300×15Z	180			300	2×100										210			15
SV9-400×20Z	240			400	3×100										280			20
SV9-500×25Z	300			500	4×100										350			25
SV9-600×30Z	360			600	5×100										420			30
SV9-700×35Z	420			700	6×100										490			35
SV9-800×40Z	480			800	7×100										560			40

CRWM1/CRWM2

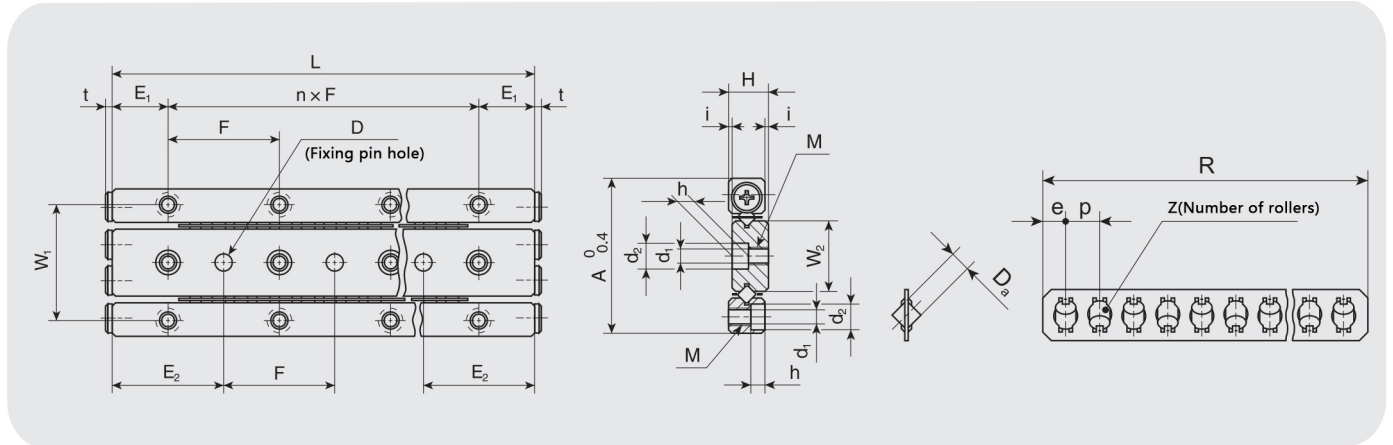

Model	Maximum stroke mm	appearance			Cylindrical roller with retainer				Main dimensions and allowable tolerances												
		A	H	L(nxF)	P	g	R	Z	Da	W	W2	E1	E2	M	d1	d2	h	D	Dimensional tolerance	t	
CRWM1-20x5Z	15	17	4.5	20(1x10)	0.5	2.5	2.25	12.5	5	1.5	3.4	7.8	5	2	M2	1.65	3	1.4	2	0.01	1.1
CRWM1-30x8Z	20			30(2x10)				20	8												
CRWM1-40x10Z	30			40(3x10)				25	10												
CRWM1-50x12Z	40			50(4x10)				30	12												
CRWM1-60x14Z	50			60(5x10)				35	14												
CRWM1-70x17Z	55			70(6x10)				42.5	17												
CRWM1-80x20Z	60			80(7x10)				50	20												
CRWM2-30x7Z	4	24	6.5	30(1x15)	0.5	4	2.8	28	7	2	19	11	7.5	15	M3	2.55	4.4	2	3	0.01	1.4
CRWM2-45x10Z	10			45(2x15)				40	10												
CRWM2-60x13Z	16			60(3x15)				52	13												
CRWM2-75x16Z	22			75(4x15)				64	16												
CRWM2-90x19Z	28			90(5x15)				76	19												
CRWM2-105x22Z	34			105(6x15)				88	22												
CRWM2-120x25Z	40			120(7x15)				100	25												
CRWM2-135x28Z	46			135(8x15)				112	28												
CRWM2-150x31Z	52			150(9x15)				124	31												
CRWM2-165x34Z	58			165(10x15)				136	34												
CRWM2-180x37Z	64			180(11x15)				148	37												

CRWM3/CRWM4

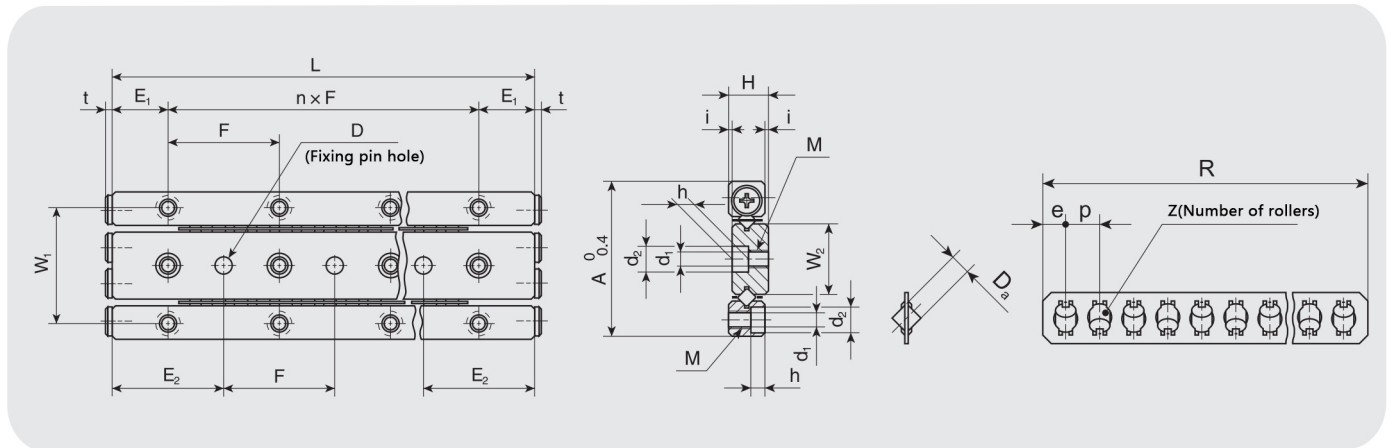

Model	Maximum stroke mm	appearance			Cylindrical roller with retainer				Main dimensions and allowable tolerances												
		A	H	L(nxF)	P	g	R	Z	Da	W1	W2	E1	E2	M	d1	d2	h	D	Dimensional tolerance	t	
CRWM3-50x8Z	20	36	8.5	50(1x25)	0.5	5	3.5	40	8	3	29	16.6	12.5	25	M4	3.3	6	3.1	4	0.012	1.5
CRWM3-75x12Z	30			75(2x25)				60	12												
CRWM3-100x16Z	40			100(3x25)				80	16												
CRWM3-125x20Z	50			125(4x25)				100	20												
CRWM3-150x24Z	60			150(5x25)				120	24												
CRWM3-175x28Z	70			175(6x25)				140	28												
CRWM3-200x32Z	80			200(7x25)				160	32												
CRWM3-225x36Z	90			225(8x25)				180	36												
CRWM3-250x40Z	100			250(9x25)				200	40												
CRWM3-275x44Z	110			275(10x25)				220	44												
CRWM3-300x48Z	120			300(11x25)				240	48												
CRWM4-80x10Z	20	44	11.5	80(1x40)	0.5	5	5	70	10	4	35	20	20	40	M5	4.3	7.5	4.1	5	0.012	2
CRWM4-120x14Z	44			120(2x40)				98	14												
CRWM4-160x19Z	54			160(3x40)				133	19												
CRWM4-200x23Z	78			200(4x40)				161	23												
CRWM4-240x28Z	88			240(5x40)				196	28												
CRWM4-280x32Z	112			280(6x40)				224	32												
CRWM4-320x37Z	122			320(7x40)				259	37												
CRWM4-360x42Z	132			360(8x40)				294	42												
CRWM4-400x46Z	156			400(9x40)				322	46												
CRWM4-440x51Z	166			440(10x40)				357	51												
CRWM4-480x55Z	190			480(11x40)				385	55												

CRWMG2/CRWMG3

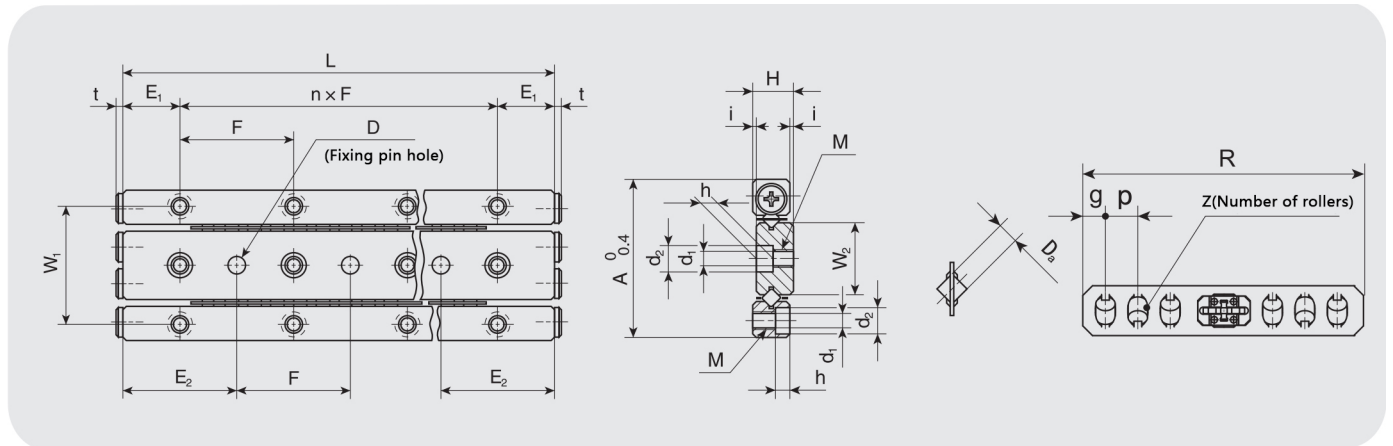

Model	Maximum stroke mm	appearance			Cylindrical roller with retainer				Main dimensions and allowable tolerances												
		A	H	L(nx F)	P	g	R	Z	Da	W1	W2	E1	E2	M	d1	d2	h	D	Dimensional tolerance	t	
CRWMG2-30x4Z	12	24	6.5	30(1x15)	0.5	4	2.8	24	4	2	19	11	7.5	15	M3	2.55	4.4	2	3	0.01	1.4
CRWMG2-45x6Z	26			45(2x15)				32	6												
CRWMG2-60x8Z	40			60(3x15)				40	8												
CRWMG2-75x12Z	38			75(4x15)				56	12												
CRWMG2-90x14Z	52			90(5x15)				64	14												
CRWMG2-105x16Z	66			105(6x15)				72	16												
CRWMG2-120x20Z	64			120(7x15)				88	20												
CRWMG2-135x22Z	78			135(8x15)				96	22												
CRWMG2-150x24Z	92			150(9x15)				104	24												
CRWMG2-165x28Z	90			65(10x15)				120	28												
CRWMG2-180x30Z	104			80(11x15)				128	30												
CRWMG3-50x6Z	20			36				8.5	50(1x25)												
CRWMG3-75x8Z	50	75(2x25)	50		8																
CRWMG3-100x12Z	60	100(3x25)	70		12																
CRWMG3-125x16Z	70	125(4x25)	90		16																
CRWMG3-150x20Z	80	150(5x25)	110		20																
CRWMG3-175x22Z	110	175(6x25)	120		22																
CRWMG3-200x26Z	120	200(7x25)	140		26																
CRWMG3-225x30Z	130	225(8x25)	160		30																
CRWMG3-250x34Z	140	250(9x25)	180		34																
CRWMG3-275x36Z	170	275(10x25)	190		36																
CRWMG3-300x40Z	180	300(11x25)	210		40																

CRWMG4

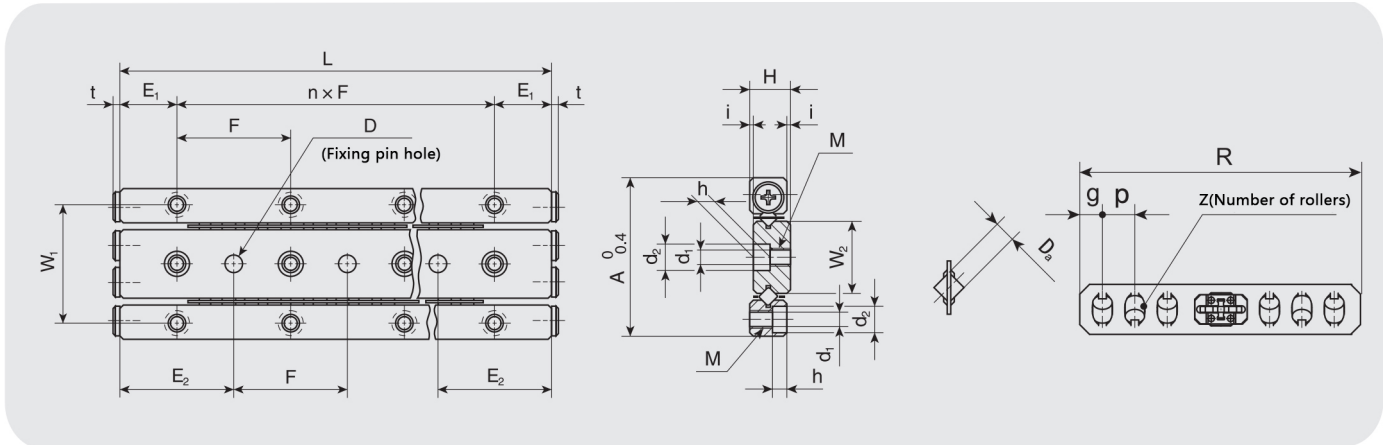

Model	Maximum stroke mm	appearance			Cylindrical roller with retainer				Main dimensions and allowable tolerances												
		A	H	L(nxF)	P	g	R	Z	Da	W1	W2	E1	E2	M	d1	d2	h	D	Dimensional tolerance	t	
CRWMG4-80x6Z	48	44	11.5	80(1x40)	0.5	7	5	56	6	4	35	20	20	40	M5	4.3	7.5	4.1	5	0.012	2
CRWMG4-120x10Z	72			120(2x40)				84	10												
CRWMG4-160x14Z	96			160(3x40)				112	14												
CRWMG4-200x18Z	120			200(4x40)				140	18												
CRWMG4-240x24Z	116			240(5x40)				182	24												
CRWMG4-280x28Z	140			280(6x40)				210	28												
CRWMG4-320x32Z	164			320(7x40)				238	32												
CRWMG4-360x34Z	216			360(8x40)				252	34												
CRWMG4-400x38Z	240			400(9x40)				280	38												
CRWMG4-440x42Z	264			440(10x40)				308	42												
CRWMG4-480x46Z	288			480(11x40)				336	46												

VRG2/VRG3

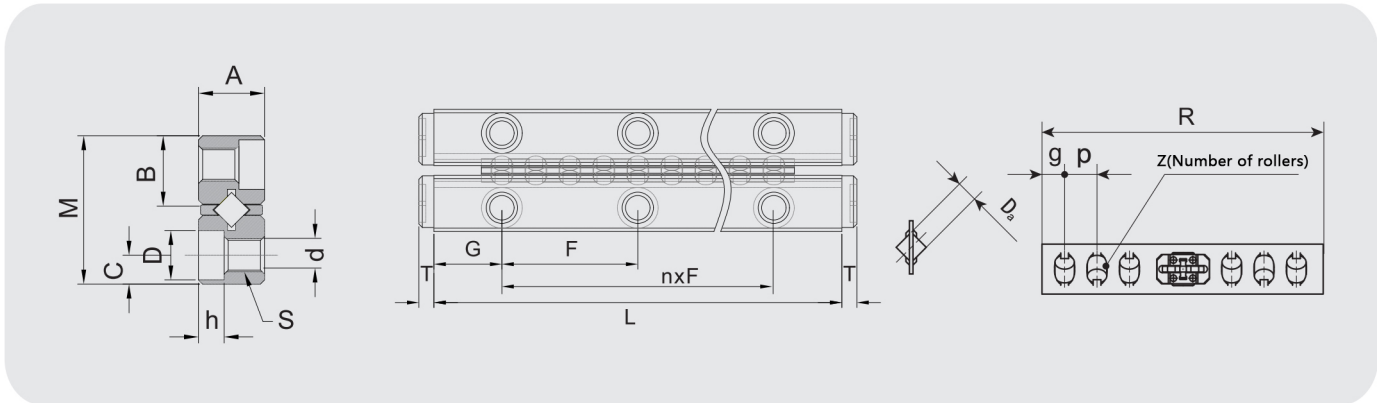
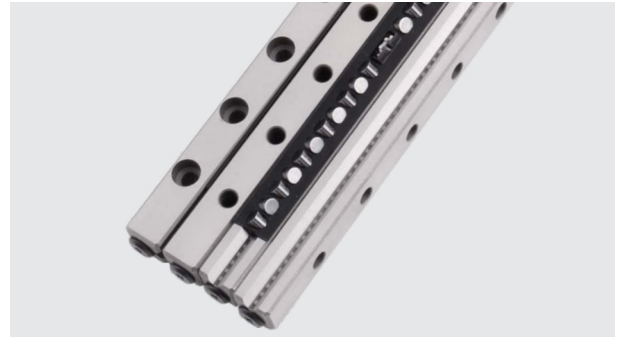

Model	Maximum stroke mm	Main dimensions																Number of rollers Z
		Combined size				Assembly dimensions									Cylindrical roller with retainer			
		M	A	L	nxF	G	B	C	S	d	D	h	T	Da	R	g	P	
VRG2-30x6Z	22	12	6	30	1×15	7.5	5.5	2.5	M3	2.55	4.4	2	1.4	2	19	2	2.5	6
VRG2-45x12Z	30			45	2×15										30			12
VRG2-60x16Z	40			60	3×15										40			16
VRG2-75x22Z	40			75	4×15										55			22
VRG2-90x24Z	60			90	5×15										60			24
VRG2-105x30Z	60			105	6×15										75			30
VRG2-120x34Z	70			120	7×15										85			34
VRG2-135x40Z	70			135	8×15										100			40
VRG2-150x44Z	80			150	9×15										110			44
VRG3-50x8Z	40	18	8	50	1×25	12.5	8.6	3.5	M4	3.3	6	3.1	1.5	3	30	2.5	3.8	8
VRG3-75x12Z	60			75	2×25										45			12
VRG3-100x18Z	64			100	3×25										68			18
VRG3-125x22Z	84			125	4×25										83			22
VRG3-150×28Z	90			150	5×25										105			28
VRG3-175x32Z	110			175	6×25										120			32
VRG3-200x38Z	112			200	7×25										144			38
VRG3-225x44Z	116			225	8×25										167			44
VRG3-250x48Z	136			250	9×25										182			48

VRG4

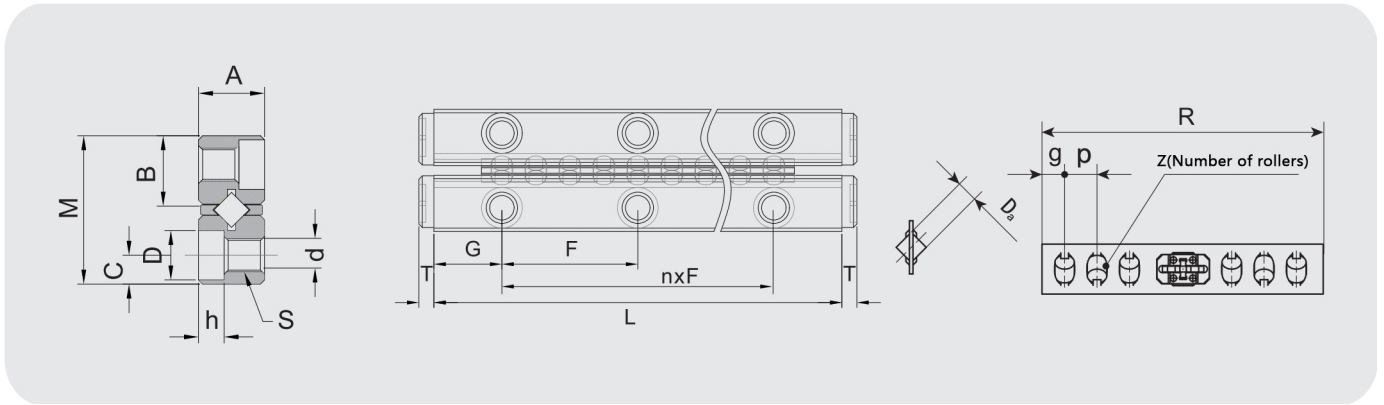
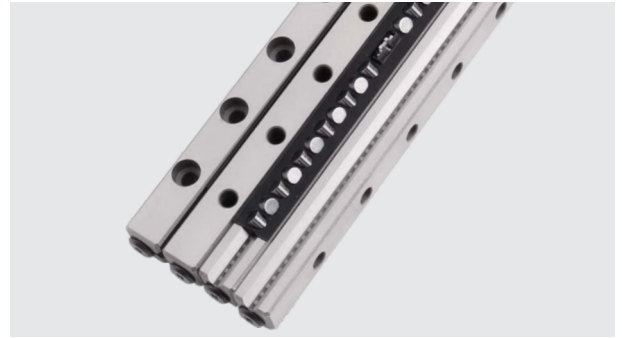

Model	Maximum stroke mm	Main dimensions																Number of rollers Z
		Combined size				Assembly dimensions									Cylindrical roller with retainer			
		M	A	L	nxF	G	B	C	S	d	D	h	T	Da	R	g	P	
VRG4-80x10Z	64	22	11	80	1×40	20	10.6	4.5	M5	4.3	7.5	4.1	2	4	48	3	4.8	10
VRG4-120×16Z	86			120	2×40										77			16
VRG4-160x22Z	110			160	3×40										105			22
VRG4-200×28Z	132			200	4×40										134			28
VRG4-240x36Z	136			240	5×40										172			36
VRG4-280x42Z	158			280	6×40										201			42
VRG4-320x48Z	180			320	7×40										230			48

VRM1/VRM2

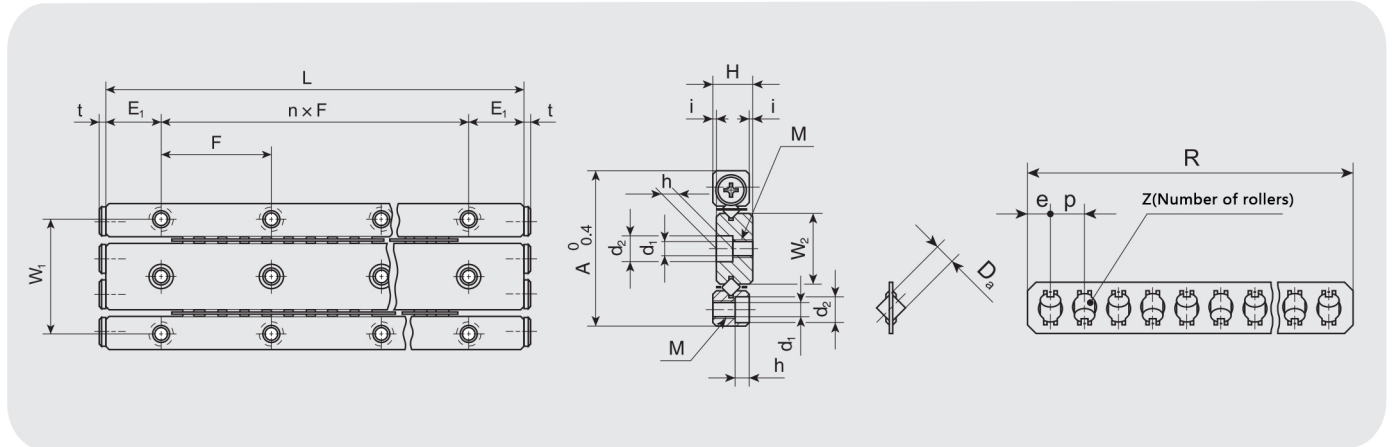

Model	Maximum stroke mm	appearance			Cylindrical roller with retainer					Main dimensions and allowable tolerances										
		A	H	L(nx F)	P	g	R	Z	Da	W	W2	E1	E2	M	d1	d2	h	D	Dimensional tolerance	t
VRM1-20x5Z	15	12	4.5	20(1x10)	0.5	2.5	2.25	12.5	5	1.5	3.4	7.8	5	M2	1.65	3	1.4	0.01	1.1	
VRM1-30x8Z	20			30(2x10)				20	8											
VRM1-40x10Z	30			40(3x10)				25	10											
VRM1-50x12Z	40			50(4x10)				30	12											
VRM1-60x14Z	50			60(5x10)				35	14											
VRM1-70x17Z	55			70(6x10)				42.5	17											
VRM1-80x20Z	60			80(7x10)				50	20											
VRM2-30x7Z	4	24	6.5	30(1x15)	0.5	4	2.8	28	7	2	19	11	7.5	M3	2.55	4.4	2	0.01	1.4	
VRM2-45x10Z	10			45(2x15)				40	10											
VRM2-60x13Z	16			60(3x15)				52	13											
VRM2-75x16Z	22			75(4x15)				64	16											
VRM2-90x19Z	28			90(5x15)				76	19											
VRM2-105x22Z	34			105(6x15)				88	22											
VRM2-120x25Z	40			120(7x15)				100	25											
VRM2-135x28Z	46			135(8x15)				112	28											
VRM2-150x31Z	52			150(9x15)				124	31											
VRM2-165x34Z	58			165(10x15)				136	34											
VRM2-180x37Z	64			180(11x15)				148	37											

VRM3/VRM4

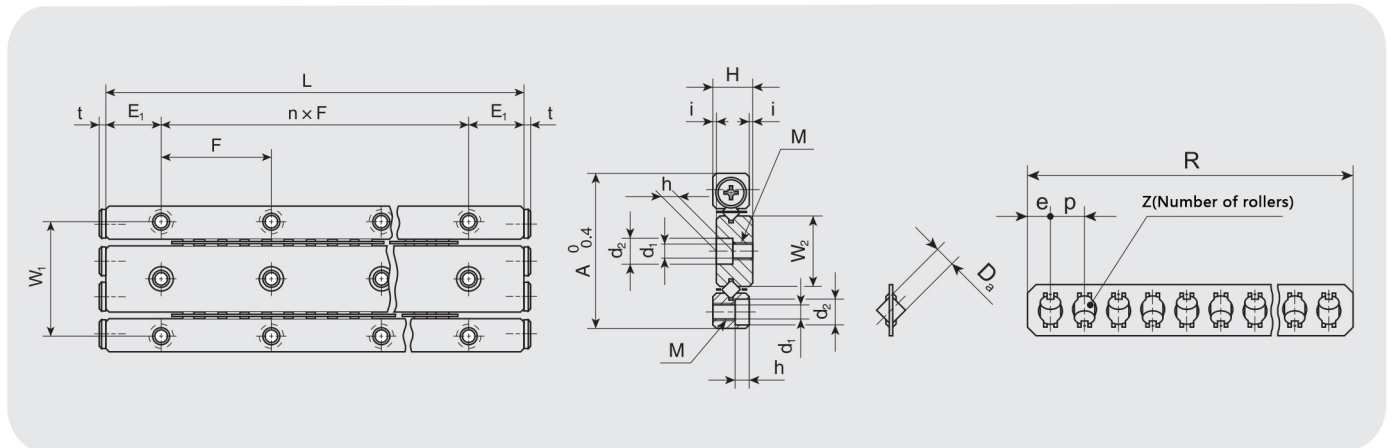

Model	Maximum stroke mm	appearance			Cylindrical roller with retainer				Main dimensions and allowable tolerances										
		A	H	L(nxF)	P	g	R	Z	Da	W1	W2	E1	E2	M	d1	d2	h	D	Dimensional tolerance
VRM3-50x8Z	20	36	8.5	50(1x25)	0.5	5	3.5	40	8	3	29	16.6	12.5	M4	3.3	6	3.1	0.012	1.5
VRM3-75x12Z	30			75(2x25)				60	12										
VRM3-100x16Z	40			100(3x25)				80	16										
VRM3-125x20Z	50			125(4x25)				100	20										
VRM3-150x24Z	60			150(5x25)				120	24										
VRM3-175x28Z	70			175(6x25)				140	28										
VRM3-200x32Z	80			200(7x25)				160	32										
VRM3-225x36Z	90			225(8x25)				180	36										
VRM3-250x40Z	100			250(9x25)				200	40										
VRM3-275x44Z	110			275(10x25)				220	44										
VRM3-300x48Z	120			300(11x25)				240	48										
VRM4-80x10Z	20	44	11.5	80(1x40)	0.5	5	70	10	4	35	20	20	M5	4.3	7.5	4.1	0.012	2	
VRM4-120x14Z	44			120(2x40)			98	14											
VRM4-160x19Z	54			160(3x40)			133	19											
VRM4-200x23Z	78			200(4x40)			161	23											
VRM4-240x28Z	88			240(5x40)			196	28											
VRM4-280x32Z	112			280(6x40)			224	32											
VRM4-320x37Z	122			320(7x40)			259	37											
VRM4-360x42Z	132			360(8x40)			294	42											
VRM4-400x46Z	156			400(9x40)			322	46											
VRM4-440x51Z	166			440(10x40)			357	51											
VRM4-480x55Z	190			480(11x40)			385	55											

VRMG2/VRMG3

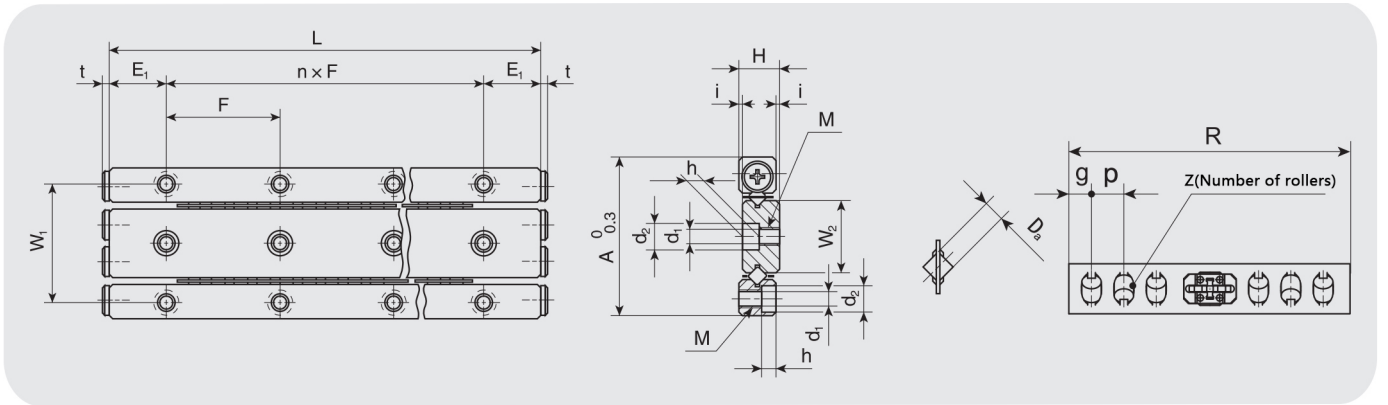
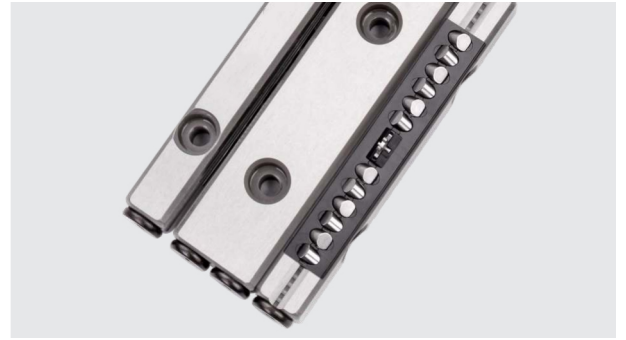

Model	Maximum stroke mm	appearance			Cylindrical roller with retainer				Main dimensions and allowable tolerances											
		A	H	L(nxF)	P	g	R	Z	Da	W1	W2	E1	E2	M	d1	d2	h	D	Dimensional tolerance	t
VRMG2-30x10Z	20	24	6.5	30(1x15)	0.5	2.5	2	28	10	2	19	11	7.5	M3	2.55	4.4	2		0.01	1.4
VRMG2-45x14Z	26			45(2x15)				40	14											
VRMG2-60x18Z	32			60(3x15)				52	18											
VRMG2-75x22Z	46			75(4x15)				64	22											
VRMG2-90x28Z	52			90(5x15)				76	28											
VRMG2-105x32Z	66			105(6x15)				88	32											
VRMG2-120x38Z	72			120(7x15)				100	38											
VRMG2-135x42Z	86			135(8x15)				112	42											
VRMG2-150x46Z	92			150(9x15)				124	46											
VRMG2-165x52Z	98			65(10x15)				136	52											
VRMG2-180x56Z	104			80(11x15)				148	56											
VRMG3-50x8Z	20	36	8.5	50(1x25)	0.5	3.8	2.5	40	8	3	29	16.6	12.5	M4	3.3	6	3.1		0.012	1.5
VRMG3-75x12Z	30			75(2x25)				60	12											
VRMG3-100x18Z	40			100(3x25)				80	18											
VRMG3-125x24Z	50			125(4x25)				100	24											
VRMG3-150x28Z	60			150(5x25)				120	28											
VRMG3-175x34Z	70			175(6x25)				140	34											
VRMG3-200x40Z	80			200(7x25)				160	40											
VRMG3-225x44Z	90			225(8x25)				180	44											
VRMG3-250x50Z	100			250(9x25)				200	50											
VRMG3-275x54Z	110			275(10x25)				220	54											
VRMG3-300x60Z	120			300(11x25)				240	60											

VRMG4

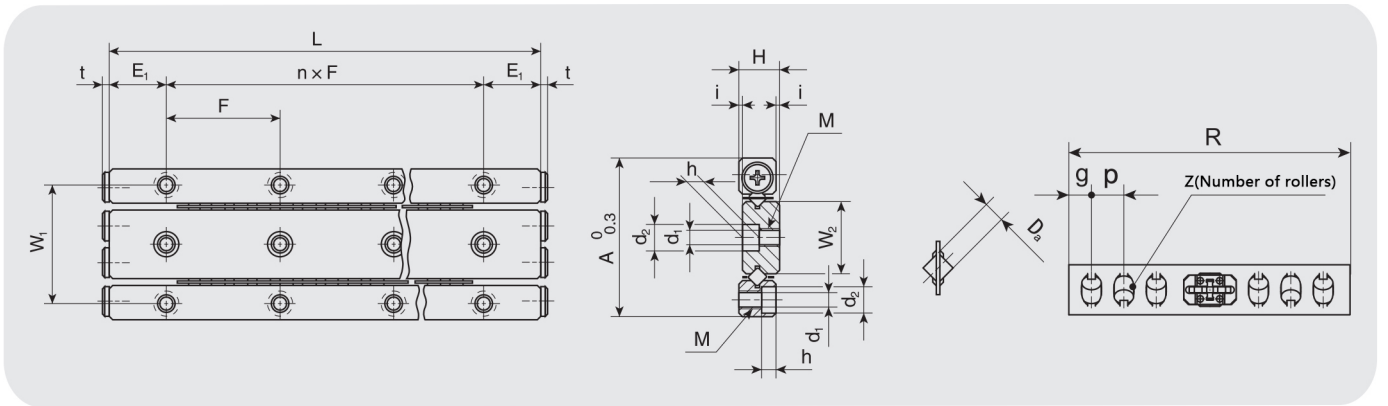

Model	Maximum stroke mm	appearance			Cylindrical roller with retainer				Main dimensions and allowable tolerances												
		A	H	L(nxF)	P	g	R	Z	Da	W1	W2	E1	E2	M	d1	d2	h	D	Dimensional tolerance	t	
VRMG4-80x12Z	20	44	11.5	80(1x40)	0.5	4.8	3	70	12	4	35	20	20	M5	4.3	7.5	4.1	0.012	2		
VRMG4-120x18Z	44			120(2x40)				98	18												
VRMG4-160x24Z	54			160(3x40)				133	24												
VRMG4-200x30Z	78			200(4x40)				161	30												
VRMG4-240x38Z	88			240(5x40)				196	38												
VRMG4-280x44Z	112			280(6x40)				224	44												
VRMG4-320x50Z	122			320(7x40)				259	50												
VRMG4-360x58Z	132			360(8x40)				294	58												
VRMG4-400x64Z	156			400(9x40)				322	64												
VRMG4-440x72Z	166			440(10x40)				357	72												
VRMG4-480x78Z	190			480(11x40)				385	78												

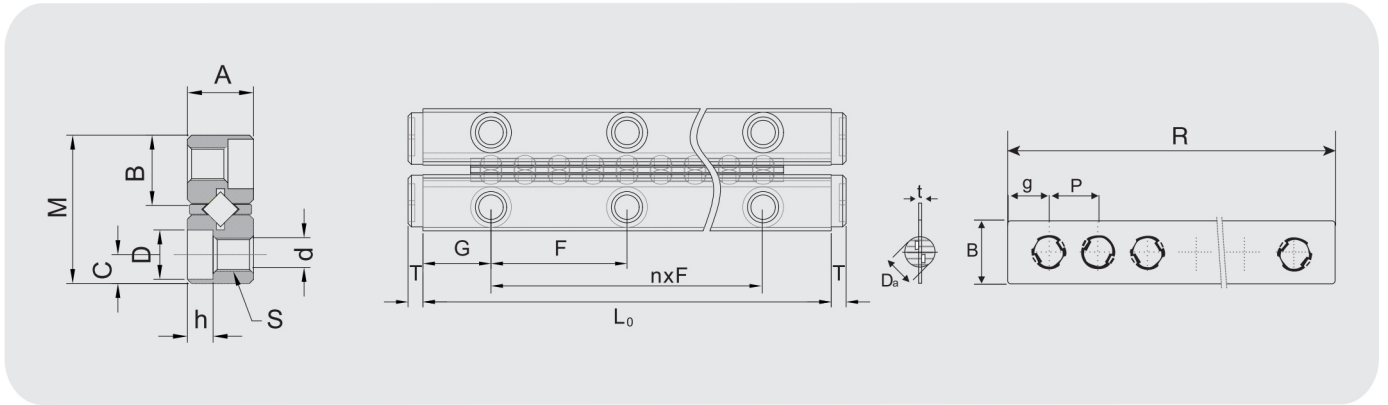
VB2/VB3

Model	Maximum stroke mm	Main dimensions																Number of rollers Z
		Combined size				Assembly dimensions								Cylindrical roller with retainer				
		M	A	LO	nxF	G	B	C	S	d	D	h	T	Da	R	9	P	
VB2-30x5Z	20	12	6	30	1×15	7.5	5.5	2.5	M3	2.55	4.5	2.2	1.4	2	20	2.5	4	5
VB2-45x8Z	26			45	2×15										32			8
VB2-60x11Z	32			60	3×15										44			11
VB2-75x13Z	46			75	4×15										52			13
VB2-90x16Z	52			90	5×15										64			16
VB2-105x18Z	66			105	6×15										72			18
VB2-120x21Z	72			120	7×15										84			21
VB2-135x23Z	86			135	8×15										92			23
VB2-150x26Z	92			150	9×15										104			26
VB2-165x29Z	98			165	10×15										116			29
VB2-180x32Z	104			180	11×15										128			32
VB3-50x7Z	16	18	8	50	1×25	12.5	8.3	3.5	M4	3.3	6	3.1	1.5	3	42	3.8	6	7
VB3-75x10Z	30			75	2×25										60			10
VB3-100x14Z	32			100	3×25										84			14
VB3-125x17Z	46			125	4×25										102			17
VB3-150x21Z	48			150	5×25										126			21
VB3-175x24Z	62			175	6×25										144			24
VB3-200x28Z	64			200	7×25										168			28
VB3-225x31Z	78			225	8×25										186			31
VB3-250x35Z	80			250	9×25										210			35
VB3-275x38Z	94			275	10×25										228			38
VB3-300x42Z	96			300	11×25										252			42

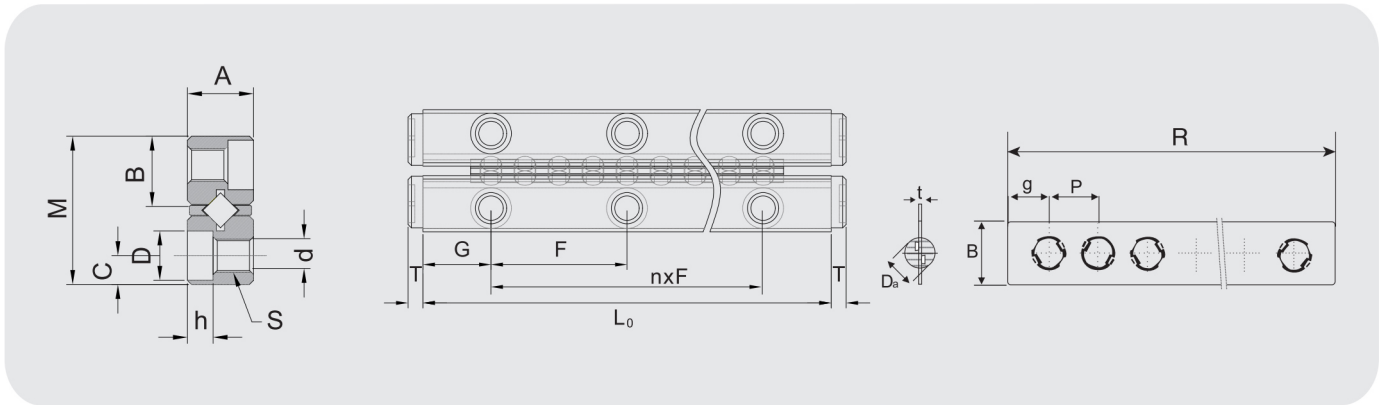
VB4/VB6

Model	Maximum stroke mm	Main dimensions																Number of rollers Z	
		Combined size				Assembly dimensions								Cylindrical roller with retainer					
		M	A	L0	nxF	G	B	C	S	d	D	h	T	Da	R	g	P		
VB4-80x7Z	62	22	11	80	1×40	20	10	4.5	M5	4.3	8	4.2	2	4	49	4.5	7		
VB4-120x11Z	86			120	2×40										77				11
VB4-160x15Z	110			160	3×40										105				15
VB4-200x19Z	134			200	4×40										133				19
VB4-240x23Z	158			240	5×40										161				23
VB4-280×27Z	182			280	6×40										189				27
VB4-320x31Z	206			320	7×40										217				31
VB4-360x35Z	230			360	8×40										245				35
VB4-400x39Z	254			400	9×40										273				39
VB4-440x43Z	278			440	10×40										301				43
VB4-480x47Z	302			480	11×40										329				47
VB6-100x7Z	60	30	15	100	1×50	25	13.6	6	M6	5.2	9.5	5.2	2.9	6	70	6	10		
VB6-150x10Z	100			150	2×50										100				10
VB6-200x13Z	140			200	3×50										130				13
VB6-250x17Z	160			250	4×50										170				17
VB6-300x20Z	200			300	5×50										200				20
VB6-350×24Z	220			350	6×50										240				24
VB6-400x27Z	260			400	7×50										270				27
VB6-450x31Z	280			450	8×50										310				31
VB6-500x34Z	320			500	9×50										340				34
VB6-550x38Z	340			550	10×50										380				38
VB6-600x41Z	380			600	11×50										410				41

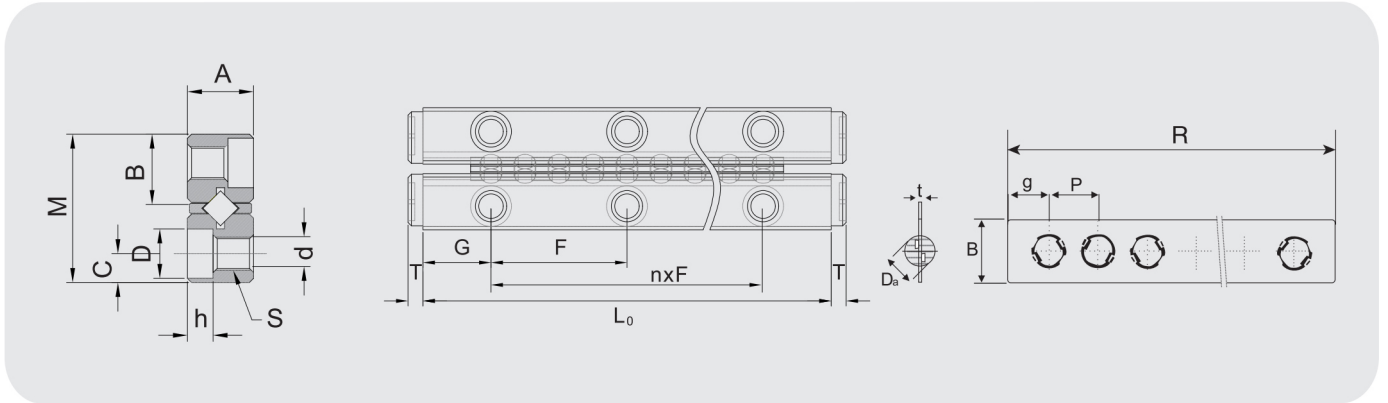
VB9

Model	Maximum stroke mm	Main dimensions																Number of rollers Z			
		Combined size				Assembly dimensions									Cylindrical roller with retainer						
		M	A	L0	nxF	G	B	C	S	d	D	h	T	Da	R	g	P				
VB9-200x10Z	120	40	20	200	1×100	50	18.1	8	M8	6.8	10.5	6.2	4	9	140	7.5	14	10			
VB9-300x15Z	180			300	2×100										210				30		
VB9-400×20Z	240			400	3×100										280					35	
VB9-500x25Z	300			500	4×100										350						40
VB9-600x30Z	360			600	5×100										420						
VB9-700x35Z	420			700	6×100										490						
VB9-800x40Z	480			800	7×100										560						

J I N G P E N G M A C H I N E R Y

Jingpeng Machinery & Equipment (Shanghai) Co.,Ltd

E-mail:sales@yosobearing.com

Mobile/Whatsapp:0086-13636560152

Address:18/F, Building 2, Ring Road Plaza, No. 515, Yishan Road,Xuhui District, Shanghai