



生輝
Shenghui

SHENXIAN SHENGHUI STAINLESS PRODUCTS CO.,LTD

莘县生辉不锈钢制品有限公司



ABOUT

Shenxian Shenghui Stainless Steel Products Co.,Ltd. is a professional stainless steel products manufacturer and exporter, located in Shenxian County, Liaocheng City, Shandong Province , near to Qingdao Port.and Jinan Airport.

We start manufacturing casting part from 2006, with more than 10 years manufacturing experience. With the increasing demand of stainless steel marine part worldwide, we strive to meet the needs of customers, put into processing work-shops and equipment, Quickly provide customers with personal needs programs.It is a manufacturer integrating production and processing. It is the leading manufacturer in China's stainless steel industry.

We pass ISO9001:2008 quality management system certification, anchor CE certificate, SGS certification. Our factory manufacture the castings and polishing surface treatment, under the support of well designed equipment and high quality precision casting machines.Mainly produce various marine hardware, anchors, castings and stainless steel products, more than 2000 products.

We have established longterm business relationship with clients from North America ,Australia ,Europe and South Korea and Japan Etc .

Welcome to visit our factory.

止链器 CHAIN STOPPER

夹绳器

cleat inox for ropes

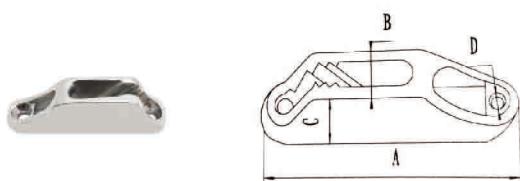

生辉编号/ITEM NO.	名称/PRODUCT NAME	A mm	B mm	C mm	D mm
SH004-001-1221	夹绳器	82	18	24	5.5
SH004-001-1224	夹绳器	82	18	24	5.5
SH004-001-K70	夹绳器	70	17	19	5.5

夹绳器

cleat inox for ropes

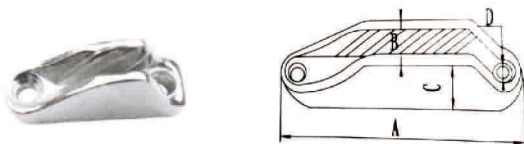

生辉编号/ITEM NO.	名称/PRODUCT NAME	A mm	B mm	C mm	D mm
SH004-001-1223	夹绳器	47.7	14.5	17	5.5

夹绳器

cleat inox for ropes

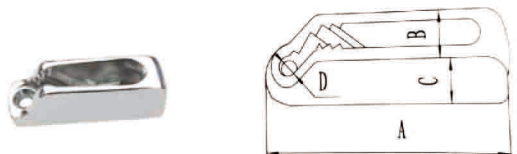

生辉编号/ITEM NO.	名称/PRODUCT NAME	A mm	B mm	C mm	D mm
SH004-001-1222	夹绳器	54.5	17	19	5.5

夹绳器

cleat inox for ropes

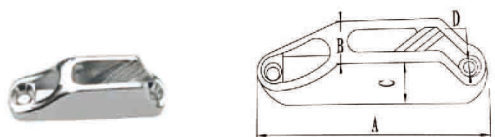

生辉编号/ITEM NO.	名称/PRODUCT NAME	A mm	B mm	C mm	D mm
SH004-001-K55	夹绳器	55	15	19	5.5

快速夹绳器

Rope Clamp Cam Cleat

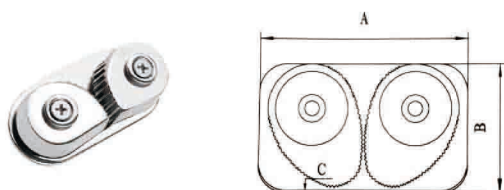

生辉编号/ITEM NO.	名称/PRODUCT NAME	A mm	B mm	C mm
SH004-002-47	快速夹绳器	46.5	23	6
SH004-002-63	快速夹绳器	63	31	10

带导向孔快速夹绳器

Rope Clamp Cam Cleat

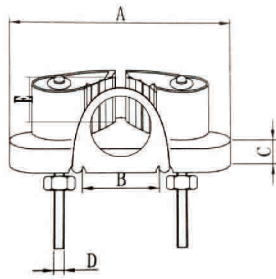

生辉编号/ITEM NO.	名称/PRODUCT NAME	A mm	B mm	C mm	D mm	E mm
SH004-002-68	带导向孔快速夹绳器	68	18.5	7	M5	15.5

止链器

Anchor Chain Lock

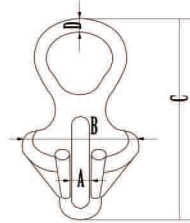

生辉编号/ITEM NO.	名称/PRODUCT NAME	A mm	B mm	C mm	D mm
SH004-003-0608A	6-8MM 止链器	10	66	121	9
SH004-003-1012A	10-12MM 止链器	14.5	100	160	13

轻型止链器

Anchor Chain Lock

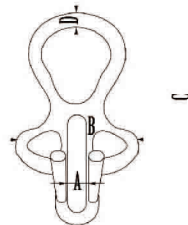

生辉编号/ITEM NO.	名称/PRODUCT NAME	A mm	B mm	C mm	D mm
SH004-003-0608B	6-8MM 轻型止链器	10	66	121	9
SH004-003-1012B	10-12MM 轻型止链器	14.5	100	160	13

山型止链器

Anchor Chain Stopper

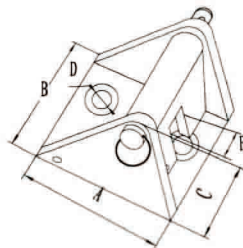

生辉编号/ITEM NO.	名称/PRODUCT NAME	A mm	B mm	C mm	D mm	E mm
SH004-004-0608	6-8MM山型止链器	59.5	53.5	48	8	10.8
SH004-004-1012	10-12MM山型止链器	80.2	70	62	12.5	13

滑槽止链器

Anchor Chain Stopper

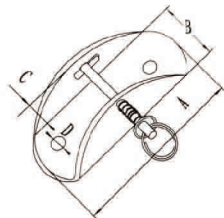

生辉编号/ITEM NO.	名称/PRODUCT NAME	A mm	B mm	C mm	D mm
SH004-005-01	滑槽止链器	101.5	40.2	35.6	5

锚链

Anchor Chain

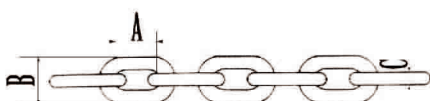

生辉编号/ITEM NO.	名称/PRODUCT NAME	A mm	B mm	C mm	Breaking load kn
SH003-766-06	DIN766 6MM 锚链	18.5	20.2	6	16
SH003-766-08	DIN766 8MM 锚链	24	27.2	8	32
SH003-766-10	DIN766 10MM 锚链	30	34	10	50
SH003-766-12	DIN766 12MM 锚链	34	40.8	12	66
SH003-766-14	DIN766 14MM 锚链	41	47.5	14	100