

华青 机封



江苏华青流体科技有限公司

JIANG SU HUAQING FLUID TECHNOLOGY CO., LTD.

张家港保税区华青机械密封有限公司

ZHANG JIA GANG BONDED HUAQING MECHANICAL SEALS CO., LTD.

前 言

欢迎您光临华青密封世界，在如繁星点点的华青密封天地里，您能发现对您有价值和有感兴趣的产品，是我们华青人的崇高荣誉。

华青密封拥有多种的系列产品，时刻应对着千奇百态的各种市场，丰富的品种会给您提供选择的自由。机制灵活的公司管理能按时向您提供您所需要的产品，严格的质量管理体系和现代化的加工能力免除您对质量的后顾之忧。DIN24960标准贯彻华青密封的80%之上，为您减少库存提供可贵的互换性能，不仅是以上等等的优点，同时再给一个具有竞争力的价格会给您全年降低大量的成本，我们总希望华青产品真正能给您一个超预期值的现实！

我们时刻努力地为用户服务，我们追寻着更好为用户服务的新思路，我们可根据您的需要随时派遣技术人才走进您的办公室，与您共同研发新产品、攻克新课题。给您的产品、给您的设备提供更多的技术支持与质量保证。这是我们华青人期盼的欣慰。

本样本编辑了华青历年来研发的新产品系列（经过市场多年的考验），同时也收集了中外密封的优秀系列，供广大用户参考选用，供广大机械设计人士参考选用，相信该样本会带来较好的社会效益！

该样本在编辑过程中由于时间匆忙，专业知识的局限与不足，一定存在许多错误与缺点，请行业专家、广大用户批评指正。值此机会感谢广大用户多年来对华青事业的惠顾！感谢专家们、教授们、行业人士多年来对华青成长的关心！感谢社会各界的领导人、朋友们对华青公司的支持！

华青密封从星火之源到现在的密封世界，一直在一条拥挤、幽深的道路上探索前进！她拥有一个具有丰富经验和责任心团队，一直以新的闪光照耀着华青人勇敢攀登、快步跨越！新产品的不断问世更有力地支撑我们这个团队大步前进！为全世界泵类、釜类及其它机械类提供先进的优质产品，是华青员工攀登不息，奋进不止的永恒动力！

INTRODUCTION

Welcome to the world of HuaQing airtight products, such in a lot of stars of HuaQing airtight products, HuaQing people is great honor that you can find anything valuable and interesting.

HuaQing has strong series products, it replies all kinds of conformation market in the time of day. It can be chosen freedom for you of abundant products. Company mange of resourceful and agile can supply you on time when you need, strict Quality Management System and process ability of modernistic prevent about quality problem for you. It cuts down repertory for you that supply golden of exchange and function because DIN24960 standard carry out of HuaQing mechanical seal upward 80%, not only has advantage etc upward, also can cut down a lots of costing in one year for you which supply price of competitive. We always hope HuaQing products can give actuality unadulterated, in condition of above.

We service for customers hard in the time of day, we track down some new idea that can service for customers more. We can send technician to your office, development of new products, in the following with you at any moment that you need. Be gratified for HuaQing people are supplying more technique support and guaranteeing for your products and equipments.

This stylebook edited many years a lot of new products series (by marke test many years) of HuaQing, also edited a lot of seals excellent series of China and foreign countries, it can supply lots of customers and mechinist which refer to choose, we believe that it can give muh society benefit kindly!

It has lots of mistakes and foible because it is make in a hurry time, specialized subject is limited and not enough, please lots of expert, trading people and customers point out mistakes so that they can be corrected. We avail this opportunity to express our gratitude to largethankful large customers, experts, professors and trading people for for their concern of HuaQing. Also,we would like to take the occasion to thank leads and friends for supporting for HuaQing company of different from society!

HuaQing seals is a found head from seals wolrd now, always in a crowd and deep and serene of road. HuaQing is such a group, who has plenty experiences and strong sense of responsibility. New products coming makes we work hard to go upward by big step! To supply advanced quality products for the pump, kettle and other machines, is the aim and force our staffs.

企业荣誉

Honor of Company

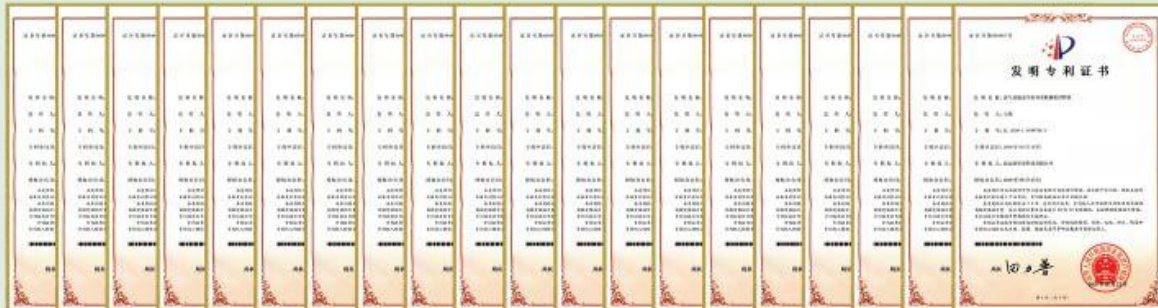



目 录 CONTENTS

机械密封基本型式及代号	3
(The basic type and code of mechanical seals)	
 机械密封 (Mechanical seals)	
一、中型单端面机械密封 (Medium-size single mechanical seals)	4-29
HU1、HB1、HU2、HB2、HU3、HB3、HU5、HB5、HB6、HBB6、HU7、HB7 HU9、HB9、HU10、HU14、HUD9、HQU8、QQB8、HQTM-A/B-1 HQ58U、HQ59U、HQ58B、HQ59B	
二、中型双端面机械密封 (Medium-size double mechanical seals)	30-34
HUU801、HBB803、HUU803、HUU805	
三、金属波纹管机械密封 (Metal bellows mechanical seals)	35-41
HBM1、HBM2、HQBM-A/B-1、HQ604/606/609、HQ670/676/680	
四、集装式流体动压式机械密封 (Cartridge hydrodynamic mechanical seals)	42-44
HQCT、HQMS	
五、轻型机械密封 (Light mechanical seals)	45-51
HQ502、HG9、FBC、FBD、HU21、HQ3272	
六、釜用机械密封 (Reaction kettle mechanical seals)	52-61
204B、205、206、207、212、HQM481、HQM481K-D、HQHS-D、HQHSH-D	
七、机械密封辅助系统 (Mechanical seal auxiliary systems)	62-63
WED 型换热器、TS2000 型热虹吸罐	
 机械密封用材料代号表 (The list of seal material for machinery)	64



机械密封基本型式及代号

The base type and code of mechanical seals

一、华青机械密封基本型式字母及数字代号

Alphabate & digital code on elemental types of Huaqing Mechanical Seals

H—机械密封 (H for HuaQing Mechanical seals CO.,Ltd.)

U—非平衡型机械密封 (U for unbalanced Mechanical seals) 如：HU2。

B—华青平衡型机械密封 (B for Balanced Mechanical seals) 如：HB2。

N—符合 DIN24960 标准 (N for conforms to DIN24960 standard) 如：HU2N。

1、2、3……代表华青机械密封设计顺序 (1、2、3……for design sequence) 如：HU1、HU2。

HUU 华青双端机械密封 (HUU for double seals) 如：HUU803、HBB803

HBM 华青金属波纹管密封 (HBM for Metal Bellows Seals) 如：HBM1、HBM2。

二、按照 DIN24960 标准，华青机械密封通常编写方法如下：(Complies with DIN24960 standard,HQMS)

1、单端面通用型机械密封 (General single seals)



2、双端面通用型机械密封 (General double seals)



如遇特殊工况、机械密封材料选择、机械密封选型，请与我公司联系并索取相关资料

如需了解进一步的信息和有关数据，请与本公司工程技术部联系。
 If you would like to know more information and relevant data, please contact the technology department.

HU1 型机械密封

Type HU1 mechanical seals

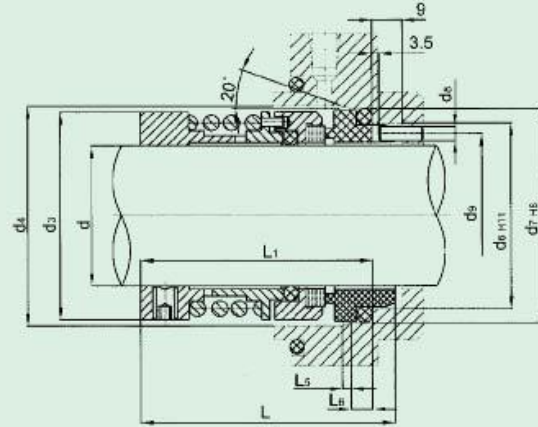

结构特点：

HU1 型机械密封符合 ISO3069 DIN24960 和 GB/T 6556 标准。辅助密封圈根据工况要求可选用同规格橡胶 "O" 圈 PTFE "V" 圈。单弹簧、非平衡型拨叉传动、补偿能力强，安装时与轴旋向无关。摩擦副材质与辅助密封材质可根据实际工况选用。

Structure Features:

The mechanical seal of type HU1 is accord with ISO3069 DIN24960 & GB/T6556, according to the working requirements, it could choose "O" ring or PTFE "V" ring seals of the same specification as auxiliary seal. Single spring, unbalanced, shifting fork drive, strong compensation ability. It is not related with shift rotation when installing.

Sub-materials of friction and auxiliary materials should be selected according to operation condition.

适用范围：

被密封介质：油水、结晶性强碱、盐、高浓度流体浆料、有机溶剂及其他弱腐蚀溶液。

密封腔压力：≤ 1Mpa

密封腔温度：-20℃ ~220℃

线速度：≤ 15m/s

Available Range:

Sealed Medium: Oil, water, crystal, strong alkalis, salt, high concentraton fluid, size, organic solvent and other low corrosion liquid.

Pressure in the sealed chamber: ≤ 1Mpa

Temperature in the sealed chamber: -20℃ ~220℃

Linear velocity: ≤ 15m/s

如需了解进一步的信息和有关数据，请与本公司工程技术部联系。
 If you would like to know more information and relevant data, please contact the technology department.

HU1 型尺寸表 Dimension Table

公称直径	d_{p7}	d_3	d_{4min}	$d_{3h(+1)}$	$d_{7h(+1)}$	d_5	$d_{h(+1)}$	$L_{(+0.5)}$	$L_{1(+0.5)}$	L_6	L_8
18	18	32	34	27	33	23	3	52	45	2	5
20	20	34	36	29	35	25	3	52	45	2	5
22	22	36	38	31	37	27	3	53	46	2	5
24	24	38	40	33	39	29	3	56	49	2	5
25	25	39	41	34	40	30	3	56	49	2	5
28	28	42	44	37	43	33	3	56.5	49.5	2	5
30	30	44	46	39	45	35	3	57	50	2	5
32	32	46	48	42	48	38	3	58.5	51.5	2	5
33	33	47	49	42	48	38	3	58.5	51.5	2	5
35	35	49	51	44	50	40	3	58.5	51.5	2	5
38	38	54	58	49	56	44	4	62	55	2	6
40	40	56	60	51	58	46	4	62	55	2	6
43	43	59	63	54	61	49	4	65	58	2	6
45	45	61	65	56	63	51	4	65	58	2	6
48	48	64	68	59	66	54	4	66	59	2	6
50	50	66	70	62	70	57	4	67	60	2.5	6
53	53	69	73	65	73	60	4	71.5	64.5	2.5	6
55	55	71	75	67	75	62	4	73.5	66.5	2.5	6
58	58	78	83	70	78	65	4	76.5	69.5	2.5	6.5
60	60	80	85	72	80	67	4	76.5	69.5	2.5	6.5
63	63	83	88	75	83	70	4	78.5	71.5	2.5	6.5
65	65	85	90	77	85	72	4	81.5	74.5	2.5	6.5
68	68	88	93	81	90	75	4	82.5	75.5	2.5	7
70	70	90	95	83	92	77	4	86.5	79.5	2.5	7
75	75	98	104	88	97	82	4	87	80	2.5	7
80	80	103	109	95	105	88	4	90.5	83.5	3	7
85	85	108	114	100	110	93	4	90.5	83.5	3	7
90	90	113	119	105	115	98	4	92.5	85.5	3	7
95	95	118	124	110	120	103	4	93.5	86.5	3	7
100	100	123	129	115	125	108	4	93.5	86.5	3	7
110	110	135	144	125	136	118	4	97	90	3	8
120	120	145	154	135	146	128	4	97	90	3	8



HB1 型机械密封

Type HB1 mechanical seals

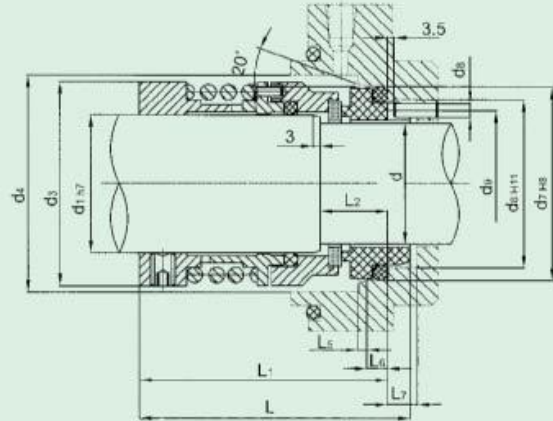

结构特点：

HB1 型机械密封符合 ISO3069、DIN24960 和 GB/T 6556 标准。辅助密封圈根据工况要求可选用同规格橡胶“O”圈 PTFE “V”圈。单弹簧、平衡型拨叉传动、补偿能力强，安装时与轴旋向无关。

摩擦副材质与辅助密封材质可根据实际工况选用。

Structure Features:

The mechanical seal of type HB1 is accorded to ISO3069 DIN24960&GB/T6556, according to the working requirements, it could choose “O” ring or PTFE “V” ring seals of the same specification as auxiliary seal. Single spring, balanced, shifting fork drive, strong compensation ability. It is not related with shift rotation when installing.

Sub-materials of friction and auxiliary materials should be selected according to operation condition.

适用范围：

被密封介质：油水、结晶性强碱、盐、高浓度流体、浆料、有机溶剂及其他弱腐蚀性溶液。

密封腔压力： $\leq 4\text{Mpa}$

密封腔温度： $-20^{\circ}\text{C} \sim 220^{\circ}\text{C}$

线速度： $\leq 15\text{m/s}$

Available Range:

Sealed Medium: Oil, water, crystal, strong alkalis, salt, high concentration fluid, size, organic solvent and other low corrosion liquid.

Pressure in the sealed chamber: $\leq 4\text{Mpa}$

Temperature in the sealed chamber: $-20^{\circ}\text{C} \sim 220^{\circ}\text{C}$

Linear velocity: $\leq 15\text{m/s}$

HB1 型尺寸表 Dimension Table

公称直径	d	$d_{1(0.7)}$	d_3	d_{min}	$d_{(H11)}$	$d_{(H6)}$	d_6	$d_{(H6)}$	$L_{(±0.5)}$	$L_{1(±0.5)}$	L_2	L_3	L_4	L_5	L_6	L_7
14	14	18	32	34	21	25	3	18	57	50.5	18	1.5	4	8.5		
16	16	20	34	36	23	27	3	20	57	50.5	18	1.5	4	8.5		
18	18	22	36	38	27	33	3	23	60.5	53.5	20	2	5	9		
20	20	24	38	40	29	35	3	25	63.5	56.5	20	2	5	9		
22	22	26	40	42	31	37	3	27	63.5	56.5	20	2	5	9		
24	24	28	42	44	33	39	3	29	64	57	20	2	5	9		
25	25	30	44	47	34	40	3	30	65	58	20	2	5	9		
28	28	33	47	49	37	43	3	33	66.5	59.5	20	2	5	9		
30	30	35	49	51	39	45	3	35	66.5	59.5	20	2	5	9		
32	32	38	54	58	42	48	3	38	68	61	20	2	5	9		
33	33	38	54	58	42	48	3	38	68	61	20	2	5	9		
35	35	40	56	60	44	50	3	40	68	61	20	2	5	9		
38	38	43	59	63	49	56	4	44	72.5	65.5	23	2	6	9		
40	40	45	61	65	51	58	4	46	72.5	65.5	23	2	6	9		
43	43	48	64	68	54	61	4	49	73.5	66.5	23	2	6	9		
45	45	50	66	70	56	63	4	51	73.5	66.5	23	2	6	9		
48	48	53	69	73	59	66	4	54	77.5	70.5	23	2	6	9		
50	50	55	71	75	62	70	4	57	82	75	25	2.5	6	9		
53	53	58	78	83	65	73	4	60	84	77	25	2.5	6	9		
55	55	60	80	85	67	75	4	62	84	77	25	2.5	6	9		
58	58	63	83	88	70	78	4	65	86	79	25	2.5	6.5	9		
60	60	65	85	90	72	80	4	67	89	82	25	2.5	6.5	9		
63	63	68	88	93	75	83	4	70	89	82	25	2.5	6.5	9		
65	65	70	90	95	77	85	4	72	93	86	25	2.5	6.5	9		
70	70	75	98	104	83	92	4	77	97	90	28	2.5	7	9		
75	75	80	103	109	88	97	4	82	99	92	28	2.5	7	9		
80	80	85	108	114	95	105	4	88	100.5	93.5	28	3	7	9		
85	85	90	113	119	100	110	4	93	102.5	95.5	28	3	7	9		
90	90	95	118	124	105	115	4	98	102.5	95.5	28	3	7	9		
95	95	100	123	129	110	120	4	103	102.5	95.5	28	3	7	9		
100	100	105	128	134	115	125	4	108	102.5	95.5	28	3	7	9		
110	110	115	140	149	125	136	4	118	106.5	99.5	28	3	8	9		
120	120	125	150	159	135	146	4	128	106.5	99.5	28	3	8	9		

如需了解进一步的信息和有关数据，请与本公司工程技术部联系。
If you would like to know more information and relevant data, please contact the technology department.

HU2 型机械密封

Type HU2 mechanical seals

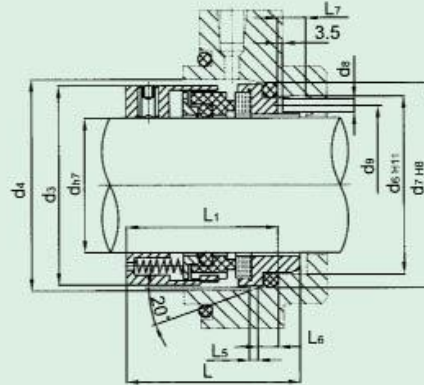

结构特点：

HU2 型机械密封尺寸符合 ISO3069、DIN24960 和 GB/T 6556 标准、互换性强，可替代进口机封 59U、M7N 等。辅助密封圈根据用户需求。可选用橡胶 O 形圈、聚四氟乙烯 V 形圈、聚四氟乙烯楔形环。与轴向无关的传动套传动，压力均、多弹簧补偿，非平衡型结构，动环部分预先组装为一体，安装简单。

摩擦副材质与辅助密封材质可根据实际工况选用。

Structure Features:

The mechanical seal of type HU2 is accord with the standards of ISO3069, DIN 24960, GB/T6556, and has the feature of good interchange to replace the imported mechanical sealing parts, such as 59u, M7N etc. The auxiliary sealing, in according to clients requirement, rubber 'O'ring, or PTFE'V'ring, PTFE wedge (w) can be selected according to different conditions. Integrating the driving of non-axial driving sleeve with multi-springs compensate, unbalanced structure. The part of rotating ring can be assembled together in advance. It can be mounted conveniently.

Sub-materials of friction and auxiliary materials should be selected according to operation condition.

适用范围：

被密封介质：水、油、酸、碱、盐、非结晶性溶剂等。

密封腔压力： $\leq 1\text{Mpa}$

密封腔温度： $-20^{\circ}\text{C} \sim 220^{\circ}\text{C}$

线速度： $\leq 15\text{m/s}$

Available Range:

Sealed Medium: water, oil, acid, alkali, salt, and non-crystalline agent, etc.

Pressure in the sealed chamber: $\leq 1\text{Mpa}$

Temperature in the sealed chamber: $-20^{\circ}\text{C} \sim 220^{\circ}\text{C}$

Linear velocity: $\leq 15\text{m/s}$

如需了解进一步的信息和有关数据，请与本公司工程技术部联系。
 If you would like to know more information and relevant data, please contact the technology department.

HU2 型尺寸表 Dimension Table

公称直径	$d_{(D)}$	d_3	$d_{(mm)}$	$d_{(D11)}$	$d_{(D6)}$	d_6	d_7	$L_{(L0.5)}$	$L_{(L1.0.25)}$	L_3	L_4	L_7
18	18	32	34	27	33	3	23	44.5	37.5	2	5	9
20	20	34	36	29	35	3	25	44.5	37.5	2	5	9
22	22	36	38	31	37	3	27	44.5	37.5	2	5	9
24	24	38	40	33	39	3	29	45	38	2	5	9
25	25	39	41	34	40	3	30	45	38	2	5	9
28	28	42	44	37	43	3	33	47	40	2	5	9
30	30	44	46	39	45	3	35	47	40	2	5	9
32	32	46	48	42	48	3	38	48.5	41.5	2	5	9
33	33	47	49	42	48	3	38	48.5	41.5	2	5	9
35	35	49	51	44	50	3	40	48.5	41.5	2	5	9
38	38	54	58	49	56	4	44	52	45	2	6	9
40	40	56	60	51	58	4	46	52	45	2	6	9
43	43	59	63	54	61	4	49	52	45	2	6	9
45	45	61	65	56	63	4	51	52	45	2	6	9
48	48	64	68	59	66	4	54	52	45	2	6	9
50	50	66	70	62	70	4	57	53.5	46.5	2.5	6	9
53	53	69	73	65	73	4	60	53.5	46.5	2.5	6	9
55	55	71	75	67	75	4	62	54.5	47.5	2.5	6	9
58	58	78	83	70	78	4	65	57.5	50.5	2.5	6.5	9
60	60	80	85	72	80	4	67	57.5	50.5	2.5	6.5	9
63	63	83	88	75	83	4	70	59.5	52.5	2.5	6.5	9
65	65	85	90	77	85	4	72	59.5	52.5	2.5	6.5	9
68	68	88	93	81	90	4	75	59.5	52.5	2.5	7	9
70	70	90	95	83	92	4	77	62.5	55.5	2.5	7	9
75	75	99	104	88	97	4	82	65.5	58.5	2.5	7	9
80	80	104	109	95	105	4	88	67	60	3	7	9
85	85	109	114	100	110	4	93	67	60	3	7	9
90	90	114	119	105	115	4	98	67	60	3	7	9
95	95	119	124	110	120	4	103	68	61	3	7	9
100	100	124	129	115	125	4	108	69	62	3	7	9
105	105	133	139	120	130	4	113	70	63	3	7	9
110	110	138	144	125	136	4	118	71	64	3	8	9
115	115	143	149	130	141	4	123	71	64	3	8	9
120	120	148	154	135	146	4	128	71	64	3	8	9
125	125	153	159	141	152	5	134	74.5	66	3	10	10.5
130	130	159	165	146	158	5	139	82	73.5	3	10	10.5
135	135	164	170	151	163	5	144	82	73.5	3	10	10.5
140	140	172	180	161	173	5	152	83	74.5	3	10	10.5
145	145	177	185	166	178	5	157	84	75.5	3	10	10.5
150	150	182	190	171	183	5	162	84	75.5	3	10	10.5
155	155	187	195	176	188	6	167	90	80.5	3	12	11.5
160	160	193	200	181	193	6	172	90	80.5	3	12	11.5
165	165	198	205	186	198	6	177	90	80.5	3	12	11.5
170	170	207	215	191	203	6	182	90	80.5	3	12	11.5
175	175	212	220	201	213	6	190	92	82.5	3	12	11.5
180	180	217	225	206	218	6	195	92	82.5	3	12	11.5
185	185	222	230	211	223	6	200	92	82.5	3	12	11.5
190	190	227	235	216	228	6	205	92	82.5	3	12	11.5
195	195	232	240	221	233	6	210	92	82.5	3	12	11.5
200	200	240	250	228	238	6	215	92	82.5	3	12	11.5

HB2 型机械密封

Type HB2 mechanical seals

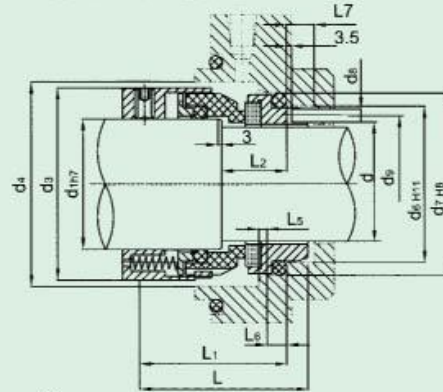

结构特点：

HB2 型机械密封尺寸符合 ISO3069、DIN24960 和 GB/T 6556 标准、互换性强，可替代进口机封 59B、H7N 等。辅助密封圈根据用户需求，可选用橡胶 O 形圈、聚四氟乙烯 V 形圈、聚四氟乙烯楔形环。与轴旋向无关的传动套传动，压力均多弹簧补偿，平衡型结构，动环部分预先组装为一体，安装简单。

摩擦副材质与辅助密封材质可根据实际工况选用。

Structure Features:

The mechanical seal of type HB2 is accord with the standards of ISO3069, DIN 24960, GB/T 6556, and has the feature of good interchange to replace the imported mechanical sealing parts, such as 59B, H7N etc. The auxiliary sealing, in according to clients requirement, rubber 'O'ring, or PTFE 'V'ring, PTFE wedge (w) can be selected according to different conditions. Integrating the driving of non-axial driving sleeve with multi-springs compensate, balanced structure. The part of rotating ring can be assembled together in advance. It can be mounted conveniently.

Sub-materials of friction and auxiliary materials should be selected according to operation condition.

适用范围：

被密封介质：水、油、酸、碱、盐、非结晶性溶剂等。

密封腔压力： $\leq 4\text{Mpa}$

密封腔温度： $-20^{\circ}\text{C} \sim 220^{\circ}\text{C}$

线速度： $\leq 15\text{m/s}$

Available Range:

Sealed Medium: water, oil, acid, alkali, salt, and non-crystalline agent, etc.

Pressure in the sealed chamber: $\leq 4\text{Mpa}$

Temperature in the sealed chamber: $-20^{\circ}\text{C} \sim 22^{\circ}\text{C}$

Linear velocity: $\leq 15\text{m/s}$

如需了解进一步的信息和有关数据，请与本公司工程技术部联系。
 If you would like to know more information and relevant data, please contact the technology department.

HB2 型尺寸表 Dimension Table

公称直径	d	d _{10/17}	d ₂	d _{4min}	d ₀₍₁₁₎	d ₇₍₂₆₎	d ₀₍₃₎	d ₃	L _{1(±0.5)}	L _{1(±0.5)}	L ₂	L ₅	L ₆	L ₇
14	14	18	32	34	21	25	3	18	49	42.5	18	1.5	4	8.5
16	16	20	34	36	23	27	3	20	49	42.5	18	1.5	4	8.5
18	18	22	36	38	27	33	3	23	51.5	44.5	20	2	5	9
20	20	24	38	40	29	35	3	25	52	45	20	2	5	9
22	22	26	40	42	31	37	3	27	52	45	20	2	5	9
24	24	28	42	44	33	39	3	29	54.5	47.5	20	2	5	9
25	25	30	44	46	34	40	3	30	54.5	47.5	20	2	5	9
28	28	33	47	49	37	43	3	33	56.5	49.5	20	2	5	9
30	30	35	49	51	39	45	3	35	56.5	49.5	20	2	5	9
32	32	38	54	58	42	48	3	38	57	50	20	2	5	9
33	33	38	54	58	42	48	3	38	57	50	20	2	5	9
35	35	40	56	60	44	50	3	40	57	50	20	2	5	9
38	38	43	59	63	49	56	4	44	59.5	52.5	23	2	6	9
40	40	45	61	65	51	58	4	46	59.5	52.5	23	2	6	9
43	43	48	64	68	54	61	4	49	59.5	52.5	23	2	6	9
45	45	50	66	70	56	63	4	51	59.5	52.5	23	2	6	9
48	48	53	69	73	59	66	4	54	59.5	52.5	23	2	6	9
50	50	55	71	75	62	70	4	57	62.5	55.5	25	2.5	6	9
53	53	58	78	83	65	73	4	60	64.5	57.5	25	2.5	6	9
55	55	60	80	85	67	75	4	62	64.5	57.5	25	2.5	6	9
58	58	63	83	88	70	78	4	65	67.5	60.5	25	2.5	6.5	9
60	60	65	85	90	72	80	4	67	67.5	60.5	25	2.5	6.5	9
63	63	68	88	93	75	83	4	70	67.5	60.5	25	2.5	6.5	9
65	65	70	90	95	77	85	4	72	69	62	25	2.5	6.5	9
70	70	75	99	104	83	92	4	77	75.5	68.5	28	2.5	7	9
75	75	80	104	109	88	97	4	82	75.5	68.5	28	2.5	7	9
80	80	85	109	114	95	105	4	88	77	70	28	2.5	7	9
85	85	90	114	119	100	110	4	93	77	70	28	2.5	7	9
90	90	95	119	124	105	115	4	98	77	70	28	2.5	7	9
95	95	100	124	129	110	120	4	103	77.5	70.5	28	2.5	7	9
100	100	105	133	139	115	125	4	108	77.5	70.5	28	3	7	9
105	105	110	138	144	120	130	4	113	78.5	71.5	28	3	7	9
110	110	115	143	149	125	136	4	118	79.5	72.5	28	3	8	9
115	115	120	148	154	130	141	4	123	79.5	72.5	28	3	8	9
120	120	125	153	159	135	146	4	128	79.5	72.5	28	3	8	9
125	125	130	159	165	141	152	5	134	90.5	82	33	3	10	10.5
130	130	135	164	170	146	158	5	139	90.5	82	33	3	10	10.5
135	135	140	172	180	151	163	5	144	90.5	82	33	3	10	10.5
140	140	150	182	190	161	173	5	152	93	84.5	35	3	10	10.5
145	145	155	187	195	166	178	5	157	93	84.5	35	3	10	10.5
150	150	160	193	200	171	183	5	162	93	84.5	35	3	10	10.5
155	155	165	198	205	176	188	6	167	98	88.5	38	3	12	11.5
160	160	170	207	215	181	193	6	172	98	88.5	38	3	12	11.5
165	165	175	212	220	186	198	6	177	98	88.5	38	3	12	11.5
170	170	180	217	225	191	203	6	182	98	88.5	38	3	12	11.5
175	175	185	222	230	201	213	6	190	100.5	91	40	3	12	11.5
180	180	190	227	235	206	218	6	195	100.5	91	40	3	12	11.5
185	185	195	232	240	211	223	6	200	100.5	91	40	3	12	11.5
190	190	200	240	250	216	228	6	205	100.5	91	40	3	12	11.5
195	195	205	245	255	221	233	6	210	100.5	91	40	3	12	11.5
200	200	210	250	260	226	238	6	215	100.5	91	40	3	12	11.5

HU3 型机械密封

Type HU3 mechanical seals

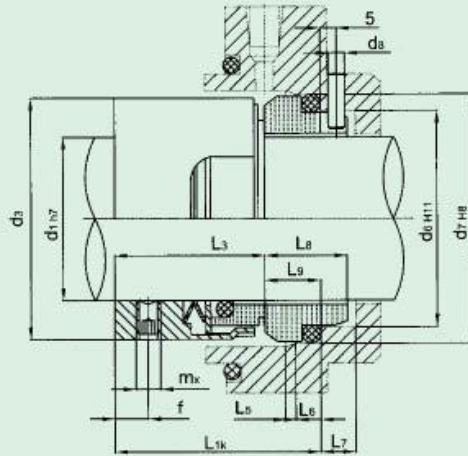

结构特点：

HU3 型机械密封符合 DIN24960 及 GB/T 6556 标准，可替代 116U、59U 型机封、为非平衡型、单端面结构、任意旋向。各种污水泵、化工泵、热循环泵均适用。弹簧选择有蝶形弹簧、多弹簧等。

摩擦副材质与辅助密封材质请根据实际工况选用。

Structure Features:

The mechanical seal of type HU3 is accord with DIN24960& GB/T 6556, can replace Type 116U, 59U mechanical seals, unbalanced, single face structure To be suitable for all kinds of sewage water pumps, chemical pumps and heal circulating pumps, with butterfly spring multi-springs etc It is independent of rotation direction of pump shaft.

Sub-materials of friction and auxiliary materials should be selected according to operation condition.

适用范围：

被密封介质：油、水、酸、碱、盐等一般腐蚀性介质。

密封腔压力： $\leq 1.6\text{Mpa}$

密封腔温度： $-50^{\circ}\text{C} \sim 220^{\circ}\text{C}$

线速度： $\leq 20\text{m/s}$

Available Range:

Sealed Medium: oil, water, acid, alkali, salt, and non-crystalline agent, etc.

Pressure in the sealed chamber: $\leq 1.6\text{Mpa}$

Temperature in the sealed chamber: $-50^{\circ}\text{C} \sim 220^{\circ}\text{C}$

Linear velocity: $\leq 20\text{m/s}$

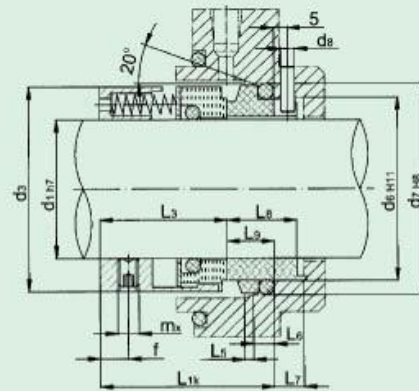

HU34型

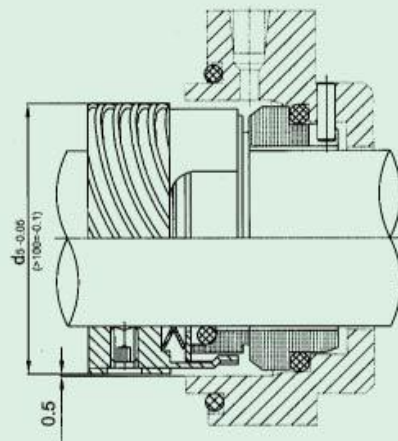

HU3F型

如需了解进一步的信息和有关数据，请与本公司工程技术部联系。
 If you would like to know more information and relevant data, please contact the technology department.

HB3 型机械密封

Type HB3 mechanical seals

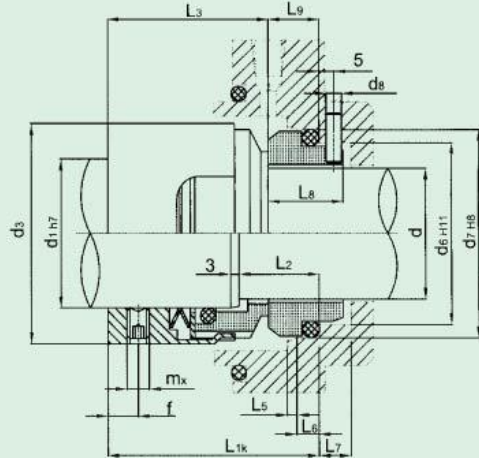

结构特点：

HB3 型机械密封符合：DIN24960 及 GB/T 6556 标准可替代 119B、59B 型机封、为平衡型、单端面结构，任意旋向。各种污水泵、化工泵，热循环泵均适用。弹簧选择有：蝶形弹簧、多弹簧等。

摩擦副材质与辅助密封材质请根据实际工况选用。

Structure Features:

The mechanical seal of type HB3 is accord with DIN24960& GB/T 6556, can replace Type 119B, 59B mechanical seals, balanced, single face structure, To be suitable for all kinds of sewage water pumps, chemical pumps and heal circulating pumps, with butterfly spring multi-springs etc. It is independent of rotation direction of pump shaft.

Sub-materials of friction and auxiliary materials should be selected according to operation condition.

适用范围：

被密封介质：油、水、酸、碱、盐等一般腐蚀性介质。

密封腔压力： $\leq 2.5\text{Mpa}$

密封腔温度： $-50^{\circ}\text{C} \sim 220^{\circ}\text{C}$

线速度： $\leq 20\text{m/s}$

Available Range:

Sealed Medium: oil, water, acid, alkali, salt, and non-crystalline agent, etc.

Pressure in the sealed chamber: $\leq 2.5\text{Mpa}$

Temperature in the sealed chamber: $-50^{\circ}\text{C} \sim 220^{\circ}\text{C}$

Linear velocity: $\leq 20\text{m/s}$

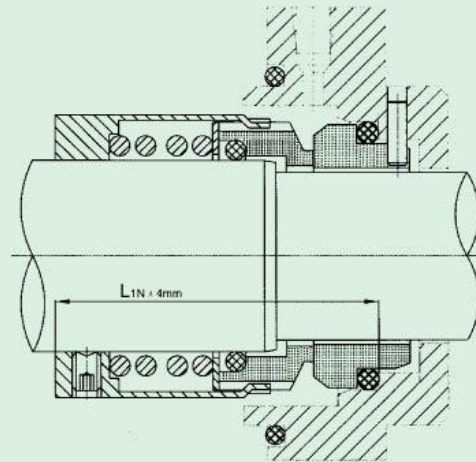

HB36型

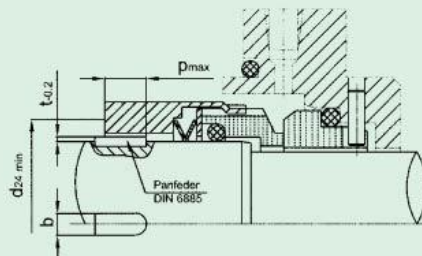

HB3S2型

如需了解进一步的信息和有关数据，请与本公司工程技术部联系。
 If you would like to know more information and relevant data, please contact the technology department.

HU5 型机械密封

Type HU5 mechanical seals

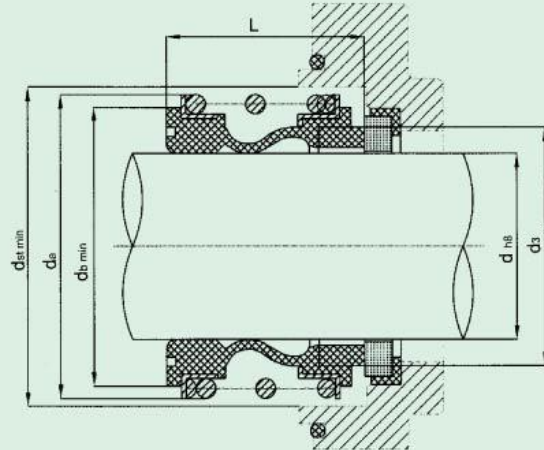
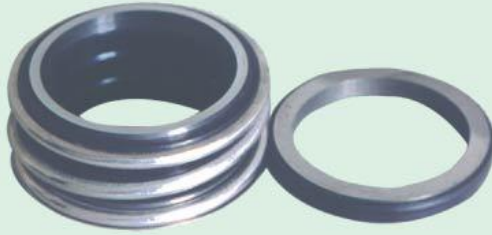

结构特点：

HU5 型机械密封符合 DIN24960 标准，背靠背安装亦符合 DIN24960 标准双端面机械密封，属于部分平衡型、橡胶波纹管、单弹簧、单端面结构，动环靠橡胶波纹管的过盈量驱动，浮动性好，弹簧也起传递扭矩作用。

摩擦副材质与辅助密封材质请根据实际工况选用。

Structure Features:

The mechanical seal of type HU5 is accord with DIN24960, this mechaical seal is back-to-back mounted and, is in accordance with DIN24960, standard of two end surface mechanical seal. Parf of balanced, the rubber of bellow, single spring, single face structure. By means of the intefierential shrink of the rubber piece, the rotating ring is radically fixed on the axle and is driven to rotate together. The spring plays roles of the torque transmission.

Sub-materials of friction and auxiliary materials should be selected according to operation condition.

适用范围：

- 被密封介质：含颗粒的废水、油、污水。
- 密封腔压力： $\leq 1.6\text{Mpa}$
- 密封腔温度： $-20^{\circ}\text{C} \sim 140^{\circ}\text{C}$
- 线速度： $\leq 10\text{m/s}$

Available Range:

- Sealed Medium: liquid waste of grains, oil, sewage water.
- Pressure in the sealed chamber: $\leq 1.6\text{Mpa}$
- Temperature in the sealed chamber: $-20^{\circ}\text{C} \sim 140^{\circ}\text{C}$
- Linear velocity: $\leq 10\text{m/s}$

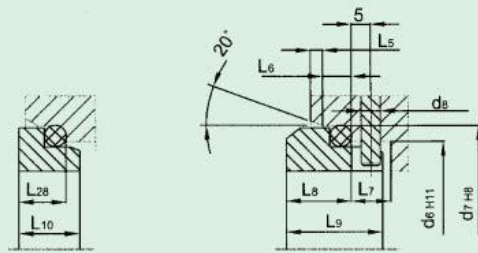

G6 DIN24960

G9 DIN24960

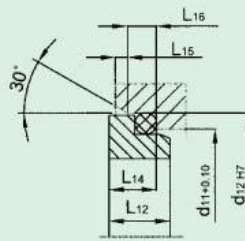

G4

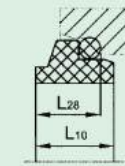

G606 DIN24960

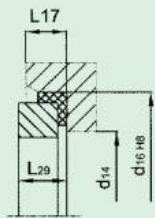

G50

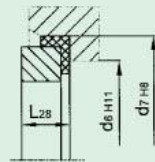

G60 DIN24960

如需了解进一步的信息和有关数据，请与本公司工程技术部联系。
 If you would like to know more information and relevant data, please contact the technology department.

HB5 型机械密封

Type HB5 mechanical seals

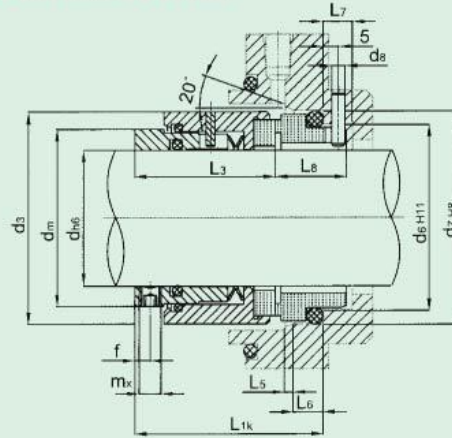

结构特点：

HB5 型机械密封符合 DIN24960 标准，平衡型，蝶形弹簧或小弹簧，单端面，机械密封弹簧在介质中被保护，不会产生粘住和阻尼的情况，这使该设计稳定，安全可靠。

摩擦副材质与辅助材质可根据实际工况选用。

Structure Features:

The mechanical seal of type HB5 is accord with DIN24960, and can replace. Balanced, single face. with butterfly spring structure No sticking and damping will be happened for the spring in medium, this makes it to be stable, safe and reliable.

Sub-materials of friction and auxiliary materials should be selected according to operation condition.

适用范围：

被密封介质：含固体颗粒和高粘度介质，如造纸、制糖、污水等工业。

密封腔压力：≤ 2.5Mpa

密封腔温度：-20℃ ~80℃

线速度：≤ 20m/s

Available Range:

Sealed Medium: Solid grains medium, high viscosity medium, papermaking, sugar-making industry and sewage water treatment, e.g.

Pressure in the sealed chamber: ≤ 2.5Mpa

Temperature in the sealed chamber: -20℃ ~80℃

Linear velocity: ≤ 20m/s

HB5 型尺寸表 Dimension Table

公称轴径	d	d ₃	d ₆	d _r	d ₈	d _m	L _{1k}	L ₃	L ₅	L ₆	L ₇	L ₈	f	m _x
18	18	32	27	33	3	26.0	37.5	30.5	2.0	5	9	15.0	3.0	M4
20	20	34	29	35	3	28.0	37.5	30.5	2.0	5	9	15.0	3.0	M4
22	22	36	31	37	3	30.0	37.5	30.5	2.0	5	9	15.0	3.0	M4
24	24	38	33	39	3	32.5	40.0	33.0	2.0	5	9	15.0	3.5	M5
25	25	39	34	40	3	33.5	40.0	33.0	2.0	5	9	15.0	3.5	M5
28	28	42	37	43	3	36.5	42.5	35.5	2.0	5	9	15.0	3.5	M5
30	30	44	39	45	3	38.5	42.5	35.5	2.0	5	9	15.0	3.5	M5
32	32	47	42	48	3	41.5	42.5	35.5	2.0	5	9	15.0	3.5	M5
33	33	47	42	48	3	41.5	42.5	35.5	2.0	5	9	15.0	3.5	M5
35	35	49	44	50	3	43.5	42.5	35.5	2.0	5	9	15.0	3.5	M5
38	38	54	49	56	4	47.5	45.0	37.0	2.0	6	9	16.0	4.0	M5
40	40	56	51	58	4	49.5	45.0	37.0	2.0	6	9	16.0	4.0	M5
43	43	59	54	61	4	52.5	45.0	37.0	2.0	6	9	16.0	4.0	M5
45	45	61	56	63	4	54.5	45.0	37.0	2.0	6	9	16.0	4.0	M5
48	48	64	59	66	4	57.5	45.0	37.0	2.0	6	9	16.0	4.0	M5
50	50	66	62	70	4	59.5	47.5	38.0	2.5	6	9	17.0	4.5	M6
53	53	69	65	73	4	62.5	47.5	38.0	2.5	6	9	17.0	4.5	M6
55	55	71	67	75	4	64.5	47.5	38.0	2.5	6	9	17.0	4.5	M6
58	58	78	70	78	4	68.5	52.5	42.0	2.5	6	9	18.0	4.5	M6
60	60	80	72	80	4	70.5	52.5	42.0	2.5	6	9	18.0	4.5	M6
63	63	83	75	83	4	73.5	52.5	42.0	2.5	6	9	18.0	4.5	M6
65	65	85	77	85	4	75.5	52.5	42.0	2.5	6	9	18.0	4.5	M6
68	68	88	81	90	4	78.5	52.5	41.5	2.5	7	9	18.5	4.5	M6
70	70	90	83	92	4	80.5	60.0	48.5	2.5	7	9	19.0	5.0	M6
75	75	99	88	97	4	89.0	60.0	48.5	2.5	7	9	19.0	5.5	M8
80	80	104	95	105	4	94.0	60.0	48.5	3.0	7	9	19.0	5.5	M8
85	85	109	100	110	4	99.0	60.0	48.5	3.0	7	9	19.0	5.5	M8
90	90	114	105	115	4	104.0	65.0	52.0	3.0	7	9	20.5	5.5	M8
95	95	119	110	120	4	109.0	65.0	52.0	3.0	7	9	20.5	5.5	M8
100	100	124	115	125	4	114.0	65.0	52.0	3.0	7	9	20.5	5.5	M8

如需了解进一步的信息和有关数据，请与本公司工程技术部联系。
 If you would like to know more information and relevant data, please contact the technology department.



HB6 型机械密封

Type HB6 mechanical seals

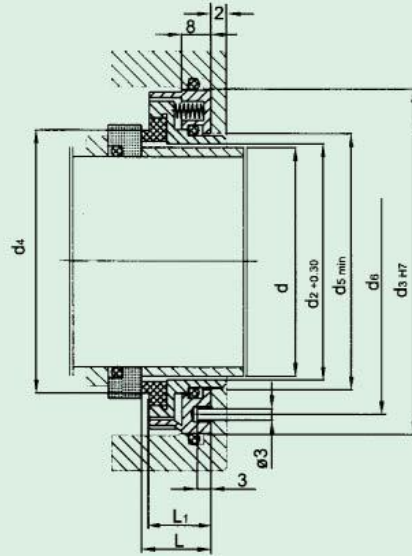

结构特点：

HB6 型机械密封为平衡型、多弹簧、单端面静止式结构，任意旋向，轴向尺寸很短，它能替代骨架油封，根据工况可在许多设备上使用，可以按照运行需要选择非补偿环，使用骨架油封的设备均可采用此型。摩擦副材质与辅助密封材质请根据实际工况选用。

Structure Features:

The mechanical seal of type HB6 is accord with balanced, and multiple-spring, single face structure. It is independent of rotation direction of shaft. Axial length is shorter. It can supersede framed oil sealing. It can be used for much equipment Non-compensation ring can be chosen according to operation condition. It can be used for all equipment with framed oil sealing.

Sub-materials of friction and auxiliary materials should be selected according to operation condition.

适用范围：

- 被密封介质：油、水等弱腐蚀性介质。
- 密封腔压力： $\leq 2.5\text{Mpa}$
- 密封腔温度： $-20^{\circ}\text{C} \sim 180^{\circ}\text{C}$
- 线速度： $\leq 35\text{m/s}$

Available Range:

- Sealed Medium: oil, water and low corrosion agent, etc.
- Pressure in the sealed chamber: $\leq 2.5\text{Mpa}$
- Temperature in the sealed chamber: $-20^{\circ}\text{C} \sim 180^{\circ}\text{C}$
- Linear velocity: $\leq 35\text{m/s}$

HB6 型尺寸表 Dimension Table

公称轴径	d	d ₂	d ₃	d ₄	d ₅	d ₆	L _(±0.5)	L ₁
15	15	16	42	22.6	21	34	17	15.0
18	18	19	45	25.6	24	37	17	15.0
20	20	21	48	27.6	26	40	17	15.0
22	22	23	50	29.6	28	42	17	15.0
25	25	26	52	32.8	31	44	17	15.0
28	28	29	55	35.8	34	47	17	15.0
30	30	31	58	37.8	36	50	17	15.0
32	32	33	60	39.8	38	52	17	15.0
35	35	36	62	42.8	41	54	17	15.0
38	38	39	65	45.9	44	57	17	15.0
40	40	41	68	47.9	46	60	17	15.0
42	42	43	72	49.9	48	64	17	15.0
45	45	46	75	52.9	51	67	17	15.0
48	48	49	80	55.9	54	72	17	15.0
50	50	51	80	58.2	56	72	17	15.0
52	52	53	82	60.2	58	74	17	15.0
55	55	56	85	63.2	61	77	17	15.0
58	58	59	90	66.7	64	82	17	15.0
60	60	61	90	68.7	66	82	17	15.0
65	65	66	95	73.7	71	87	19	16.5
68	68	69	100	76.7	74	92	19	16.5
70	70	71	100	78.7	76	92	19	16.5
75	75	76	108	83.7	81	100	19	16.5
80	80	81	112	88.7	86	104	19	16.5
85	85	86	118	93.7	91	110	19	16.5
90	90	91	122	99.5	96	114	19	16.5
95	95	96	128	104.5	101	120	19	16.5
100	100	101	132	109.5	106	124	19	16.5

如需了解进一步的信息和有关数据，请与本公司工程技术部联系。
 If you would like to know more information and relevant data, please contact the technology department.

HBB6 型机械密封

Type HBB6 mechanical seals

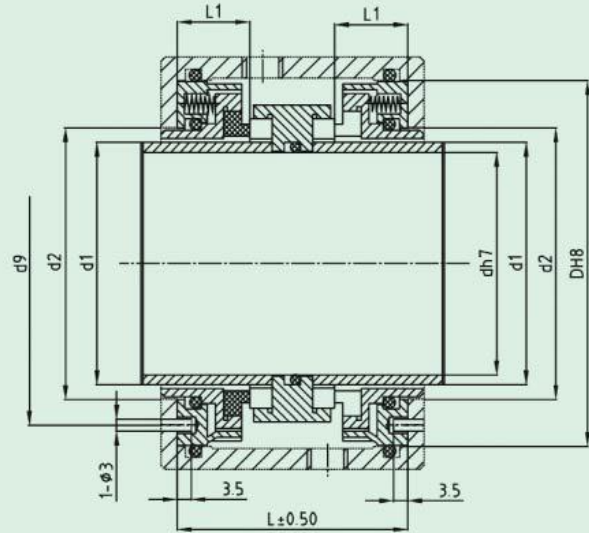

结构特点：

HBB6 型机械密封为内流、多弹簧、双端面、平衡型结构，静止环补偿。适用于易爆易结晶或转速较高的高速泵、压缩机上。摩擦副材质与辅助密封材质请根据实际工况选用。

Structure Features:

The mechanical seal of type HBB6 is accorded to inward leakage, multi-spring, double faces, and balanced structure. Stationary ring compensated, and suitable for mediums of combustible, easily exploded, easily crystallized or high-speed pumps and compressors.

Sub-materials of friction and auxiliary materials should be selected according to operation condition.

适用范围：

- 被密封介质：水、油等一般腐蚀性液体。
- 密封腔压力： $\leq 2.5\text{Mpa}$
- 密封腔温度： $-20^{\circ}\text{C} \sim 100^{\circ}\text{C}$
- 线速度： $\leq 15\text{m/s}$

Available Range:

- Sealed medium: Average corrosive mediums, such as, water, oil etc.
- Pressure in the sealed chamber: $\leq 2.5\text{Mpa}$
- Temperature in the sealed chamber: $-20^{\circ}\text{C} \sim 100^{\circ}\text{C}$
- Linear velocity: $\leq 15\text{m/s}$

HBB6 型尺寸表 Dimension Table

公称轴径	d	d ₁	d ₂	d _{h7}	D	L	L ₁
15	15	20	26	40	48	50	17
20	20	25	31	44	52	50	17
25	25	30	36	50	58	51	17
30	30	35	41	54	62	55	18
35	35	40	46	60	68	55	18
40	40	45	51	67	75	55	18
45	45	50	56	72	80	57	18
50	50	55	61	77	85	57	18
55	55	60	66	82	90	57	18
60	60	65	71	87	95	61	19
65	65	70	76	92	100	61	19
70	70	75	81	100	108	61	19
75	75	80	86	104	112	61	19
80	80	85	91	110	118	62	19
85	85	90	96	114	122	62	19
90	90	95	101	120	128	62	19
95	95	100	106	124	132	62	19

如需了解进一步的信息和有关数据，请与本公司工程技术部联系。
 If you would like to know more information and relevant data, please contact the technology department.



HU7 型机械密封

Type HU7 mechanical seals

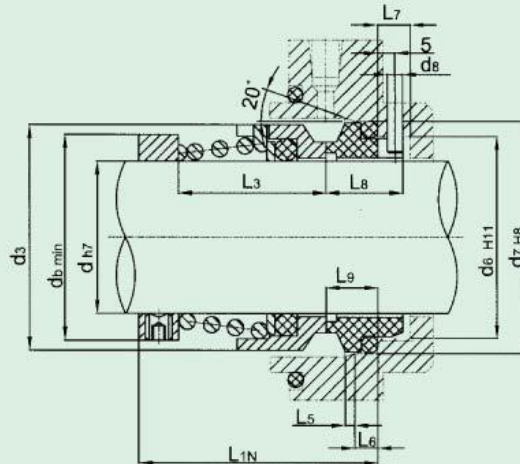

结构特点：

HU7 型机械密封符合 DIN24960 及 GB/T 6556 标准，可替代 108U 型机封，非平衡、圆锥形弹簧结构，弹簧的旋向与轴旋向有关。摩擦副材质与辅助密封材质请根据实际工况选用。

Structure Features:

The mechanical seal of type HU7 is accorded to DIN24960 & GB/T 6556-94, and can replace type 108U Mechanical seals, unbalanced, and conical spring structure. It is dependent of rotation direction of pump shaft.

Sub-materials of friction and auxiliary materials should be selected according to operation condition.

适用范围：

被密封介质：污水泵、潜水泵、化工泵、循环泵、清水泵和加热系统。

- 密封腔压力：≤ 1Mpa
- 密封腔温度：-20℃ ~180℃
- 线速度：≤ 15m/s

Available Range:

- Sealed medium: sewage water pump, diving pump, chemical pump, circulating pump and heating system.
- Pressure in the sealed chamber: ≤ 1Mpa
- Temperature in the sealed chamber: -20℃ ~180℃
- Linear velocity: ≤ 15m/s

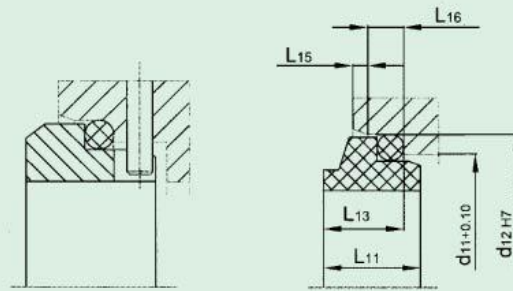

G9 DIN24960

G13

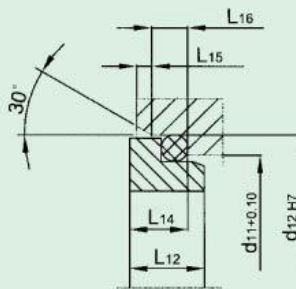

G4

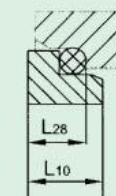

G6 DIN24960

如需了解进一步的信息和有关数据，请与本公司工程技术部联系。
 If you would like to know more information and relevant data, please contact the technology department.

HU7 型机械密封

Type HU7 mechanical seals

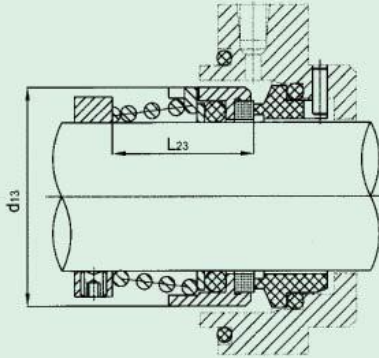

HU77型

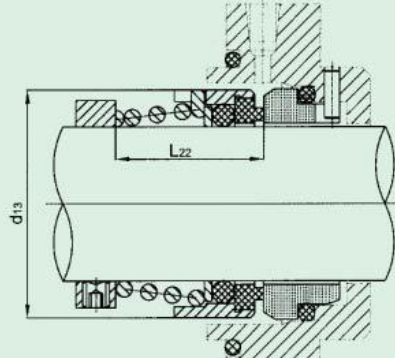

HU72型

HU7 型尺寸表 Dimension Table

公称口径 d	d ₅	d ₆	d ₇	d ₈	d ₁₁	d ₁₂	d ₁₃	d _b	L ₁₄	L ₅	L ₆	L ₇	L ₈	L ₉	L ₁₀	L ₁₁	L ₁₂	L ₁₃	L ₁₄	L ₁₅	L ₁₆	L ₁₇	L ₁₈	L ₁₉	L ₂₀	L ₂₁	L ₂₂	L ₂₃
6"	6"	14	-	-	-	11.5	16.0	16	8	-	-	-	-	-	-	-	9.0	6.5	7.1	5.6	1.2	3.8	11.9	-	-	-	-	-
8"	8"	18	-	-	-	15.5	19.2	18	11	-	-	-	-	-	-	-	9.0	8.0	7.1	7.0	1.2	3.8	16.9	-	-	-	-	-
10"	10"	19	17	21	3	15.5	19.2	20	13	40	15.5	1.5	4	8.5	17.5	10.0	7.5	9.0	7.5	7.1	6.6	1.2	3.8	16.9	-	6.6	-	-
12"	12"	21	19	23	3	17.5	21.6	22	16	40	16.0	1.5	4	8.5	17.5	10.0	7.5	10.0	6.5	7.6	5.6	1.2	3.8	17.4	-	6.6	-	-
14"	14"	23	21	25	3	20.5	24.6	24	18	40	16.5	1.5	4	8.5	17.5	10.0	7.5	10.0	6.5	7.6	5.6	1.2	3.8	17.4	16.5	6.6	-	-
15"	15"	24	-	-	-	20.5	24.6	25	19	-	-	-	-	-	-	-	11.0	7.5	8.6	6.6	1.2	3.8	17.4	-	-	-	-	-
16"	16"	26	23	27	3	22.0	28.0	26	21	40	18.0	1.5	4	8.5	17.5	10.0	7.5	11.5	8.5	9.0	7.5	1.5	5.0	19.5	16.5	6.6	-	-
18"	18"	29	27	33	3	24.0	30.0	31	23	45	19.5	2.0	5	9.0	19.5	11.5	8.5	12.5	9.0	10.0	8.0	1.5	5.0	20.5	18.0	7.5	-	-
20"	20"	31	29	35	3	29.5	35.0	34	26	45	22.0	2.0	5	9.0	19.5	11.5	8.5	12.5	8.5	9.5	7.5	1.5	5.0	22.0	19.0	7.5	-	-
22"	22"	33	31	37	3	29.5	35.0	36	28	45	21.5	2.0	5	9.0	19.5	11.5	8.5	12.5	8.5	9.5	7.5	1.5	5.0	23.5	20.5	7.5	-	-
24"	24"	35	33	39	3	32.0	38.0	38	30	50	23.5	2.0	5	9.0	19.5	11.5	8.5	12.5	8.5	9.5	7.5	1.5	5.0	25.0	22.0	7.5	-	-
25"	25"	36	34	40	3	32.0	38.0	39	31	50	26.5	2.0	5	9.0	19.5	11.5	8.5	12.5	8.5	9.5	7.5	1.5	5.0	26.5	23.5	7.5	-	-
26"	26"	37	-	-	-	34.0	40.0	40	32	-	-	-	-	9.0	-	-	-	13.0	9.0	10.0	8.0	1.5	5.0	26.5	23.5	-	-	-
28"	28"	40	37	43	3	36.0	42.0	42	35	50	26.5	2.0	5	9.0	19.5	11.5	8.5	14.0	10.0	11.0	9.0	1.5	5.0	26.5	24.5	7.5	-	-
30"	30"	43	39	45	3	39.2	45.0	44	37	50	26.5	2.0	5	9.0	19.5	11.5	8.5	14.0	11.5	11.0	10.5	1.5	5.0	25.0	24.5	7.5	-	-
32"	32"	46	42	48	3	42.2	48.0	46	39	55	28.5	2.0	5	9.0	19.5	11.5	8.5	14.0	11.5	11.0	10.5	1.5	5.0	28.5	28.0	7.5	-	-
33"	33"	47	42	48	3	-	-	47	40	55	28.5	2.0	5	9.0	19.5	11.5	8.5	-	12.0	-	-	-	-	-	-	-	7.5	-
35"	35"	49	44	50	3	46.2	52.0	49	43	55	28.5	2.0	5	9.0	19.5	11.5	8.5	14.5	12.0	11.5	11.0	1.5	5.0	28.5	28.0	7.5	-	-
38"	38"	53	49	56	4	49.2	55.0	54	45	55	33.5	2.0	6	9.0	22.0	14.0	10.0	14.5	11.3	11.5	10.3	1.5	5.0	32.2	31.0	9.0	-	-
40"	40"	56	51	58	4	52.2	58.0	56	49	55	36.0	2.0	6	9.0	22.0	14.0	10.0	14.5	11.8	11.5	10.8	1.5	5.0	34.7	34.0	9.0	-	-
42"	42"	59	-	-	-	53.3	62.0	58	52	-	-	-	-	9.0	-	-	-	17.0	13.2	14.3	12.0	2.0	6.0	37.3	35.0	-	-	-
43"	43"	59	54	61	4	-	-	59	52	60	38.5	2.0	6	9.0	22.0	14.0	10.0	-	13.2	-	-	2.0	-	-	-	-	9.0	-
45"	45"	61	56	63	4	55.3	64.0	61	55	60	39.5	2.0	6	9.0	22.0	14.0	10.0	17.0	12.8	14.3	11.6	2.0	6.0	39.2	36.5	9.0	-	-
48"	48"	64	59	66	4	59.7	68.4	64	58	60	46.0	2.0	6	9.0	22.0	14.0	10.0	17.0	12.8	14.3	11.6	2.0	6.0	44.7	42.0	9.0	-	-
50"	50"	66	62	70	4	60.8	69.3	66	61	60	45.0	2.5	6	9.0	23.0	15.0	10.5	17.0	12.8	14.3	11.6	2.0	6.0	45.7	43.0	9.5	-	-
53"	53"	69	65	73	4	-	-	69	64	70	47.0	2.5	6	9.0	23.0	15.0	12.0	-	13.5	-	-	-	-	-	-	11.0	-	-
55"	55"	71	67	75	4	66.5	75.4	71	66	70	49.0	2.5	6	9.0	23.0	15.0	12.0	18.0	14.5	15.3	13.3	2.0	6.0	49.0	47.0	11.0	-	-
58"	58"	76	70	78	4	69.5	78.4	78	69	70	55.0	2.5	6	9.0	23.0	15.0	12.0	18.0	14.5	15.3	13.3	2.0	6.0	52.0	50.0	11.0	-	-
60"	60"	78	72	80	4	71.5	80.4	79	71	70	55.0	2.5	6	9.0	23.0	15.0	12.0	18.0	14.5	15.3	13.3	2.0	6.0	53.0	51.0	11.0	-	-
63"	63"	83	75	83	4	-	-	83	74	70	55.0	2.5	6	9.0	23.0	15.0	12.0	-	14.2	-	-	-	-	-	-	11.0	-	-
65"	65"	84	77	85	4	76.5	85.4	85	77	80	55.0	2.5	6	9.0	23.0	15.0	12.0	18.0	14.2	15.3	13.0	2.0	6.0	54.3	52.0	11.0	-	-
68"	68"	88	81	90	4	82.7	91.5	88	80	80	55.0	2.5	7	9.0	26.0	18.0	12.5	19.0	14.9	16.0	13.7	2.0	6.0	55.3	52.7	11.3	-	-
70"	70"	90	83	92	4	83.0	92.0	90	83	80	57.0	2.5	7	9.0	26.0	18.0	12.5	18.0	14.2	15.3	13.0	2.0	6.0	56.3	54.0	11.3	-	-
75"	75"	98	88	97	4	90.2	99.0	98	88	80	62.0	2.5	7	9.0	26.0	18.0	12.5	18.0	15.2	15.3	14.0	2.0	6.0	56.3	54.0	11.3	-	-
80"	80"	100	95	105	4	95.2	104.0	103	93	90	61.8	3.0	7	9.0	26.2	18.2	13.0	19.0	16.2	16.3	15.0	2.0	6.0	59.3	58.0	12.0	-	-

如需了解进一步的信息和有关数据，请与本公司工程技术部联系。
 If you would like to know more information and relevant data, please contact the technology department.

HB7 型机械密封

Type HB7 mechanical seals

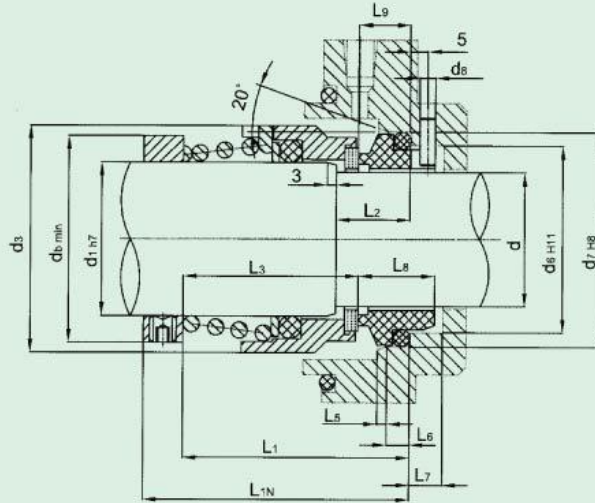

结构特点：

HB7 型机械密封符合 ISO3069、DIN24960 和 GB/T 6556 标准。平衡型、圆锥弹簧、单端面结构。弹簧的旋向与转轴有关。摩擦副材质与辅助密封材质请根据实际工况选用。

Structure Features:

The mechanical seal of type HB7 is accord with ISO3069, DIN24960 & GB/T 6556. Balanced, conical spring, single face structure. It is dependent of rotation direction of pump shaft.

Sub-materials of friction and auxiliary materials should be selected according to operation condition.

适用范围：

- 被密封介质：除强氧化性酸外其他介质的化工泵和水泵行业。
- 密封腔压力： $\leq 2.5\text{Mpa}$
- 密封腔温度： $-20^{\circ}\text{C} \sim 180^{\circ}\text{C}$
- 线速度： $\leq 15\text{m/s}$

Available Range:

- Sealed Medium: the chemical pumps and water pumps other than strong oxygenized acids.
- Pressure in the sealed chamber: $\leq 2.5\text{Mpa}$
- Temperature in the sealed chamber: $-20^{\circ}\text{C} \sim 180^{\circ}\text{C}$
- Linear velocity: $\leq 15\text{m/s}$

HB7 型尺寸表 Dimension Table

公称轴径 d	d ₁	d ₃	d _{6(H1)}	d ₇	d ₈	d _b	L _{1N}	L ₁	L ₂	L ₃	L ₅	L ₆	L ₇	L ₈	L ₉	
10	10	14	24	17	21	3	18	50	35.5	18	25.5	1.5	4	8.5	17.5	10.0
12	12	16	26	19	23	3	21	50	36.5	18	26.5	1.5	4	8.5	17.5	10.0
14	14	18	31	21	25	3	23	55	39.5	18	29.5	1.5	4	8.5	17.5	10.0
16	16	20	34	23	27	3	26	55	41.0	18	31.0	1.5	4	8.5	17.5	10.0
18	18	22	36	27	33	3	28	55	44.0	20	32.5	2.0	5	9.0	19.5	11.5
20	20	24	38	29	35	3	30	60	44.0	20	32.5	2.0	5	9.0	19.5	11.5
22	22	26	40	31	37	3	31	60	44.0	20	32.5	2.0	5	9.0	19.5	11.5
24	24	28	42	33	39	3	35	60	44.0	20	32.5	2.0	5	9.0	19.5	11.5
25	25	30	44	34	40	3	37	60	45.0	20	33.5	2.0	5	9.0	19.5	11.5
28	28	33	47	37	43	3	40	65	47.0	20	35.5	2.0	5	9.0	19.5	11.5
30	30	35	49	39	45	3	43	65	47.0	20	35.5	2.0	5	9.0	19.5	11.5
32	32	38	54	42	48	3	45	65	51.0	20	39.5	2.0	5	9.0	19.5	11.5
33	33	38	54	42	48	3	45	65	51.0	20	39.5	2.0	5	9.0	19.5	11.5
35	35	40	56	44	50	3	49	65	55.0	20	43.5	2.0	5	9.0	19.5	11.5
38	38	43	59	49	56	4	52	75	60.0	23	46.0	2.0	6	9.0	22.0	14.0
40	40	45	61	51	58	4	55	75	62.0	23	48.0	2.0	6	9.0	22.0	14.0
43	43	48	64	54	61	4	58	75	65.0	23	51.0	2.0	6	9.0	22.0	14.0
45	45	50	66	56	63	4	61	75	69.0	23	55.0	2.0	6	9.0	22.0	14.0
48	48	53	69	59	66	4	64	85	69.0	23	55.0	2.0	6	9.0	22.0	14.0
50	50	55	71	62	70	4	66	85	73.0	25	58.0	2.5	6	9.0	23.0	15.0
53	53	58	78	65	73	4	69	85	75.0	25	60.0	2.5	6	9.0	23.0	15.0
55	55	60	79	67	75	4	71	85	75.0	25	60.0	2.5	6	9.0	23.0	15.0
58	58	63	83	70	78	4	74	85	75.0	25	60.0	2.5	6	9.0	23.0	15.0
60	60	65	85	72	80	4	77	95	75.0	25	60.0	2.5	6	9.0	23.0	15.0
63	63	68	88	75	83	4	80	95	75.0	25	60.0	2.5	6	9.0	23.0	15.0
65	65	70	90	77	85	4	83	95	76.0	25	61.0	2.5	6	9.0	23.0	15.0
70	70	75	98	83	92	4	88	95	81.0	28	63.0	2.5	7	9.0	26.0	18.0
75	75	80	103	88	97	4	93	105	86.0	28	68.0	2.5	7	9.0	26.0	18.0
80	80	85	109	95	105	4	98	105	86.0	28	68.0	3.0	7	9.0	26.2	18.2

如需了解进一步的信息和有关数据，请与本公司工程技术部联系。
 If you would like to know more information and relevant data, please contact the technology department.



HU9 型机械密封

Type HU9 mechanical seals

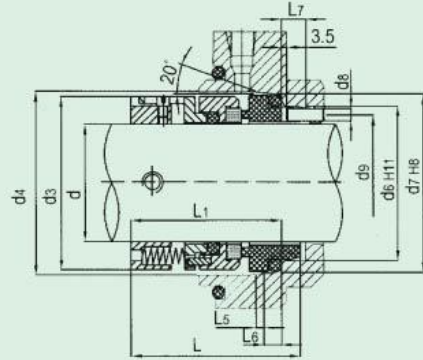

HU9 型尺寸表 Dimension Table

公称轴径	d	d3	d4(min)	d6(H1)	d7(H8)	d8(H8)	d9	L(±0.5)	L1(±0.5)	L5	L6	L7
18	18	32	34	27	33	3	23	44.5	37.5	2	5	9
20	20	34	36	29	35	3	25	44.5	37.5	2	5	9
22	22	36	38	31	37	3	27	44.5	37.5	2	5	9
24	24	38	40	33	39	3	29	45	38	2	5	9
25	25	39	41	34	40	3	30	45	38	2	5	9
28	28	42	44	37	43	3	33	47	40	2	5	9
30	30	44	46	39	45	3	35	47	40	2	5	9
32	32	46	48	42	48	3	38	48.5	41.5	2	5	9
33	33	47	49	42	48	3	38	48.5	41.5	2	5	9
35	35	49	51	44	50	3	40	48.5	41.5	2	5	9
38	38	54	58	49	56	4	44	52	45	2	6	9
40	40	56	60	51	58	4	46	52	45	2	6	9
43	43	59	63	54	61	4	49	52	45	2	6	9
45	45	61	65	56	63	4	51	52	45	2	6	9
48	48	64	68	59	66	4	54	52	45	2	6	9
50	50	66	70	62	70	4	57	53.5	46.5	2.5	6	9
53	53	69	73	65	73	4	60	53.5	46.5	2.5	6	9
55	55	71	75	67	75	4	62	54.5	47.5	2.5	6	9
58	58	78	83	70	78	4	65	57.5	50.5	2.5	6.5	9
60	60	80	85	72	80	4	67	57.5	50.5	2.5	6.5	9
63	63	83	88	75	83	4	70	59.5	52.5	2.5	6.5	9
65	65	85	90	77	85	4	72	59.5	52.5	2.5	6.5	9
68	68	88	93	81	90	4	75	59.5	52.5	2.5	7	9
70	70	90	95	83	92	4	77	62.5	55.5	2.5	7	9
75	75	98	104	88	97	4	82	65.5	58.5	2.5	7	9
80	80	103	109	95	105	4	88	67	60	3	7	9
85	85	108	114	100	110	4	93	67	60	3	7	9
90	90	113	119	105	115	4	98	67	60	3	7	9
95	95	118	124	110	120	4	103	68	61	3	7	9
100	100	123	129	115	125	4	108	69	62	3	7	9
105	105	128	139	120	130	4	113	70	63	3	7	9
110	110	135	144	125	136	4	118	71	64	3	8	9
115	115	140	149	130	141	4	123	71	64	3	8	9
120	120	145	154	135	146	4	128	71	64	3	8	9
125	125	151	159	141	152	5	134	74.5	66	3	10	10.5
130	130	159	165	146	158	5	139	82	73.5	3	10	10.5
135	135	164	170	151	163	5	144	82	73.5	3	10	10.5
140	140	171	180	161	173	5	152	83	74.5	3	10	10.5
145	145	176	185	166	178	5	157	84	75.5	3	10	10.5
150	150	181	190	171	183	5	162	84	75.5	3	10	10.5
155	155	186	195	176	188	6	167	90	80.5	3	12	11.5
160	160	193	200	181	193	6	172	90	80.5	3	12	11.5
165	165	198	205	186	198	6	177	90	80.5	3	12	11.5
170	170	206	215	191	203	6	182	90	80.5	3	12	11.5
175	175	211	220	201	213	6	190	92	82.5	3	12	11.5
180	180	216	225	206	218	6	195	92	82.5	3	12	11.5
185	185	221	230	211	223	6	200	92	82.5	3	12	11.5
190	190	226	235	216	228	6	205	92	82.5	3	12	11.5
195	195	232	240	221	233	6	210	92	82.5	3	12	11.5
200	200	240	250	226	238	6	215	92	82.5	3	12	11.5

结构特点：

HU9 型机械密封符合 ISO3069、DN24960 和 GB/T 6556 标准。通用性强、多弹簧、离合器式传动、端面受压均匀，非平衡型结构。摩擦副材质与辅助密封材质可根据实际工况选用。

Structure Features:

The mechanical seal of type HU9 is accorded to ISO3069, DIN24960 GB/T6556, with strong generality, Multiple-spring & clutch type driving, the seal under uniform pressure, unbalanced structure.

Sub-materials of friction and auxiliary materials should be selected according to operation condition.

适用范围：

- 被密封介质：油、水、非结晶性酸、碱、盐、有机溶剂体等。
- 密封腔压力：≤ 1Mpa
- 密封腔温度：-20℃ ~220℃
- 线速度：≤ 15m/s

Available Range:

- Sealed medium: oil, water, non-crystallizing acid, alkali, salt, and organic liquid, etc.
- Pressure in the sealed chamber: ≤ 1Mpa
- Temperature in the sealed chamber: -20℃ ~220℃
- Linear velocity: ≤ 15m/s

如需了解进一步的信息和有关数据，请与本公司工程技术部联系。
 If you would like to know more information and relevant data, please contact the technology department.

HB9 型机械密封

Type HB9 mechanical seals

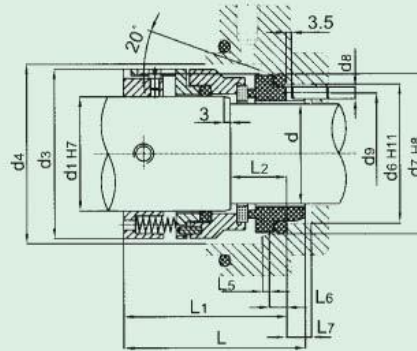

HB9 型尺寸表 Dimension Table

公称轴径	d	d _{1(H7)}	d ₃	d _{4(MH)}	d _{6(H1)}	d _{7(H8)}	d _{8(H8)}	d ₉	L _{1(+0.5)}	L _{11(+0.5)}	L ₂	L ₅	L ₆	L ₇
14	14	18	32	34	21	25	3	18	49	42.5	18	1.5	4	8.5
16	16	20	34	36	23	27	3	20	49	42.5	18	1.5	4	8.5
18	18	22	36	38	27	33	3	23	51.5	44.5	20	2	5	9
20	20	24	38	40	29	35	3	25	52	45	20	2	5	9
22	22	26	40	42	31	37	3	27	52	45	20	2	5	9
24	24	28	42	44	33	39	3	29	54.5	47.5	20	2	5	9
25	25	30	44	46	34	40	3	30	54.5	47.5	20	2	5	9
28	28	33	47	49	37	43	3	33	56.5	49.5	20	2	5	9
30	30	35	49	51	39	45	3	35	56.5	49.5	20	2	5	9
32	32	38	54	58	42	48	3	38	57	50	20	2	5	9
33	33	38	54	58	42	48	3	38	57	50	20	2	5	9
35	35	40	56	60	44	50	3	40	57	50	20	2	5	9
38	38	43	59	63	49	56	4	44	59.5	52.5	23	2	6	9
40	40	45	61	65	51	58	4	46	59.5	52.5	23	2	6	9
43	43	48	64	68	54	61	4	49	59.5	52.5	23	2	6	9
45	45	50	66	70	56	63	4	51	59.5	52.5	23	2	6	9
48	48	53	69	73	59	66	4	54	59.5	52.5	23	2	6	9
50	50	55	71	75	62	70	4	57	62.5	55.5	25	2.5	6	9
53	53	58	78	83	65	73	4	60	64.5	57.5	25	2.5	6	9
55	55	60	80	85	67	75	4	62	64.5	57.5	25	2.5	6	9
58	58	63	83	88	70	78	4	65	67.5	60.5	25	2.5	6.5	9
60	60	65	85	90	72	80	4	67	67.5	60.5	25	2.5	6.5	9
63	63	68	88	93	75	83	4	70	67.5	60.5	25	2.5	6.5	9
65	65	70	90	95	77	85	4	72	69	62	25	2.5	6.5	9
70	70	75	98	104	83	92	4	77	75.5	68.5	28	2.5	7	9
75	75	80	103	109	88	97	4	82	75.5	68.5	28	2.5	7	9
80	80	85	108	114	95	105	4	88	77	70	28	3	7	9
85	85	90	113	119	100	110	4	93	77	70	28	3	7	9
90	90	95	118	124	105	115	4	98	77	70	28	3	7	9
95	95	100	123	129	110	120	4	103	77.5	70.5	28	3	7	9
100	100	105	128	139	115	125	4	108	77.5	70.5	28	3	7	9
105	105	110	135	144	120	130	4	113	78.5	71.5	28	3	7	9
110	110	115	140	149	125	136	4	118	79.5	72.5	28	3	8	9
115	115	120	145	154	130	141	4	123	79.5	72.5	28	3	8	9
120	120	125	151	159	135	146	4	128	79.5	72.5	28	3	8	9
125	125	130	159	165	141	152	5	134	90.5	82	33	3	10	10.5
130	130	135	164	170	146	158	5	139	90.5	82	33	3	10	10.5
135	135	140	171	180	151	163	5	144	90.5	82	33	3	10	10.5
140	140	150	181	190	161	173	5	152	93	84.5	35	3	10	10.5
145	145	155	186	195	166	178	5	157	93	84.5	35	3	10	10.5
150	150	160	193	200	171	183	5	162	93	84.5	35	3	10	10.5
155	155	165	198	205	176	188	6	167	98	88.5	38	3	12	11.5
160	160	170	206	215	181	193	6	172	98	88.5	38	3	12	11.5
165	165	175	211	220	186	198	6	177	98	88.5	38	3	12	11.5
170	170	180	216	225	191	203	6	182	98	88.5	38	3	12	11.5
175	175	185	221	230	201	213	6	190	100.5	91	40	3	12	11.5
180	180	190	226	235	206	218	6	195	100.5	91	40	3	12	11.5
185	185	195	232	240	211	223	6	200	100.5	91	40	3	12	11.5
190	190	200	240	250	216	228	6	205	100.5	91	40	3	12	11.5
195	195	205	245	255	221	233	6	210	100.5	91	40	3	12	11.5
200	200	210	250	260	226	238	6	215	100.5	91	40	3	12	11.5

结构特点：

HB9 型机械密封符合 ISO3069、DIN24960 和 GB/T 6556 标准。通用性强、多弹簧、离台器式传动，端面受压均匀，平衡型结构。

摩擦副材质与辅助密封材质请根据实际工况选用。

Structure Features:

The mechanical seal of type HB9 is accord with ISO3069, DIN24960, GB/T 6556, with strong generality, Multiple-spring & clutch type driving the seal under uniform pressure balanced structure

Sub-materials of friction and auxiliary materials should be selected according to operation condition.

适用范围：

被密封介质：油、水、非结晶性酸、碱、盐、有机溶剂等。

密封腔压力：≤ 4Mpa

密封腔温度：-20℃ ~180℃

线速度：≤ 15m/s

Available Range:

Sealed medium., oil, water, non-crystallizing acid, alkali, salt, and organic solvent, etc.

Pressure in the sealed chamber: ≤ 4Mpa

Temperature in the sealed chamber: -20℃ ~180℃

Linear velocity: ≤ 15m/s

如需了解进一步的信息和有关数据，请与本公司工程技术部联系。
 If you would like to know more information and relevant data, please contact the technology department.

HU10 型机械密封

Type HU10 mechanical seals

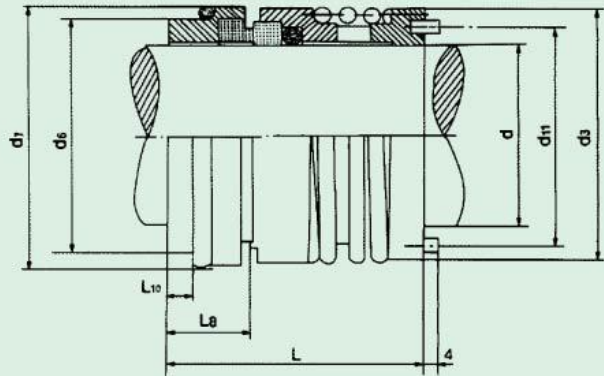
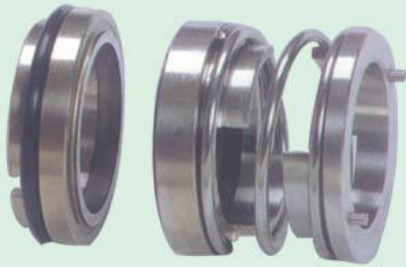

结构特点：

HU10 型机械密封符合 DIN24960 标准。为单端面、单弹簧、非平衡型结构，拨叉传动。弹簧座直接靠二销钉与叶轮相连，弹簧旋向与转轴无关，轴向尺寸短。

摩擦副材质与辅助密封材质请根据实际工况选用。

Structure Features:

The mechanical seal of type HUI0 is accord with DIN24960, single face single spring, and unbalanced structure~ by means of shifting fork drive Spring base are contact with impeller by means of two pins, it is independent of rotation direction of pump shaft, axial length is shorter.

Sub-materials of friction and auxiliary materials should be selected according to operation condition.

适用范围：

被密封介质：油、水、污水、弱酸、弱碱等可溶性溶剂。

密封腔压力： $\leq 1\text{Mpa}$

密封腔温度： $-20^{\circ}\text{C} \sim 180^{\circ}\text{C}$

线速度： $\leq 10\text{m/s}$

Available Range:

Sealed medium: oil, water, sewage water, low acid, low alkali, and dissolubility solvent, etc.

Pressure in the sealed chamber: $\leq 1\text{Mpa}$

Temperature in the sealed chamber: $-20^{\circ}\text{C} \sim 180^{\circ}\text{C}$

Linear velocity: $\leq 10\text{m/s}$

HU10 型尺寸表 Dimension Table

公称轴径	$d_{(H8)}$	d_s	$d_{6(H11)}$	$d_{7(H8)}$	d_{11}	L	L_8	L_{10}
25	25	39	34	40	32	37	14	5
30	30	44	39	45	37	40	15	5
35	35	49	44	50	42	45	15	5
40	40	57	51	58	48.5	50	18	5
45	45	62	56	63	53.5	50	18	5
50	50	69	62	70	58.5	55	18	6
55	55	73	67	75	64.5	55	18	6
60	60	79	72	80	70	65	19	6
65	65	84	77	85	74.5	65	19	6

如需了解进一步的信息和有关数据，请与本公司工程技术部联系。
 If you would like to know more information and relevant data, please contact the technology department.

HU14 型机械密封

Type HU14 mechanical seals

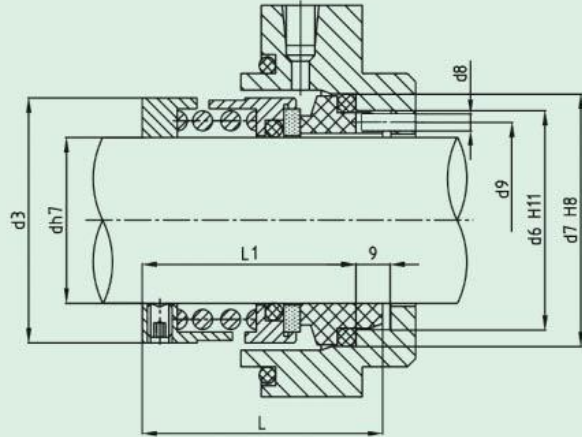

结构特点：

HU14 型机械密封符合 ISO3069、DIN24960 和 GB/T 6556 标准。单弹簧、拨叉传动、非平衡型，抗堵塞能力强，弹簧旋向与转轴旋向无关。

摩擦副材质与辅助密封材质请根据实际工况选用。

Structure Features:

The mechanical seal of type HU14 is accord with ISO3069, DIN24960, GB/T 6556, single spring, unbalanced, by means of shifting fork drive, has a stronger anti-blocking condition, It is independent of rotation direction of pump shaft.

Sub-materials of friction and auxiliary materials should be selected according to operation condtion.

适用范围：

被密封介质：水、油类、酸、碱等弱腐蚀性化工介质。

密封腔压力： $\leq 1\text{Mpa}$

密封腔温度： $-50^{\circ}\text{C} \sim 150^{\circ}\text{C}$

线速度： $\leq 15\text{m/s}$

Available Range:

Sealed medium: water, oil, acid, alkali, low corrosive chemical mediums etc.

Pressure in the sealed chamber: $\leq 1\text{Mpa}$

Temperature in the sealed chamber: $-50^{\circ}\text{C} \sim 150^{\circ}\text{C}$

Linear velocity: $\leq 15\text{m/s}$

HU14 型尺寸表 Dimension Table

公称轴径	d	d ₃	d _{6(H11)}	d _{7(H8)}	d ₈	d ₉	L	L ₁
20	20	34	29	35	3	25	52	45
22	22	36	31	37	3	27	52	45
24	24	38	33	39	3	29	57	50
25	25	39	34	40	3	30	57	50
28	28	42	37	43	3	33	57	50
30	30	44	39	45	3	35	57	50
32	32	46	42	48	3	38	62	55
33	33	47	42	48	3	38	62	55
35	35	49	44	50	3	40	62	55
38	38	54	49	56	4	44	62	55
40	40	56	51	58	4	46	62	55
43	43	59	54	61	4	49	67	60
45	45	61	56	63	4	51	67	60
48	48	64	59	66	4	54	67	60
50	50	66	62	70	4	57	72	65
53	53	69	65	73	4	60	72	65
55	55	71	67	75	4	62	77	70
58	58	78	70	78	4	65	77	70
60	60	80	72	80	4	67	82	75
63	63	83	75	83	4	70	82	75
65	65	85	77	85	4	72	82	75
68	68	88	81	90	4	75	87	80
70	70	90	83	92	4	77	87	80
75	75	99	88	97	4	82	87	80
80	80	104	95	105	4	88	97	90
85	85	109	100	110	4	93	97	90
90	90	114	105	115	4	98	97	90
95	95	119	110	120	4	103	97	90
100	100	124	115	125	4	108	105	98
105	105	129	120	130	4	113	105	98
110	110	138	125	136	4	118	105	98
115	115	143	130	141	4	123	105	98
120	120	148	135	146	4	128	105	98

如需了解进一步的信息和有关数据，请与本公司工程技术部联系。
 If you would like to know more information and relevant data, please contact the technology department.

HUD9 型机械密封

Type HUD9 mechanical seals

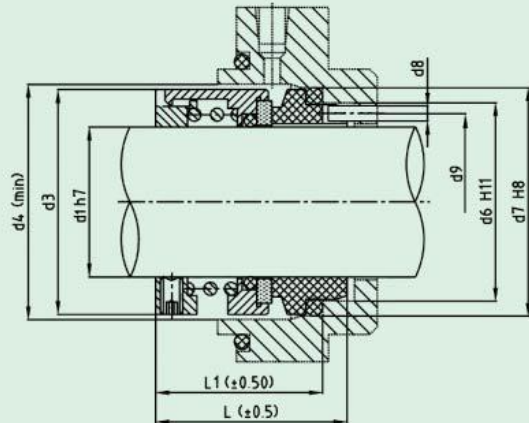

结构特点：

HUD9 型机械密封符合 ISO3069, DIN24960 和 GB/T6556 标准。离合器式传动, 端面受压均匀, 非平衡单弹簧结构。辅助密封橡胶“O”形圈, 本型除提供 DIN24960 标准尺寸的静止环外, 还可提供 105 型等其他流行型式的静止环。

摩擦副材质与辅助密封材质可根据实际工况选用。

Structure Features:

The mechanical seal of type HUD9 is accorded to ISO 3069, DIN 24960 and GB/T6556 with strong generality, clutch type driving, the seal under uniform pressure, Single spring, unbalanced structure. Auxiliary Sealing rubber "O" ring, besides providing the stationary ring according to DIN24960, this model also accepts the stationary ring of 105 and other popular patterns.

Sub-materials of friction and auxiliary materials should be selected according to operation condition.

适用范围：

被密封介质: 油、水、非结晶, 性酸、碱、盐、有机溶剂等。

密封腔压力: $\leq 1\text{Mpa}$

密封腔温度: $-20^{\circ}\text{C} \sim 150^{\circ}\text{C}$

线速度: $\leq 15\text{m/s}$

Available Range:

Sealed Medium: Oil, water, non-crystallizeacid, alkali, salt, and organic solvent, etc.

Pressure in the sealed chamber: $\leq 1\text{Mpa}$

Temperature in the sealed chamber: $-20^{\circ}\text{C} \sim 150^{\circ}\text{C}$

Linear velocity: $\leq 15\text{m/s}$

HUD9 型尺寸表 Dimension Table

公称轴径	d ₁	d ₃	d ₄ (mm)	d ₆ (H11)	d ₇ (H8)	d ₈	d ₉	L ₁ (±0.5)	L ₂ (±0.5)
18	18	32	34	27	33	3	23	44.5	37.5
20	20	34	36	29	35	3	25	44.5	37.5
22	22	36	38	31	37	3	27	44.5	37.5
24	24	38	40	33	39	3	29	45	38
25	25	39	41	34	40	3	30	45	38
28	28	42	44	37	43	3	33	47	40
30	30	44	46	39	45	3	35	47	40
32	32	46	48	42	48	3	38	48.5	41.5
33	33	47	49	42	48	3	38	48.5	41.5
35	35	49	51	44	50	3	40	48.5	41.5
38	38	54	58	49	56	4	44	52	45
40	40	56	60	51	58	4	46	52	45
43	43	59	63	54	61	4	49	52	45
45	45	61	65	56	63	4	51	52	45
48	48	64	68	59	66	4	54	52	45
50	50	66	70	62	70	4	57	53.5	46.5
53	53	69	73	65	73	4	60	53.5	46.5
55	55	71	75	67	75	4	62	54.5	47.5
58	58	78	83	70	78	4	65	57.5	50.5
60	60	80	85	72	80	4	67	57.5	50.5
63	63	83	88	75	83	4	70	59.5	52.5
65	65	85	90	77	85	4	72	59.5	52.5
68	68	88	93	81	90	4	75	59.5	52.5
70	70	90	95	83	92	4	77	62.5	55.5
75	75	98	104	88	97	4	82	65.5	58.5
80	80	103	109	95	105	4	88	67	60

如需了解进一步的信息和有关数据, 请与本公司工程技术部联系。
 If you would like to know more information and relevant data, please contact the technology department.

HQU8 型机械密封

Type HQU8 mechanical seals

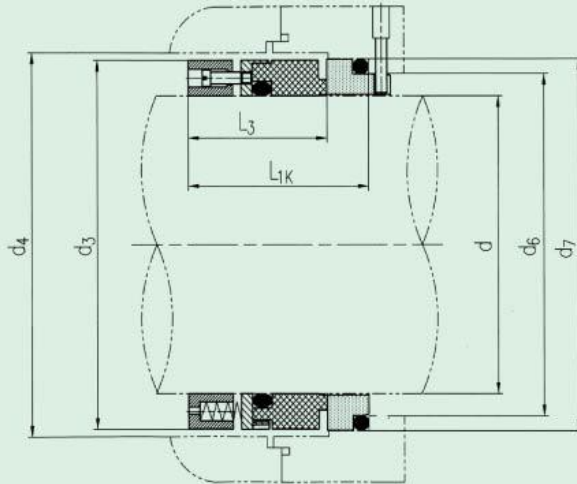

结构特点：

为单端面非平衡型多弹簧密封结构，辅助密封为橡胶 O 型圈，结构简单可靠，为通用型密封，适合密封中性或弱腐蚀介质如油、水等。

Structure Features:

It is a single face, un-balanced and multi-spring mechanical seal, the auxiliary seals is rubber o ring, its structure is simple and reliable. It is the general type mechanical seal and suit to the neutral medium and weak corrosive medium, like oil, water.

适用范围：

- 温度：-40~ 200℃
- 压力：≤ 1MPa
- 转速：≤ 3000r/min

Available Range:

- Temperature: -40~200℃
- Pressure: ≤ 1MPa
- Speed: ≤ 3000r/min

如需了解进一步的信息和有关数据，请与本公司工程技术部联系。
 If you would like to know more information and relevant data, please contact the technology department.

HQU8 型尺寸表 Dimension Table

规格	尺寸		d	d ₃	d ₄	d ₆	d ₇	L _{1K}	L ₃
	公差	h6							
HQU8-014	14	24	26	21	25	35	25		
HQU8-016	16	26	28	23	27	35	25		
HQU8-018	18	32	34	27	33	37.5	25.5		
HQU8-020	20	34	36	29	35	37.5	25.5		
HQU8-022	22	36	38	31	37	37.5	25.5		
HQU8-024	24	38	40	33	39	40	28		
HQU8-025	25	39	41	34	40	40	28		
HQU8-028	28	42	44	37	43	42.5	30.5		
HQU8-030	30	44	46	39	45	42.5	30.5		
HQU8-032	32	46	48	42	48	42.5	30.5		
HQU8-033	33	47	49	42	48	42.5	30.5		
HQU8-035	35	49	51	44	50	42.5	30.5		
HQU8-038	38	54	58	49	56	45	32		
HQU8-040	40	56	60	51	58	45	32		
HQU8-043	43	59	63	54	61	45	32		
HQU8-045	45	61	65	56	63	45	32		
HQU8-048	48	64	68	59	66	45	32		
HQU8-050	50	66	70	62	70	47.5	34		
HQU8-053	53	69	73	65	73	47.5	34		
HQU8-055	55	71	75	67	75	47.5	34		
HQU8-058	58	78	83	70	78	52.5	39		
HQU8-060	60	80	85	72	80	52.5	39		
HQU8-063	63	83	88	75	83	52.5	39		
HQU8-065	65	85	90	77	85	52.5	39		
HQU8-068	68	88	93	81	90	52.5	39		
HQU8-070	70	90	95	83	92	60	45.5		
HQU8-075	75	99	104	88	97	60	45.5		
HQU8-080	80	104	109	95	105	60	45		
HQU8-085	85	109	114	100	110	60	45		
HQU8-090	90	114	119	105	115	65	50		
HQU8-095	95	119	124	110	120	65	50		
HQU8-100	100	124	129	115	125	65	50		

HQB8 型机械密封

Type HQC8B mechanical seals

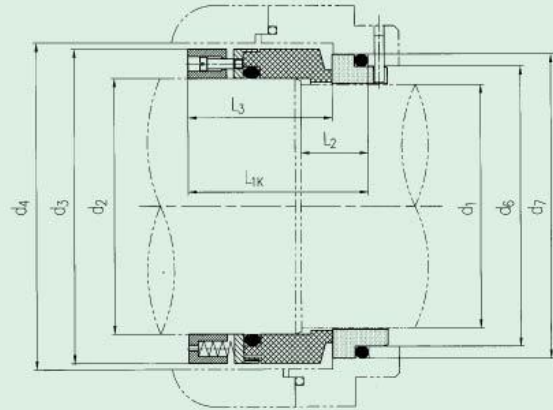

结构特点：

为单端面平衡型多弹簧密封结构，辅助密封为橡胶 O 型圈，结构简单可靠，它是 HQU8 的平衡型结构，可适用于更高的压力，也是通用型密封，适合密封中性或弱腐蚀性介质，如油，水等。

Structure Features:

It is a single face, balanced and multi-spring mechanical seal, the auxiliary seals is rubber o ring, its structure is simple and reliable. It is the balanced structure of HQU8 and suit more higher pressure. It is also the general type mechanical seal and suit to the neutral medium and weak corrosive medium, like oil, water.

适用范围：

- 温度：-40~ 200℃
- 压力：≤ 3MPa
- 转速：≤ 3000r/min

Available Range:

- Temperature: -40~200℃
- Pressure: ≤ 3MPa
- Speed: ≤ 3000r/min

如需了解进一步的信息和有关数据，请与本公司工程技术部联系。
 If you would like to know more information and relevant data, please contact the technology department.

HQB8 型尺寸表 Dimension Table

规格	尺寸		d ₁	d ₂	d ₃	d ₄	d ₅	d ₆	d ₇	L _{1K}	L ₂	L ₃
	公差			h ₉			H11	H8				
HQB8-014	14	18	32	34	21	25	42.5	18	32.5			
HQB8-016	16	20	34	38	23	27	42.5	18	32.5			
HQB8-018	18	22	36	38	27	33	45	20	33			
HQB8-020	20	24	38	40	29	35	45	20	33			
HQB8-022	22	26	40	42	31	37	45	20	33			
HQB8-024	24	28	42	44	33	39	47.5	20	35.5			
HQB8-025	25	30	44	46	34	40	47.5	20	35.5			
HQB8-028	28	33	47	49	37	43	50	20	38			
HQB8-030	30	35	49	51	39	45	50	20	38			
HQB8-032	32	38	54	58	42	48	50	20	38			
HQB8-033	33	38	54	58	42	48	50	20	38			
HQB8-035	35	40	56	61	44	50	50	20	38			
HQB8-038	38	43	59	63	49	56	52.5	23	39.5			
HQB8-040	40	45	61	65	51	58	52.5	23	39.5			
HQB8-043	43	48	64	68	54	61	52.5	23	39.5			
HQB8-045	45	50	66	70	56	63	52.5	23	39.5			
HQB8-048	48	53	69	73	59	66	52.5	23	39.5			
HQB8-050	50	55	71	75	62	70	57.5	25	44			
HQB8-053	53	58	78	83	65	73	57.5	25	44			
HQB8-055	55	60	80	85	67	75	57.5	25	44			
HQB8-058	58	63	83	88	70	78	62.5	25	49			
HQB8-060	60	65	85	90	72	80	62.5	25	49			
HQB8-063	63	68	88	93	75	83	62.5	25	49			
HQB8-065	65	70	90	95	77	85	62.5	25	49			
HQB8-070	70	75	99	104	83	92	70	28	55.5			
HQB8-075	75	80	104	109	88	91	70	28	55.5			
HQB8-080	80	85	109	114	95	105	70	28	55			
HQB8-085	85	90	114	119	100	110	75	28	60			
HQB8-090	90	95	119	124	105	115	75	28	60			
HQB8-095	95	100	124	129	110	120	75	28	60			
HQB8-100	100	105	129	134	115	125	75	28	60			



HQTM-A/B-1 型机械密封

Type HQTM-A/B-1 mechanical seals

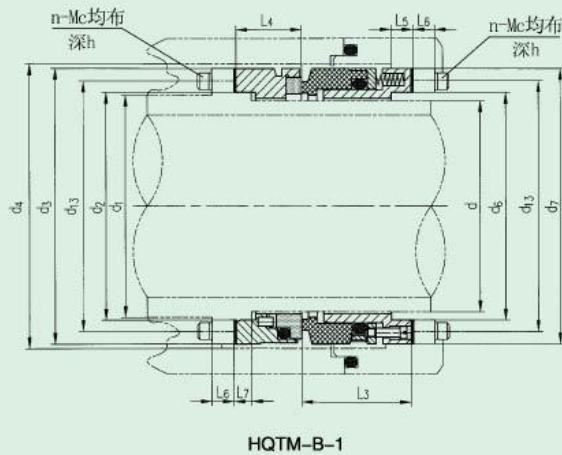
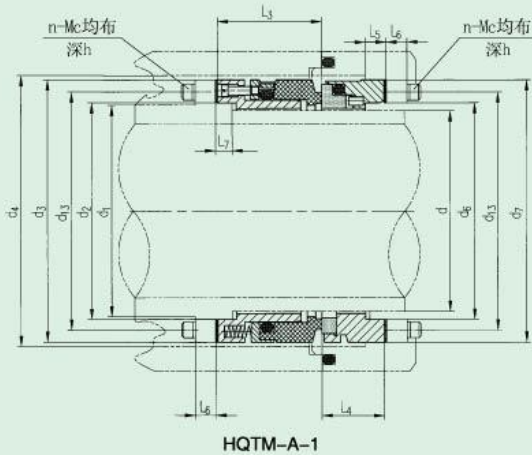

结构特点：

为单端面平衡型多弹簧密封结构辅助密封为橡胶 O 型圈，HQTM-A-1 为旋转式，HQTM-B-1 为静止式，HQTM-A-1 和 HQTM-B-1 所有零件完全互换，即 HQTM-A-1 型密封只要改变安装方式即可变成 HQTM-B-1 静止式。另外它的非补偿环也有两种结构形式，一种是镶嵌式，另一种是整体式，用户增加了一个选择的方式。它与 HQBM-A/B-1 型密封可以整套互换。

Structure Features:

It is a single face, balanced and multi-spring mechanical seal, the auxiliary seals is rubber o ring, HQTM-A-1 is a rotation type mechanical seal and HQTM-B-1 is static type. The components of them can be entirely exchanged. that is, if change the way of mounting of HQTM-A-1, it can be turned into HQTM-B-1. Furthermore there are two kinds of its un-compensated ring: the inlaying ring and the integrated ring. The customers have more choices. It can be exchanged by HQTM-A/B-1 by the whole set. It does not work at the situation of negative pressure and exharstion.

适用范围：

- 温度：-40~ 200℃
- 压力：≤ 4MPa 不适合负压及抽空状态下工作
- 转速：≤ 3000r/min

Available Range:

- Temperature: -40~200℃
- Pressure: ≤ 4MPa
- Speed: ≤ 3000r/min

HQTM-A/B-1 型尺寸表 Dimension Table

尺寸公差	d	d ₁	d ₂	d ₃	d ₄	d ₆	d ₇	d ₁₈	L ₃	L ₄	L ₅	L ₆	L ₇	n	M	h
规格	H8/e8			H8/M7 ±0.1												
30	27	30	32.5	47	49	32.2	47	40	30	18	5	6	5	8	4	6
35	31.5	35	36	51	53	35.7	51	44	30	20	5	6	5	8	4	6
40	37	40	41.5	62	65	41.2	62	52	40	25	5	8	6	6	6	8
45	41.5	45	49.5	67	70	46.2	67	56	45	25	5	8	6	6	6	8
50	46.5	50	51.5	72	75	51.2	72	62	45	25	5	8	6	6	6	8
55	51.5	55	56.5	78	80	56.2	78	67	45	30	5	8	6	6	6	8
60	53	60	61	83	85	60.7	83	72	45	30	5	8	6	6	6	8
65	58.5	65	66	88	90	67.5	88	76	45	30	5	10	6	6	6	10
70	67	70	72.5	97	100	72.2	97	84	50	30	8	10	6	6	6	10
75	73	75	77.5	98	100	77.2	98	88	50	30	8	10	6	6	6	10
80	73.5	80	79.5	103	105	79.2	103	91	50	30	8	10	6	6	6	10
85	78	85	85.5	108	110	85.2	108	97	50	30	8	10	6	6	6	10
90	86	90	92.5	115	118	92.2	115	103	50	30	10	10	6	6	6	10
95	90	95	97.5	121	124	97.2	121	110	50	30	10	10	8	8	6	10
100	95	100	102.5	124	128	102.2	124	113	50	30	10	10	8	8	6	10

如需了解进一步的信息和有关数据，请与本公司工程技术部联系。
 If you would like to know more information and relevant data, please contact the technology department.

HQ58U、HQ59U 型机械密封

Type 58U、59U mechanical seals

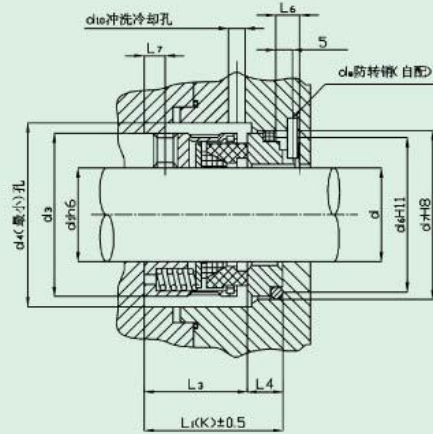
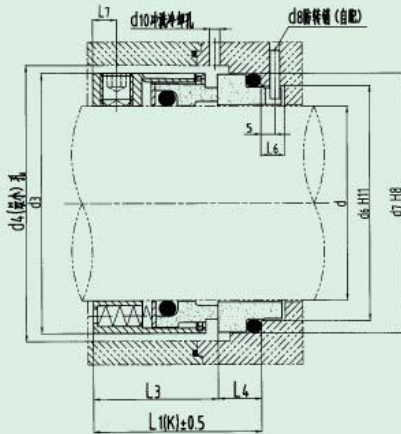

结构特点：

HQ59U 型泵用机械密封采用由聚四氟乙烯制作的楔形环作动静环辅助密封圈。58U 型机械密封采用橡胶“O”形圈作动、静环辅助密封圈。符合 ISO3069、DIN24960 及 GB/T 6556 标准。也符合美国石油学会标准 API610。是单端面、多弹簧非平衡型结构，轴向尺寸小，结构紧凑，广泛用于泵类、釜类、压缩机等类似设备的旋转轴的密封。

摩擦副材质、辅助密封材质请根据实际工况选用。

Structure Features:

The mechanical seal of type HQ59U is accord with ISO3069, DIN24960, and GB/T 6556, also API610 of USA, PTFE or flexible carbon for making wedgy ring, single face, multi-spring, balanced structure, the axial length is shorter, the structure is compact. Be suitable for rotating shaft seals in the equipment, such as, pumps, reaction cauldrons and compressor s etc.

Sub-materials of friction and auxilliary materials should be selected according to operation condition.

适用范围：

被密封介质：油、水、有机溶剂及其它弱腐蚀性溶液。

密封腔压力：≤ 1.6Mpa

密封腔温度：-50℃ ~220℃

线速度：≤ 25m/s

Available Range:

Sealed Medium: oil, water ,organic solvent, and other low corrosion liquor.

Pressure in the sealed chamber: ≤ 1.6Mpa

Temperature in the sealed chamber: -50℃ ~220℃

Linevelocity: ≤ 25m/s

如需了解进一步的信息和有关数据，请与本公司工程技术部联系。
 If you would like to know more information and relevant data, please contact the technology department.

HQ58U、HQ59U 型尺寸表 Dimension Table

公称轴径	d ₁	d ₃	d ₄	d ₅	d ₇	d ₈	d ₁₀	L ₁₀₀	L ₃	L ₄	L ₅	L ₇
14	14	24	26	21	25	2	6.5	35.0	23.0	12.0	8.5	4.0
16	16	26	28	23	27	2	6.5	35.0	23.0	12.0	8.5	4.0
18	18	32	34	27	33	3	6.5	37.5	24.0	13.5	9.0	5.0
20	20	34	36	29	35	3	6.5	37.5	24.0	13.5	9.0	5.0
22	22	36	38	31	37	3	6.5	37.5	24.0	13.5	9.0	5.0
24	24	38	40	33	39	3	6.5	40.0	26.7	13.3	9.0	5.0
25	25	39	41	34	40	3	6.5	40.0	27.0	13.0	9.0	5.0
28	28	42	44	37	43	3	6.5	42.5	30.0	12.5	9.0	7.5
30	30	44	46	39	45	3	6.5	42.5	30.5	12.0	9.0	7.5
32	32	46	48	42	48	3	6.5	42.5	30.5	12.0	9.0	7.5
33	33	47	49	42	48	3	6.5	42.5	30.5	12.0	9.0	6.5
35	35	49	51	44	50	3	6.5	42.5	30.5	12.0	9.0	6.5
38	38	54	58	49	56	4	6.5	45.0	32.0	13.0	9.0	8.0
40	40	56	60	51	58	4	6.5	45.0	32.0	13.0	9.0	8.0
43	43	59	63	54	61	4	6.5	45.0	32.0	13.0	9.0	8.0
45	45	61	65	56	63	4	6.5	45.0	32.0	13.0	9.0	8.0
48	48	64	68	59	66	4	6.5	45.0	32.0	13.0	9.0	5.5
50	50	66	70	62	70	4	6.5	47.5	34.0	13.5	9.0	6.5
53	53	69	73	65	73	4	6.5	47.5	34.0	13.5	9.0	5.5
55	55	71	75	67	75	4	6.5	47.5	34.0	13.5	9.0	5.5
58	58	78	83	70	78	4	6.5	52.5	39.0	13.5	9.0	7.5
60	60	80	85	72	80	4	6.5	52.5	39.0	13.5	9.0	7.5
63	63	83	88	75	83	4	6.5	52.5	39.0	13.5	9.0	7.5
65	65	85	90	77	85	4	6.5	52.5	39.0	13.5	9.0	7.5
68	68	88	93	81	90	4	6.5	52.5	39.0	13.5	9.0	7.5
70	70	90	95	83	92	4	6.5	60.0	45.5	14.5	9.0	7.5
75	75	95	104	88	97	4	6.5	60.0	45.5	14.5	9.0	7.8
80	80	104	109	95	105	4	9.5	60.0	45.0	15.0	9.0	7.8
85	85	109	114	100	110	4	9.5	60.0	45.0	15.0	9.0	7.8
90	90	114	119	105	115	4	9.5	65.0	50.0	15.0	9.0	7.8
95	95	119	124	110	120	4	9.5	65.0	50.0	15.0	9.0	7.8
100	100	124	129	115	125	4	9.5	65.0	50.0	15.0	9.0	7.8

HQ58B、HQ59B 型机械密封

Type HQ58B、HQ59B mechanical seals

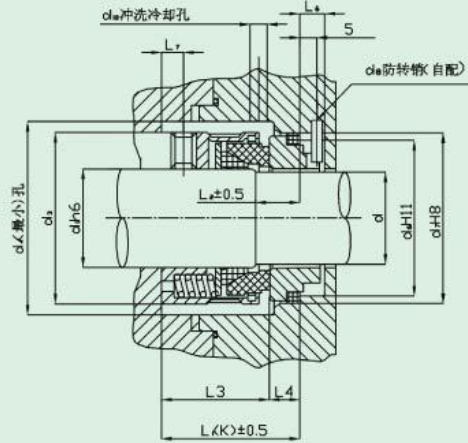
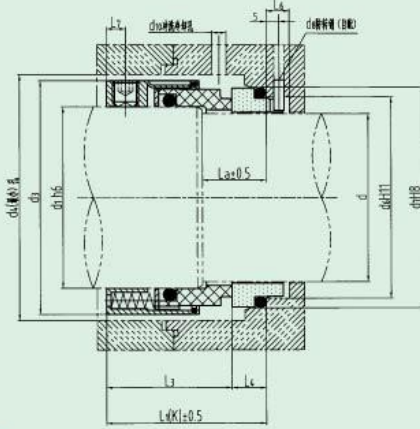

结构特点：

HQ59B 型泵用机械密封由聚四氟乙烯制作的楔形环作动辅助密封圈，HQ58B 机械密封采用橡胶“O”形圈作动静环辅助密封。符合 ISO3069、DIN24960 及 GB/T 6556 标准型，也符合美国石油学会标准 API610。是单端面、多弹簧平衡型结构，轴向尺寸小，结构紧凑，广泛适用于泵类、釜类、压缩机等类似设备的旋转轴的密封。摩擦副材质辅助密封材质请根据实际工况选用。

Structure Features:

The mechanical seal of type HQ59B is accord with ISO3069, DIN24960, and GB/T 6556, also API610 of USA, PTFE or flexible carbon for making wedgy ring, single face, multi-spring, balanced structure, the axial length is shorter, the structure is compact. Be suitable for rotating shaft seals in the equipment such as, pumps, reaction cauldrons and compressor s etc.

Sub-materials of friction and auxiliary materials should be selected according to operation condition.

适用范围：

- 被密封介质：油、水、有机溶剂及其它弱腐蚀性溶液。
- 密封腔压力： $\leq 2.5\text{Mpa}$
- 密封腔温度： $-50^{\circ}\text{C} \sim 220^{\circ}\text{C}$
- 线速度： $\leq 25\text{m/s}$

Available Range:

- Sealed Medium: oil, water, organic solvent, and other low corrosion liquor.
- Pressure in the sealed chamber: $\leq 2.5\text{Mpa}$
- Temperature in the sealed chamber: $-50^{\circ}\text{C} \sim 220^{\circ}\text{C}$
- Linearvelocity: $\leq 25\text{m/s}$

如需了解进一步的信息和有关数据，请与本公司工程技术部联系。
 If you would like to know more information and relevant data, please contact the technology department.



HQ58B、HQ59B 型尺寸表 Dimension Table

公称轴径	d	d1	d2	d3	d4	d5	d6	d7	d8	d9	d10	L1(K)	L2	L3	L4	L5	L6	L7	L8	L9	L10
14	14	18	32	34	21	25	3	6.5	42.5	30.5	12.0	8.5	5.0	18							
16	16	20	34	36	23	27	3	6.5	42.5	30.5	12.0	8.5	5.0	18							
18	18	22	36	38	27	33	3	6.5	45.0	31.5	13.5	9.0	5.0	20							
20	20	24	38	40	29	35	3	6.5	45.0	31.5	13.5	9.0	5.0	20							
22	22	26	40	42	31	37	3	6.5	45.0	31.5	13.5	9.0	5.0	20							
24	24	28	42	44	33	39	3	6.5	47.5	34.2	13.3	9.0	7.5	20							
25	25	30	44	46	34	40	3	6.5	47.5	34.5	13.0	9.0	7.5	20							
28	28	33	47	49	37	43	3	6.5	50.0	37.5	12.5	9.0	6.5	20							
30	30	35	49	51	39	45	3	6.5	50.0	38.0	12.0	9.0	6.5	20							
32	32	38	54	58	42	48	3	6.5	50.0	38.0	12.0	9.0	8.0	20							
33	33	38	54	58	42	48	3	6.5	50.0	38.0	12.0	9.0	8.0	20							
35	35	40	56	60	44	50	3	6.5	50.0	38.0	12.0	9.0	8.0	20							
38	38	43	59	63	49	56	4	6.5	52.5	39.5	13.0	9.0	8.0	23							
40	40	45	61	65	51	58	4	6.5	52.5	39.5	13.0	9.0	8.0	23							
43	43	48	64	68	54	61	4	6.5	52.5	39.5	13.0	9.0	5.5	23							
45	45	50	66	70	56	63	4	6.5	52.5	39.5	13.0	9.0	6.5	23							
48	48	53	69	73	59	66	4	6.5	52.5	39.5	13.0	9.0	5.5	23							
50	50	55	71	75	62	70	4	6.5	57.5	44.0	13.5	9.0	5.5	25							
53	53	58	78	83	65	73	4	6.5	57.5	44.0	13.5	9.0	7.5	25							
55	55	60	80	85	67	75	4	6.5	57.5	44.0	13.5	9.0	7.5	25							
58	58	63	83	88	70	78	4	6.5	62.5	49.0	13.5	9.0	7.5	25							
60	60	65	85	90	72	80	4	6.5	62.5	49.0	13.5	9.0	7.5	25							
63	63	68	88	93	75	83	4	6.5	62.5	49.0	13.5	9.0	7.5	25							
65	65	70	90	95	77	85	4	6.5	62.5	49.0	13.5	9.0	7.5	25							
70	70	75	95	104	83	92	4	6.5	70.0	55.5	14.5	9.0	7.8	28							
75	75	80	104	109	88	97	4	6.5	70.0	55.5	14.5	9.0	7.8	28							
80	80	85	109	114	95	105	4	9.5	70.0	55.0	15.0	9.0	7.8	28							
85	85	90	114	119	100	110	4	9.5	75.0	60.0	15.0	9.0	7.8	28							
90	90	95	119	124	105	115	4	9.5	75.0	60.0	15.0	9.0	7.8	28							
95	95	100	124	129	110	120	4	9.5	75.0	60.0	15.0	9.0	7.8	28							
100	100	105	129	134	115	125	4	9.5	75.0	60.0	15.0	9.0	7.8	28							



HUU801 型机械密封

Type HUU801 mechanical seals

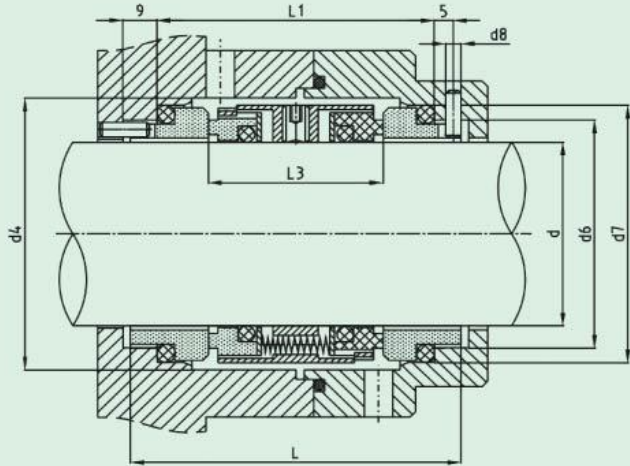
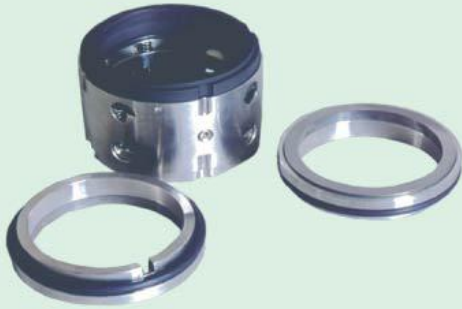

结构特点：

HUU801 型机械密封为双端面，多弹簧，非平衡结构。动环与传动座靠突耳传递扭矩，符合 ISO3069 及 DIN24960 标准，在潜污泵上广泛使用。密封腔压力必须高于被密封介质压力 0.1~0.2Mpa。

摩擦副材质与辅助密封材质请根据实际工况选用。

Structure Features:

The mechanical seal of type HUU801 is accord with double faces, multi-spring, unbalanced structure. Dash forward of ear transfer torsion between rotary and driving seat Conforms to ISO3069, DIN24960 standard, used in piping and sewage pumps. The pressure of sealant must be higher than sealed medium 0.1~0.2Map.

Sub-materials of friction and auxiliary materials should be selected according to operation condition.

适用范围：

被密封介质：水、油类、酸、碱等中等以下腐蚀性液体。

介质压力：≤ 0.6Mpa

介质温度：-20℃ ~100℃

线速度：≤ 20m/s

Available Range:

Sealed Medium water, oil, acid, alkali, under middle of corrosive liquid, etc.

Medium Pressure: ≤ 0.6Mpa

Medium temperature: -20℃ ~100℃

Linear velocity: ≤ 20m/s

如需了解进一步的信息和有关数据，请与本公司工程技术部联系。
If you would like to know more information and relevant data, please contact the technology department.

HUU801 型尺寸表 Dimension Table

公称轴径 d	d _a	d ₆₍₊₁₁₎	d ₇₍₊₈₎	d ₈	L	L ₁	L ₅	
20	20	36	29	35	3	81	67	40
22	22	38	31	37	3	81	67	40
24	24	40	33	39	3	81	67	40
25	25	41	34	40	3	81	67	40
28	28	44	37	43	3	82	68	41
30	30	46	39	45	3	82	68	41
32	32	48	42	48	3	82	68	41
33	33	49	42	48	3	82	68	41
35	35	51	44	50	3	82	68	41
38	38	58	49	56	4	85	71	44
40	40	60	51	58	4	85	71	44
43	43	63	54	61	4	85	71	44
45	45	65	56	63	4	85	71	44
48	48	68	59	66	4	85	71	44
50	50	70	62	70	4	87	73	46
53	53	73	65	73	4	87	73	46
55	55	75	67	75	4	87	73	46
58	58	83	70	78	4	101	87	60
60	60	85	72	80	4	101	87	60
63	63	88	75	83	4	101	87	60
65	65	90	77	85	4	101	87	60
68	68	93	81	90	4	101	87	60
70	70	95	83	92	4	103	89	60
75	75	104	88	97	4	103	89	60
80	80	109	95	105	4	104	90	60
85	85	114	100	110	4	104	90	60
90	90	119	105	115	4	104	90	60
95	95	124	110	120	4	104	90	60
100	100	129	115	125	4	104	90	60
110	110	144	125	136	4	111	97	65
120	120	154	135	146	4	111	97	65

HUU803 型机械密封

Type HUU803 mechanical seals

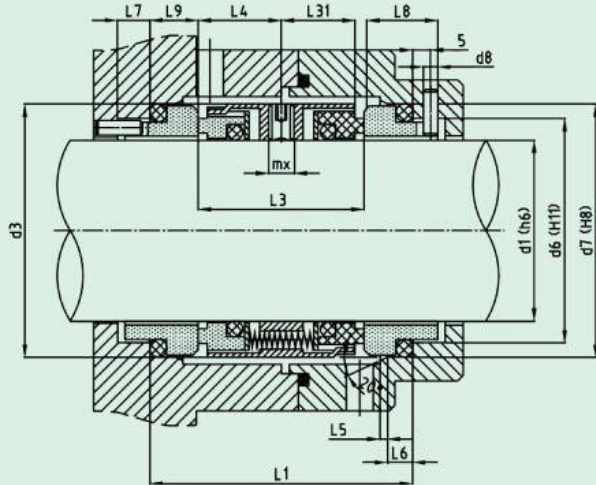

结构特点：

HUU803 型机械密封符合 GB/T65564 标准为非平衡型，双端面多弹簧结构，传动套传动。密封腔压力必须高于介质压力 0.1~0.2Mpa

摩擦副材质与辅助密封材质请根据实际工况选用。

Structure Features:

The mechanical seal of type HUU803 is accord with GB/T6556, multi-spring, unbalanced structure, transmission seat drive; it is independent of rotation direction of pump shaft the pressure of sealant must be higher than sealed medium 0.1~0.2Mpa.

Sub-materials of friction and auxiliary materials should be selected according to operation condition.

适用范围：

被密封介质：酸、碱、盐、海水、汽体易燃易爆有毒介质。

介质压力：≤ 1.6Mpa

介质温度：-50℃ ~150℃

线速度：≤ 20m/s

Available Range:

Sealed Mediums: acids, alkali, salt, seawater, gases, flammable, and explosive toxic media.

Medium Pressure: ≤ 1.6Mpa

Medium temperature: -20℃ ~150℃

Linear velocity: ≤ 20m/s

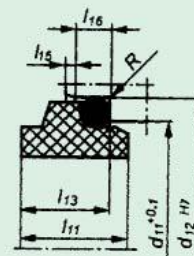
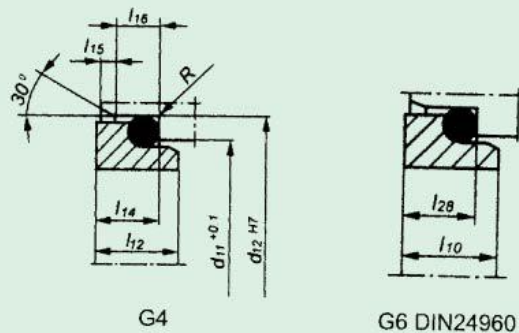

如需了解进一步的信息和有关数据，请与本公司工程技术部联系。
 If you would like to know more information and relevant data, please contact the technology department.

HUU805 型机械密封

Type HUU805 mechanical seals

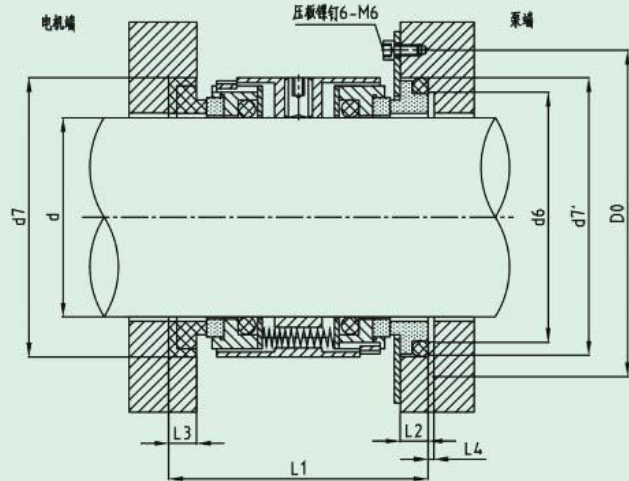

结构特点：

HUU805 型机械密封符合 ISO3069、DIN24960 和 GB/T6556 标准。多弹簧、非平衡型、双端面结构，旋转方向与转轴无关。可代替 UU4701 机封。

摩擦副材质与辅助密封材质请根据实际工况选用。

Structure Features:

The mechanical seal of type HUU805 is accord with ISO3069, DIN2496and GB/T6556, multi-spring, unbalanced, double faces structure, direction of rotation is independent of spindle can be replace type UU4701 mechanical seal.

Sub-materials of friction and auxiliary materials should be selected according to operation condition.

适用范围：

被密封介质：气体、泥水、浆料及其他含固体颗粒的流体。

介质压力：≤ 0.6Mpa

介质温度：-20℃ ~150℃

线速度：≤ 10m/s

Available Range:

Sealed Mediums: Gas, slurry, pulp and otherfluid with more solid particle, etc.Medium

Pressure: ≤ 0.6Mpa

Mediumtemperature: -20℃ ~150℃

Linear velocity: ≤ 10m/s

HUU805 型尺寸表 Dimension Table

公称轴径	d ₆₀	d _{6H11}	d _{7H8}	d _{7H8}	D _{0±0.1}	L ₁	L ₂	L ₃	L ₄	备注
25	25	34	40	40	60	49	6.5	6.5	2	有压板
28	28	37	43	43	61	52	6.5	6.5	2	有压板
30	30	39	45	45	65	56	6	7.5	2	有压板
35	35	44	50	50	75	59	7.5	7.5	2	有压板
38	38	49	56	56	80	60	6	7.5	2	有压板
40	40	51	58	58	82	63	7.5	7.5	2	有压板
45	45	56	63	63	87	65	8	9.5	2	有压板
50	50	62	70	70	93	68	7.5	8	2	有压板
55	55	67	75	75	98	71	8	9.5	2	有压板
60	60	72	80	80	105	72.5	8	8	2	有压板
65	65	77	85	85	112	79	9.5	11	2	有压板
70	70	83	92	92	117	81	9.5	11	2	有压板
85	85	97.5	109	107.5	132	102.5	9.5	12	2	有压板
90	90	105	115	115	137	103	12	12	4	有压板
100	100	122.5	133	133	155	112	18	18.5	4	有压板

如需了解进一步的信息和有关数据，请与本公司工程技术部联系。
 If you would like to know more information and relevant data, please contact the technology department.

HBM2 型机械密封

Type HBM2 mechanical seals

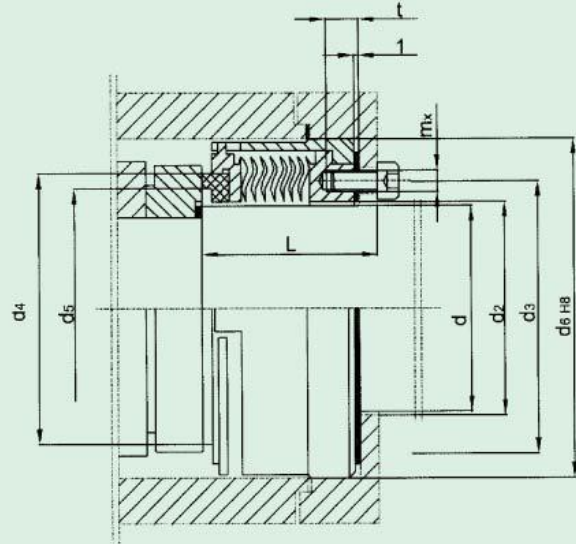

结构特点：

HBM2 型机械密封为单端面、平衡型、任意旋向，静止式金属波纹管密封，非补偿环按照运行工况需要选择。波纹管不传递扭矩，没有其他弹性元件构成次级密封。

摩擦副材质与辅助密封材质请根据实际工况选用。

Structure Features:

The mechanical seal of type HBM2 is accord with single seal, balanced, static metal bellows seal, which can be rotated at will. The uncompensated ring shall be selected according to the operation condition. The bellows doesn't transfer torsion & no other elastic element forms the secondary seal.

Sub-materials of friction and auxiliary materials should be selected according to operation condition.

适用范围：

- 被密封介质：油、水、弱酸、弱碱。
- 压力：当波纹管受外压时 ≤ 2.5Mpa
- 当波纹管受内压时 ≤ 1Mpa
- 密封腔温度：-20℃ ~ 400℃，
- 线速度：≤ 50m/s

Available Range:

- Sealed Medium: oil, water, lowacid, lowalkali, etc.
- Pressure in the sealed chamber: ≤ 2.5Mpa (with external pressurization)
- ≤ 1Mpa (with internal pressurization)
- Temperature in the sealed chamber: -20℃ ~400℃
- Linear velocity: ≤ 50m/s

如需了解进一步的信息和有关数据，请与本公司工程技术部联系。
 If you would like to know more information and relevant data, please contact the technology department.

HBM2 型尺寸表 Dimension Table

公称轴径	d	d ₂	d ₃	d ₄	d ₅	d ₆	L	nxmx	t
19	16-19	20.5	29	30.3	25.3	45.0	33.5	4xM4	6
24	20-24	25.5	35	38.8	33.8	49.0	33.5	4xM4	6
30	25-30	31.5	40	43.6	38.6	55.0	34.5	6xM4	6
35	31-35	36.0	45	45.8	40.8	59.0	33.0	6xM4	6
40	36-40	41.0	50	51.5	46.5	65.0	30.5	6xM4	6
45	41-45	46.0	55	55.2	50.2	69.0	35.5	6xM4	6
51	46-51	52.0	63	64.7	59.7	76.5	40.5	6xM5	7
60	52-60	61.0	70	70.6	65.6	84.0	32.0	6xM5	7
70	61-70	71.0	80	82.8	76.8	95.0	38.0	6xM5	7
82	71-82	83.5	95	98.0	92.0	112.0	41.0	6xM6	7
88	83-88	89.5	100	107.7	101.7	120.0	47.0	6xM6	7
100	89-100	101.0	112	112.7	106.7	130.0	47.0	6xM6	7

HQBM-A/B-1 型机械密封

Type HQBM-A/B-1 mechanical seals

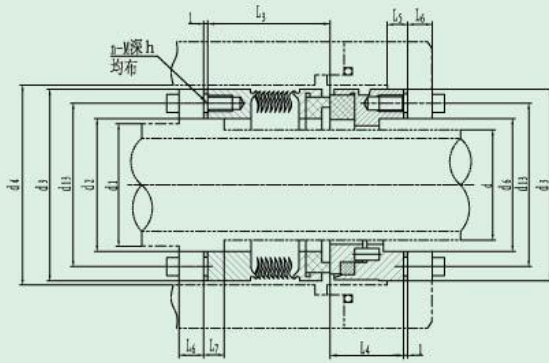

HQBM-A-1

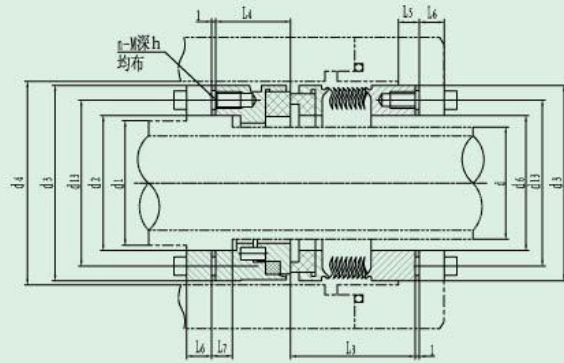

HQBM-B-1

结构特点：

为单端面平衡型单层金属波纹管密封结构，辅助密封为柔性石墨和柔性石墨增强垫，HQBM-A-1 为旋转式，HQBM-B-1 为静止式，HQBM-A-1 和 HQBM-B-1 所有零件完全互换，即 HQBM-A-1 型密封只要改变安装方式即变成 HQBM-B-1 静止式，另外它的非补偿环也有两种结构形式，一种是镶嵌式，另一种为整体式，用户增加了一个选择的方式。它与 HQTm-A/B-1 型密封可以整套互换。

Structure Features:

It is a single face, balanced and bilayer metal bellows, the auxiliary mechanical seals are flexible graphite and flexible gasket. Its interconvertibility is the same as the HQBM-A/B-1 and it can bear more pressure. It has two kinds of un-compensated ring: the inlaying ring and the integrated ring. The customers have more choices. It can be exchanged by HQBM-A/B-1 by the whole set.

适用范围：

- 温度：200~315℃
- 压力：≤ 2MPa
- 转速：≤ 3000r/min

Available Range:

- Temperature: 200~315℃
- Pressure: ≤ 2MPa
- Speed: ≤ 3000r/min

HQBM-A/B-1 型尺寸表 Dimension Table

规格	尺寸公差	d	d ₁	d ₂	d ₃	d ₄	d ₆	d ₁₃	L ₃	L ₄	L ₅	L ₆	L ₇	n	M	h
		H8/e8		H8/e8		H8/e8		H8/e8		H8/e8		H8/e8		H8/e8		H8/e8
030		27	30	32.5	47	49	32.2	40	30	18	5	6	5	8	4	6
035		31.5	35	36	51	53	35.7	44	30	20	5	6	5	8	4	6
040		37	40	41.5	62	65	41.2	52	40	25	5	8	6	6	6	8
045		41.5	45	46.5	67	70	46.2	56	45	25	5	8	6	6	6	8
050		46.5	50	51.5	72	75	51.2	62	45	25	5	8	6	6	6	8
055		51.5	55	56.5	78	80	56.2	67	45	30	5	8	6	6	6	8
060		53	60	61	83	85	60.7	72	45	30	5	8	6	6	6	8
065		58.5	65	66	88	90	67.5	76	45	30	5	10	6	6	6	10
070		67	70	72.5	97	100	72.2	84	50	30	8	10	6	6	6	10
075		73	75	77.5	98	100	77.2	88	50	30	8	10	6	6	6	10
080		73.5	80	79.5	103	105	79.2	91	50	30	8	10	6	6	6	10
085		78	85	85.5	108	110	85.2	97	50	30	8	10	6	6	6	10
090		86	90	92.5	115	118	92.2	103	50	30	10	10	6	6	6	10
095		90	95	97.5	121	124	97.2	110	50	30	10	10	8	8	6	10
100		95	100	102.5	124	128	102.2	113	50	30	10	10	8	8	6	10

如需了解进一步的信息和有关数据，请与本公司工程技术部联系。
 If you would like to know more information and relevant data, please contact the technology department.



HQ604/606/609 型机械密封

Type HQ 604/606/609 mechanical seals

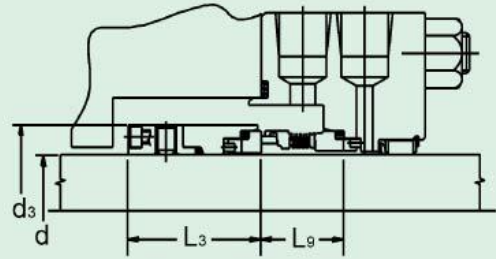

HQ604 型

结构特点：

HQ604 型

高温通用型金属波纹管，用于大轴径和高速工况及密封腔体不标准的大轴径之中。

HQ606 型

高温旋转式波纹管，依靠波纹管下的拨叉传动，应用于有粘度和易结晶的工况。

HQ609 型

高温旋转波纹管，其狭窄的断面设计使安装更简易。

适用范围：

温度：

-75℃ ~ +425℃ / -100° F ~ +800° F
(柔性石墨静态包装)

压力：

真空下 2.5Mpa.
真空下 5Mpa. (使用双层波纹管)

速度：

25m/s/5,000 (HQ606 和 HQ609)
50m/s/10,000 (HQ604)

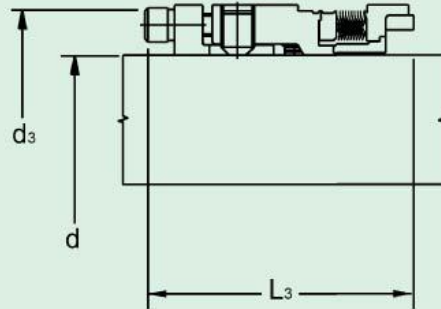

HQ606 型

Structure Features:

Type HQ604:

High-temperature general-purpose stationary bellows assembly capable of handling high shaft speed applications and high shaft-to-seal chamber misalignment.

Type HQ606:

High-temperature rotary bellows assembly with drive lugs under the bellows for additional rotational drive in viscous or thermosetting applications.

Type HQ609:

High-temperature rotary bellows assembly with narrow cross-section design for easy fit.

Available Range

Temperature:

-75℃ ~ +425℃ / -100° F ~ +800° F
(with flexible graphite static packing)

Pressure:

Vacuum to 2.5Mpa.
Vacuum to 5Mpa. (with DOUBLE-PLY bellows)

Speed:

up to 25m/s/5,000 fpm for Types HQ606 and HQ609
up to 50m/s/10,000 fpm for Type HQ604

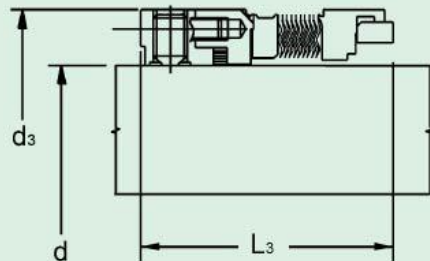

HQ609 型

如需了解进一步的信息和有关数据，请与本公司工程技术部联系。
If you would like to know more information and relevant data, please contact the technology department.



HQ604/606/609 型机械密封

Type HQ 604/606/609 mechanical seals

HQ 604 型

密封件 编号	d +0.00	d ₃ Ref.	L ₃ Ref.	L ₉ Ref.	d +0.00	d ₃ Ref.	L ₃ Ref.	L ₉ Ref.
尺寸代码	-0.002				-0.05			
-18	1.000	1.937	1.969	1.138	25.40	49.20	50.01	28.91
-20	1.125	2.062	1.969	1.138	28.58	52.37	50.01	28.91
-22	1.250	2.187	1.969	1.138	31.75	55.55	50.01	28.91
-24	1.375	2.312	1.938	1.138	34.93	58.72	49.23	28.91
-26	1.500	2.562	2.063	1.191	38.10	65.07	52.40	30.25
-28	1.625	2.562	2.060	1.222	41.28	65.07	52.32	31.04
-30	1.750	2.687	2.060	1.254	44.45	68.25	52.32	31.85
-32	1.875	2.812	2.062	1.254	47.63	71.42	52.37	31.85
-34	2.000	2.937	2.060	1.285	50.80	74.60	52.32	32.64
-36	2.125	3.187	2.182	1.316	53.98	80.95	55.42	33.43
-38	2.250	3.312	2.218	1.348	57.15	84.12	56.34	34.24
-40	2.375	3.437	2.186	1.379	60.33	87.30	55.52	35.03
-42	2.500	3.562	2.184	1.410	63.50	90.47	55.47	35.81
-44	2.625	3.687	2.250	1.443	66.68	93.65	57.15	36.65
-46	2.750	3.937	2.250	1.608	69.85	100.00	57.15	40.84
-48	2.875	4.062	2.281	1.608	73.03	103.17	57.94	40.84
-50	3.000	4.187	2.250	1.608	76.20	106.35	57.15	40.84
-52	3.125	4.312	2.250	1.608	79.38	109.52	57.15	40.84
-54	3.250	4.437	2.219	1.608	82.55	112.70	56.36	40.84
-56	3.375	4.562	2.282	1.608	85.73	115.87	57.96	40.84
-58	3.500	4.687	2.373	1.650	88.90	119.05	60.27	41.91
-60	3.625	4.812	2.375	1.650	92.08	122.22	60.33	41.91
-62	3.750	4.937	2.375	1.650	95.25	125.40	60.33	41.91
-64	3.875	5.062	2.375	1.650	98.43	128.57	60.33	41.91

HQ 606 型

密封件 编号	d +0.00	d ₃ Ref.	L ₃ Ref.	d +0.00	d ₃ Ref.	L ₃ Ref.
尺寸代码	-0.002			-0.05		
-16	0.750	1.625	2.312	19.05	41.28	58.72
-18	0.875	1.750	2.343	22.23	44.45	59.51
-20	1.000	1.875	2.343	25.40	47.63	59.51
-22	1.125	2.000	2.375	28.58	50.80	60.33
-24	1.250	2.125	2.375	31.75	53.98	60.33
-26	1.375	2.250	2.468	34.93	57.15	62.69
-28	1.500	2.375	2.500	38.10	60.33	63.50
-30	1.625	2.500	2.500	41.28	63.50	63.50
-32	1.750	2.625	2.531	44.45	66.68	64.29
-34	1.875	2.750	2.531	47.63	69.85	64.29
-36	2.000	2.875	2.562	50.80	73.03	65.07
-38	2.125	3.000	2.562	53.98	76.20	65.07
-40	2.250	3.250	2.750	57.15	82.55	69.85
-42	2.375	3.375	2.781	60.33	85.73	70.64
-44	2.500	3.500	2.781	63.50	88.90	70.64
-46	2.625	3.687	2.875	66.68	93.65	73.03
-48	2.750	3.812	3.000	69.85	96.82	76.20
-50	2.875	4.000	3.000	73.03	101.60	76.20
-52	3.000	4.125	3.000	76.20	104.78	76.20
-54	3.125	4.250	3.000	79.38	107.95	76.20
-56	3.250	4.375	3.000	82.55	111.13	76.20
-58	3.375	4.500	3.000	85.73	114.30	76.20
-60	3.500	4.625	3.000	88.90	117.48	76.20
-62	3.625	4.750	3.000	92.08	120.65	76.20
-64	3.750	4.875	3.000	95.25	123.83	76.20

HQ 609 型

密封件 编号	d +0.00	d ₃ Ref.	L ₃ Ref.	d +0.00	d ₃ Ref.	L ₃ Ref.
尺寸代码	-0.002			-0.05		
-16	1.000	1.625	1.531	25.40	41.28	38.89
-18	1.125	1.750	1.562	28.58	44.45	39.67
-20	1.250	1.875	1.593	31.75	47.63	40.46
-22	1.375	2.000	1.593	34.93	50.80	40.46
-24	1.500	2.125	1.593	38.10	53.98	40.46
-26	1.625	2.250	1.593	41.28	57.15	40.46
-28	1.750	2.375	1.625	44.45	60.33	41.28
-30	1.875	2.500	1.625	47.63	63.50	41.28
-32	2.000	2.625	1.656	50.80	66.68	42.06
-34	2.125	2.750	1.656	53.98	69.85	42.06
-36	2.250	2.875	1.719	57.15	73.03	43.66
-38	2.375	3.000	1.719	60.33	76.20	43.66
-40	2.500	3.250	1.750	63.50	82.55	44.45
-42	2.625	3.375	1.781	66.68	85.73	45.24
-44	2.750	3.500	1.781	69.85	88.90	45.24
-46	2.875	3.687	1.875	73.03	93.65	47.63
-48	3.000	3.812	1.875	76.20	96.82	47.63
-50	3.125	4.000	1.875	79.38	101.60	47.63
-52	3.250	4.125	1.875	82.55	104.78	47.63
-54	3.375	4.250	1.875	85.73	107.95	47.63
-56	3.500	4.375	1.875	88.90	111.13	47.63
-58	3.625	4.500	1.875	92.08	114.30	47.63
-60	3.750	4.625	1.875	95.25	117.48	47.63
-62	3.875	4.750	1.875	98.43	120.65	47.63
-64	4.000	4.875	1.875	101.60	123.83	47.63

如需了解进一步的信息和有关数据, 请与本公司工程技术部联系。
 If you would like to know more information and relevant data, please contact the technology department.



HQ670/676/680 型机械密封

Type HQ 670/676/680 mechanical seals



结构特点：

静态二级密封
标准组件
单双安排都有效
轴装或者在套管里
HQ670 型符合 API682 标准

HQ 670 型

波纹管材质为 Hast.c, 应用于强腐蚀性工况。

HQ 676 型

波纹管材质为 AM350, 主要应用于轻微腐蚀工况。

HQ 680 型

全合金 20 低温高性能密封, 广泛应用于腐蚀性介质中。

适用范围：

温度：

-75℃ to +290℃ / -100°F to +550°F
(视使用材质而定)

压力：

真空下 2.5Mpa.

速度：

25m/s / 5,000 fpm

Structure Features:

Static Secondary Seal
Standard Components
Available in Single or Dual Arrangements,
Shaft-mounted or in a Cartridge
The Type HQ670 meets API 682 Requirements

Type HQ670:

All-Alloy C-276 high-strength low-temperature bellows assembly for highly corrosive applications.

Type HQ676:

AM350 low-temperature bellows assembly for large sizes and mildly corrosive applications.

Type HQ680:

All-Alloy 20 low-temperature high performance seal for use on a broad range of corrosive media.

Available Range

Temperature:

-75℃ to +290℃ / -100°F to +550°F
(depending on materials used)

Pressure:

Vacuum to 2.5Mpa.

Speed:

Up to 25m/s / 5,000 fpm

如需了解进一步的信息和有关数据, 请与本公司工程技术部联系。
If you would like to know more information and relevant data, please contact the technology department.

HQ670/676/680 型机械密封

Type HQ 670/676/680 mechanical seals

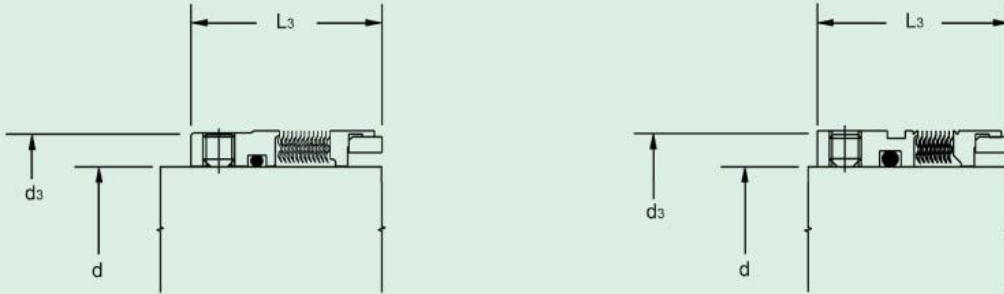

HQ 670/676 型

密封件 编号	d +0.000	d ₃ Ref.	L ₃ Ref.
尺寸代码	-0.05		
-018	18	32.0	27.5
-020	20	33.3	27.5
-022	22	36.0	27.5
-024	24	38.1	30.0
-025	25	39.0	30.0
-028	28	42.0	32.5
-030	30	44.0	32.5
-032	32	46.0	32.5
-033	33	47.0	32.5
-035	35	49.2	32.5
-038	38	52.4	34.0
-040	40	55.6	34.0
-043	43	58.7	34.0
-045	45	58.7	34.0
-048	48	61.9	34.0
-050	50	65.1	34.5
-053	53	68.3	34.5
-055	55	71.0	34.5
-060	60	74.6	39.5
-065	65	84.1	39.5
-070	70	87.3	45.0
-075	75	95.3	45.0
-080	80	98.4	44.5
-085	85	104.8	44.5
-090	90	108.0	49.5
-095	95	114.3	49.5
-0100*	100	120.7	49.5
-0105*	105	131.7	48.3
-0110*	110	138.1	48.3
-0115*	115	144.5	48.3
-0120*	120	144.5	48.3
-0125*	125	150.8	48.3
-0130*	130	157.8	48.3
-0140*	140	170.5	48.3
-0150*	150	176.9	48.3

HQ 680 型

密封件 编号	d +0.000	d ₃ Ref.	L ₃ Ref.
尺寸代码	-0.05		
-12	.750	1.312	1.250
-14	.875	1.437	1.250
-15	.937	1.500	1.250
-16	1.000	1.562	1.250
-18	1.125	1.687	1.250
-20	1.250	1.812	1.312
-22	1.375	1.937	1.437
-24	1.500	2.062	1.437
-26	1.625	2.187	1.437
-28	1.750	2.312	1.437
-30	1.875	2.437	1.500
-32	2.000	2.562	1.500
-34	2.125	2.687	1.500
-36	2.250	2.812	1.562
-38	2.375	2.937	1.562
-40	2.500	3.187	1.562
-42	2.625	3.312	1.625
-44	2.750	3.437	1.625
-46	2.875	3.625	1.687
-48	3.000	3.750	1.687
-50	3.125	3.875	1.750
-52	3.250	4.000	1.750
-54	3.375	4.125	1.750
-56	3.500	4.250	1.875
-58	3.625	4.375	1.875
-60	3.750	4.500	1.875
-62	3.875	4.625	1.875
-64	4.000	4.750	1.875
-68*	4.250	5.187	1.903
-72*	4.500	5.438	1.903
-76*	4.750	5.688	1.903
-80*	5.000	5.938	1.903
-84*	5.250	6.213	1.903
-88*	5.500	6.463	1.903
-92*	5.750	6.714	1.903
-96*	6.000	6.964	1.903
-104*	6.500	7.470	1.903
-112*	7.000	7.971	1.903

如需了解进一步的信息和有关数据, 请与本公司工程技术部联系。
 If you would like to know more information and relevant data, please contact the technology department.



HQCT 型机械密封

Type HQCT mechanical seals

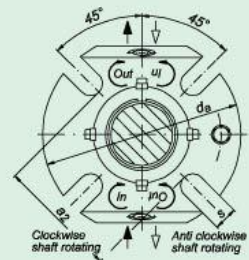
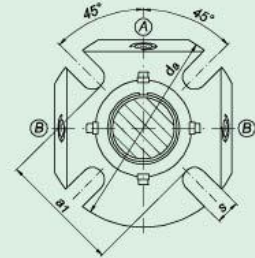
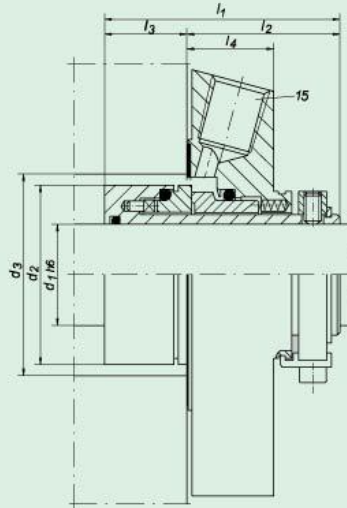

结构特点：

HQCT 型机械密封为集装式密封，由于弹簧不与介质接触，可以广泛应用于含有杂质颗粒的工况，它有单端面 and 双端面两种密封结构。HQCT-SE 为带有冲洗接口的单端面密封，HQCT- QE 为带有无压急冷的单端面密封，设计与 HQCT-SE 相同，单密封大气侧带有唇形滑架油封，密封端盖带有冲洗接口和集冷接口。

HQCT-DE 为双端面密封，双向平衡（隔离压降低或压力反向时，密封仍保持闭合），要求用隔离液系统，不必另加循环装置。

HQCT-SE

Structure Features:

HQCT is a kind of Cartridge mechanical seal, because of no connection between springs and medium, It can be applied in the working condition of particles, it has the single-face and double-face. HQCT-SE is a single face seal with rinse interface. HQCT-QE same designed with HQCT-SE is a single face seal with no pressure quench. Atmospheric side of single seal has a lip seal carriage. The tip of mechanical seal have rinse interface and set cold interface.

HQCT-QE is a double-face , Bidirectional balance mechanical seal, when the isolated pressure drop or pressure reverse,the seal remains closed, it needs use spacer system and not need add Additional circulatory system

适用范围：

- 温度：-40~ 200℃
- 压力：≤ 1.2MPa
- 线速度：≤ 10m/s

Available Range:

- Temperature in the sealed chamber: -40~ 200℃
- Pressure in the sealed chamber: ≤ 1.2MPa
- Linear velocity: ≤ 10m/s

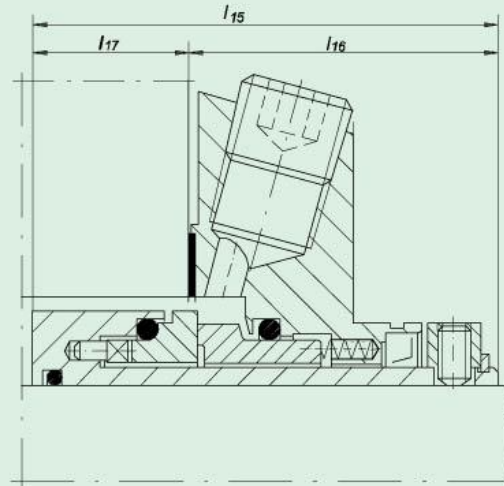

HQCT-QE

如需了解进一步的信息和有关数据，请与本公司工程技术部联系。
 If you would like to know more information and relevant data, please contact the technology department.

HQCT 型机械密封

Type HQCT mechanical seals

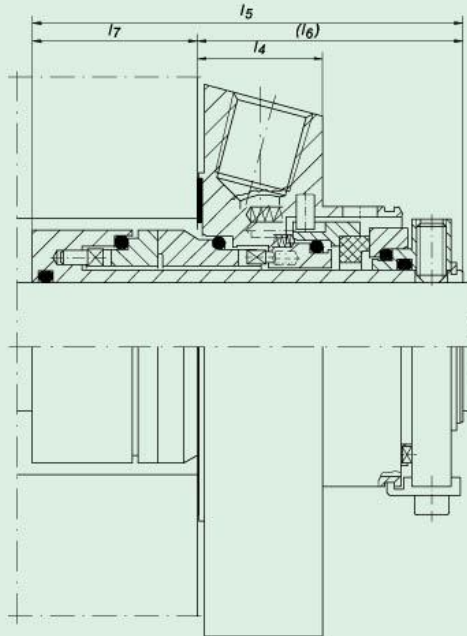

HQCT 型尺寸表 Dimension Table

HQCT-DE

d ₁	d ₂	d _{3min.}	d _{3max.}	l ₁	l ₂	l ₃	l ₄	l ₅	l ₆	l ₇	l ₁₂	l ₁₃	l ₁₄	l ₁₅	l ₁₆	l ₁₇	a ₁	a ₂	d _a	s
25	43.0	44.0	51.5	67	42.4	24.6	25.4	86.5	53.4	33.1	35.0	32.0	17.5	79.5	53.4	26.1	62	62	105	13.2
28	46.0	47.0	52.0	67	42.4	24.6	25.4	86.5	53.4	33.1	35.0	32.0	17.5	79.5	53.4	26.1	62	65	105	13.2
30	48.0	49.0	56.0	67	42.4	24.6	25.4	86.5	53.4	33.1	35.0	32.0	17.5	79.5	53.4	26.1	65	67	105	13.2
32	49.8	51.0	57.0	67	42.4	24.6	25.4	86.5	53.4	33.1	35.0	32.0	17.5	79.5	53.4	26.1	67	70	108	13.2
33	49.8	51.0	57.0	67	42.4	24.6	25.4	86.5	53.4	33.1	35.0	32.0	17.5	79.5	53.4	26.1	67	70	108	13.2
35	53.0	54.0	61.5	67	42.4	24.6	25.4	86.5	53.4	33.1	35.0	32.0	17.5	79.5	53.4	26.1	70	72	113	13.2
38	56.0	57.0	66.0	67	42.4	24.6	25.4	86.5	53.4	33.1	35.0	32.0	17.5	79.5	53.4	26.1	75	75	123	13.2
40	58.0	59.0	68.0	67	42.4	24.6	25.4	86.5	53.4	33.1	35.0	32.0	17.5	79.5	53.4	26.1	75	77	123	14.2
42	60.5	61.5	69.5	67	42.4	24.6	25.4	86.5	53.4	33.1	35.0	32.0	17.5	79.5	53.4	26.1	80	80	133	14.2
43	60.5	61.5	70.5	67	42.4	24.6	25.4	86.5	53.4	33.1	35.0	32.0	17.5	79.5	53.4	26.1	80	80	133	14.2
45	62.5	64.0	73.0	67	42.4	24.6	25.4	86.5	53.4	33.1	35.0	32.0	17.5	79.5	53.4	26.1	81	82	138	14.2
48	65.6	67.0	75.0	67	42.4	24.6	25.4	86.5	53.4	33.1	35.0	32.0	17.5	79.5	53.4	26.1	84	85	138	14.2
50	68.0	69.0	78.0	67	42.4	24.6	25.4	86.5	53.4	33.1	35.0	32.0	17.5	79.5	53.4	26.1	87	87	148	14.2
53	73.0	74.0	83.0	67	42.4	24.6	25.4	86.5	53.4	33.1	35.0	32.0	17.5	79.5	53.4	26.1	90	92	148	18.0
55	73.0	74.0	83.0	67	42.4	24.6	25.4	86.5	53.4	33.1	35.0	32.0	17.5	79.5	53.4	26.1	90	92	148	18.0
60	78.0	79.0	91.0	67	42.4	24.6	25.4	86.5	53.4	33.1	35.0	32.0	17.5	79.5	53.4	26.1	102	102	157	18.0
65	84.8	85.7	98.5	67	42.4	24.6	25.4	86.5	53.4	33.1	35.0	32.0	17.5	79.5	53.4	26.1	109	109	163	18.0
70	93.0	95.0	108.0	67	42.4	24.6	25.4	86.5	53.4	33.1	35.0	32.0	17.5	79.5	53.4	26.1	118	118	178	18.0
75	100.0	101.6	118.0	84	57.4	26.6	28.0	108.0	63.9	44.1	46.1	37.9	22.0	-	-	-	129	129	190	18.0
80	106.4	108.0	124.0	84	57.4	26.6	28.0	108.0	63.9	44.1	46.1	37.9	22.0	-	-	-	135	135	195	18.0
85	109.5	111.1	128.0	84	57.4	26.6	28.0	108.0	63.9	44.1	46.1	37.9	22.0	-	-	-	139	139	198	22.0
90	115.9	117.5	135.0	84	57.4	26.6	28.0	108.0	63.9	44.1	46.1	37.9	22.0	-	-	-	145	145	205	22.0
95	119.1	120.7	138.0	84	57.4	26.6	28.0	108.0	63.9	44.1	46.1	37.9	22.0	-	-	-	148	148	208	22.0
100	125.4	127.0	144.0	84	57.4	26.6	28.0	108.0	63.9	44.1	46.1	37.9	22.0	-	-	-	154	154	218	22.0

HQMS 型机械密封

Type HQMS mechanical seals

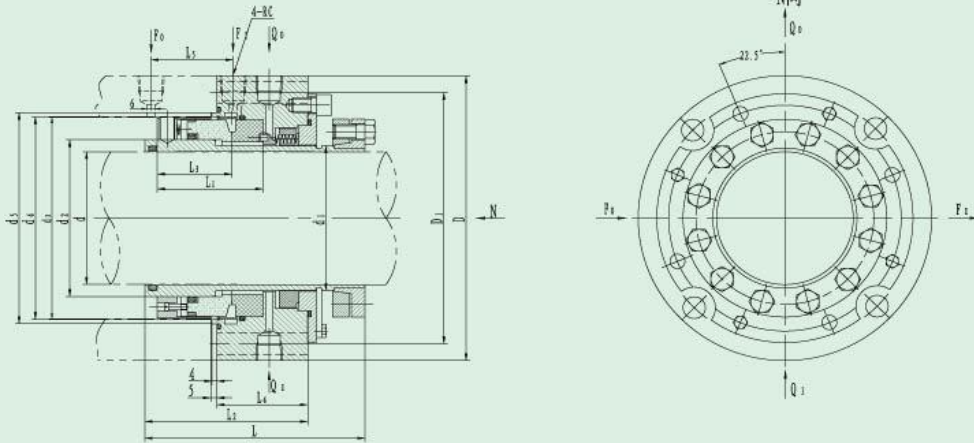

结构特点：

为单端面平衡型多弹簧流体动压式集装式密封结构，辅助密封为橡胶 O 型圈，本密封结构最大特点是在旋转环（硬环）上开有若干均匀分布的动压槽，开槽部分承受载荷和冷却，密封环表面的其他部分完成密封和节流作用。采用泵送螺旋方式将密封腔中的密封流体泵送至冷却器冷却后再回到密封腔，冲洗采用沿圆周多孔均匀分布的分布板结构，使密封面冷却均匀和冷却效果最佳。在急冷部分采用浮动节流套，它与轴或轴套的间隙更小，减少了急冷液的泄露，在传动方式上采用了夹紧式的锥面传动方式，避免了紧定螺钉传动在高轴向载荷下打滑的情况。

本密封适用于压力较高的过热水或类似工况。

Structure Features:

It is a balanced ,multi-spring hydrodynamic single cartridge mechanical seals, the auxiliary mechanical seals is rubber o ring. Its biggest characteristic is that there are a few equally distributed dynamic pressure trough on the rotation ring, the trough can bear loading and cooling, the others can play the role of sealing and throttling. The sealed fluids in the sealed chamber are pumped to congealer and back to sealed chamber by the way of pumping spiral, washing is by the distribution plate on which there are holes equally distributed, which can make the face cooling uniformly and well. It apply the floating throttling set as quickly cooling, it can reduces the gap between the axle and axle sleeve and also reduce the leakage of the urgent cold liquid, it apply the way of clampon cone transmission to avoid the situation of the slipping of the socket set screw when it is at the transmission of the high axle load.

It apply to the situation of the high water with high pressure.

适用范围：

- 温度：< 200℃
- 压力：≤ 7MPa
- 转速：≤ 3000r/min

Available Range:

- Temperature: < 200℃
- Pressure: ≤ 7MPa
- Speed: ≤ 3000r/min

如需了解进一步的信息和有关数据，请与本公司工程技术部联系。
 If you would like to know more information and relevant data, please contact the technology department.

HQMS 型尺寸表 Dimension Table

尺寸 规格	d	d ₁	d ₂	d ₃	d ₄	d ₅	D	D1	L	L ₁	L ₂	L ₃	L ₄	L ₅	RC	φ
公差			h ₇	h ₇	H ₇	H8/e8										
30	24	30	35	53	54	60	100	84	125	58	92	38	58.5		1/4"	
32	25	32	38	58	59	64	104	88	125	58	92	38	58.5	30.5	1/4"	10
33	25	33	38	58	59	64	104	88	125	58	92	38	58.5		1/4"	
35	28	35	40	60	61	71	116	97	125	58	92	38	58.5		1/4"	
38	28	38	43	64	65	74	119	100	136	62	100	39.5	64.5		1/4"	
40	30	40	45	65	66	76	121	102	136	62	100	39.5	64.5		1/4"	
43	33	43	48	68	69	79	124	105	136	62	100	39.5	64.5	32.5	1/4"	12
45	35	45	50	70	71	81	126	107	136	62	100	39.5	64.5		1/4"	
48	38	48	53	74	75	84	129	110	136	62	100	39.5	64.5		3/8"	
50	40	50	55	75	76	86	131	112	144	69	107	44	67		3/8"	
53	43	53	58	82	83	93	144	122	144	69	107	44	67	38	3/8"	
55	45	55	60	84	85	95	146	124	144	69	107	44	67		3/8"	
58	48	58	63	87	88	99	150	128	153	74	114	49	69		3/8"	
60	50	60	65	94	95	101	152	130	153	74	114	49	69		3/8"	14
63	53	63	68	92	93	103	154	132	153	74	114	49	69	42	3/8"	
65	55	65	70	94	95	105	156	134	153	74	114	49	69		3/8"	
70	60	70	75	104	105	115	166	144	164.5	80.5	122.5	55.5	70		3/8"	
75	65	75	80	108	109	119	186	158	164.5	80.5	122.5	55.5	70	49	3/8"	
80	70	80	85	113	114	124	190	162	164	80	122	55	70		1/2"	
85	75	85	90	118	119	129	196	168	174	85	129	60	72		1/2"	
90	80	90	95	123	124	134	200	172	174	85	129	60	72		1/2"	
95	85	95	100	128	129	139	208	180	174	85	129	60	72		1/2"	18
100	90	100	105	133	134	144	213	185	176	85	130	60	73	53	1/2"	
110	100	110	120	157	158	165	226	198	176	85	130	60	73		1/2"	
120	110	120	130	167	168	175	236	208	176	85	130	60	73		1/2"	

HQ502 型机械密封

Type HQ502 mechanical seals

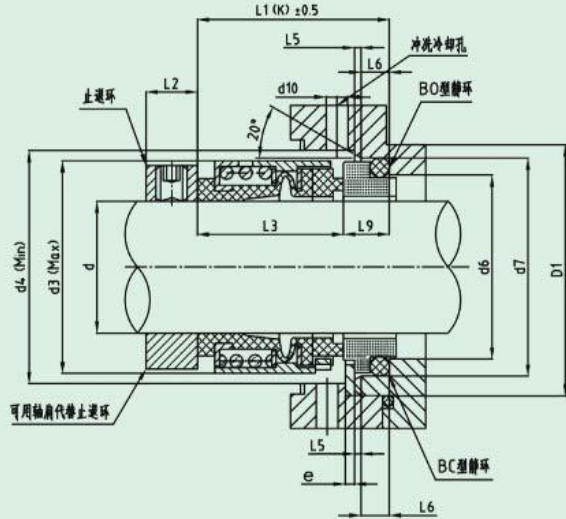

结构特点：

HQ502 型机械密封符合欧洲标准 DIN24960，国际标准 ISO3069 和英国标准 BS/T5257。此机械密封属于单弹簧、橡胶波纹管结构，由于采用了橡胶波纹管，此结构简单、紧凑，还可以补偿轴的径向和轴向跳动。

摩擦副材质与辅助密封材质请根据实际工况选用。

Structure Features:

The mechanical seal of type HQ502 is accord with the standardizations of DIN24960, ISO3069 and BS5257, single spring, the rubber bellow structure. Simple and compact due to the adoption of rubber bellows; to compensate the radial run-out and axial play.

Sub-materials of friction and auxiliary materials should be selected according to operation condition.

适用范围：

被密封介质：油、水、有机溶剂及其它腐蚀性溶液。

密封腔压力：≤ 4Mpa

密封腔温度：-40℃ ~200℃

线速度：≤ 25m/s

Available Range:

Sealed Medium: oil, water, organic solvent or other corrosive solvent

Pressure in the sealed chamber : ≤ 4Mpa

Temperature in the sealed chamber: -40℃ ~200℃

Linear velocity: ≤ 25m/s

HQ502 型尺寸表 Dimension Table

公称轴径 d	d _s	d ₄	d ₅	d ₇	d ₁₀	D ₁	e	L ₁ (k)	L ₂	L ₃	L ₅	L ₆	L ₉	
14	14	24	26	21	25	6.5	30	4	35.0	5.0	23.0	1.5	4	12.0
16	16	26	28	23	27	6.5	32	4	35.0	5.0	23.0	1.5	4	12.0
18	18	32	34	27	33	6.5	38	4	37.5	7.5	24.0	2.0	5	13.5
20	20	34	36	29	35	6.5	40	4	37.5	7.5	24.0	2.0	5	13.5
22	22	36	38	31	37	6.5	42	4	37.5	7.5	24.0	2.0	5	13.5
24	24	38	40	33	39	6.5	43	4	40.0	7.5	26.7	2.0	5	13.3
25	25	39	41	34	40	6.5	46	4	40.0	7.5	27.0	2.0	5	13.0
28	28	42	44	37	43	6.5	48	4	42.5	7.5	30.0	2.0	5	12.5
30	30	44	46	39	45	6.5	50	4	42.5	7.5	30.5	2.0	5	12.0
32	32	46	48	42	48	6.5	53	4	42.5	8.0	30.5	2.0	5	12.0
33	33	47	49	42	48	6.5	53	4	42.5	8.0	30.5	2.0	5	12.0
35	35	49	51	44	50	6.5	60	4	42.5	8.0	30.5	2.0	5	12.0
38	38	54	58	49	56	6.5	62	6	45.0	10.0	32.0	2.0	6	13.0
40	40	56	60	51	58	6.5	65	6	45.0	10.0	32.0	2.0	6	13.0
43	43	59	63	54	61	6.5	67	6	45.0	12.0	32.0	2.0	6	13.0
45	45	61	65	56	63	6.5	70	6	45.0	12.0	32.0	2.0	6	13.0
48	48	64	68	59	66	6.5	72	6	45.0	12.0	32.0	2.0	6	13.0
50	50	66	70	62	70	6.5	75	6	47.5	12.0	34.0	2.5	6	13.5
53	53	69	73	65	73	6.5	77	6	47.5	12.0	34.0	2.5	6	13.5
55	55	71	75	67	75	6.5	86	6	47.5	12.0	34.0	2.5	6	13.5
58	58	78	83	70	78	6.5	88	6	52.5	14.0	39.0	2.5	6	13.5
60	60	80	85	72	80	6.5	91	6	52.5	14.0	39.0	2.5	6	13.5
63	63	83	88	75	83	6.5	93	6	52.5	14.0	39.0	2.5	6	13.5
65	65	85	90	77	85	6.5	96	6	52.5	14.0	39.0	2.5	6	13.5
68	68	88	93	81	90	6.5	98	6	52.5	14.0	39.0	2.5	7	13.5
70	70	89	95	83	92	6.5	103	6	60.0	14.0	45.5	2.5	7	14.5
75	75	96	104	88	97	6.5	108	6	60.0	14.0	45.5	2.5	7	14.5
80	80	104	109	95	105	9.5	120	6	60.0	14.0	45.0	3.0	7	15.0
85	85	108	114	100	110	9.5	125	6	60.0	14.0	45.0	3.0	7	15.0
90	90	114	119	105	115	9.5	130	6	65.0	14.0	50.0	3.0	7	15.0
95	95	118	124	110	120	9.5	135	6	65.0	14.0	50.0	3.0	7	15.0
100	100	124	129	115	125	9.5	140	6	65.0	14.0	50.0	3.0	7	15.0

如需了解进一步的信息和有关数据，请与本公司工程技术部联系。
 If you would like to know more information and relevant data, please contact the technology department.

HG9 型机械密封

Type HG9 mechanical seals



结构特点：

HG9 型机械密封属于单端面，非平衡型橡胶波纹管结构，HG9 型机械密封其 G60 符合 DIN24960 标准，G50 符合欧洲标准，G55 符合美国标准，其浮动调节性能好，可以增强或减少弹簧的圈数来适应轴向安装要求。结构简单、安装方便、工作性能良好，被国际权威水泵厂认可，深受用户的欢迎。

摩擦副材质与辅助密封材质请根据实际工况条件进行选用。

Structure Features:

The mechanical seal of type HG9 is single face, unbalanced rubber bellow structure. Rectangular seats with rubber cup, available ex stock in three fitting dimensions: G60(DIN24960). G50(Euro standard, mainly metric). G55(us-standard, mainly inch-based), and fine floating adjustability, and length adaptability due to varying spring lengths, and compact one-piece bellows unit with fixed seal face, ensures optimum installation and operation Technically approved by leading international pump manufacturers.

Sub-materials of friction and auxiliary materials should be selected according to operation condition.

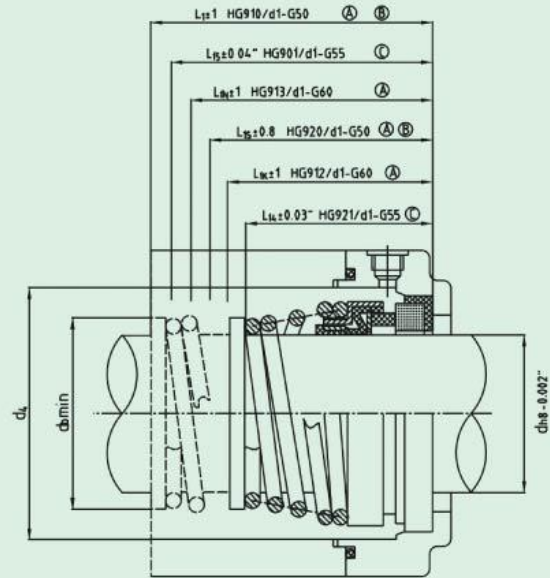

适用范围：

被密封介质：冷水、热水、饮料、弱酸弱碱、含颗粒物的各种介质。

密封腔压力： $\leq 0.8\text{Mpa}$

密封腔温度： $-20^{\circ}\text{C} \sim 140^{\circ}\text{C}$

线速度： $\leq 10\text{m/s}$

Available Range:

Sealed medium: cold and hot water, beverages, suspensions.

Pressure in the sealed chamber: $\leq 0.8\text{Mpa}$

Temperature in the seal chamber: $-20^{\circ}\text{C} \sim 140^{\circ}\text{C}$

Linear velocity: $\leq 10\text{m/s}$

规格Specification	给水管crane*	密封垫Seal	尺寸	Dimensions	表格 Table
HG910/d1-G50v	1A	43CE	长英寸/毫米	long inches/mm	B
	1A	43CE	长毫米	long mm	A
HG920/d1-G50	2	43CE	短英寸/毫米	short inches/mm	B
	2	43CE	短毫米	short mm	A
HG901/d1-G55	1	43CU	长英寸(限于美国)	long inches(USA only)	C
HG921/d1-G55	2	43CU	短英寸(限于美国)	short inches(USA only)	C
	21	43CU	短英寸(限于美国)	short inches(USA only)	C
HG912/d1-G60	502	43DIN	毫米	mm	A
	521	43DIN	毫米	mm	A
	2100-11K	43DIN	毫米	mm	A
HG913/d1-G60	2100-11N		毫米	mm	A

如需了解进一步的信息和有关数据，请与本公司工程技术部联系。
 If you would like to know more information and relevant data, please contact the technology department.

FBC 型机械密封

Type FBC mechanical seals

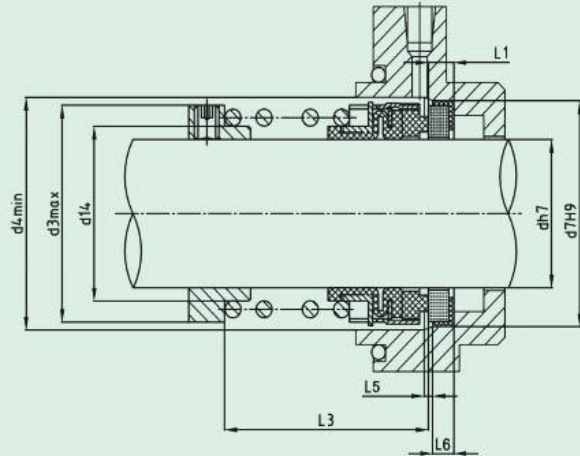

结构特点：

FBC 型机械密封由于采用了橡胶波纹管，可以补偿轴的径向跳动，并且提高了旋转环的浮动性，减少了补偿阻力。采用单弹簧，不易堵塞。

摩擦副材质与辅助密封材质请根据实际工况选用。

Structure Features:

Due to the adoption of rubber bellow, the radial run-out is compensated and the floatability of rotating ring is increased to reduce the negating force. Single spring to avoid blocking.

Friction-resistant sub-materials and auxiliary seal material will be selected based upon operating conditions.

Sub-materials of friction and auxiliary materials should be selected according to operation condition.

适用范围：

被密封介质：油、水及其它弱腐蚀性溶液。

密封腔压力：≤ 0~1.4Mpa

密封腔温度：-20℃ ~150℃

线速度：≤ 15m/s

Available Range:

Sealed Medium: oil, water and other weak corrosive solvents,

Pressure in the sealed chamber: ≤ 0~1.4Mpa

Temperature in the sealed chamber: -20℃ ~150℃

Linear velocity: ≤ 15m/s

HBC 型尺寸表 Dimension Table

公称轴径	d	d ₃	d ₄	d ₇	d ₁₀	L ₁	L ₃	L ₅	L ₆
16	16	34.0	37	30	5	8	25	1.5	6
18	18	36.8	40	32	5	8	25	2.0	6
20	20	38.8	42	34	5	8	25	2.0	6
22	22	41.5	45	36	5	8	25	2.0	6
25	25	44.8	48	39	5	8	26	2.0	6
28	28	48.5	52	43	5	8	26	2.0	6
30	30	52.0	55	48	5	8	26	2.0	7
35	35	57.0	60	53	5	10	30	2.0	8
40	40	67.0	70	58	5	10	34	2.0	8
45	45	73.0	76	63	5	10	36	2.0	8
50	50	79.0	81	68	8	10	41	2.5	8
55	55	84.0	87	73	8	12	41	2.5	10
60	60	90.0	95	79	8	12	41	2.5	10
65	65	98.5	104	86	8	12	49	2.5	10
70	70	103.5	109	91	8	12	52	2.5	10
75	75	110.5	116	96	8	12	52	2.5	10
80	80	120.0	125	105	11	14	56	3.0	12
85	85	125.0	130	110	11	14	56	3.0	12
90	90	132.0	137	115	11	14	56	3.0	12
95	95	137.0	142	120	11	14	56	3.0	12
100	100	144.0	149	125	11	14	62	3.0	12
110	110	157.0	162	135	11	16	62	3.0	14
120	120	169.5	175	145	11	16	72	3.0	14

如需了解进一步的信息和有关数据，请与本公司工程技术部联系。
 If you would like to know more information and relevant data, please contact the technology department.



FBD 型机械密封

Type FBD mechanical seals

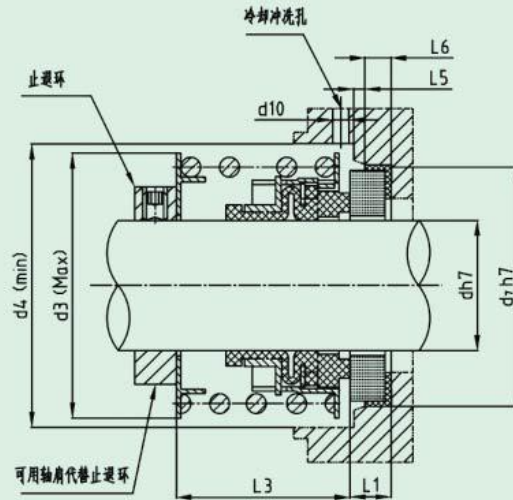

结构特点：

由于采用了橡胶波纹管，可以补偿轴的径向跳动，并且提高了旋转环的浮动性，减少了补偿阻力。采用单弹簧，不易堵塞。

摩擦副材质与辅助密封材质请根据实际工况选用。

Structure Features:

Due to the adoption of rubber bellow, the radial run-out is compensated and the floatability of rotating ring is increased to reduce the negating force. Single spring to avoid blocking.

Sub-materials of friction and auxiliary materials should be selected according to operation condition.

适用范围：

被密封介质：油、水及其它弱腐蚀性溶液。

密封腔压力： $\leq 1.4\text{Mpa}$

密封腔温度： $-20^{\circ}\text{C} \sim 150^{\circ}\text{C}$

线速度： $\leq 15\text{m/s}$

Available Range:

Sealed Medium: oil, water and other weak corrosive solvents.

Temperature in the sealed chamber: $\leq 1.4\text{Mpa}$

Temperature in the sealed chamber: $-20^{\circ}\text{C} \sim 150^{\circ}\text{C}$

Linear velocity: $\leq 15\text{m/s}$

FBD 型尺寸表 Dimension Table

公称轴径	d	d ₃	d ₄	d ₇	d ₁₀	L ₁	L ₃	L ₅	L ₆
16	16	34.0	37	30	5	8	25	1.5	6
18	18	36.8	40	32	5	8	25	2.0	6
20	20	38.8	42	34	5	8	25	2.0	6
22	22	41.5	45	36	5	8	25	2.0	6
25	25	44.8	48	39	5	8	26	2.0	6
28	28	48.5	52	43	5	8	26	2.0	6
30	30	52.0	55	48	5	8	26	2.0	7
35	35	57.0	60	53	5	10	30	2.0	8
40	40	67.0	70	58	5	10	34	2.0	8
45	45	73.0	76	63	5	10	36	2.0	8
50	50	79.0	81	68	8	10	41	2.5	8
55	55	84.0	87	73	8	12	41	2.5	10
60	60	90.0	95	79	8	12	41	2.5	10
65	65	98.5	104	86	8	12	49	2.5	10
70	70	103.5	109	91	8	12	52	2.5	10
75	75	110.5	116	96	8	12	52	2.5	10
80	80	120.0	125	105	11	14	56	3.0	12
85	85	125.0	130	110	11	14	56	3.0	12
90	90	132.0	137	115	11	14	56	3.0	12
95	95	137.0	142	120	11	14	56	3.0	12
100	100	144.0	149	125	11	14	62	3.0	12
110	110	157.0	162	135	11	16	62	3.0	14
120	120	169.5	175	145	11	16	72	3.0	14

如需了解进一步的信息和有关数据，请与本公司工程技术部联系。
If you would like to know more information and relevant data, please contact the technology department.

HU21 型机械密封

Type HU21 mechanical seals

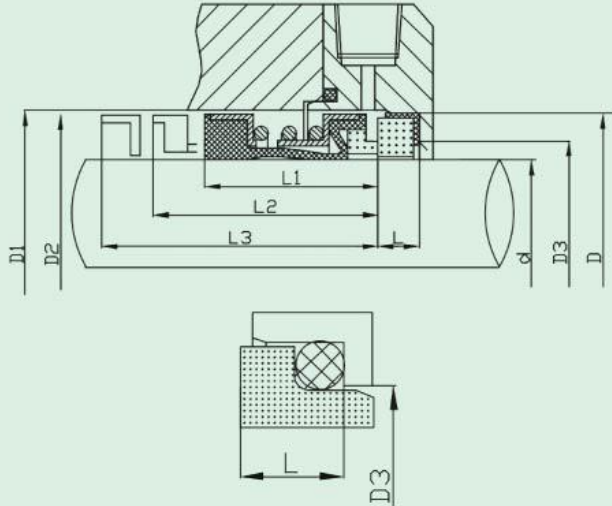

结构特点:

HU21型机械密封符合DIN24960标准, 采用单弹簧、单端面、橡胶波纹管, 非平衡型结构, 动环非波纹管过盈量驱动, 浮动性好, 拨叉传递扭矩。

Structure Features:

The mechanical seal of type HU21 is accord to DIN24960, using single-spring single face. Tubber Bellows unbalanced structure, rotary seal driving more than non-Bellows, torque transmission with.

The spring play rodes of. The torque Transmission.

适用范围:

被密封介质: 含颗粒的水、油等一般腐蚀性介质。

密封腔压力: $\leq 1.0\text{Mpa}$

密封腔温度: $-20^{\circ}\text{C}\sim 120^{\circ}\text{C}$

线速度: $\leq 15\text{m/s}$

Available Range:

Sealed Medium: liquid water, efratns, oil, sewage water.

Pressure in the sealed chamber: $\leq 1.0\text{Mpa}$

Temperature in the sealed chamber: $-20^{\circ}\text{C}\sim 120^{\circ}\text{C}$

Linearvelocity: $\leq 15\text{m/s}$

HU21 型尺寸表 Dimension Table

公称轴径	$d_{(H7)}$	$D_{(H8)}$	D_3	D_2	D_1	L_1	L_2	L_3	L
10	10	21	17	20	22	15	27.5	35.0	5
12	12	23	19	22	24	15	26.5	34.0	6
14	14	25	21	24	26	15	29.0	34.0	6
15	15	25	22	25	27	15	29.0	34.0	6
16	16	27	23	26	28	15	29.0	34.0	6
18	18	33	27	32	34	20	31.5	39.0	6
20	20	35	29	34	36	20	31.5	39.0	6
22	22	37	31	36	38	20	31.5	39.0	6
24	24	39	33	38	40	20	34.0	44.0	6
25	25	40	34	39	41	20	34.0	44.0	6
28	28	43	37	42	44	26	36.5	44.0	6
30	30	45	39	44	46	26	35.5	43.0	7.5
32	32	48	42	46	48	26	35.5	48.0	7
33	33	48	42	47	49	26	35.5	48.0	7
35	35	50	44	49	51	26	34.5	47.0	7
38	38	56	49	54	58	30	37.0	47.0	8
40	40	58	51	56	60	30	37.0	47.0	8
43	43	61	54	59	63	30	37.0	52.0	8
45	45	63	56	61	65	30	37.0	52.0	8
48	48	66	59	64	68	30	35.0	50.0	8
50	50	70	62	66	70	30	37.5	50.0	10
53	53	73	65	69	73	30	37.5	60.0	10
55	55	75	67	71	75	30	37.5	60.0	10
58	58	78	70	78	83	33	42.5	60.0	10
60	60	80	72	80	85	33	40.5	58.0	12
63	63	83	75	83	88	33	40.5	58.0	12
65	65	85	77	85	90	33	40.5	68.0	12
68	68	90	81	88	93	33	40.5	68.0	12
70	70	92	83	90	95	33	48.0	68.0	12
75	75	97	88	99	104	40	48.0	68.0	12
80	80	105	95	104	109	40	47.5	77.5	12.5
85	85	110	100	109	114	40	47.5	77.5	12.5
90	90	115	105	114	119	40	52.5	77.5	12.5
95	95	120	110	119	124	40	52.5	77.5	12.5
100	100	125	115	129	129	40	52.5	77.5	12.5

如需了解进一步的信息和有关数据, 请与本公司工程技术部联系。
 If you would like to know more information and relevant data, please contact the technology department.

HQ3272 型机械密封

Type HQ3272 mechanical seals

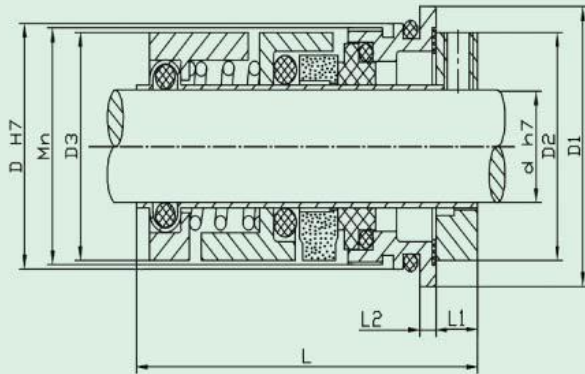

结构特点：

HQ3272 型系列机械密封结构特点：HQ3272 型机械密封主要用于各种进口多级泵，用于各种水处理工况，其紧密的设计和短小的外观尺寸使其可以使用在任何工况，并且安装方便，操作简单。

Structure Features:

Mechanical seals of type HQ3272 series Structure feature: HQ3272 type mechanical seals is applicable for all kinds of imported multistage pump and operation conditions of water treatment .The compact design and short apperence make it be able to use in any work condition and install conveniently, mount simply.

适用范围：

被密封介质：油、水、污水等含一定颗粒的一般腐蚀性介质。

密封腔压力：≤ 1.6Mpa

密封腔温度：-20℃ ~160℃

线速度：≤ 20m/s

Available Range:

Sealed Medium: Oil,water, sewage and containing some grains corrosive agent,etc.

Pressure in the sealed chamber: ≤ 1.6Mpa

Temperature in the sealed chamber: -20℃ ~160℃

Linear velocity: ≤ 20m/s

HQ3272 型尺寸表 Dimension Table

型号规格	d	D	D ₁	D ₂	D ₃	L	L ₁	L ₂	M _n
HQ3272-12	12	28.4	40.6	26	24.9	57	7	4	28x1.5
HQ3272-16	16	32.5	46.1	29	29.0	57	7	4	32x1.5

注：HQ3272 系列机械密封，可根据用户要求开发其它规格，如：现有轴径 φ22 的规格，没有螺纹连接，其它结构大致相同。

如需了解进一步的信息和有关数据，请与本公司工程技术部联系。
 If you would like to know more information and relevant data, please contact the technology department.

204B 型机械密封

Mechanical Seals of Code 204 Series

结构特点:

釜用204B型机械密封为单端面，多弹簧平衡型结构。采用传动螺钉传动。由于采用多弹簧故弹簧压力分布均匀且可调节。平衡结构又使其适应范围较高，故为目前最广泛使用的两种釜用密封之一。适用于化工行业反应釜搅拌轴的密封。

摩擦副材质与辅助密封材质请根据实际工况选用。

Structure Features:

The mechanical seal of code 204B is a single face, multi spring and balanced structure. The transmission of driving screw is adopted. The spring pressure is not only distributed uniformly but also adjustable, adding the balanced structure, the available range of pressure is raised, therefore, now it is one of the two types to be most widely used. Suits to seal the stirring axle of an agitator for chemical industry.

Sub-materials of friction and auxiliary materials should be selected according to operation condition.

适用范围:

被密封介质：选用不同摩擦副材质以适应具有一般腐蚀性或非腐蚀性介质。

密封腔压力： $\leq 0.25\text{--}0.6\text{Mpa}$

密封腔温度： $-40^{\circ}\text{C}\text{--}200^{\circ}\text{C}$

线速度： $\leq 5\text{m/s}$

Available Range:

Sealed Medium= Select various material of friction pairs to suit respective medium of average corrosive or non-corrosive.

Pressure in the sealed chamber: $\leq 0.25\text{--}0.6\text{Mpa}$

Temperature in the sealed chamber: $-40^{\circ}\text{C}\text{--}200^{\circ}\text{C}$

Linear velocity: $\leq 5\text{m/s}$

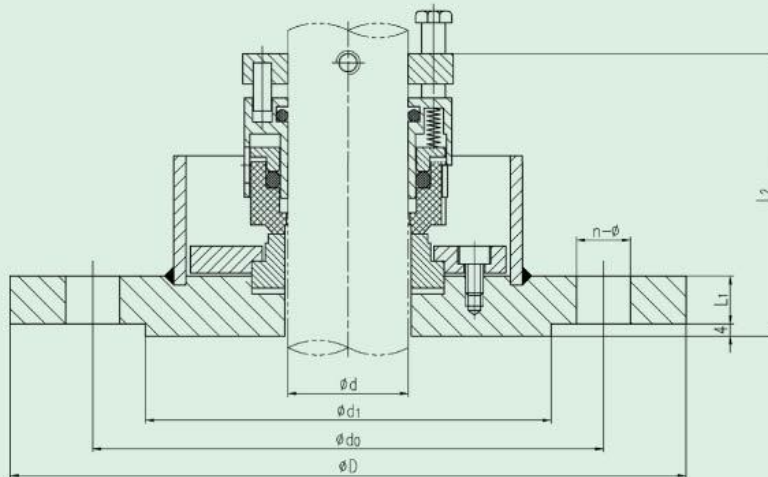

釜用 204B 型尺寸表 Dimension Table

d	d1	d0	D	L1	L2	n-φ
30	116	150	180	20	92	4-18
40	135	170	225	20	92	4-18
45	164	200	235	22	94	8-18
50	164	200	235	22	94	8-18
60	164	200	235	22	94	8-18
65	164	200	235	22	94	8-18
80	188	225	260	22	94	12-18
90	220	255	290	24	94	12-18
95	220	255	290	24	96	12-18
100	245	280	315	24	96	12-18
110	245	280	315	24	96	12-18
120	245	280	315	24	96	12-18
125	245	280	315	24	96	12-18

如需了解进一步的信息和有关数据，请与本公司工程技术部联系。
If you would like to know more information and relevant data, please contact the technology department.



205 型机械密封

Mechanical Seals of Code 205 Series

结构特点:

釜用205型机械密封为双端面，多弹簧非平衡型结构。主要靠密封腔内密封液与被密封介质间的压力差达到密封的目的，密封液另需一套装置来循环，整个系统比较复杂。故仅用于密封易燃易爆，有毒及较强腐蚀性介质的特殊场合。

摩擦副材质与辅助密封材质请根据实际工况选用。

Structure Features:

The mechanical seal of code 205 is double face, multi spring and unbalanced structure. Its sealing function mainly depends on the pressure difference between the sealant circulating in the seal chamber and the seal medium. To circulate the sealant and engender a certain pressure difference, a set of circulating equipment is essential. As a result, the entire system will be complicated; therefore, it is only employed in the special case. Such as, easily exploded combustible, poisonous and for the strictly sealing of more strong corrosive mediums.

Sub-materials of friction and auxiliary materials should be selected according to operation condition.

适用范围:

被密封介质: 易燃、易爆有毒及较强腐蚀性介质。

密封腔压力: $P_1 \leq 0.6 \text{Mpa}$

被密封介质压力 $P_2 = (P_1 - 0.1) \text{Mpa}$

密封腔温度: $-40^\circ\text{C} \sim 250^\circ\text{C}$

线速度: $\leq 20 \text{m/s}$

Available Range:

Sealed Medium: easy exploded, combustible, poisonous and more strong corrosive medium.

Pressure in the seal chamber: $P_1 \leq 0.6 \text{Mpa}$

Pressure of sealed medium: $P_2 = (P_1 - 0.1) \text{Mpa}$

Temperature in the sealed chamber: $-40^\circ\text{C} \sim 250^\circ\text{C}$

Linear velocity: $\leq 20 \text{m/s}$

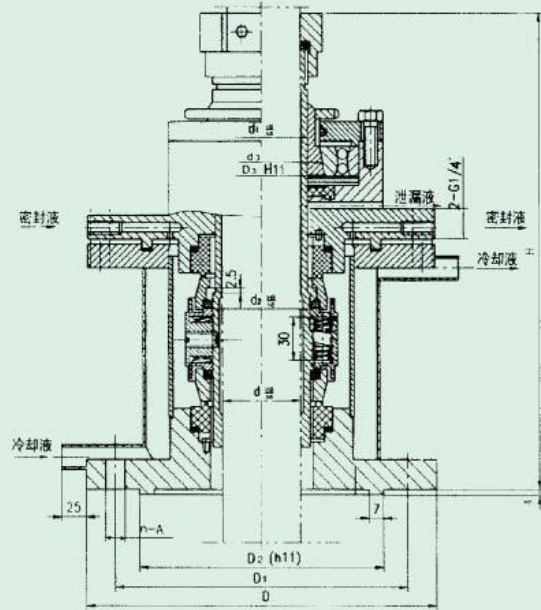

釜用 205 型尺寸表 Dimension Table

公称轴径	$d_{1H8/h8}$	d_{1H6}	$d_{2H8/h8}$	D_1	D_{2H11}	D_{3H11}	D	H	$n-A$
30	30	45	45	150	116	85	185	295	4- $\emptyset 18$
40	40	55	55	170	135	100	225	297	4- $\emptyset 18$
50	50	65	65	200	164	120	235	308	8- $\emptyset 18$
65	65	80	80	200	164	140	235	311	8- $\emptyset 18$
80	80	95	95	225	188	170	260	339	12- $\emptyset 18$
95	95	110	110	255	220	200	290	357	12- $\emptyset 18$
110	110	130	130	280	245	200	315	368	12- $\emptyset 18$

如需了解进一步的信息和有关数据，请与本公司工程技术部联系。
 If you would like to know more information and relevant data, please contact the technology department.



206 型机械密封

Mechanical Seals of Code 206 Series

结构特点：

釜用 206 型机械密封为双端面，多弹簧、平衡型结构。其密封作用主要靠密封腔内的密封液与介质间的压力差来达到。由于密封液的循环需另设一套循环装置，故增加了系统的复杂，陛。所以只用于密封易燃、易爆、有毒及较强腐蚀性介质对密封要求极严的特殊场合。

摩擦副材质与辅助密封材质请根据实际工况选用。

Structure Features:

The mechanical seal of code 206 is double face, multi spring and balanced structure Its sealing function mainly depends on the pressure difference between the sealant circulatina in the seal chainber and the seal medium To circulate the sealant, a set of circulating equipment is essential, As a result, the entire system will be complicated, Therefore, it is only employed in the special case, such as, easily exploded combustibile, poisonous and for the strictly sealing of more strong corrosive mediums,

Sub-materials of friction and auxiliary materials should be selected according to operation condition,

适用范围：

密封介质：易燃、易爆有毒及较强腐蚀性介质。

密封腔压力： $P_1 \leq 1.6\text{Mpa}$

被密封介质压力 $P_2=(P_1-0.1)\text{Mpa}$

密封腔温度： $-40^\circ\text{C} \sim 250^\circ\text{C}$

线速度： $\leq 20\text{m/s}$

Available Range:

Sealed Medium: easy exploded, combustibile, poisonous and more strong corrosive medium,

Pressure in the seal chamber: $P_1 \leq 1.6\text{Mpa}$

Pressure of sealed medium: $P_2=(P_1-0.1)\text{Mpa}$

Temperature in the sealed chamber: $-40^\circ\text{C} \sim 250^\circ\text{C}$

Linear velocity: $\leq 20\text{m/s}$

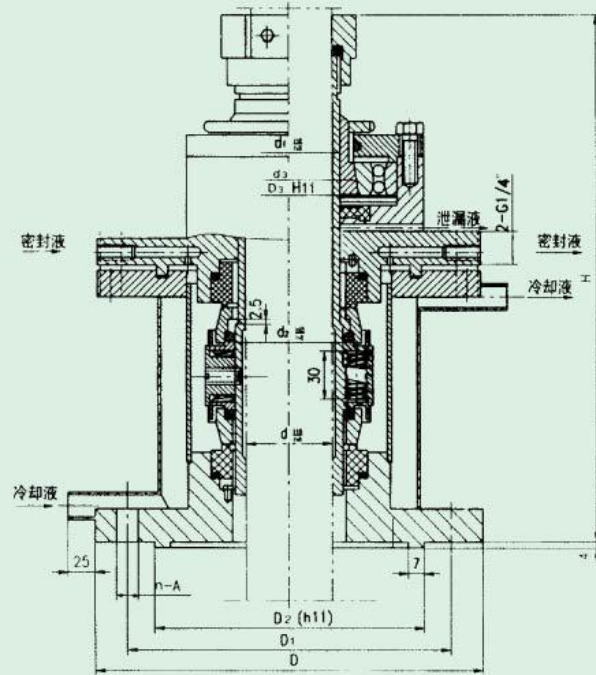

釜用 206 型尺寸表 Dimension Table

公称轴径	$d_{\text{нвнл}}$	$d_{1\text{н}}$	$d_{2\text{нвнл}}$	$d_{3-0.2-0.3}$	D_1	$D_{2\text{н11}}$	$D_{3\text{н11}}$	D	H	$n-A$
30	30	40	45	45	150	116	85	185	293	4- $\varnothing 18$
40	40	50	55	55	170	135	100	225	297	4- $\varnothing 18$
50	50	60	65	65	200	164	120	235	309	8- $\varnothing 18$
65	65	75	80	80	200	164	150	235	316	8- $\varnothing 18$
80	80	90	95	100	225	188	180	260	313	12- $\varnothing 18$
95	95	110	115	120	255	220	215	290	374	12- $\varnothing 18$
110	110	125	130	140	280	245	250	315	397	12- $\varnothing 18$

如需了解进一步的信息和有关数据，请与本公司工程技术部联系。
If you would like to know more information and relevant data, please contact the technology department.



207 型机械密封

Mechanical Seals of Code 207E Series

结构特点：

釜用 207 型机械密封与 206 型具有相似的结构，但承压能力提高到 2.5Mpa，同样地，由于需要比较复杂的循环系统，故仅使用在易燃、易爆、有毒或腐蚀性较强对密封要求极严的场合。

摩擦副材质与辅助密封材质请根据实际工况选用。

Structure Features:

The mechanical seal of code 207 is the same of the mechanical seal of code 206, but the capacity of bearable pressure is raised to a higher pressure class, reaches 2.5Mpa. As the same, since a more complicate circulating system is needed, therefore, it is only employed in the special case, such as, easy-exploded, combustible, poisonous and for the strictly sealing of more strong corrosive mediums.

Sub-materials of friction and auxiliary materials should be selected according to operation condition.

适用范围：

被密封介质：易燃、易爆有毒及较强腐蚀性介质。

密封腔压力： $P_1 \leq 2.5\text{Mpa}$

被密封介质压力 $P_2=(P_1-0.1)\text{Mpa}$

密封腔温度： $\leq 70^\circ\text{C}$

线速度： $\leq 5\text{m/s}$

Available Range:

Sealed Medium: Easy exploded, combustible, poisonous and more strong corrosive medium.

Pressure in the seal chamber: $P_1 \leq 2.5\text{Mpa}$

Pressure of sealed medium: $P_2=(P_1-0.1)\text{Mpa}$

Temperature in the sealed chamber: $\leq 70^\circ\text{C}$

Linear velocity: $\leq 5\text{m/s}$

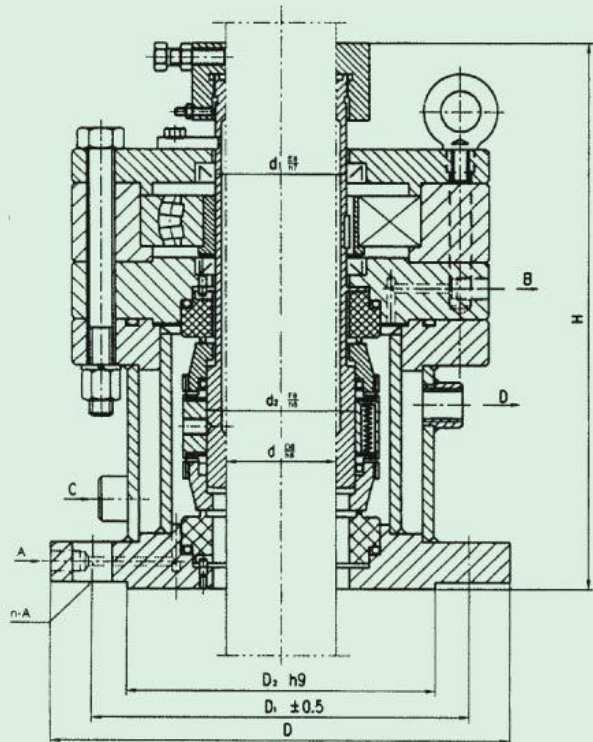

釜用 207E 型尺寸表 Dimension Table

公称轴径	d	d ₁	d ₂	D ₁	D ₂	D	H	n-A
65	65	75	80	250	203	300	335	8- ϕ 18
80	80	90	95	250	203	300	335	12- ϕ 18

如需了解进一步的信息和有关数据，请与本公司工程技术部联系。
 If you would like to know more information and relevant data, please contact the technology department.

212 型机械密封

Mechanical Seals of Code 212 Series

结构特点：

釜用 212 型机械密封为单端面、多弹簧、非平衡型结构。专门为耐腐蚀搪玻璃反应釜搅拌轴的密封而设计，采用氧化铝陶瓷静环和带波纹管的填充四氟乙烯动环。为防止干摩擦，密封浸设在敞开式的贮液槽内。其下部与釜体连接部份可另设一带四氟乙烯衬套的冷却水套，以减少釜体传导给密封的热量 and 搅拌轴的偏摆。

摩擦副材质与辅助密封材质请根据实际工况选用。

Structure Features:

The mechanical seal of code 212 is single face, multi spring and unbalanced structure. Specially designed to seal the stirring axle enameled by spreader glass used in the strongly corrosion-resistance agitators for this purpose, the stators ring of ceramic and rotating ring of filled fluor plastic attached with a bellows are adopted. To avoid the dry-friction, the seal is submerged into a opening tank filling with lubricating fluid. Under the seal, a cooling jacket with a filled PTFE bush may be added to reduce the heat conducted from the agitator to the seal and bswing of the stirring axle.

Sub-materials of friction and auxiliary materials should be selected according to operation condition.

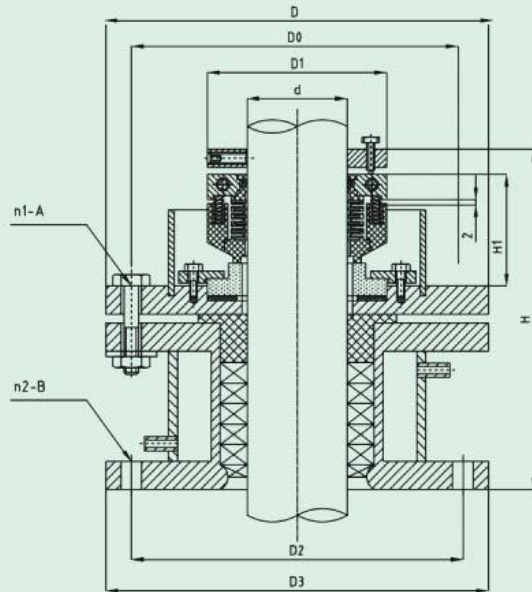

适用范围：

被密封介质：各种较强腐蚀性介质。
 密封腔压力： $\leq 0.5\text{Mpa}$
 密封腔温度： $-10^{\circ}\text{C} \sim 120^{\circ}\text{C}$
 线速度： $\leq 5\text{m/s}$

Available Range:

Sealed Medium: Various more strong corrosive mediums.
 Pressure in the sealed chamber: $\leq 0.5\text{Mpa}$
 Temperature in the sealed chamber: $-10^{\circ}\text{C} \sim 120^{\circ}\text{C}$
 Linear velocity: $\leq 5\text{m/s}$

釜用 212 型尺寸表 Dimension Table (69 标)

公称轴径	d	D	D0	D1	D2	D3	H	H1	n1-A	n2-B
60	60	200	170	110	190	220	180	66	8- $\emptyset 13$	10- $\emptyset 16$
70	70	220	190	120	250	280	180	66	10- $\emptyset 13$	16- $\emptyset 16$
76	76	220	190	130	250	280	180	66	10- $\emptyset 13$	16- $\emptyset 16$
80	80	220	190	130	250	280	180	66	10- $\emptyset 13$	16- $\emptyset 16$
89	89	220	190	140	250	280	180	66	10- $\emptyset 13$	16- $\emptyset 16$
95	95	230	200	150	300	330	180	66	10- $\emptyset 13$	20- $\emptyset 16$

釜用 212 型尺寸表 Dimension Table (79 标)

公称轴径	d	d	D0	D1	D2	D3	H1	H	n1-A	n2-B
40	40	170	140	90	130	160	66	180	6- $\emptyset 13$	4- $\emptyset 14$
50	50	200	170	100	150	185	66	180	8- $\emptyset 13$	4- $\emptyset 18$
65	65	220	190	115	170	205	66	180	10- $\emptyset 13$	4- $\emptyset 18$
80	80	220	190	130	200	235	66	180	10- $\emptyset 13$	4- $\emptyset 18$
95	95	230	200	150	200	235	66	180	10- $\emptyset 13$	4- $\emptyset 18$
102	102	230	200	150	255	290	66	180	10- $\emptyset 13$	4- $\emptyset 18$

如需了解进一步的信息和有关数据，请与本公司工程技术部联系。
 If you would like to know more information and relevant data, please contact the technology department.

HQM481 型机械密封

Mechanical Seals of Code HQM481 Series

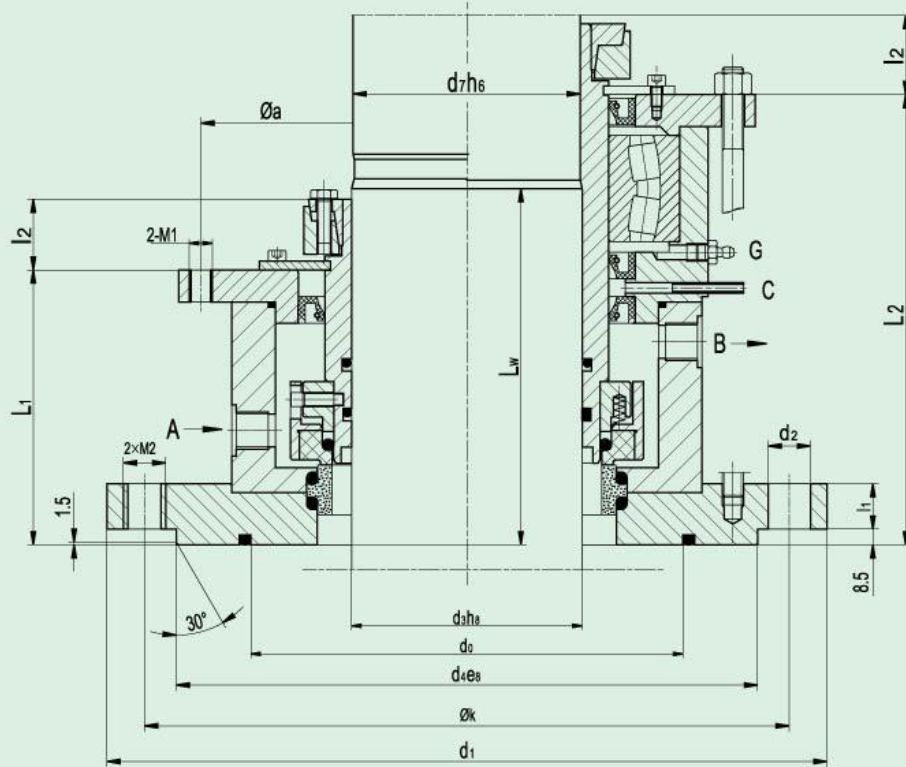

结构特点：

非平衡型；任意旋向；集装式；联接尺寸按 DIN 标准
 HQM481 系列釜用机械密封由生产厂完成组装和测试，按照 DIN28136 标准用在碳钢或不锈钢反应釜上。法兰装配尺寸符合 DIN28141 标准，轴套尺寸按 DIN28154 标准。

HQM481K

单端面密封

HQM481KL

单端面密封，附有骨架油封和轴承。

Structure Features:

Unbalanced ; Independent of direction of rotation ;
 Cartridge unit ;

Connections according to DIN

Agitator seals of the M481 range are factory assembled and tested units. For use on carbon steel and stainless steel vessels in conformance with DIN 28136.

The fitting dimensions of the mounting flanges are in accordance with DIN 28141. The sleeve dimensions comply with shaft details given in DIN 28154.

HQM481K

Single seal

HQM481KL

Single seal with integrated floating bearing.

Operation of single seals only with pressureless quench.

适用范围：

轴径 = 40 ... 220 mm

压力 = 真空 ... 6 bar (M481K-D and M481KL-D: up to 16 bar)

温度 = -10℃ ...+200 (350)℃ (M481K and M481KL: = up to 150 (250)℃)

线速度 = 2 m/s

Available range :

Diameter of axle = 40 ... 220 mm

Pressure = vacuum ... 6 bar (M481K-D and M481KL-D: up to 16 bar)

Temperature =-10℃ ...+200 (350)℃ (M481K and M481KL: = up to 150 (250)℃)

Linear velocity =2 m/s



HQM481K-D 型机械密封

Type HQM481K-D Mechanical Seals

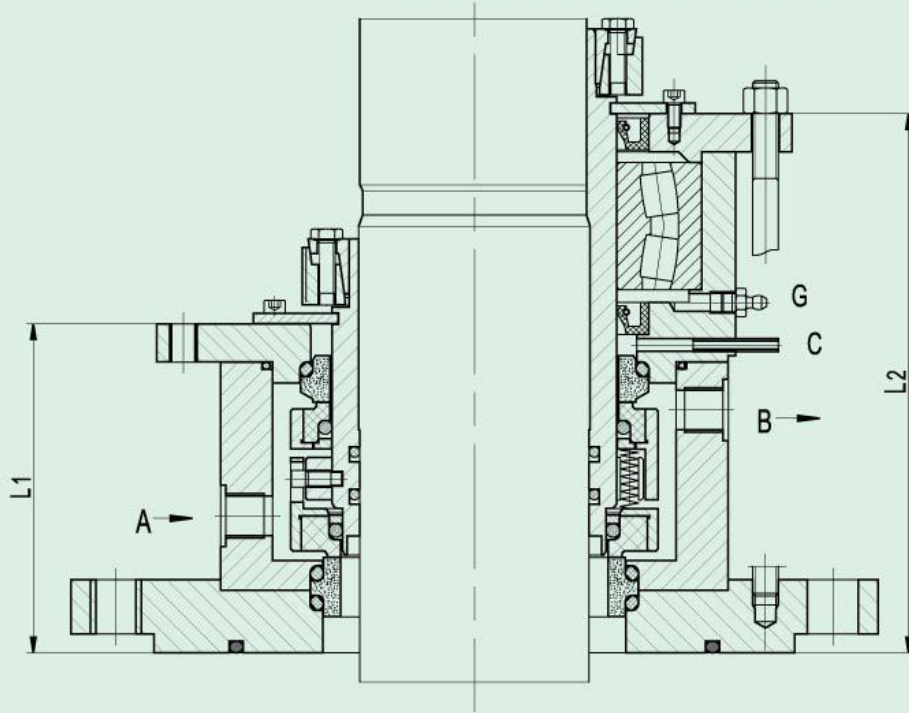

结构特点：

HQM481K-D

双端面密封

HQM481KL-D

双端面密封，附有骨架油封和轴承。

此种密封在介质端被设计成自闭式结构，即：当压力变化或反方向时保持端面闭合。

($P_{max}=0.6\text{Mpa}$ 或 $\Delta P_{max}=0.6\text{Mpa}$ ，当 $P_1 > P_3$ 时)，考虑到大气侧密封，双封时缓冲液加压可用到 $P_1=0.6\text{Mpa}$

Structure Features:

HQM481K-D

Double seal

HQM481KL-D

Double seal with integrated floating bearing

These seals are designed to be self-closing on the product side, i.e. they will remain closed even with pressure variations or a pressure reversal. Operation is optionally the same as for the single version ($P_{max} = 6 \text{ bar}$ or $\Delta P_{max} = 6 \text{ bar}$ at $p_1 > p_3$). In view of the mechanical seal on the atmosphere side it can be used as a buffer pressurized double seal $p_1 = 16 \text{ bar}$.

$d_3^{1)}$	$d_7^{1)}$	d_1	$n \times d_2$	d_4	d_0	ϕk	L_1	L_2	$L_w^{2)}$	l_1	l_2	a	M	M_2	A,B
40	38	175	4*18	110	90	145	110.5	159.5	142	15	28	122	M12	M16	G3/8
50	48	240	8*18	176	135	210	114.5	174.5	148	17	28	157	M12	M16	G3/8
60	58	240	8*18	176	135	210	119.0	181.5	158	17	28	168	M12	M16	G3/8
80	78	275	8*22	204	155	240	133.0	217.5	168	20	34	203	M16	M20	G1/2
100	98	305	8*22	234	190	270	137.5	218.5	178	20	34	228	M16	M20	G1/2
125	120	330	8*22	260	215	295	138.5	233.5	203	20	40	268	M20	M20	G1/2
160	135	395	12*22	313	250	350	152.5	250.5	208	20	40	285	M20	M20	G1/2
140	150	395	12*22	313	265	350	161.0	253.0	213	25	40	297	M20	M20	G1/2
180	170	445	12*22	364	310	350	166.0	263.5	233	25	45	322	M24	M20	G1/2
200	190	445	12*22	364	310	400	171.0	271.0	243	25	45	352	M24	M20	G1/2
220	210	505	16*22	422	340	460			263	25			M24	M20	G1/2



HQSH-D 型机械密封

Type HQSH-D Mechanical Seals

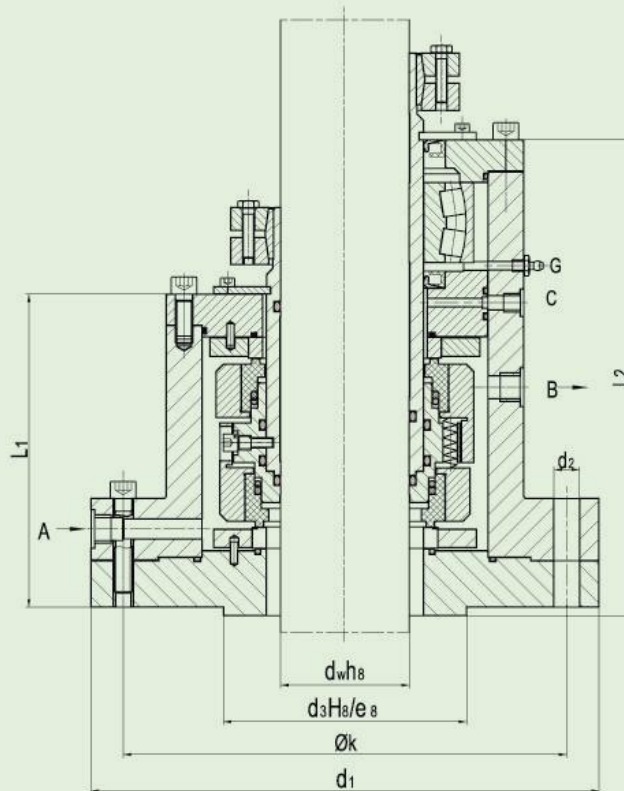

结构特点：

顶部驱动；平衡型；任意旋向；集装式密封；水力平衡静环型式

HQSH-D 系列釜用密封是为高压工况特殊设计的，运转时缓冲液必须带压，尺寸可以按用户要求专门设计。

HQSH-D

双端面密封

HQSHL-D

双端面密封，带有轴承的双封

HQSH-D

Double seal

HQSHL-D

Double seal with integrated floating bearing

适用范围：

轴径 = 20 ... 350 mm

压力 = 4 ... 25 (40) bar

温度 = -20℃ ... +200 (350) °C

Structure Features:

Top entry drive ; Balanced ; Independent of direction of rotation ; Cartridge unit ;Hydraulically balanced ; stationary seats

Agitator seals of the HQSH-D range are designed and built specially for highpressure applications. They are operated solely with pressurised buffer fluid. Dimensions available on request.

Available range :

Diameter of axle = 20 ... 300 mm

Pressure = 4... 25 (40) bar

Temperature = -20℃ ... +200 (350) °C



WED 型换热器

WED Heat Exchanger

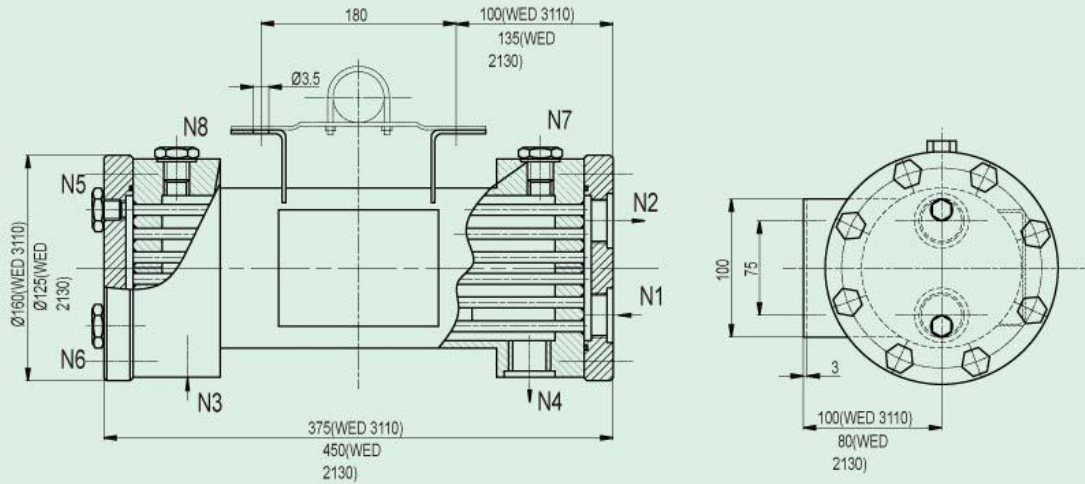

WED2130/A100

WED3110/A110

Heat exchangers

WED 系列换热器在密封

系统中用来冷却缓冲液。

设计为列管式换热器，

WED 的显著的特点是具

有高冷却功率且结构紧

凑。设计、制造和材料

选择符合德国压力容器

规则和 AD 法规，保证

质量。

特性：

缓冲液直接通过壳程，

冷却水通过管程。换热

器可卧式安装也可立式

安装。

打开端盖后，可以清洗

冷却和缓冲介质区域(用

合适的溶剂清洗)。

连接

N2 冷却水 出

N1 冷却水 进

N4 缓冲液

材料

与介质接触的零件为 1.4571

辅助密封：O 型圈：Viton

垫片：PTFE

螺栓：A4-70

技术数据

项 目	WED2130/a100		WED3110/a100	
	管	壳	管	壳
设计压力 (Mpa)	2.5	13	2.5	11
进口温度 (°C)	30	65	30	65
流量 (m³/h)	1	0.5	6	3
容量 (L)	0.23	1.4	0.75	1.8
冷却量 (Kw)	6		36	
净重 (Kg)	14		24	
设计温度 (°C)	150			



可以使双封和串联密封的适用范围更广。缓冲液通过上升的管路流入容器

且被冷却，特别是自然循环，液位必须高于维持循环的管路来保证特殊的冷却效果。密封的连接管路必须设计为阻抗尽可能的小，用压缩空气或氮气加压。

TS 容器可以作为带有所有必要的接管和托架的标准组件来装备。TS 容器安装系统组件可以适合新设备要求或密封的改造。

热虹吸容器被用在密封循环的环路中为缓冲液提供存储、保压和冷却。设计和制造符合德国压力容器规则和 AD 法规，保证质量。



TS2000 型虹吸罐

TS2000 Siphon Tank

TS2000

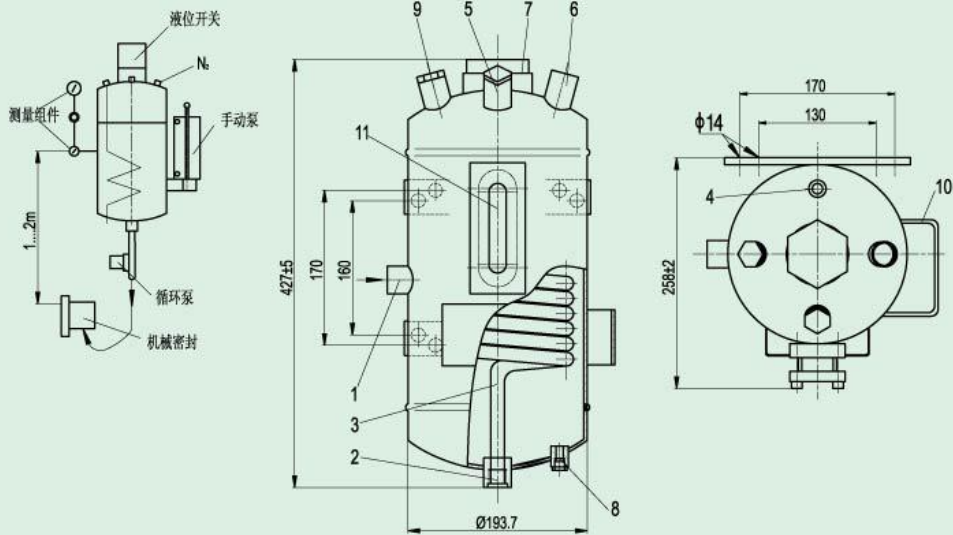

TS2000

赐热虹吸容器为平封头，带有监测液位的视窗和冷却蛇形管。

- 1、缓冲液 进 (G1/2)
- 2、缓冲液 出 (G1/2)
- 3、冷却水 进 (管 12 * 1.5 毫米)
- 4、冷却水 出 (管 12 * 1.5 毫米)
- 5、带盖灌注接头 (G1/2)
- 6、连接加压空气 (1/4 国家标准管螺纹)
- 7、连接开关或压力指示器 (Q2)
- 8、连接补液装置 (1/4 国家标准管螺纹)

技术数据

容 积	9L
冷却管的容积	0.5L
使用压力	3Mpa.
使用温度	-60~+200℃
工作容积	1.8L
冷却功率 (自然循环)	1.5Kw
冷却功率 (强制循环)	4Kw
冷却水流量	0.4m ³ /h
视 窗	硼硅酸玻璃
密封垫	PTFE

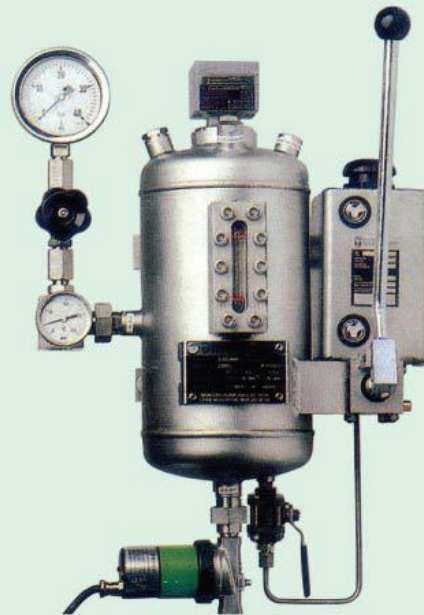



机械密封用材料代号表

The List of Seal Material for Machinery

江苏华青流体科技有限公司机械密封用材料代号表

代号	摩擦副材料	代号	辅助密封材料	代号	弹性元件及结构件材料	机封型号 / 对应博格曼型号		
						机封形式	非平衡型	平衡型
A1	整体浸渍碳石墨	V	氟橡胶	F1	0Cr18Ni9 (304)	机封形式	非平衡型	平衡型
A2	镶装浸渍碳石墨	V1	高温氟橡胶	F2	1Cr18Ni9Ti(321)	键传动	HU3S2/ M7S2	HB3S2/ H7S2
B1K	整体浸渍呋喃树脂碳石墨	K	全氟醚橡胶	G1	0Cr18Ni 12Mo2Ti(316)	泵效应螺纹	HU3F/M7F	HB3F/H7F
B2K	镶装浸渍呋喃树脂碳石墨	P	丁腈橡胶	G2	00Cr17Ni 14Mo2(316L)	波形弹簧	HU3/M7N	HB3/H7N
B1H	整体浸渍环氧树脂碳石墨	P1	氯化丁腈橡胶	M1	哈氏 C	多弹簧	HU34/M74	HB34/H74
B2H	镶装浸渍环氧树脂碳石墨	E	乙丙橡胶	M2	哈氏 B	带弹簧套形式 的多弹簧		HB35/H75
B1F	整体浸渍酚醛树脂碳石墨	N	氟丁橡胶	M3	20# 合金	大弹簧		HB36/H76
B2F	镶装浸渍酚醛树脂碳石墨	S	硅橡胶	M4	蒙乃尔合金			
U1	整体钴基碳化钨	B	丁基橡胶	M5	因可镍 718			
U12	镶装钴基碳化钨	X	氟醇橡胶	T1	双相不锈钢			
U2	整体镍基碳化钨	M1	PTFE 包覆氟橡胶	T2	钛合金			
U22	镶装镍基碳化钨	M2	PTFE 包覆乙丙橡胶	T3	AM350			
U3	整体镍铬基碳化钨	M3	PTFE 包覆硅橡胶	T4	4J42			
U32	镶装镍铬基碳化钨	M4	PTFE 包覆氟丁橡胶	E	2Cr13			
U4	整体碳化钛硬质合金	M5	氯化乙丙烯包覆氟橡胶	D	65Mn			
U42	镶装碳化钛硬质合金	T	聚四氟乙烯					
01	整体反应烧结碳化硅	C	柔性石墨					
012	镶装反应烧结碳化硅	C1	增强柔性石墨垫					
02	整体无压烧结碳化硅	C2	金属柔性石墨缠绕垫					
022	镶装无压烧结碳化硅							
I1	金属表面堆焊钴基 2#							
I2	金属表面喷焊 Ni60							
J1	金属表面喷涂氧化铬							
V	氧化铝陶瓷							
Q	氮化硅							
Y1	填充 20% 玻纤的聚四氟乙烯							
Y2	填充 5% 石墨 15% 玻纤的 聚四氟乙烯							



江苏华青流体科技有限公司
张家港保税区华青机械密封有限公司
JIANG SU HUAQING FLUID TECHNOLOGY CO.,LTD.
ZHANGJIAGANG BONDED HUAQING MECHANICAL SEALS CO.,LTD.

HQ-TH 轴端密封（碳环密封）

HQ-HT Shaft End Mechanical Seal(Carbon Ring Seal)



结构特点:

碳环密封属于流阻型非接触密封，依靠密封间隙的流体阻力效应来限制介质的泄漏。主要用于风机、鼓风机、压缩机和离心机等工业设备的轴封。

结构简单，安装容易，运行可靠，维修方便，不需要复杂的润滑冷却系统，可以干运行。

密封功率消耗低，发热量小。轴的振动和窜动对他几乎无影响。

Structure Features:

Carbon Ring Seal is a flow resistance-type mechanical seal that depends on the effect of seal gap flow resistance to limit medium leak. It is mainly used for industrial equipment shaft seal such as draught fan, air blower, compressor and centrifuge. Its characteristics are simple structure, easy to install, works reliably, easy maintenance, no need complicated lubricating and cooling system. It can dry run.

Seals consume lower power and a small heat. It cannot be barely affected by shaft vibration and traverse.

应用条件:

一般密封气体介质，对于易燃易爆有毒的气体时，可通入隔离气体或隔离液，压力应高于介质压力0.5-1bar，这样可以实现介质的零泄漏。

可根据用户的使用要求进行多种形式的密封环组合。

Application conditions:

Generally, it seals gas medium and can be injected isolated gas or spacer fluid for inflammable and explosive toxic gases. Pressure should be higher than medium pressure 0.5-1bar. This can achieve zero leak of medium.

We can choose a combination of a various form of sealing rings according to customers' requirements.

材料:

密封环（3瓣）：石墨； 金属件：不锈钢或由工况条件定

O型圈和密封垫根据工况条件选择。

适用范围:

轴径=40...340mm

压力=真空...5bar

温度=-20...200（500）℃

Material:

Sealing Ring: graphite

Metal parts: stainless steel(determined by working conditions)

O Ring and gasket are chosen according to working conditions.

Available Range:

Diameter of shaft: 40...340mm

Pressure: vacuum 5bar

Temperature: -20...200(500)℃





HQ-TH 轴端密封（碳环密封）

HQ-HT Shaft End Mechanical Seal(Carbon Ring Seal)

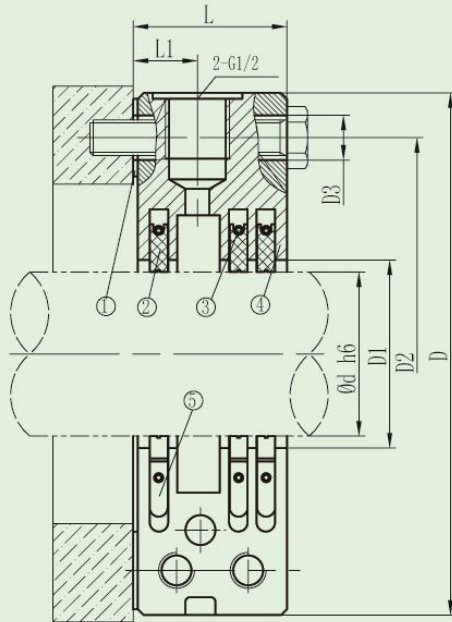

HQ-TH-A

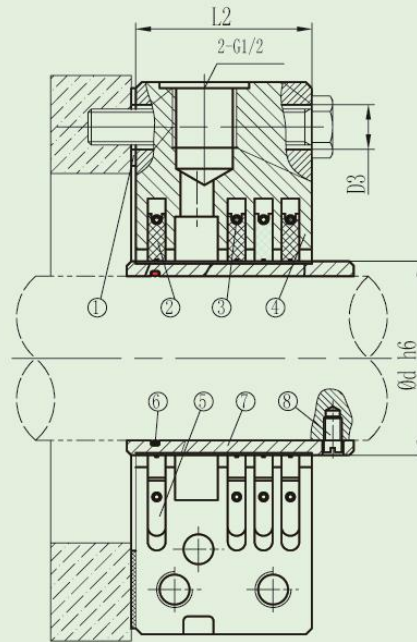

HQ-TH-B

- 1、密封垫 2、密封环（3瓣） 3、拉簧 4、分瓣密封体 5、止动片 6、O型圈 7、轴套 8、防转螺钉
 1. gasket 2. sealing ring(3piece), 3.tension spring, 4. Sub-valve body seal, 5. Stop ring, 6. O ring, 7. Shaft sleeve, 8. anti-rotation screws

HQ-TH-A 安装尺寸表(mm) Dimension Mounting

d	D1	D2	D	L	L1	L2	D3
45	49	135	165	50	20	60	15
50	54	140	170	50	20	60	15
60	64	150	180	50	20	60	15
70	74	160	190	50	20	60	15
80	84	170	200	50	20	60	15
90	94	180	210	50	20	60	15
100	104	190	220	50	20	60	15
110	114	200	230	50	20	60	15
120	124	210	240	50	20	60	15
130	134	220	250	50	20	60	15
140	144	230	260	50	20	60	15
150	154	240	270	50	20	60	15
160	164	250	280	50	20	60	15
170	174	260	290	50	20	60	15
180	184	270	300	50	20	60	15
190	194	280	310	50	20	60	15
200	204	290	320	50	20	60	15

如需了解进一步的信息和有关数据，请与本公司工程技术部联系。 If you would like to know more information and relevant data, please contact the technology department.