

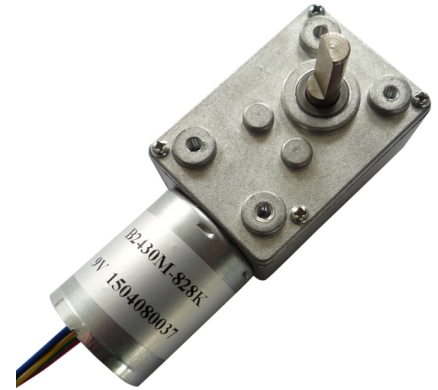

# Dc Gear Motor

## WGM3246-TEC2430 32 x 46 mm worm gearbox plus 370 & 320 dc motor and 24mm brushless motor

- Small size dc gear motor with low speed and big torque
- 32 x 46mm gear motor provide 1.0Nm torque and more reliable
- Suitable to small diameter. Low noise and big torque application
- Reduction ratio: 146、188、300、438、563、700、900、1020、1313、1688、2700

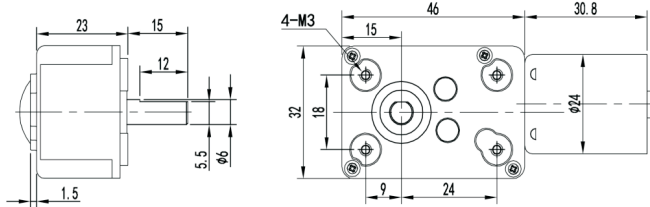

### Motor Technical Data

| Motor model No. | Rated voltage | No-load speed | No-load current | Rated speed | Rated torque | Rated current | Output power | Stall torque | Stall current |
|-----------------|---------------|---------------|-----------------|-------------|--------------|---------------|--------------|--------------|---------------|
|                 | VDC           | r/min         | mA              | r/min       | g.cm         | mA            | W            | g.cm         | A             |
| WGM2430-0645    | 6.0           | 4500          | 180             | 3500        | 62           | 570           | 2.2          | 120          | 1.4           |
| WGM2430-1260    | 12.0          | 6000          | 180             | 4600        | 84           | 800           | 4.6          | 140          | 1.6           |
| WGM2430-2490    | 24.0          | 9000          | 180             | 7200        | 90           | 500           | 6.7          | 180          | 1.9           |

### Gear Motor Technical Data

Gearbox with motor WGM3246-TEC2430-0645-XXX

|                                      | 146 | 188 | 300 | 438 | 563 | 700 | 900 | 1020 | 1313 | 1688 |
|--------------------------------------|-----|-----|-----|-----|-----|-----|-----|------|------|------|
| Reduction ratio                      | 146 | 188 | 300 | 438 | 563 | 700 | 900 | 1020 | 1313 | 1688 |
| Length mm                            | 46  | 46  | 46  | 46  | 46  | 46  | 46  | 46   | 46   | 46   |
| No-load speed rpm                    | 30  | 23  | 15  | 12  | 8   | 6   | 5   | 4    | 3    | 3    |
| Rated speed rpm                      | 24  | 18  | 12  | 10  | 6   | 5   | 4   | 4    | 3    | 3    |
| Rated torque kg.cm                   | 6   | 7   | 10  | 10  | 10  | 10  | 10  | 10   | 10   | 10   |
| Max.momentary tolerance torque kg.cm | 14  | 15  | 15  | 15  | 15  | 15  | 15  | 15   | 15   | 15   |

### Gearbox with motor

WGM3246-TEC2430-1260-XXX

|                                      | 146 | 188 | 300 | 438 | 563 | 700 | 900 | 1020 | 1313 | 1688 |
|--------------------------------------|-----|-----|-----|-----|-----|-----|-----|------|------|------|
| Reduction ratio                      | 146 | 188 | 300 | 438 | 563 | 700 | 900 | 1020 | 1313 | 1688 |
| Length mm                            | 46  | 46  | 46  | 46  | 46  | 46  | 46  | 46   | 46   | 46   |
| No-load speed rpm                    | 40  | 30  | 20  | 13  | 10  | 8   | 6   | 5    | 4    | 3    |
| Rated speed rpm                      | 31  | 25  | 16  | 11  | 9   | 7   | 5   | 5    | 4    | 3    |
| Rated torque kg.cm                   | 8   | 10  | 10  | 10  | 10  | 10  | 10  | 10   | 10   | 10   |
| Max.momentary tolerance torque kg.cm | 15  | 15  | 15  | 15  | 15  | 15  | 15  | 15   | 15   | 15   |

### Gearbox with motor

WGM3246-TEC2430-2490-XXX

|                                      | 146 | 188 | 300 | 438 | 563 | 700 | 900 | 1020 | 1313 | 1688 |
|--------------------------------------|-----|-----|-----|-----|-----|-----|-----|------|------|------|
| Reduction ratio                      | 146 | 188 | 300 | 438 | 563 | 700 | 900 | 1020 | 1313 | 1688 |
| Length mm                            | 46  | 46  | 46  | 46  | 46  | 46  | 46  | 46   | 46   | 46   |
| No-load speed rpm                    | 60  | 47  | 30  | 20  | 16  | 12  | 10  | 8    | 7    | 5    |
| Rated speed rpm                      | 49  | 38  | 25  | 17  | 14  | 11  | 9   | 7    | 7    | 5    |
| Rated torque kg.cm                   | 9   | 10  | 10  | 10  | 10  | 10  | 10  | 10   | 10   | 10   |
| Max.momentary tolerance torque kg.cm | 15  | 15  | 15  | 15  | 15  | 15  | 15  | 15   | 15   | 15   |