

Expandable House PRODUCT BROCHURE

Global Service. Global Promise



CDPH (Hainan) Company Limited

Address: Room A118-102, 4th Floor, Joint Inspection Building
Haikou Comprehensive Bonded Zone, Haikou, Hainan.

Phone: +86 18001125803 / +86 18001120338

Email: cdphfacility@cdph.com.cn / marketing@cdph.com.cn

WhatsApp: +86 18001125803 / +86 18001120338



盛诚（海南）贸易有限公司
CDPH (Hainan) Company Limited



01

COMPANY OVERVIEW

CDPH (Hainan) Company Limited is a subsidiary company and formerly the export department fully owned by Beijing Chengdong International Modular Housing Corporation (CDPH). We have our own 70,000 sqm super factory in Hebei near Tianjin port, with advanced technology and facilities to support production under CE and US standard. Chengdong is a Chinese public listed company with industry experience in prefabricated building since 1998!

Excellence through integrity is our motto since the establishment of Chengdong. We are proud of our quality and expertise in providing one-stop solutions to our customers.

An example for you to know CDPH: Not every factory can fulfill OEM projects for major leading US modular housing companies since 2014 with stable high quality supply to the US market, which proves our top quality!

If you're seeking an absolutely safe and quality house, with years of after service support guarantee, CDPH is your reliable choice!

- 01 Company Overview #1
- 02 Factory Introduction #3
- 03 Certification #5
- 04 Quick Installation #7
- 05 20ft Flat Roof #9
- 06 40ft Flat Roof #11
- 07 20ft Sloping Roof #13
- 08 40ft Sloping Roof #15
- 09 More Options #17
- 10 Customized Options #19

02

Factory Introduction

Our factory is 140 kilometers away from the Beijing Municipal Administrative Center, covering a total area of 70,000 sqm with more than 300 staff.

The core positioning of the factory is as a base of prefabricated housing production, processing, warehousing and logistics. It adopts automated welding robots for the production of core components which is an advanced technology in Chinese mobile housing industry. Its production workshop utilizes the assembly line layout for the cold bending, welding, grinding, spraying, and decoration of the main profiles. The factory also has a material laboratory capable of independent testing of the performance of core main materials.

Our factory serves as a manufacturing center, cost center, service center, quality center, and image center.





03 Certification

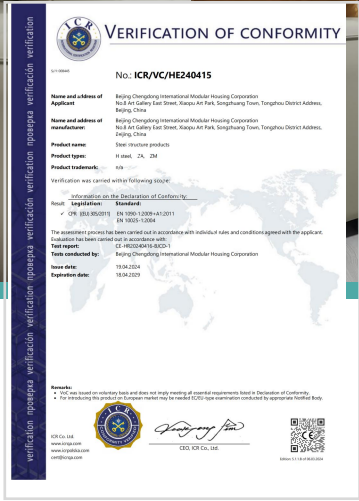

CE



ISO14001



ISO 9001 Quality Cert.



Steel structure project
Class II License

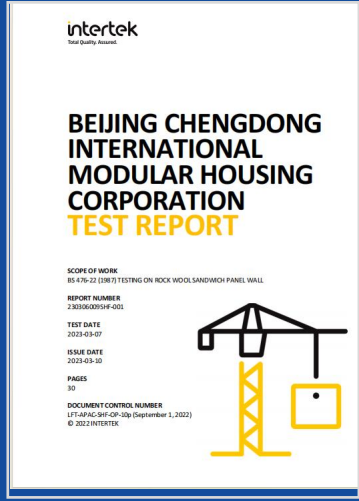

Intertek fire resistant test report



CE-COC



< 5 Certificate of High Tech Enterprise



70+ nos Patents



CWB certification for welding
manufacturing enterprises



American Welder Certificate

20ft

Flat Roof

L5900*W6420*
H2450mm



20ft

Sloping Roof

L5900*W6300*
H2480mm



40ft

Flat Roof

L11800*W6420*
H2450mm



40ft

Sloping Roof

L11800*W6220*
H2480mm



04

Quick installation

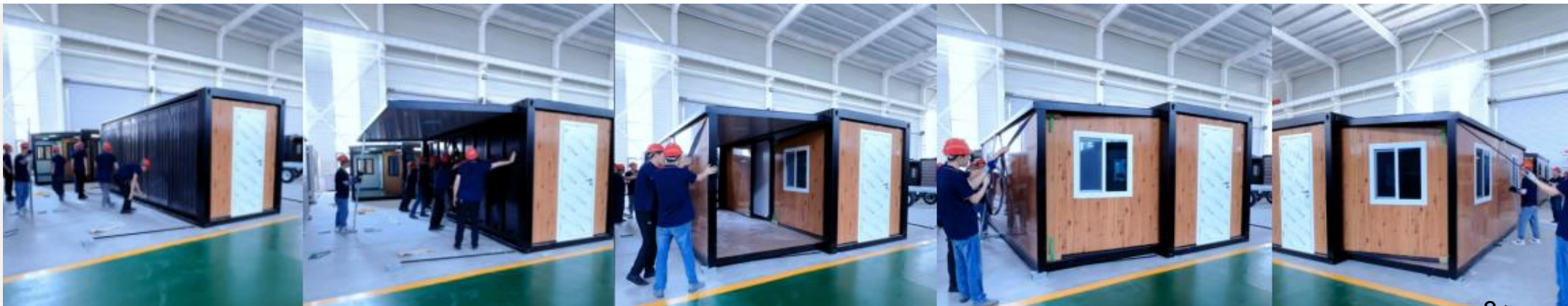

05

20ft FLAT ROOF

Multi storey design available



✓ Standard Info.

Size (mm)	5900 (W) *6240 (L) *2450 (H)
Area	36.8m ²
Weight	3900kg
Loading	2 sets in 40HQ
Wall	EPS / rockwool / PU sandwich panels

06

40ft FLAT ROOF

1 Standard Info.

Size (mm)	11800 (W) *6240 (L) *2450 (H)
Area	73.6m ²
Weight	5600kg
Loading	1 set in 40HQ



2 Options

- Bedroom: 1-5
- Living Room: 1-2
- Kitchen: 1
- Bathroom: 1

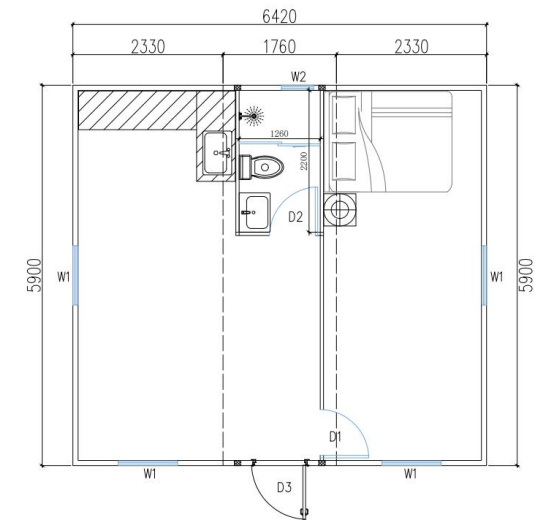

07

20ft SLOPING ROOF

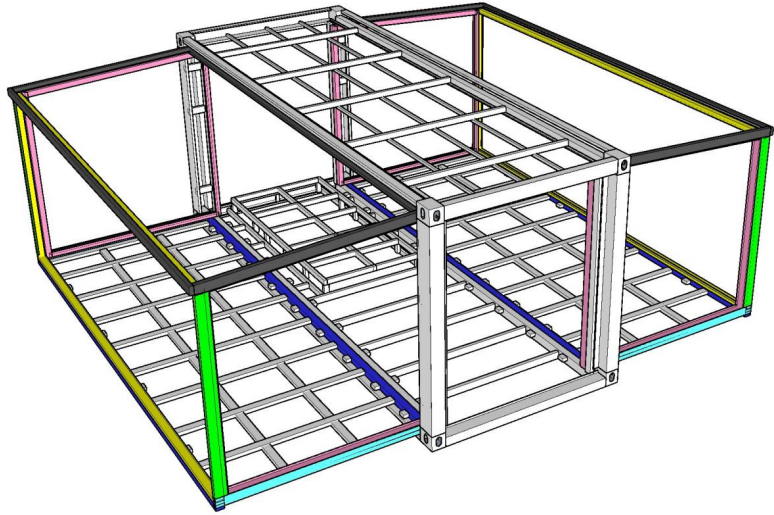

Size (mm)	5900 (W) *6300 (L) *2480 (H)
Area	37.2m ²
Weight	3300kg
Loading	2 sets in 40HQ

08

40ft SLOPING ROOF

Size (mm)	11800 (W) *6220 (L) *2480 (H)
Area	73.4m ²
Weight	5300kg
Loading	1 set in 40HQ

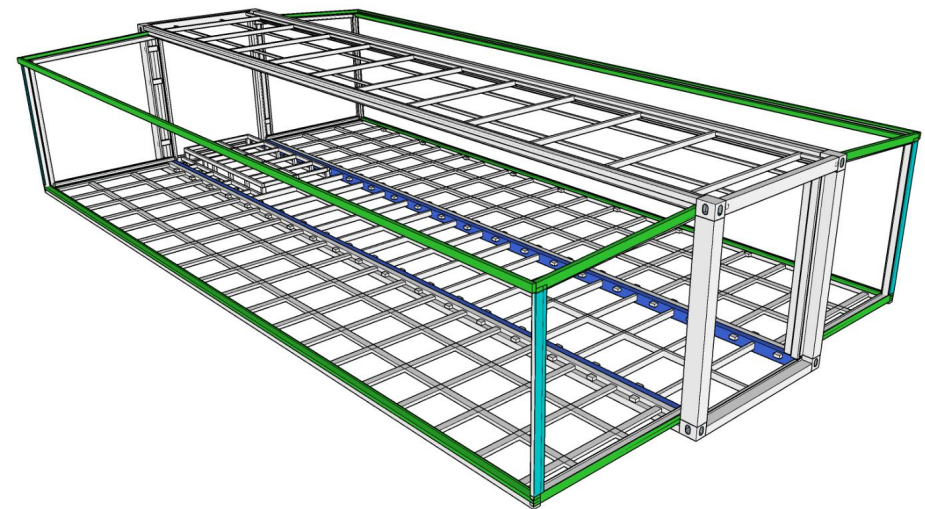

09

MORE OPTIONS



CDPH - Build Your Dream Home

▼ For Tourism Project



< 17

▼ With Trailer



▲ For Home



▲ For Business

18 >

10

CUSTOMIZATION OPTIONS



Floor



Exterior Decorative Panel



Electrical Accessories



Sockets



Window



Bath



Kitchen